

November 29th, 2019

BY E-MAIL: Mike.Giampa@ottawa.ca

City of Ottawa
Planning and Growth Management Department
110 Laurier Ave. W, 4th Floor
Ottawa ON, K1P 1J1

Attention: Mr. Mike Giampa
Project Manager, Infrastructure Approvals

Dear Mr. Giampa:

Reference: 1053, 1075 and 1145 March Road
RMA Application
Our File No.: 116132

A Transportation Impact Assessment Report (TIA), was submitted to the City in October 2018 in support of a Draft Plan of Subdivision and Zoning By-law Amendment applications for 1053, 1075 and 1145 March Road.

The roadway modifications associated with this development include the development of a new four-legged signalized intersection along March Road at the proposed Street 1 access. The proposed roadway modifications have been updated to address City comments regarding the east-west multi-use pathway.

Please find attached the required documentation to initiate the Roadway Modification Approval process for the roadway modifications associated with the above-noted development:

- Key Plan (PDF)
- Functional Design Drawing (PDF)
- 1:500 Functional Design Drawing (PDF)
- Preliminary Cost Estimate (PDF)
- Intersection turning movements (PDF)

Digital copies of the drawings will be provided when City comments are provided and addressed.

Contact information for the proponent is as follows:

CU Developments Inc.
210 Gladstone Avenue, Suite 2001
Ottawa Ontario K2P 0Y6
Canada

Attention. Jim Burghout
Email: jim.burghout@claridgehomes.com

613-233-6030

Should you require anything further please feel free to call.

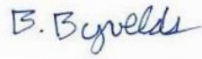

Yours truly,

NOVATECH

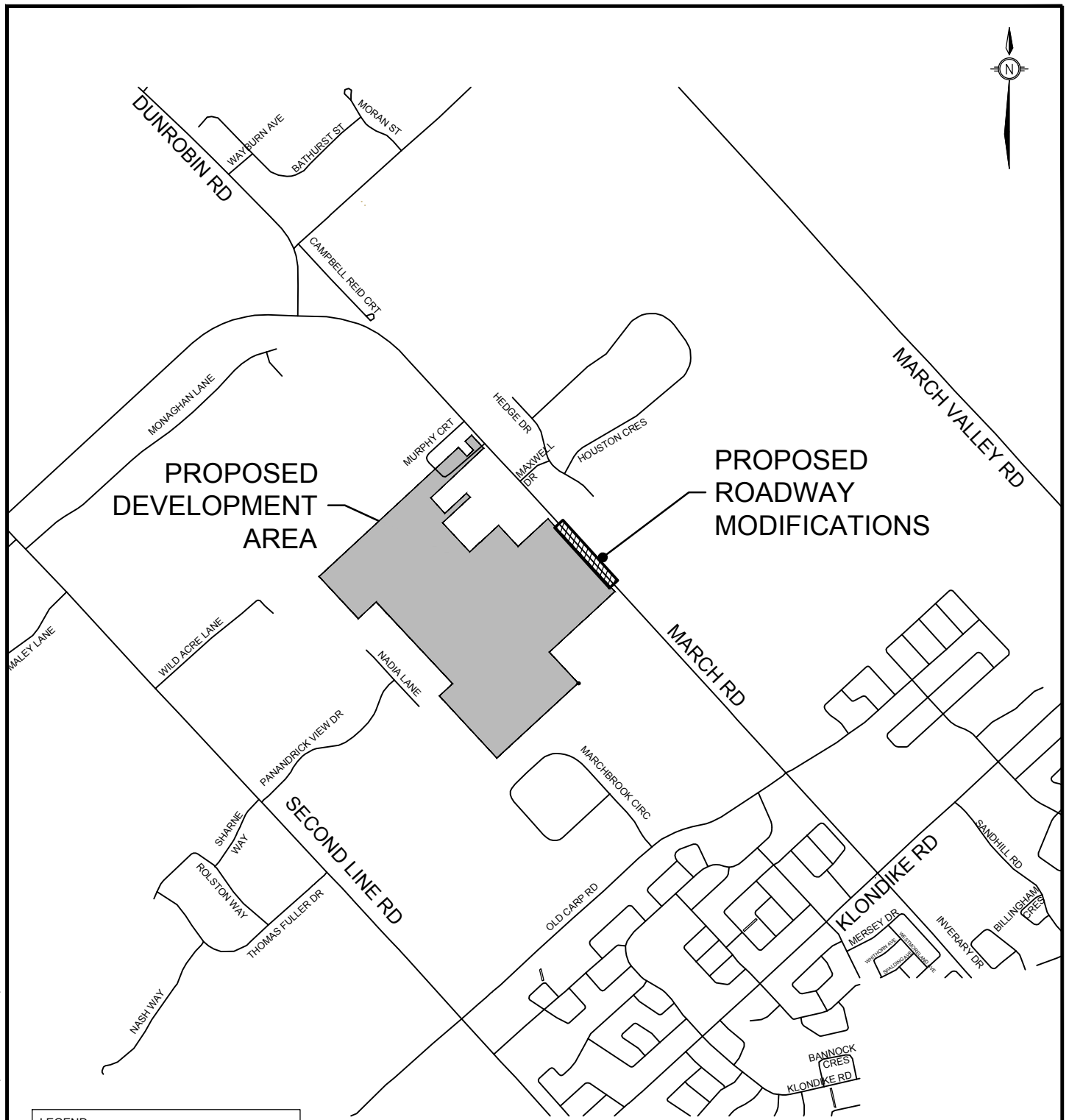

Brad Byvelds, P. Eng.
Project Coordinator | Transportation/Traffic



LEGEND:	
	PROPOSED ROADWAY MODIFICATION
	PROPOSED DEVELOPMENT AREA

M:\2016\116132\CAD\Design\116132-FD.dwg, RMA-keyplan, Nov 29, 2019 - 10:34am, millier



**KEYPLAN
MARCH ROAD
AT
STREET 1 (KANATA NORTH
URBAN EXPANSION AREA)**

Transportation Engineering Services

Approved By:	XXXX
Completed By:	NOVATECH
Scale:	Date:
N.T.S.	NOV 2019

Drawing No.:

**RMA-2019
-TES-????**

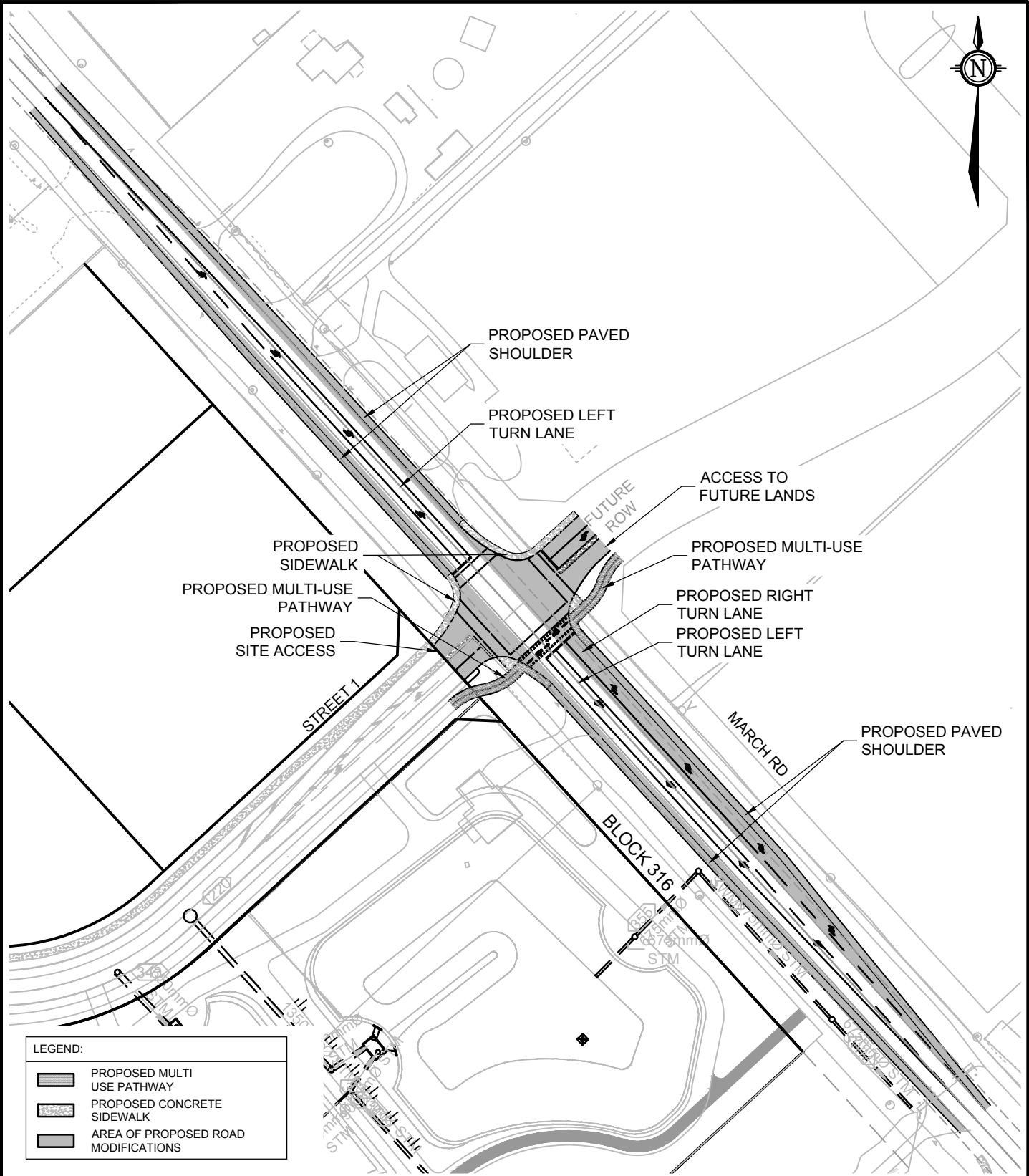

LEGEND:

	PROPOSED MULTI USE PATHWAY
	PROPOSED CONCRETE SIDEWALK
	AREA OF PROPOSED ROAD MODIFICATIONS

M:\2016\116132\CAD\Design\116132-FD.dwg, RMA-detail, Nov 29, 2019 - 10:34am, rhillier



TRANSPORTATION SERVICES
DEPARTMENT

**PROPOSED ROADWAY
MODIFICATIONS
MARCH ROAD
AT
STREET 1 (KANATA NORTH
URBAN EXPANSION AREA)**

Transportation Engineering Services

Approved By:		XXXX
Completed By:		NOVATECH
Scale:	Date:	
N.T.S.	NOV 2019	

Drawing No.:

**RMA-2019
-TES-???**

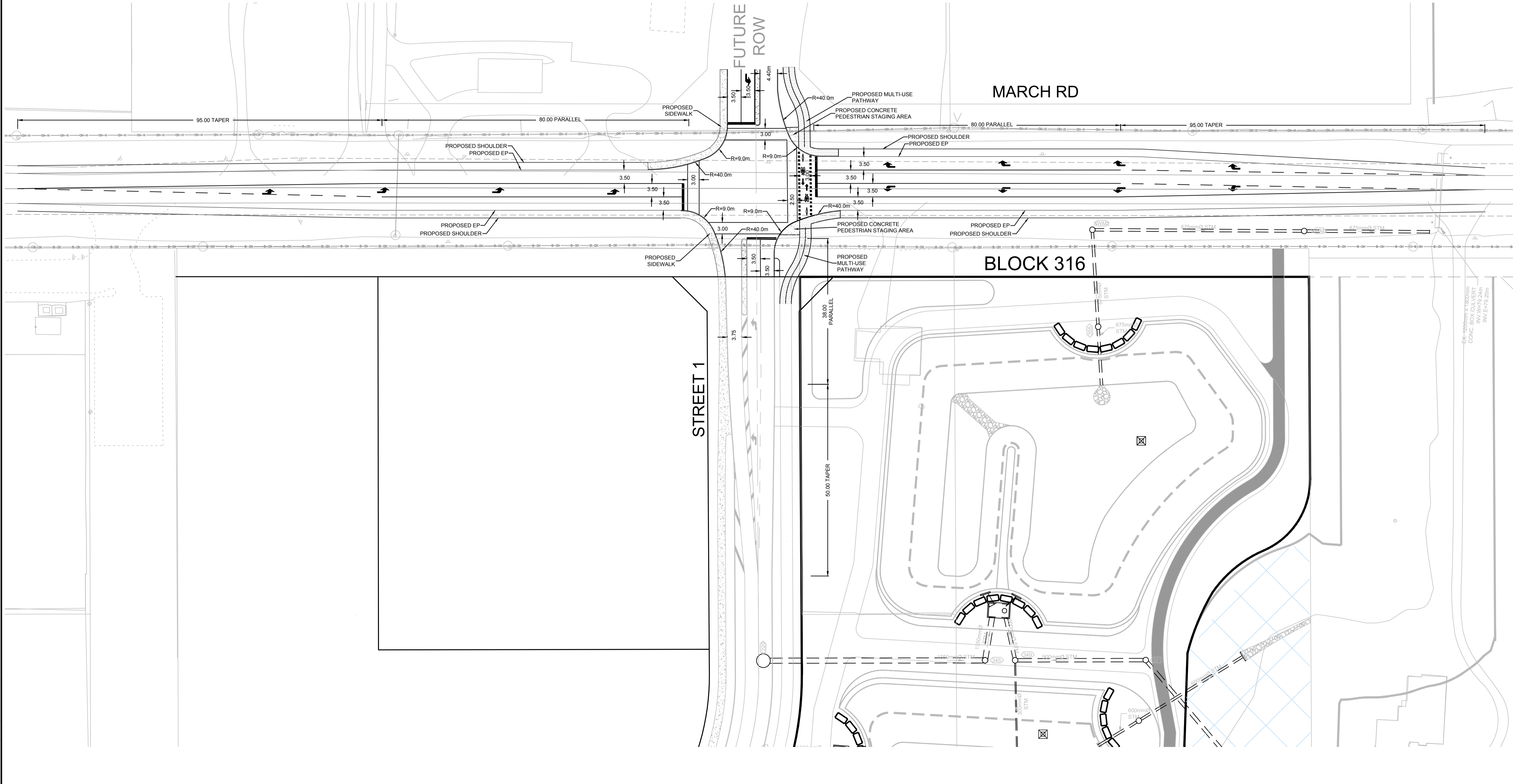
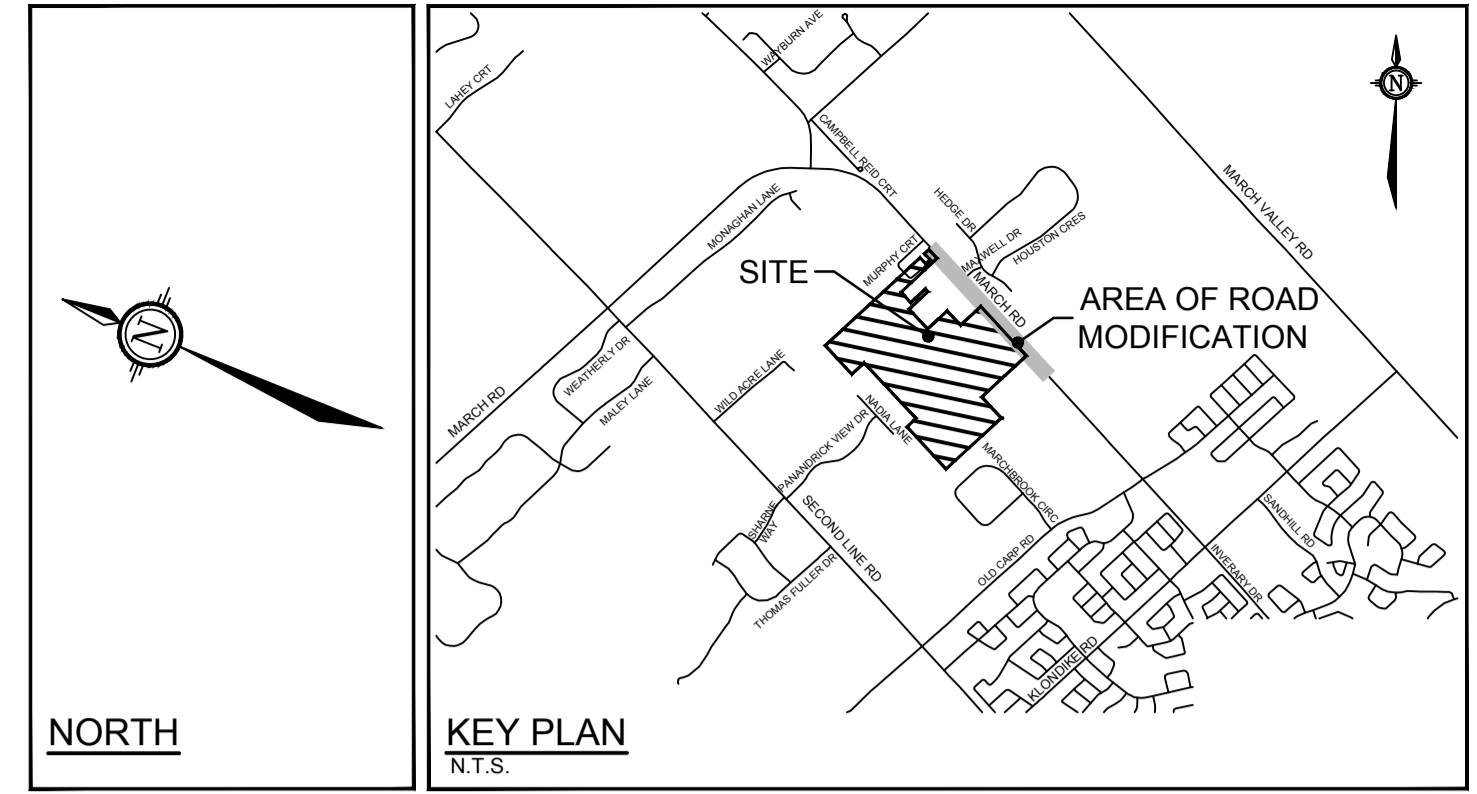

NOTE:
 THE POSITION OF ALL POLE LINES, CONDUITS, WATERMANS, SEWERS AND OTHER UNDERGROUND AND OVERGROUND UTILITIES AND STRUCTURES IS NOT NECESSARILY SHOWN ON THE CONTRACT DRAWINGS, AND WHERE SHOWN, THE ACCURACY OF THE POSITION OF SUCH UTILITIES AND STRUCTURES IS NOT GUARANTEED. BEFORE STARTING WORK, DETERMINE THE EXACT LOCATION OF ALL SUCH UTILITIES AND STRUCTURES AND ASSUME ALL LIABILITY FOR DAMAGE TO THEM.

No.	REVISION	DATE	BY
3.	REVISED PER CITY COMMENTS	NOV 29/19	BJB
2.	REVISED PER CITY COMMENTS	MAY 13/19	BJB
1.	ISSUED FOR CITY OF OTTAWA REVIEW	SEPT 28/18	BJB

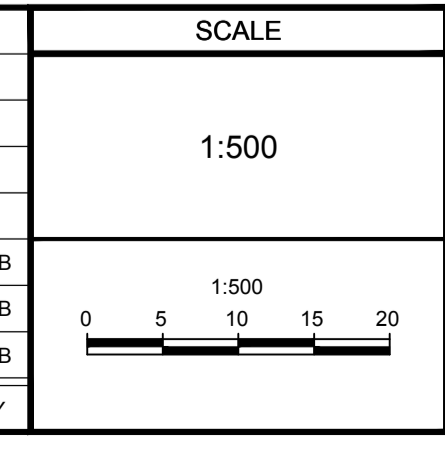

DESIGN		FOR REVIEW ONLY	
DESIGN	BJB		
CHECKED	JLL		
DRAWN	RCH		
CHECKED	BJB		
APPROVED	JLL		

NOVATECH
 Engineers, Planners & Landscape Architects
 Suite 200, 240 Michael Cowpland Drive
 Ottawa, Ontario, Canada K2M 1P6
 Telephone: (613) 254-9643
 Facsimile: (613) 254-5867
 Website: www.novatech-eng.com

LOCATION CITY OF OTTAWA MULTIVESCO LANDS - KANATA NORTH		PROJECT No. 116132-00	
DRAWING NAME MARCH ROAD/STREET 1 MODIFICATIONS FUNCTIONAL DESIGN		REV REV # 3	
		DRAWING No. 116132-FD	

M:\2016\116132\CAD\Design\116132-FD.dwg, 116132-RMA-FD, Nov 29, 2018, 10:34am, rhiller

CU DEVELOPMENTS
STREET 1 MARCH ROAD INTERSECTION
COST ESTIMATE

ITEM NO.	ITEM	QUANTITY	UNIT	UNIT RATE	TOTAL AMOUNT
SECTION A - Earthworks					
1	Traffic Management	1.00	LS	\$25,000.00	\$25,000.00
2	Erosion and Sediment Control	1	LS	\$10,000.00	\$10,000.00
3	Excavation and Grading (including tie-in to existing ditch)	1	LS	\$35,000.00	\$35,000.00
4	Topsoil Stripping	1,100	m ²	\$5.50	\$6,050.00
5	Realign and Regrade Existing Ditch (including any existing culvert realignments)	130	m	\$40.00	\$5,200.00
SUBTOTAL - SECTION A					\$81,250.00
SECTION B - Storm Sewer					
1	500mm CSP Culvert	60.0	m	\$550.00	\$33,000.00
2	Extend Existing Box Culvert	3.0	m	\$2,500.00	\$7,500.00
SUBTOTAL - SECTION B					\$40,500.00
SECTION C - Road Works					
1	Roadway Filter Fabric	3,075	m ²	\$3.00	\$9,225.00
2	Subexcavation	470	m ³	\$50.00	\$23,500.00
Local Roadway					
3	Granular B, Type II (450mm)	3,075	m ²	\$18.00	\$55,350.00
4	Granular A (150mm)	3,075	m ²	\$12.00	\$36,900.00
5	40mm Superpave 12.5mm PG 58-34	1,675	m ²	\$18.50	\$30,987.50
6	50mm Superpave 19.0mm PG 58-34	1,675	m ²	\$20.50	\$34,337.50
7	50mm Superpave 19.0mm PG 58-34	1,675	m ²	\$20.50	\$34,337.50
8	Asphalt Shoulder (80mm)	1,400	m ²	\$25.00	\$35,000.00
9	Multi-Use Asphalt Pathway	168	m ²	\$70.00	\$11,760.00
10	Curb				
	a) Barrier	57	m	\$70.00	\$3,990.00
11	Sidewalk				
	a) 1.8m width - Concrete	109	m	\$115.00	\$12,535.00
12	Concrete Median				
	a) 1.5m width - Concrete	17	m ²	\$80.00	\$1,360.00

CU DEVELOPMENTS
STREET 1 MARCH ROAD INTERSECTION
COST ESTIMATE

ITEM NO.	ITEM	QUANTITY	UNIT	UNIT RATE	TOTAL AMOUNT
13	Removals				
	a) Saw-Cut and Key Grind Existing Asphalt	765	m	\$15.50	\$11,857.50
	b) Asphalt Removal (existing driveway)	245	m ²	\$10.50	\$2,572.50
	c) Removal Gravel Shoulder	2,130	m ²	\$7.00	\$14,910.00
	d) Relocate Existing Traffic Signs	2	ea	\$150.00	\$300.00
14	Line Painting				
	a) Pavement Markings	775	m	\$5.50	\$4,262.50
	b) Pavement Symbols	12	ea	\$180.00	\$2,160.00
SUBTOTAL - SECTION C					\$325,345.00
SECTION D - Utilities					
1	Streetlight Trenching c/w Sand Bedding and Sand Backfill				
	a) Boulevard	390	m	\$36.50	\$14,235.00
2	Streetlighting				
	a) New Fixture, Poles, Brackets, Base	8	ea	\$5,000.00	\$40,000.00
	b) New Fixture, Brackets, Mounted on Joint Use	4	ea	\$2,500.00	\$10,000.00
	c) 75mm Dia. PVC Streetlight Duct	365	m	\$8.50	\$3,102.50
	d) 2x75mm Dia. Conc. Encased PVC Streetlight Duct	100		\$50.00	\$5,000.00
	e) 3 - #4 AWG Copper (B,W) + #4 GRND	525	m	\$30.00	\$15,750.00
	f) Streetlight Disconnect (EB99)	1	ea	\$9,500.00	\$9,500.00
3	Utility Pole Overhead Line Adjustment	4	ea	\$5,000.00	\$20,000.00
4	Utility Pole Relocation	2	ea	\$17,500.00	\$35,000.00
5	Signalized Intersection (including all hardware and underground traffic plant)	1	LS	\$325,000.00	\$325,000.00
SUBTOTAL - SECTION D					\$477,587.50
SECTION E - Landscaping					
1	Topsoil, Seed and Mulch	720	m ²	\$15.00	\$10,800.00
SUBTOTAL - SECTION E					\$10,800.00
TOTAL					\$935,482.50

Notes:

- 1) Granulars for the asphalt shoulder included in the roadway Granular 'A' and Granular 'B' items.
- 2) Streetlighting based on an average spacing of 1/50m and an additional 4 for the intersection.
- 3) Assume Streetlighting on one side only behind shoulder c/w pole, too much spacing between hydro poles to accommodate.
- 4) Assume Hydro available at any utility pole for streetlighting.

M:\2016\116132\CAD\Design\Figures\Traffic\116132-TM1.dwg, 116132-TM1, Nov 29, 2019 - 10:41am, rhillier

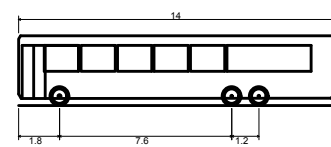
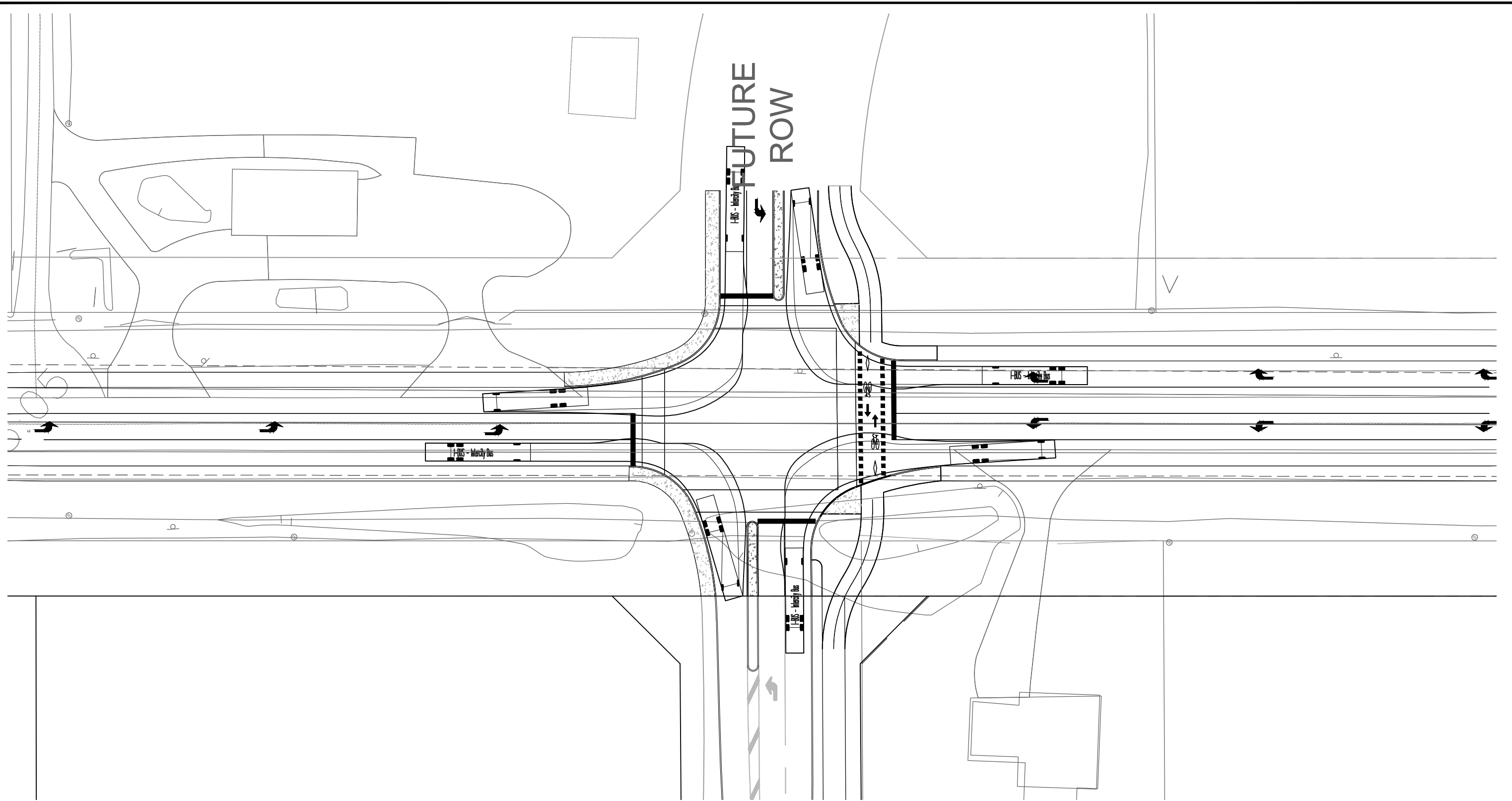

I-BUS - Intercity Bus
 Overall Length 14.000m
 Overall Width 3.084m
 Overall Body Height 2.400m
 Min Body Ground Clearance 0.319m
 Track Width 4.000m
 Lock-to-lock time 4.00s
 Curb to Curb Turning Radius 13.900m

NOVATECH

Engineers, Planners & Landscape Architects
 Suite 200, 240 Michael Cowpland Drive
 Ottawa, Ontario, Canada K2M 1P6

Telephone (613) 254-9643
 Facsimile (613) 254-5867
 Website www.novatech-eng.com

CLARIDGE/UNIFORM DEVELOPMENT

MARCH ROAD/STREET 1 TURNING MOVEMENTS

SCALE 1 : 500

DATE NOV 2019 JOB 116132 FIGURE TM-1

M:\2016\116132\CAD\Design\Figures\Traffic\116132-TM.dwg, 116132-TM2, Nov 29, 2019 - 10:41am, rhillier

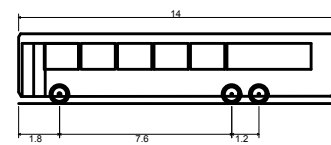
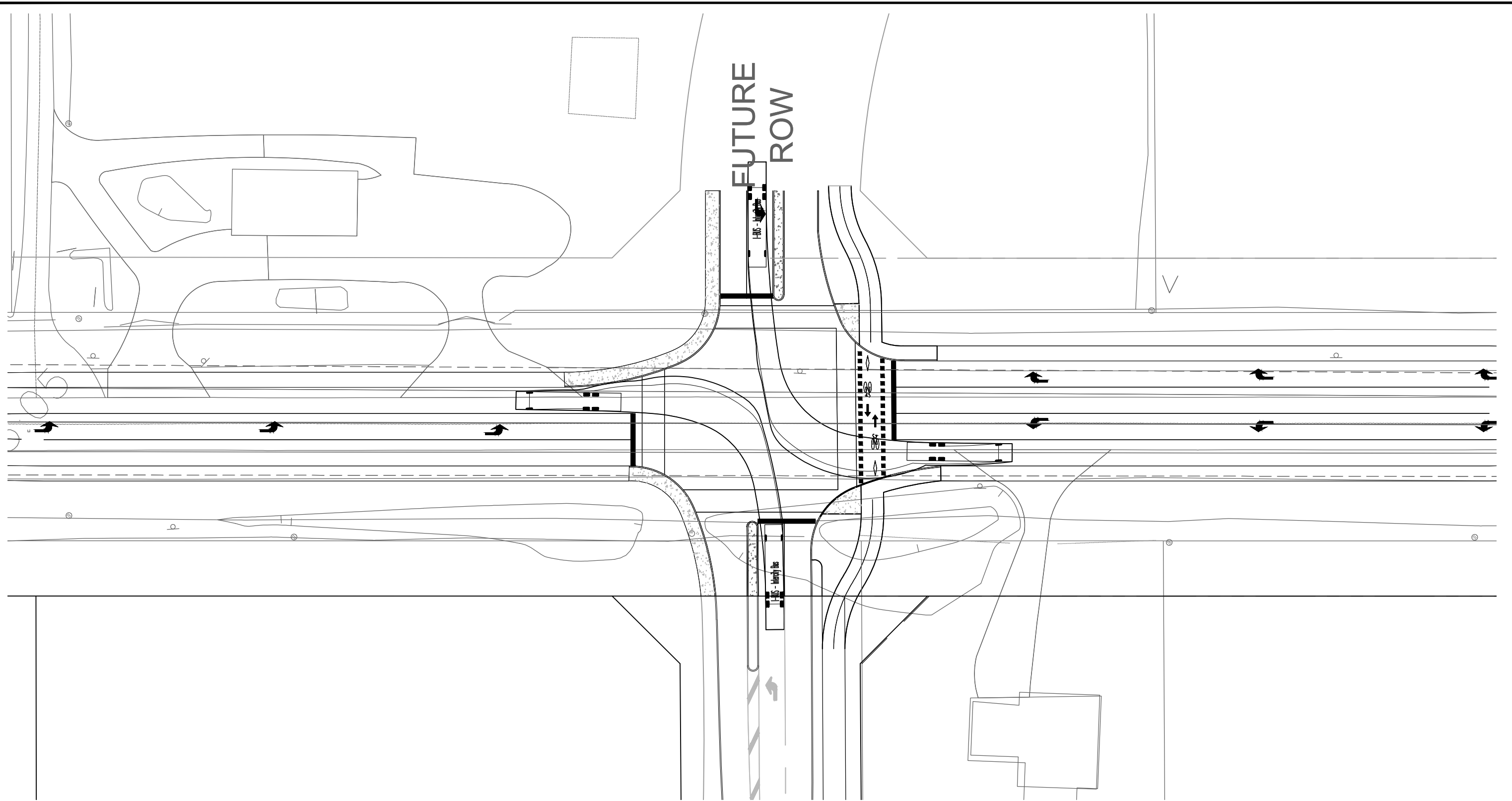

I-BUS - Intercity Bus
 Overall Length 14.000m
 Overall Width 2.400m
 Overall Body Height 3.084m
 Min Body Ground Clearance 0.319m
 Track Width 2.400m
 Lock-to-lock time 4.00s
 Curb to curb Turning Radius 13.900m

NOVATECH

Engineers, Planners & Landscape Architects
 Suite 200, 240 Michael Cowpland Drive
 Ottawa, Ontario, Canada K2M 1P6

Telephone (613) 254-9643
 Facsimile (613) 254-5867
 Website www.novatech-eng.com

CLARIDGE/UNIFORM
 DEVELOPMENT

MARCH ROAD/STREET 1
 TURNING MOVEMENTS

SCALE 1 : 500

DATE NOV 2019 JOB 116132 FIGURE TM-2

M:\2016\116132\CAD\Design\Figures\Traffic\116132-TM.dwg, 116132-TM3, Nov 29, 2019 - 10:41am, rhillier

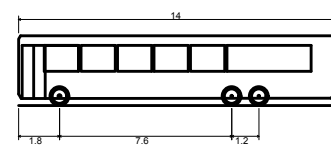
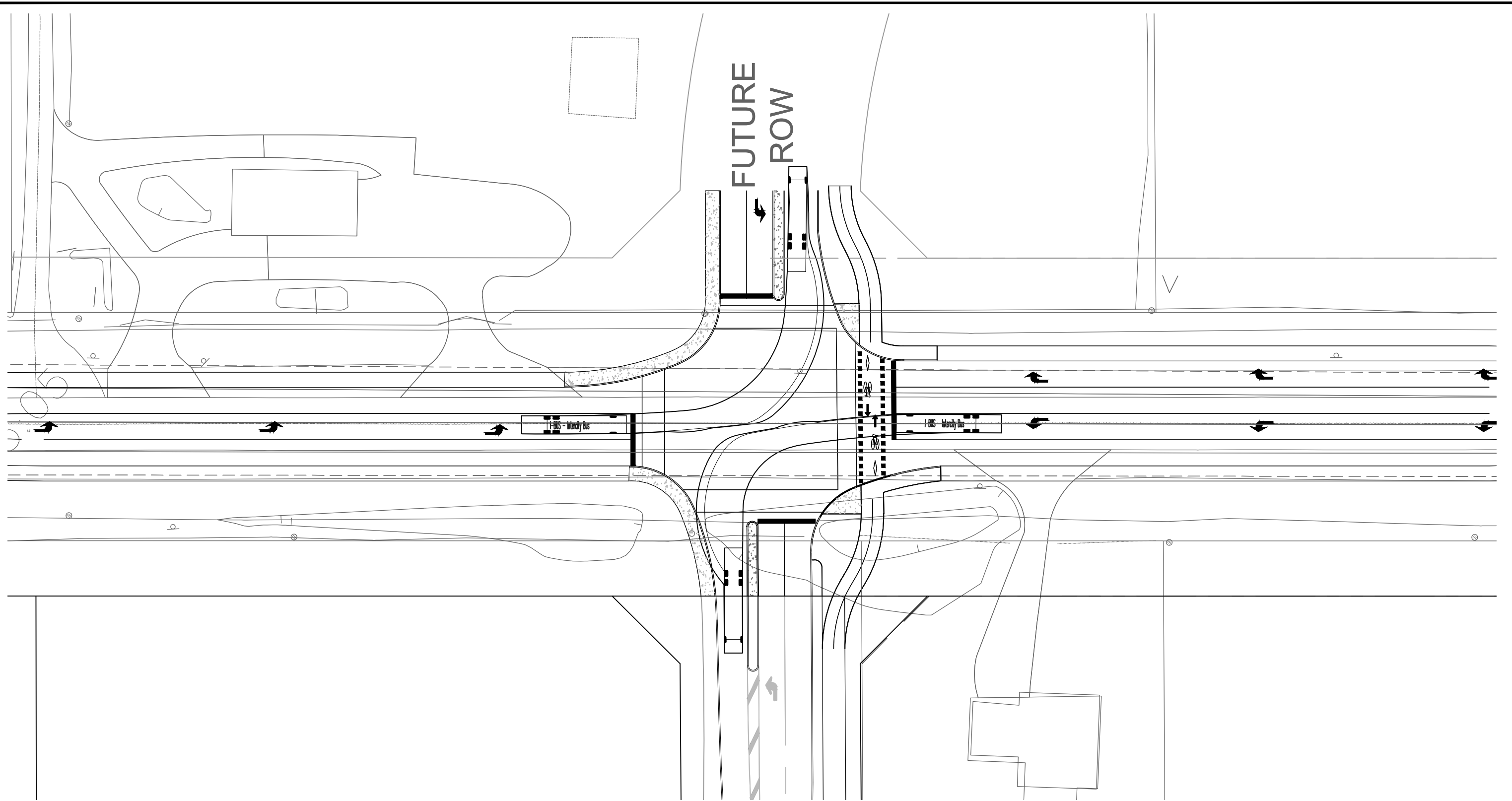

I-BUS - Intercity Bus
 Overall Length 14.000m
 Overall Width 2.400m
 Overall Body Height 3.084m
 Min Body Ground Clearance 0.319m
 Track Width 2.400m
 Lock-to-lock time 4.00s
 Curb to curb Turning Radius 13.900m

NOVATECH

Engineers, Planners & Landscape Architects
 Suite 200, 240 Michael Cowpland Drive
 Ottawa, Ontario, Canada K2M 1P6

Telephone (613) 254-9643
 Facsimile (613) 254-5867
 Website www.novatech-eng.com

CLARIDGE/UNIFORM DEVELOPMENT

MARCH ROAD/STREET 1 TURNING MOVEMENTS

SCALE 1 : 500

DATE NOV 2019 JOB 116132 FIGURE TM-3