

**LEGEND**

- SANITARY DRAINAGE SUB AREA  
POPULATION EQUIVALENT  
NUMBER OF UNITS IN SUB AREA
- DRAINAGE AREA BOUNDARY
- PROPOSED SANITARY SEWER
- EXISTING SANITARY SEWER
- OUTSIDE PROPOSED DEVELOPMENT
- N=85.75  
S=85.75  
W=85.75  
160
- PROPOSED OVERT ELEVATION
- PROPOSED MANHOLE NUMBER

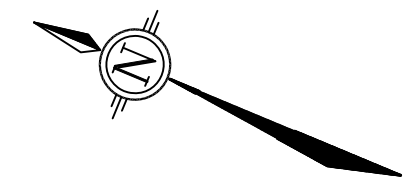

THE POSITION OF ALL POLE LINES, CONDUITS, WATERMANS, SEWERS AND OTHER UNDERGROUND AND OVERGROUND UTILITIES AND STRUCTURES IS NOT NECESSARILY SHOWN ON THE CONTRACT DRAWINGS, AND WHERE SHOWN, THE ACCURACY OF THE POSITION OF SUCH UTILITIES AND STRUCTURES IS NOT GUARANTEED. BEFORE STARTING WORK, DETERMINE THE EXACT LOCATION OF ALL SUCH UTILITIES AND STRUCTURES AND ASSUME ALL LIABILITY FOR DAMAGE TO THEM.

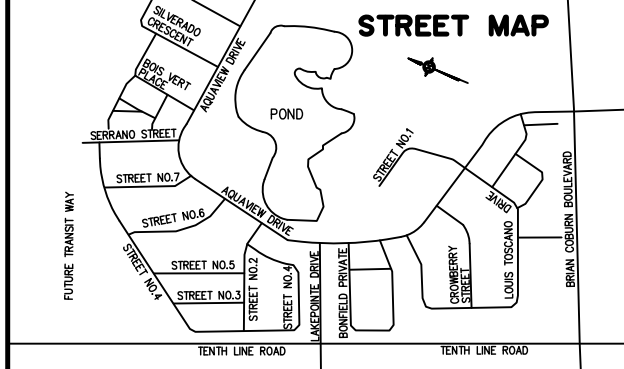

No.	REVISION	APPLIES WHEN DRAWING MODIFIED	DATE	BY
1	REVISED AS PER CITY COMMENTS		APR. 30/18	AGS
2	REVISED DRAFT PLAN		OCT. 18/18	AGS

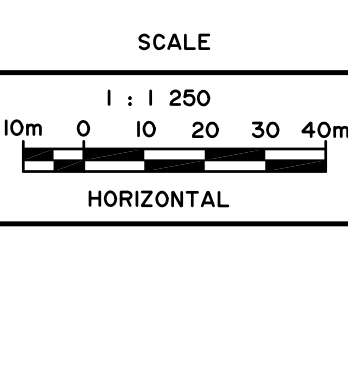

DESIGN	PLM
CHECKED	AGS
DRAWN	PLM
CHECKED	AGS
APPROVED	AGS

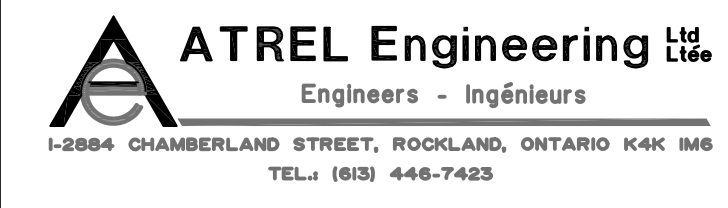

CITY OF OTTAWA  
AQUAVIEW  
PLAN  
MACRO SANITARY DRAINAGE AREA PLAN

MINTO COMMUNITIES INC.  
PROJECT No. 171203  
DRAWING No. 171203-SANM

CLIENT No. 148  
PROJECT No. 171203  
DRAWING No. 171203-SANM