

SUBJECT TO THE CONDITIONS, IF ANY, SET FORTH IN OUR LETTER DATED _____

THIS DRAFT PLAN IS APPROVED BY THE CITY OF OTTAWA UNDER SECTION 51-17 OF THE PLANNING ACT ON THIS DAY OF _____ 20____.

_____, TERRACE MODELS MANAGER
DEVELOPMENT REVIEW WEST
PLANNING, INFRASTRUCTURE AND ECONOMIC
DEVELOPMENT DEPARTMENT, CITY OF OTTAWA

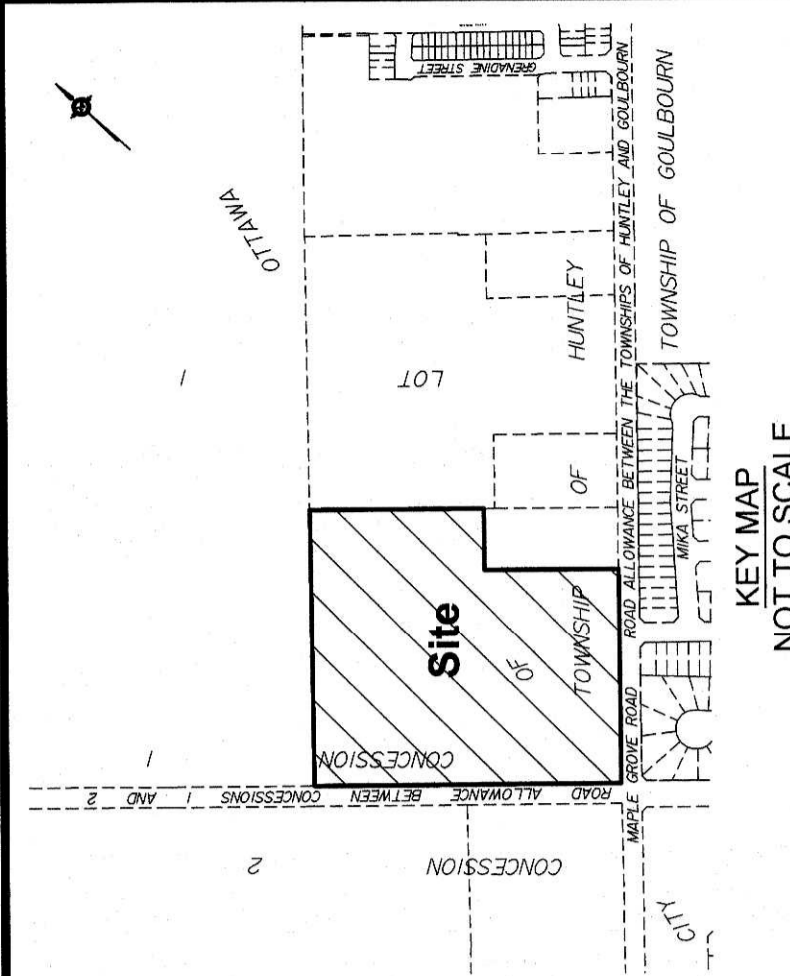

**DRAFT PLAN OF SUBDIVISION OF
PART OF LOT 1
CONCESSION 1**
Geographic Township of Huntley
CITY OF OTTAWA
Prepared by Annis, O'Sullivan, Vollebek Ltd.

Scale 1 : 750
0 2.5 5 7.5 10 15 30 Metres

Metric
DISTANCES SHOWN ON THIS PLAN ARE IN METRES AND CAN BE CONVERTED TO FEET BY DIVIDING BY 0.3048

SURVEYOR'S CERTIFICATE
I CERTIFY THAT:
The boundaries of the lands to be subdivided and their relationship to adjoining lands have been accurately and correctly shown.

May 2/2018
Date
Andrie Roy
Andrie Roy
ONTARIO LAND SURVEYOR

OWNER'S CERTIFICATE
This is to certify that I am the owner/agent of the lands to be subdivided and that this plan was prepared in accordance with my instructions.

May 2, 2018
Date
Jim Wright
Jim Wright
Claridge Homes (Maple Grove) Inc.
I have the authority to bind the corporation.

ADDITIONAL INFORMATION REQUIRED UNDER SECTION 51-17 OF THE PLANNING ACT

- (a) see plan
- (b) see plan
- (c) see plan
- (d) residential housing, parkland
- (e) see plan
- (f) see plan
- (g) see plan
- (h) City of Ottawa
- (i) see soils report
- (j) see plan
- (k) sanitary, storm sewers, municipal water, bell, hydro, cable and gas to be available
- (l) see plan

AREA SCHEDULE	
LOT/BLOCK	AREA (sqm)
1-57	19 395.4
58-66	25 558.0
67	6 834.0
68, 69 & STREETS	24 030.6
TOTAL	75 818.0