



1.1 All general site information and conditions compiled from existing plans, surveys and consultant's field notes. Report all discrepancies prior to any work. No responsibility is born by the Consultant for unknown subsurface conditions.

-

N45 ARCHITECTURE INC.
71 Bank Street, 7th Floor - Ottawa, Ontario, K1P 5N2
tel. 613.224.0095 fax 613.224.9811

East Urban Centre Elementary School
700 Spring Valley Dr.
Ottawa, ON, K1W 0H2.

drawing title			
LANDSCAPE PLAN			
scale	As Shown	drawn by	D.A.
date	2025-02-25	checked by	M.R.
project number	N45 24-828	drawing number	L-01
RA	24-1743		
CONTRACTOR TO VERIFY ALL DIMENSIONS AND NOTIFY THE ARCHITECT OF ANY DISCREPANCIES BEFORE WORK COMMENCES.			revision
DO NOT SCALE DRAWINGS			

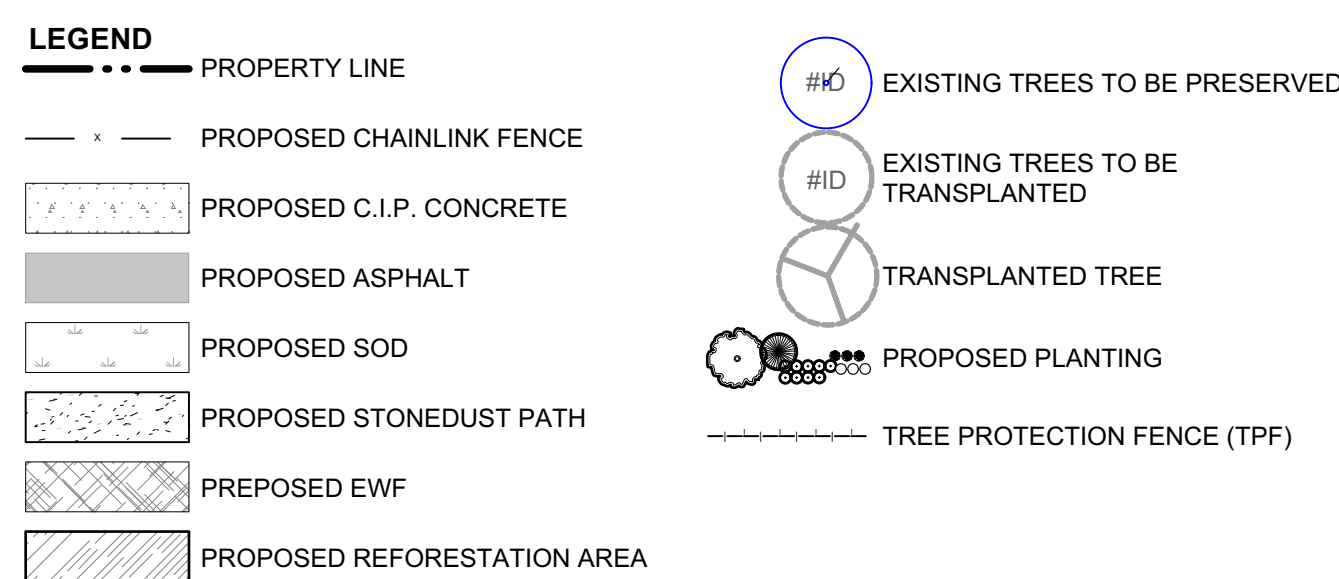

Plant List						
Origin	ID	Qty	Botanical Name	Common Name	Scheduled Size	Remarks
		28	LARGE DECIDUOUS TREES			
Ntv	As	5	Acer saccharum	Sugar Maple	70mm caliper	WB, Staked
Ntv	Co	9	Celtis occidentalis	Common Hackberry	60mm caliper	WB, Staked
Ntv	Cov	2	Carya ovata	Shagbark Hickory	60mm caliper	WB, Staked
Non Ntv	Qm	3	Ginkgo biloba 'Autumn Gold'	Autumn Gold Maidenhair Tree	70mm caliper	WB, Staked
Ntv	GB	5	Quercus macrocarpa	Burr Oak	70mm caliper	WB, Staked
Ntv	Qr	4	Quercus rubra	Northern Red Oak	70mm caliper	WB, Staked
		12	LARGE COLUMNAR DECIDUOUS TREES			
Ntv	ArAS	2	Acer rubrum 'Autumn Spice'	Autumn Spice Red Maple	60mm caliper	WB, Staked
Ntv	CoPS	3	Celtis occidentalis 'Prairie Sentinel'	Prairie Sentinel Hackberry	70mm caliper	WB, Staked
Ntv	GD	7	Gleditsia triacanthos 'Inermis 'Draves'	Streetkeeper Honeylocust	70mm caliper	WB, Staked
		29	MEDIUM DECIDUOUS TREES			
Ntv	Ag	5	Aesculus glabra	Ohio Buckeye	50mm caliper	WB, Staked
Ntv	Bp	2	Betula papyrifera	Paper Birch, Canoe Birch	60mm caliper	WB, Staked
Non N	MD	3	Malus 'Dolgo'	Malus Dolgo	60mm caliper	WB, Staked
Ntv	Ov	6	Ostrya virginiana	Ironwood	50mm caliper	WB, Staked
Ntv	Sd	4	Sorbus Americana	Mountain Ash	45mm caliper	WB, Staked
Ntv	Ta	3	Tilia americana	Basswood	70mm cal	WB, Staked
Non Ntv	UF	6	Ulmus minor x parvifolia 'Frontier'	Frontier Elm	70mm caliper	WB, Staked
		5	MEDIUM DECIDUOUS TREES			
Ntv	CcgC	5	Crataegus crus-galli inermis 'Cruzam'	Thornless Crusader Cockspur Hawthorn	45mm caliper	WB, Staked
		18	CONIFEROUS TREES			
Ntv	Ab	4	Abies balsamea	Balsam Fir	200 cm ht	WB, Staked
Ntv	Pg	7	Picea glauca	White Spruce	200 cm ht	WB, Staked
Ntv	Pr	2	Pinus resinosa	Red Pine	200cm ht	WB, Staked
Ntv	Ps	5	Pinus strobus	Eastern White Pine	200 cm ht	WB, Staked

TREES UNDER CITY OWNERSHIP = 17, UNDER PRIVATE OWNERSHIP = 75

Shrubs					
ToH	60	Thuja occidentalis 'Holmstrup'	Holmstrup Cedar	125cm ht	Potted
Perennials					
Hs	90	Helictrochon sempervirens	Ornamental Oats	3 year	Potted
CaKF	120	Calamagrostis x acutiflora 'Karl Foerster'	Feather Reed Grass	3 year	Potted

NOTE:
SITE SERVICING ELEMENTS SHOWN ON THIS SHEET ARE FOR REFERENCE ONLY.
SEE CIVIL DRAWINGS FOR SITE SERVICING / GRADING.

PLAN TO BE READ IN CONJUNCTION WITH 'TREE CONSERVATION REPORT FOR 700 SPRING VALLEY, OTTAWA ON' APRIL 08, 2025 BY Andrew K. Boyd, Certified Arborist #ON-0496A, IFS Associates.

TRANSPLANTING & REFORESTATION NOTES
TRANSPLANTING OF TREES TO BE COMPLETED AT THE PROJECT STARTUP, IDEALLY IN
FALL.

BASE CONTRACT: ASSUME ALL THE TREES CAN BE TRANSPLANTED. IF NOT THEN A MEDIUM TO LARGE NATIVE DECIDUOUS TREE (70CM CALIPER) FROM THE PLANT LIST SHOULD BE PLANTED INSTEAD.

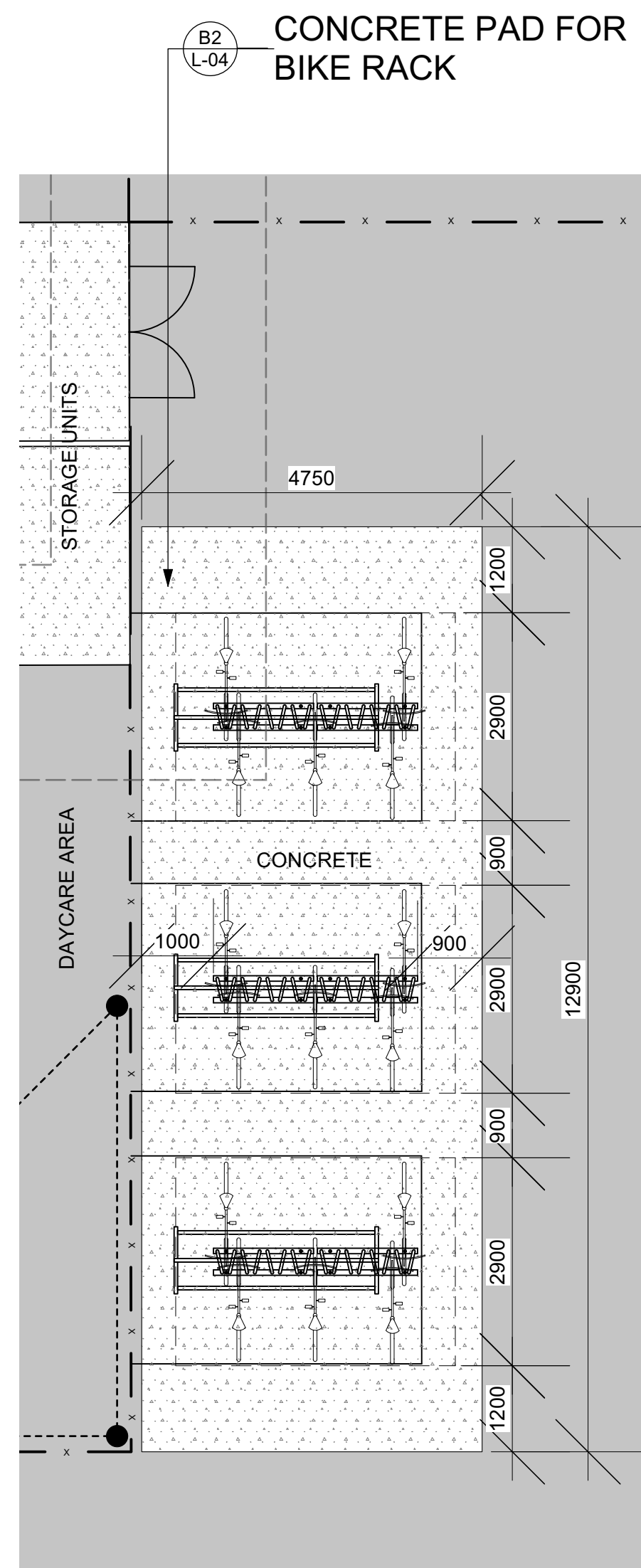
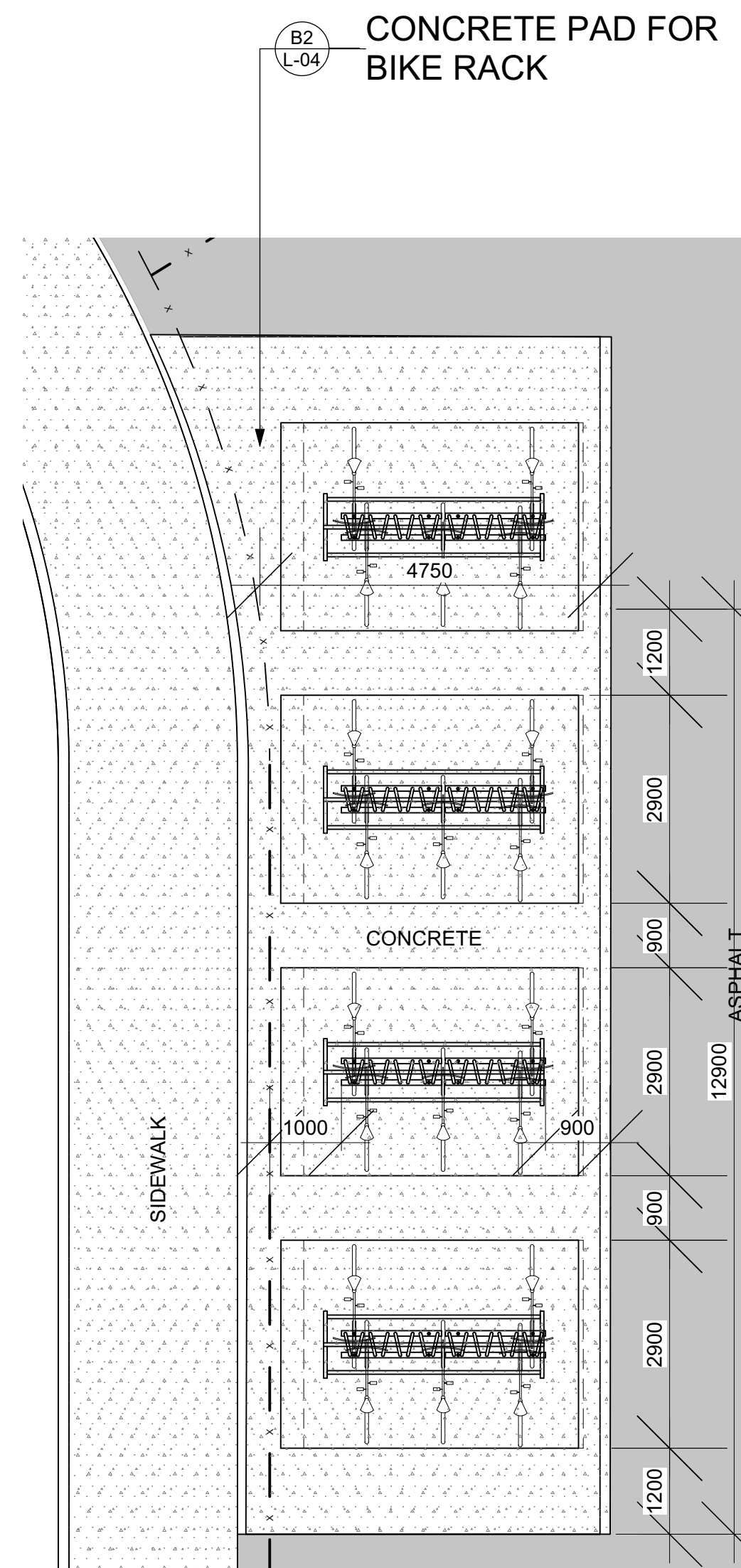
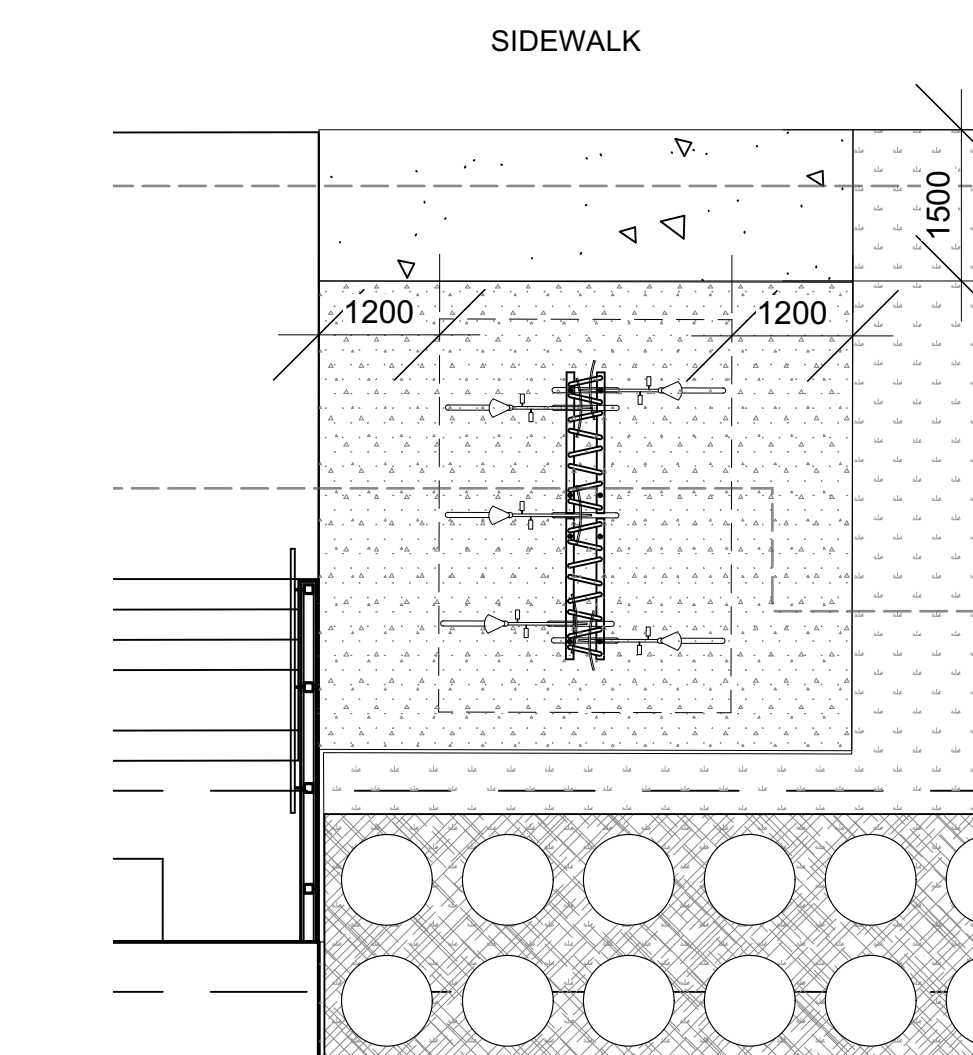
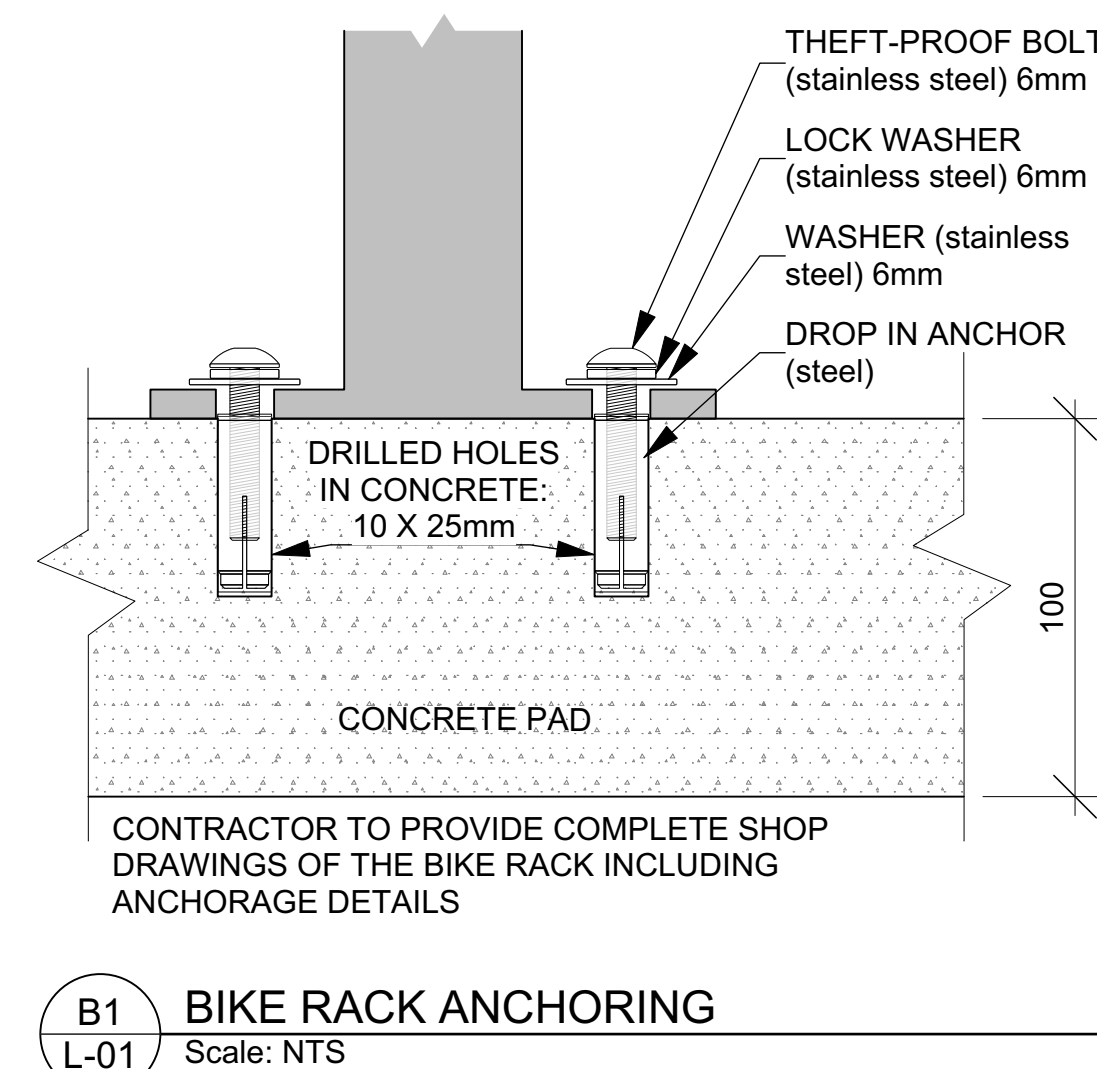

2
L-01

ENLARGEMENT - KINDERGARTEN & DAYCARE PLAY AREA
Scale: 1:150

EN-1 ENLARGEMENT - BIKE RACK 1
L-01 Scale: NTS
4 BIKE RACKS - EQUIPARC EP5911-7; 30 BIKES

EN-2 **ENLARGEMENT - BIKE RACK 2**
L-01 Scale: NTS
 6 BIKE RACKS - EQUIPARC EP5911-7; 45 BIKES

EN-3 **ENLARGEMENT - BIKE RACK 3**
L-01 Scale: NTS
 6 BIKE RACKS - EQUIPARC EP5911-7; 45 BIKES

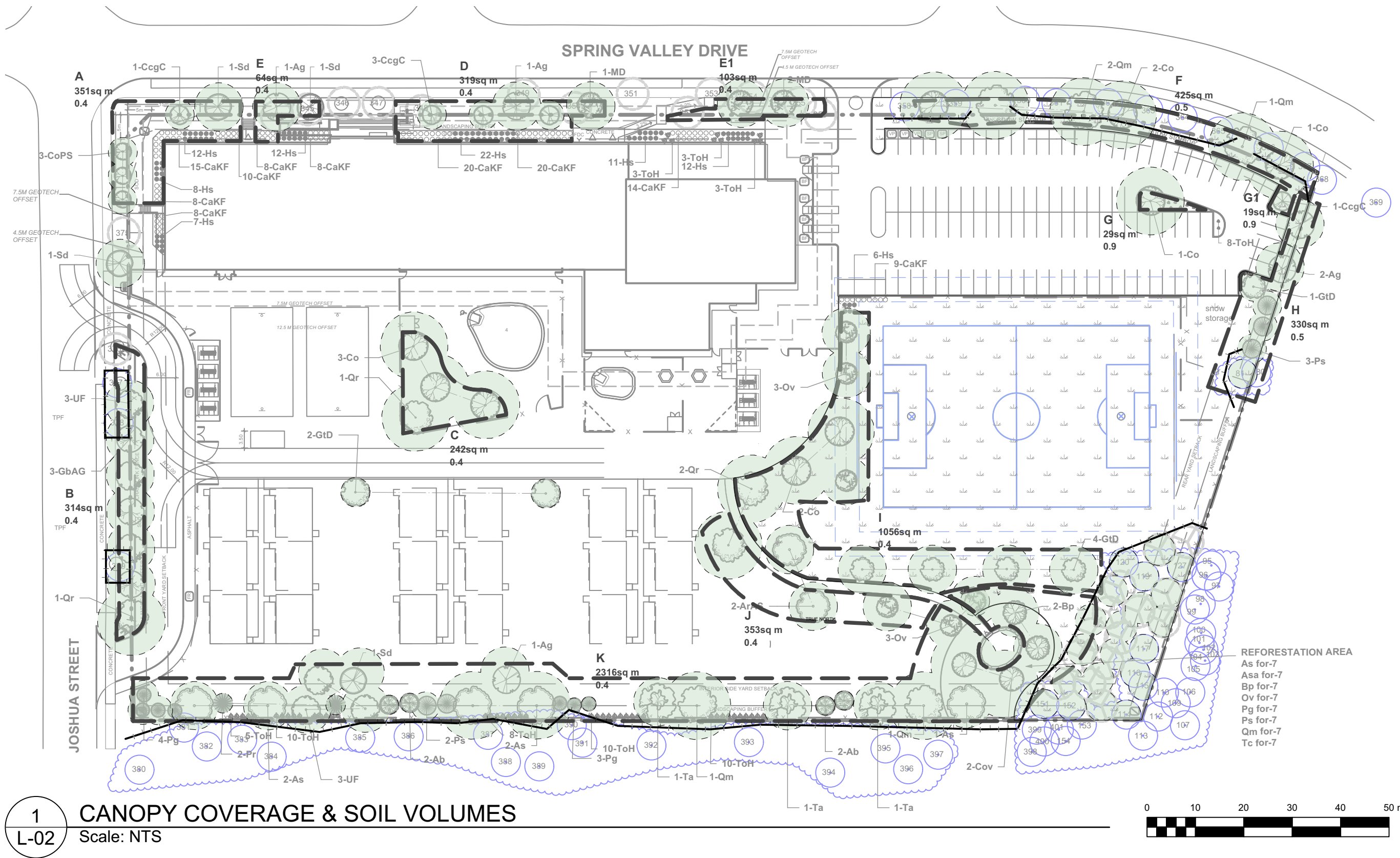

- LEGEND**
- EXISTING TREES TO BE PRESERVED
 - EXISTING TREES TO BE TRANSPLANTED
 - TRANSPLANTED TREE
 - PROPOSED PLANTING
 - TREE PROTECTION FENCE (TPF)

TREE CANOPY COVERAGE			
TOTAL CANOPY AREA	7112	m2	
TOTAL SITE AREA	28345	m2	
PERCENT COVERAGE	25.09%		

Soil Volume Area, Tree Quantity and Size		Tree Quantity	OTTAWA Target Soil Volume (m³)	Design Soil Volume	Soil Adequacy percentage	%Soil to be supplied by contractor
AREA A - 1 Medium, 1 Small, 3 L - Columnar Trees						SEE NOTE
plant bed (351 sq m x 0.4 ave metre deep)		5	87.0	140.4	161%	2
AREA B - 1 Large, 6 Medium, 2 Ex. Trees						SEE NOTE
plant bed (314 sq m x 0.4 ave metre deep)		8	144.0	125.6	87%	2
AREA C - 4 Large Trees						SEE NOTE
plant bed (242 sq m x 0.4 ave metre deep)		4	72.0	96.8	134%	1
AREA D - 3 Small, 2 Medium Trees						SEE NOTE
plant bed (319 sq m x 0.4 ave metre deep)		4	66.0	127.6	193%	2
AREA E - 1 Medium Tree						SEE NOTE
plant bed (61 sq m x 0.7 ave metre deep)		2	36.0	42.7	119%	2
AREA E1 - 2 Medium Trees						SEE NOTE
plant bed (103 sq m x 0.4 ave metre deep)		2	36.0	41.2	114%	2
AREA F - 6 Large, 3 Ex. Trees						SEE NOTE
plant bed (425 sq m x 0.4 ave metre deep)		6	108.0	170.0	157%	2
AREA G - 1 Large Tree						SEE NOTE
plant bed (29.5 sq m x 1.2ave metre deep)		1	30.0	35.4	118%	1
AREA G1 - 1 Small Tree						SEE NOTE
plant bed (19 sq m x 1.1ave metre deep)		1	25.0	20.9	84%	1
AREA H - 3 Medium Trees, 3 Conifers						SEE NOTE
plant bed (330 sq m x 0.4ave metre deep)		6	108.0	132.0	122%	3
AREA I - 3 Large, 8 Medium Trees						SEE NOTE
plant bed (1056 sq m x 0.4ave metre deep)		11	198.0	422.4	213%	4
AREA J - 1 Large, 2 Medium Trees						SEE NOTE
plant bed (353 sq m x 0.4ave metre deep)		3	54.0	141.2	261%	4
AREA K - 8 Large, 13 Medium Trees, 13 Con.						SEE NOTE
plant bed (2316 sq m x 0.4ave metre deep)		28	504.0	926.4	184%	4

* Smaller columnar trees, small ornamental trees with growth to 8-15cm DBH, large shrubs, and columnar conifers calculated using 'How much soil to grow a big tree' by DeepRoot as a guide

Reforestation Trees			
As for	7	Acer saccharum	Sugar Maple
Asa for	7	Acer rubrum	Red Maple
Bp for	7	Betulus papyrifera	White Birch
Ov for	7	Ostrya virginiana	American Hophornbeam
Pg for	7	Picea glauca	White Spruce
Ps for	7	Pinus strobus	White Pine
Qm for	7	Quercus macrocarpa	Bur Oak
Tc for	7	Tsuga canadensis	Canadian Hemlock

NOTES:

1 WHERE SOIL VOLUMES ARE WITHIN EXCAVATED DEVELOPMENT AREA:

PROVIDE 100% PLANTING MEDIUM TO DEPTHS INDICATED IN SOIL VOLUME CHART.

WHERE SUBSOIL BELOW THE INDICATED DEPTH OF PLANTING MEDIUM IS NOT CONDUCTIVE TO PLANT GROWTH, REPLACE WITH APPROVED SUBSOIL TO A FURTHER DEPTH OF 300mm.

2 WHERE SOIL VOLUMES INCLUDE SOIL VOLUMES IN R.O.W. AT PROPERTY LINE

R.O.W. AND WITHIN SUBJECT PROPERTY.

ASSUME ALL SOIL VOLUME REQUIREMENTS ARE MET WITHIN THE R.O.W. AREA. REINSTATE ANY DISTURBED AREAS IN R.O.W. OUTSIDE THE 2m RADIUS TREE PITS WITH 100-150mm TOPSOIL AND SOD.

PLACE PLANTING MEDIUM (TO DEPTH INDICATED ON SOIL VOLUME CHART) AT ALL DISTURBED AREAS WHERE EXISTING SOILS ARE REMOVED, OR WHERE EXISTING SOILS ARE NOT CONDUCTIVE TO PLANT GROWTH.

ADDITIONAL PLANTING MEDIUM IS NOT REQUIRED WHERE EXISTING SOIL IS PRESENT IN OR ADJACENT TO THE R.O.W. THIS DOES NOT INCLUDE TOPSOIL REQUIRED FOR SODDING.

WHERE SUBSOIL BELOW THE INDICATED DEPTH OF PLANTING MEDIUM IS NOT CONDUCTIVE TO PLANT GROWTH, REPLACE WITH APPROVED SUBSOIL TO A FURTHER DEPTH OF 300mm.

BASE CONTRACT TO ASSUME SUBSOIL IS CONDUCTIVE TO PLANT GROWTH.

3 WHERE SOIL VOLUMES INCLUDE SOIL VOLUMES ON ADJACENT PROPERTY AT PROPERTY LINE

ADJACENT PROPERTY AND WITHIN SUBJECT PROPERTY.

ASSUME ALL SOIL VOLUME REQUIREMENTS ARE MET WITHIN THE ADJACENT PROPERTY AREA. REINSTATE ANY DISTURBED AREAS ON ADJACENT PROPERTY OUTSIDE THE 2m RADIUS TREE PITS WITH 100-150mm TOPSOIL AND SOD.

PLACE PLANTING MEDIUM (TO DEPTH INDICATED ON SOIL VOLUME CHART) AT ALL DISTURBED AREAS WHERE EXISTING SOILS ARE REMOVED, OR WHERE EXISTING SOILS ARE NOT CONDUCTIVE TO PLANT GROWTH.

ADDITIONAL PLANTING MEDIUM IS NOT REQUIRED WHERE EXISTING SOIL IS PRESENT IN OR ADJACENT TO THE ADJACENT PROPERTY. THIS DOES NOT INCLUDE TOPSOIL REQUIRED FOR SODDING.

WHERE SUBSOIL BELOW THE INDICATED DEPTH OF PLANTING MEDIUM IS NOT CONDUCTIVE TO PLANT GROWTH, REPLACE WITH APPROVED SUBSOIL TO A FURTHER DEPTH OF 300mm.

BASE CONTRACT TO ASSUME SUBSOIL IS CONDUCTIVE TO PLANT GROWTH.

4 AREAS NEAR SOCCER FIELD AND OUTDOOR CLASSROOM

ASSUME ALL SOIL VOLUME REQUIREMENTS ARE MET, REINSTATE ANY DISTURBED AREAS ON ADJACENT PROPERTY OUTSIDE THE 2m RADIUS TREE PITS WITH 100-150mm TOPSOIL AND SOD.

ADDITIONAL PLANTING MEDIUM IS NOT REQUIRED WHERE EXISTING SOIL IS PRESENT IN OR ADJACENT TO THE ADJACENT PROPERTY. THIS DOES NOT INCLUDE TOPSOIL REQUIRED FOR SODDING.

WHERE SUBSOIL BELOW THE INDICATED DEPTH OF PLANTING MEDIUM IS NOT CONDUCTIVE TO PLANT GROWTH, REPLACE WITH APPROVED SUBSOIL TO A FURTHER DEPTH OF 300mm.

BASE CONTRACT TO ASSUME SUBSOIL IS CONDUCTIVE TO PLANT GROWTH.

Bed Preparation

- EXCAVATE OR PLACE FILL FOR PLANTING BED TO PROVIDE 750mm MINIMUM DEPTH OF PLANTING MEDIUM AND 300mm MIN DEPTH SUBSOIL (CONTINUOUS BETWEEN TREES).
- WHERE DISTANCE BETWEEN CURB ALLOWS, EXTEND DEPTH OF SUBSOIL. SUBSOIL TO BE APPROVED FILL OR OPSS GRANULAR 'B' TYPE 1 CULTIVATE PLANTING SUBSOIL INTO SUBGRADE TO A DEPTH OF 150mm.
- PLACE COMPACTED PLANTING MEDIUM ON SUBSOIL TO ACHIEVE FINAL GRADE.
- CENTRE OF BED TO BE CROWNED ABOVE ADJACENT GRADE TO APPROVAL OF CONSULTANT.

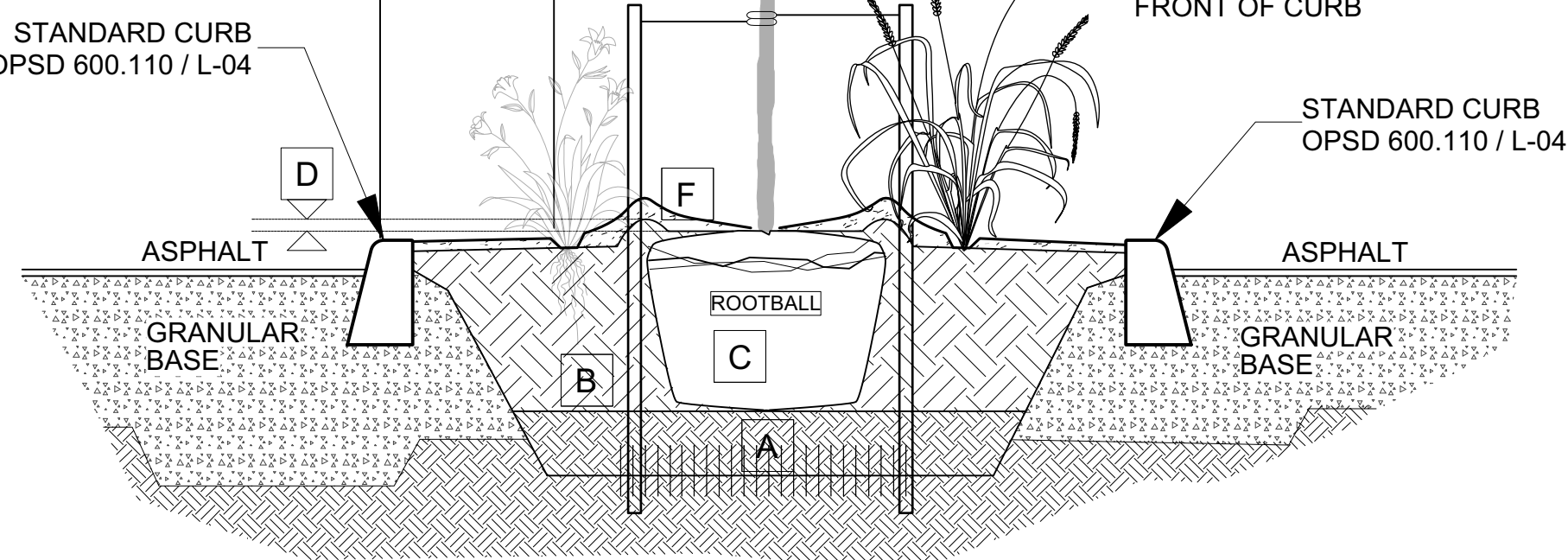

2 TREE & PERENNIAL PLANTING IN CURBED PLANTER

Scale: NTS

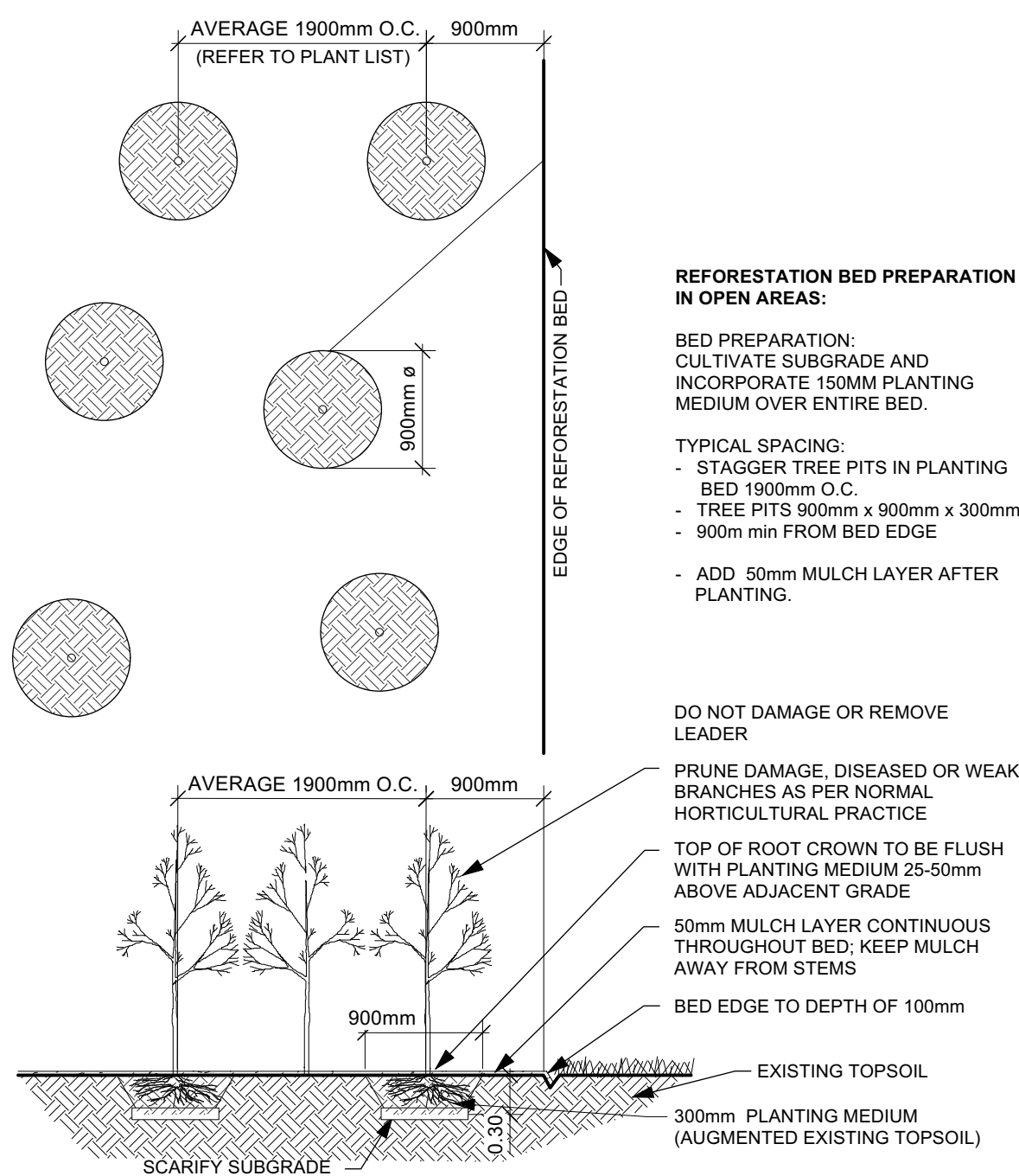

- 450mm COMPACTED PLANTING MEDIUM, DEEPEN AT TREES
- ROOTBALL, TOP OF ROOT CROWN TO BE FLUSH WITH PLANTING SOIL AND 50mm ABOVE SOIL OUTSIDE PLANTING PIT / POT
- 350mm PLANTING MEDIUM / SUBSOIL CULTIVATED LAYER. CULTIVATE AT TREE PIT BOTTOM. SEE NOTE BELOW.
- EDGE TO DEPTH OF 100mm.
- 50-75 mm MULCH LAYER, KEEP MULCH AWAY FROM STEMS.
- PRUNE DAMAGE, DISEASED OR WEAK BRANCHES AS PER ACCEPTED HORTICULTURAL PRACTICE. DO NOT DAMAGE OR REMOVE LEADER.
- FIRST ROW OF PERENNIALS TO BE PLANTED 800mm FROM EDGE OF BED/CURB FIRST ROW OF SHRUBS TO BE PLANTED 900mm FROM EDGE OF BED/CURB
- PROVIDE 150 mm DEEP SAUCER AT TREES

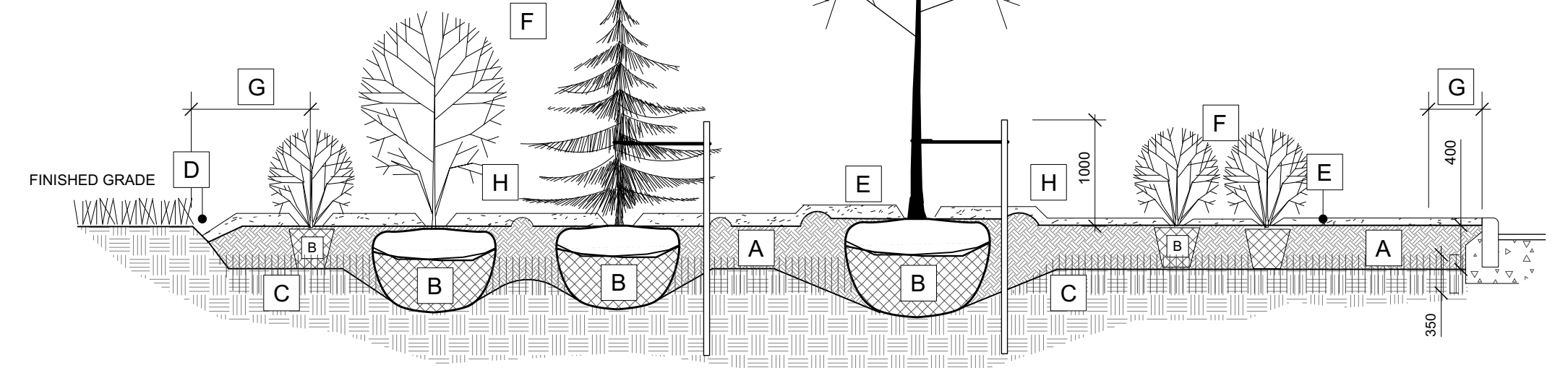

BED PREPARATION

- EXCAVATE OR PLACE FILL FOR PLANTING BED TO PROVIDE 450mm MINIMUM DEPTH OF PLANTING MEDIUM. PLANTING BED TO BE DEEPENED AT TREE LOCATIONS. FILL OF PIT IS OVER EXCAVATED, RAISE BOTTOM TO PROPER LEVEL WITH COMPACTED PLANTING MEDIUM.
- PLACE 150mm PLANTING MEDIUM ON SUBGRADE AND CULTIVATE INTO TOP 200mm OF SUBSOIL. SEE NOTE BELOW.
- PLACE REMAINDER OF PLANTING MEDIUM OVER CULTIVATED PORTION TO ACHIEVE FINAL GRADE.
- CENTRE OF BED TO BE CROWNED ABOVE ADJACENT GRADE TO APPROVAL OF CONSULTANT.
- ENSURE POSITIVE DRAINAGE AWAY FROM BUILDING WALLS WHERE APPLICABLE.

TREE PLANTING:

- CUT AND REMOVE TOP 2/3 OF BURLAP AND WIRE BASKET FROM ROOTBALL.
- PLACE 1-METAL POST (40 x 40 x 2100 mm) AT OUTSIDE OF ROOTBALL ON THE PREVAILING WIND SIDE AND FASTEN TO TRUNK WITH APPROVED TREE TIES.
- WATER THOROUGHLY SUBSEQUENT TO PLANTING AND THROUGHOUT THE WARRANTY PERIOD.
- WRAP TREE TRUNK AFTER INSPECTION OF TREES BY LANDSCAPE ARCHITECT.
- INSTALL RODENT GUARD AND PROTECT TREE FROM RODENT DAMAGE.
- REMOVE TREE RINGS, STAKES AND TRUNK WRAPPING AFTER WARRANTY PERIOD.
- ENSURE THAT ALL TREES MEET THEIR REQUIRED SETBACKS WHEN PLANTED AS PER CITY'S TREE PLANTING GUIDELINE (2008). DECIDUOUS SPECIES SHALL BE A MINIMUM 1.5 METERS AND CONIFEROUS SPECIES SHALL BE A MINIMUM OF 4.5 METER FROM ROADWAY, DRIVEWAY, SIDEWALK.

6 PLANTING DETAIL

Scale: NTS

- PLANTING BED AREAS EXCAVATED TO 500mm BELOW FINAL GRADE FOR ROUGH GRADE.
- REFER TO PLANT LIST FOR PLANT SPACING.

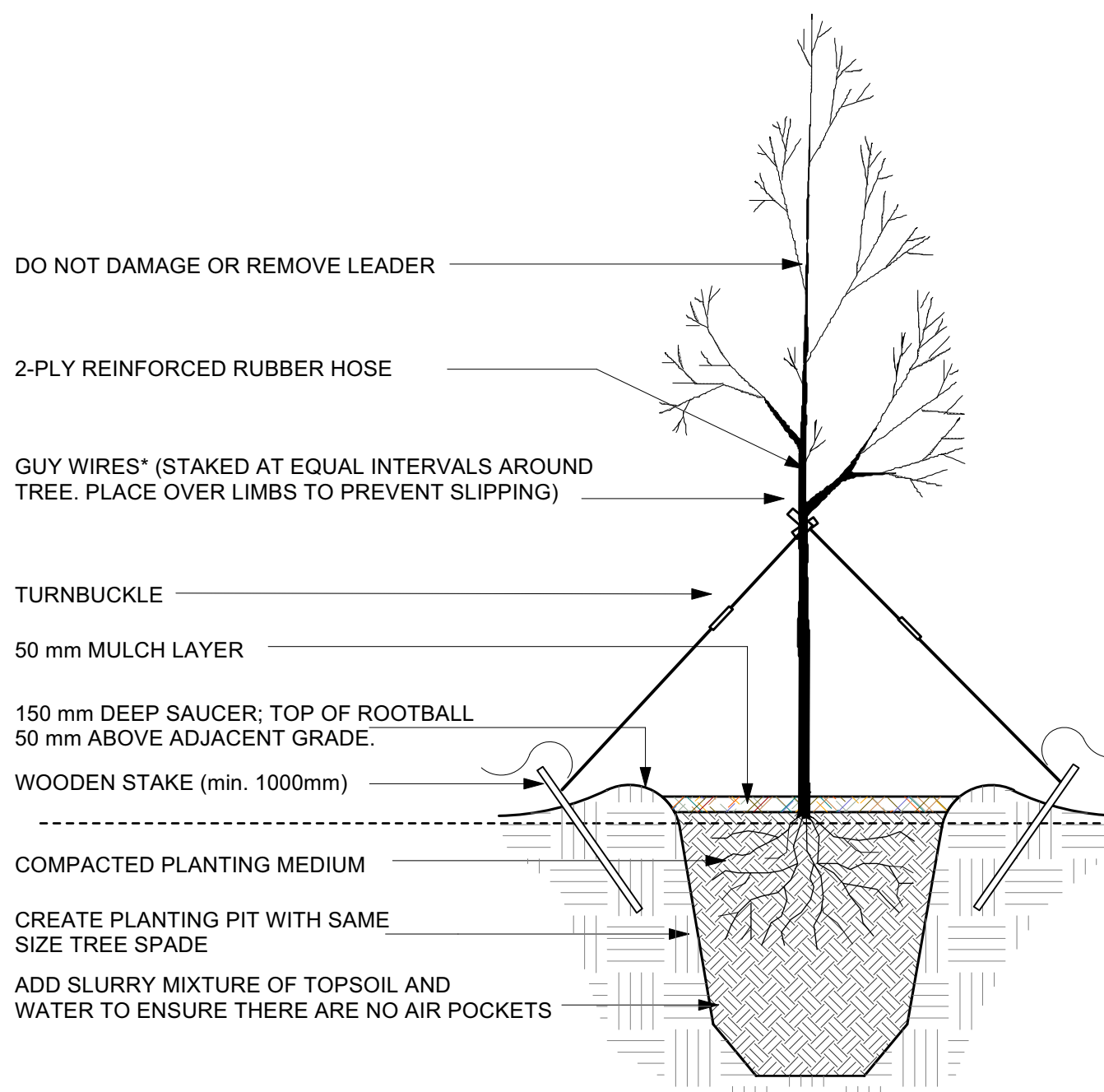
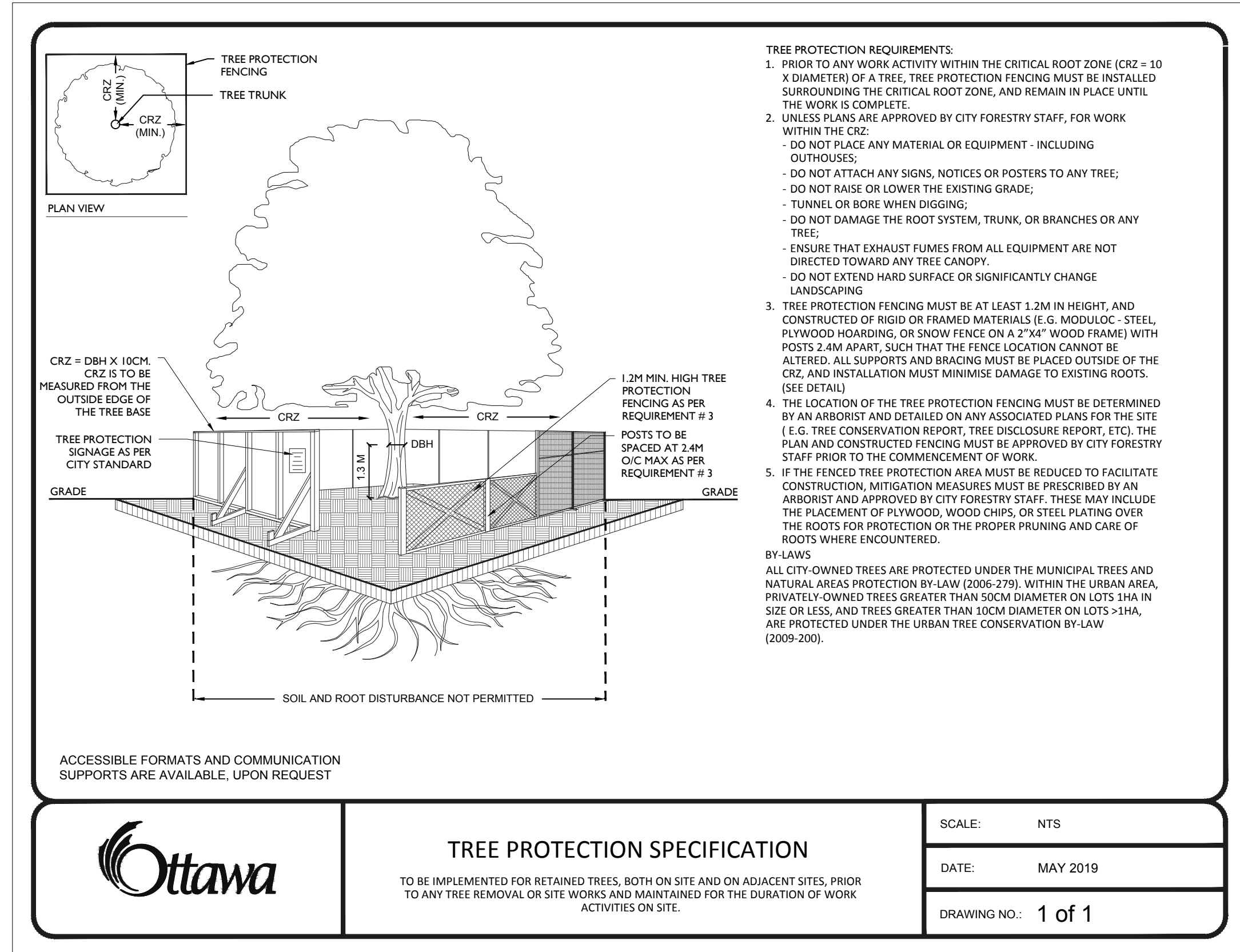

- FERTILIZE TREES AFTER PLANTING.
- WATER THOROUGHLY SUBSEQUENT TO PLANTING.
- WRAP TREE TRUNK FOR PROTECTION FROM CLIMATIC CONDITIONS.
- PROTECT TREE FROM RODENT DAMAGE.
- REMOVE TREE RING AND STAKES AFTER ONE YEAR.

FOR TREES UP TO 150mm: PROVIDE 3 GUY WIRES OF 3mm. FOR TREES OVER 150mm PROVIDE 3 GUY WIRES CONSISTING EACH OF 3 WIRES OF 4mm TWISTED TOGETHER.

4 TREE TRANSPLANTING DETAIL

Scale: NTS

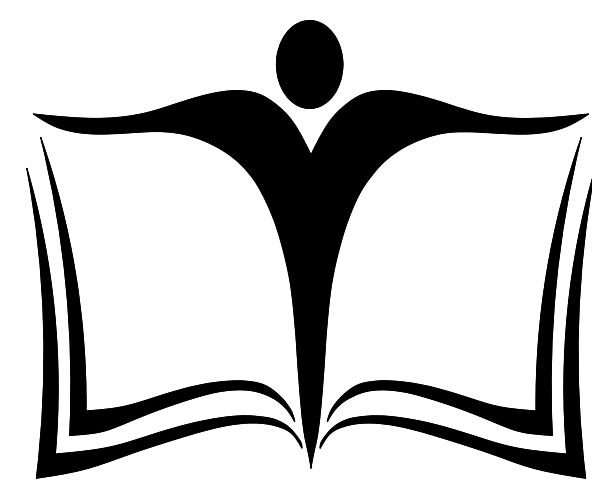

OTTAWA - CARLETON
DISTRICT SCHOOL BOARD

GENERAL NOTES

- All general site information and conditions compiled from existing plans, surveys and consultant's field notes. Report all discrepancies prior to any work. No responsibility is born by the Consultant for unknown subsurface conditions.
- The location of the utilities is approximate only, and the exact location should be determined by consulting the municipal authorities and utility companies concerned. The Contractor shall prove the location of utilities and shall be responsible for adequate protection from damage.
- All dimensions shown are to be verified on site prior to any construction. No deviations are to be made from the layouts as shown on this plan without prior consultation with the Landscape Architect and Owner.
- Obtain approval of Landscape Architect for granular base and layout of all pavement areas prior to construction.
- Stake planting locations and receive approval of Landscape Architect, prior to excavation of any planting pits. No substitutions of plant material shall be made without prior approval of the Landscape Architect.
- Where clay is encountered proper drainage must be ensured in tree/shrub pits, prior to planting. Have method approved by Landscape Architect.
- All sodded areas to receive a minimum of 150mm of topsoil over graded sub-base. If sod with mesh is used, mesh to be removed completely during sodding operations. Sod shall come from an approved source and shall be laid within 24 hours of being cut in the nursery. Only nursery sod shall be used.
- Final subgrade is to be approved by the Landscape Architect prior to sod being laid.
- Maintain positive surface runoff through the entire construction period.
- Reinstate all areas and items damaged as a result of construction activities.



no.	revision	date
06		
05		
04		
03	Reissued for SPC	2025/04/14
02	Issued for Permit	2025/02/04
01	Issued for Coordination	2025/01/30

N45 ARCHITECTURE INC.

71 Bank Street, 7th Floor - Ottawa, Ontario, K1P 5N2
tel. 613.224.0095 fax 613.224.9811

Ruhland & Associates Ltd
landscape architecture • urban design • site planning
Ph: 613-224-4244 Fx: 613-224-4331 info@rala.ca www.rala.ca

East Urban Centre Elementary School

700 Spring Valley Dr.
Ottawa, K1W 0H2.

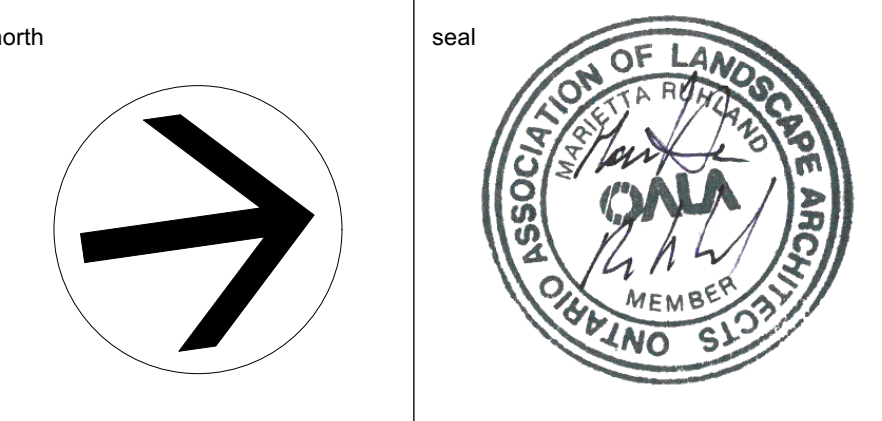

LANDSCAPE SOIL VOLUMES / DETAILS

scale	As Shown	drawn by	D.A.
date	2025-02-25	checked by	M.R.
project number	N45 24-828	drawing number	L-02
RA	24-1743	revision	
CONTRACTOR TO VERIFY ALL DIMENSIONS AND NOTIFY THE ARCHITECT OF ANY DISCREPANCIES BEFORE WORK COMMENCES			
DO NOT SCALE DRAWINGS			

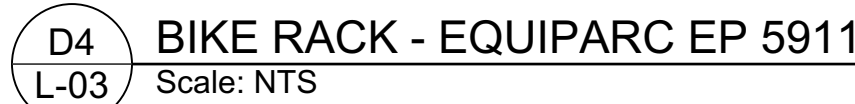

KEY PLAN

The map shows the project site (SITE) in a white rectangle with a red border. The site is located between Eastmore St to the north and Eastmore St to the south. To the west of the site is a residential area with streets like Eastmore St and Eastmore St. To the east of the site is a green area labeled 'Greenwood Park' with a small building and a parking lot.

06		
05		
04		
03	Reissued for SPC	2025/04/14
02	Issued for Permit	2025/02/04
01	Issued for Coordination	2025/01/30
no.	revision	date



71 Bank Street, 7th Floor - Ottawa, Ontario, K1P 5N2
tel. 613.224.0095 fax 613.224.9811



700 Spring Valley Dr,
Ottawa, ON, K1W 0H2.

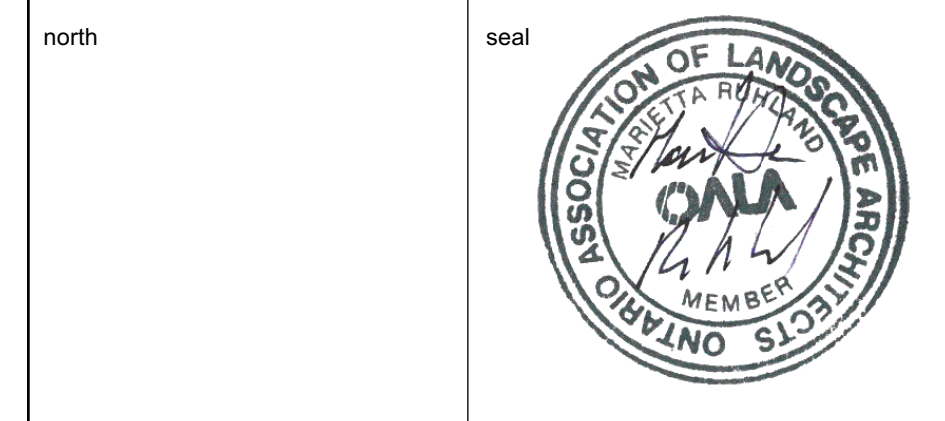

scale	As Shown	drawn by	D.A.
date	2025-02-25	checked by	M.R.
project number	N45 24-828	drawing number	L-03
RA	24-1743		
CONTRACTOR TO VERIFY ALL DIMENSIONS AND BEFORE WORK COMMENCES.			revision
DO NOT SCALE DRAWINGS			



1 All general site information and conditions compiled from existing plans, surveys and consultant's field notes. Report all discrepancies prior to any work. No responsibility is born by the Consultant for unknown subsurface conditions.

- [illegible]

N45 ARCHITECTURE INC.
71 Bank Street, 7th Floor - Ottawa, Ontario, K1P 5N2
tel. 613.224.0095 fax 613.224.9811



north	seal
-------	------

CONTRACTOR TO VERIFY ALL DIMENSIONS AND NOTIFY THE ARCHITECT OF ANY DISCREPANCIES BEFORE WORK COMMENCES.	revision
DO NOT SCALE DRAWINGS	

