

# WALGREEN ROAD

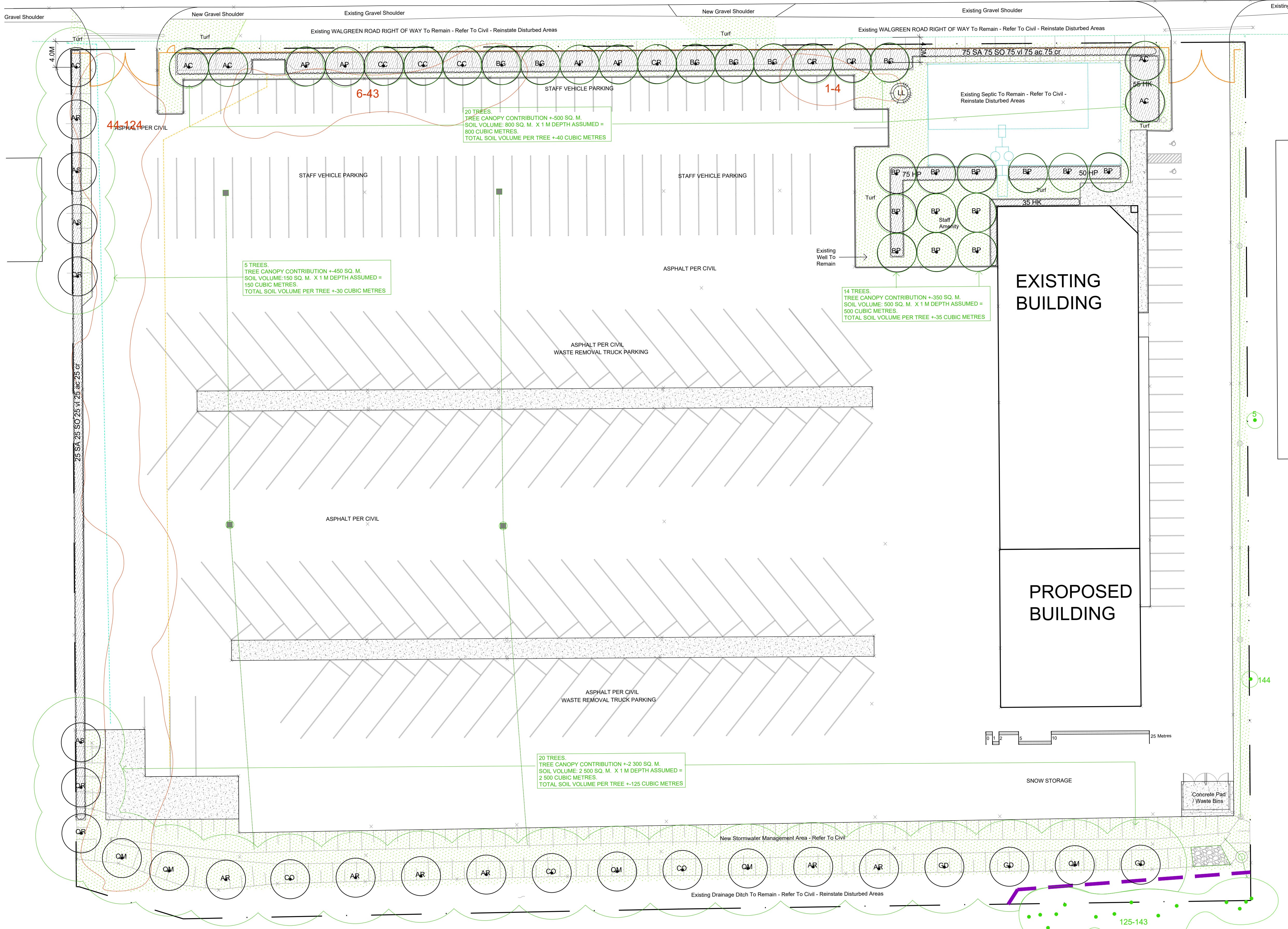

\*\*\*\*\*ADDITIONAL LANDSCAPE PLAN NOTES \*\*\*\*\*  
 LANDSCAPING ON CITY OF OTTAWA PROPERTY TO BE TO CITY OF OTTAWA DETAILS / STANDARDS. L1-L6, L17  
 TREES ON CITY OF OTTAWA PROPERTY TO CARRY A 2 YEAR WARRANTY. REFER TO SITE PLAN FOR LOCATIONS AND DIMENSIONS OF BUILDING, ROADS, PARKING, CURBS, SETBACKS, EASEMENTS, LEGAL DESCRIPTION...  
 EXISTING AND PROPOSED SITE SERVICING IS SHOWN ON THE LANDSCAPE PLAN TO PROVIDE AN AWARENESS TO REVIEWERS AND CONTRACTORS OF THEIR INTENDED LOCATION AND SEPARATION OF TREES/SERVICES/PROPOSED LANDSCAPING. DETERMINE AS BUILT LOCATIONS OF SERVICES PRIOR TO PLANTING AND ADJUST ACCORDINGLY TO RESPECT REQUIRED SETBACKS

**TREE CANOPY CALCULATION AS PER EVOLVING CITY OF OTTAWA REQUIREMENTS:**

**TOTAL SITE AREA:** 23 700 SQ. M.

**CALCULATIONS FOR TREE CANOPY**  
 Proposed Trees (Areas of Polygons Excluding Overlap.)  
 60 + 350 + 450 + 450 + 2 300 = 3 610 SQ. M.

**CANOPY COVER AS % OF SITE**  
 W/O EXISTING CANOPY 3 610 / 23 700 = 15%

**+ ADD EXISTING VEGETATION TO REMAIN**  
 @ 1.5X 130 sq. m. = 195 sq. m.

**CANOPY COVER AS % OF SITE INCLUDING EXISTING CANOPY**  
 1 650 + 335 = 1985 3 805 / 23 700 = 16%

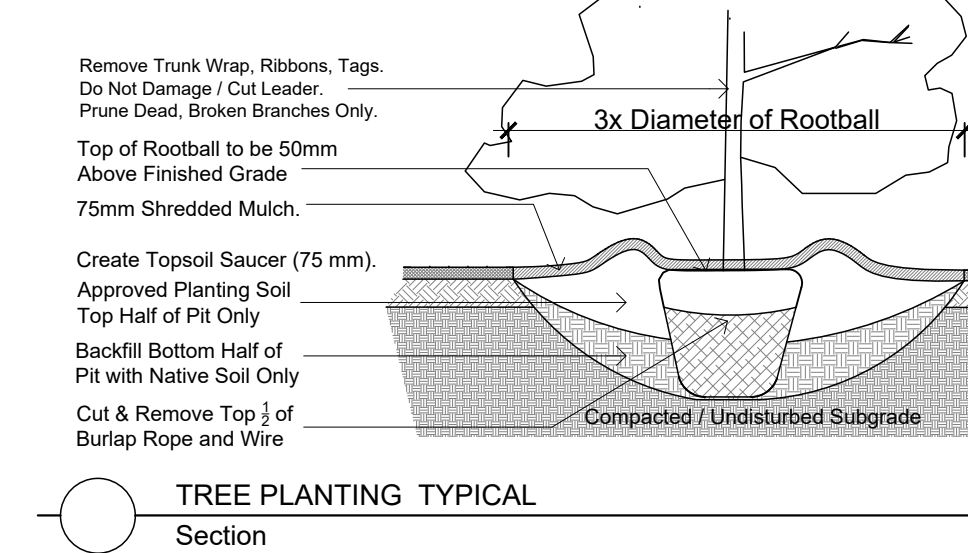
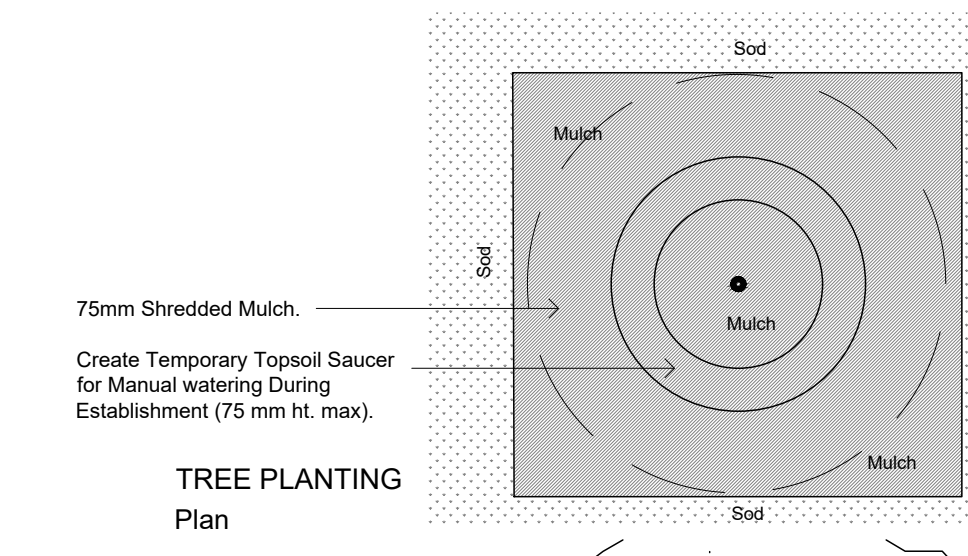
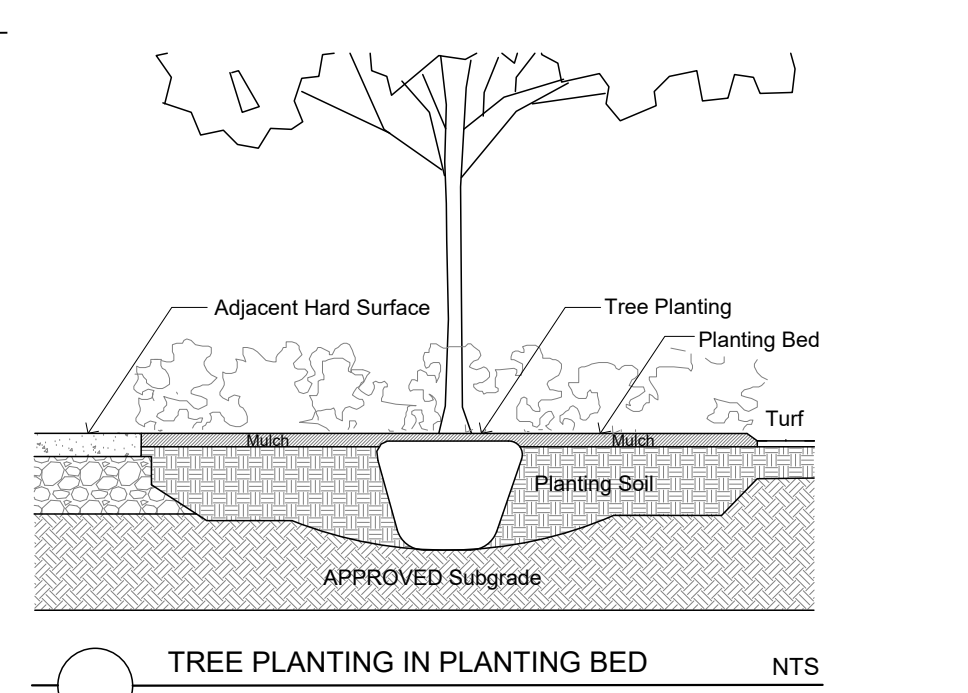
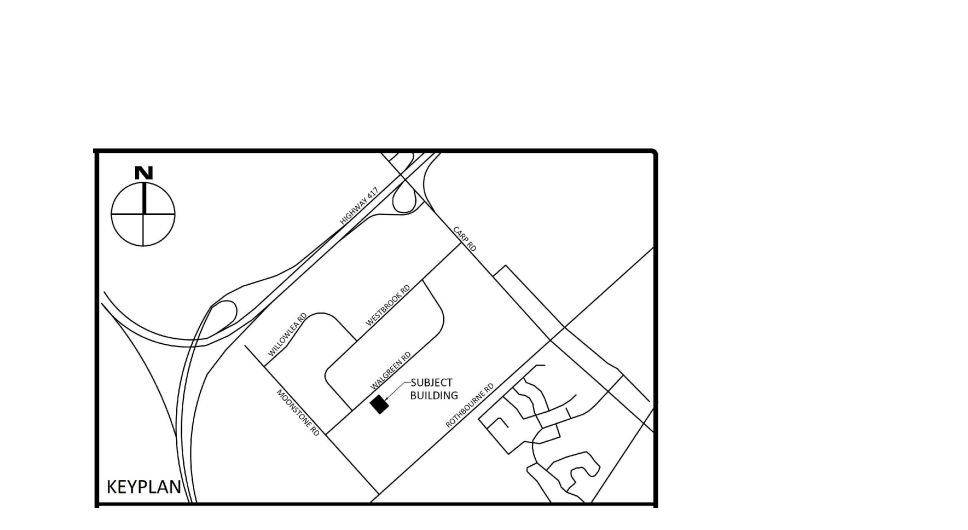

Drawing Remains the Property of / Copyright Reserved by / Do Not Use or Reproduce Without Approval of Gino J. Aiello Landscape Architect / GJA INC.  
**Use For Construction If Indicated**  
**Contractor is Responsible** for Verification of Site Locations of all Utilities. Report any Discrepancies Between Site and Drawing Immediately to GJA INC. Do NOT Proceed Until Clarified.  
 TURF AREAS TO BE SOD C/W 150MM DEPTH TOPSOIL ON APPROVED SUBGRADE | SOD TO BE #1 GRADE TURFGRASS NURSERY SOD per NSGA - Fine Fescue/Kentucky Bluegrass Sod | PLANTING MIX TO BE APPROVED BY LANDSCAPE ARCHITECT | PLANT MATERIAL TO MEET CNLA STANDARDS/BE APPROVED BY LANDSCAPE ARCHITECT PRIOR TO PLANTING ALL MATERIALS & WORK TO BE MAINTAINED UNTIL FINAL ACCEPTANCE. (MOWING TURF, WEEDING BEDS, WATERING TURF & PLANTS) & INCLUDE 1 YEAR WARRANTY FROM DATE OF FINAL ACCEPTANCE | PROVIDE WATERING OF ALL PLANT MATERIAL AS REQUIRED FOR PROPER ESTABLISHMENT, UNTIL END OF WARRANTY PERIOD | REFER TO CIVIL ENGINEER'S DRAWING FOR ELEVATIONS / GRADING |  
 The Landscape Plan is to be read in conjunction with the grading, servicing, site and survey plan | Bare root material to be planted in season only | All plant material locations to be staked on site by the landscape contractor and checked by the landscape architect prior to planting | All trees to be preserved on or directly adjacent to the site will be protected | Plant material are to be installed a minimum of: 3.0m away from any part of any hydro transformer, 3.0m corridor between a fire hydrant and the curb, a 2.5m radius beside or behind a fire hydrant, 2.0m from any servicing/utility line or structure |

- REFER TO TCR BY IFS
- Existing Tree to Remain
  - Existing Tree to Remove
  - Protection for Existing Trees
- LANDSCAPE LEGEND
- Coniferous Tree
  - Deciduous Tree
  - Shrub Planting Bed
  - Riverwash Stone On Filter Cloth
  - Turf
  - Security Fence

- BELOW GRADE SERVICES REFER TO CIVIL/CUP
- WTR U/G Water Service
  - STM U/G Storm Service
  - SAN U/G Sanitary Service
  - GAS U/G Gas Service
  - BC U/G TelCo Service
  - H U/G Hydro Service
  - OHV O/H Hydro Service

ARCHITECT  
**DEIMLING**  
 ARCHITECTURE & INTERIOR DESIGN

CIVIL ENGINEER  
**egis**

NO.	REVISION	DATE
2	CITY COMMENTS	2025 03 05
1	MUNICIPAL REVIEW	2024 12 20
0	REVIEW/COORDINATION	2024 11 00
#	Revision	Date

PROPERTY OWNER  
**MILLER WASTE SYSTEMS**  
 112 BALES DRIVE EAST EAST GWILLIMBURY, ON

**GJA INC.**  
 GINO J. AIELLO | LANDSCAPE ARCHITECT  
 GJALA.COM | 613 286 5130 | GINO@GJALA.COM  
 112 BURLINGTON ROAD UNIT # 3, ST. THOMAS, ONTARIO | N5T 2C2

**BUILDING ADDITION**  
 145 WALGREEN

**Landscape Plan**  
 Scale: 1:300

Code	Qty.	Botanical Name	Common Name	Size	Condition	NATIVE
ac	100	Amelanchier canadensis	Tree Serviceberry	90cm Ht.	Pot	YES
cr	100	Cornus racemosa	Grey Dogwood	90cm Ht.	Pot	YES
vl	100	Viburnum lentago	Nannyberry	90cm Ht.	Pot	YES
SO	100	Symphoricarpos albus	Snowberry	50cm Ht.	Pot	YES
SA	100	Spiraea alba	Meadowsweet	50cm Ht.	Pot	YES
HK	90	Hypericum kalmianum	Kalm St. John's Wort	30cm Ht.	Pot	YES
HP	125	Hypericum prolificum	Shrubby St. John's Wort	40cm Ht.	Pot	YES

CODE	QUANTITY	BOTANICAL NAME	COMMON NAME	B&B SPECIMEN	NATIVE TO CANADA	FORECASTED SPREAD as per City of Ottawa Forestry	Canopy Cover Contribution/Tree in Square Metres		
	PRIVATE	PUBLIC				DIAMETER	RADIUS		
AC	5	0	Amelanchier canadensis	Tree Serviceberry	50mm cal	YES	5.0m	2.5m	20.0 sq. m.
AR	7	0	Acer rubrum	Red Maple	60mm cal	YES	10.0m	5.0m	78.5 sq. m.
AP	4	0	Acer pensylvanicum	Striped Maple	40mm cal	YES	5.0m	2.5m	20.0 sq. m.
AS	3	0	Acer saccharum	Sugar Maple	60mm cal	YES	14.0m	7.0m	154.0 sq. m.
BP	12	0	Betula papyrifera	Paper Birch	50mm cal	YES	10.0m	5.0m	78.5 sq. m.
BG	6	0	Betula populifolia	Gray Birch	50mm cal	YES	5.0m	2.5m	20.0 sq. m.
CC	3	0	Carpinus caroliniana	Hornbeam Bluebeech	50mm cal	YES	5.0m	2.5m	20.0 sq. m.
CO	3	0	Celtis occidentalis	Common Hackberry	60mm cal	YES	14.0m	7.0m	154.0 sq. m.
CR	3	0	Cornus racemosa	Grey Dogwood	50mm cal	YES	5.0m	2.5m	20.0 sq. m.
GD	3	0	Gymnocladus dioicus	Kentucky Coffee Tree	50mm cal	YES	14.0m	7.0m	154.0 sq. m.
QM	5	0	Quercus macrocarpa	Bur Oak	60mm cal	YES	14.0m	7.0m	154.0 sq. m.
QR	3	0	Quercus rubra	Red Oak	60mm cal	YES	14.0m	7.0m	154.0 sq. m.
TOTALS	52	0							
LL	1	0	Larix laricina	Eastern Larch / Tamarack	1.5m Ht.	YES	5.0m	2.5m	10.0 sq. m.

