

ANSI D 864mm x 559mm
Checked: JP / DJ Approved:
Designer: PE
Project Management Initials:
Last Plotted: 2024-07-30
Filename: 2024072_C106.0.DWG

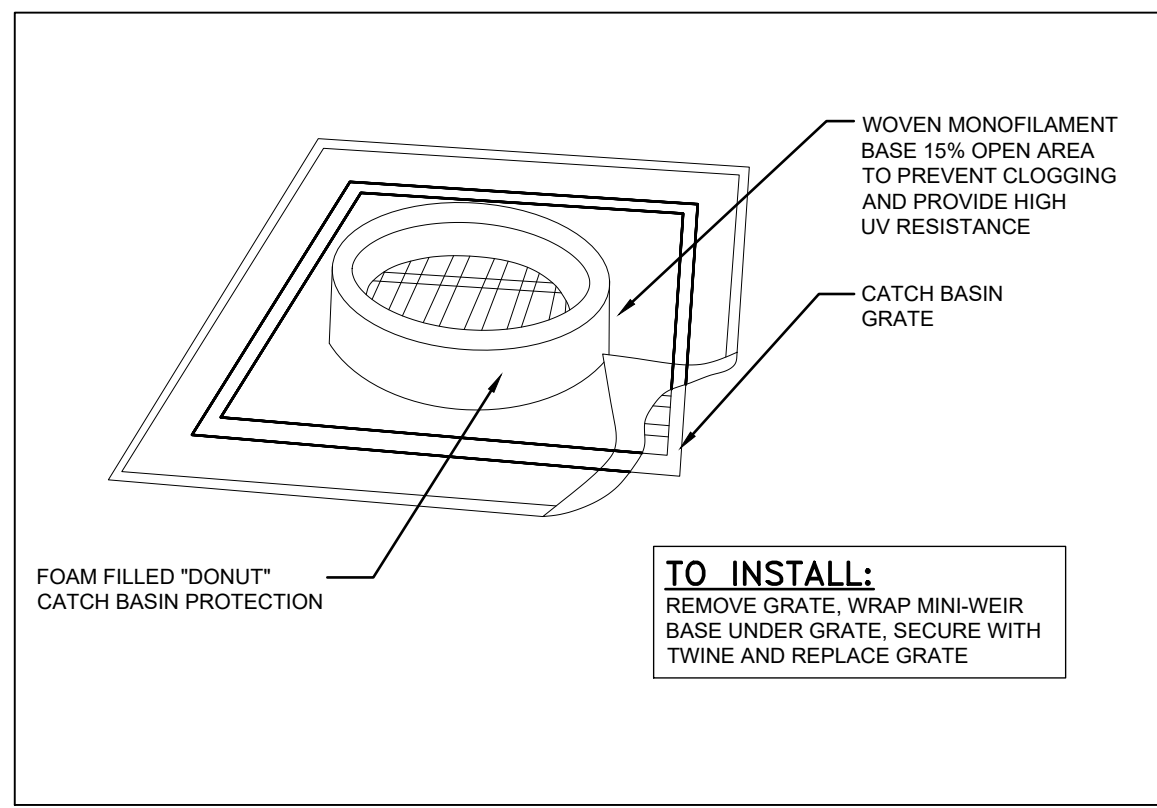

TO INSTALL:
REMOVE GRATE, WRAP MINI-WEIR BASE UNDER GRATE, SECURE WITH TWINE AND REPLACE GRATE



EROSION & SEDIMENT CONTROL NOTES:

- ANY DIRECTION GIVEN BY THE ENGINEER TO THE CONTRACTOR FOR EROSION AND SEDIMENT CONTROL AND NOT FOLLOWED BY THE CONTRACTOR IS TO BE REPORTED TO THE CITY IMMEDIATELY.
- IT IS THE RESPONSIBILITY OF THE CONTRACTOR TO ENSURE THAT NO MUD, DIRT, SOIL, SILT OR ANY OTHER SUBSTANCES ARE SPILLED, DROPPED, WASHED OR TRACKED ONTO PUBLIC RIGHTS-OF-WAY, OR AREAS THAT LEAD TO CATCH BASINS CONNECTED TO PUBLIC SYSTEMS. THE CONTRACTOR IS TO CLEAN ANY SUCH MATERIAL IMMEDIATELY. STREETS ARE TO BE SWEEPED WITH A VACUUM STREET SWEEPER AFTER WORK STOPPAGE EACH DAY.
- THE ENTRANCE SHOULD BE MAINTAINED FOR THE DURATION OF CONSTRUCTION, IN A CONDITION THAT WILL PREVENT TRACKING OF SEDIMENT ONTO PUBLIC SYSTEMS. THIS MAY REQUIRE PERIODIC TOP DRESSING WITH ADDITIONAL MATERIAL AS CONDITIONS DEMAND. THE PAD MAY BE REMOVED ONCE PERMANENT PAVEMENTS ARE IN PLACE AT THE SITE. A WHEEL WASH MAY BE REQUIRED IF THE TEMPORARY GRAVEL PAD IS NOT WORKING.
- PRIOR TO CONSTRUCTION, CLEARLY FLAG OR FENCE AREAS OF NO DISTURBANCE AS WELL AS ANY DESIGNATED TREES AND SHRUBS THAT ARE TO BE PRESERVED. MARKINGS SHOULD REMAIN IN PLACE THROUGHOUT CONSTRUCTION.
- STRIP AND GRUB ONLY THOSE AREAS NECESSARY FOR THE CURRENT CONSTRUCTION. STAGE CONSTRUCTION OPERATIONS TO LIMIT DISTURBANCE AND DO NOT STRIP ANY AREA UNTIL REQUIRED.
- ASPHALT SILT FENCING IS TO BE INSTALLED AROUND ALL STOCK PILES, OR PILES ARE TO BE OTHERWISE COVERED TO LIMIT EROSION AND SEDIMENT GENERATION.
- ROUTINE ON SITE COORDINATION AND MAINTENANCE OF THE SYSTEM COMPONENTS WILL BE THE RESPONSIBILITY OF THE CONTRACTOR. THE CONTRACTOR SHALL RETAIN A QUALIFIED PROFESSIONAL RESPONSIBLE FOR INSPECTING AND MONITORING THE ESC FACILITY PER BYLAW OR BY OPSD. THE CONTRACTOR SHALL SUPPLY A PHONE NUMBER WHERE THE CONTACT PERSON CAN BE REACHED 24 HOURS/DAY. AT A MINIMUM, INSPECT WEEKLY TO ENSURE PROPER FUNCTION. PROVIDE INSPECTION REPORTS TO THE ENGINEER FOR REVIEW.
- FOLLOWING EACH SIGNIFICANT STORM EVENT, THE DESIGNATED SITE PERSON SHOULD OBSERVE THE SETTLEMENT PONDS AND STORM DRAIN TO CONFIRM THAT TURBID WATERS FROM SOURCES ASSOCIATED WITH CONSTRUCTION ARE NOT ENTERING THE STORM DRAINAGE SYSTEM. TAKE IMMEDIATE CORRECTIVE ACTION IF INSPECTION INDICATES A PROBLEM. RECORD INSPECTION DATES, SIGNIFICANT OBSERVATIONS AND ACTIONS TAKEN, THEN INFORM THE ENGINEER IN CHARGE AND MUNICIPALITY.

2 TYPICAL SILT CONTROL FOR CATCH BASIN / GTMH
SCALE: N.T.S.

3 TYPICAL SILT CONTROL FOR CATCH BASIN
SCALE: N.T.S.

4 TYPICAL ASPHALT SILT FENCE
SCALE: N.T.S.

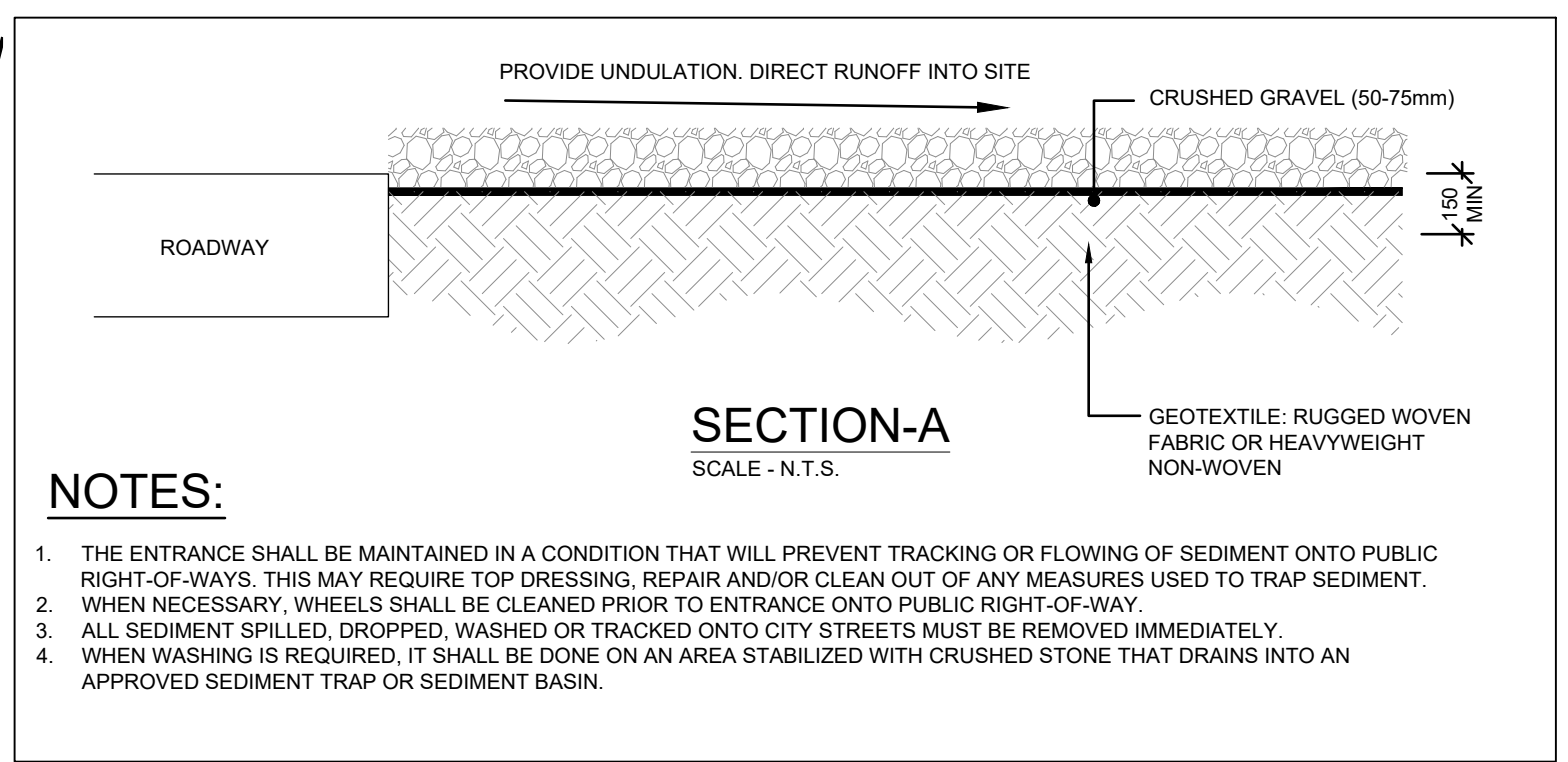
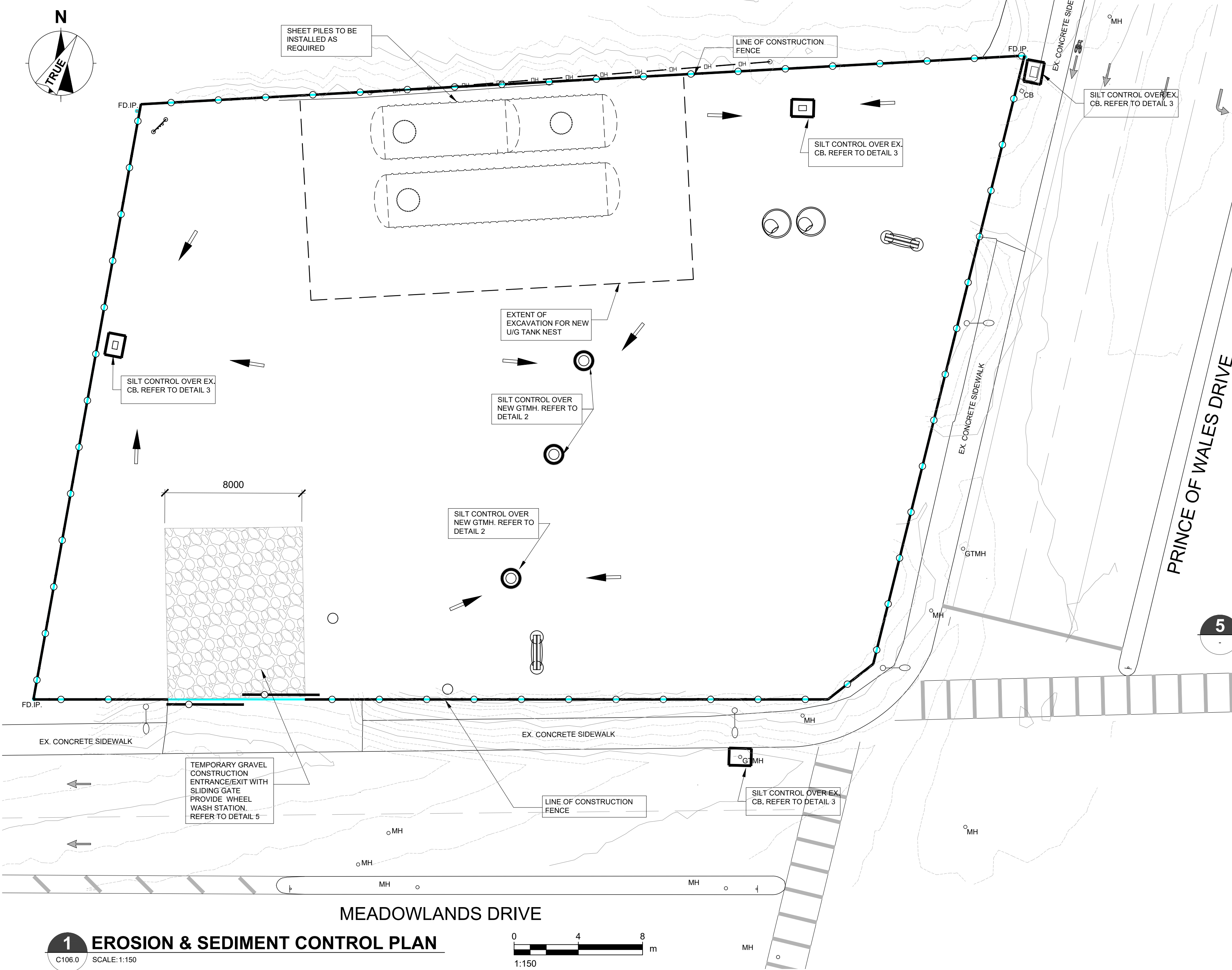

- NOTES:**
- THE ENTRANCE SHALL BE MAINTAINED IN A CONDITION THAT WILL PREVENT TRACKING OR FLOWING OF SEDIMENT ONTO PUBLIC RIGHT-OF-WAYS. THIS MAY REQUIRE TOP DRESSING, REPAIR AND/OR CLEAN OUT OF ANY MEASURES USED TO TRAP SEDIMENT.
 - WHEN NECESSARY, WHEELS SHALL BE CLEANED PRIOR TO ENTRANCE ONTO PUBLIC RIGHT-OF-WAY.
 - ALL SEDIMENT SPILLED, DROPPED, WASHED OR TRACKED ONTO CITY STREETS MUST BE REMOVED IMMEDIATELY.
 - WHEN WASHING IS REQUIRED, IT SHALL BE DONE ON AN AREA STABILIZED WITH CRUSHED STONE THAT DRAINS INTO AN APPROVED SEDIMENT TRAP OR SEDIMENT BASIN.

5 TEMPORARY GRAVEL PAD AT CONSTRUCTION ENTRANCE/EXIT
SCALE: N.T.S.

1. Exposed soil stockpiles must be covered with Plastic



By covering soil stockpiles, soil is protected from wind and water erosion. The Soil is also protected from being oversaturated making it difficult to handle at the backfill stage of the project.

6 TYPICAL SOIL STOCKPILE
SCALE: N.T.S.



PROJECT
Shell Canada Products Prince of Wales and Meadowlands (KDR)

1440 Prince of Wales Dr
Ottawa, ON K2C 1N6

CLIENT
Shell Canada
400-4th Avenue SW
Calgary, AB T2P 0J4
403.252.4554 tel
www.shell.ca
CONSULTANT

AECOM Canada Ltd
4th Floor, 3292 Production Way
Burnaby, BC V5A 4R4
604.444.6400 tel 604.294.8597 fax
www.aecom.com

CTM Design Services Ltd.
225, 340 Midpark Way SE
Calgary, AB T2X 1P1
403.640.0990 tel
www.ctmdesign.ca



REGISTRATION



ISSUE/REVISION		
NO.	DATE	DESCRIPTION
1	2024-08-01	ISSUED FOR SPC - PHASE 3

DRAWN BY ED **SCALE**
KEY PLAN

GLOBAL PROJECT ID NUMBER
CAN00650
SHEET TITLE
EROSION & SEDIMENT CONTROL PLAN

CTM DESIGN FILE NAME
2024072_C106.0
SHEET NUMBER

C106.0

This drawing has been prepared for the use of AECOM's client and may not be used, reproduced or relied upon by third parties, except as signed by their parties, except as signed by AECOM and its client, as required by law or for use by governmental reviewing agencies. AECOM accepts no responsibility, and denies any liability whatsoever, to any party that modifies this drawing without AECOM's express written consent. Do not scale this document. All measurements must be obtained from stated dimensions.