

LEGEND:
 [Hatched Box] NOT INCLUDED IN CONTRACT (N.I.C.)
 [Dotted Box] EXISTING GRAVEL

OBS: PROPERTY BOUNDARY INFORMATION DERIVED FROM SURVEY PLAN ELABORATED BY IN ENGINEERING + SURVEYING, DATED OF JANUARY 13TH, 2021.

| | | |
|--|---|------------------------|
| Address: | 1353 Coker Street, Greely, ON K4P 1A1 | |
| Legal Description | An additional building at Dymech's existing facilities. | |
| Zoning | RG3 | |
| Proposed use | Manufacturing | |
| Permitted use | Medium industrial uses | |
| Schedule 1 | - | |
| Schedule 2 | - | |
| Schedule 3 | - | |
| Other Schedules | - | |
| Exceptions | - | |
| Road Widening | - | |
| Easements | - | |
| Corner Lot triangle | - | |
| Heritage Overlay | No | |
| Street considered front (if a corner lot): | N/A | |
| Flood plane line | - | |
| Adjacent zoning | - | |
| Proximity to another special needs house | None | |
| | Required | Provided |
| Lot Area | 2000 m ² (min.) | 2674.73 m ² |
| Lot Width | 30 m | 32.93 m |
| Max. lot Coverage | 50% | 27% |
| Floor Space Index | - | - |
| Front yard setback | 15 m | 17.75m |
| Side yard setback | 3 m | West 3.55m, East 3.79m |
| Rear yard setback | 15 m | 17.54m |
| Building height (max.) | 15 m | 7m |
| Permitted projections into required yard | - | |
| Permitted projections above the height limit | - | |
| Accessory Building Requirements | - | |
| Parking | - | |
| Bicycle Parking | - | |
| Off Street Parking requirements | - | |
| Visitors parking | - | |
| Loading Dock | - | |
| Landscape Area | - | |
| Outdoor Storage | - | |

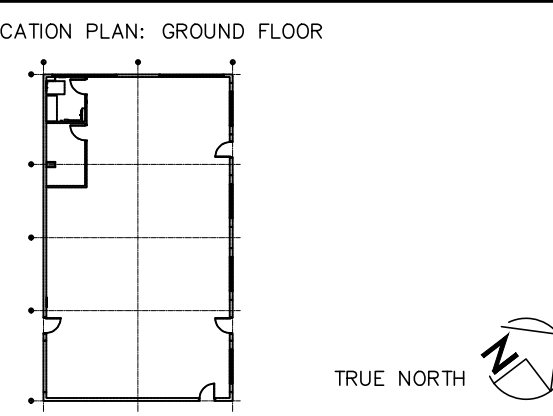

CONTRACTOR SHALL CHECK AND VERIFY ALL DIMENSIONS AND REPORT ANY OMISSIONS OR DISCREPANCIES TO THE ARCHITECT BEFORE PROCEEDING WITH THE WORK.
 DO NOT SCALE DRAWINGS.

REVISIONS

| NO. | DESCRIPTION | DATE |
|-----|--|------------|
| 1 | Issued for Site Plan approval | 2022-03-04 |
| 2 | Issued for Permit | 2022-07-04 |
| 3 | City Response - R01 | 2022-08-09 |
| 4 | City Response - R02 | 2022-09-07 |
| 5 | City Response - R03 | 2022-11-29 |
| 6 | City Response - Site Plan Approval - R04 | 2023-02-10 |

PROFESSIONAL ASSOCIATION OF ARCHITECTS OF ONTARIO
 ANDREA R. BUCHSBAUM
 LICENSE 7996

NOT BE USED FOR CONSTRUCTION PURPOSES UNTIL SIGNED BY THE ARCHITECT.

PROJECT NORTH

DATE: 2022-09-07
 DRAWN: SV
 CHECKED: AB
 DATE PRINTED: 2022-09-07

DYMECH WAREHOUSE ADDITION

ADDRESS: 1353 COKER STREET, GREELY, ON, K4P 1A1
 DRAWING TITLE

NEW SITE PLAN + NOTES

| | |
|--------------------|----------------------|
| SCALE: AS SHOWN | DRAWING NO. 1: A-010 |
| PROJECT NO: 059-20 | |