

2 TREE PROTECTION DETAIL
1:50

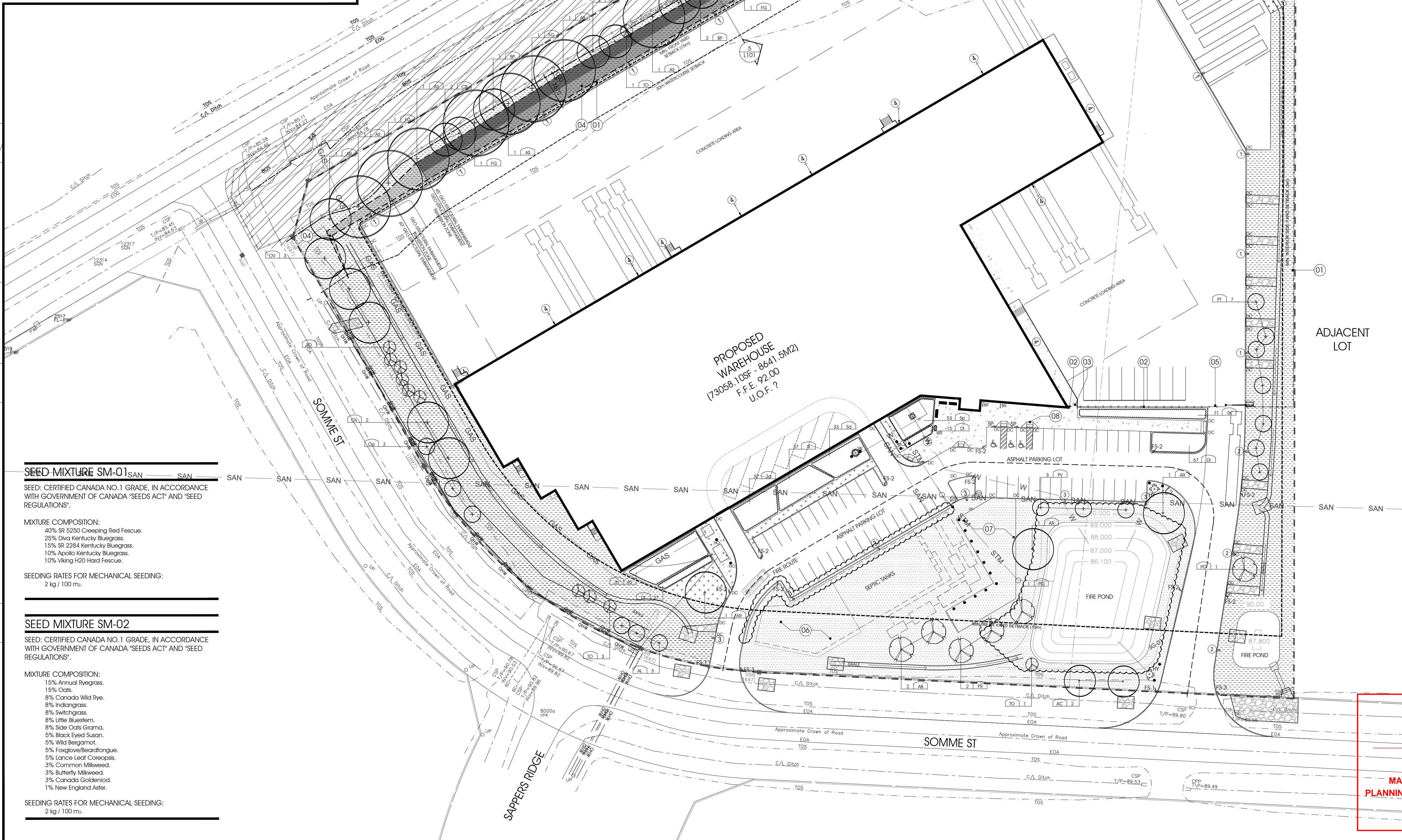

EXISTING LINE OF LOT 26 PART 1 CONCESSION 6 PLAN 5R-9712

PROPOSED WAREHOUSE
(73058, 10SF, 8641.5M²)
F.F.E. 92.00
U.O.F. ?

SEED MIXTURE SM-01

SEED: CERTIFIED CANADA NO. 1 GRADE, IN ACCORDANCE WITH GOVERNMENT OF CANADA 'SEEDS ACT' AND 'SEED REGULATIONS'.

MIXTURE COMPOSITION:
40% SR 5250 Creeping Red Fescue,
25% Diva Kentucky Bluegrass,
15% SR 2284 Kentucky Bluegrass,
10% Apollo Kentucky Bluegrass,
10% Viking H20 Hard Fescue.

SEEDING RATES FOR MECHANICAL SEEDING:
2 kg / 100 m².

SEED MIXTURE SM-02

SEED: CERTIFIED CANADA NO. 1 GRADE, IN ACCORDANCE WITH GOVERNMENT OF CANADA 'SEEDS ACT' AND 'SEED REGULATIONS'.

MIXTURE COMPOSITION:
15% Annual Ryegrass,
15% Oats,
8% Canada Wild Rye,
8% Indiangrass,
8% Switchgrass,
8% Little Bluestem,
8% Side Oats Grama,
5% Black Eyed Susan,
5% Wild Bergamot,
5% Foxglove/Beardtongue,
5% Lance Leaf Coreopsis,
3% Common Milkweed,
3% Butterfly Milkweed,
3% Canada Goldenrod,
1% New England Aster.

SEEDING RATES FOR MECHANICAL SEEDING:
2 kg / 100 m².

DRAWING LEGEND, L100

- PROPERTY LINE
- SETBACK LINES
- FIRE ROUTE
- [Hatched Box] PROPOSED BUILDING FOOTPRINT
- [Dotted Box] NEW CONCRETE SIDEWALK
- [Dotted Box] SOD, PROVIDE 150mm TOPSOIL
- [Dotted Box] SEED MIX (SM-01) PROVIDE 150mm TOPSOIL
- [Dotted Box] SEED MIX (SM-02) PROVIDE 150mm TOPSOIL
- [Dotted Box] GRAVEL MAINTENANCE STRIP, SEE DETAIL ON L101
- [Hatched Box] GEO-STRUCTURAL EMBANKMENT LOWER PLANTING ZONE (45° SECTION)
- [Hatched Box] GEO-STRUCTURAL EMBANKMENT UPPER PLANTING ZONE (45° SECTION)
- [Hatched Box] VEGETATION CONSERVATION ZONE
- BOS --- BOTTOM OF SWALE
- TOS --- TOP OF SWALE
- NEW FENCING
- [Dashed Box] NEW GUARD RAIL
- [Dashed Box] TREE PROTECTION FENCING AND SEDIMENT CONTROL BARRIER, SEE DETAIL 2/1100
- [Symbol] BIKE RACK, SEE L103
- [Symbol] BENCH, SEE L103
- [Symbol] WASTE RECEPTACLE, SEE L103
- [Symbol] BARRIER FREE ACCESSIBLE PARKING MARKING
- CONCRETE CURB
- DEPRESSED CONCRETE CURB
- [Symbol] BUILDING ENTRANCES & EXITS
- [Symbol] TYPE OF TREE, REFER TO PLANTING SCHEDULE
- [Symbol] QUANTITY, REFER TO PLANTING SCHEDULE
- [Symbol] NEW CONIFEROUS TREE, REFER TO PLANTING SCHEDULE
- [Symbol] NEW DECIDUOUS TREE, REFER TO PLANTING SCHEDULE
- [Symbol] FIRE HYDRANT
- [Symbol] ELECTRICAL POLE LIGHTING

TREE PROTECTION DETAIL NOTES

- 01 FINISHED GRADE.
- 02 THIN AND CLEAN CROWN TO APPROVAL BY CONSULTANT.
- 03 DRIP LINE OF EXISTING TREE.
- 04 35x35mm T-BAR STAKES AT 1500mm O/C MAX.
- 05 1200mm HIGH HEAVY DUTY ORANGE PLASTIC MESH FENCE SECURED WITH TWIST TIES. FENCED AREA TO BE CLEAR OF BUILDING MATERIALS, WASTE AND EXCESS SOIL. NO DIGGING, TRENCHING OR OTHER SOIL DISTURBANCE ALLOWED WITHIN THE FENCED AREA. ERECT TREE PROTECTION FENCE AWAY FROM TREE TRUNK AT A DISTANCE OF 10cm PER EVERY cm of DIAMETER OF TREE TRUNK AT BREST HEIGHT, MIN. 1000mm FROM DRIFLINE OF TREE. ACCEPTABLE TO REDUCE EXTENT OF TREE PROTECTION FENCE WHEN TREE IS IN CLOSE PROXIMITY TO PROPOSED STRUCTURES. OBTAIN APPROVAL FROM CONSULTANT PROTECT ROOT SYSTEMS UNDER THE TREE DRIFLINE FROM DAMAGE, COMPACTION AND CONTAMINATION RESULTING FROM CONSTRUCTION.
- 06
- 07

DRAWING NOTES, L100

- 01 CHAIN LINK FENCE WITH BARBED WIRE, SEE 3/L102 FOR DETAIL.
- 02 OMEGA80 LOUVERED FENCING SYSTEM, SEE L102 FOR DETAIL.
- 03 OMEGA ARCHITECTURAL SIMPLE SYSTEM SINGLE SWING GATE 1220mm WIDE, SEE L102 FOR DETAIL.
- 04 VEGETATED RETAINING WALL, SEE L101 AND CIVIL DRAWINGS FOR DETAILS.
- 05 SWING DOWN GATE, SEE L102 FOR DETAIL.
- 06 SAND MANTLE, SEE CIVIL DRAWINGS.
- 07 GRANULAR BASE FOR TRUCK ACCESS, SEE CIVIL DRAWINGS.
- 08 CONCRETE CURB RAMP, SEE DETAIL 8/L101.

APPROVED
By Adam Brown at 9:46 am, Feb 07, 2023

Adam Brown
ADAM BROWN
MANAGER, DEVELOPMENT REVIEW - RURAL PLANNING, REAL ESTATE & ECONOMIC DEVELOPMENT DEPARTMENT, CITY OF OTTAWA

CLIENT LOGO: **FASTFRATE** **CBRE**

KEY PLAN:

FILE NUMBER: PROJECT NUMBER:

RECORD OF REVISIONS:

REVISION	DESCRIPTION	DATE
1	ISSUED FOR SITE PLAN APPROVAL	2021-08-13
2	ISSUED FOR SITE PLAN APPROVAL	2021-12-14
3	REVISED FOR SITE PLAN APPROVAL	2022-06-09
4	REVISED FOR SITE PLAN APPROVAL	2022-09-29

PROFESSIONAL STAMP: **ASSOCIATION OF LANDSCAPE ARCHITECTS** **ONIA** **MEMBER**

CIVITAS GROUP
ARCHITECTURE & LANDSCAPE ARCHITECTURE

CIVITAS ARCHITECTURE INC.
14 CHAMBERLAIN AVENUE, SUITE 101 OTTAWA, ON K1M 1K5
1-613-742-7482
WWW.CIVITAS-INC.CA

CONSULTANT LOGO:

PROJECT TITLE: **NEW WAREHOUSE & CROSS DOCK FACILITY**
301 SOMME STREET, OTTAWA, ON

DRAWING TITLE: **LANDSCAPE PLAN**

DRAWN BY: J. TORIJI
DATE: 2022-07-27
REVIEWED BY: S. PARENT
APPROVED BY: D. MATICHUK
PRINT DATE: 2022-07-27
ISSUED DATE: 2022-07-27

DRAWING NUMBER: **L100**
REVISION NUMBER: **4**
CLIENT PROJECT #: PROJECT #: **2001**

DO NOT SCALE THE DRAWING. USE FIGURE DIMENSIONS ONLY. THE CONTRACTOR IS RESPONSIBLE FOR VERIFYING ALL DIMENSIONS AND NOTIFYING THE ARCHITECT OF ANY DISCREPANCIES BEFORE CONSTRUCTION COMMENCES. THE DRAWING IS TO BE READ IN CONJUNCTION WITH ALL STRUCTURAL, MECHANICAL, ELECTRICAL, CIVIL AND OTHER CONSULTANT DRAWINGS. THIS DRAWING SHALL NOT BE USED FOR CONSTRUCTION PURPOSES UNLESS SIGNED BY THE ARCHITECT. COPYRIGHT RESERVED. ALL PARTS OF THIS DRAWING ARE THE EXCLUSIVE PROPERTY OF THE ARCHITECT AND SHALL NOT BE USED WITHOUT THE EXPRESSED PERMISSION FROM THE ARCHITECT.