

- GENERAL NOTES:**
- IT IS THE RESPONSIBILITY OF THE APPROPRIATE CONTRACTOR OR OFFICIAL TO REPORT ANY ERRORS, OMISSIONS OR DISCREPANCIES ON THIS PLAN WITH ACTUAL SITE CONDITIONS TO THE LANDSCAPE ARCHITECT BEFORE PROCEEDING WITH CONSTRUCTION.
  - THE CONTRACTOR IS TO NOTIFY ALL UTILITY COMPANIES AND AUTHORITIES PRIOR TO ANY EXCAVATION AND ASCERTAIN LOCATIONS OF UNDERGROUND SERVICES.
  - THE CONTRACTOR IS TO REINSTATE ALL AREAS AND ITEMS DAMAGED AS A RESULT OF CONSTRUCTION ACTIVITY.
  - THE CONTRACTOR IS TO COMPLY WITH ALL PERTINENT CODES AND BY-LAWS.
  - THE CONTRACTOR IS TO MAINTAIN A POSITIVE SURFACE RUN-OFF THROUGHOUT THE ENTIRE CONSTRUCTION PERIOD.
  - THE LANDSCAPE ARCHITECT IS NOT RESPONSIBLE FOR SUBSURFACE CONDITIONS.
  - THE CONTRACTOR IS TO IDENTIFY ALL EXISTING TREES TO REMAIN ON SITE WITH THE LANDSCAPE ARCHITECT PRIOR TO CONSTRUCTION.
  - THE CONTRACTOR IS TO STAKE THE PROPOSED LOCATION OF ALL PLANT MATERIAL IN CONJUNCTION WITH THE LANDSCAPE ARCHITECT PRIOR TO EXCAVATION.
  - MINIMUM DISTANCES FOR SELECTED DECIDUOUS TREES ARE AS FOLLOWS:
    - BUILDING FOUNDATIONS - 7.5M
    - SIDEWALKS - 1.5M
    - PUBLIC STREETS - 2.5M
    - UNDERGROUND INFRASTRUCTURE - 2.0M
  - ALL TREES WITHIN 1M OF UNDERGROUND UTILITY TRENCHES ARE TO BE EXCAVATED BY HAND.
  - REMOVE ALL PROTECTIVE WRAPPING FROM TREE TRUNKS AFTER INSTALLATION.
  - STAKING OF TREES SHALL ONLY BE PERFORMED IF NECESSARY.
  - ENSURE THAT MULCH IS PULLED BACK A MINIMUM DISTANCE OF 75MM FROM BASE OF TREE TRUNK.

**EXISTING TREE LIST**

KEY	QTY	BOTANICAL NAME	COMMON NAME	SIZE	CONDITION	REMARKS	OWNERSHIP
<b>DECIDUOUS TREES</b>							
HL	1	Gleditsia triacanthos	Honey Locust	400mm dia.		To Be Removed	2040 Arrowsmith Dr.
JTL	2	Syringa reticulata	Japanese Tree Lilac	200mm dia.		To Be Removed	2040 Arrowsmith Dr.
MS	3	Malus sp.	Crabapple	250mm dia.		To Be Removed	2040 Arrowsmith Dr.
PD	1	Prunus domestica	Plum Tree	175mm dia.		To Be Removed	2040 Arrowsmith Dr.
<b>CONIFEROUS TREES</b>							
CO	1	Picea pungens	Colorado Spruce	350mm dia.	Good	To Be Removed	2040 Arrowsmith Dr.
CS	5	Picea pungens	Colorado Spruce	200-400mm dia.	Good	To Be Removed	2040 Arrowsmith Dr.
PP	13	Picea pungens	Colorado Spruce	200-400mm dia.	Good	To Remain	2000 Jasmine Cr.

**PROPOSED PLANT LIST**

KEY	QTY	BOTANICAL NAME	COMMON NAME	SIZE	CONDITION	NOTES
<b>DECIDUOUS TREES</b>						
AC	3	Amelanchier canadensis	Canadian Serviceberry	60mm dia.	B&B	
AF	1	Acer freemanii	Freeman's Maple	60mm dia.	B&B	
AS	3	Acer saccharum	Sugar Maple	60mm dia.	B&B	
CO	2	Celtis occidentalis	Hackberry	60mm dia.	B&B	
GB	2	Ginkgo biloba	Malden Tree	60mm dia.	B&B	Male
GP	1	Ginkgo biloba 'Princeton Sentry'	Princeton Sentry Ginkgo	60mm dia.	B&B	Male
GD	2	Gleditsia triacanthos var inermis 'Draves'	Streetkeeper Honeylocust	60mm dia.	B&B	
GS	2	Gleditsia triacanthos var inermis 'Shademaster'	Shademaster Honeylocust	60mm dia.	B&B	
QM	1	Quercus macrocarpa	Bur Oak	60mm dia.	B&B	
<b>SHRUBS</b>						
Bt	6	Berberis thunbergii 'Concorde'	Concorde Barberry	300mm ht.	Potted	800 mm o.c.
Ea	28	Euroytmus alatus 'Compactus'	Dwarf Burning Bush	600mm ht.	Potted	800 mm o.c.
Rr	10	Rosa rugosa	Rugosa Rose	800mm ht.	Potted	800 mm o.c.
Sa	6	Spiraea x arguta	Garland Spirea	800mm spr.	Potted	1000 mm o.c.
Sb	5	Spiraea x bumalda 'Anthony Waterer'	Anthony Waterer Spirea	600mm ht.	Potted	800 mm o.c.
Sj	27	Spiraea japonica 'Goldmound'	Goldmound Spirea	500 mm ht.	Potted	800 mm o.c.
Tm	16	Taxus x media 'Densiformis'	Dense Spreading Yew	500 mm spr.	Potted	800 mm o.c.
<b>PERENNIALS/ GRASSES</b>						
ca	16	Calamagrostis x acutiflora 'Karl Foerster'	Karl Foerster Grass	250mm pot	Potted	800 mm o.c.
hr	37	Hemerocallis 'Ruby Stella'	Ruby Stella Daylily	150mm pot	Potted	300 mm o.c.
hj	109	Hemerocallis 'Joan Senior'	Joan Senior Daylily	150mm pot	Potted	400 mm o.c.
pr	14	Perovskia atriplicifolia	Russian sage	250mm pot	Potted	600 mm o.c.
ps	44	Phalaris arundinacea 'Strawberries & Cream'	Strawberries & Cream Ribbon Grass	250mm pot	Potted	600 mm o.c.

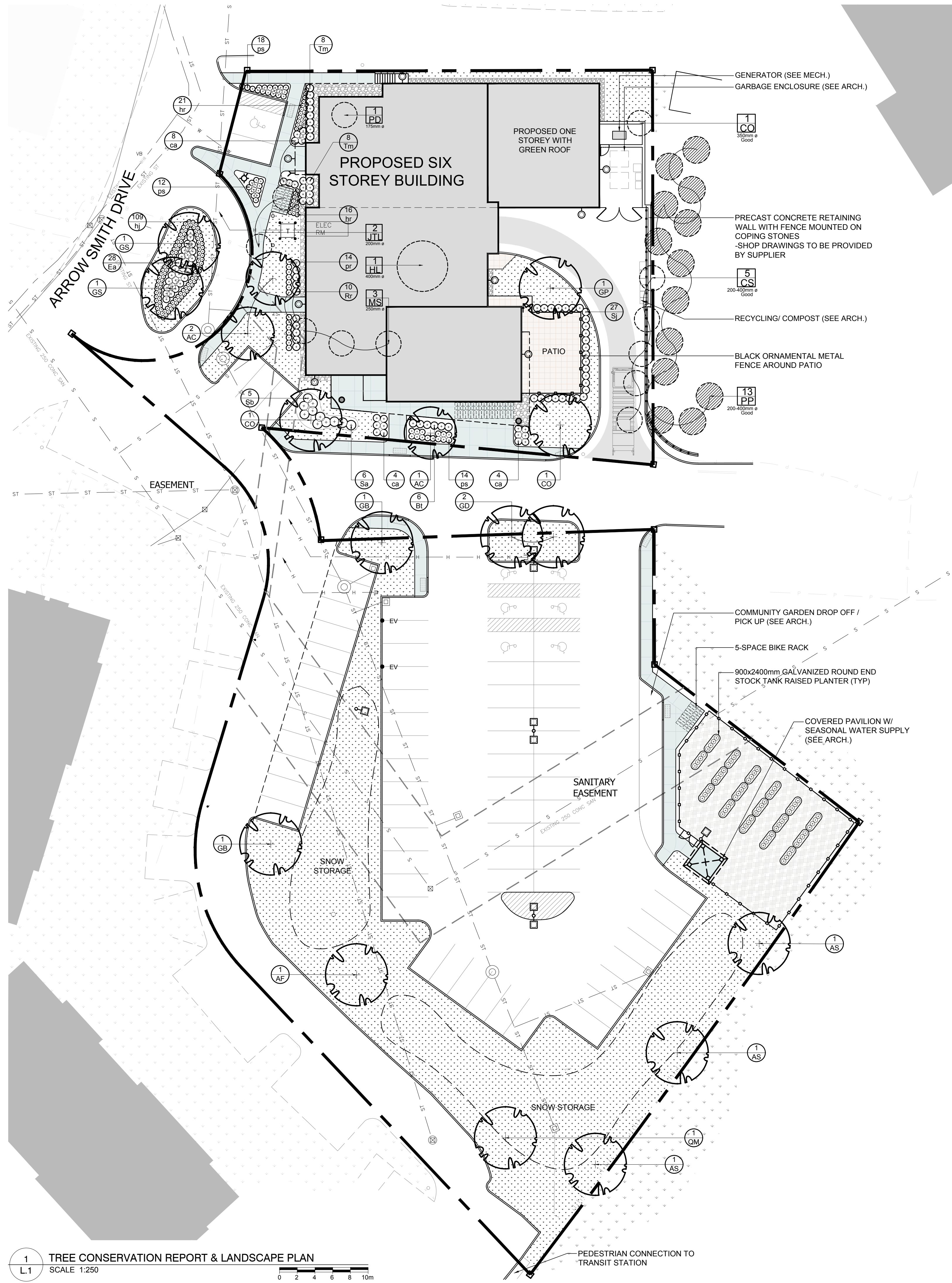

**CLIENT**  
**Vandenberg & Wildeboer**  
 A.R.C.H.I.T.E.C.T.S.  
 www.vandenberg-wildeboer.ca Telephone: 613.287.0144 Fax: 613.271.8889 info@vandenberg-wildeboer.ca  
 • THE OLD STORE HOUSE • 140 RIVERVIEW BLVD • OTTAWA, ONTARIO • K1R 1S8 •

**CONSULTANTS**  
**SURVEYORS:** FARLEY SMITH & DENNIS SURVEYING LTD.  
 275 St. Catherine Street  
 Ottawa, ON K1Z 7J6  
 P: 613.727.6226  
 E: fsurvey@fsd.ca

**MECHANICAL/ELECTRICAL ENGINEERS:** Smith + Andersen  
 1800 Carling Ave #100  
 Ottawa, ON K1Z 1G1  
 P: 613.691.0200  
 E: sara.sara@smithandandersen.com

**CIVIL ENGINEERS:** D.B. GRAY ENGINEERING INC.  
 1052 Kavan Dr.  
 Ottawa, ON K1G 4H1  
 P: 613.727.8222  
 E: dgray@dbgrayengineering.com

**LEGEND**

- PROPOSED CONCRETE WALKWAY (BY OTHERS)
- PROPOSED PATIO (BY OTHERS)
- PROPOSED MULCH
- EXISTING GRASS
- PROPOSED SOD
- PROPOSED RIVERSTONE
- PROPOSED RAISED PLANTER
- PROPOSED PERENNIALS & SHRUBS
- EXISTING TREE TO BE REMOVED
- EXISTING TREE TO REMAIN
- PROPOSED TREE
- LIGHT STANDARD (SEE ELECTRICAL)
- H HYDRO LINE (SEE ELECTRICAL)
- STM STORM SEWER (SEE CIVIL)
- SAN SANITARY SEWER (SEE CIVIL)
- W WATER LINE (SEE CIVIL)

No.	Issue	Date	DR	CK
4	ISSUED FOR SITE PLAN APPLICATION (rev 2)	12/22/2022	WF	JL
3	ISSUED FOR SITE PLAN APPLICATION	12/20/2022	WF	JL
2	ISSUED FOR DISCUSSION AND REVIEW	11/29/2022	WF	JL
1	ISSUED FOR DISCUSSION AND REVIEW	11/15/2022	WF	JL

**JAMES B. LENNOX & ASSOCIATES INC.**  
**LANDSCAPE ARCHITECTS**  
 3332 CARLING AVE. OTTAWA, ONTARIO K2H 5A8  
 Tel. (613) 722-5168 Fax. 1(866) 343-3942

**PROJECT**  
**WIGWAMEN**  
 2040 ARROWSMITH DRIVE  
 GLOUCESTER, ON K1J 8V9

**DRAWING**  
**TREE CONSERVATION REPORT & LANDSCAPE PLAN**

**STAMP**  
 SCALE: AS SHOWN  
 START DATE: NOVEMBER 2022  
 PROJECT NO.: 23VAN2312

**PROJECT NORTH**  
 DRAWING NO.: **L.1**  
 PLOT SIZE ARCH-D

**1**  
**L.1**  
**TREE CONSERVATION REPORT & LANDSCAPE PLAN**  
 SCALE: 1:250