

LEGEND

- PROPERTY LINE
- - - EXISTING DITCH
- - - EXISTING FENCE
- - - EXISTING GRADE
- EXISTING OVERLAND FLOW DIRECTION
- [Pattern] MUD-MAT; SEE DETAIL
- SF - SF - TEMPORARY SILT FENCE; (OPSD 219.110)
- - - PROPOSED CONSTRUCTION LIMITS
- [Shaded Area] PROPOSED LIMIT OF ASPHALT REMOVAL

NOTE:
A All dimensions are in millimetres unless otherwise shown.

ONTARIO PROVINCIAL STANDARD DRAWING Nov 2015 Rev 2

LIGHT-DUTY SILT FENCE BARRIER
OPSD 219.110

2	RE-ISSUED FOR SPA PER CITY COMMENTS	2023/JAN/10
1	RE-ISSUED FOR SPA PER CITY COMMENTS	2022/OCT/17
0	ISSUED FOR SITE PLAN APPLICATION	2022/MAY/17
No.	ISSUE / REVISION	YYYY/MM/DD

ELEVATION NOTE:
ELEVATIONS SHOWN ARE GEODETIC AND ARE REFERRED TO GEODETIC DATUM CGVD-1928:1978. (SEE FSD FILE No. 531-20)

IT IS THE RESPONSIBILITY OF THE SER OF THIS INFORMATION TO VERIFY THAT THE JOB BENCHMARK HAS NOT BEEN ALTERED OR DISTURBED AND THAT ITS RELATIVE ELEVATION AND DESCRIPTION AGREES WITH THE INFORMATION SHOWN ON THIS DRAWING.

LOCAL BENCHMARK:
TOP SPINDLE OF FIRE HYDRANT LOCATED ON SOUTH SIDE OF COLONNADE ROAD, APPROXIMATELY 95.0m WEST OF PRINCE OF WHALES DRIVE.
ELEVATION = 85.19m

SURVEY NOTES:
SURVEY COMPLETED BY FARLEY, SMITH, & DENIS SURVEYING LTD. (2022/MAR/09)
FILE No.: 101-21
BEARINGS ARE GRID AND ARE REFERRED TO THE WESTERLY LIMIT OF PRINCE OF WHALES DRIVE HAVING A BEARING OF N 24° 04' 30" W, AS SHOWN ON PLAN 4R-18363.

SITE PLAN NOTES:
DESIGN ELEMENTS ARE BASED ON SITE PLAN BY ARCHITECTURE 49.
DRAWING No.: A0.2 WITH REVISION DATED (2022/SEP/23)
PROJECT No.: 219-00058-00

DRAWING NOTES:
THIS DRAWING IS THE EXCLUSIVE PROPERTY OF C.F. CROZIER & ASSOCIATES INC. AND THE REPRODUCTION OF ANY PART OF IT WITHOUT PRIOR WRITTEN CONSENT OF THIS OFFICE IS STRICTLY PROHIBITED.
THE CONTRACTOR SHALL VERIFY ALL DIMENSIONS, LEVELS, AND DATUMS ON SITE AND REPORT ANY DISCREPANCIES OR OMISSIONS TO THIS OFFICE PRIOR TO CONSTRUCTION.
THIS DRAWING IS TO BE READ AND UNDERSTOOD IN CONJUNCTION WITH ALL OTHER PLANS AND DOCUMENTS APPLICABLE TO THIS PROJECT. DO NOT SCALE THIS DRAWING.
ALL EXISTING UNDERGROUND UTILITIES TO BE VERIFIED IN THE FIELD BY THE CONTRACTOR PRIOR TO CONSTRUCTION.

Project
125 COLONNADE ROAD SOUTH
CITY OF OTTAWA

Drawing
EROSION, REMOVALS AND SEDIMENT CONTROL PLAN

CROZIER CONSULTING ENGINEERS
2800 HIGH POINT DRIVE SUITE 100 MILTON, ON L9T 6P4 905-875-0026 T 905-875-4915 F WWW.CFCROZIER.CA

Drawn	M.I.M.	Design	B.P.	Project No.	2112-6218
Check	B.W.	Check	B.W.	Scale	1:500
				Dwg.	C101

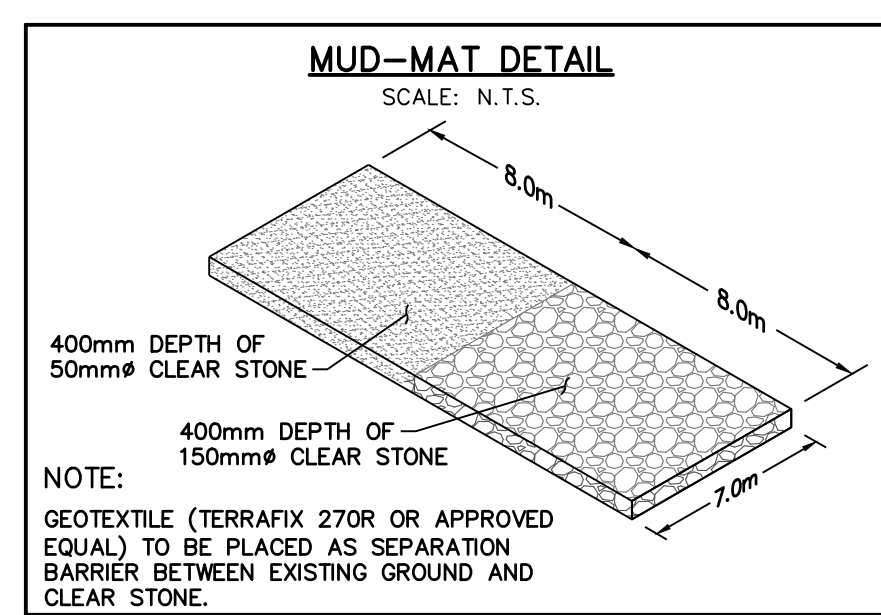

NOTE:
CONTRACTOR TO OBTAIN ALL NECESSARY ROAD OCCUPANCY PERMITS FOR PROPOSED WORKS IN MUNICIPAL ROAD ALLOWANCE

EROSION & SEDIMENT CONTROL NOTES:

- EROSION & SEDIMENT CONTROL MEASURES MUST BE INSTALLED PRIOR TO THE COMMENCEMENT OF SITE WORKS.
- EROSION & SEDIMENT CONTROLS MUST BE INSPECTED ON A REGULAR BASIS AND AFTER EVERY RAIN FALL EVENT, AND MUST BE MAINTAINED AND REPAIRED IN A TIMELY MANNER TO PREVENT SEDIMENT FROM LEAVING THE SITE.
- IT IS REQUIRED TO STABILIZE ALL AREAS THAT WILL REMAIN DISTURBED FOR MORE THAN 30 DAYS.
- MUD MAT AND SILT FENCE, AND ARE NOT TO BE REMOVED UNTIL COMPLETION OF CONSTRUCTION.

NOT FOR CONSTRUCTION

Stamp
LICENSED PROFESSIONAL ENGINEER
B. G. D. WALTON
100503737
PROVINCE OF ONTARIO

Stamp
LICENSED PROFESSIONAL ENGINEER
N. CONSTANTIN
100073636
PROVINCE OF ONTARIO



D07-12-22-0095

#18809

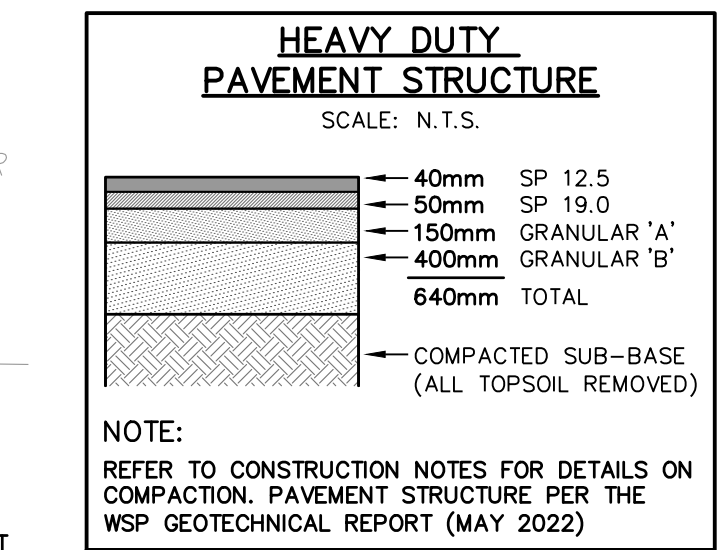
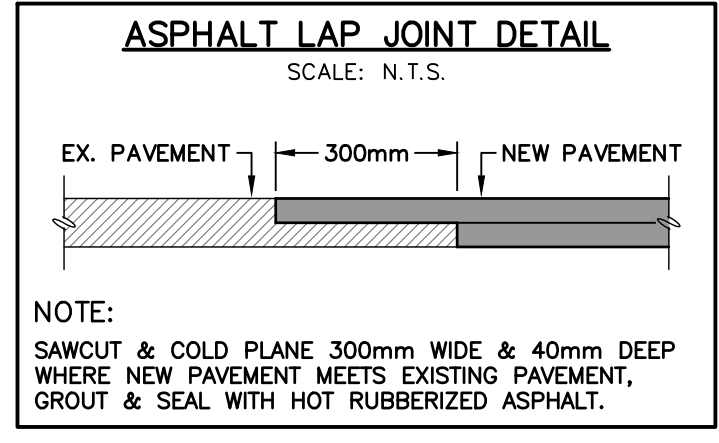

NOTE:
UNDERSIDE OF FOOTING (USF) TO BE CONFIRMED WITH PROJECT STRUCTURAL ENGINEER. STRUCTURAL ENGINEER TO NOTIFY C.F. CROZIER AND ASSOCIATES OF ANY CHANGES TO THE USF FOR EACH BUILDING.

LEGEND

- — — — — PROPERTY LINE
- - - - - EXISTING CONTOUR (0.5m)
- - - - - EXISTING CONTOUR (1.0m)
- - - - - EXISTING DITCH
- - - - - EXISTING FENCE
- - - - - EXISTING GRADE
- ×215.00 PROPOSED GRADE
- ×215.00 PROPOSED GRADE (TO MATCH EXISTING)
- 2.0% PROPOSED MINOR FLOW DIRECTION
- 2.0% PROPOSED GRASSED SWALE
- ▨▨▨▨▨▨ PROPOSED SLOPE (3:1 MAX.)
- ▢▢▢▢▢▢ PROPOSED OVERLAND FLOW DIRECTION
- ▢▢▢▢▢▢ EXISTING OVERLAND FLOW DIRECTION
- ▢▢▢▢▢▢ PROPOSED RETAINING WALL
- --- PROPOSED CONSTRUCTION LIMITS

2	RE-ISSUED FOR SPA PER CITY COMMENTS	2023/JAN/10
1	RE-ISSUED FOR SPA PER CITY COMMENTS	2022/OCT/17
0	ISSUED FOR SITE PLAN APPLICATION	2022/MAY/17

ELEVATION NOTE:
ELEVATIONS SHOWN ARE GEODETIC AND ARE REFERRED TO GEODETIC DATUM CGVD-1928:1978. (SEE FSD FILE No. 531-20)

IT IS THE RESPONSIBILITY OF THE SER OF THIS INFORMATION TO VERIFY THAT THE JOB BENCHMARK HAS NOT BEEN ALTERED OR DISTURBED AND THAT ITS RELATIVE ELEVATION AND DESCRIPTION AGREES WITH THE INFORMATION SHOWN ON THIS DRAWING.

LOCAL BENCHMARK:
TOP SPINDLE OF FIRE HYDRANT LOCATED ON SOUTH SIDE OF COLONNADE ROAD, APPROXIMATELY 95.0m WEST OF PRINCE OF WALES DRIVE.
ELEVATION = 85.19m

SURVEY NOTES:
SURVEY COMPLETED BY FARLEY, SMITH, & DENIS SURVEYING LTD. (2022/MAR/09)
FILE No.: 101-21
BEARINGS ARE GRID AND ARE REFERRED TO THE WESTERLY LIMIT OF PRINCE OF WALES DRIVE HAVING A BEARING OF N 24° 04' 30" W, AS SHOWN ON PLAN 48-1835.3.

SITE PLAN NOTES:
DESIGN ELEMENTS ARE BASED ON SITE PLAN BY ARCHITECTURE 49.
DRAWING No.: A0.2 WITH REVISION DATED (2022/SEP/23)
PROJECT No.: 219-00058-00

DRAWING NOTES:
THIS DRAWING IS THE EXCLUSIVE PROPERTY OF C.F. CROZIER & ASSOCIATES INC. AND THE REPRODUCTION OF ANY PART OF IT WITHOUT PRIOR WRITTEN CONSENT OF THIS OFFICE IS STRICTLY PROHIBITED.
THE CONTRACTOR SHALL VERIFY ALL DIMENSIONS, LEVELS, AND DATUMS ON SITE AND REPORT ANY DISCREPANCIES OR OMISSIONS TO THIS OFFICE PRIOR TO CONSTRUCTION.
THIS DRAWING IS TO BE READ AND UNDERSTOOD IN CONJUNCTION WITH ALL OTHER PLANS AND DOCUMENTS APPLICABLE TO THIS PROJECT. DO NOT SCALE THIS DRAWING.
ALL EXISTING UNDERGROUND UTILITIES TO BE VERIFIED IN THE FIELD BY THE CONTRACTOR PRIOR TO CONSTRUCTION.

Project
125 COLONNADE ROAD SOUTH
CITY OF OTTAWA

Drawing
SITE GRADING PLAN

NOT FOR CONSTRUCTION

Stamp
LICENSED PROFESSIONAL ENGINEER
B. G. D. WALTON
100503737
PROVINCE OF ONTARIO

Stamp
LICENSED PROFESSIONAL ENGINEER
N. CONSTANTIN
100073636
PROVINCE OF ONTARIO

Stamp
CROZIER CONSULTING ENGINEERS
2800 HIGH POINT DRIVE
SUITE 100
MILTON, ON L9T 6P4
905-875-0026 T
905-875-4915 F
WWW.CFCROZIER.CA

Drawn M.I.M. Design B.P. Project No. **2112-6218**
Check B.W. Check B.W. Scale 1:500 Dwg. **C102**

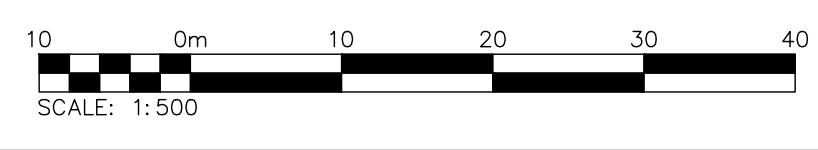

D07-12-22-0095

#18809

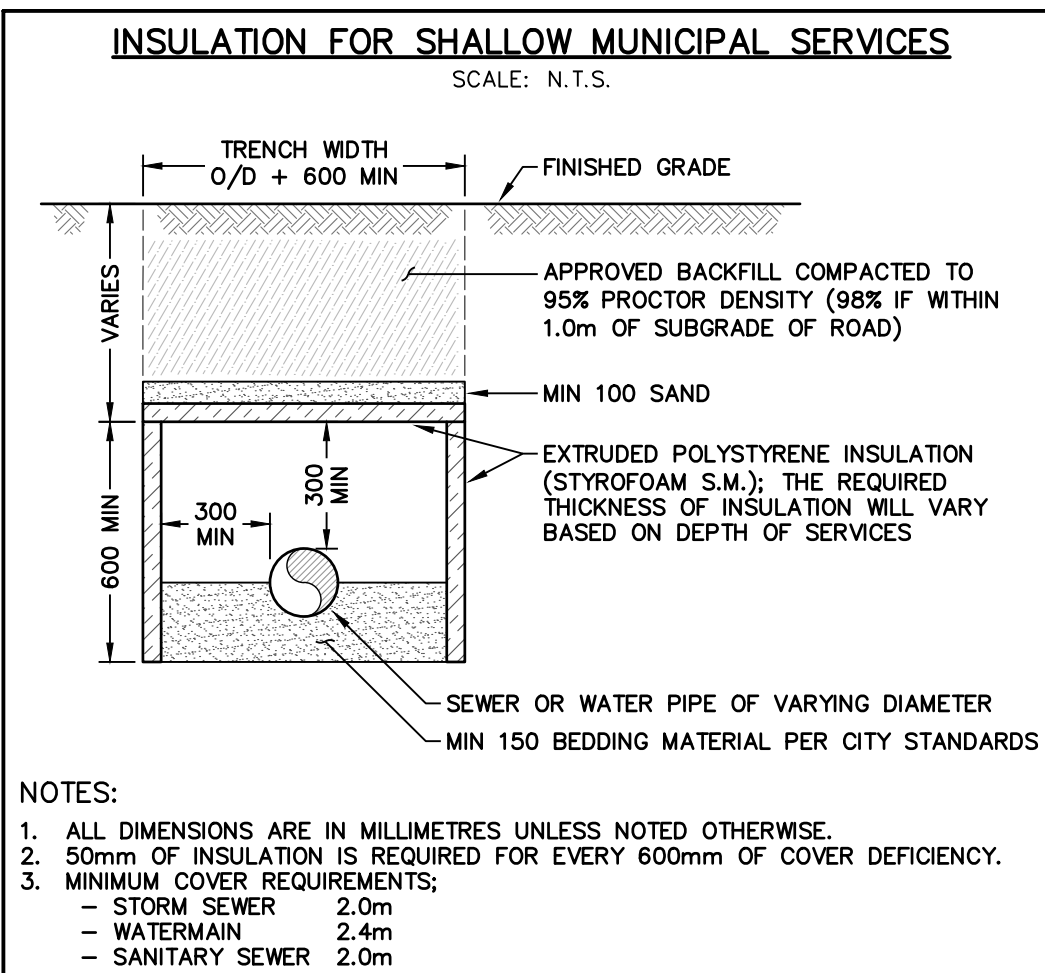
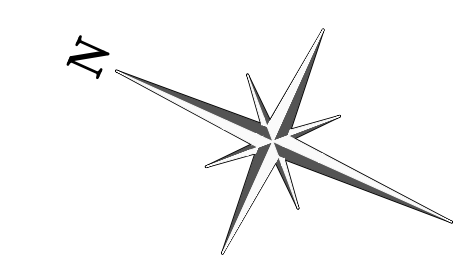
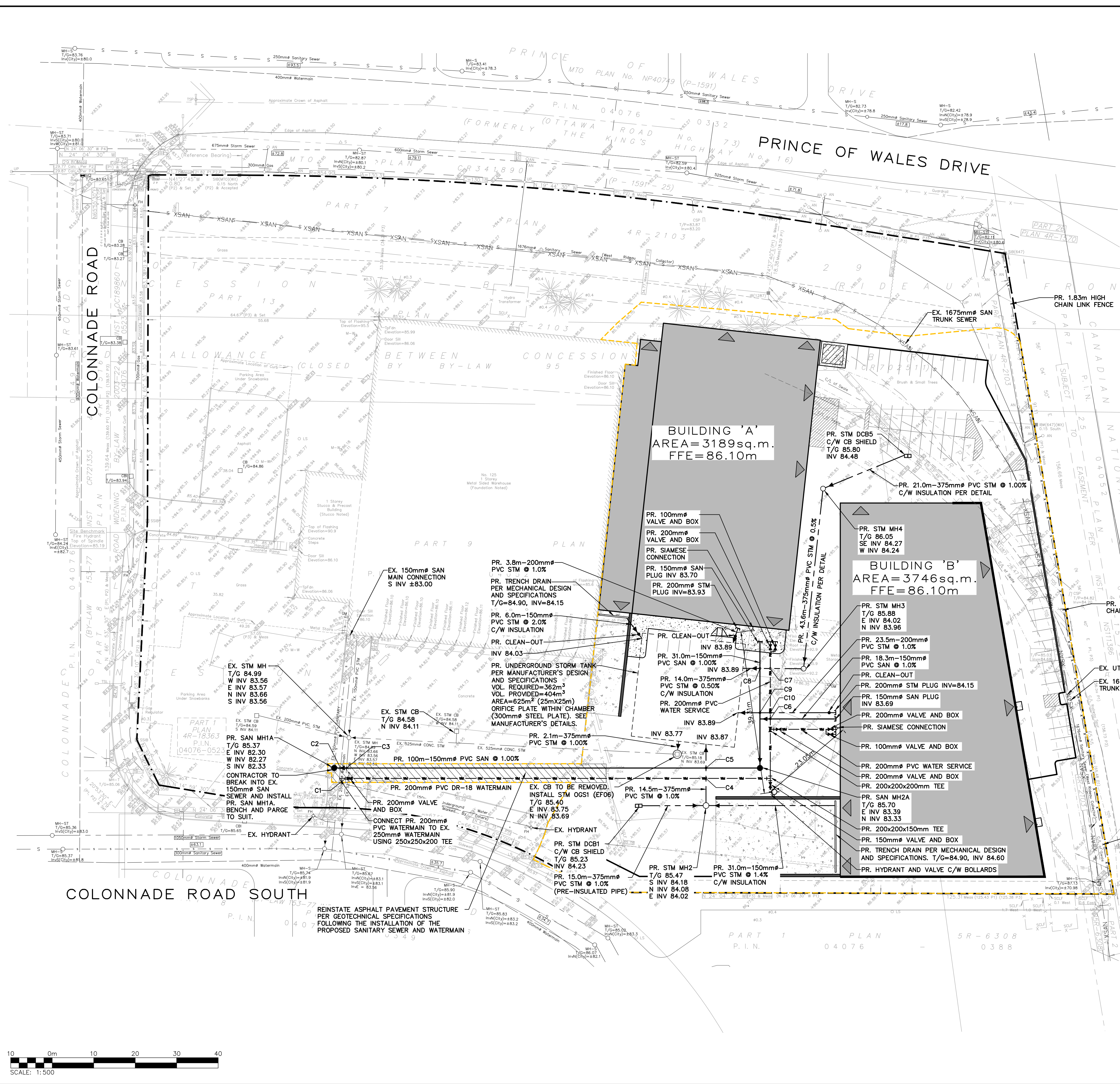

LEGEND

- PROPERTY LINE
- EXISTING WATERMAIN & GATE VALVE
- EXISTING STORM SEWER & MANHOLE
- EXISTING SINGLE / DOUBLE CATCHBASIN
- EXISTING SANITARY SEWER & MANHOLE
- PROPOSED WATERMAIN & GATE VALVE
- PROPOSED FIRE HYDRANT & GATE VALVE
- PROPOSED SIAMESE CONNECTION
- PROPOSED WATER METER
- PROPOSED BACKFLOW PREVENTOR
- PROPOSED STORM SEWER & MANHOLE
- PROPOSED SINGLE / DOUBLE CATCHBASIN
- PROPOSED SANITARY SEWER & MANHOLE
- PROPOSED CONSTRUCTION LIMITS

CROSSING TABLE

CROSSING I.D.	UPPER	LOWER
C1	EX STM INV 83.56±	W/M OBV 83.26
C2	EX W/M INV 83.09±	SAN OBV 82.50
C3	EX STM INV 83.57±	SAN OBV 82.52
C4	STM INV 83.97	W/M OBV 83.47
C5	STM INV 83.96	SAN OBV 83.35
C6	SAN INV 83.54	W/M OBV 83.04
C7	STM INV 84.16	W/M OBV 83.66
C8	STM INV 84.13	SAN OBV 83.73
C9	STM INV 83.97	SAN OBV 83.67
C10	STM INV 83.98	W/M OBV 83.04

NOTE:
 1. CONTRACTOR TO ENSURE A MINIMUM 0.50m VERTICAL SEPARATION BETWEEN THE WATERMAIN AND ALL SEWER CROSSINGS DURING CONSTRUCTION. IN CASE OF CONFLICT BETWEEN SEWERS AND WATERMAIN, CONTRACTOR TO LOWER THE WATERMAIN CROSSING THE SEWER, ENSURING THE MINIMUM 0.50m VERTICAL CLEARANCE.
 2. TRENCH DRAIN INVERTS AND ROOF DRAINS/DOWNSPOUTS PER MECHANICAL DESIGN AND SPECIFICATIONS.
 3. CONTRACTOR TO VERIFY EXISTING WATERMAIN, SANITARY AND STORM SEWER LOCATIONS AND ELEVATIONS PRIOR TO CONSTRUCTION. DAYLIGHT THESE SERVICES TO VERIFY CROSSINGS.

NOTE:
 BUILDING "B"
 TWELVE (12) ROOF DRAINS REQUIRED. ALL DRAINS TO BE ZURN MODEL ZCF121-1W-X1-2-105-10-77 OR CERTIFIED EQUIVALENT. THE DRAINS ARE TO BE INSTALLED WITH TWO NOTCHES OPEN AND AN OVERALL RELEASE RATE OF 29.8 L/s/m OF HEAD.
 * FOR ROOFTOP PONDING VOLUME CALCULATIONS AND CONTROLLED ROOFTOP RELEASE RATE CALCULATIONS SEE DWG. C104.

No.	ISSUE / REVISION	DATE
2	RE-ISSUED FOR SPA PER CITY COMMENTS	2023/JAN/10
1	RE-ISSUED FOR SPA PER CITY COMMENTS	2022/OCT/17
0	ISSUED FOR SITE PLAN APPLICATION	2022/MAY/17

ELEVATION NOTE:
 ELEVATIONS SHOWN ARE GEODETIC AND ARE REFERRED TO GEODETIC DATUM CGVD-1928:1978. (SEE FSD FILE No. 531-20)
 IT IS THE RESPONSIBILITY OF THE SER OF THIS INFORMATION TO VERIFY THAT THE JOB BENCHMARK HAS NOT BEEN ALTERED OR DISTURBED AND THAT ITS RELATIVE ELEVATION AND DESCRIPTION AGREES WITH THE INFORMATION SHOWN ON THIS DRAWING.

LOCAL BENCHMARK:
 TOP SPINDLE OF FIRE HYDRANT LOCATED ON SOUTH SIDE OF COLONNADE ROAD, APPROXIMATELY 95.0m WEST OF PRINCE OF WALES DRIVE.
 ELEVATION = 85.19m

SURVEY NOTES:
 SURVEY COMPLETED BY FARLEY, SMITH, & DENIS SURVEYING LTD. (2022/MAR/09)
 FILE No.: 101-21
 BEARINGS ARE GRID AND ARE REFERRED TO THE WESTERLY LIMIT OF PRINCE OF WALES DRIVE HAVING A BEARING OF N 24° 04' 30" W, AS SHOWN ON PLAN 48-1835.3.

SITE PLAN NOTES:
 DESIGN ELEMENTS ARE BASED ON SITE PLAN BY ARCHITECTURE 49.
 DRAWING No.: A0.2 WITH REVISION DATED (2022/SEP/23)
 PROJECT No.: 219-00058-00

DRAWING NOTES:
 THIS DRAWING IS THE EXCLUSIVE PROPERTY OF C.F. CROZIER & ASSOCIATES INC. AND THE REPRODUCTION OF ANY PART OF IT WITHOUT PRIOR WRITTEN CONSENT OF THIS OFFICE IS STRICTLY PROHIBITED.
 THE CONTRACTOR SHALL VERIFY ALL DIMENSIONS, LEVELS, AND DATUMS ON SITE AND REPORT ANY DISCREPANCIES OR OMISSIONS TO THIS OFFICE PRIOR TO CONSTRUCTION.
 THIS DRAWING IS TO BE READ AND UNDERSTOOD IN CONJUNCTION WITH ALL OTHER PLANS AND DOCUMENTS APPLICABLE TO THIS PROJECT. DO NOT SCALE THIS DRAWING.
 ALL EXISTING UNDERGROUND UTILITIES TO BE VERIFIED IN THE FIELD BY THE CONTRACTOR PRIOR TO CONSTRUCTION.

125 COLONNADE ROAD SOUTH
 CITY OF OTTAWA

SITE SERVICING PLAN

NOT FOR CONSTRUCTION

Stamp: B. G. D. WALTON 100503737 PROVINCE OF ONTARIO
 Stamp: N. CONSTANTIN 100073636 PROVINCE OF ONTARIO

CROZIER CONSULTING ENGINEERS
 2800 HIGH POINT DRIVE SUITE 100 MILTON, ON L9T 6P4 905-875-0026 T 905-875-4915 F WWW.CFCROZIER.CA

Drawn	M.I.M.	Design	B.P.	Project No.	2112-6218	
Check	B.W.	Check	B.W.	Scale	1:500	
					Dwg. No.	C103



D07-12-22-0095

SECTION A-A

SCALE: HOR: 1:50
VER: 1:50

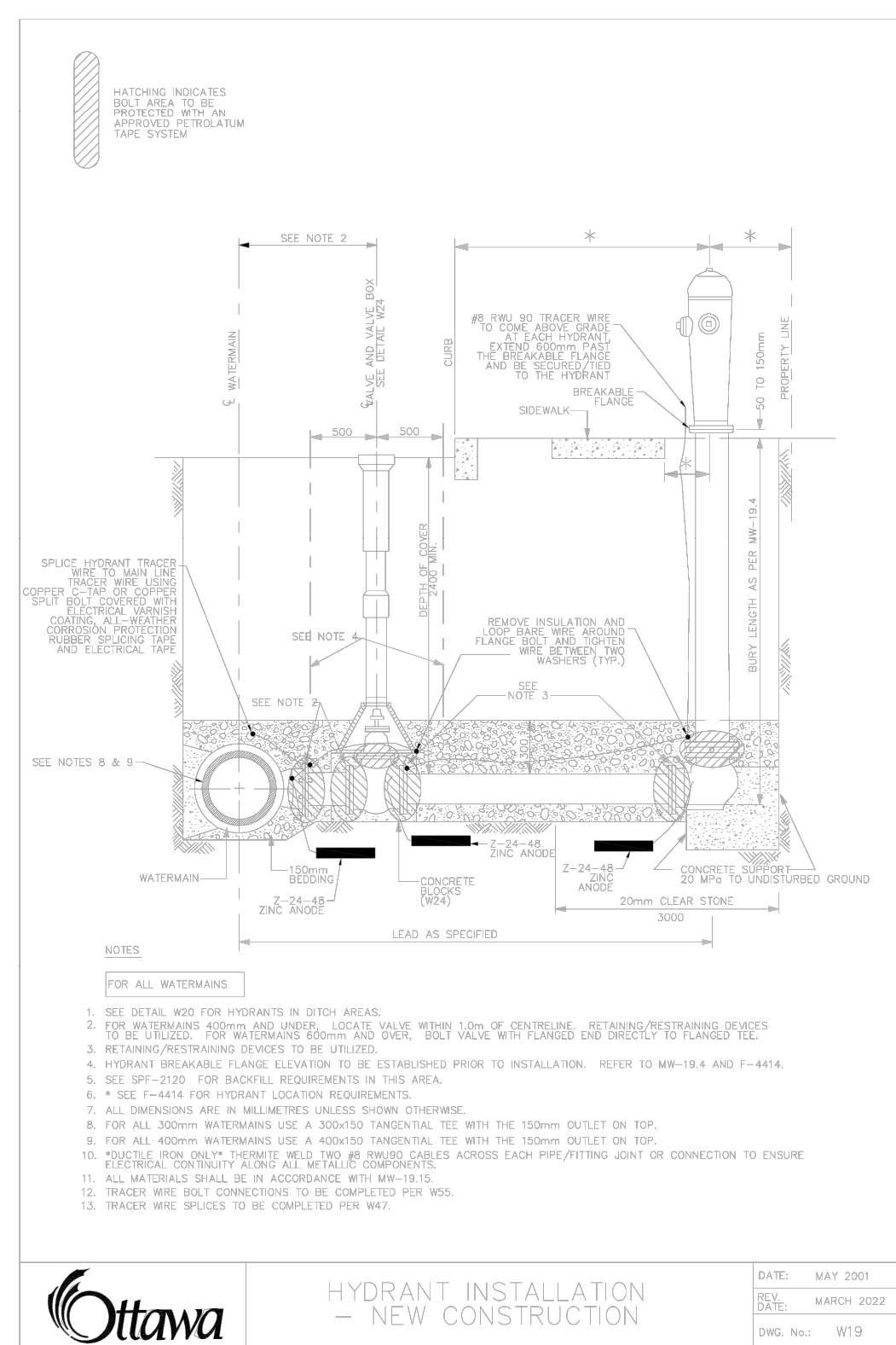
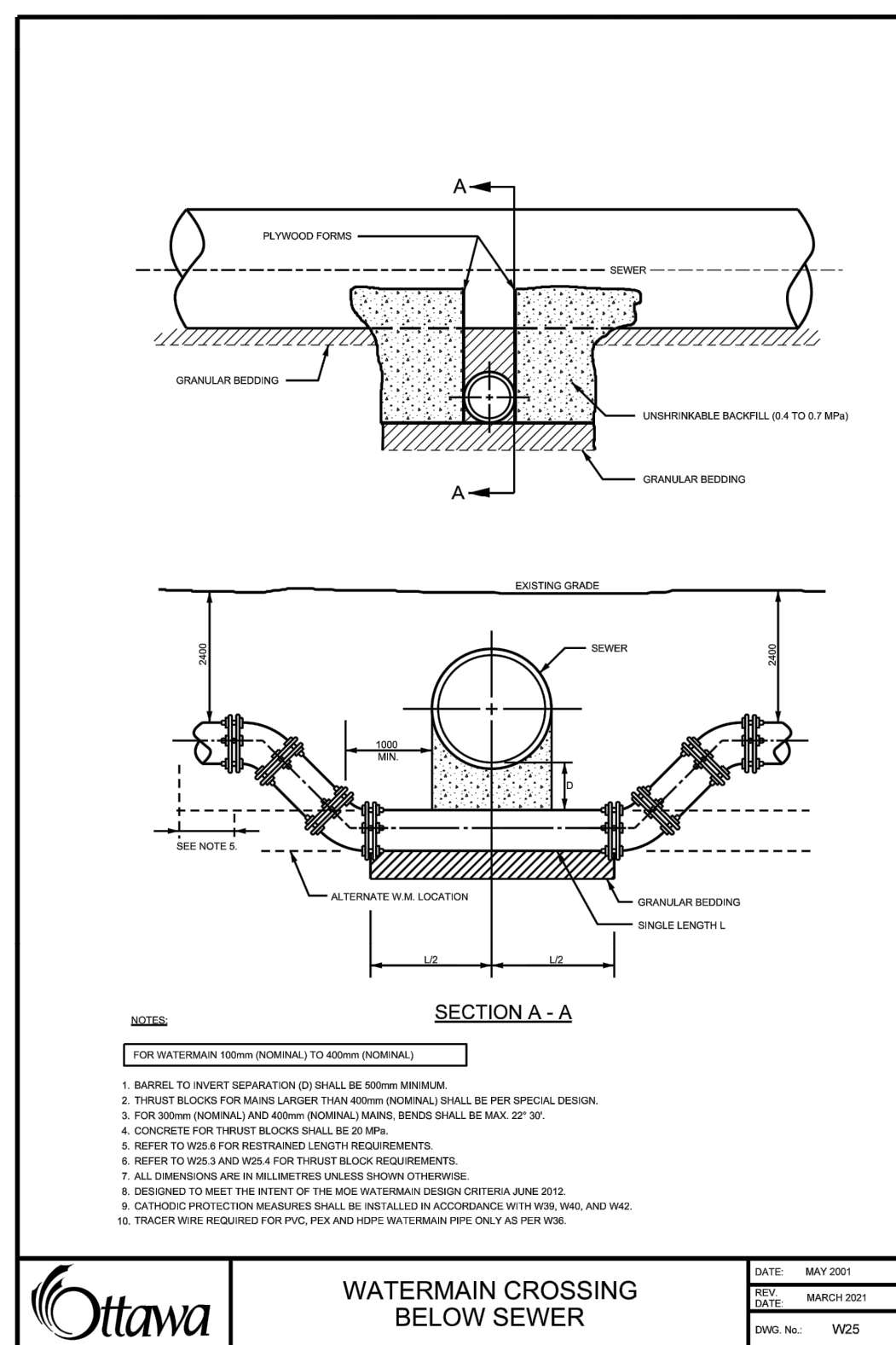
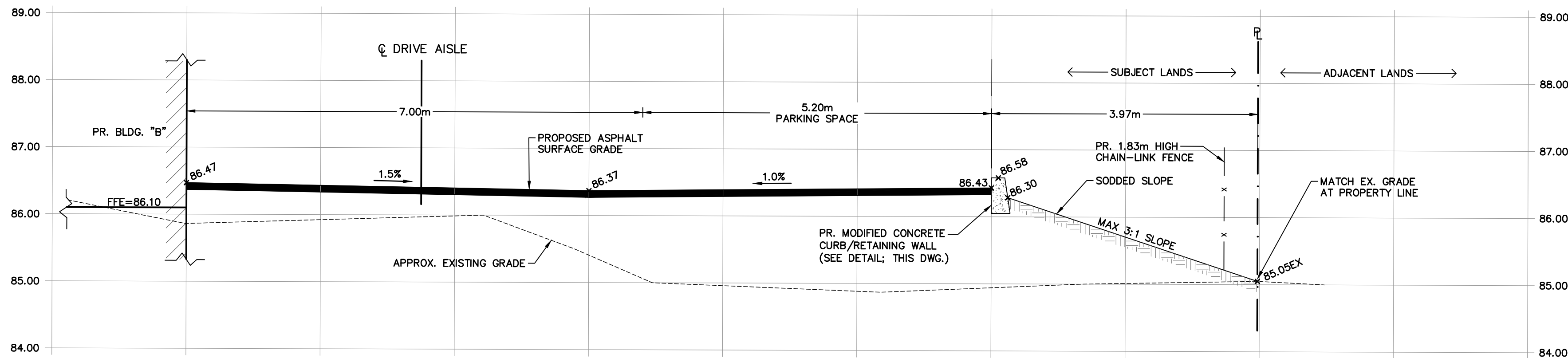

ROOFTOP PONDING CALCULATIONS

ROOFTOP PONDING VOLUME CALCULATIONS

Roof Name	Roof Area (ha)	Roof Area Per Drain (ha)	Drain Ponding Area (ha)	Max. Allowable Rooftop Ponding Depth (m)	Max. Rooftop Ponding Volume per Drain (m³)	Max. Rooftop Ponding Volume Available (m³)	Max. Rooftop Ponding Volume Required (m³)
BLDG A (3 storey)	0.27	0.03	0.02	0.15	10.7	85.5	-
BLDG A (2 storey)	0.05	0.02	0.01	0.15	0.8	20.6	-
BLDG A (total)	0.32	-	-	0.15	-	106.2	100
BLDG B	0.37	0.03	0.02	0.15	2.6	124.9	123

Note: Maximum required rooftop ponding per VO Model prepared by Crozier.

ZURN ROOF DRAIN FLOW RATING

Opening	G.P.M. Per Inch of Head	L.P.M. Per Inch of Head	L/s Per Meter of Head	L/s Per 0.05 m of Head	L/s Per 0.10 m of Head	L/s Per 0.15 m of Head
X ₁	5.00	22.73	14.91	0.75	1.49	2.24
X ₂	3.75	17.05	11.19	0.56	1.12	1.68
X ₃	2.50	11.37	7.46	0.37	0.75	1.12
X ₄	1.25	5.68	3.73	0.19	0.37	0.56

Note: Zurn control flow rates obtained from Drawing No. P-13521 - Adjustable Weir for Sloped-Roof "Control-Flo" Roof Drain

CONTROLLED ROOFTOP RELEASE RATE CALCULATIONS

Roof Name	Control System	Zurn Model Number	Release Rate per Drain (L/s per meter of head)	Proposed # of Zurn Drains	# of Notches per Zurn Drain	Total Release Rate from Roof (L/s)
BLDG A (3 storey)	Zurn Roof Drain	ZCF121-1W-X1-Z-105-10-77	14.92	10	2	44.7
BLDG A (2 storey)	Zurn Roof Drain	ZCF121-1W-X1-Z-105-10-77	14.92	3	2	13.4
BLDG A (total)	Zurn Roof Drain	ZCF121-1W-X1-Z-105-10-77	14.92	13	2	58.2
BLDG B	Zurn Roof Drain	ZCF121-1W-X1-Z-105-10-77	14.92	12	2	53.7

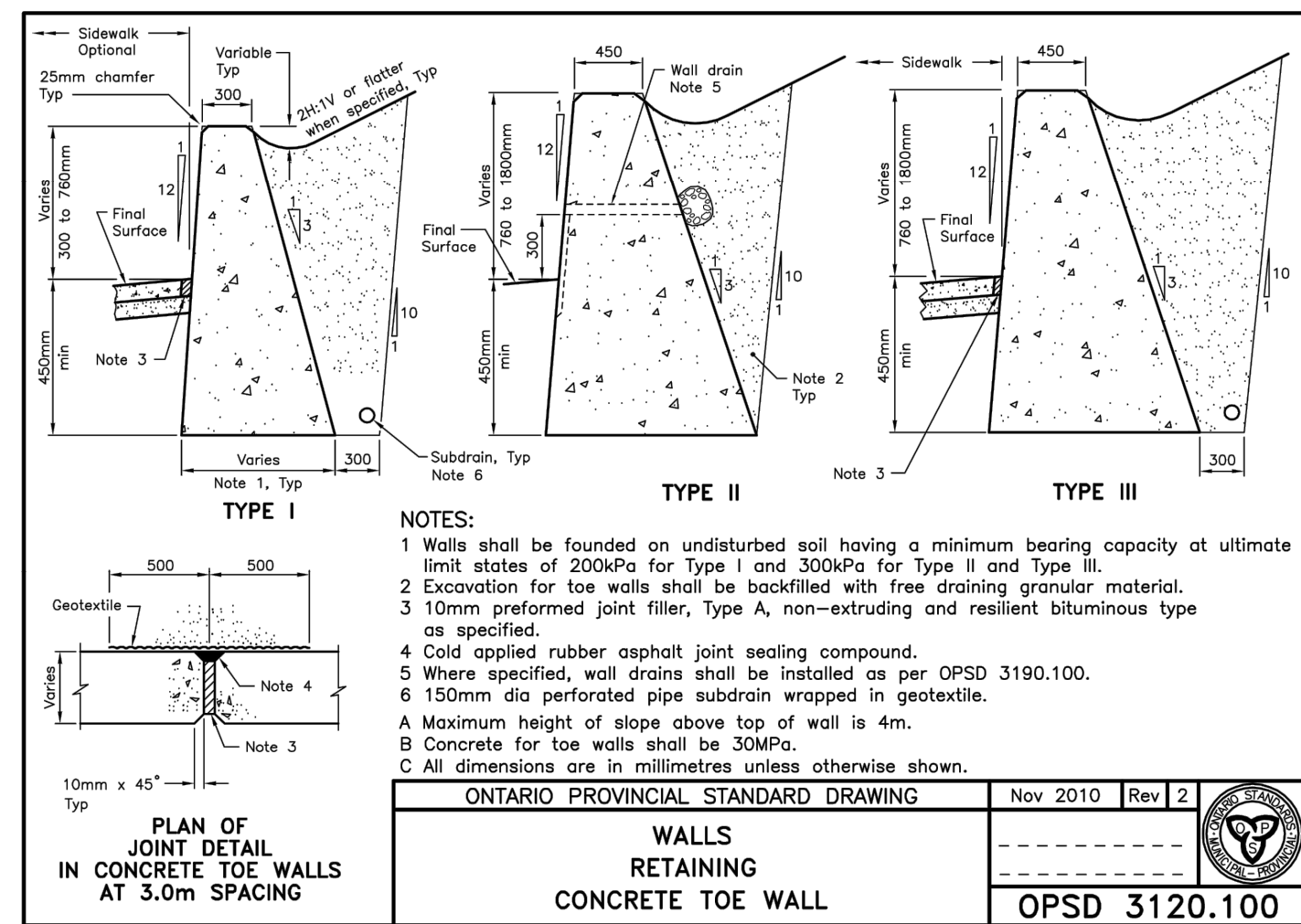

- NOTES:**
- Walls shall be founded on undisturbed soil having a minimum bearing capacity at ultimate limit states of 200kPa for Type I and 300kPa for Type II and Type III.
 - Excavation for toe walls shall be backfilled with free draining granular material.
 - 10mm preformed joint filler, Type A, non-extruding and resilient bituminous type as specified.
 - Cold applied rubber asphalt joint sealing compound.
 - Where specified, wall drains shall be installed as per OPSD 3190.100.
 - 150mm dia perforated pipe subdrain wrapped in geotextile.
 - Maximum height of slope above top of wall is 4m.
 - Concrete for toe walls shall be 30MPa.
 - All dimensions are in millimetres unless otherwise shown.

ONTARIO PROVINCIAL STANDARD DRAWING
WALLS RETAINING CONCRETE TOE WALL
Nov 2010 Rev 2
OPSD 3120.100

2	RE-ISSUED FOR SPA PER CITY COMMENTS	2023/JAN/10
1	RE-ISSUED FOR SPA PER CITY COMMENTS	2022/OCT/17
0	ISSUED FOR SITE PLAN APPLICATION	2022/MAY/17

No.	ISSUE / REVISION	YYYY/MM/DD
-----	------------------	------------

ELEVATION NOTE:
ELEVATIONS SHOWN ARE GEODETIC AND ARE REFERRED TO GEODETIC DATUM CGVD-1928:1978. (SEE FSD FILE No. 531-20)

IT IS THE RESPONSIBILITY OF THE SER OF THIS INFORMATION TO VERIFY THAT THE JOB BENCHMARK HAS NOT BEEN ALTERED OR DISTURBED AND THAT ITS RELATIVE ELEVATION AND DESCRIPTION AGREES WITH THE INFORMATION SHOWN ON THIS DRAWING.

LOCAL BENCHMARK:
TOP SPINDLE OF FIRE HYDRANT LOCATED ON SOUTH SIDE OF COLONNADE ROAD, APPROXIMATELY 95.0m WEST OF PRINCE OF WHALES DRIVE.
ELEVATION = 85.19m

SURVEY NOTES:
SURVEY COMPLETED BY FARLEY, SMITH, & DENIS SURVEYING LTD. (2022/MAR/09)
FILE No.: 101-21
BEARINGS ARE GRID AND ARE REFERRED TO THE WESTERLY LIMIT OF PRINCE OF WHALES DRIVE HAVING A BEARING OF N 24° 04' 30" W, AS SHOWN ON PLAN 48-1836.3.

SITE PLAN NOTES:
DESIGN ELEMENTS ARE BASED ON SITE PLAN BY ARCHITECTURE 49.
DRAWING No.: AD-2 WITH REVISION DATED (2022/SEP/23)
PROJECT No.: 219-00058-00

DRAWING NOTES:
THIS DRAWING IS THE EXCLUSIVE PROPERTY OF C.F. CROZIER & ASSOCIATES INC. AND THE REPRODUCTION OF ANY PART OF IT WITHOUT PRIOR WRITTEN CONSENT OF THIS OFFICE IS STRICTLY PROHIBITED.
THE CONTRACTOR SHALL VERIFY ALL DIMENSIONS, LEVELS, AND DATUMS ON SITE AND REPORT ANY DISCREPANCIES OR OMISSIONS TO THIS OFFICE PRIOR TO CONSTRUCTION.
THIS DRAWING IS TO BE READ AND UNDERSTOOD IN CONJUNCTION WITH ALL OTHER PLANS AND DOCUMENTS APPLICABLE TO THIS PROJECT. DO NOT SCALE THIS DRAWING.
ALL EXISTING UNDERGROUND UTILITIES TO BE VERIFIED IN THE FIELD BY THE CONTRACTOR PRIOR TO CONSTRUCTION.

Project
125 COLONNADE ROAD SOUTH
CITY OF OTTAWA

Drawing
CONSTRUCTION DETAILS

NOT FOR CONSTRUCTION

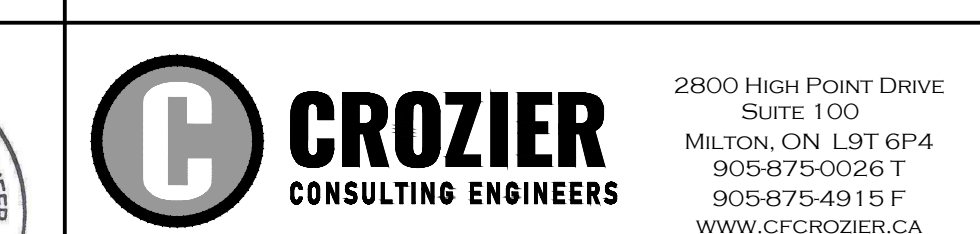
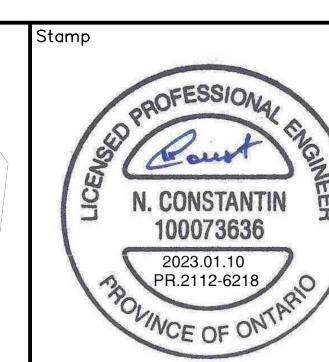
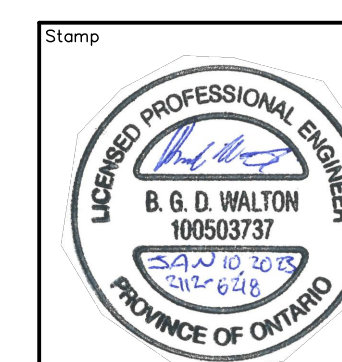

Drawn	M.I.M.	Design	B.P.	Project No.	2112-6218	
Check	B.W.	Check	B.W.	Scale	N.T.S.	
					Dwg. No.	C104

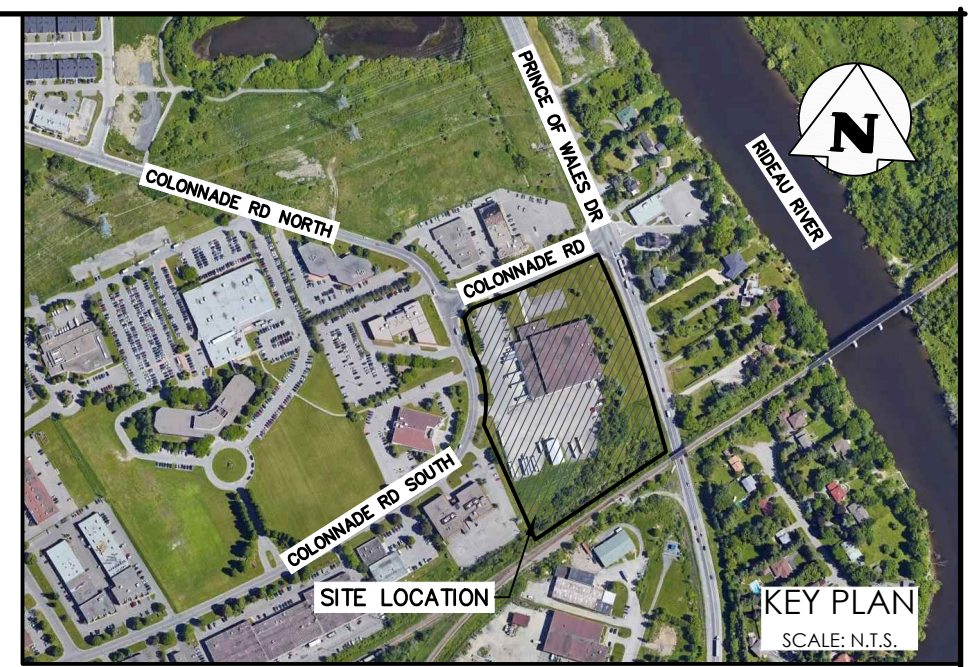
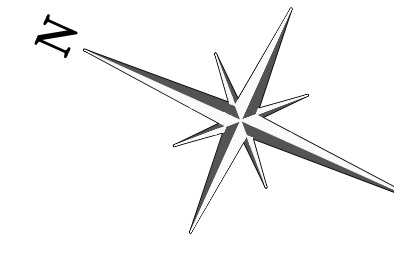

LEGEND

- PROPERTY LINE
- EXISTING DITCH
- EXISTING GRADE
- EXISTING OVERLAND FLOW DIRECTION
- STORM DRAINAGE CATCHMENT
- CATCHMENT I.D.
AREA (ha) | PERCENT IMPERVIOUS (%)

103
1.7157

102
0.79 | 0

101
0.98 | 78

2	RE-ISSUED FOR SPA PER CITY COMMENTS	2023/JAN/10
1	RE-ISSUED FOR SPA PER CITY COMMENTS	2022/OCT/17
0	ISSUED FOR SITE PLAN APPLICATION	2022/MAY/17
No.	ISSUE / REVISION	YYYY/MM/DD

ELEVATION NOTE:
ELEVATIONS SHOWN ARE GEODETIC AND ARE REFERRED TO GEODETIC DATUM CGVD-1928:1978. (SEE FSD FILE No. 531-20)
IT IS THE RESPONSIBILITY OF THE SER OF THIS INFORMATION TO VERIFY THAT THE JOB BENCHMARK HAS NOT BEEN ALTERED OR DISTURBED AND THAT ITS RELATIVE ELEVATION AND DESCRIPTION AGREES WITH THE INFORMATION SHOWN ON THIS DRAWING.

LOCAL BENCHMARK:
TOP SPINDLE OF FIRE HYDRANT LOCATED ON SOUTH SIDE OF COLONNADE ROAD, APPROXIMATELY 95.0m WEST OF PRINCE OF WALES DRIVE.
ELEVATION = 85.19m

SURVEY NOTES:
SURVEY COMPLETED BY FARLEY, SMITH, & DENIS SURVEYING LTD. (2022/MAR/09)
FILE No.: 101-21
BEARINGS ARE GRID AND ARE REFERRED TO THE WESTERLY LIMIT OF PRINCE OF WALES DRIVE HAVING A BEARING OF N 24° 04' 30" W, AS SHOWN ON PLAN 4R-18363.

SITE PLAN NOTES:
DESIGN ELEMENTS ARE BASED ON SITE PLAN BY ARCHITECTURE 49.
DRAWING No.: A0.2 WITH REVISION DATED (2022/SEP/23)
PROJECT No.: 219-00058-00

DRAWING NOTES:
THIS DRAWING IS THE EXCLUSIVE PROPERTY OF C.F. CROZIER & ASSOCIATES INC. AND THE REPRODUCTION OF ANY PART OF IT WITHOUT PRIOR WRITTEN CONSENT OF THIS OFFICE IS STRICTLY PROHIBITED.
THE CONTRACTOR SHALL VERIFY ALL DIMENSIONS, LEVELS, AND DATUMS ON SITE AND REPORT ANY DISCREPANCIES OR OMISSIONS TO THIS OFFICE PRIOR TO CONSTRUCTION.
THIS DRAWING IS TO BE READ AND UNDERSTOOD IN CONJUNCTION WITH ALL OTHER PLANS AND DOCUMENTS APPLICABLE TO THIS PROJECT. DO NOT SCALE THIS DRAWING.
ALL EXISTING UNDERGROUND UTILITIES TO BE VERIFIED IN THE FIELD BY THE CONTRACTOR PRIOR TO CONSTRUCTION.

Project
125 COLONNADE ROAD SOUTH
CITY OF OTTAWA

Drawing
PRE-DEVELOPMENT DRAINAGE PLAN

NOT FOR CONSTRUCTION

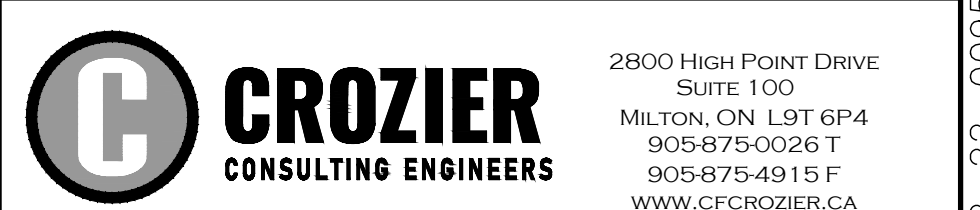
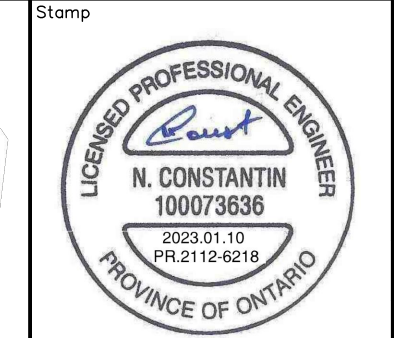
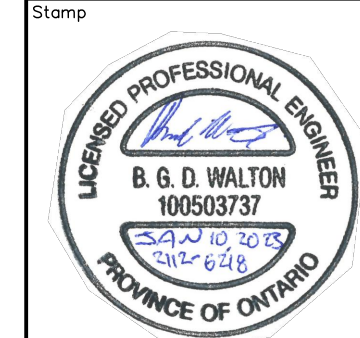
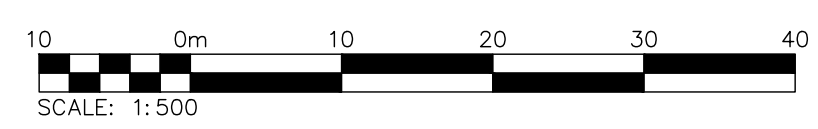

Drawn	M.I.M.	Design	B.P.	Project No.	2112-6218
Check	B.W.	Check	B.W.	Scale	1:500
				Dwg.	FIG 1

D07-12-22-0095

#18809

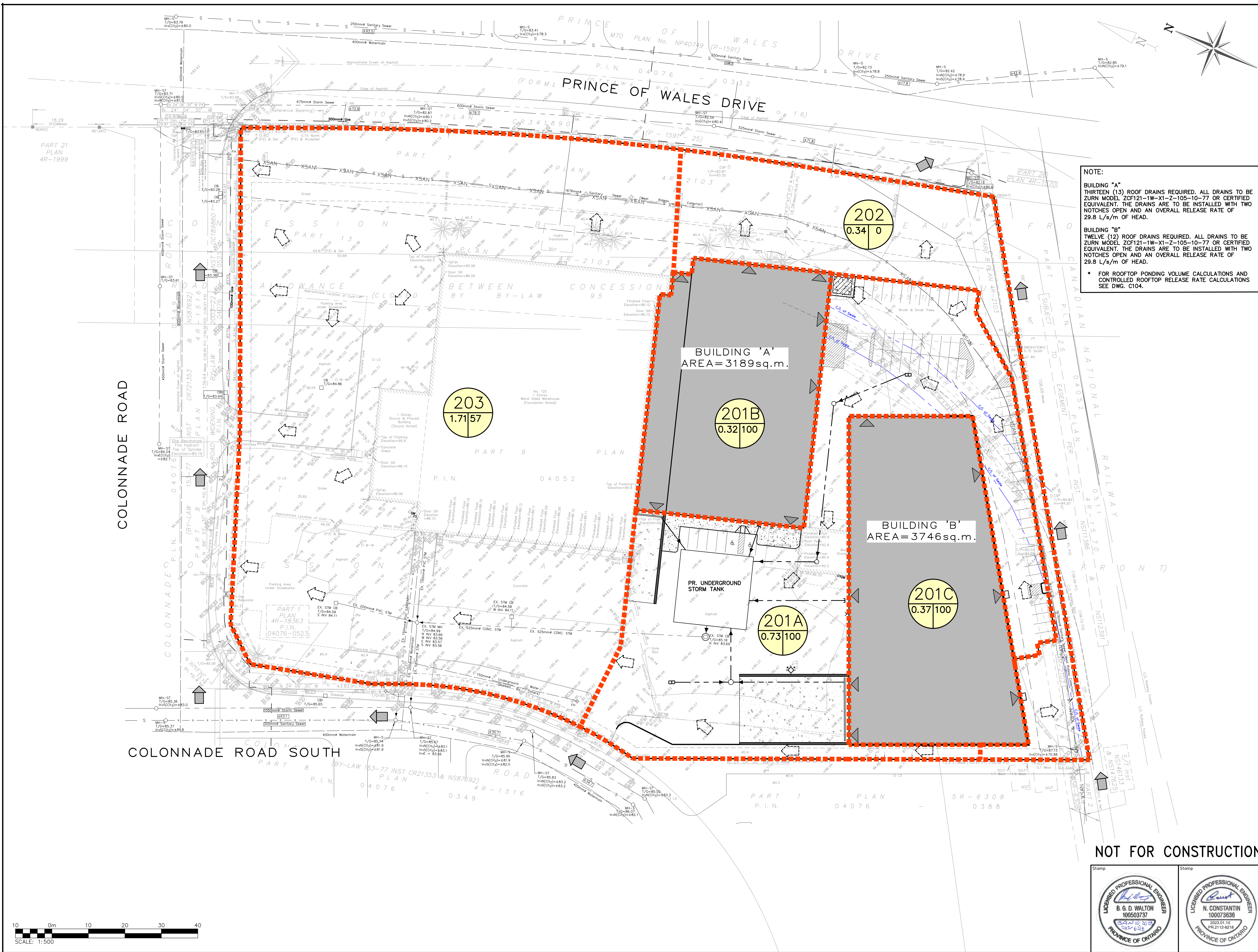

NOTE:
 BUILDING "A"
 THIRTEEN (13) ROOF DRAINS REQUIRED. ALL DRAINS TO BE ZURN MODEL ZCF121-1W-X1-2-105-10-77 OR CERTIFIED EQUIVALENT. THE DRAINS ARE TO BE INSTALLED WITH TWO NOTCHES OPEN AND AN OVERALL RELEASE RATE OF 29.8 L/s/m OF HEAD.
 BUILDING "B"
 TWELVE (12) ROOF DRAINS REQUIRED. ALL DRAINS TO BE ZURN MODEL ZCF121-1W-X1-2-105-10-77 OR CERTIFIED EQUIVALENT. THE DRAINS ARE TO BE INSTALLED WITH TWO NOTCHES OPEN AND AN OVERALL RELEASE RATE OF 29.8 L/s/m OF HEAD.
 * FOR ROOFTOP PONDING VOLUME CALCULATIONS AND CONTROLLED ROOFTOP RELEASE RATE CALCULATIONS SEE DWG. C104.

LEGEND

- PROPERTY LINE
- EXISTING DITCH
- EXISTING GRADE
- EXISTING MAJOR OVERLAND FLOW DIRECTION
- PROPOSED MAJOR OVERLAND FLOW DIRECTION
- STORM DRAINAGE CATCHMENT
- CATCHMENT I.D.
- AREA (ha) | PERCENT IMPERVIOUS (%)

2	RE-ISSUED FOR SPA PER CITY COMMENTS	2023/JAN/10
1	RE-ISSUED FOR SPA PER CITY COMMENTS	2022/OCT/17
0	ISSUED FOR SITE PLAN APPLICATION	2022/MAY/17
No.	ISSUE / REVISION	YYYY/MM/DD

ELEVATION NOTE:
 ELEVATIONS SHOWN ARE GEODETIC AND ARE REFERRED TO GEODETIC DATUM CGVD-1928:1978. (SEE FSD FILE No. 531-20)
 IT IS THE RESPONSIBILITY OF THE SER OF THIS INFORMATION TO VERIFY THAT THE JOB BENCHMARK HAS NOT BEEN ALTERED OR DISTURBED AND THAT ITS RELATIVE ELEVATION AND DESCRIPTION AGREES WITH THE INFORMATION SHOWN ON THIS DRAWING.

LOCAL BENCHMARK:
 TOP SPINDLE OF FIRE HYDRANT LOCATED ON SOUTH SIDE OF COLONNADE ROAD, APPROXIMATELY 95.0m WEST OF PRINCE OF WALES DRIVE.
 ELEVATION = 85.19m

SURVEY NOTES:
 SURVEY COMPLETED BY FARLEY, SMITH, & DENIS SURVEYING LTD. (2022/MAR/09)
 FILE No.: 101-21
 BEARINGS ARE GRID AND ARE REFERRED TO THE WESTERLY LIMIT OF PRINCE OF WALES DRIVE HAVING A BEARING OF N 24° 04' 30" W, AS SHOWN ON PLAN 4R-1836.3.

SITE PLAN NOTES:
 DESIGN ELEMENTS ARE BASED ON SITE PLAN BY ARCHITECTURE 49.
 DRAWING No.: A0.2 WITH REVISION DATED (2022/SEP/23)
 PROJECT No.: 219-00058-00

DRAWING NOTES:
 THIS DRAWING IS THE EXCLUSIVE PROPERTY OF C.F. CROZIER & ASSOCIATES INC. AND THE REPRODUCTION OF ANY PART OF IT WITHOUT PRIOR WRITTEN CONSENT OF THIS OFFICE IS STRICTLY PROHIBITED.
 THE CONTRACTOR SHALL VERIFY ALL DIMENSIONS, LEVELS, AND DATUMS ON SITE AND REPORT ANY DISCREPANCIES OR OMISSIONS TO THIS OFFICE PRIOR TO CONSTRUCTION.
 THIS DRAWING IS TO BE READ AND UNDERSTOOD IN CONJUNCTION WITH ALL OTHER PLANS AND DOCUMENTS APPLICABLE TO THIS PROJECT. DO NOT SCALE THIS DRAWING.
 ALL EXISTING UNDERGROUND UTILITIES TO BE VERIFIED IN THE FIELD BY THE CONTRACTOR PRIOR TO CONSTRUCTION.

Project
125 COLONNADE ROAD SOUTH
 CITY OF OTTAWA

Drawing
POST-DEVELOPMENT DRAINAGE PLAN

NOT FOR CONSTRUCTION

Stamp

 Stamp

CROZIER CONSULTING ENGINEERS
 2800 HIGH POINT DRIVE
 SUITE 100
 MILTON, ON L9T 6P4
 905-875-0026 T
 905-875-4915 F
 WWW.CFCROZIER.CA

Drawn	M.I.M.	Design	B.P.	Project No.	2112-6218
Check	B.W.	Check	B.W.	Scale	1:500
					Dwg. FIG 2

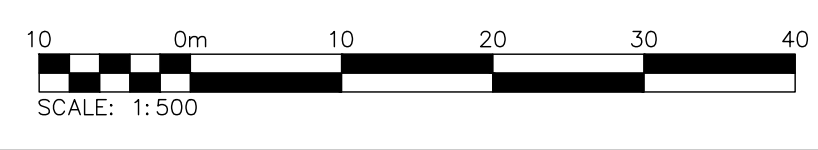

D07-12-22-0095

#18809