

AREA DRAIN #	100 YEAR PONDING DEPTH (mm)	FLOW PER DRAIN (L/sec)
R-A1	131	0.89
R-A2	129	0.88
R-A3	131	0.89
R-A4	121	0.86
R-A5	128	0.88
R-A6	138	0.91
R-B1	131	0.89
R-B2	134	0.90
R-B3	138	0.91
R-B4	139	0.91
R-B5	132	0.89
R-B6	132	0.89

STRUCTURE NUMBER	TYPE	LID ELEV (m)	INVERT IN (m) and DIA (mm)	INVERT OUT (m) and DIA (mm)	STRUCTURE			Comment
					SIZE	REFERENCE	FRAME COVER	
STMMH 100	STORM	74.01	72.28 N (250)	72.22 E (300)	1200 DIA	OPSD 701.010	Ottawa S25	Ottawa S24.1
			72.23 W (300)					
STMMH 101	STORM	74.69	72.44 NW (250)	72.38 S (250)	1200 DIA	OPSD 701.010	Ottawa S25	Ottawa S24.1
			72.44 W (250)					
STMMH 102	STORM	74.91	72.94 E (250)	72.91 W (250)	1200 DIA	OPSD 701.010	Ottawa S25	Ottawa S24.1
SANMH 200	SANITARY	75.20	72.22 N (250)	72.16 W (250)	1200 DIA	OPSD 701.010	Ottawa S25	Ottawa S24
SANMH 201	SANITARY	75.04	72.19 E (250)	71.91 S (250)	1200 DIA	OPSD 701.010	Ottawa S25	Ottawa S24
			71.92 N (250)					

STRUCTURE	U/S	D/S	TYPE	INVERT ELEV (m)	NOMINAL DIA. (mm)	LENGTH (m)	Type	Class	Comment
CISTERN	STMMH 102	STORM		73.000	72.980	250	0.8	PVC	SDR35 50mm Insulation required
STMMH 102	CITY STORM	STORM		72.950	72.870	250	4.2	PVC	SDR35 50mm Insulation required
TOWER B	STMMH 101	STORM		72.450	72.440	250	0.9	PVC	SDR35
STMMH 101	STMMH 100	STORM		72.380	72.280	250	10.1	PVC	SDR35
TOWER A	SANMH 200	SANITARY		72.340	72.220	250	6.1	PVC	SDR35
TOWER B	SANMH 200	SANITARY		72.240	72.220	250	1.0	PVC	SDR35
SANMH 200	SANMH 201	SANITARY		72.160	71.970	250	9.7	PVC	SDR35

STATION	DESCRIPTION	GROUND ELEVATION (m)	TOP OF WATERMAIN. ELEV (m)	
			PROPOSED (m)	AS-BUILT (m)
0+000	300x200 TEE	74.80	72.80	
	300x200 TEE	74.80	72.80	
	200 VALVE & VALVE BOX	74.80	72.80	
0+002.4	CROSSING SANITARY SEWER	74.89	72.80	
0+003.3	45° VERTICAL BEND	74.82	72.80	
0+003.8	45° VERTICAL BEND	74.85	72.34	
0+004.8	CROSSING STORM SEWER	74.89	72.34	
0+009.0	200 VALVE AND VALVE BOX	74.95	72.37	
0+009.8	200 VALVE AND VALVE CHAMBER (W3)	74.95	72.37	
0+009.8	CAP - FROM BUILDING	74.97	72.38	

CB#	TOP OF GRATE ELV.	INVERTS	REFERENCE	FRAME	COVER
CB1	74.76	SE=73.22 (250mm) SW=73.16 (250mm)	OPSD 705.010	S19	S19
CBE1	74.62	NW=73.41 (250mm)	S31	S31	S31
CBE2	75.05	W=73.45 (250mm)	S31	S31	S31

LOCATION	SANITARY SEWER			STORM SEWER			WATERMAIN			CLEARANCES (mm)	NOTES
	INV ELEV (m)	DIA (mm)	OBV ELEV (m)	INV ELEV (m)	DIA (mm)	OBV ELEV (m)	INV ELEV (m)	DIA (mm)	OBV ELEV (m)		
1	74.89	72.03	250	72.28			72.60	200	72.80	(WATER SERVICE ABOVE SEWER AS PER CITY STD. W25.2)	100mm OF INSULATION TO BE PROVIDED AS PER CITY STD. W22.
2	74.80			72.84	300	73.14	72.14	200	72.34	(WATER SERVICE BELOW SEWER AS PER CITY STD. W25.2)	

CONTROL LOCATION	POST DEVELOPMENT DRAINAGE NUMBER	TOTAL ROOF MAX FLOW (L/sec)	TOTAL ROOF STORAGE VOLUME (m3)	MAX HEAD (m)	TYPE	NUMBER OF DRAINS	MANUFACTURER	MODEL
TOWER A ROOF	PST-1 (R-A1 - R-A6)	5.3 L/sec	1198 m3	0.15	FLOW CONTROLLED ROOF DRAIN	6	WATTS	ACUTROL ADJUSTABLE 1 WEIR PER DRAIN SET @25% POSITION
TOWER B ROOF	PST-3 (R-B1 - R-B6)	5.4 L/sec	1384 m3	0.15	FLOW CONTROLLED ROOF DRAIN	6	WATTS	ACUTROL ADJUSTABLE 1 WEIR PER DRAIN SET @25% POSITION

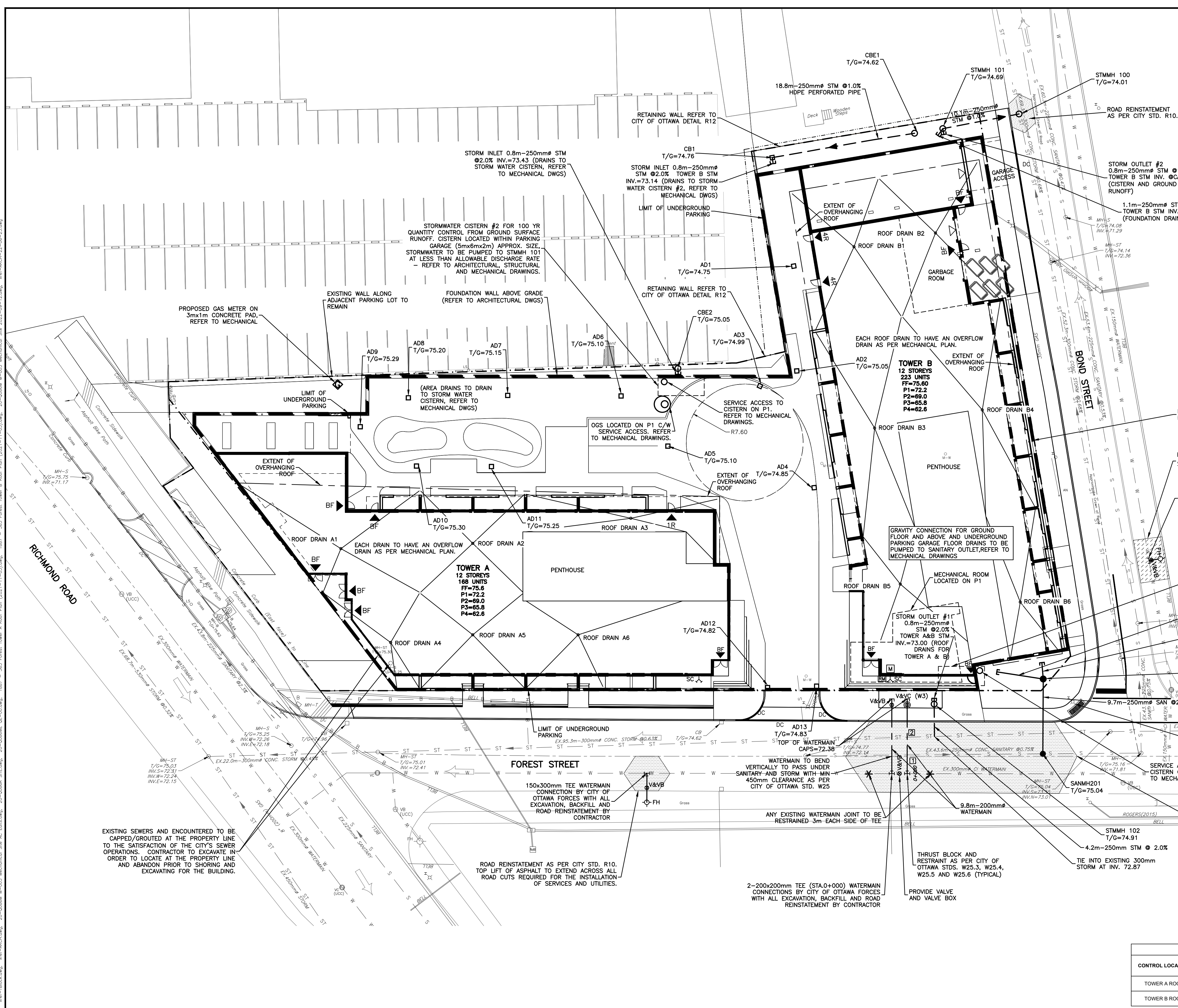

REV	REVISION DESCRIPTION	DATE	BY	APPD
7	REVISED PER CITY COMMENTS	09/12/22	SAB	BMT
6	REVISED PER CITY COMMENTS	17/11/22	AC	BMT
5	REVISED PER CITY COMMENTS	15/09/22	AC	BMT
4	REVISED PER CITY COMMENTS	10/12/21	AC	JD
3	REVISED PER CITY COMMENTS	27/05/21	AC	BMT
2	ISSUED FOR REZONING APPLICATION	27/01/20	MZG	BMT
1	ISSUED FOR REVIEW	12/09/19	SAB	BMT

CAUTION: THE POSITION OF ALL POLE LINES, CONDUITS, WATERMANS, SEWERS AND OTHER UNDERGROUND AND OVERGROUND UTILITIES AND STRUCTURES IS NOT NECESSARILY SHOWN ON THE CONTRACT DRAWINGS, AND WHERE SHOWN, THE ACCURACY OF THE POSITION OF SUCH UTILITIES AND STRUCTURES IS NOT GUARANTEED. BEFORE STARTING WORK, DETERMINE THE EXACT LOCATION OF ALL SUCH UTILITIES AND STRUCTURES AND ASSUME ALL LIABILITY FOR DAMAGE TO THEM.

SCALE: 0 2m 4m 10m HORIZONTAL 1:250

DESIGNED BY: [Signature]

REVIEWED BY: [Signature]

CLIENT: 11061917 CANADA INCORPORATED, 100-768 ST. JOSEPH BOULEVARD, GATINEAU, QC. J8Y 4B8

PROJECT: 11061917 CANADA INC RESIDENTIAL DEVELOPMENT, 365 FOREST STREET, OTTAWA, ONTARIO.

TITLE: SITE SERVICING PLAN

DRAWING No.: OTT-252570-A0

SURVEY: ACV

DATE: JAN 2020

DRAWING No.: C100

exp. Services Inc. 1-877-888-1889 | 1-613-225-7330 | 1000 GARDEN AVENUE UNIT 100 OTTAWA, ON K2B 8R6 Canada www.exp.com

• BUILDINGS • EARTH & ENVIRONMENT • ENERGY • INDUSTRIAL • INFRASTRUCTURE • SUSTAINABILITY •