

SITE INFORMATION:

LEGAL DESCRIPTION:
BLOCKS 313 AND 314 REGISTERED PLAN
44-1619 CITY OF OTTAWA

BOUNDARY INFORMATION RE-ESTABLISHED FROM
SUBVISION COORDINATE CONTROL FILE
17879-18

EASEMENTS:
REFER TO PLANNING DOCUMENTS

MUNICIPAL ADDRESS:
755 COPE DR

SITE AREA:
28,889m² (310,958.6 FT²)

BUILDING AREA:
3,803.078m² (40,935.99 FT²)

MAX. BUILDING HEIGHT:
18m (59'-3")

ZONING INFORMATION:

ZONING:
MINOR INSTITUTIONAL ZONE (I1B)

PROPOSED LOT COVERAGE:
NO REQUIREMENT

SETBACKS:
MIN FRONT YARD: 6m (REQ. 6m)
MIN REAR YARD: 8.74m (REQ. 7.5m)
MIN CORNER SIDE YARD: 56.26m (REQ. OTHERS NOTED)
MIN. EXT. SIDE YARD: NO REQUIREMENT

MIN. LANDSCAPED OPEN SPACE:
NO REQUIREMENT

MIN. LANDSCAPED BUFFER FOR PARKING:
3.61m (REQ. 3m)

LAYOUT NOTES:

- CONTRACTOR TO CONFIRM ALL DIMENSIONS AND REPORT ANY DISCREPANCIES TO CONTRACTOR ADMINISTRATOR PRIOR TO CONSTRUCTION
- LAYOUT TO BE APPROVED BY CONTRACT ADMINISTRATOR PRIOR TO ANY CONSTRUCTION OR REMOVALS
- ALL DIMENSIONS ARE IN METRIC UNLESS OTHERWISE NOTED
- CONTRACTOR IS RESPONSIBLE FOR ALL EXCAVATIONS, REMOVALS, DISPOSALS AND ROUGH GRADING AS REQUIRED TO CONSTRUCTION ALL WORKS AS SHOWN ON ALL PLANS, DETAILS AND SPECIFICATIONS
- LOCATION OF ALL UTILITIES SHOWN FOR ILLUSTRATION ONLY. CONTRACTOR MUST CONTACT ALL UTILITIES REGARDING RULES FOR WORKING IN THE AREA OF THE UTILITIES PRIOR TO COMMENCEMENT OF ANY WORK. CONTRACTOR MUST CONFIRM LOCATION OF ALL UTILITIES PRIOR TO CONSTRUCTION
- ALL EXISTING ROADS, SIDEWALKS, CURBS, FENCING, PAVING, SODDED RIGHT-OF-WAY, AND APPROACHES, ETC. TO REMAIN TO BE PROTECTED DURING CONSTRUCTION TO THE CITY OF OTTAWA STANDARDS AT THE CONTRACTOR'S OWN COSTS
- ALL EXISTING TREES, SHRUB BEDS, MULCH BEDS, AND SOIL TO REMAIN TO BE PROTECTED DURING CONSTRUCTION TO CITY OF OTTAWA STANDARDS. CONTRACTOR TO STAKE OUT PARKING ROWS AND ISLANDS FOR REVIEW AND APPROVAL BY PROJECT LANDSCAPE ARCHITECT PRIOR TO EXCAVATION
- CONTRACTOR TO LAYOUT PARKING AREAS TO ACHIEVE REQUIRED NUMBER OF STALLS IN EACH ROW. STALLS ARE 2500mm WIDE BY 5800mm DEEP (UNLESS OTHERWISE NOTED). CONTRACTOR TO REPORT ANY DISCREPANCIES TO CONTRACTOR ADMINISTRATOR PRIOR TO CONSTRUCTION
- PARKING LOT ROWS TO BE LAID OUT PARALLEL TO BUILDING FACE. CONTRACTOR TO STAKE OUT PARKING ROWS AND ISLANDS FOR REVIEW AND APPROVAL BY PROJECT LANDSCAPE ARCHITECT PRIOR TO EXCAVATION
- USE SPECIFIED BACKFILL IN ALL TRENCHES RUNNING BELOW ALL STRUCTURES, PAVING, WALKWAYS, ETC.
- REFER TO PLANTING PLAN L103 FOR LAYOUT OF ALL SHRUB BEDS AND TREES
- ALL PAINTED PAVEMENT MARKING AND SIGNS SHOWN, WITHIN LIMIT OF WORK & AS NOTED ON PLANS, TO BE INCLUDED IN WORK UNDER THIS CONTRACT

PARKING REQUIREMENTS:

- SCHOOL, ELEMENTARY (SEC. 101, TABLE 101A, NB1)
1.5 PER CLASSROOM (INCLUDING PORTABLES, ADMIN, CHILDCARE)
= 55 SPACES REQ.
61 PROVIDED
- ACCESSIBLE PARKING REQ. (BY-LAW NO. 2017-301, SECTION 111)
= 1 TYPE A SPOT REQ.
2 PROVIDED

BICYCLE PARKING:
SCHOOL: 1 PER 100m² OF GROSS FLOOR AREA - 47.41 REQ.
DAY CARE: 1 PER 250m² GFA - 1.3 REQ.
= 48 SPACES REQ.
56 PROVIDED

KEYNOTES:

- CONCRETE SIDEWALK REFER TO DETAIL 10/L200
- ASPHALT SIDEWALK REFER TO DETAIL 11/L200
- UNIT PAVING ON CONCRETE BASE. REFER TO DETAIL 12/L200
- 150mm HT CONCRETE CURB. REFER TO DETAIL 15/L200
- 150mm HT CONCRETE CURB. REFER TO DETAIL 15/L200
- ASPHALT PARKING LOT (61 STALLS, INCLUDING 2 TYPE A ACCESSIBLE STALLS)
- SODDED AREA. REFER TO DETAIL 13/L200
- NEW VEHICLE GATE. REFER TO DETAIL 28/L201
- NEW PEDESTRIAN GATE. REFER TO DETAIL 29/L201
- NEW FREE STANDING BASKETBALL HOOP AND BACKBOARD. REFER TO DETAIL 27/L201
- OUTDOOR CLASSROOM, REFER TO ENLARGEMENT A, L104
- NEW MINI-SOCCER GOALS
- LINE PAINTING. REFER TO SPECIFICATIONS
- SODDED BERM. REFER TO CIVIL GRADING PLAN
- TRIPLE HOOP AND POST
- STRUCTURAL CONCRETE PAD. REFER TO CIVIL
- ASPHALT PAVING. REFER TO CIVIL
- FUTURE PARKING EXPANSION
- SOCCER FIELD LINES FOR SPATIAL LAYOUT PURPOSES ONLY, NOT TO BE PAINTED
- SPACING FOR FUTURE PORTABLE CLASSROOMS
- 1.2m HT CHAIN LINK FENCE AND GATE
- EXTERIOR FREE STANDING SIGN
- ELECTRIC VEHICLE CHARGING STATION
- LOADING SPACE
- FIRE ROUTE
- EXISTING MUP TO BE RETAINED
- EXISTING CONCRETE SIDEWALK TO BE RETAINED
- MID BLOCK NARROWING AS PER CITY OF OTTAWA DETAIL R9
- 100mm WHITE EDGE LINE PAINTING PER CITY OF OTTAWA STANDARDS. ENSURE CONTINUOUS WITH EXISTING MUP LINE PAINTING
- SOLID YELLOW 100mm DIRECTIONAL DIVIDING LINE PER CITY OF OTTAWA STANDARDS. ENSURE CONTINUOUS WITH EXISTING MUP LINE PAINTING
- DEPRESSED CURB PER CITY OF OTTAWA SC7.1

LEGEND:

- CONCRETE SIDEWALK
- UNIT PAVING
- HEAVY DUTY ASPHALT PAVING
- LIGHT DUTY ASPHALT PAVING
- SODDED AREA
- PLANTING BED
- ENGINEERED WOOD FIBRE SAFETY SURFACE
- PROPERTY LINE
- 1.8M HT WOOD SCREEN FENCE
- 1.2M HT CHAIN LINK FENCE
- CONTOUR LINE
- DECIDUOUS TREE
- CONIFEROUS TREE
- CONIFEROUS SHRUB
- PERENNIAL SHRUB
- DETAIL CALLOUT
- PLANT KEY
- NUMBER PLANTS
- PLANT SPECIES. REFER TO PLANT LIST
- SCOPE OF WORK LINE

PLANT LIST:

KEY	QTY	BOTANICAL NAME	COMMON NAME	SPACING (mm) (75%)	SIZE	COMMENTS
TREES - Deciduous						
Aa	3	Acer saccharum 'Endowment'	Endowment Sugar Maple	as shown	65mm Cal. BAB	
Gr	9	Gleditsia triacanthos 'Draven'	Street Keeper Honeylocust	as shown	75mm Cal. BAB	
Ar	1	Acer x freemanii 'Armstrong Gold'	Armstrong Gold Maple	as shown	75mm Cal. BAB	
Rp	3	Betula pendula 'Telecartar'	Culbave Weeping Birch	as shown	75mm Cal. BAB	
Sa	3	Sorbus aucuparia	European Mountain Ash	as shown	75mm Cal. BAB	
Ar	2	Acer glabrum 'Drammondii'	Hedgehog Norway Maple	as shown	75mm Cal. BAB	
Dr	4	Quercus rubra	Red Oak	as shown	75mm Cal. BAB	
Al	5	Ambelanchier laevis	Allegheny Serviceberry	as shown	75mm Cal. BAB	
Cc	2	Cercis canadensis	Eastern Redbud	as shown	75mm Cal. BAB	
Ga	2	Gleditsia triacanthos 'Suntail'	Suntail Honeylocust	as shown	75mm Cal. BAB	
Ua	2	Ulmus americana 'Valley Forge'	Valley Forge Elm	as shown	75mm Cal. BAB	
Ms	9	Malus 'Spring Snow'	Spring Snow Flowering Crab	as shown	50mm Cal. BAB	
Ta	3	Tilia americana	American Linden	as shown	75mm Cal. BAB	
Sr	6	Syringa reticulata 'Ivory Silk'	Ivory Silk Japanese Tree Lilac	as shown	75mm Cal. BAB	
Cr	13	Corylus x modernensis 'Snowbird'	Snowbird Hawthorn	as shown	50mm Cal. BAB	
TREES - Coniferous						
Pp	6	Picea pungens 'Fastigiat'	Colorado Blue Spruce	as shown	180mm HT. BAB	
Pr	6	Prinus arbutus	White Pine	as shown	180mm HT. BAB	
SHRUBS - Coniferous						
Jc	133	Juniperus sabina 'Sandal'	Sandaline Juniper	900	2 gpl.	
SHRUBS - Deciduous						
Ca	19	Cornus alba 'Lilac Petal'	Lilac Petal Dogwood	900	2 gpl.	

ARCHITECTURE 49

1345 ROSEMOUNT AVENUE
CORNWALL, ONTARIO, CANADA, K6J 3E5
TEL: 613-833-8804 | FAX: 613-836-0335 | WWW.ARCHITECTURE49.COM

CONSULTANT - SUB-CONSULTANT:

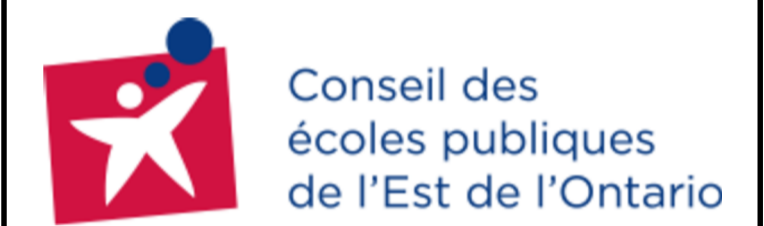

CLIENT REF. # --

PROJECT:

**ÉCOLE ÉLÉMENTAIRE
KANATA-STITTSVILLE**

KEY PLAN:

COPYRIGHT:
COPYRIGHT IN THIS ELECTRONIC DOCUMENT BELONGS TO ARCHITECTURE49 INC. THIS ELECTRONIC DOCUMENT MAY NOT BE FORWARDED TO OTHERS, TRANSMITTED, DOWNLOADED OR REPRODUCED IN ANY FORMAT, WHETHER PRINT OR ELECTRONIC, WITHOUT THE EXPRESS, WRITTEN PERMISSION OF THE COPYRIGHT OWNER.

DISCLAIMER:
THE CONTRACTOR SHALL CHECK AND VERIFY ALL DIMENSIONS AND UTILITY LOCATIONS AND REPORT ALL ERRORS AND OMISSIONS PRIOR TO COMMENCING WORK. THIS DRAWING IS NOT TO BE SCALED.

ISSUED FOR - REVISION:

REV.	DATE	DESCRIPTION
12	9 DEC 2022	UPDATED FOR CITY COMMENTS
11	28 NOV 2022	REISSUED FOR SITE PLAN CONTROL
10	03 NOV 2022	REISSUED FOR SPA APPROVAL
9	02 SEP 2022	UPDATED PER CITY COMMENTS
8	18 JUL 2022	REISSUED FOR SPA APPROVAL
7	30 JUN 2022	ISSUED FOR ADDENDUM 2
6	21 MAR 2022	ISSUED FOR BID AND PERMIT
5	14 JAN 2022	99% CD REVIEW
4	19 NOV 2021	85% CD REVIEW
3	24 SEP 2021	60% CD REVIEW
2	27 AUG 2021	RE-ISSUED FOR 30% CD REVIEW
1	04 AUG 2021	30% CD REVIEW

PROJECT NO:
219-00014-00

DATE:
NOVEMBER 3, 2022

ORIGINAL SCALE:
AS NOTED

DESIGNED BY:
AH

DRAWN BY:
MK / SG

CHECKED BY:
AH

DISCIPLINE:
LANDSCAPE

TITLE:
SITE PLAN

SHEET NUMBER:
L100

ISSUE:
OF

REV. #
0

DATE OF: --

1 SITE PLAN
L100 1:400

D07-12-22-0058
Plan #18734

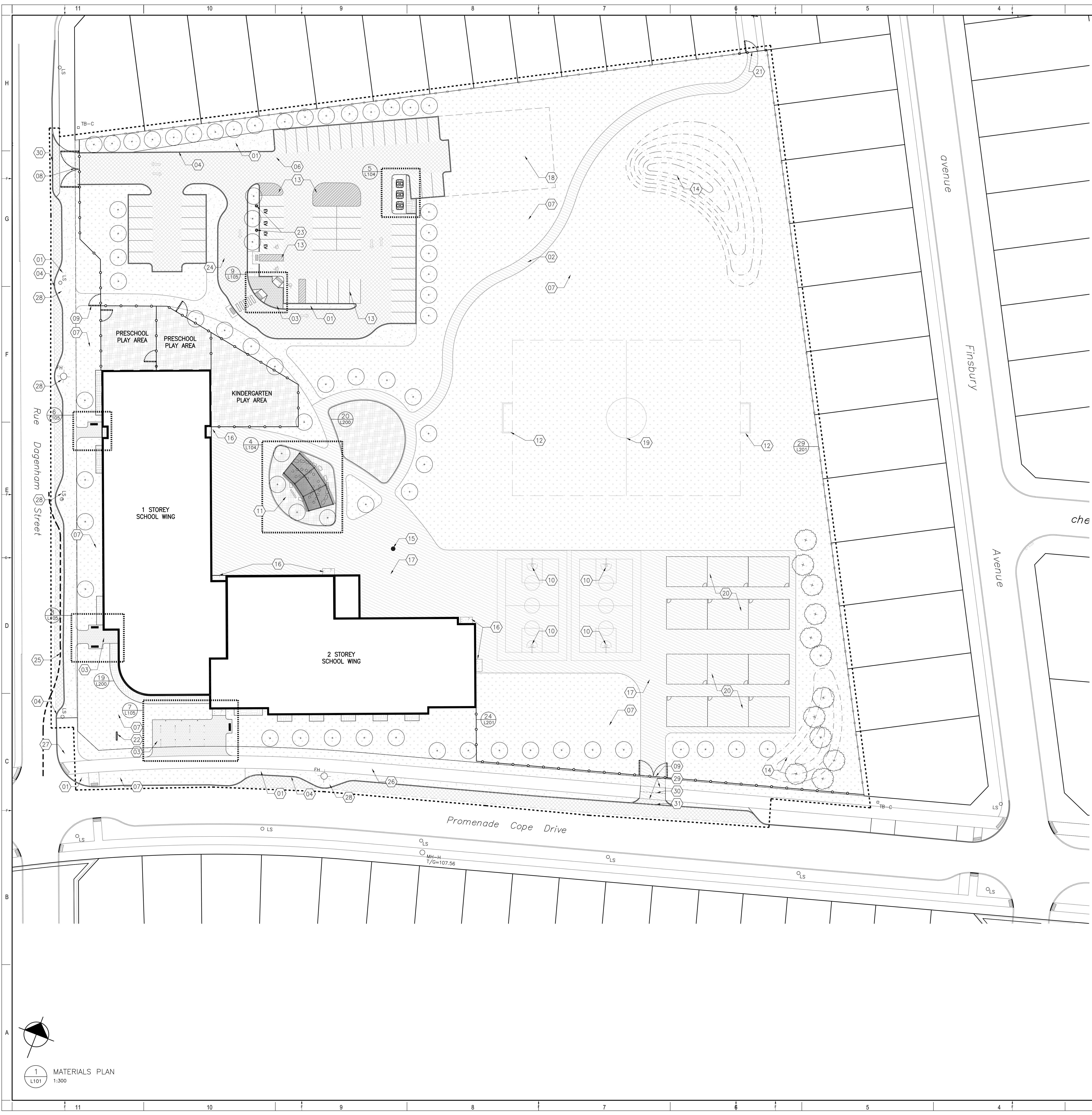

KEYNOTES:

1. CONCRETE SIDEWALK REFER TO DETAIL 10/L200
2. ASPHALT SIDEWALK REFER TO DETAIL 11/L200
3. UNIT PAVING ON CONCRETE BASE REFER TO DETAIL 12/L200
4. 150mm HT CONCRETE CURB REFER TO DETAIL 15/L200
5. SIDEWALK RAMP WITH TACTILE WARNING SURFACE INDICATOR (TWS) TO CITY OF OTTAWA CONSTRUCTION STANDARDS
6. ASPHALT PARKING LOT (E1 STALLS) INCLUDING 2 TYPE A ACCESSIBLE STALLS
7. SOODED AREA REFER TO DETAIL 13/L200
8. NEW WHEELIE GATE REFER TO DETAIL 25/L201
9. NEW PEDESTRIAN GATE REFER TO DETAIL 25/L201
10. NEW FREE STANDING BASKETBALL HOOP AND BACKBOARD REFER TO DETAIL 27/L201
11. OUTDOOR CLASSROOM REFER TO ENLARGEMENT 4, L104
12. NEW MINI-SOCCER GOALS
13. LINE PAINTING REFER TO SPECIFICATIONS
14. SOODED BERM REFER TO CIVIL GRADING PLAN
15. TRIPLE HOOP AND POST
16. STRUCTURAL CONCRETE PAD REFER TO CIVIL
17. ASPHALT PAVING REFER TO CIVIL
18. FUTURE PARKING EXPANSION
19. SOCCER FIELD LINES FOR SPATIAL LAYOUT PURPOSES ONLY, NOT TO BE PAINTED
20. SPAING FOR FUTURE PORTABLE CLASSROOMS
21. 1.2m HT CHAIN LINK FENCE AND GATE
22. EXTERIOR FREE STANDING SIGN
23. ELECTRIC VEHICLE CHARGING STATION
24. LOADING SPACE
25. FIRE ROUTE
26. EXISTING MUP TO BE RETAINED
27. EXISTING CONCRETE SIDEWALK TO BE RETAINED
28. MD BLOCK NARROWING AS PER CITY OF OTTAWA DETAIL R9
29. 100mm WHITE EDGE LINE PAINTING PER CITY OF OTTAWA STANDARDS. ENSURE CONTINUOUS WITH EXISTING MUP LINE PAINTING
30. SOLID YELLOW 100mm DIRECTIONAL DIVIDING LINE PER CITY OF OTTAWA STANDARDS. ENSURE CONTINUOUS WITH EXISTING MUP LINE PAINTING
31. DEPRESSED CURB PER CITY OF OTTAWA SCT.1

LAYOUT NOTES:

1. CONTRACTOR TO CONFIRM ALL DIMENSIONS AND REPORT ANY DISCREPANCIES TO CONTRACTOR ADMINISTRATOR PRIOR TO CONSTRUCTION
2. LAYOUT TO BE APPROVED BY CONTRACT ADMINISTRATOR PRIOR TO CONSTRUCTION OR REMOVALS
3. ALL DIMENSIONS ARE IN METRIC UNLESS OTHERWISE NOTED
4. CONTRACTOR IS RESPONSIBLE FOR ALL EXCAVATIONS, REMOVALS, DISPOSALS AND ROUGH GRADING AS REQUIRED TO CONSTRUCTION ALL WORKS AS SHOWN ON ALL PLANS, DETAILS AND SPECIFICATIONS
5. LOCATION OF ALL UTILITIES SHOWN FOR ILLUSTRATION ONLY. CONTRACTOR MUST CONTACT ALL UTILITIES REGARDING RULES FOR WORKING IN THE AREA OF THE UTILITIES PRIOR TO COMMENCEMENT OF ANY WORK. CONTRACTOR MUST CONFIRM LOCATION OF ALL UTILITIES PRIOR TO CONSTRUCTION
6. ALL EXISTING ROADS, SIDEWALKS, CURBS, FENCING, PAVING, SOODED RIGHT-OF-WAY, AND APPROACHES, ETC. TO REMAIN TO BE PROTECTED DURING CONSTRUCTION TO THE CITY OF OTTAWA STANDARDS AT THE CONTRACTORS OWN COSTS.
7. ALL EXISTING TREES, SHRUB BEDS, MULCH BEDS, AND SOIL TO REMAIN TO BE PROTECTED DURING CONSTRUCTION TO CITY OF OTTAWA STANDARDS. DAMAGED DURING CONSTRUCTION TO BE REPAIRED TO CITY OF OTTAWA STANDARDS AT THE CONTRACTORS OWN COST.
8. CONTRACTOR TO LAYOUT PARKING AREAS TO ACHIEVE REQUIRED NUMBER OF STALLS IN EACH ROW. STALLS ARE 2050mm WIDE BY 5000mm DEEP (UNLESS OTHERWISE NOTED). CONTRACTOR TO REPORT ANY DISCREPANCIES TO CONTRACT ADMINISTRATOR PRIOR TO CONSTRUCTION.
9. PARKING LOT ROWS TO BE Laid OUT PARALLEL TO BUILDING FACE. CONTRACTOR TO STAKE OUT PARKING ROWS AND ISLANDS FOR REVIEW AND APPROVAL BY PROJECT LANDSCAPE ARCHITECT PRIOR TO CONSTRUCTION.
10. USE SPECIFIED BACKFILL IN ALL TRENCHES RUNNING BELOW ALL STRUCTURES, PAVING, WALKWAYS, ETC.
11. REFER TO PLANTING PLAN L103 FOR LAYOUT OF ALL SHRUB BEDS AND TREES.
12. ALL PLANTED PLANTING MATERIALS AND SIGNS SHOWN WITHIN LIMIT OF WORK & AS NOTED ON PLANS, TO BE INCLUDED IN WORK UNDER THIS CONTRACT.

LEGEND:

- CONCRETE SIDEWALK
- UNIT PAVER
- HEAVY DUTY ASPHALT PAVING
- LIGHT DUTY ASPHALT PAVING
- SOODED AREA
- PLANTING BED
- ENGINEERED WOOD FIBRE SAFETY SURFACE
- PROPERTY LINE
- 1.8M HT WOOD SCREEN FENCE
- 1.2M HT CHAIN LINK FENCE
- CONTOUR LINE
- DECIDUOUS TREE
- CONIFEROUS TREE
- CONIFEROUS SHRUB
- DETAIL CALLOUT
- PLANT KEY
- NUMBER PLANTS
- PLANT SPECIES, REFER TO PLANT LIST
- SCOPE OF WORK LINE

ARCHITECTURE 49

1345 ROSEMOUNT AVENUE
OTTAWA, ONTARIO, CANADA, K1J 3E9
TEL: 613-933-8044 FAX: 613-933-8035 WWW.ARCHITECTURE49.COM

CONSULTANT - SUBCONSULTANT:

CONSULTANT - SUBCONSULTANT:

CONSULTANT - SUBCONSULTANT:

CONSULTANT - SUBCONSULTANT:

CONSULTANT - SUBCONSULTANT:

ASSOCIATION OF LANDSCAPE ARCHITECTS OF ONTARIO

CLIENT:

Conseil des écoles publiques de l'Est de l'Ontario

CLIENT REF # -

PROJECT:

**ÉCOLE ÉLÉMENTAIRE
KANATA - STITTSVILLE**

KEY PLAN:

COPYRIGHT:

COPYRIGHT IN THIS ELECTRONIC DOCUMENT BELONGS TO ARCHITECTURE 49. THIS ELECTRONIC DOCUMENT IS NOT BE REPRODUCED, STORED, TRANSMITTED OR OTHERWISE USED IN ANY MANNER WITHOUT THE WRITTEN PERMISSION OF ARCHITECTURE 49. ANY UNAUTHORIZED USE OF THIS ELECTRONIC DOCUMENT WITHOUT THE EXPRESS WRITTEN PERMISSION OF ARCHITECTURE 49 IS PROHIBITED.

DISCLAIMER:

THE CONTRACTOR SHALL CHECK AND VERIFY ALL DIMENSIONS AND UTILITY LOCATIONS AND REPORT ALL DISCREPANCIES AND CONCERNS PRIOR TO COMMENCING WORK. THE CONTRACTOR IS NOT TO BE SOLELY RESPONSIBLE FOR ANY ERRORS OR OMISSIONS.

ISSUED FOR REVIEW:

REV.	DATE	DESCRIPTION
11	9 DEC 2022	UPDATED FOR CITY COMMENTS
10	28 NOV 2022	ISSUED FOR SITE PLAN CONTROL
9	28 SEP 2022	ISSUED FOR CONSTRUCTION
8	02 SEP 2022	UPDATED PER CITY COMMENTS
7	30 JUN 2022	ISSUED FOR ADDENDUM 2
6	21 MAR 2022	ISSUED FOR BID AND PERMIT
5	14 JAN 2022	50% CD REVIEW
4	19 NOV 2021	85% CD REVIEW
3	24 SEP 2021	60% CD REVIEW
2	27 AUG 2021	REVISED FOR 50% CD REVIEW
1	04 AUG 2021	30% CD REVIEW

PROJECT NO: 219-0001-040

ISSUE DATE: MARCH 2022

ORIGINAL SCALE: AS NOTED

DESIGNED BY: JAH

DRAWN BY: MK / SG

CHECKED BY: JAH

DISCIPLINE: LANDSCAPE

TITLE: MATERIALS PLAN

SHEET NUMBER: L101

SHEET # OF #

DATE: 01/03/2022

DATE OF: 0

1 MATERIALS PLAN

L101 1:300

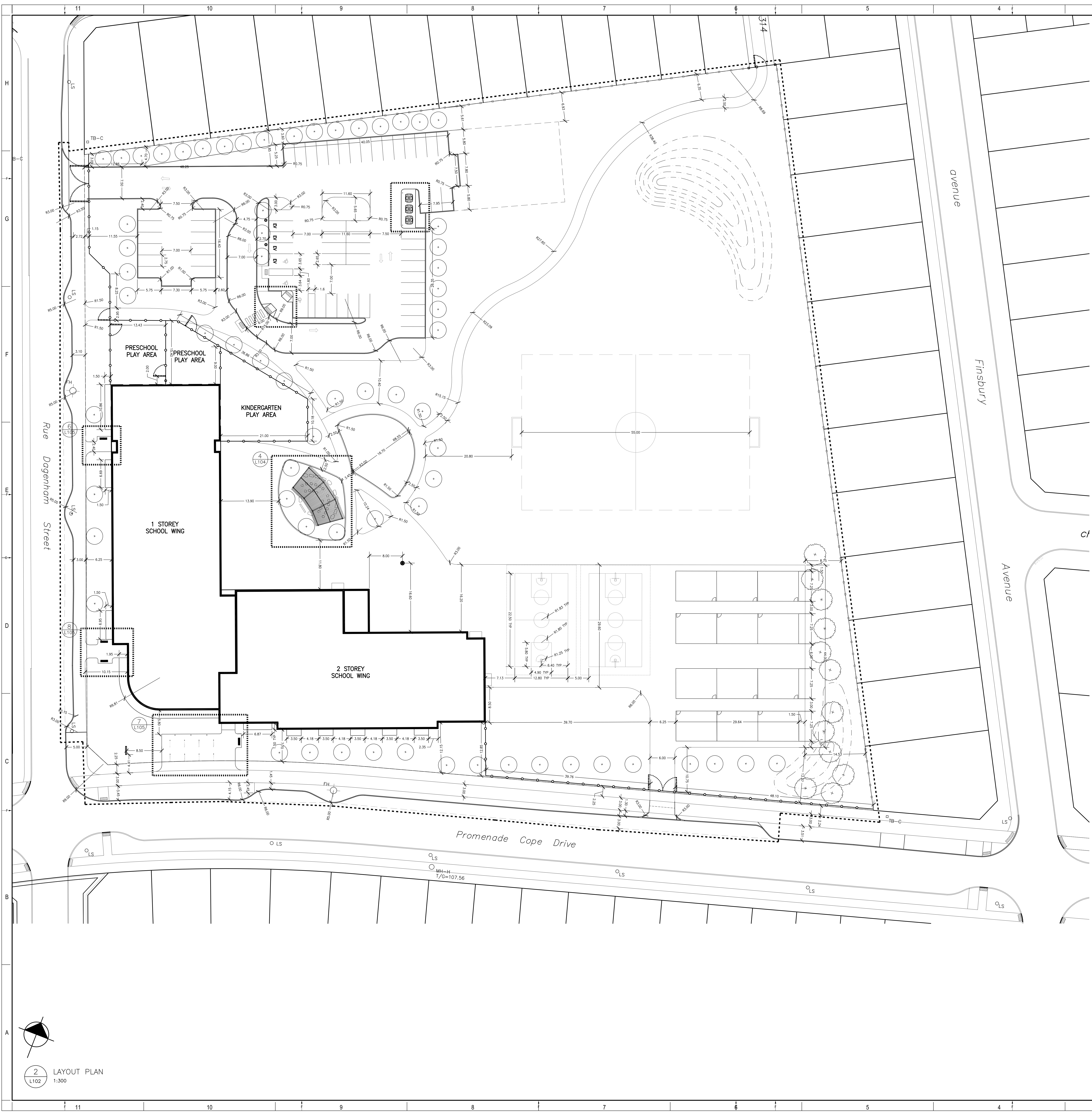

LAYOUT NOTES:

- CONTRACTOR TO CONFIRM ALL DIMENSIONS AND REPORT ANY DISCREPANCIES TO CONTRACTOR ADMINISTRATOR PRIOR TO CONSTRUCTION.
- LAYOUT TO BE APPROVED BY CONTRACT ADMINISTRATOR PRIOR TO ANY CONSTRUCTION OR REMOVALS.
- ALL DIMENSIONS ARE IN METRIC UNLESS OTHERWISE NOTED.
- CONTRACTOR IS RESPONSIBLE FOR ALL EXCAVATIONS, REMOVALS, DISPOSALS AND ROUGH GRADING AS REQUIRED TO CONSTRUCT ALL WORKS AS SHOWN ON ALL PLANS, DETAILS AND SPECIFICATIONS.
- LOCATION OF ALL UTILITIES SHOWN FOR ILLUSTRATION ONLY. CONTRACTOR MUST CONTACT ALL UTILITIES REGARDING RULES FOR WORKING IN THE AREA OF THE UTILITIES PRIOR TO COMMENCEMENT OF ANY WORK. CONTRACTOR MUST CONFIRM LOCATION OF ALL UTILITIES PRIOR TO CONSTRUCTION.
- ALL EXISTING ROADS, SIDEWALKS, CURBS, FENCING, PAVING, SLOPED RIGHT-OF-WAY AND APPROACHES, ETC. TO REMAIN TO BE PROTECTED DURING CONSTRUCTION TO THE CITY OF OTTAWA STANDARDS AT THE CONTRACTOR'S OWN COSTS.
- ALL EXISTING TREES, SHRUB BEDS, MULCH BEDS, AND SOIL TO REMAIN TO BE PROTECTED DURING CONSTRUCTION TO CITY OF OTTAWA STANDARDS DURING CONSTRUCTION TO BE REPAIRED TO CITY OF OTTAWA STANDARDS AT THE CONTRACTOR'S OWN COST.
- CONTRACTOR TO LAYOUT PARKING AREAS TO ACHIEVE REQUIRED NUMBER OF SPACES IN EACH ROW. SPACES ARE 2000mm WIDE BY 5000mm DEEP (UNLESS OTHERWISE NOTED). CONTRACTOR TO REPORT ANY DISCREPANCIES TO CONTRACT ADMINISTRATOR PRIOR TO CONSTRUCTION.
- PARKING LOT ROWS TO BE Laid OUT PARALLEL TO BUILDING FACE. CONTRACTOR TO STAKE OUT PARKING ROWS AND ISLANDS FOR REVIEW AND APPROVAL BY PROJECT LANDSCAPE ARCHITECT PRIOR TO EXCAVATION.
- USE SPECIFIED BACKFILL IN ALL TRENCHES RUNNING BELOW ALL STRUCTURES, PAVING, WALKWAYS, ETC.
- REFER TO PLANTING PLAN L103 FOR LAYOUT OF ALL SHRUB BEDS AND TREES.
- ALL PRINTED DIMENSION MARKINGS AND SIGNS SHOWN WITHIN LIMIT OF WORK & AS NOTED ON PLANS, TO BE INCLUDED IN WORK UNDER THIS CONTRACT.

LEGEND:

- PROPERTY LINE
- 1.5M HT WOOD SCREEN FENCE
- 1.2M HT CHAIN LINK FENCE
- CONTOUR LINE
- DECEADUOUS TREE
- CONIFEROUS TREE
- CONIFEROUS SHRUB
- PERENNIAL SHRUB
- DETAIL CALLOUT

1345 ROSEMOUNT AVENUE
OTTAWA, ONTARIO, CANADA, K0J 3E3
TEL: 613-933-9044 FAX: 613-938-0025 WWW.ARCHITECTURE49.COM

CONSULTANT - SUBCONSULTANT:
CONSULTANT - SUBCONSULTANT:
CONSULTANT - SUBCONSULTANT:
CONSULTANT - SUBCONSULTANT:
CONSULTANT - SUBCONSULTANT:
CONSULTANT - SUBCONSULTANT:



CLIENT REF # -
PROJECT:
**ÉCOLE ÉLÉMENTAIRE
KANATA - STITTSVILLE**

KEY PLAN:
DATE:
SCALE:

COPYRIGHT:
THIS ELECTRONIC DOCUMENT BELONGS TO ARCHITECTURE 49. THIS ELECTRONIC DOCUMENT IS NOT BE LOANED, REPRODUCED, COPIED, OR REPRODUCED IN ANY MANNER WITHOUT THE WRITTEN PERMISSION OF ARCHITECTURE 49.

DISCLAIMER:
THE CONTRACTOR SHALL CHECK AND VERIFY ALL DIMENSIONS AND UTILITIES LOCATION AND REPORT ALL DISCREPANCIES AND CORRECTIONS PRIOR TO COMMENCING WORK. THE DIMENSIONS NOT TO BE SCALE.

ISSUED FOR -	REVISION
10	9 DEC 2022 UPDATED FOR CITY COMMENTS
9	28 NOV 2022 REISSUED FOR SITE PLAN CONTROL
8	26 SEP 2022 ISSUED FOR CONSTRUCTION
7	02 SEP 2022 UPDATED PER CITY COMMENTS
6	21 MAR 2022 ISSUED FOR BID AND PERMIT
5	14 JAN 2022 99% CD REVIEW
4	19 NOV 2021 85% CD REVIEW
3	24 SEP 2021 80% CD REVIEW
2	27 AUG 2021 REISSUED FOR 30% CD REVIEW
1	04 AUG 2021 30% CD REVIEW

REV.	DATE	DESCRIPTION
1	04 AUG 2021	30% CD REVIEW
2	27 AUG 2021	REISSUED FOR 30% CD REVIEW
3	24 SEP 2021	80% CD REVIEW
4	19 NOV 2021	85% CD REVIEW
5	14 JAN 2022	99% CD REVIEW
6	21 MAR 2022	ISSUED FOR BID AND PERMIT
7	02 SEP 2022	UPDATED PER CITY COMMENTS
8	26 SEP 2022	ISSUED FOR CONSTRUCTION
9	28 NOV 2022	REISSUED FOR SITE PLAN CONTROL
10	9 DEC 2022	UPDATED FOR CITY COMMENTS

2 LAYOUT PLAN
L102 1:300

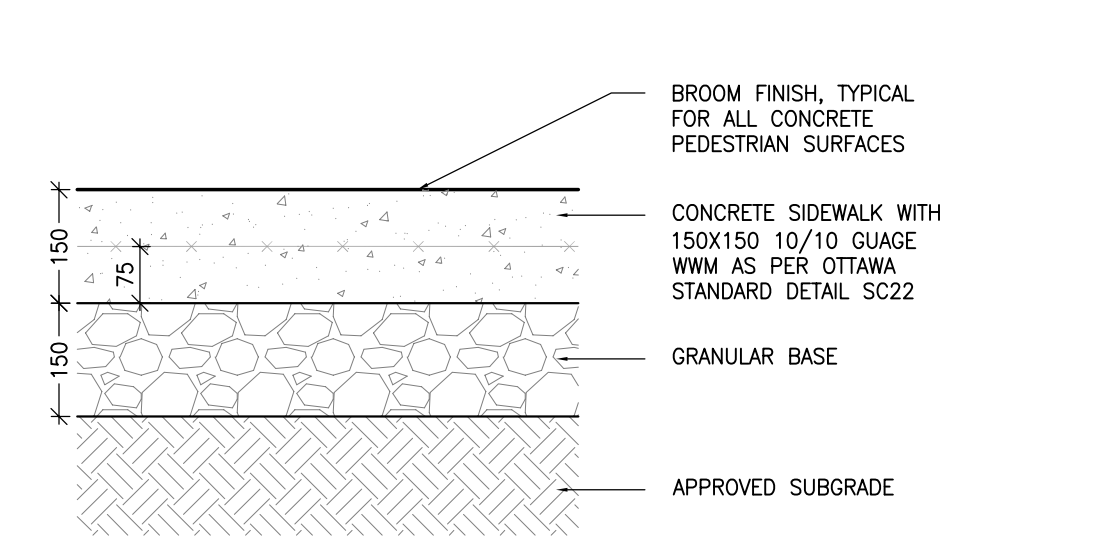

10 TYP CONCRETE SIDEWALK
1:01 L200 1:10

NOTES:
1. PROVIDE EXPANSION JOINTS EVERY 6M AND AT EVERY LOCATION A CONCRETE SIDEWALK ABUTS A RIGID SURFACE (E.G. CONCRETE CURB, WALL, ASPHALT PAVING) THE BITUMINOUS EXPANSION JOINT TO BE THE WIDTH OF THE CONCRETE SIDEWALK AND HAVE A JOINT SEALANT AT THE SURFACE.
2. PROVIDE CONTROL JOINTS EVERY 1.5m. CONTROL JOINT TO BE A SAW CUT JOINT AT A DEPTH OF 12mm.
3. PROVIDE CONSTRUCTION JOINTS AS NECESSARY. CONSTRUCTION JOINT TO HAVE A BITUMINOUS FILLER AND SEALANT AT THE SURFACE. JOIN BOTH SLABS WITH A SMOOTH, CRASSED ROOF EXTENDING 75mm IN EACH SIDE.

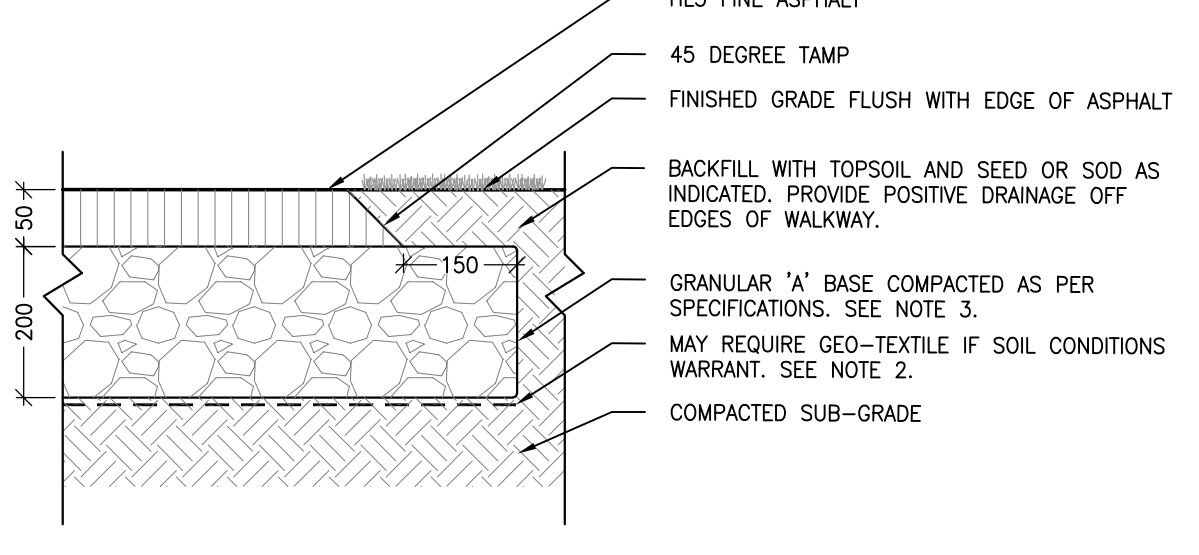

11 TYP ASPHALT SIDEWALK
1:01 L200 1:10

NOTES:
1. CROSS SLOPE SIDEWALK 1 TO 2% IN DIRECTION OF NATURAL DRAINAGE TO PROVIDE POSITIVE DRAINAGE OFF ALL WALKS.
2. APPROVED NON-WOVEN CLASS 1 GEOTEXTILE AS PER 60-2115 WHEN WARRANTED BY SOIL CONDITION, SUBJECT TO APPROVAL BY THE CONTRACT ADMINISTRATOR.
3. GRANULAR 'A' SHALL MEET THE REQUIREMENTS OF OPSS 1010

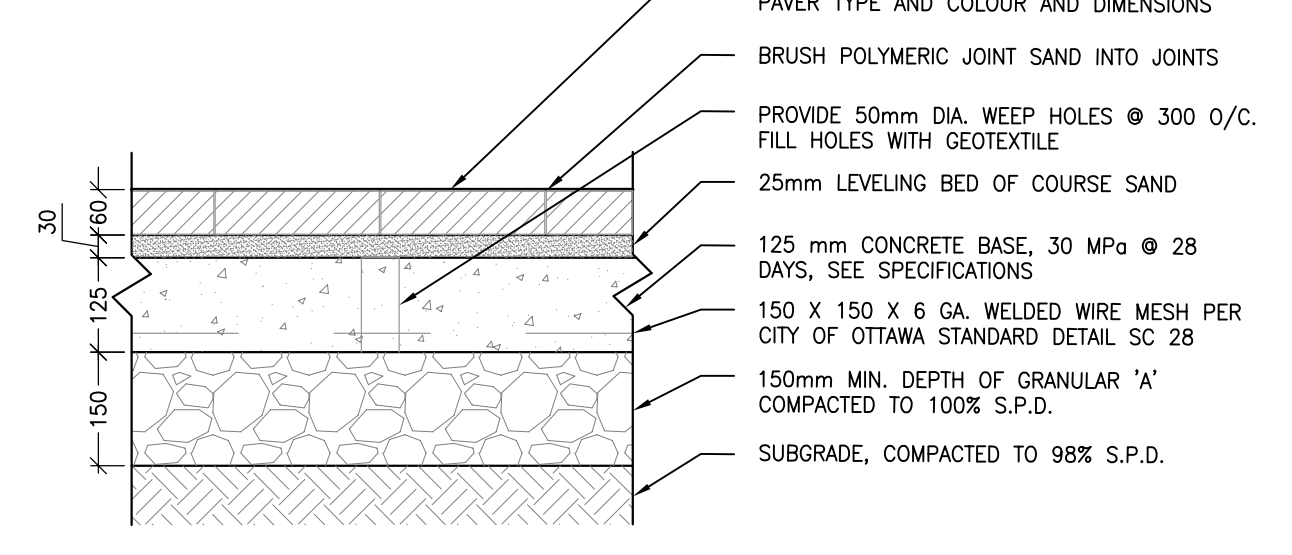

12 TYP UNIT PAVER ON CONCRETE BASE
1:01 L200 1:10

NOTES:
1. ALL MEASUREMENTS ARE IN MILLIMETERS UNLESS OTHERWISE NOTED.
2. PAVERS SHALL BE INSTALLED IN STRICT ACCORDANCE WITH THE MANUFACTURER'S RECOMMENDATIONS WITH JOINT BUTT JOINTS OF APPROXIMATELY 2mm. ON A SAND BASE, SAW CUT PAVERS ARE REQUIRED. USE AN APPROVED VIBRATORY COMPACTOR IN A CIRCULAR PATTERN. SPRINKLE SAND OVER AREA TO PREVENT CHIPPING. FOR HEAVY VIBRATORY COMPACTOR, BRUSH SAND INTO JOINTS AND SPRINKLE WITH WATER UNTIL JOINTS ARE FILLED.
3. ALL DAMAGED OR CHIPPED PAVERS MUST BE REPLACED AT THE CONTRACTOR'S COST.
4. REFER TO SPECIFICATIONS FOR EDGE RESTRAINTS. EDGE RESTRAINTS MUST BE APPROVED BY LANDSCAPE ARCHITECT PRIOR TO COMMENCING WORK. INSTALL WHERE LAY PAVERS. IF ANY SOFT SURFACE, EXCAVATE AND REPAIR ALL TOPSOIL AND UNSTABLE MATERIALS OFF THE SUBGRADE TO BE COMBED TO SIMILAR CONDITIONS AS FINISHED GRADE. COMPACT SUBGRADE TO 95% S.P.D. PLACE 150mm LAYER OF GRANULAR 'A' COMPACTED TO 100% S.P.D.

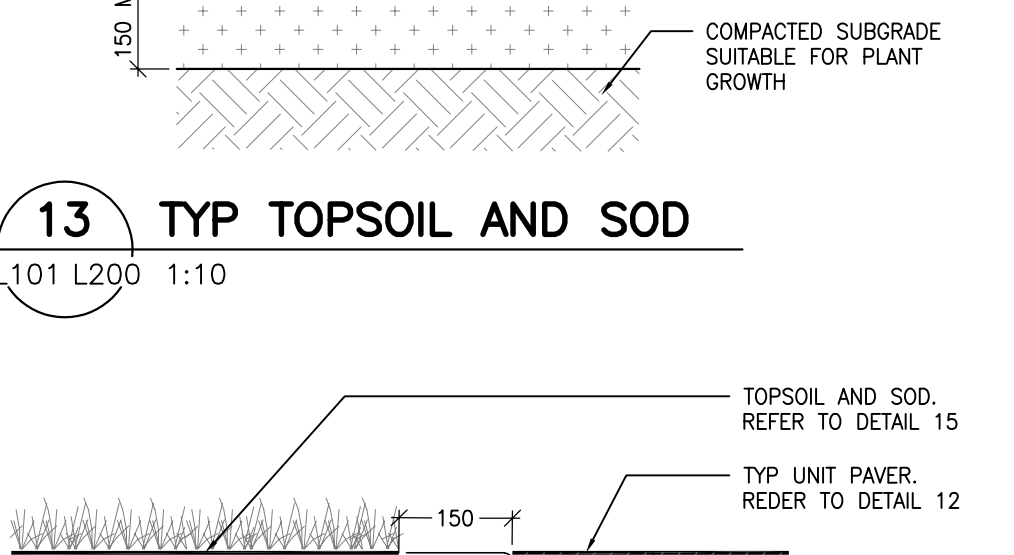

13 TYP TOPSOIL AND SOD
1:01 L200 1:10

NOTES:
1. TOPSOIL AND SOD, REFER TO DETAIL 15.
2. TYP UNIT PAVER, REFER TO DETAIL 12.

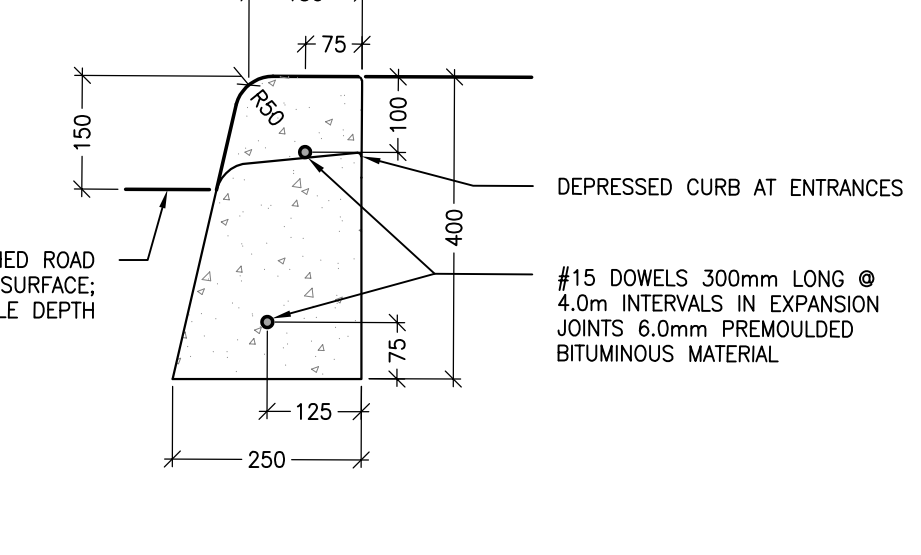

14 TYP UNIT PAVER EDGE RESTRAINT
1:05 L200 1:10

NOTES:
1. THE FULL CURB DEPTH SHALL BE CARRIER THROUGH THE DEPRESSED ACCESS CROSSING.
2. A CONCRETE SUPPORT IS REQUIRED WHEN BUILT ADJACENT TO THE SIDEWALK.
3. IF AN EXTRUSION CURBING MACHINE IS USED, THE EXPANSION BITUMINOUS MATERIAL AND THE #15 CONCRETE ARE TO BE PLACED AT THE END OF THE EXTRUSION.
4. DUMPT JOINTS SHALL BE 25mm DEEP, FRONT, BACK AND TOP OF SECTION AT 2m SPACING.
5. FOR DEPRESSED CURB AT ENTRANCES USE 250mm HEIGHT.
6. DEPRESSED CURB HEIGHT - FOR PROTECTION CURB RAMP: 0 TO 6mm AND FOR PRIVATE ENTRANCES 0 TO 25mm.

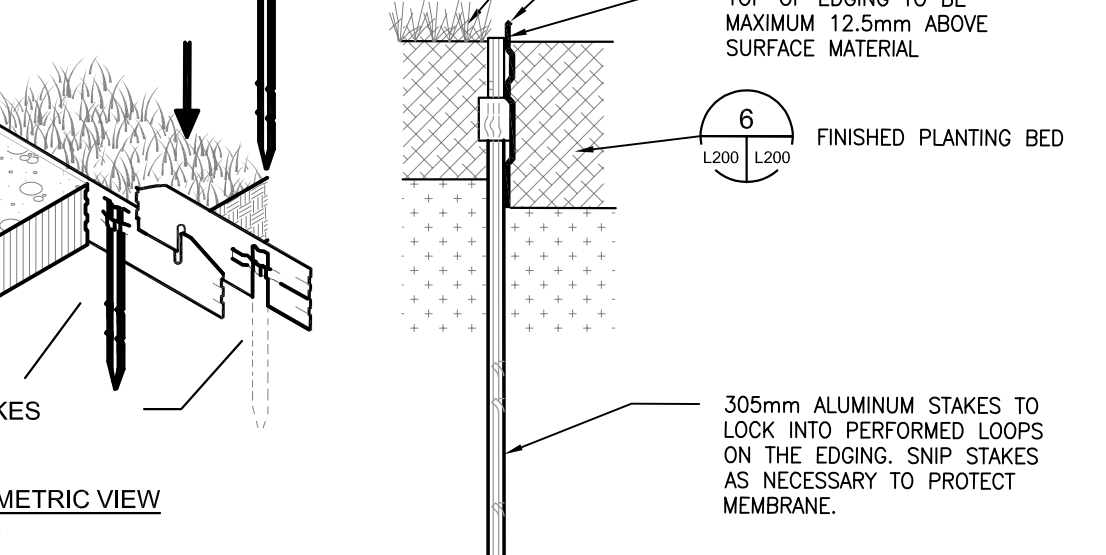

15 CONCRETE BARRIER CURB
1:01 L200 1:10

NOTES:
1. INSTALL AS PER MANUFACTURER'S GUIDELINES.
2. 2.5m SECTIONS TO INCLUDE (3) ALUMINUM STAKES; 4.75m SECTIONS TO INCLUDE (5) ALUMINUM STAKES.
3. FOR CORNERS, CUT BACK EDGING U/WALKWAY AND FORM A CONTIGUOUS CORNER.

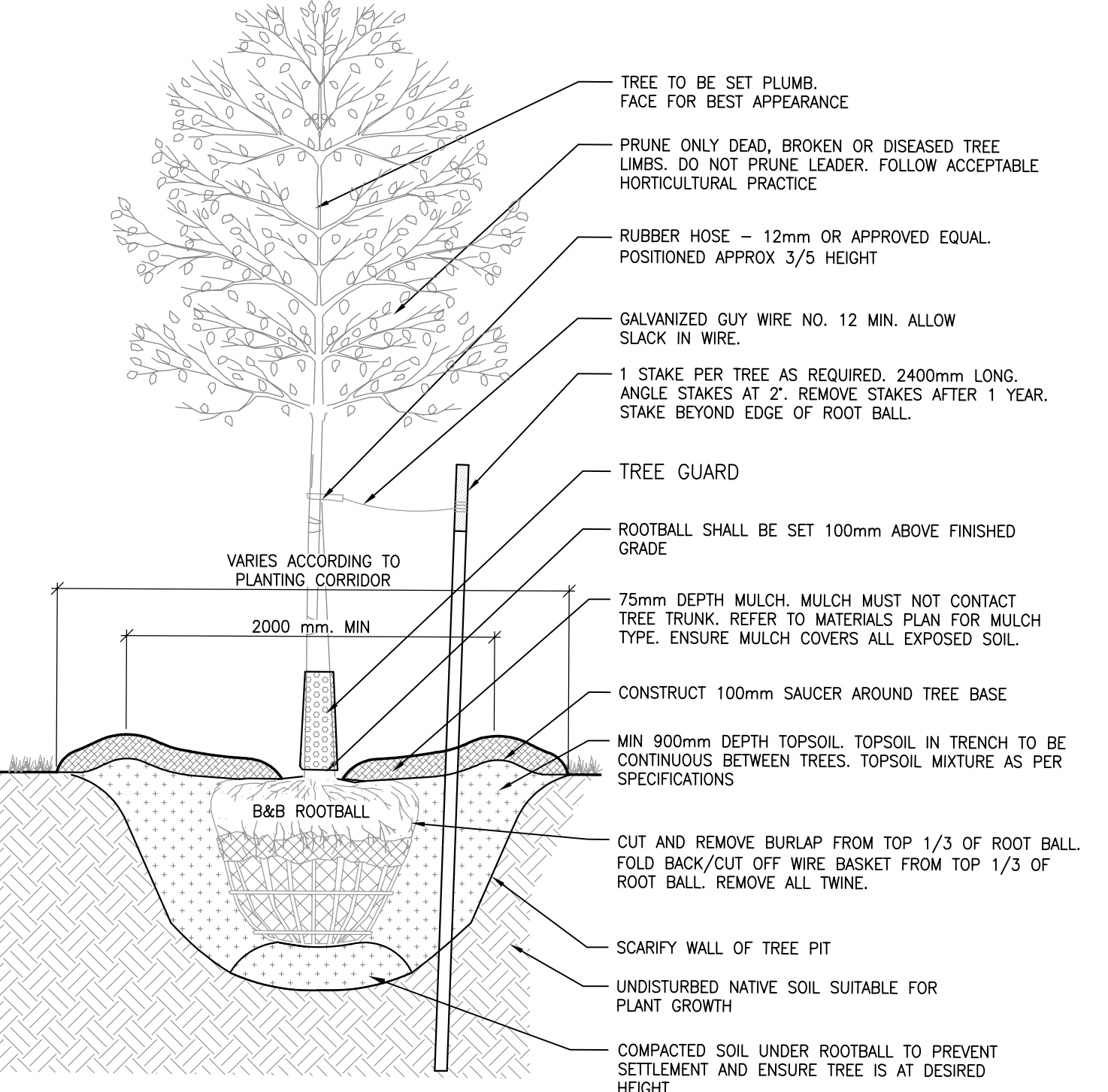

16 ALUMINUM PLANTER EDGING
1:01 L200 1:10

NOTES:
1. IF MINIMUM UTILITY SETBACKS PERMIT, POSITION TREE STAKES INTO DIRECTION OF PREVAILING WINDS.
2. ALL TREE STAKES TO MAINTAIN MINIMUM 1.0m CLEARANCE FROM ALL U/G POWER, TELEPHONE AND GAS ALIGNMENTS.
3. DIG ALL ROOT HOLES BY HAND WHEN CLOSER THAN 1.0m TO U/G POWER, TELEPHONE AND GAS ALIGNMENTS.

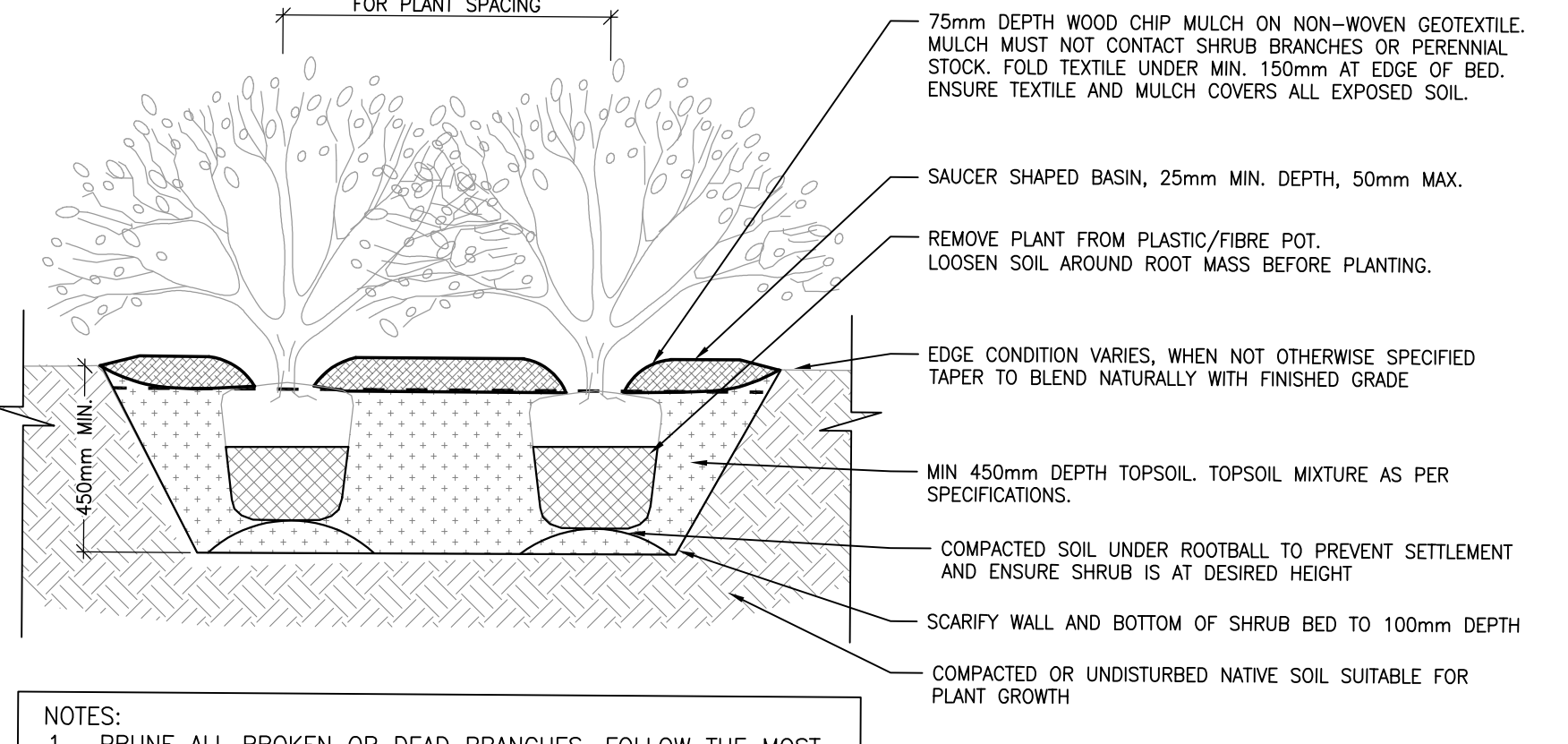

17 TYP TREE PLANTING DETAIL
1:01 L200 1:20

NOTES:
1. PRUNE ALL BROKEN OR DEAD BRANCHES. FOLLOW THE MOST RECENT CANADIAN NURSARY & TRADES ASSOCIATION PRACTICE.
2. PLANT PIT SHALL BE DIG TWICE DIAMETER OF THE ROOT BALL.
3. SCARIFY COMPACTED SUBGRADE TO 150mm DEPTH.
4. FACE PLANTS FOR BEST APPEARANCE.
5. STAGGER PLANTING SUCH THAT ALL PLANTS ARE EQUALLY SPACED FROM EACH OTHER AS SPECIFIED IN PLANT LIST.
6. PLANTING BED TO BE CONTIGUOUS 900mm DEPTH WHEN PLANTED WITH TREES.

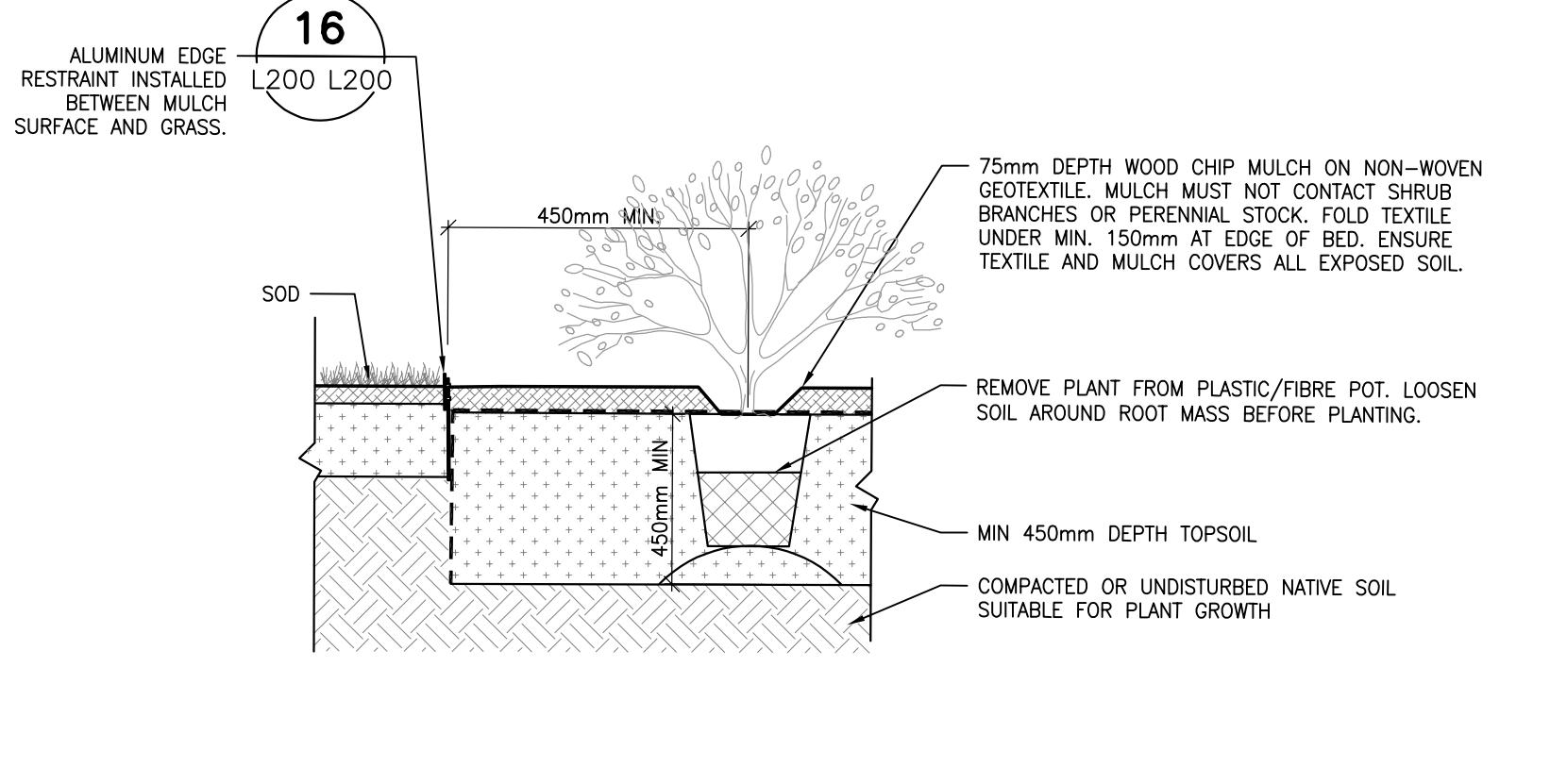

18 TYP SHRUB PLANTING DETAIL
1:01 L200 1:20

NOTES:
1. ALL SPECIFICATIONS FROM DETAIL 2/1200 APPLY. IN CASE OF CONFLICT, 2/1200 SHOULD BE TAKEN AS CORRECT.
2. PLANT PIT SHALL BE DIG TWICE DIAMETER OF THE ROOT BALL.
3. PLANT BED TO BE CONTIGUOUS MIN 900mm DEPTH WHEN PLANTED WITH TREES. REFER TO DETAIL 1 TYP TREE PLANTING.
4. SCARIFY SUBGRADE TO 150mm DEPTH.

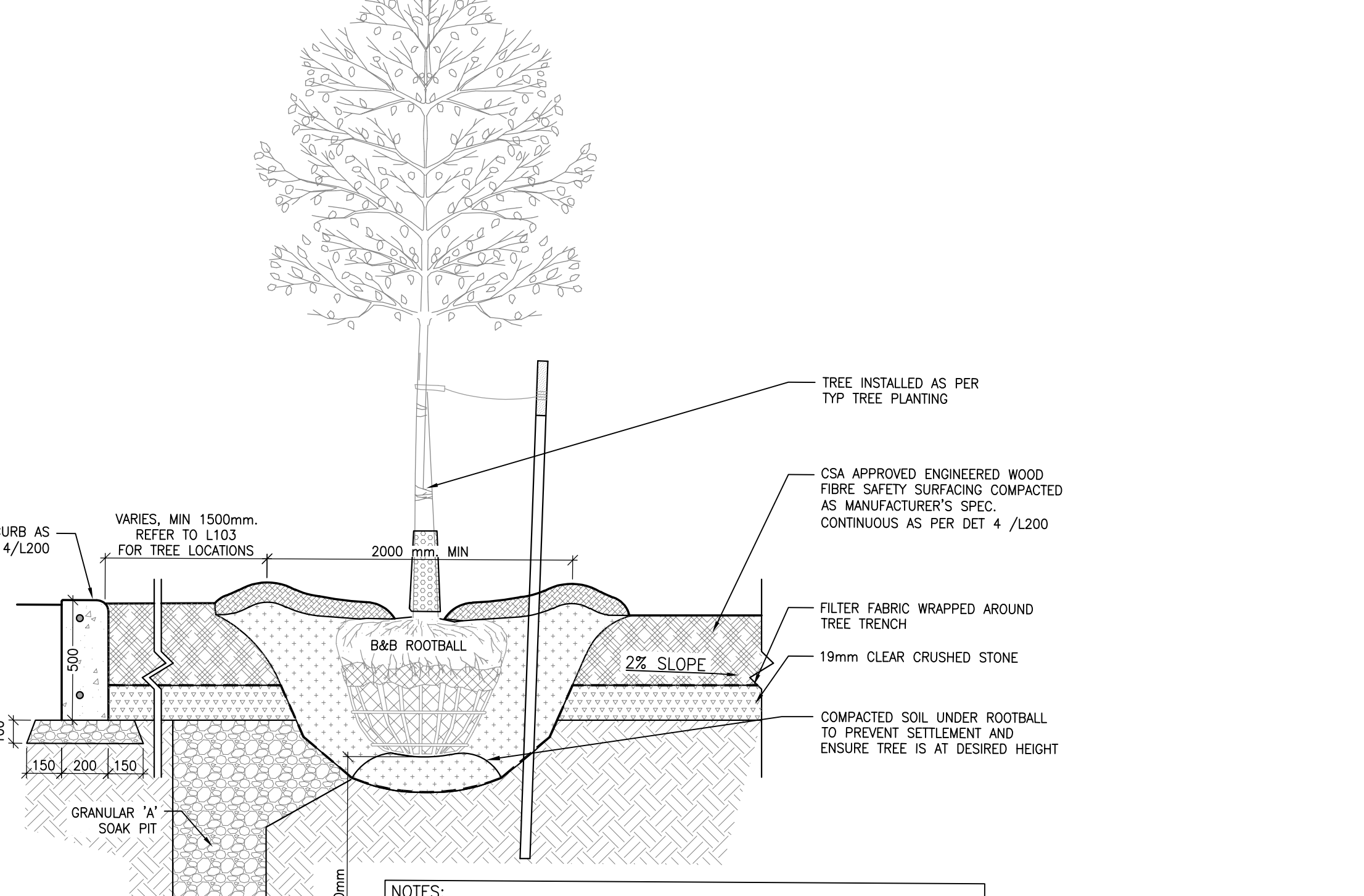

19 PLANTING BED AND ALUMINUM EDGE DETAIL
1:04 L200 1:20

NOTES:
1. INSTALL TREE AS PER DET 6/1200 TYP TREE PLANTING.
2. IF MINIMUM UTILITY SETBACKS PERMIT, POSITION TREE STAKES INTO DIRECTION OF PREVAILING WINDS.
3. ALL TREE STAKES TO MAINTAIN MINIMUM 1.0m CLEARANCE FROM ALL U/G POWER, TELEPHONE AND GAS ALIGNMENTS.
4. DIG ALL ROOT HOLES BY HAND WHEN CLOSER THAN 1.0m TO U/G POWER, TELEPHONE AND GAS ALIGNMENTS.
5. GRANULAR 'A' SHALL MEET REQUIREMENTS OF OPSS 1010

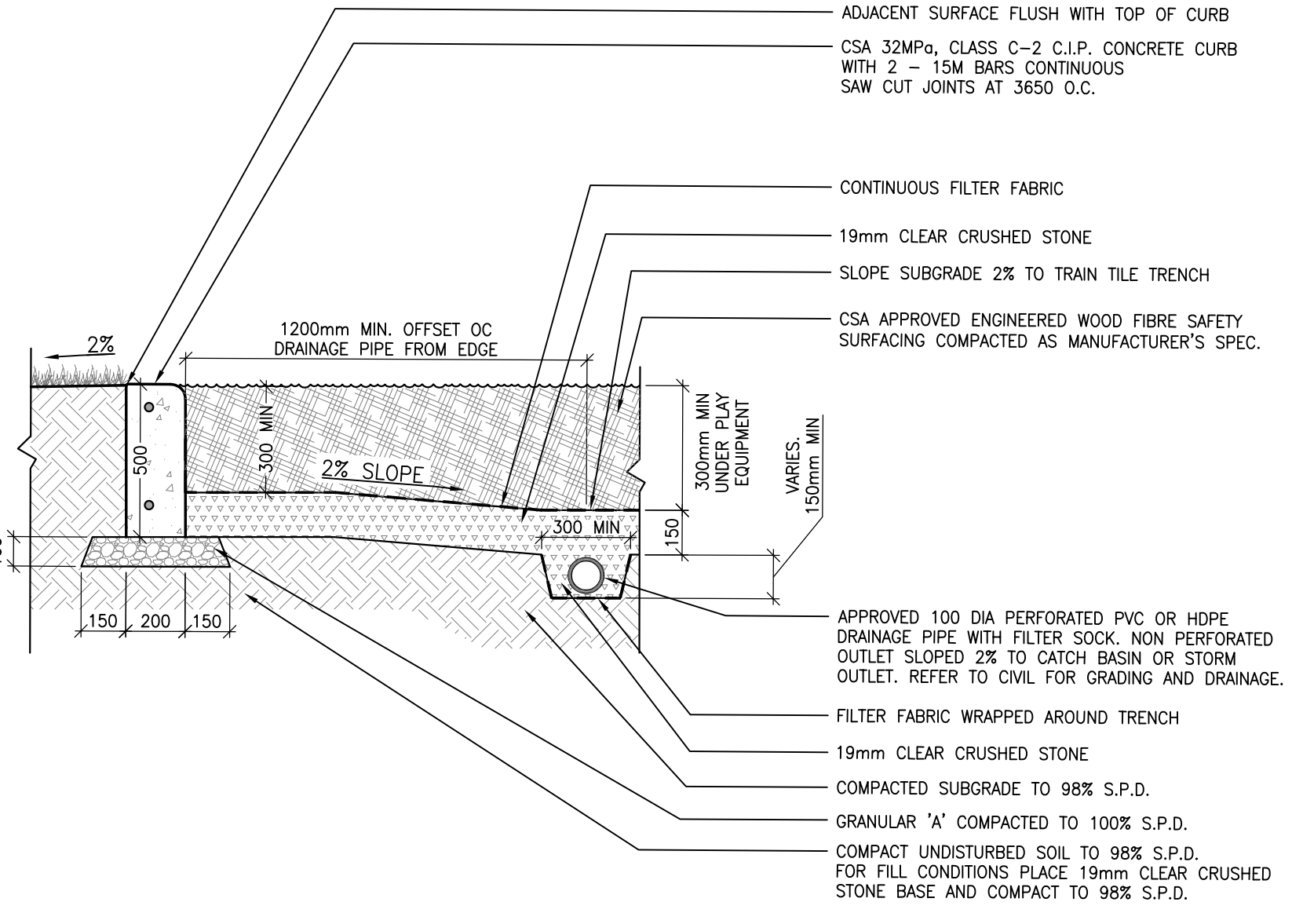

20 TREE PLANTING WITHIN PLAY AREA
1:01 L200 1:20

NOTES:
1. PLAY AREA SURFACE DEPTH AS PER CSA REQUIREMENTS.
2. 100 DIA RIGID PVC OR HDPE PIPE CONNECTION FROM PLAYGROUND CURB TO CATCH BASIN. REFER TO CIVIL FOR CATCH BASIN LOCATIONS.
3. FILTER FABRIC SHALL BE APPROVED NON-WOVEN CLASS 1 GEOTEXTILE.
4. 19mm CLEAR STONE SHALL MEET THE REQUIREMENTS OF OPSS 1044.
5. ENGINEERED WOOD FIBRE TO COMPLY WITH ASTM 1292, ASTM 2075, ASTM 1951.
6. GRANULAR 'A' SHALL MEET THE REQUIREMENTS OF OPSS 1010.

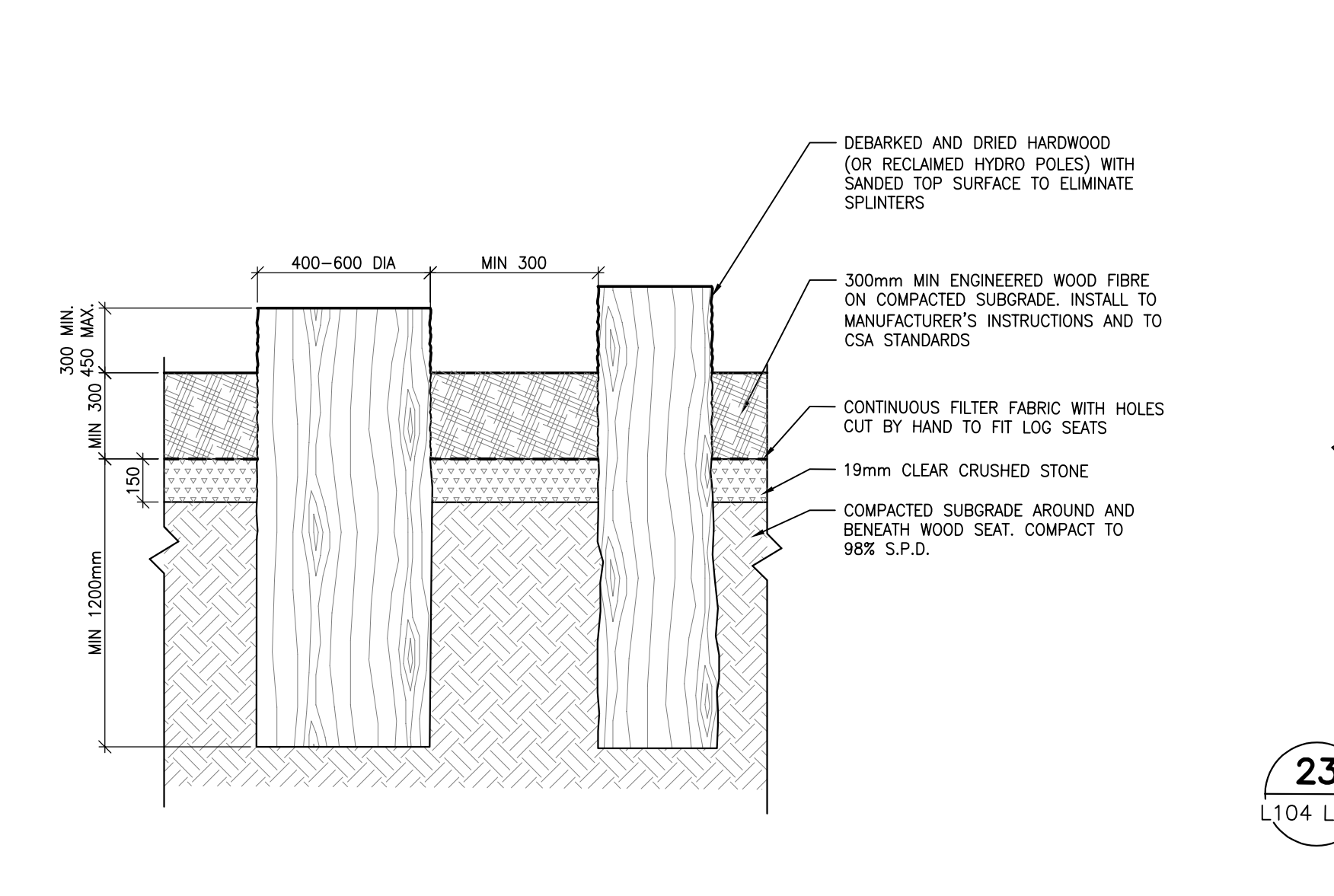

21 LANDSCAPE CURB DETAIL
1:04 L200 1:20

NOTES:
1. PLAY AREA SURFACE DEPTH AS PER CSA REQUIREMENTS.
2. 100 DIA RIGID PVC OR HDPE PIPE CONNECTION FROM PLAYGROUND CURB TO CATCH BASIN. REFER TO CIVIL FOR CATCH BASIN LOCATIONS.
3. FILTER FABRIC SHALL BE APPROVED NON-WOVEN CLASS 1 GEOTEXTILE.
4. 19mm CLEAR STONE SHALL MEET THE REQUIREMENTS OF OPSS 1044.
5. ENGINEERED WOOD FIBRE TO COMPLY WITH ASTM 1292, ASTM 2075, ASTM 1951.
6. GRANULAR 'A' SHALL MEET THE REQUIREMENTS OF OPSS 1010.

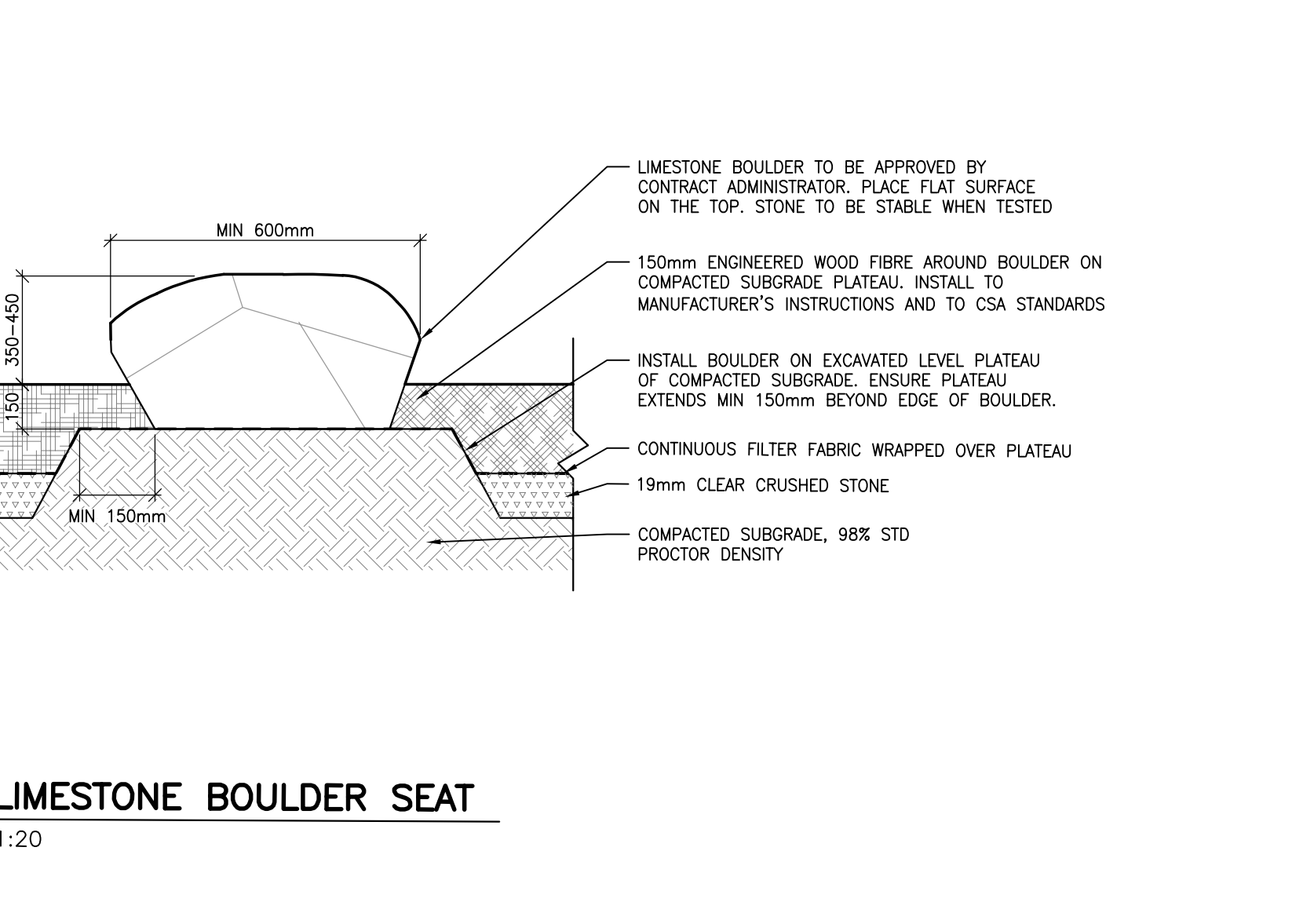

22 LOG STUMP SEAT
1:04 L200 1:20

NOTES:
1. ALL SPECIFICATIONS FROM DETAIL 2/1200 APPLY. IN CASE OF CONFLICT, 2/1200 SHOULD BE TAKEN AS CORRECT.
2. PLANT PIT SHALL BE DIG TWICE DIAMETER OF THE ROOT BALL.
3. PLANT BED TO BE CONTIGUOUS MIN 900mm DEPTH WHEN PLANTED WITH TREES. REFER TO DETAIL 1 TYP TREE PLANTING.
4. SCARIFY SUBGRADE TO 150mm DEPTH.

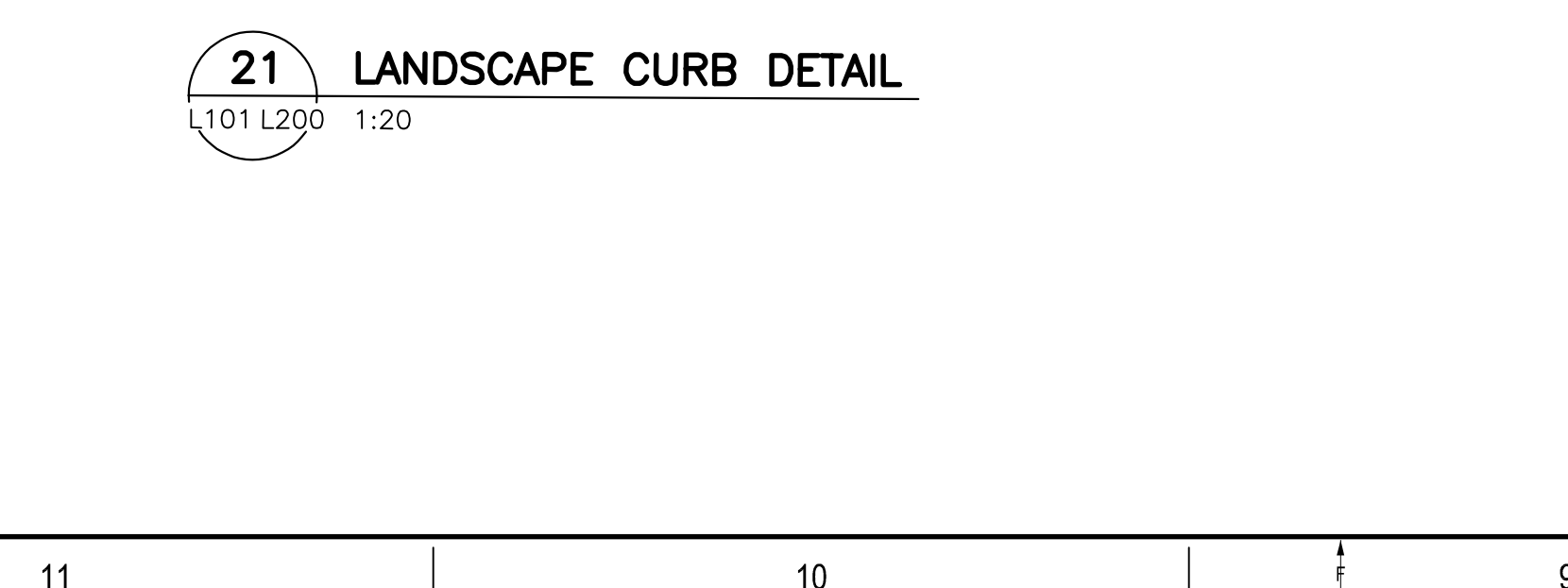

23 LIMESTONE BOULDER SEAT
1:04 L200 1:20

NOTES:
1. PLAY AREA SURFACE DEPTH AS PER CSA REQUIREMENTS.
2. 100 DIA RIGID PVC OR HDPE PIPE CONNECTION FROM PLAYGROUND CURB TO CATCH BASIN. REFER TO CIVIL FOR CATCH BASIN LOCATIONS.
3. FILTER FABRIC SHALL BE APPROVED NON-WOVEN CLASS 1 GEOTEXTILE.
4. 19mm CLEAR STONE SHALL MEET THE REQUIREMENTS OF OPSS 1044.
5. ENGINEERED WOOD FIBRE TO COMPLY WITH ASTM 1292, ASTM 2075, ASTM 1951.
6. GRANULAR 'A' SHALL MEET THE REQUIREMENTS OF OPSS 1010.



Conseil des écoles publiques de l'Est de l'Ontario

CENTRE ÉDUCATIF DE KANATA-STITTSVILLE
755 PROMENADE COPE, K2S 1S3

CONTRACTOR: THIS ELECTRONIC DOCUMENT BELONGS TO ARCHITECTURE 49. THIS ELECTRONIC DOCUMENT IS NOT TO BE REPRODUCED, COPIED, TRANSMITTED, OR OTHERWISE USED IN ANY MANNER WITHOUT THE EXPRESS WRITTEN PERMISSION OF ARCHITECTURE 49.

DISCLAIMER: THE CONTRACTOR SHALL CHECK AND VERIFY ALL DIMENSIONS AND UTILITY LOCATIONS AND REPORT ALL DISCREPANCIES AND CONCURRENCES PRIOR TO COMMENCING WORK. THE DIMENSIONS NOT TO SCALE.

ISSUED FOR REVIEW

NO.	DATE	DESCRIPTION
1	04 AUG 2021	30% CD REVIEW
2	27 AUG 2021	REV. ISSUED FOR 50% CD REVIEW
3	24 SEP 2021	60% CD REVIEW
4	19 NOV 2021	85% CD REVIEW
5	14 JAN 2022	99% CD REVIEW
6	21 MAR 2022	ISSUED FOR BID AND PERMIT
7	26 SEP 2022	ISSUED FOR CONSTRUCTION

NO.	DATE	DESCRIPTION
1	04 AUG 2021	30% CD REVIEW
2	27 AUG 2021	REV. ISSUED FOR 50% CD REVIEW
3	24 SEP 2021	60% CD REVIEW
4	19 NOV 2021	85% CD REVIEW
5	14 JAN 2022	99% CD REVIEW
6	21 MAR 2022	ISSUED FOR BID AND PERMIT
7	26 SEP 2022	ISSUED FOR CONSTRUCTION

PROJECT NO: 219-0001-H-01
DATE: MARCH 2022
ORIGINAL SCALE: AS NOTED
DESIGNED BY: MK
DRAWN BY: MK
CHECKED BY: MK
DATE: 0

TITLE: LANDSCAPE
SUBTITLE: LANDSCAPE DETAILS
SHEET NUMBER: L200
SHEET: 0 OF 0
DATE: 0

