

LEGEND:

- UNDISTURBED NATIVE SOIL
- GROWTH MEDIUM
- MULCH
- SOD
- CONCRETE
- FREE DRAINING STONE AGGREGATE

LAYOUT NOTES:

1. CONTRACTOR TO CONFIRM ALL DIMENSIONS AND REPORT ANY DISCREPANCIES TO CONTRACTOR ADMINISTRATOR PRIOR TO CONSTRUCTION
2. LAYOUT TO BE APPROVED BY CONTRACT ADMINISTRATOR PRIOR TO ANY CONSTRUCTION OR REMOVALS
3. ALL DIMENSIONS ARE IN METRIC UNLESS OTHERWISE NOTED
4. CONTRACTOR IS RESPONSIBLE FOR ALL EXCAVATIONS, REMOVALS, DISPOSALS AND ROUGH GRADING AS REQUIRED TO CONSTRUCTION ALL WORKS AS SHOWN ON ALL PLANS, DETAILS AND SPECIFICATIONS
5. LOCATION OF ALL UTILITIES SHOWN FOR ILLUSTRATION ONLY. CONTRACTOR MUST CONTACT ALL UTILITIES REGARDING RULES FOR WORKING IN THE AREA OF THE UTILITIES PRIOR TO COMMENCEMENT OF ANY WORK. CONTRACTOR MUST CONFIRM LOCATION OF ALL UTILITIES PRIOR TO CONSTRUCTION
6. ALL EXISTING ROADS, SIDEWALKS, CURBS, FENCING, PAVING, SODDED RIGHT-OF-WAY, AND APPROACHES, ETC. TO REMAIN TO BE PROTECTED DURING CONSTRUCTION TO THE CITY OF WINNIPEG STANDARDS AT THE CONTRACTORS OWN COSTS.
7. ALL EXISTING TREES, SHRUB BEDS, MULCH BEDS, AND SOD TO REMAIN TO BE PROTECTED DURING CONSTRUCTION TO CITY OF WINNIPEG STANDARDS. AREAS DAMAGED DURING CONSTRUCTION TO BE REPAIRED TO CITY OF WINNIPEG STANDARDS AT THE CONTRACTORS OWN COST.
8. CONTRACTOR TO LAYOUT PARKING AREAS TO ACHIEVE REQUIRED NUMBER OF STALLS IN EACH ROW. STALLS ARE 9' WIDE BY 18' DEEP (UNLESS OTHERWISE NOTED). CONTRACTOR TO REPORT ANY DISCREPANCIES TO CONTRACT ADMINISTRATOR PRIOR TO CONSTRUCTION.
9. PARKING LOT ROWS TO BE LAID OUT PARALLEL TO BUILDING FACE. CONTRACTOR TO STAKE OUT PARKING ROWS AND ISLANDS FOR REVIEW AND APPROVAL BY PROJECT LANDSCAPE ARCHITECT PRIOR TO EXCAVATION.
10. USE SPECIFIED BACKFILL IN ALL TRENCHES RUNNING BELOW ALL STRUCTURES, PAVING, WALKWAYS, ETC.
11. REFER TO PLANTING PLAN L3 FOR LAYOUT OF ALL SHRUB BEDS AND TREES.
12. ALL PAINTED PAVEMENT MARKING AND SIGNS SHOWN, WITHIN LIMIT OF WORK & AS NOTED ON PLANS, TO BE INCLUDED IN WORK UNDER THIS CONTRACT.

CONSULTANT - I/S CONSULTANT:	
CONSULTANT - S/S CONSULTANT:	
CLIENT REF. #	
PROJECT	ACCESS STORAGE LEGGET DRIVE
KEY PLAN	
DISCLAIMER	COPYRIGHT
THIS DRAWING AND DESIGN IS COPYRIGHT PROTECTED. WHEN SHOWN, IT SHALL NOT BE REPRODUCED OR COPIED WITHOUT THE WRITTEN PERMISSION OF ARCHITECTURE 49. THE CONTRACTOR SHALL CHECK AND VERIFY ALL DIMENSIONS AND UTILITY LOCATIONS AND REPORT ALL ERRORS AND OMISSIONS PRIOR TO COMMENCEMENT OF WORK.	
DESIGNED FOR: REVIEWER:	
ISSUE	
1	1
2	2
3	3
4	4
5	5
6	6
7	7
8	8
9	9
10	10
11	11
12	12
13	13
14	14
15	15
16	16
17	17
18	18
19	19
20	20
21	21
22	22
23	23
24	24
25	25
26	26
27	27
28	28
29	29
30	30
31	31
32	32
33	33
34	34
35	35
36	36
37	37
38	38
39	39
40	40
41	41
42	42
43	43
44	44
45	45
46	46
47	47
48	48
49	49
50	50
51	51
52	52
53	53
54	54
55	55
56	56
57	57
58	58
59	59
60	60
61	61
62	62
63	63
64	64
65	65
66	66
67	67
68	68
69	69
70	70
71	71
72	72
73	73
74	74
75	75
76	76
77	77
78	78
79	79
80	80
81	81
82	82
83	83
84	84
85	85
86	86
87	87
88	88
89	89
90	90
91	91
92	92
93	93
94	94
95	95
96	96
97	97
98	98
99	99
100	100

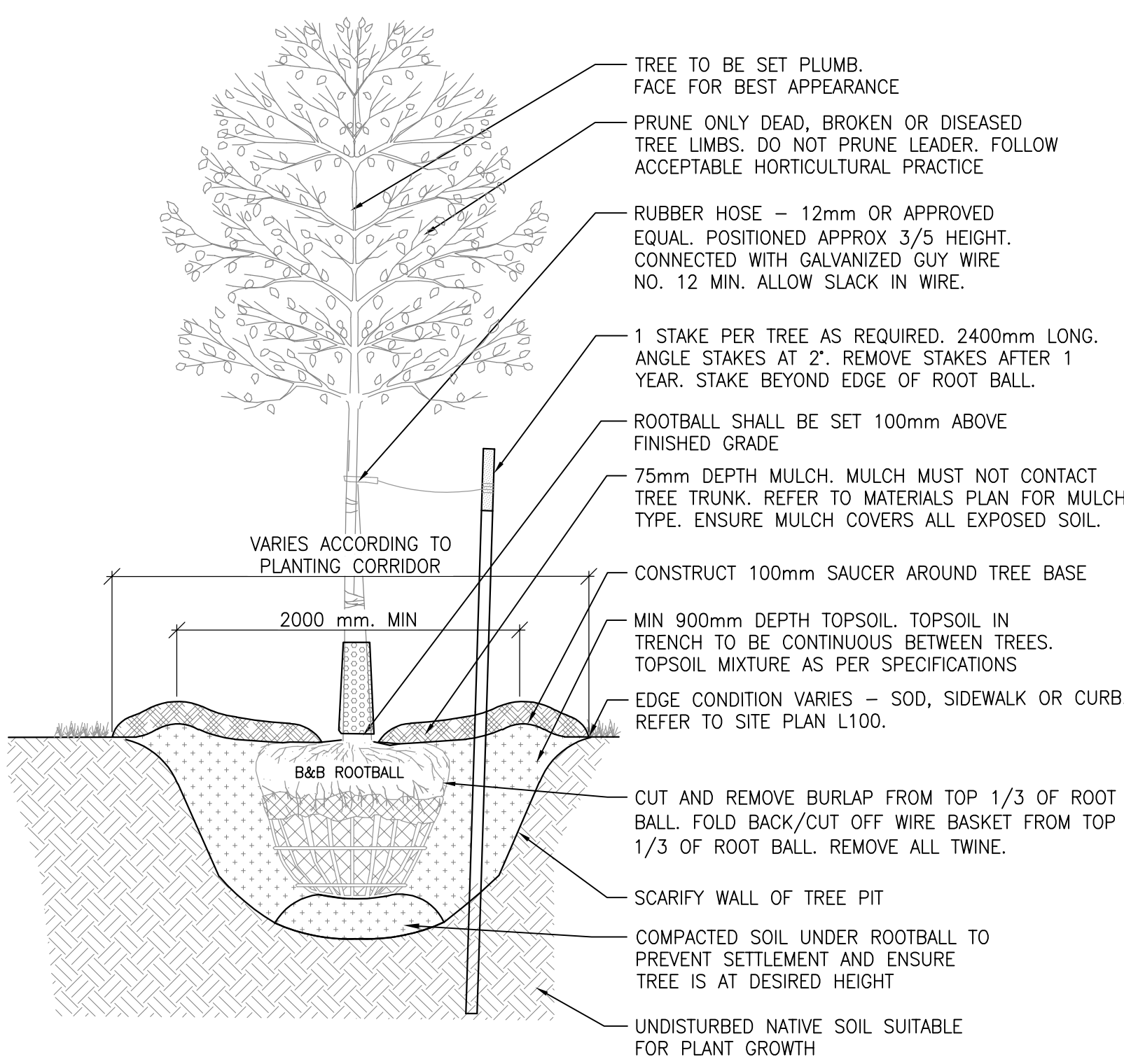

- NOTES:
1. IF MINIMUM UTILITY SETBACKS PERMIT, POSITION TREE STAKES INTO DIRECTION OF PREVAILING WINDS
 2. ALL TREE STAKES TO MAINTAIN MINIMUM 1.0m CLEARANCE FROM ALL U/G POWER, TELEPHONE AND GAS ALIGNMENTS
 3. DIG ALL ROOT HOLES BY HAND WHEN CLOSER THAN 1.0m TO U/G POWER, TELEPHONE AND GAS ALIGNMENTS

4 TYP DEC TREE PLANTING DETAIL
L100 L300 1:20

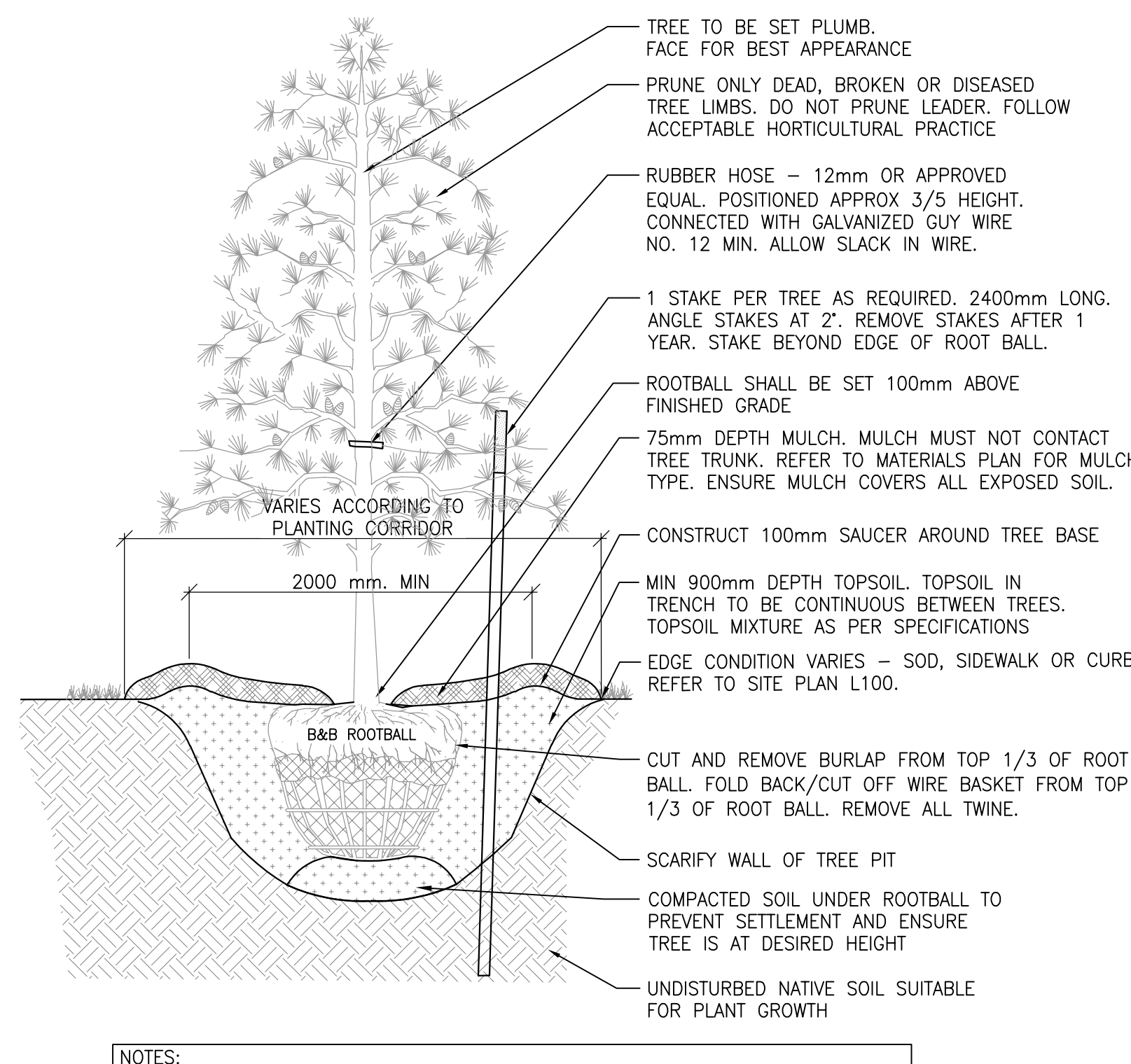

- NOTES:
1. IF MINIMUM UTILITY SETBACKS PERMIT, POSITION TREE STAKES INTO DIRECTION OF PREVAILING WINDS
 2. ALL TREE STAKES TO MAINTAIN MINIMUM 1.0m CLEARANCE FROM ALL U/G POWER, TELEPHONE AND GAS ALIGNMENTS
 3. DIG ALL ROOT HOLES BY HAND WHEN CLOSER THAN 1.0m TO U/G POWER, TELEPHONE AND GAS ALIGNMENTS

5 TYP CONIF TREE PLANTING DETAIL
L100 L300 1:20

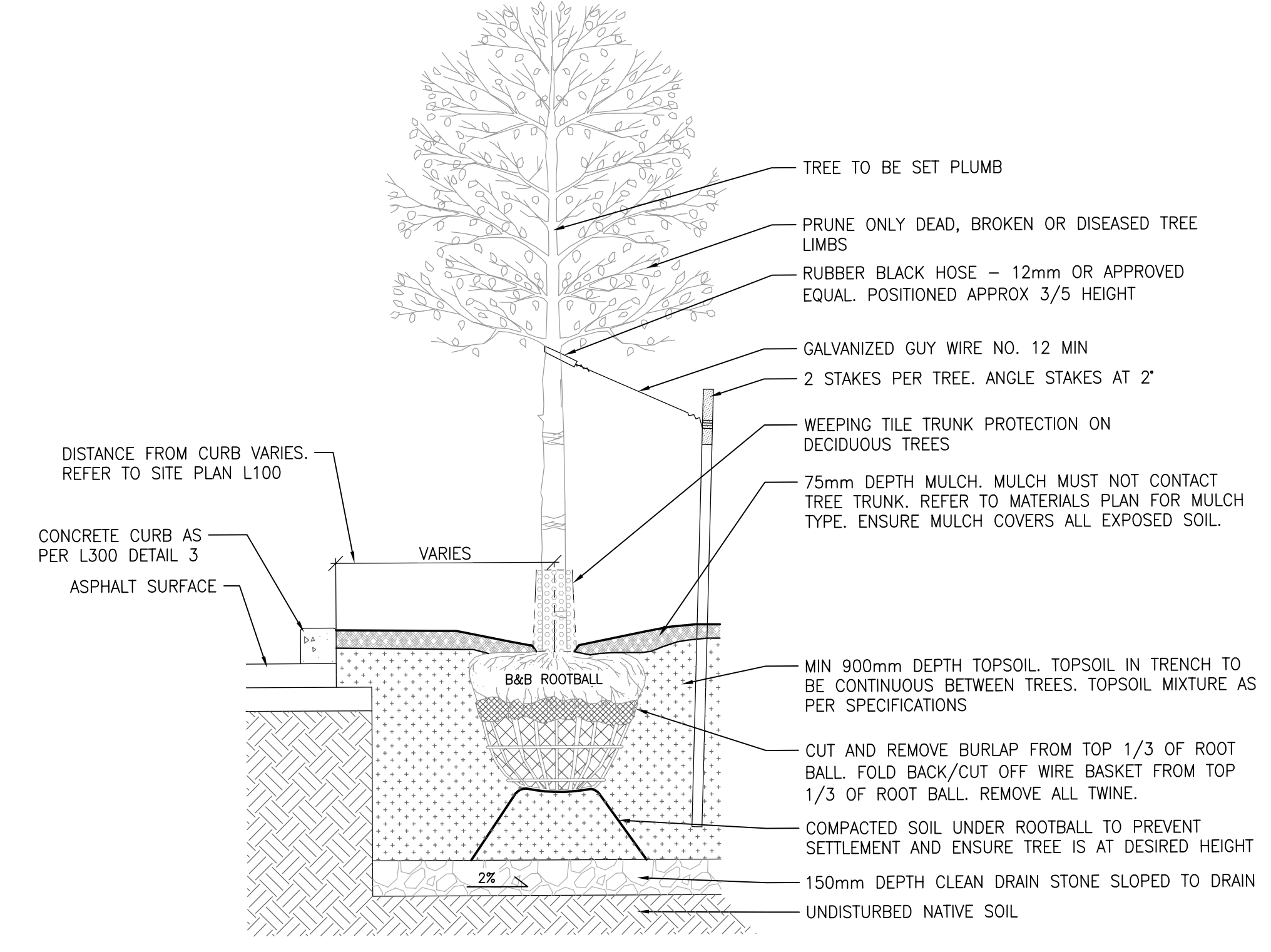

- NOTES:
1. IF MINIMUM UTILITY SETBACKS PERMIT, POSITION TREE STAKES INTO DIRECTION OF PREVAILING WINDS
 2. ALL TREE STAKES TO MAINTAIN MINIMUM 1.0m CLEARANCE FROM ALL U/G POWER, TELEPHONE AND GAS ALIGNMENTS
 3. DIG ALL ROOT HOLES BY HAND WHEN CLOSER THAN 1.0m TO U/G POWER, TELEPHONE AND GAS ALIGNMENTS

6 TYP TREE PLANTING IN PARKING ISLAND
L100 L300 1:20

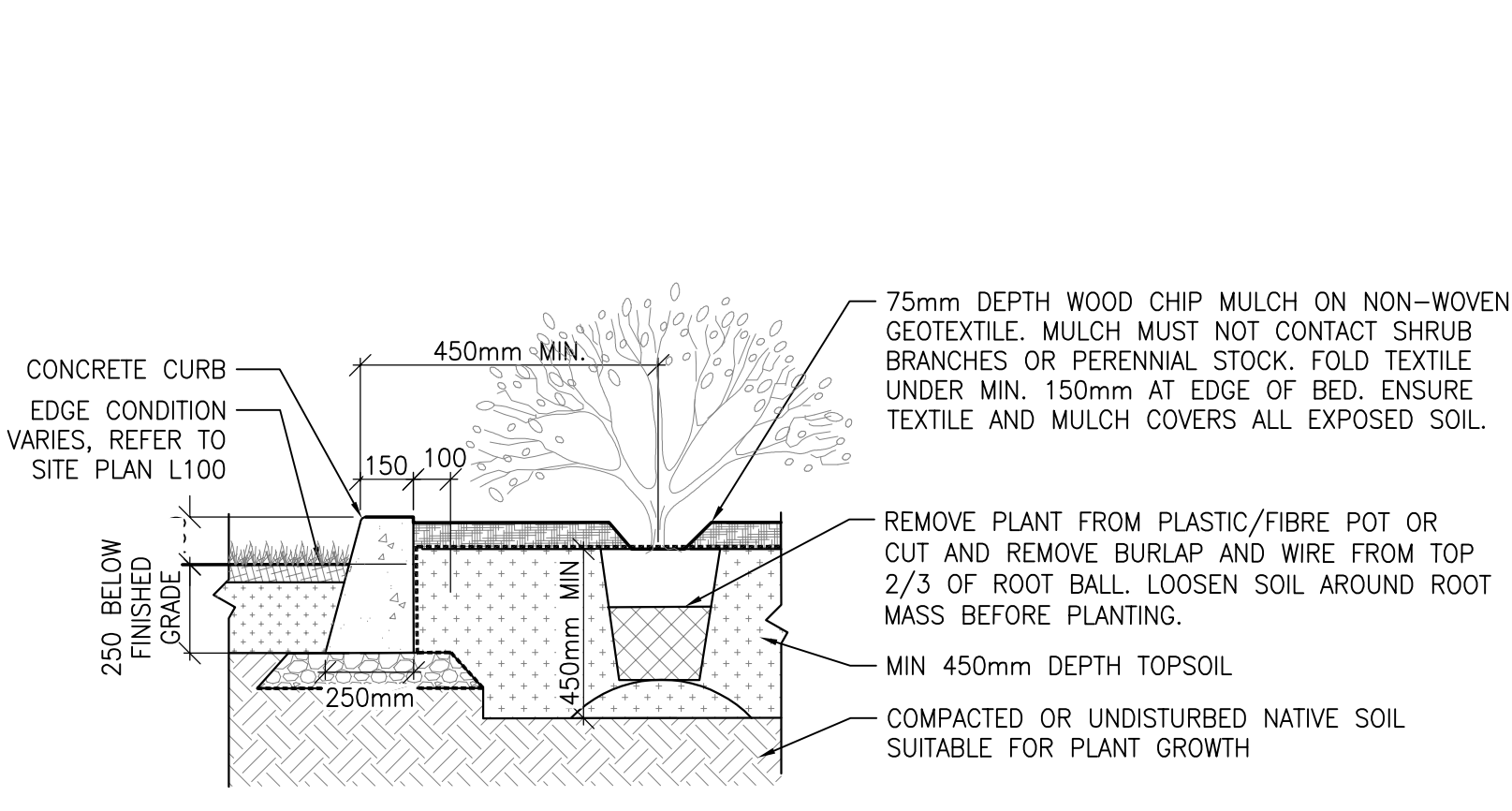

- NOTES:
1. ALL SPECIFICATIONS FROM DETAIL 2/L102 APPLY. IN CASE OF CONFLICT, 2/L102 SHOULD BE TAKEN AS CORRECT.
 2. PLANT PIT SHALL BE DUG TWICE DIAMETER OF THE ROOT BALL.
 3. PLANT BED TO BE CONTINUOUS MIN 900mm DEPTH WHEN PLANTED WITH TREES. REFER TO DETAIL 1 TYP TREE PLANTING
 4. SCARIFY SUBGRADE TO 150mm DEPTH.

7 PLANTING BED AND CONCRETE EDGE DETAIL
L100 L300 1:20

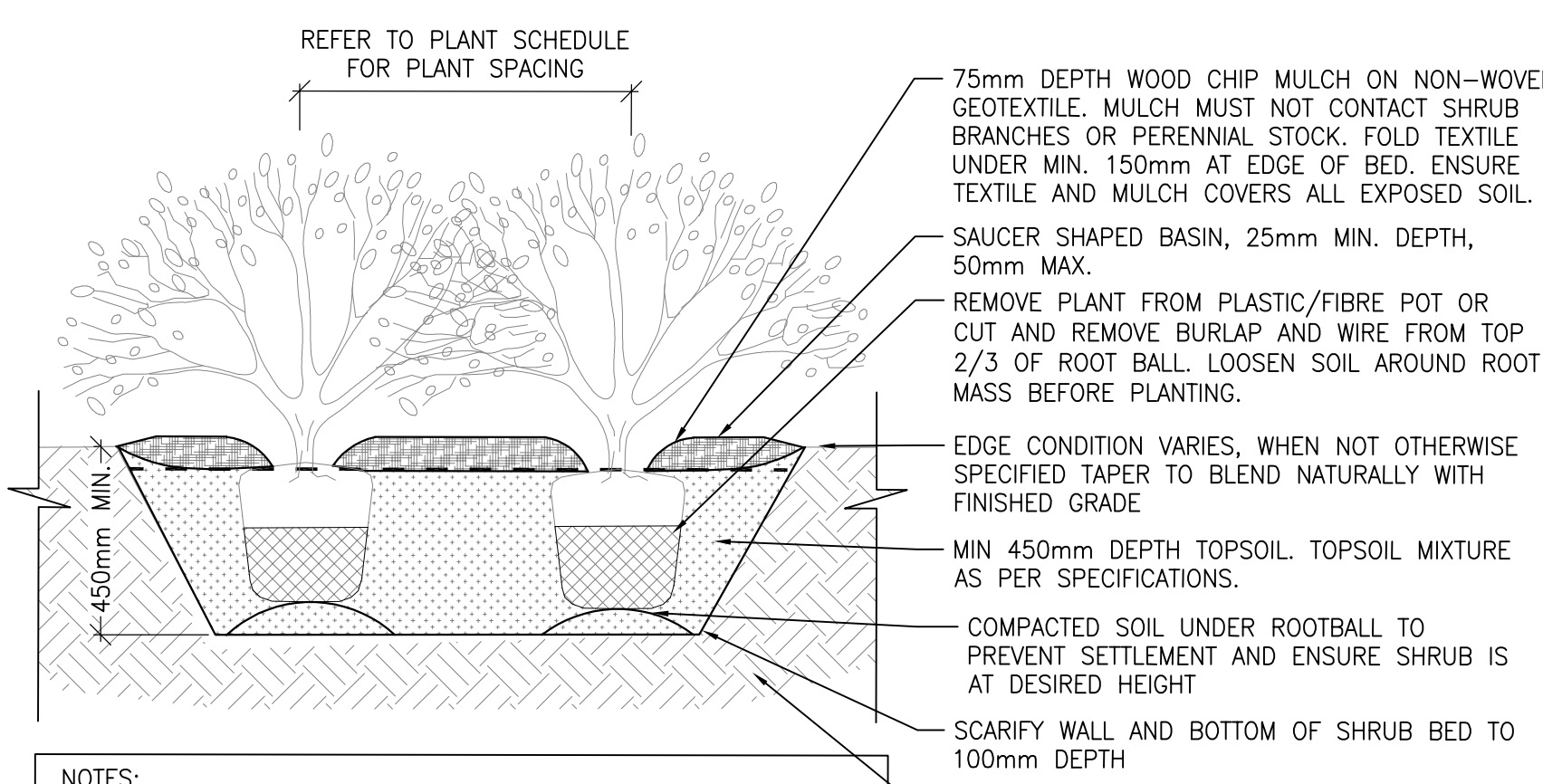

- NOTES:
1. PRUNE ALL BROKEN OR DEAD BRANCHES. FOLLOW THE MOST RECENT CANADIAN NURSERY & TRADES ASSOCIATION PRACTICE.
 2. PLANT PIT SHALL BE DUG TWICE DIAMETER OF THE ROOT BALL.
 3. SCARIFY COMPACTED SUBGRADE TO 150mm DEPTH.
 4. FACE PLANTS FOR BEST APPEARANCE.
 5. STAGGER PLANTING SUCH THAT ALL PLANTS ARE EQUALLY SPACED FROM EACH OTHER AS SPECIFIED IN PLANT LIST.
 6. PLANTING BED TO BE CONTINUOUS 900mm DEPTH WHEN PLANTED WITH TREES

8 TYP SHRUB PLANTING DETAIL
L101 L300 1:20

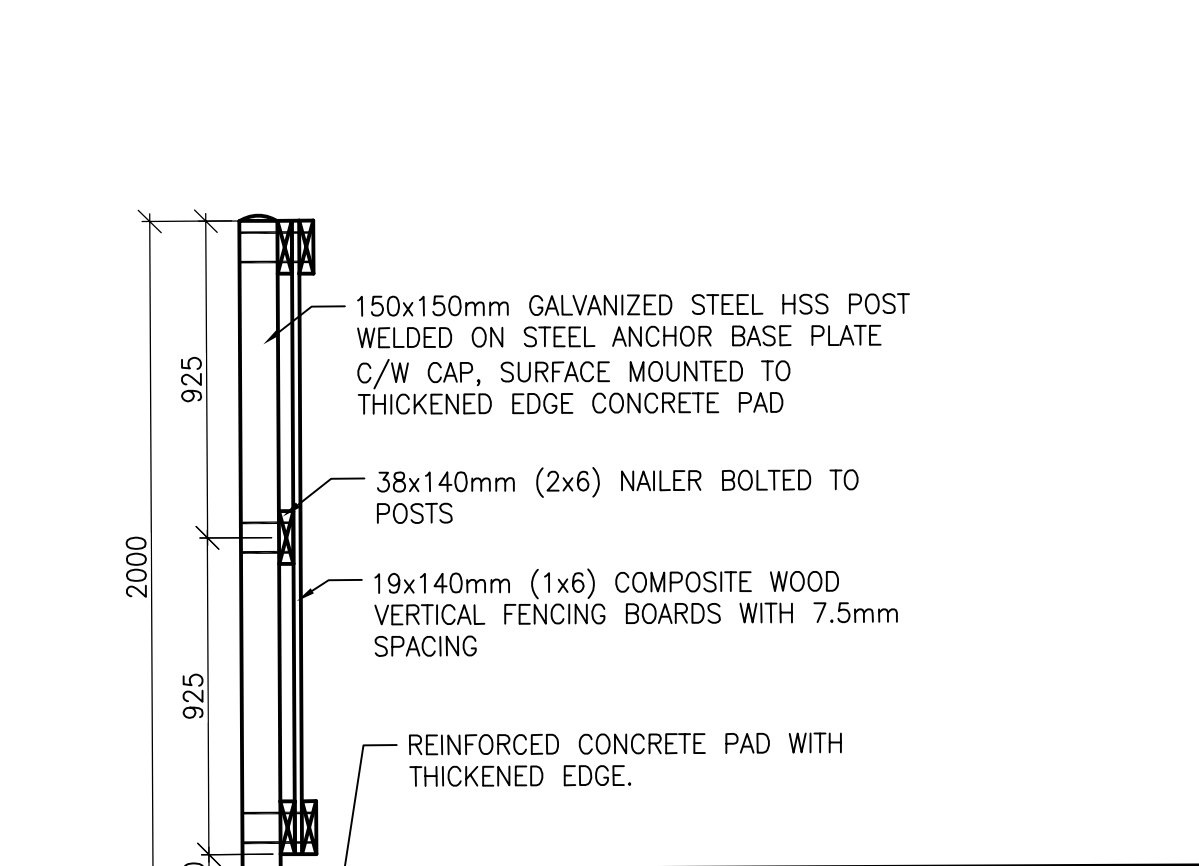

- NOTES:
1. ALL HARDWARE TO BE SUITABLE FOR COMPOSITE WOOD.
 2. WOOD FOR FENCES TO BE COMPOSITE WOOD BROWN COLOR.
 3. SHOP DRAWINGS FOR CONCRETE PAD TO BE REVIEWED AND APPROVED BY STRUCTURAL ENGINEER LICENSED TO PRACTICE IN THE PROVINCE OF ONTARIO

9 GARBAGE ENCLOSURE FENCE
L100 L300 1:20

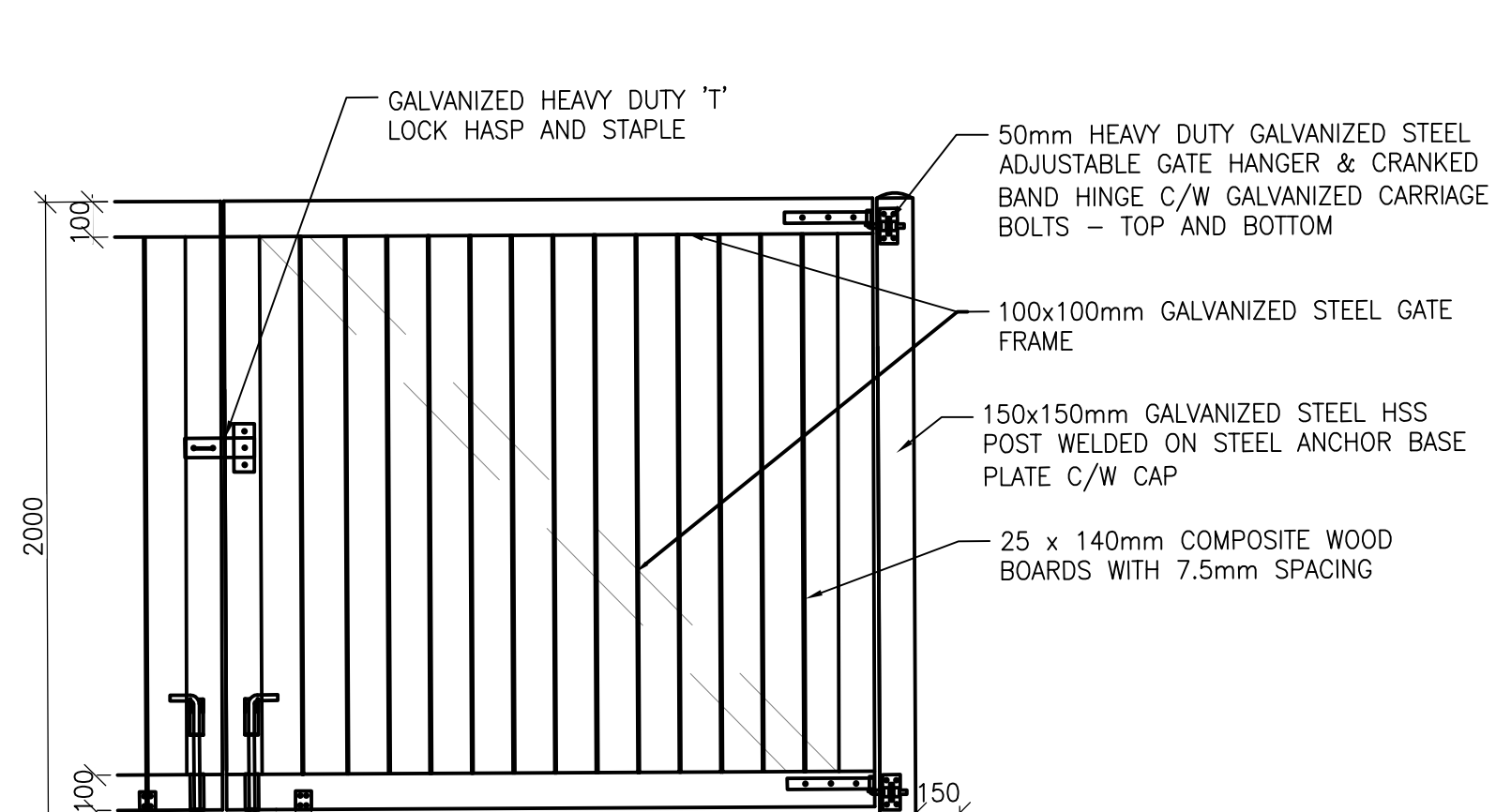

- NOTES:
1. ALL HARDWARE TO BE SUITABLE FOR COMPOSITE WOOD.
 2. WOOD FOR FENCES TO BE COMPOSITE WOOD BROWN COLOR.
 3. SHOP DRAWINGS FOR CONCRETE PAD TO BE REVIEWED AND APPROVED BY STRUCTURAL ENGINEER LICENSED TO PRACTICE IN THE PROVINCE OF ONTARIO

10 GARBAGE ENCLOSURE GATE
L100 L300 1:20

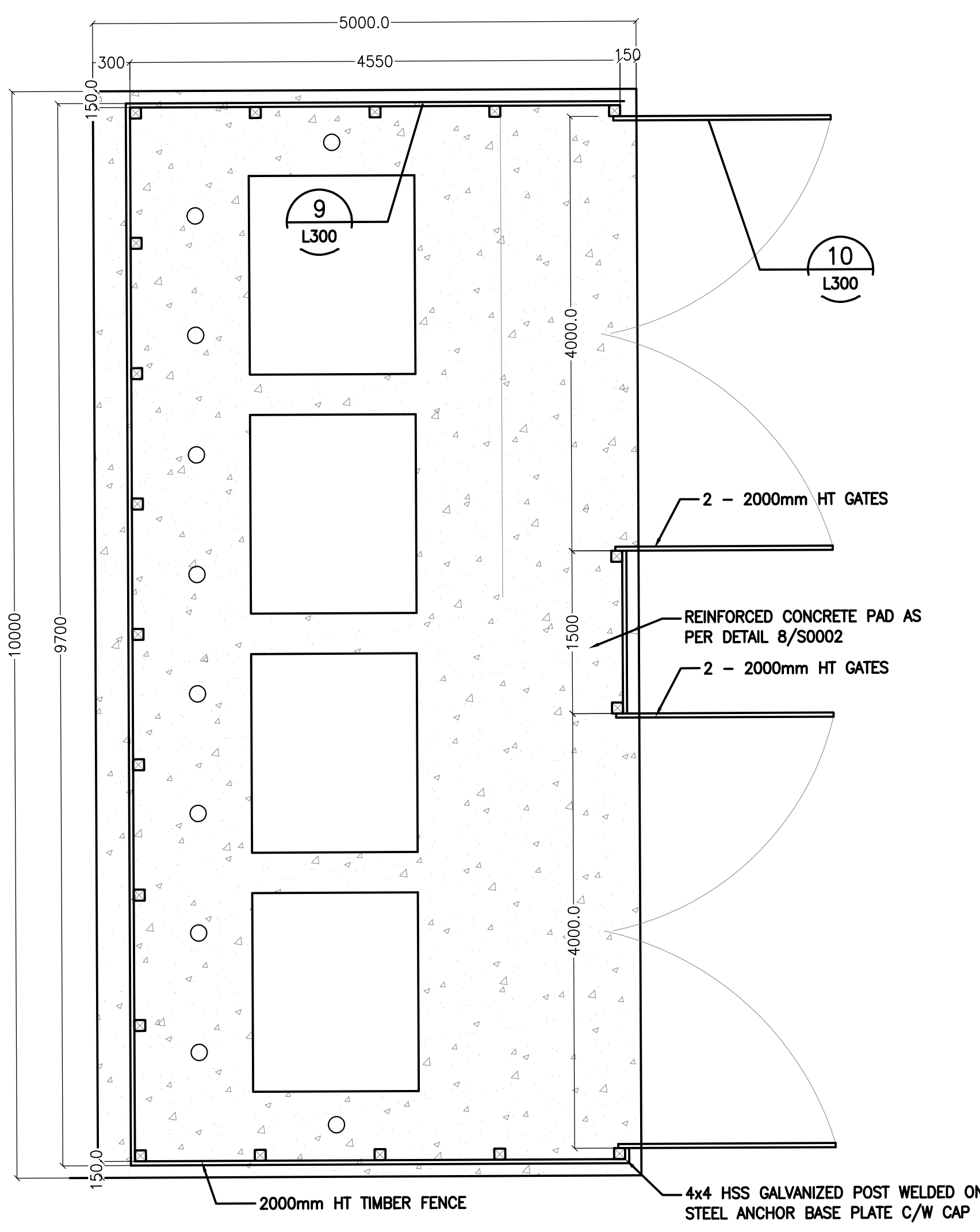

11 GARBAGE ENCLOSURE LAYOUT
L100 L300 1:40

TITLE	LANDSCAPE
TITLE	LANDSCAPE DETAILS
SHEET NUMBER	L300
SHEET #	OF
ISSUE	
DATE OF	