

CONSULTANT - IS-B CONSULTANT

CONSULTANT - IS-B CONSULTANT

SCALE

CLIENT REF #

PROJECT

CLIENT REF #

PROJECT

ACCESS STORAGE LEGGET DRIVE

KEY PLAN

DISCLAIMER: THE DRAWING AND DESIGN IS COPYRIGHT PROTECTED WHICH SHALL NOT BE REPRODUCED OR COPIED WITHOUT THE WRITTEN PERMISSION OF ARCHITECTURE 49. THE CONTRACTOR SHALL CHECK AND VERIFY ALL DIMENSIONS AND UTILITY LOCATIONS AND REPORT ALL ERRORS AND OMISSIONS PRIOR TO COMMENCING WORK. THE DRAWING IS NOT TO BE SCALED.

ISSUED FOR REVIEW

PROJECT NO: 219-0005243

DATE: MARCH 23, 2022

DESIGNED BY: AH

CHECKED BY: AH / SG

DATE: MARCH 23, 2022

SCALE: As Indicated

DATE: MARCH 23, 2022

DATE: MARCH 23, 2022

DATE: MARCH 23, 2022

DATE: MARCH 23, 2022

DATE: MARCH 23, 2022

DATE: MARCH 23, 2022

DATE: MARCH 23, 2022

DATE: MARCH 23, 2022

DATE: MARCH 23, 2022

DATE: MARCH 23, 2022

DATE: MARCH 23, 2022

DATE: MARCH 23, 2022

DATE: MARCH 23, 2022

DATE: MARCH 23, 2022

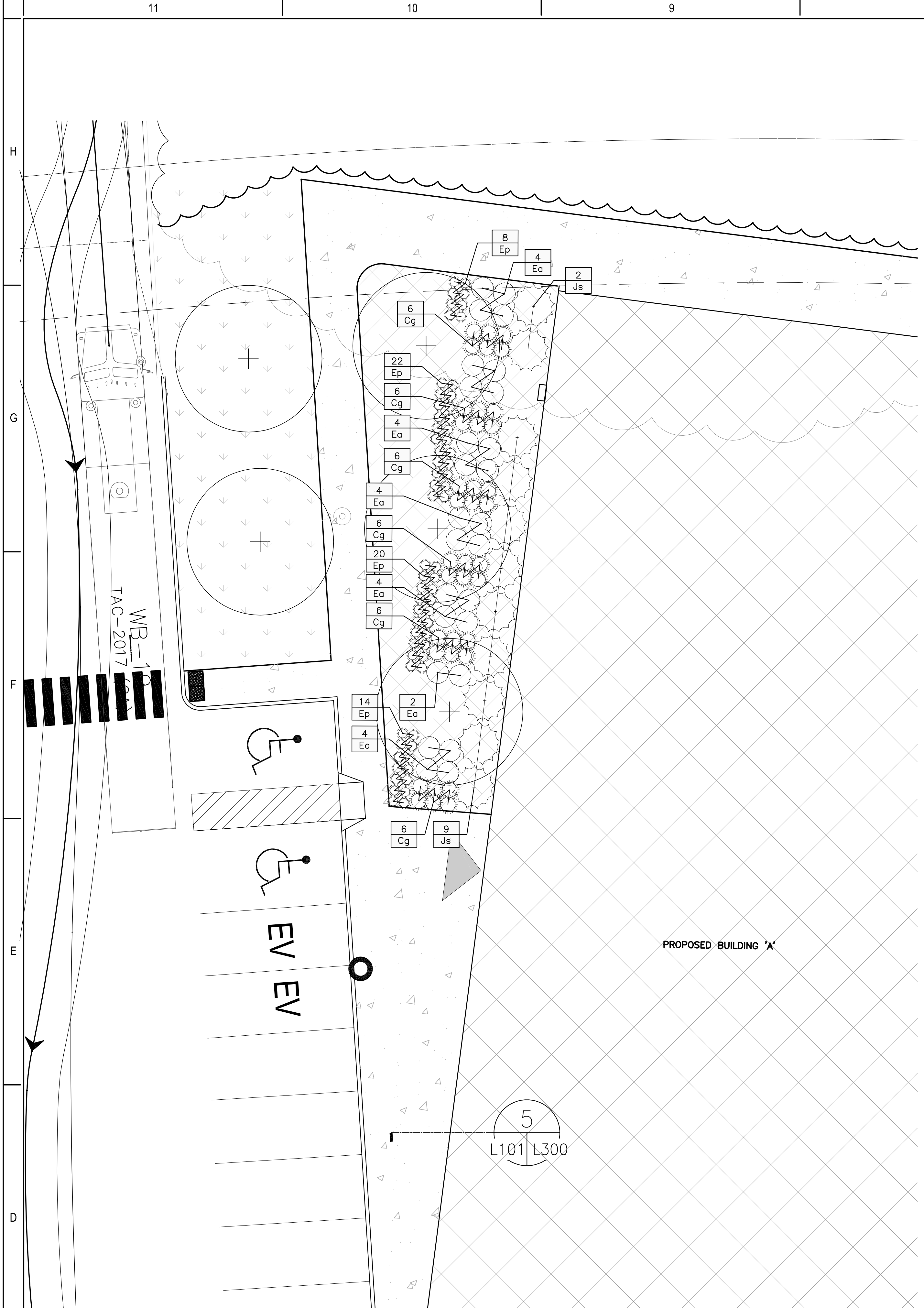

2 PLANTER DETAIL PLAN
 L101 1:100

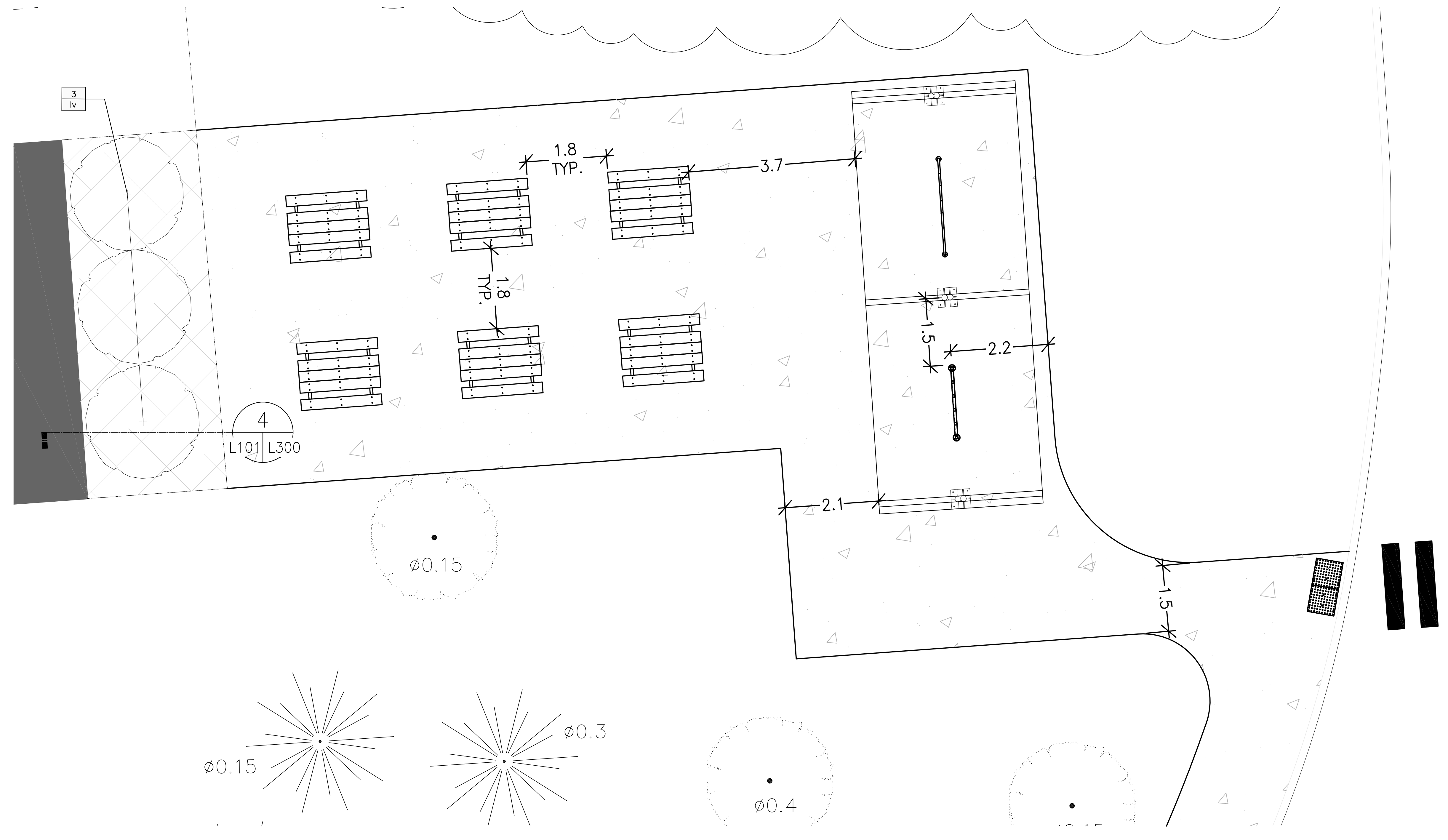

3 SEATING AREA DETAIL PLAN
 L101 1:50

LAYOUT NOTES:

- CONTRACTOR TO CONFIRM ALL DIMENSIONS AND REPORT ANY DISCREPANCIES TO CONTRACTOR ADMINISTRATOR PRIOR TO CONSTRUCTION
- LAYOUT TO BE APPROVED BY CONTRACT ADMINISTRATOR PRIOR TO ANY CONSTRUCTION OR REMOVALS
- ALL DIMENSIONS ARE IN METRIC UNLESS OTHERWISE NOTED
- CONTRACTOR IS RESPONSIBLE FOR ALL EXCAVATIONS, REMOVALS, DISPOSALS AND ROUGH GRADING AS REQUIRED TO CONSTRUCTION ALL WORKS AS SHOWN ON ALL PLANS, DETAILS AND SPECIFICATIONS
- LOCATION OF ALL UTILITIES SHOWN FOR ILLUSTRATION ONLY, CONTRACTOR MUST CONTACT ALL UTILITIES REGARDING RULES FOR WORKING IN THE AREA OF THE UTILITIES PRIOR TO COMMENCEMENT OF ANY WORK. CONTRACTOR MUST CONFIRM LOCATION OF ALL UTILITIES PRIOR TO CONSTRUCTION
- ALL EXISTING ROADS, SIDEWALKS, CURBS, FENCING, PAVING, SODDED AREAS, AND APPROACHES, ETC. TO REMAIN TO BE PROTECTED DURING CONSTRUCTION TO CONTRACT ADMINISTRATOR'S APPROVAL AT THE CONTRACTOR'S OWN COSTS.
- ALL EXISTING TREES, SHRUB BEDS, MULCH BEDS, AND SOD TO REMAIN TO BE PROTECTED DURING CONSTRUCTION TO BE REPAIRED TO CONTRACT ADMINISTRATOR'S APPROVAL AT THE CONTRACTOR'S OWN COST.
- USE SPECIFIED BACKFILL IN ALL TRENCHES RUNNING BELOW ALL STRUCTURES, PAVING, WALKWAYS, ETC.
- FILL ALL HOLES AND LOW AREAS TO DESIGN SUBGRADE WITH COMPACTED FILL (SUITABLE TO SURFACE FINISH), FOR SODDED/PLANTED AREAS USE COMPACTED CLEAN EARTH FILL SUITABLE FOR PLANT GROWTH. FOR PAVED AREAS USE COMPACTED GRANULAR BASE.
- ALL TREES WITHIN OR IMMEDIATELY ADJACENT TO AREA OF WORK TO BE PROTECTED TO CITY OF OTTAWA TREE PROTECTION STANDARDS.

LEGEND:

- TOPSOIL AND SOD
- PLANT BED
- CONCRETE SIDEWALK
- EXISTING CURB
- NEW CURB
- NEW DECIDUOUS TREE
- EXISTING TREE TO BE REMOVED. SEE TREE PROTECTION PLAN L200.
- NEW DECIDUOUS SHRUB
- NEW CONIFEROUS SHRUB
- NEW PERENNIAL GRASS
- PLANT KEY
 - PLANT QUANTITY
 - PLANT SPECIES
- DETAIL CALLOUT

PLANTING NOTES:

- REFER TO L100 FOR FULL PLANTING NOTES. IN CASE OF DISCREPANCY, CONFIRM WITH LANDSCAPE ARCHITECT PRIOR TO PLANTING.
- PLANT LIST BELOW ONLY INCLUDES SHRUBS AND PERENNIAL GRASSES WITHIN THE BOUNDARIES OF L101. FULL PLANT LIST IS FOUND ON L100.
- LOCATION OF ALL PLANTS MATERIAL TO BE MARKED OUT ON SITE AND APPROVED BY CONTRACT ADMINISTRATOR PRIOR TO PLANTING
- TREE SPACING, UNLESS OTHERWISE NOTED:
 - DECIDUOUS TREES: 6.0m MIN.
 - CONIFEROUS TREES: 3.0m MIN.
- SHRUB SPACING, UNLESS OTHERWISE NOTED:
 - SMALL DECIDUOUS: 600mm O.C.
 - LARGE DECIDUOUS: 900mm O.C.
 - CONIFEROUS: 750mm O.C.
 - GRASSES: 450mm O.C.
- ALL PLANT MATERIAL TO BE BEST QUALITY, REVIEWED ON SITE BY LANDSCAPE ARCHITECT PRIOR TO PLANTING. UNACCEPTABLE PLANTS TO BE REPLACED AND NEW PLANTS APPROVED PRIOR TO PLANTING. REPLACEMENTS ARE AT CONTRACTOR'S OWN COST.
- ALL PLANTING EXCAVATIONS ARE TO BE REVIEWED AND APPROVED BY LANDSCAPE ARCHITECT PRIOR TO PLACEMENT OF DRAINAGE COURSE, FILTER FABRIC AND/OR SOIL.

PROPOSED PLANT LIST:

KEY	QUANTITY	BOTANICAL NAME	COMMON NAME	SPACING (mm) (75%)	SIZE	COMMENTS
SHRUBS - DECIDUOUS						
W	3	<i>Ilex verticillata</i>	Winterberry	as shown	2 gal.	SHRUBS TO BE IN POTS. SOURCED IN SAME GROWING ZONE. ALL SHRUBS SHOULD HAVE DENSE GROWTH, WELL ROOTED AND WITHOUT DEFECT. MIN ROOT ZONE VOLUME PER SHRUB: 5 CU.M.
Ea	26	<i>Euonymus alatus 'Odon'</i>	Burning Bush	900	2 gal.	
SHRUBS - CONIFEROUS						
Js	11	<i>Juniperus sabina 'Arcadia'</i>	Arcadian Juniper	1800	2 gal.	SHRUBS TO BE IN POTS. SOURCED IN SAME GROWING ZONE. ALL SHRUBS SHOULD HAVE DENSE GROWTH, WELL ROOTED AND WITHOUT DEFECT. MIN ROOT ZONE VOLUME PER SHRUB: 5 CU.M.
PERENNIAL GRASSES						
Ep	64	<i>Euphorbia polychroma 'Bonfire'</i>	Bonfire Cushion Spurge	450	1 gal.	PERENNIALS TO BE IN POTS. SOURCED IN SAME GROWING ZONE. ALL PERENNIALS SHOULD HAVE DENSE GROWTH, WELL ROOTED AND WITHOUT DEFECT.
Cg	36	<i>Calamagrostis x acutiflora 'Overdam'</i>	Variegated Reed Grass	600	2 gal.	

PLAN ENLARGEMENTS

L101

DATE: MARCH 23, 2022