

PAVEMENT DESIGN

40mm SUPERPAVE 12.5 ASPHALTIC CONCRETE
 50mm SUPERPAVE 19.0 ASPHALTIC CONCRETE
 150mm OPSS GRANULAR A CRUSHED STONE
 40mm OPSS GRANULAR B TYPE II

GRADING AND SERVICING FOR ADJACENT CONDO BLOCK WEST OF PROPERTY PER IBI GRADING AND SERVICING PLANS, RECEIVED AUGUST 8, 2021.

GRADING FOR SUBDIVISION PER IBI PROJECT No. 27970 - REV 16, DATED JUNE 27, 2019.

SERVICING FOR SUBDIVISION PER IBI PROJECT No. 27970 - REV 18, DATED JANUARY 11, 2019.

COMPOSITE UTILITY PLAN OF SUBDIVISION PER IBI PROJECT No. 27970 - REV 7, DATED NOVEMBER 29, 2018.

NOTE:
 ALL EXISTING BUILDINGS, BARNs, POST & WIRE FENCES, TREES, UTILITY WIRES, POLES AND CULVERTS WITHIN LOTS AND BLOCKS TO BE REMOVED, UNLESS OTHERWISE NOTED.

NOTE:
 UNDERGROUND STORAGE TANK VOLUMES EXCLUDE VOLUME IN THE BASE STONE BELOW THE INVERT OF THE STORAGE TANK

ANY DISTURBED AREA DURING CONSTRUCTION TO BE RESTORED TO ORIGINAL CONDITION OR BETTER TO THE SATISFACTION OF THE AUTHORITIES HAVING JURISDICTION

WRITTEN PERMISSION REQUIRED FOR WORK ON ADJACENT LANDS

NOTE:
 FOR WATERMAIN STUBS, 2.4m MIN. COVER TO BE PROVIDED

NOTE:
 ALL WATERMAIN CONNECTIONS AND DECOMMISSIONING OF EXISTING WATERMAINS TO BE COMPLETED BY CITY FORCES. TRENCH BACKFILL/REINSTATEMENT TO BE COMPLETED BY THE CONTRACTOR TO THE SATISFACTION OF THE CITY OF OTTAWA.

NOTE:RE: TEST PIT/BOREHOLE EXCAVATIONS
 ANY DISTURBED MATERIAL ENCOUNTERED BELOW THE SUBGRADE LEVEL WITHIN A BUILDING FOOTPRINT TO BE SUB-EXCAVATED AND BACKFILLED WITH COMPACTED ENGINEERED FILL AS PER GEOTECHNICAL ENGINEERS RECOMMENDATION.

CONTRACTOR TO VERIFY THE PRECISE LOCATIONS AND INVERT ELEVATIONS OF EX. UNDERGROUND SERVICES AND EX. UTILITIES PRIOR TO STARTING CONSTRUCTION

NOTE: CB
 FOR CATCHBASIN INFORMATION, REFER TO DRAWING No. 3 FOR DETAIL.

NOTE
 FOR WATERMAIN LAYOUT AT DEAD-END STREETS REFER TO CITY STD. W37.2

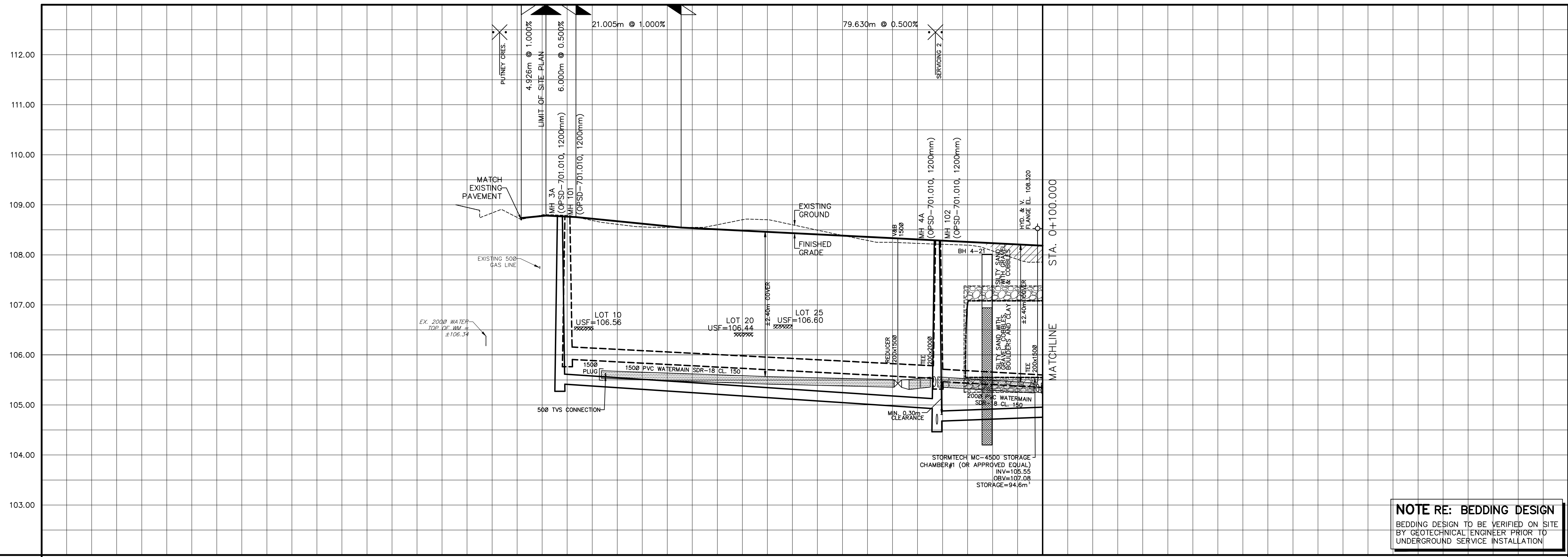
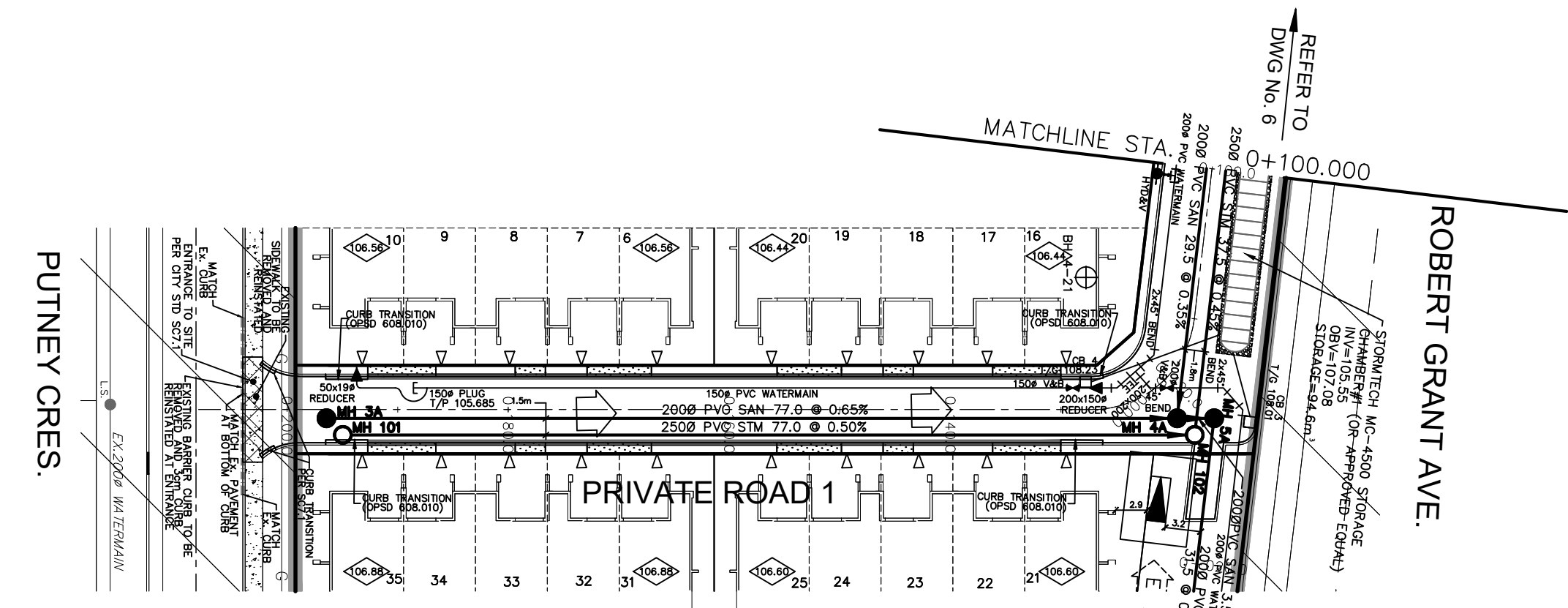
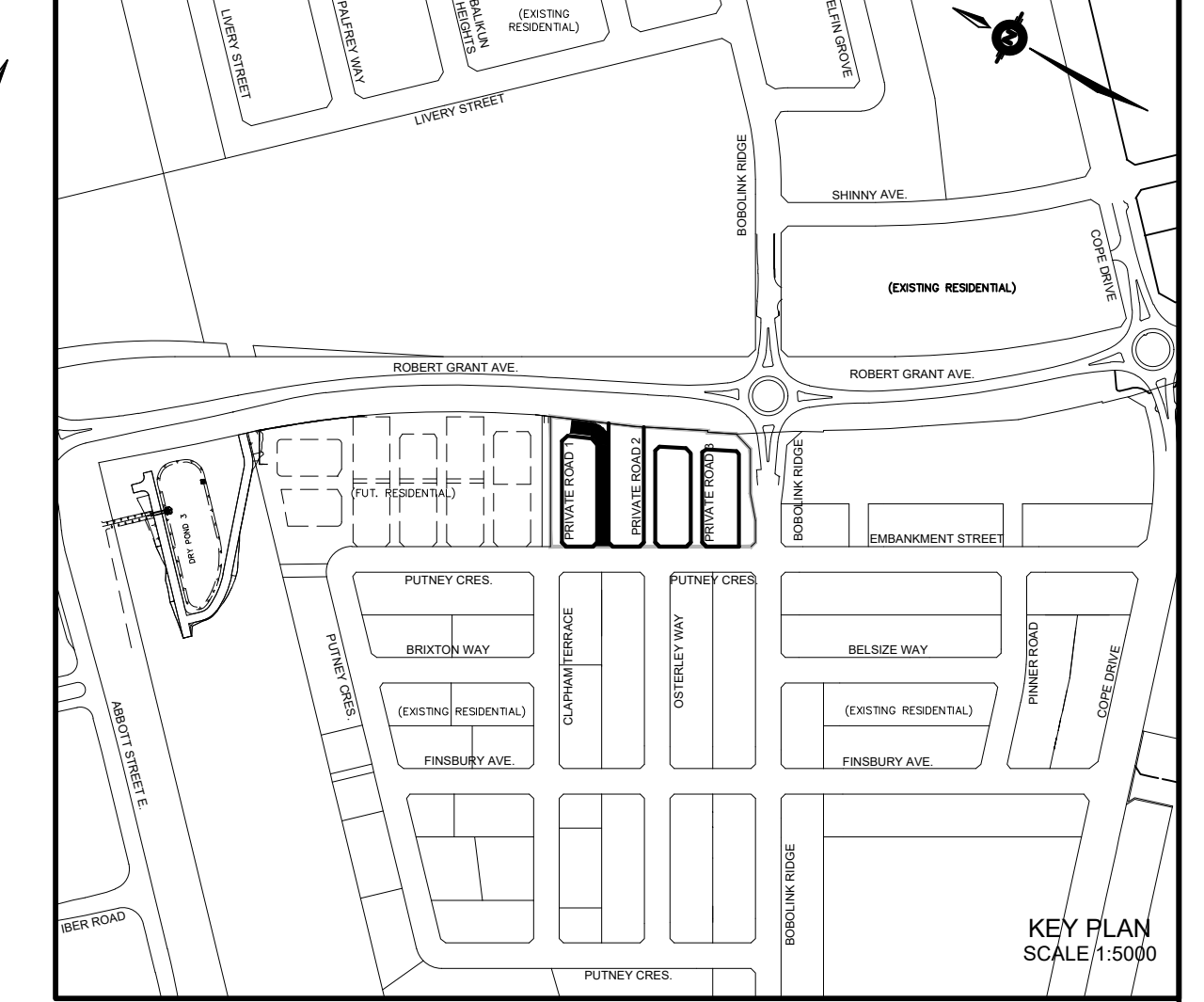

TOP OF WATERMAIN	105.85 105.85 105.85 105.85 105.85 105.85 105.85 105.85 105.85 105.85 105.85 105.85 105.85 105.85 105.85 105.85	TOP OF WATERMAIN	105.85
SANITARY INVERT	NE 105.822 2000 PVC SAN 77.0 @ 0.65% SDR-35 SW 104.525 TE 104.625 N 104.675 2000 PVC SAN 29.9 @ 0.35% SDR-35	SANITARY INVERT	105.85
STORM INVERT	NE 105.913 2500 PVC STM 77.0 @ 0.50% SDR-35 SW 105.528 TE 105.528 N 105.468 2500 PVC STM 37.5 @ 0.45% SDR-35	STORM INVERT	105.85
PROPOSED GRADES	108.736 108.736 108.736 108.736 108.736 108.623 108.545 108.484 108.384 108.320 108.280 108.284 108.252 108.184	PROPOSED GRADES	108.736
CENTERLINE CHAINAGE	0+220.000 0+207.995 0+204.171 0+199.945 0+193.245 0+180.000 0+172.240 0+160.000 0+140.000 0+127.177 0+121.436 0+120.000 0+113.662 0+100.000	CENTERLINE CHAINAGE	0+220.000

NOTE RE: BEDDING DESIGN
 BEDDING DESIGN TO BE VERIFIED ON SITE BY GEOTECHNICAL ENGINEER PRIOR TO UNDERGROUND SERVICE INSTALLATION

LEGEND

- CROSS 45° BEND
- LATERAL
- HYDRANT, VALVE & VB
- TEE
- VALVE & VC
- VALVE & VB
- 22.5° BEND
- 11.25° BEND
- REDUCER
- CAP
- SANITARY MAINTENANCE HOLE
- CAP
- STREET CATCHBASIN & LEAD
- STREET CATCHBASIN WITH CLOSED LID & LEAD
- STORM MAINTENANCE HOLE
- CURB INLET CATCHBASIN & LEAD
- CATCHBASIN/ MAINTENANCE HOLE
- INTERCONNECTED CATCH BASIN & LEADS
- CAP
- SINGLE SERVICE LOCATION (ST, SAN & WM)
- SINGLE SERVICE LOCATION (ST, SAN & WM)
- TEE CATCHBASIN
- PERFORATED PIPE
- ELBOW CATCHBASIN
- DITCH AND CULVERT
- HYDRO TRANSFORMER
- STREET LIGHT STANDARD
- CONCRETE SIDEWALK
- CURB & DEPRESSED CURB
- ASPHALT SIDEWALK
- CHAINLINK FENCE (1.5m UNLESS OTHERWISE NOTED)
- NOISE BARRIER (2.5m UNLESS OTHERWISE NOTED)
- DECORATIVE FENCE (SEE LANDSCAPE DIGS FOR DETAIL)
- CONSTRUCTION FENCE
- POST AND RAIL FENCE
- PHASING LIMITS
- PROPERTY BOUNDARY
- BOREHOLE (BH)
- TEST PIT (TP)
- AUGER HOLE (AH)
- MONITORING WELL LOCATION
- CONCEPTUAL WELL LOCATION
- TOP OF FOUNDATION ELEVATION
- FINISHED FLOOR ELEVATION
- UNDERSIDE OF FOOTING ELEVATION
- NUMBER OF RISERS
- UNITS REQUIRING PRESSURE
- REDUCING VALVES
- WALKOUT UNITS
- SLAB ON GRADE
- OVERLAND FLOW DIRECTION
- EXTERNAL OVERLAND FLOW DIRECTION
- EMERGENCY OVERLAND FLOW DIRECTION
- DEVELOPMENT NOT PART OF THIS APPLICATION

AS PER GEOTECHNICAL REPORT

NOT FOR CONSTRUCTION

1	S.L.M.	22-01-13	1st SUBMISSION
No.	BY	DATE	DESCRIPTION
TOPOGRAPHIC INFORMATION			
TOPOGRAPHIC INFORMATION PROVIDED BY ANNIS, O'SULLIVAN, VOLLEBEKK LTD. PROJECT No. 22111-21 RECEIVED JUNE 24, 2021			
LEGAL INFORMATION			
CALCULATED M-PLAN PROVIDED BY ANNIS, O'SULLIVAN, VOLLEBEKK LTD., PROJECT No. 22111-21. RECEIVED DECEMBER 13, 2021.			
BENCH MARK			
SITE BENCHMARK #1, FIRE HYDRANT TOP OF SPINDLE ELEVATION = 109.78m			
SITE BENCHMARK #2, CP IN ASPHALT ELEVATION = 109.09			
TAMARACK HOMES		BOBOLINK RIDGE BLOCK 343	
<p>120 Iher Road Unit 103 Slittsville, Ontario, K2S 1E9 Tel. (613) 836-0856 Fax. (613) 836-7183 www.DSEL.ca</p>		<p>S. L. MERRICK 100186523 22-01-13 PROVINCE OF ONTARIO</p>	

Ottawa			
110 Laurier Ave W Ottawa, Ontario, K1P 1J1 Tel. (613) 580-2400 www.Ottawa.ca			
PLAN AND PROFILE OF PRIVATE ROAD 1 (STA. 0+100.000 TO 0+220.000)			
DRAWN BY:	G.G.G.	CHECKED BY:	S.L.M.
DESIGNED BY:	G.G.G.	CHECKED BY:	S.L.M.
SCALE:	HORIZ. 1:50	VERT. 1:500	
PROJECT No.	21-1261		
SHEET No.	7		

CITY PLAN No. XXXXX
 CITY FILE No. D07-XX-XX-XXXX