

**EXISTING VEGETATION SCHEDULE**  
 TREE ASSESSMENT CONDUCTED: March 20, 2018

ID	BOTANICAL NAME	COMMON NAME	DBH (cm)	HEALTH CONDITION	REMARKS
1)	ACER SPP	MAPLE	30	GOOD	STREET TREE; TO BE RETAINED
2)	TILIA AMERICANA	BASSWOOD	50	GOOD	STREET TREE; TO BE RETAINED
3)	SYRINGA VULGARIS	COMMON LILAC	N/A	GOOD	GROUPS OF SHRUBS; PARTLY INSIDE RIGHT PARTLY INSIDE RIGHT-OF-WAY; SHRUB ADJACENT TO SIDEWALK TO BE RETAINED
4)	SYRINGA VULGARIS	COMMON LILAC	N/A	GOOD	SHRUB; TO BE REMOVED
5)	SYRINGA VULGARIS	COMMON LILAC	N/A	GOOD	SHRUB; TO BE REMOVED
6)	ACER NEGUNDO	MANITOBA MAPLE	34.6	FAIR	TREE SHOOT FROM DEAD STUMP LOCATED AT 408 NELSON; EXISTING WOOD FENCE SEPARATE TREE SHOOT FROM STUMP; TO BE RETAINED
7)	ACER NEGUNDO	MANITOBA MAPLE	20	GOOD	SPECIMEN TREE; TO BE REMOVED
8)	ACER NEGUNDO	MANITOBA MAPLE	50	GOOD	SHARED PROPERTY OF 119 HENDERSON AVE AND 408 NELSON STREET; EXISTING WOOD FENCE SEPARATE THE GROUND SECTION OF THE TREE FROM THE TRUNK; TO BE RETAINED
9)	ACER NEGUNDO	MANITOBA MAPLE	70	GOOD	410 NELSON STREET
10)	ACER SPP	MAPLE	50	GOOD/FAIR	392 NELSON STREET
11)	ACER NEGUNDO	MANITOBA MAPLE	15	GOOD	99 HENDERSON AVENUE

SCHEDULE BY OTHERS

**NOTES:**

SOIL STABILITY SLOPE IS ASSUMED TO BE 1:1 AND SHALL BE CONFIRMED BY GEOTECHNICAL ENGINEER

- ASSUMED ELEVATIONS:  
 - BOTTOM OF EXCAVATION: 67.71 m  
 - AVERAGE GRADE LEVEL: 69.71 m

1:1 SLOPING IS NOT ACHIEVABLE ON NORTH SIDE OF EXCAVATION. SHORING REQUIREMENTS SHALL BE REVIEWED BY OTHERS.

ENCROACHMENT OUTSIDE OF PROPERTY LINE IS REQUIRED ON NORTH, SOUTH AND WEST OF THE EXCAVATION

TREE PRESERVATION PLAN IS BY OTHERS

**GENERAL NOTES:**

- ANY DEVIATION FROM CONDITIONS SHOWN ON DRAWINGS SHALL BE REPORTED TO ENGINEER.
- DESIGN LOADS:  
 A) REQUIREMENT OF OPS 539 MUNI 539 AND PROTECTION SYSTEM PL2  
 B) SURCHARGE PRESSURE = 2.4 KPA  
 C) SOIL PARAMETERS:  
 $K_a = 0.33$   
 SOIL UNIT WEIGHT = 19.5
- MATERIALS  
 A) WOOD TO BE P.T. SPF #1/#2 OR BETTER  
 B) MODEL 88 DUCKBILL EARTH ANCHOR BY DUCKBILL EARTH ANCHORS (INSTALL AS PER MANUFACTURER INSTRUCTIONS)
- CONTRACTOR TO VERIFY EXISTING SERVICES AND SUPPORT AS REQUIRED.
- INSTALL PROTECTIVE FENCE @ 600MM AWAY FROM TOP OF EXCAVATION SLOPES.
- ALL EXCAVATED MATERIAL TO BE REMOVED FROM SITE. ALL BACK FILL TO BE NON-FROST SUSCEPTIBLE FREE-DRAINING MATERIAL.
- SOIL ASSUMED TO BE TYPE 3 AS PER THE GEOTECHNICAL ENGINEERING REPORT ISSUED BY GOLDER DATED AUGUST 2018.
- SOIL CONDITIONS TO BE REVIEWED BY SOILS ENGINEER ON SITE
- TRENCH BOX OR STEEL PLATES TO BE IN CONTACT WITH SOIL OR MINIMUM GAP
- SLOPES MUST BE SLOPED AT 45 DEGREES MINIMUM
- FACTOR OF SAFETY = 1.5
- SITE REVIEW OF STRUCTURAL ITEMS, AS NOTED ON THESE DRAWINGS, SHALL BE COORDINATED WITH LAMPKIN STRUCTURAL SERVICES LTD. THROUGH THE DURATION OF THE PROJECT.

HENDERSON AVENUE

APPROVED  REFUSED   
 THIS 13 DAY OF August, 2020  
  
 ERIN O'CONNELL, MCIP, RPP, MANAGER (A)  
 DEVELOPMENT REVIEW, WEST  
 PLANNING, INFRASTRUCTURE AND ECONOMIC  
 DEVELOPMENT DEPARTMENT, CITY OF OTTAWA

1 SITE PLAN  
 SKI 1:150

FOR STRUCTURAL ONLY		 34 - 5330 Canotek Rd. Ottawa, On. K1J 9C4 Phone: (613) 745-6437 Fax: (613) 745-9348		CLIENT NEMORIN GROUP	
		PROJECT/TITLE 105-109 HENDERSON ROAD EXCAVATION PLAN		PROJECT/TITLE 105-109 HENDERSON ROAD EXCAVATION PLAN	
DATE 28/05/2020 dd/mm/yyyy	PROJECT# 19-14198	DESIGNED BY R.H.	DRAWN BY R.L.	DRAWING# SK1 REV# 1	

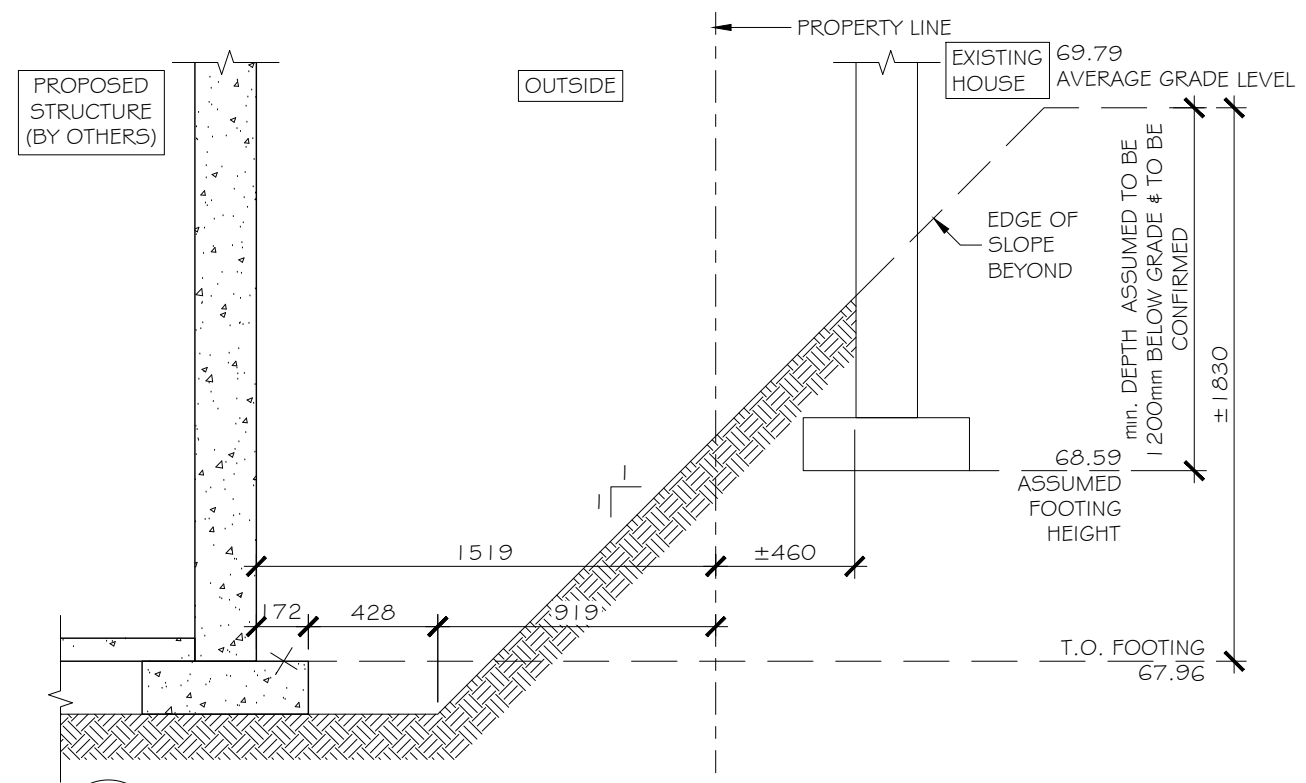

1  
SK2 1:25  
EXCAVATION SHORING SLOPE ON NORTH SIDE

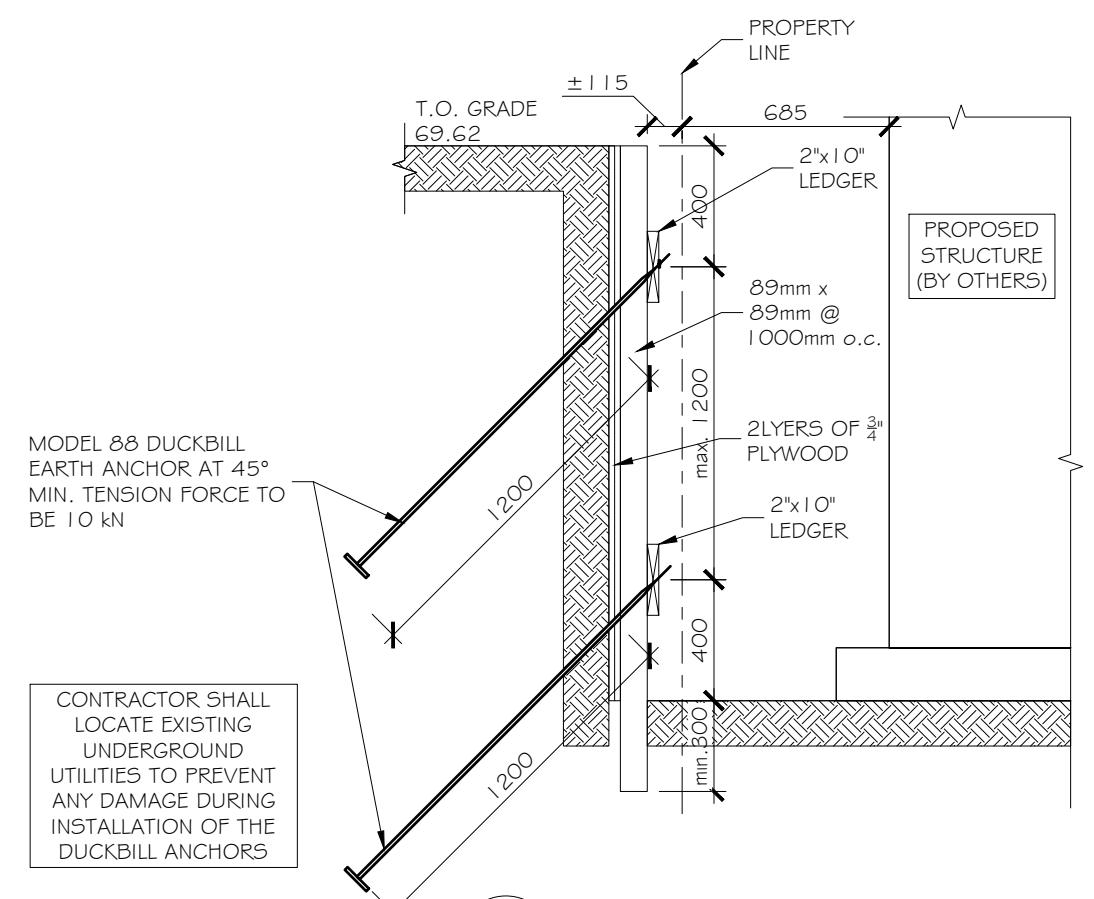

CONTRACTOR SHALL LOCATE EXISTING UNDERGROUND UTILITIES TO PREVENT ANY DAMAGE DURING INSTALLATION OF THE DUCKBILL ANCHORS

2  
SK2 1:25  
EXCAVATION SHORING WALL ADJACENT TO TREE

	<b>FOR STRUCTURAL ONLY</b> <b>LAMPKIN</b> Structural Services Ltd. 34 - 5330 Canotek Rd. Ottawa, On. K1J 9C4 Phone: (613) 745-6437 Fax: (613) 745-9348		CLIENT NEMORIN GROUP		
	PROJECT/TITLE 105-109 HENDERSON ROAD EXCAVATION PLAN		DESIGNED BY	DRAWN BY	DRAWING#
DATE	PROJECT#	R.H.	R.L.	SK2	REV# 1
28/05/2020 dd/mm/yyyy	19-14198				