

REFERENCE / KEY SITE PLAN NTS

LEGEND / SYMBOL

PROPOSED DECIDUOUS TREE
DETAIL 1/L3

PROPOSED CONIFEROUS TREE
DETAIL 1/L3

PROPOSED SHRUBS / PERENNIALS /
ORNAMENTAL GRASSES / GROUNDCOVERS
DETAIL 1/L3

SEED MIX TYPE A
20% Canada Wild Rye (*Elymus canadensis*)
20% Annual Ryegrass (*Lolium multiflorum*)
20% Little Bluestem (*Andropogon scoparius*)
10% Autumn Bentgrass (*Agrostis perennans*)
10% Fringed Brome (*Bromus*)
10% Rough Dropseed (*Sporobolus asper*)
5% Black Eyed Susan (*Rudbeckia hirta*)
2% New England Aster (*Aster novae-angliae*)
2% Wild Bergamot (*Monarda fistulosa*)
1% Gray Goldenrod (*Solidago nemoralis*)
Seeding Rate: 55kg/ha

SEED MIX TYPE B
25% Creeping Red Fescue (*Festuca rubra*)
20% Tall Fescue (*Festuca arundinacea*)
15% Annual Ryegrass (*Lolium multiflorum*)
15% Perennial Ryegrass (*Lolium perenne*)
15% Canada Bluegrass (*Poa compressa*)
3% Redtop (*Agrostis gigantea*)
2.5% Canada Wild Rye (*Elymus canadensis*)
2.5% Swithgrass (*Panicum virgatum*)
1% Big Bluestem (*Andropogon gerardii*)
1% Tall Cord Grass (*Spartina pectinata*)
Seeding Rate: 55kg/ha

GENERAL NOTES

- This drawing shall be read in conjunction with all relevant Architectural, Engineering and related Drawings and Documents.
- Refer to Engineering Drawings for Grading and Servicing.
- Refer to Architectural Drawings for Site layout.
- Contractor shall provide the location(s) of all services/utilities by consulting Municipal Authorities and Utility companies and shall be responsible for adequate protection from damage during construction.
- Plant material shall be No.1 Grade and shall comply with the Metric Guide Specifications For Nursery Stock (latest edition), published by the Canadian Nursery Trades Association.
- Plant Material locations are **Schematic / Approximate only**. Contractor shall stake out locations on site prior to work.
- Contractor shall guarantee all plant material for a period of one (1) full year from the date of final acceptance.
- Plant Material substitutions shall not be permitted without written approval from the Consultant.
- Shrubs** shall be planted in a continuous prepared bed of 450mm depth planting soil mix covered over with a woven polypropylene weed control fabric (**LANDSCAPE FABRIC-Green-Line by Thrace-LINQ**) and 75mm depth shredded pine mulch to finish grade, as specified.
- Reinstate all areas damaged or disturbed beyond the limit of Work.
- THIS PLAN HAS BEEN PREPARED FOR MUNICIPAL SITE PLAN APPROVAL AND MAY NOT BE USE FOR ANY OTHER PURPOSE.**

PLANT MATERIAL SCHEDULE

CODE	BOTANICAL NAME	COMMON NAME	QTY.	SIZE	REMARKS
DECIDUOUS TREES					
AFJ	ACER x FREEMANII JEFFERS	AUTUMN BLAZE MAPLE	2	60mm cal	B&B, Single Stem
AS	ACER SACCHARUM	SUGAR MAPLE	3	60mm cal	B&B, Single Stem
BP	BETULA PAPYRIFERA	PAPER BIRCH	6	60mm cal	B&B, Single Stem
CO	CELTIS OCCIDENTALIS	COMMON HACKBERRY	2	60mm cal	B&B, Single Stem
MD	MALUS DOLGO	DOLGO CRABAPPLE	3	50mm cal	B&B, Single Stem
MT	MALUS THUNDERCHILD	THUNDERCHILD CRABAPPLE	3	50mm cal	B&B, Single Stem
QM	QUERCUS MACROCARPA	BUR OAK	1	60mm cal	B&B, Single Stem
QR	QUERCUS RUBRA	RED OAK	1	60mm cal	B&B, Single Stem
TA	TILIA AMERICANA	AMERICAN BASSWOOD	1	60mm cal	B&B, Single Stem
CONIFEROUS TREES					
PG	PICEA GLAUCA	WHITE SPRUCE	8	180 cm ht	B&B
PN	PINUS NIGRA	AUSTRIAN PINE	5	180cm ht	B&B
PP	PICEA PUNGENS	COLORADO GREEN SPRUCE	10	180 cm ht	B&B
PR	PINUS RESINOSA	RED PINE	5	180cm ht	B&B
SHRUBS					
PO	PHYSOCARPUS OPULIFOLIUS	COMMON NINEBARK	55	50cm ht	potted, 100cm o/c
RB	ROSA BLANDA	SHRUB ROSE	30	50cm ht	potted, 100cm o/c

NOT FOR CONSTRUCTION

1.	???	ISSUE FOR SITE PLAN APPROVAL
no.	date	revision
North Arrow		Stamp

Contractor shall check and verify all dimensions on site and report all errors and/or omissions to the Consultant.

Work to be done in accordance with all applicable codes and by-laws.

Do not scale Drawing.

Copyright reserved. This Drawing is the exclusive property of Levstek Consultants Inc. and shall not be used without consent.

Consultant

LEVSTEK CONSULTANTS
LANDSCAPE ARCHITECTS

5671 Hugh Crescent - Ottawa - Ontario - K0A 2W8
613 - 826 - 8518

Client

D-SQUARED CONSTRUCTION LTD.
6811 HIRAM ROAD, GREELEY, ONTARIO

Project

5455 BOUNDARY ROAD
OTTAWA, ONTARIO

Drawing Title

LANDSCAPE PLAN

Drawn	Date	Drawing No.
MGB	JUNE 2020	L1
Scale	Project No.	
1:400	1174	

LEGEND / SYMBOL

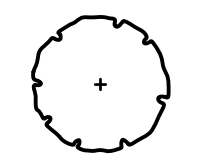
- 

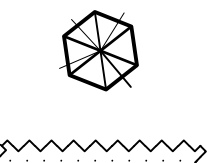
PROPOSED DECIDUOUS TREE
DETAIL 1/L3
- 

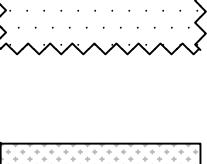
PROPOSED CONIFEROUS TREE
DETAIL 1/L3
- 

PROPOSED SHRUBS / PERENNIALS /
ORNAMENTAL GRASSES / GROUNDCOVERS
DETAIL 1/L3
- 

SEED MIX TYPE A
20% Canada Wild Rye (*Elymus canadensis*)
20% Annual Ryegrass (*Lolium multiflorum*)
20% Little Bluestem (*Andropogon scoparius*)
10% Autumn Bentgrass (*Agrostis perennans*)
10% Fringed Brome (*Bromus*)
10% Rough Dropseed (*Sporobolus asper*)
5% Black Eyed Susan (*Rudbeckia hirta*)
2% New England Aster (*Aster novae-angliae*)
2% Wild Bergamot (*Monarda fistulosa*)
1% Gray Goldenrod (*Solidago nemoralis*)
Seeding Rate: 55kg/ha
- 

SEED MIX TYPE B
25% Creeping Red Fescue (*Festuca rubra*)
20% Tall Fescue (*Festuca arundinacea*)
15% Annual Ryegrass (*Lolium multiflorum*)
15% Perennial Ryegrass (*Lolium perenne*)
15% Canada Bluegrass (*Poa compressa*)
3% Redtop (*Agrostis gigantea*)
2.5% Canada Wild Rye (*Elymus canadensis*)
2.5% Swithgrass (*Panicum virgatum*)
1% Big Bluestem (*Andropogon gerardii*)
1% Tall Cord Grass (*Spartina pectinata*)

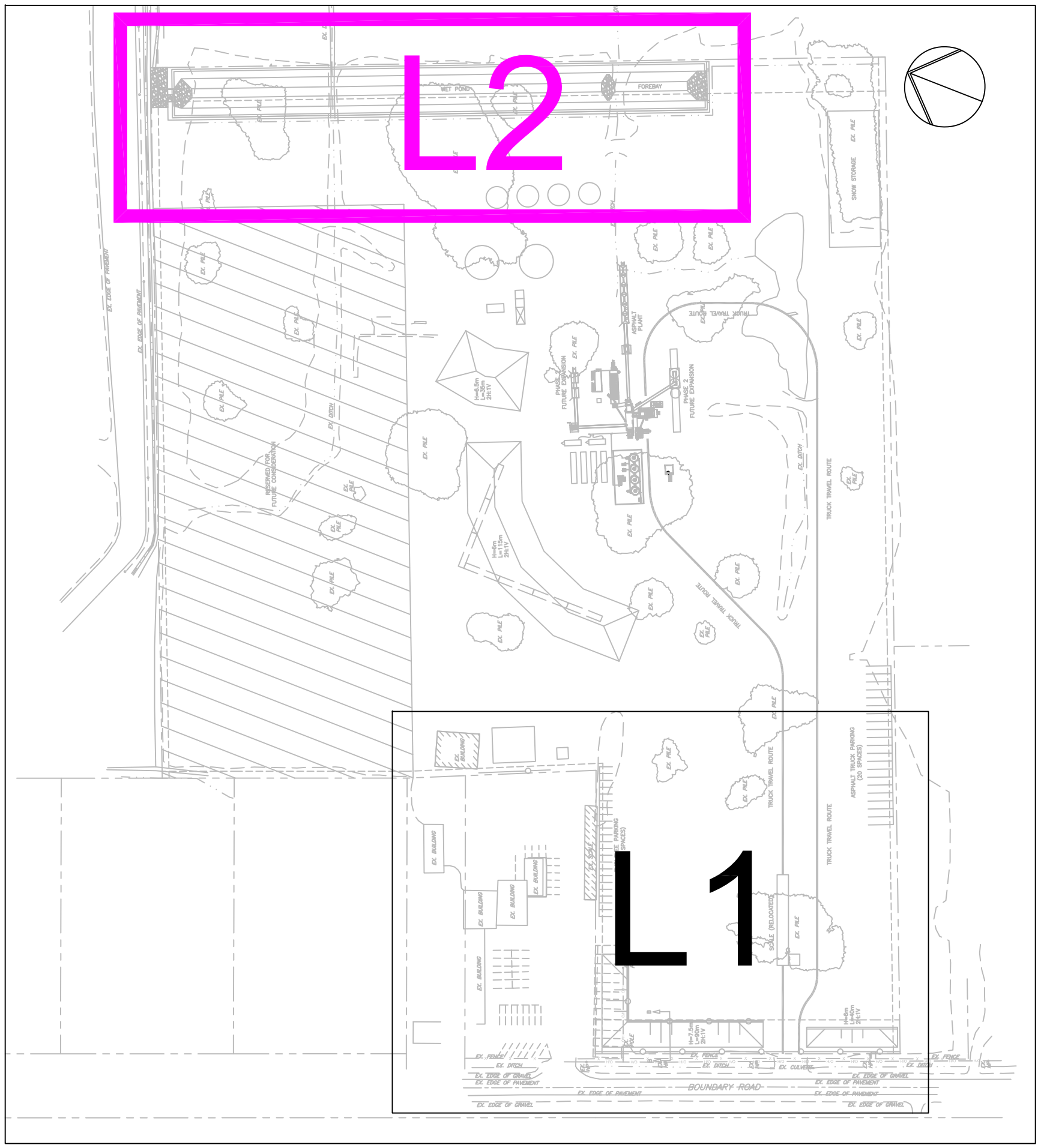

PLANT MATERIAL SCHEDULE

CODE	BOTANICAL NAME	COMMON NAME	QTY.	SIZE	REMARKS
DECIDUOUS TREES					
AR	ACER RUBRUM	RED MAPLE	3	60mm cal	B&B, Single Stem
AS	ACER SACCHARUM	SUGAR MAPLE	2	60mm cal	B&B, Single Stem
ASa	ACER SACCHARINUM	SILVER MAPLE	5	60mm cal	B&B, Single Stem
BP	BETULA Papyrifera	PAPER BIRCH	6	60mm cal	B&B, Single Stem
PD	POPULUS DELTOIDES	COTTONWOOD	3	60mm cal	B&B, Single Stem
QM	QUERCUS MACROCARPA	BURR OAK	1	60mm cal	B&B, Single Stem
QR	QUERCUS RUBRA	RED OAK	3	60mm cal	B&B, Single Stem
CONIFEROUS TREES					
AB	ABIES BALSAMEA	BALSAM FIR	8	180 cm ht	B&B
LL	LARIX LARICINIA	TAMARACK	3	180cm ht	B&B
PB	PINUS BANKSIANA	JACK PINE	3	180cm ht	B&B
PG	PICEA GLAUCA	WHITE SPRUCE	6	180 cm ht	B&B
PSt	PINUS STROBUS	WHITE PINE	3	180 cm ht	B&B
TO	THUJA OCCIDENTALIS	EASTERN WHITE CEDAR	22	150 cm ht	Potted
DECIDUOUS SHRUBS					
CS	CORNUS SERICEA	RED OSIER DOGWOOD	44	50cm ht	potted, 120cm o/c
DL	DIERVILLA LONICERA	BUSH HONEYSUCKLE	29	50cm ht	potted, 120cm o/c
PO	PHYSCARPUS OPULIFOLIUS	COMMON NINEBARK	15	50cm ht	potted, 120cm o/c
RB	ROSA BLANDA	SHRUB ROSE (rose-pink)	29	50cm ht	potted, 120cm o/c
RhA	RHUS AROMATICA	FRAGRANT SUMAC	14	50cm ht	potted, 120cm o/c

SWM POND

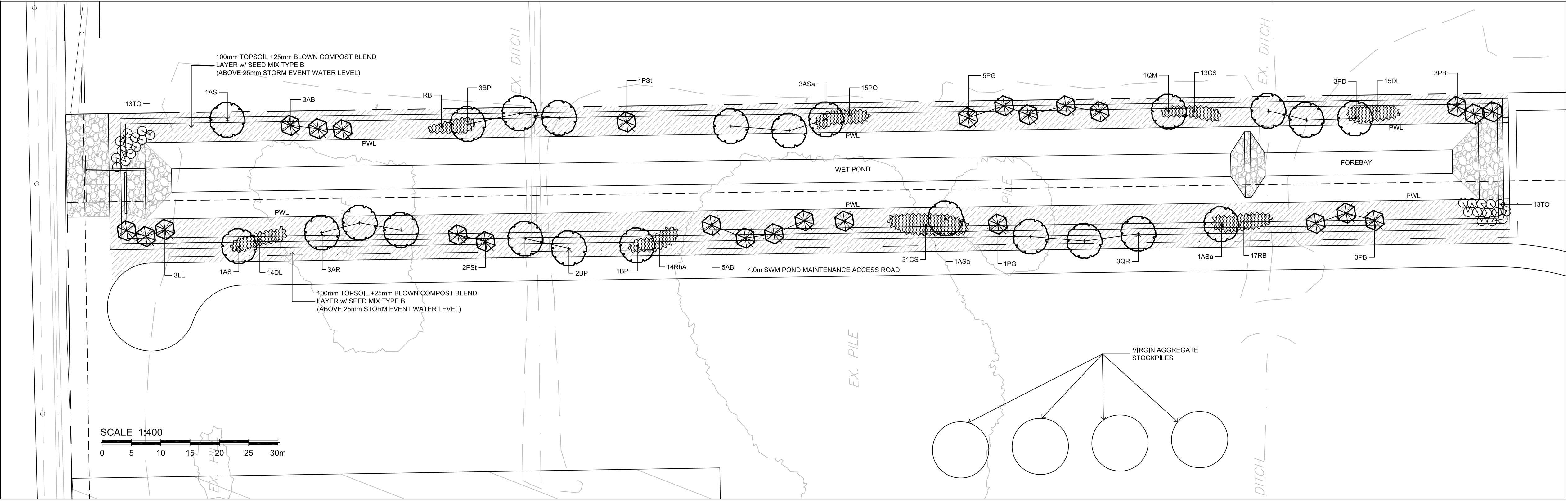

DRAFT 3

REFERENCE / KEY SITE PLAN NTS

NOT FOR CONSTRUCTION

1.	???	ISSUE FOR SITE PLAN APPROVAL
no.	date	revision
North Arrow		Stamp

Contractor shall check and verify all dimensions on site and report all errors and/or omissions to the Consultant.

Work to be done in accordance with all applicable codes and by-laws.

Do not scale Drawing.

Copyright reserved. This Drawing is the exclusive property of Levstek Consultants Inc. and shall not be used without consent.

Consultant
LEVSTEK CONSULTANTS
LANDSCAPE ARCHITECTS
5871 Hugh Crescent · Ottawa · Ontario · K0A 2W8
613 · 826 · 9518

Client
D-SQUARED CONSTRUCTION LTD.
6811 HIRAM ROAD, GREELEY, ONTARIO

Project
5455 BOUNDARY ROAD
OTTAWA, ONTARIO

Drawing Title
LANDSCAPE PLAN

Drawn MGB	Date JUNE 2020	Drawing No. L2
Scale 1:400	Project No. 1174	

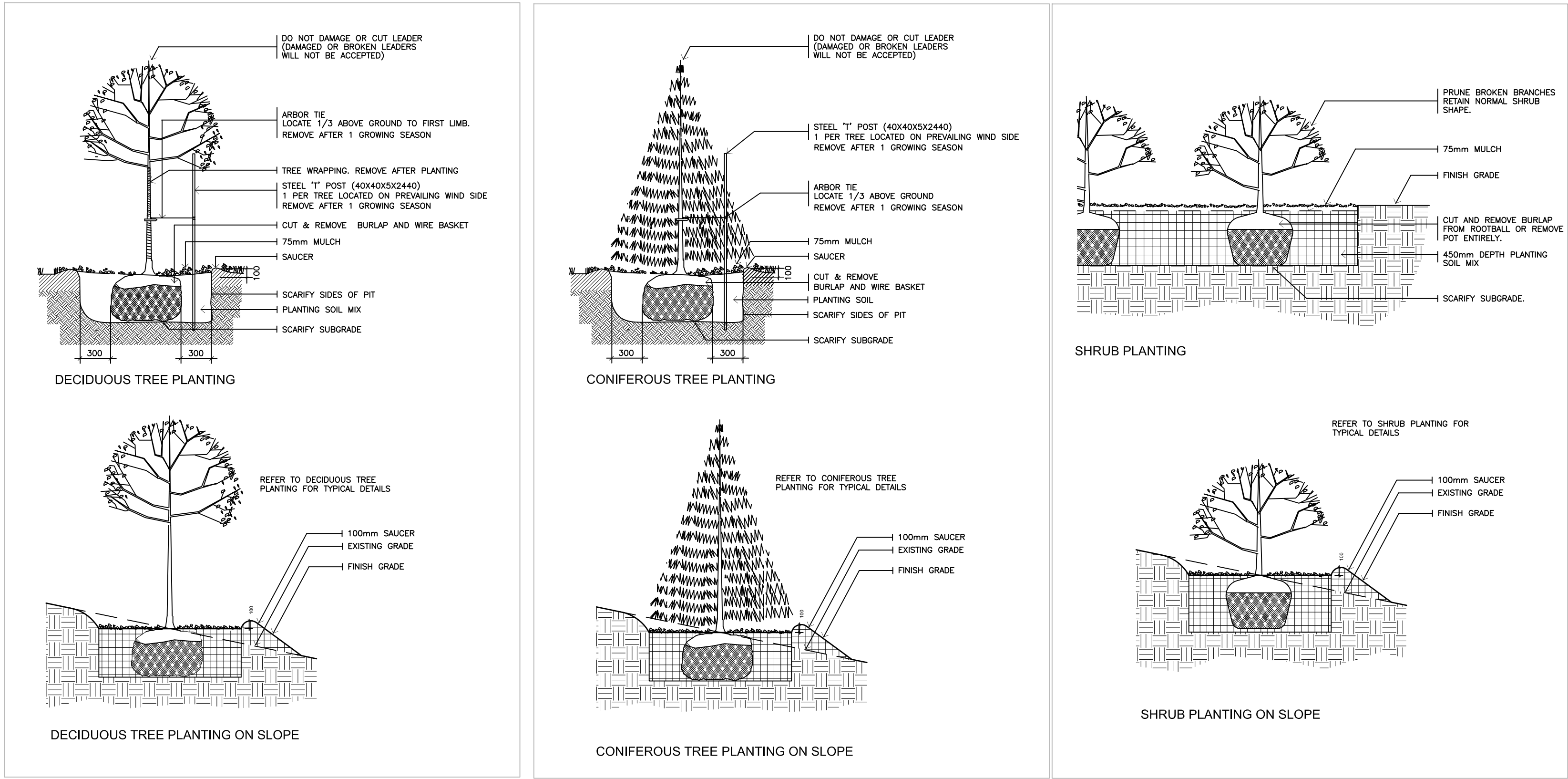

1
L3 PLANTING DETAILS (TYPICAL) NTS

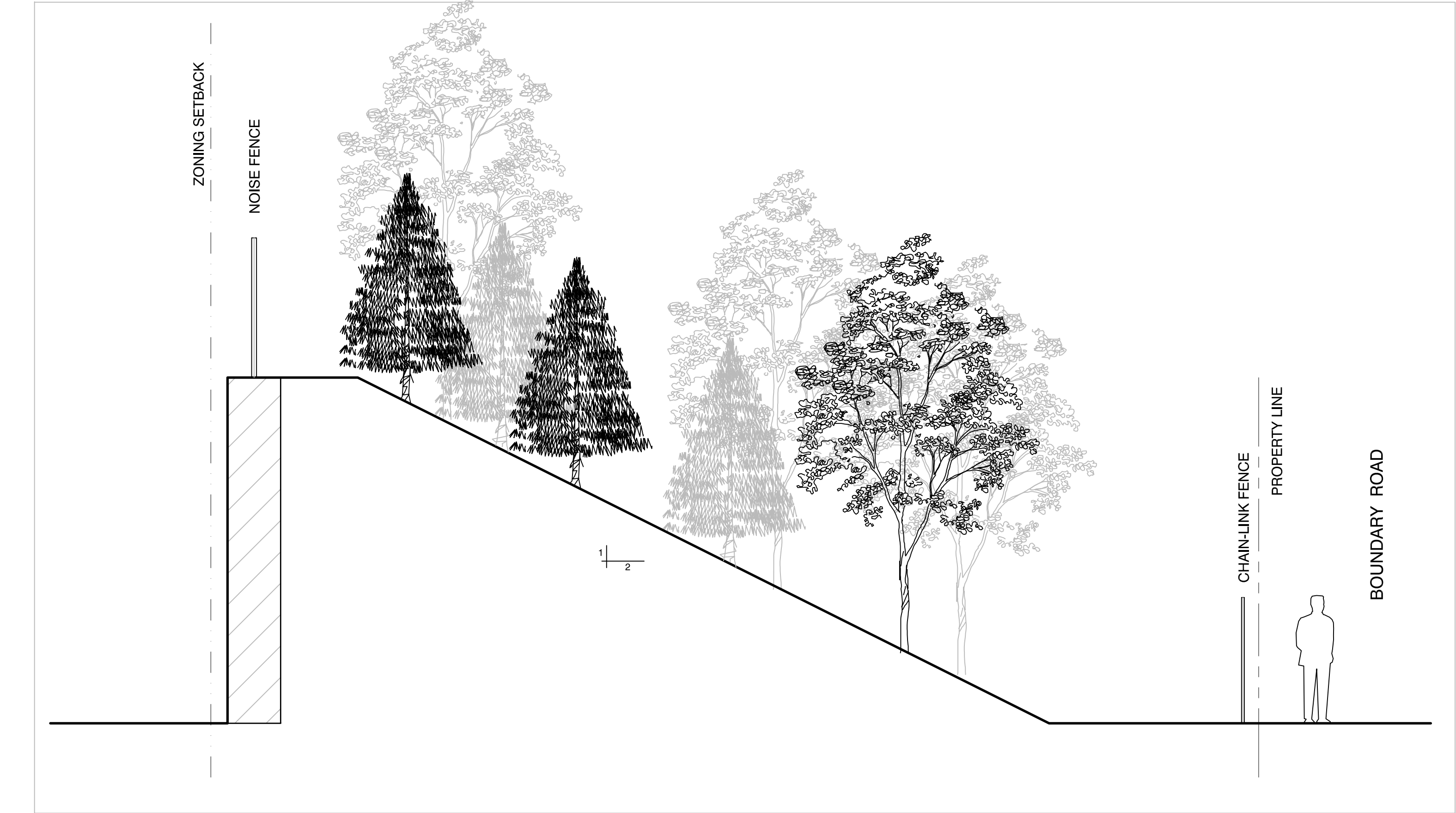

2
L3 BOUNDARY ROAD 'SCREEN' PLANTING SECTION NTS

DRAFT3

NOT FOR CONSTRUCTION

1.	???	ISSUE FOR SITE PLAN APPROVAL
no.	date	revision
North Arrow		Stamp

Contractor shall check and verify all dimensions on site and report all errors and/or omissions to the Consultant.

Work to be done in accordance with all applicable codes and by-laws.

Do not scale Drawing.

Copyright reserved. This Drawing is the exclusive property of Levstek Consultants Inc. and shall not be used without consent.

Consultant

LEVSTEK CONSULTANTS
LANDSCAPE ARCHITECTS

5671 Hugh Crescent - Ottawa - Ontario - K0A 2W8
613 - 826 - 6518

Client

D-SQUARED CONSTRUCTION LTD.
6811 HIRAM ROAD, GREELEY, ONTARIO

Project

5455 BOUNDARY ROAD
OTTAWA, ONTARIO

Drawing Title

LANDSCAPE DETAILS

Drawn	Date	Drawing No.
MGB	JUNE 2020	L3
Scale	Project No.	
AS NOTED	1174	