

	ORIGINAL GROUND
	PROPOSED ELEVATION
	PROPOSED TOP OF CURB ELEVATION
	DIRECTION & PERCENT FLOW
	FINISHED FIRST FLOOR ELEVATION
	UNDER SIDE OF FOOTING
	TERRACING 3:1 SLOPE MINIMUM (UNLESS OTHERWISE SHOWN)
	PROPOSED FIRE HYDRANT
	T/W=ELEVATION
	B/W=ELEVATION
	PROPOSED RETAINING WALL (DESIGN BY OTHERS)
	DIRECTION OF OVERLAND FLOW
	PROPERTY LINE
	PROPOSED MAXIMUM PONDING ELEVATION
	MOUNTABLE CURB (UNLESS OTHERWISE NOTED)
	3R NUMBER OF RISERS
	POND EXTENTS

3.	ISSUED FOR SITE PLAN APPROVAL	WAJ	SGG	15.10.27
2.	ISSUED FOR 2ND SUBMISSION	SGG	TJW	15.06.03
1.	ISSUED FOR SITE PLAN APPROVAL	SGG	TJW	14.04.11

PAVEMENT STRUCTURE
(SEE HOULE CHEVRIER REPORT FOR DETAILS)
PRIVATE ACCESS ROAD
40mm SUPERPAVE 12.5
40mm SUPERPAVE 19.0
150mm OPSS GRANULAR A BASE
375mm OPSS GRANULAR B TYPE II

*NOTE GRANULAR B MAY BE REDUCED IF ROAD BASE FOUNDED ON BEDROCK. SEE HOULE CHEVRIER GEOTECHNICAL REPORT FOR DETAILS.

- SITE GRADING**
- ALL GRANULAR BASE & SUB BASE COURSE MATERIALS SHALL BE COMPACTED TO 98% STANDARD PROCTOR MAX. DRY DENSITY.
 - ALL DISTURBED GRASSED AREAS SHALL BE RESTORED TO ORIGINAL CONDITION OR BETTER, WITH SOD ON MIN. 100mm TOPSOIL. THE RELOCATION OF TREES AND SHRUBS SHALL BE SUBJECT TO APPROVAL BY THE PROJECT LANDSCAPE ARCHITECT OR ENGINEER.
 - PAVEMENT CONSTRUCTION AS PER HOULE CHEVRIER GEOTECHNICAL INVESTIGATION DATED FEB. 12, 2014
 - ALL BARRIER AND MOUNTABLE TO BE CONSTRUCTED PER CITY OF OTTAWA STANDARD DRAWING SC1.1 AND SC1.3
 - INSPECTIONS: ALL WORK ON THE MUNICIPAL RIGHT OF WAY AND EASEMENTS TO BE INSPECTED BY THE MUNICIPALITY PRIOR TO BACKFILLING. ALL WORK RELATING TO WATERMANS AND SEWERS TO BE INSPECTED BY THE MUNICIPALITY WHEN REQUIRED.
 - REFER TO ARCHITECTURAL SITE PLAN FOR DIMENSIONS AND SITE DETAILS.
 - STEP JOINTS ARE TO BE USED WHERE PROPOSED ASPHALT MEETS EXISTING ASPHALT AS PER DETAIL. ALL JOINTS MUST BE SEALED AS PER DETAIL.
 - CONTRACTOR TO OBTAIN A ROAD OCCUPANCY PERMIT 48 HOURS PRIOR TO COMMENCING ANY WORK WITHIN THE MUNICIPAL ROAD ALLOWANCE IF REQUIRED BY THE MUNICIPALITY.
 - 100 YEAR PONDING DEPTH TO BE 0.30m (MAXIMUM).
 - EMBANKMENTS TO BE SLOPED AT MIN. 3:1, UNLESS OTHERWISE SPECIFIED.
 - REFER TO DRAWING EC-1 FOR EROSION AND SEDIMENT CONTROL.
 - ALL PAVEMENT MARKING, LINE PAINTING, DIRECTIONAL LINES/ARROWS ETC. SHALL BE PLACED IN ACCORDANCE WITH THE ARCHITECTURAL SITE PLAN OR THE OWNER'S TRAFFIC ENGINEERING CONSULTANT'S DRAWINGS. LINE PAINTING AND DIRECTIONAL SYMBOLS SHALL BE APPLIED WITH A MINIMUM OF TWO COATS OF ORGANIC SOLVENT BASED PAINT.
 - THE CONTRACTOR SHALL PROVIDE TO THE ENGINEER 1 (ONE) SET OF AS CONSTRUCTED SITE SERVING, GRADING, AND SITE ELECTRICAL DWGS.
 - SITE SIGNAGE TO BE INSTALLED AS PER ARCHITECTURAL SITE PLAN.
 - ALL NECESSARY CLEARING AND GRUBBING SHALL BE COMPLETED BY THE CONTRACTOR. REVIEW WITH ARCHITECT AND THE CITY OF OTTAWA PRIOR TO TREE CUTTING.
 - SUB-EXCAVATE SOFT AREAS & FILL WITH GRANULAR 'B' COMPACTED IN 0.15m LAYERS.
 - FOR ALL LANDSCAPING FEATURES (i.e. TREES, WALKWAYS, PARK DETAILS, NOISE BARRIERS, FENCES etc.) REFER TO LANDSCAPE ARCHITECT PLAN.

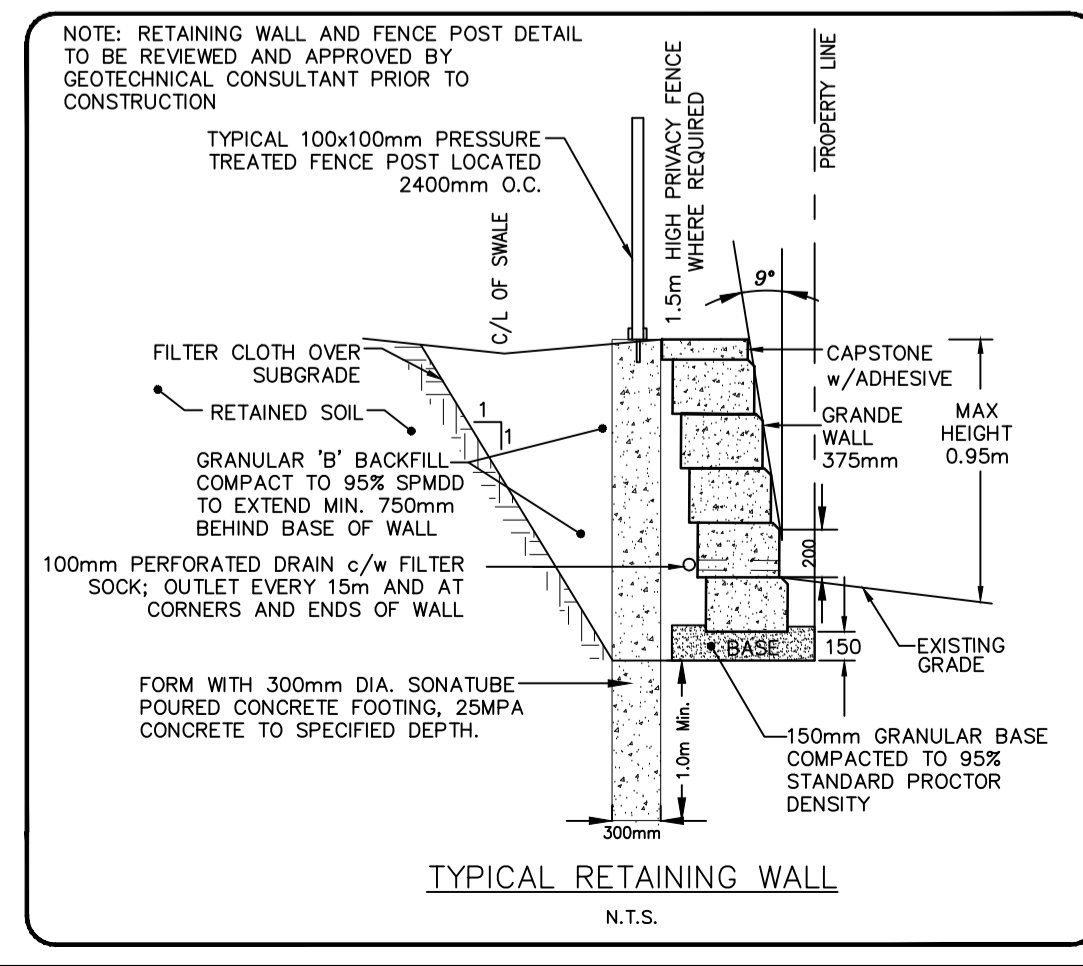
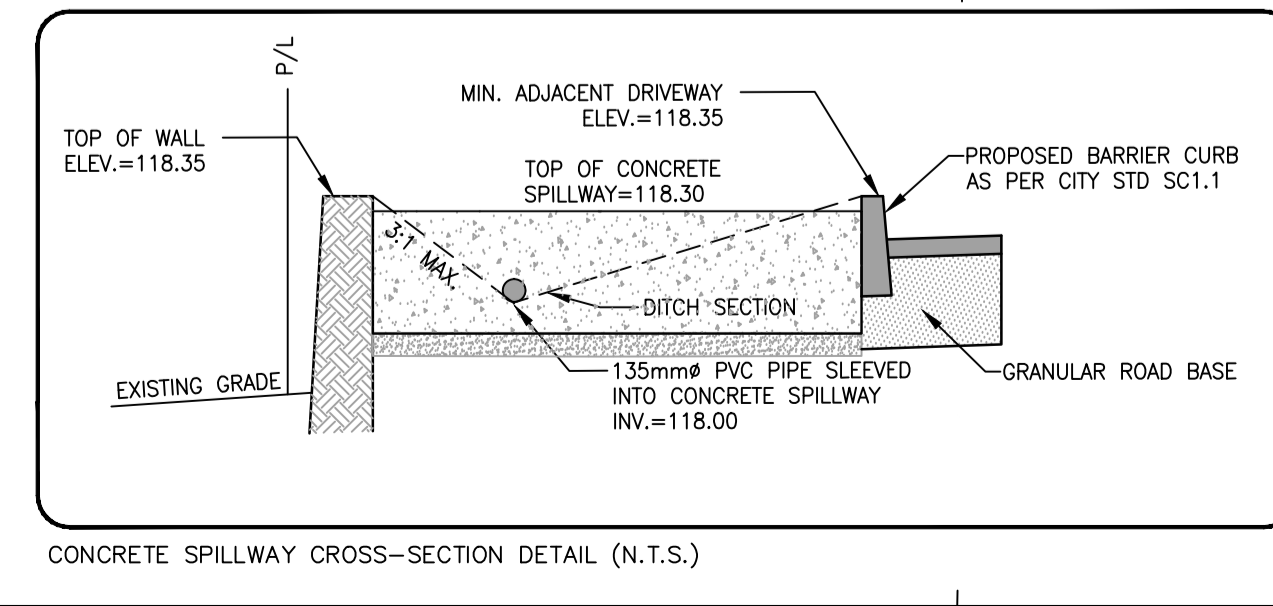
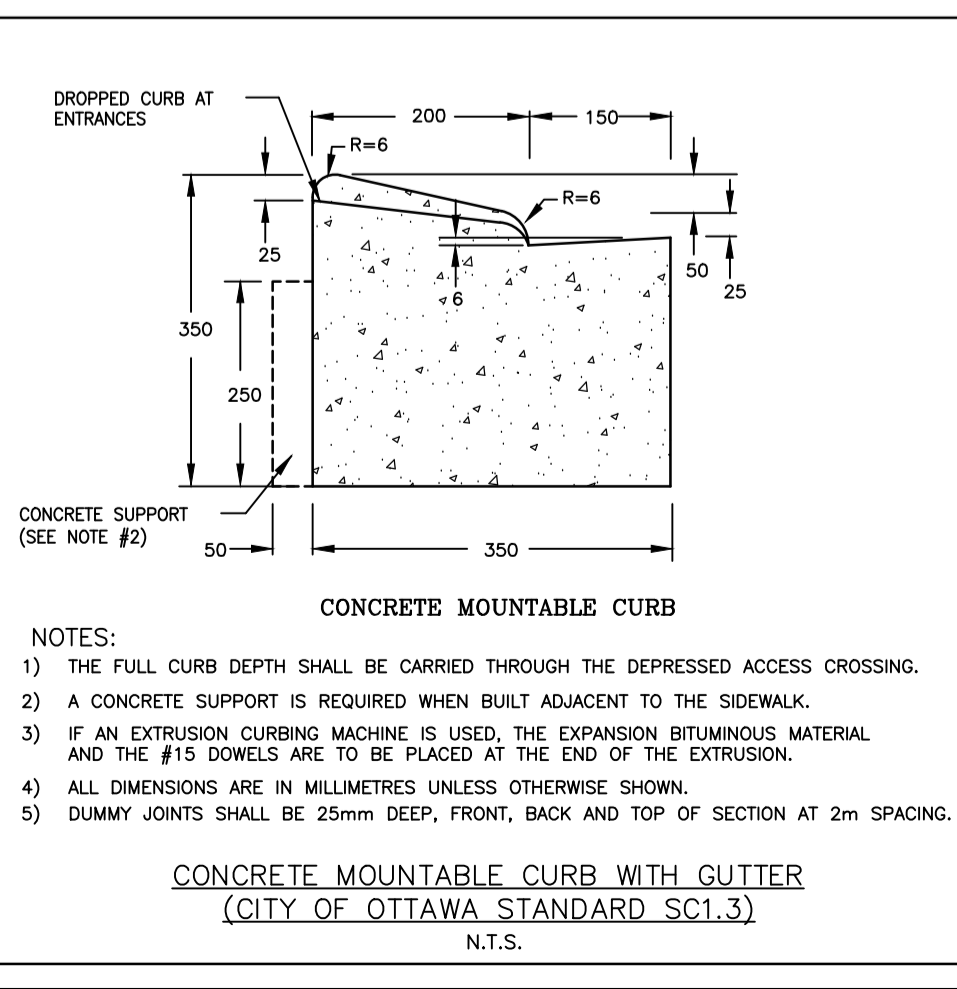
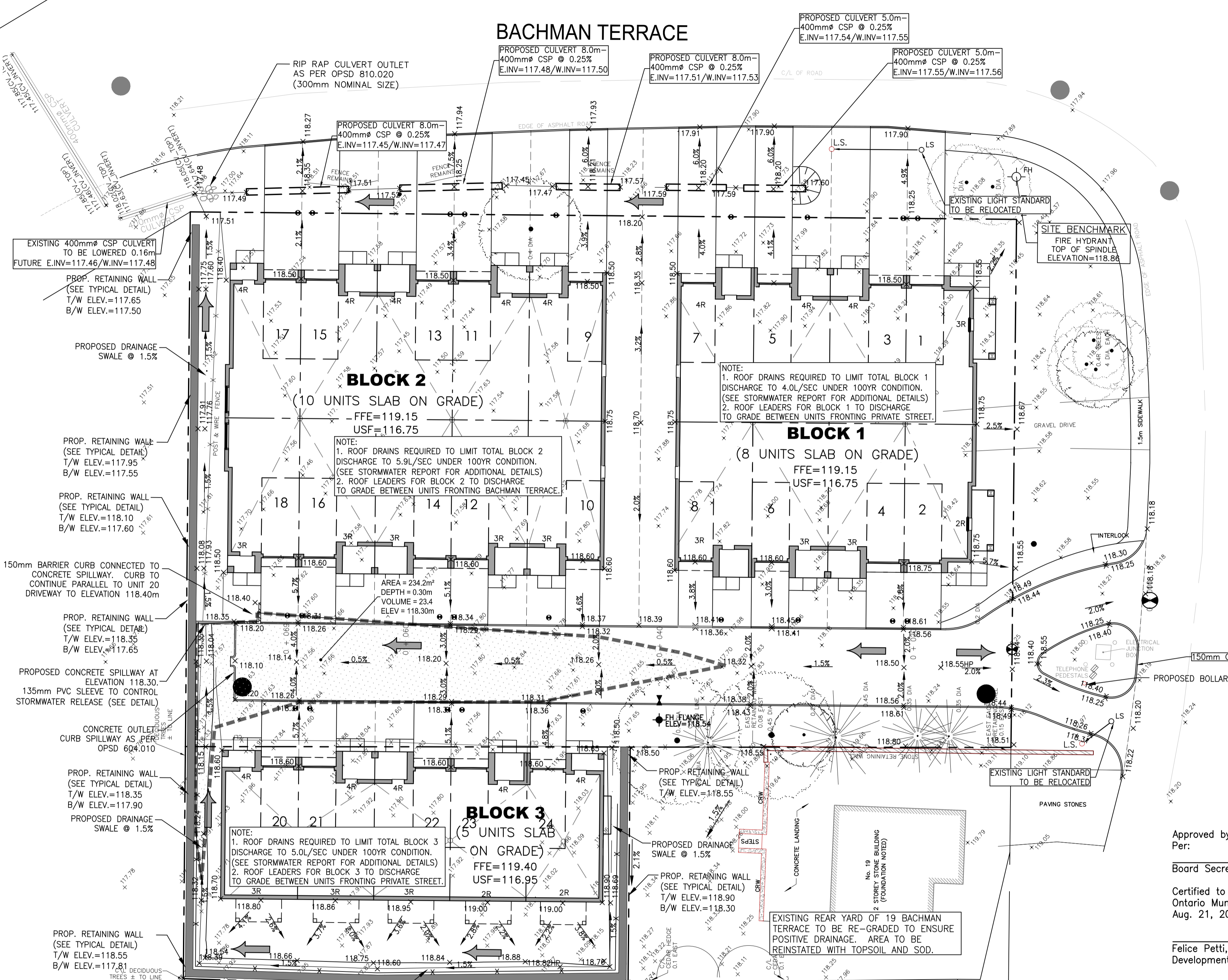

PART 3, PLAN 4R-24261

PART 2, PLAN 4R-24261

Approved by the Ontario Municipal Board
Per:
Board Secretary
Certified to be in conformity with the Ontario Municipal Board decision dated Aug. 21, 2015 OMB File No. P141061
Felice Petti, P.Eng. Manager
Development Review, Suburban Services

WIDENING PER INST. 154566