

EXISTING TREE INVENTORY

No.	Botanical Name	Common Name	DBH (cm)	CRZ (m)	Condition	Owner	Remarks	Recomm.
1	Pinus sylvestris	Scots Pine	30.0	3.00	D	Neighbour	Dead	Remove
2	Acer negundo	Manitoba Maple	70.0	7.00	F	Neighbour	significant lean	PROTECT
3	Pinus sylvestris	Scots Pine	30.0	3.00	D	Private	Dead	Remove
4	Pinus sylvestris	Scots Pine	30.0	3.00	P	Boundary	Minimal needle foliage at tree top	PROTECT
5	Acer negundo	Manitoba Maple	30.0	3.00	F	Boundary	lean	PROTECT
6	Pinus sylvestris	Scots Pine	30.0	3.00	D	Private	Dead	Remove
7	Acer negundo	Manitoba Maple	40.0	4.00	F	Private	lean	PROTECT
8	Pinus sylvestris	Scots Pine	30.0	3.00	P	Private	Minimal needle foliage at tree top	Remove
9	Pinus sylvestris	Scots Pine	40.0	4.00	P	Private	Minimal needle foliage at tree top	Remove
10	Pinus sylvestris	Scots Pine	30.0	3.00	P	Private	Minimal needle foliage at tree top	Remove
11	Pinus sylvestris	Scots Pine	40.0	4.00	P	Private	Minimal needle foliage at tree top	PROTECT
12	Acer negundo	Manitoba Maple	60.0	6.00	F	Boundary	lean	PROTECT
13	Acer negundo	Manitoba Maple	60.0	6.00	F	Private	lean	PROTECT
14	Pinus strobus	White Pine	30.0	3.00	F	Private	lean	PROTECT
15	Acer negundo	Manitoba Maple	50.0	5.00	F	Private	lean	Remove
16	Salix alba	Willow	80.0	8.00	P	Private	split trunk, dead wood, decay	PROTECT
17	Pinus sylvestris	Scots Pine	30.0	3.00	P	Private	Minimal needle foliage at tree top	PROTECT
18	Pinus sylvestris	Scots Pine	40.0	4.00	P	Private	Minimal needle foliage at tree top	PROTECT
19	Populus deltoides	Eastern Cottonwood	60.0	6.00	F	Private	lean	PROTECT
20	Acer saccharum	Sugar Maple	50.0	5.00	G	Neighbour		PROTECT
21	Acer saccharum	Sugar Maple	40.0	4.00	G	Private		PROTECT
22	Acer platanoides	Norway Maple	40.0	4.00	G	Neighbour		PROTECT
23	Acer saccharum	Sugar Maple	30.0	3.00	F	Private	multi-leader	PROTECT
24	Acer saccharum	Sugar Maple	30.0	3.00	F	Private	multi-leader	PROTECT
25	Populus deltoides	Eastern Cottonwood	70.0	7.00	F	Boundary	lean	PROTECT
26	Acer saccharum	Sugar Maple	40.0	4.00	F	Private	lean	Remove
27	Acer saccharum	Sugar Maple	30.0	3.00	F	Boundary	multi-leader	PROTECT
28	Acer saccharum	Sugar Maple	30.0	3.00	F	Boundary	multi-leader	PROTECT
29	Acer saccharum	Sugar Maple	30.0	3.00	F	Boundary	multi-leader	PROTECT
30	Pinus sylvestris	Scots Pine	30.0	3.00	P	Private	Minimal needle foliage at tree top	PROTECT
31	Pinus sylvestris	Scots Pine	30.0	3.00	P	Private	Minimal needle foliage at tree top	PROTECT
32	Populus deltoides	Eastern Cottonwood	70.0	7.00	F	Private	lean	PROTECT
33	Pinus sylvestris	Scots Pine	30.0	3.00	P	Private	Minimal needle foliage at tree top	PROTECT
34	Acer saccharum	Sugar Maple	30.0	3.00	F	Boundary	multi-leader	PROTECT
35	Acer saccharum	Sugar Maple	30.0	3.00	F	Boundary	multi-leader	PROTECT
36	Quercus rubra	Red Oak	40.0	4.00	G	Neighbour		PROTECT
37	Pinus sylvestris	Scots Pine	40.0	4.00	D	Private	Dead	PROTECT
38	Acer saccharum	Sugar Maple	30.0	3.00	G	Private		PROTECT
39	Acer saccharum	Sugar Maple	30.0	3.00	G	Private		PROTECT
40	Acer saccharum	Sugar Maple	30.0	3.00	F	Private		Remove
41	Picea abies	Norway Spruce	30.0	3.00	F	Private		Remove
42	Acer platanoides	Norway Maple	50.0	5.00	F	Neighbour		PROTECT
43	Acer platanoides	Norway Maple	50.0	5.00	F	Neighbour		PROTECT
44				0.00		Neighbour	missed	PROTECT
45	Acer platanoides	Norway Maple	60.0	6.00	F	Neighbour		PROTECT
46	Acer saccharum	Sugar Maple	70.0	7.00	P	Private		PROTECT
47	Acer negundo	Manitoba Maple	40.0	4.00	P	Private	significant lean	PROTECT
48	Prunus serotina	Black Cherry	30.0	3.00	F	Private		PROTECT
49	Pinus sylvestris	Scots Pine	30.0	3.00	F	Private	Minimal needle foliage at tree top	PROTECT
50	Acer negundo	Manitoba Maple	30.0	3.00	F	Neighbour	x3	PROTECT
51	Pinus sylvestris	Scots Pine	40.0	4.00	F	Private	Minimal needle foliage at tree top	PROTECT
52	Pinus sylvestris	Scots Pine	30.0	3.00	F	Private	Minimal needle foliage at tree top	Remove
53	Pinus sylvestris	Scots Pine	30.0	3.00	F	Private	Minimal needle foliage at tree top	Remove
54	Pinus sylvestris	Scots Pine	30.0	3.00	F	Private	Minimal needle foliage at tree top	Remove
55	Pinus sylvestris	Scots Pine	30.0	3.00	F	Private	Minimal needle foliage at tree top	Remove
56	Acer negundo	Manitoba Maple	30.0	3.00	F	Neighbour		PROTECT
57	Populus deltoides	Eastern Cottonwood	30.0	3.00	F	Private		PROTECT
58	Picea glauca	White Spruce	30.0	3.00	G	Neighbour		PROTECT
59	Picea glauca	White Spruce	30.0	3.00	G	Neighbour		PROTECT
60	Picea glauca	White Spruce	30.0	3.00	G	Neighbour		PROTECT
61	Picea glauca	White Spruce	30.0	3.00	G	Neighbour		PROTECT
62	Pinus strobus	White Pine	40.0	4.00	G	Private		PROTECT
63	Pinus strobus	White Pine	30.0	3.00	G	Private		PROTECT
64	Pinus strobus	White Pine	40.0	4.00	G	Private		Remove
65	Pinus sylvestris	Scots Pine	30.0	3.00	F	Private	Minimal needle foliage at tree top	PROTECT
66	Pinus sylvestris	Scots Pine	30.0	3.00	F	Private	Minimal needle foliage at tree top	PROTECT
67	Pinus sylvestris	Scots Pine	30.0	3.00	F	Private	Minimal needle foliage at tree top	PROTECT
68	Populus deltoides	Eastern Cottonwood	30.0	3.00	F	Neighbour	x6	PROTECT
69	Populus deltoides	Eastern Cottonwood	40.0	4.00	F	Neighbour	x3	PROTECT
70	Acer saccharum	Sugar Maple	30.0	3.00	P	Private		PROTECT
71	Acer saccharum	Sugar Maple	40.0	4.00	P	Private		PROTECT
72	Acer saccharum	Sugar Maple	30.0	3.00	P	Private		PROTECT
73	Pinus strobus	White Pine	30.0	3.00	G	Private		PROTECT
74	Pinus sylvestris	Scots Pine	30.0	3.00	F	Private	Minimal needle foliage at tree top	PROTECT
75	Pinus strobus	White Pine	30.0	3.00	G	Private		PROTECT
76	Pinus strobus	White Pine	40.0	4.00	G	Private		PROTECT
77	Pinus sylvestris	Scots Pine	30.0	3.00	F	Private	Minimal needle foliage at tree top	PROTECT
78	Pinus sylvestris	Scots Pine	40.0	4.00	F	Private	Minimal needle foliage at tree top	PROTECT
79	Pinus sylvestris	Scots Pine	30.0	3.00	F	Private	Minimal needle foliage at tree top	PROTECT
80	Acer saccharum	Sugar Maple	30.0	3.00	P	Private		PROTECT
81	Acer saccharum	Sugar Maple	40.0	4.00	P	Private		PROTECT
82	Acer saccharum	Sugar Maple	50.0	5.00	P	Private		PROTECT
83	Acer saccharum	Sugar Maple	30.0	3.00	P	Private		PROTECT
84	Acer saccharum	Sugar Maple	30.0	3.00	P	Private		PROTECT
85	Acer saccharum	Sugar Maple	30.0	3.00	P	Private		PROTECT
86	Acer saccharum	Sugar Maple	30.0	3.00	P	Private		PROTECT
87	Acer saccharum	Sugar Maple	30.0	3.00	P	Private		PROTECT
88	Pinus sylvestris	Scots Pine	30.0	3.00	F	Private	Minimal needle foliage at tree top	Remove
89	Pinus sylvestris	Scots Pine	30.0	3.00	F	Private	Minimal needle foliage at tree top	PROTECT
90	Pinus sylvestris	Scots Pine	30.0	3.00	F	Private	Minimal needle foliage at tree top	PROTECT
91	Acer negundo	Manitoba Maple	30.0	3.00	F	Private		PROTECT
92	Acer negundo	Manitoba Maple	30.0	3.00	F	Private		PROTECT
93	Pinus strobus	White Pine	30.0	3.00	G	Private		PROTECT
94	Populus deltoides	Eastern Cottonwood	30.0	3.00	F	Private		PROTECT
95	Populus deltoides	Eastern Cottonwood	40.0	4.00	F	Private		PROTECT
96	Pinus strobus	White Pine	30.0	3.00	G	Private		Remove

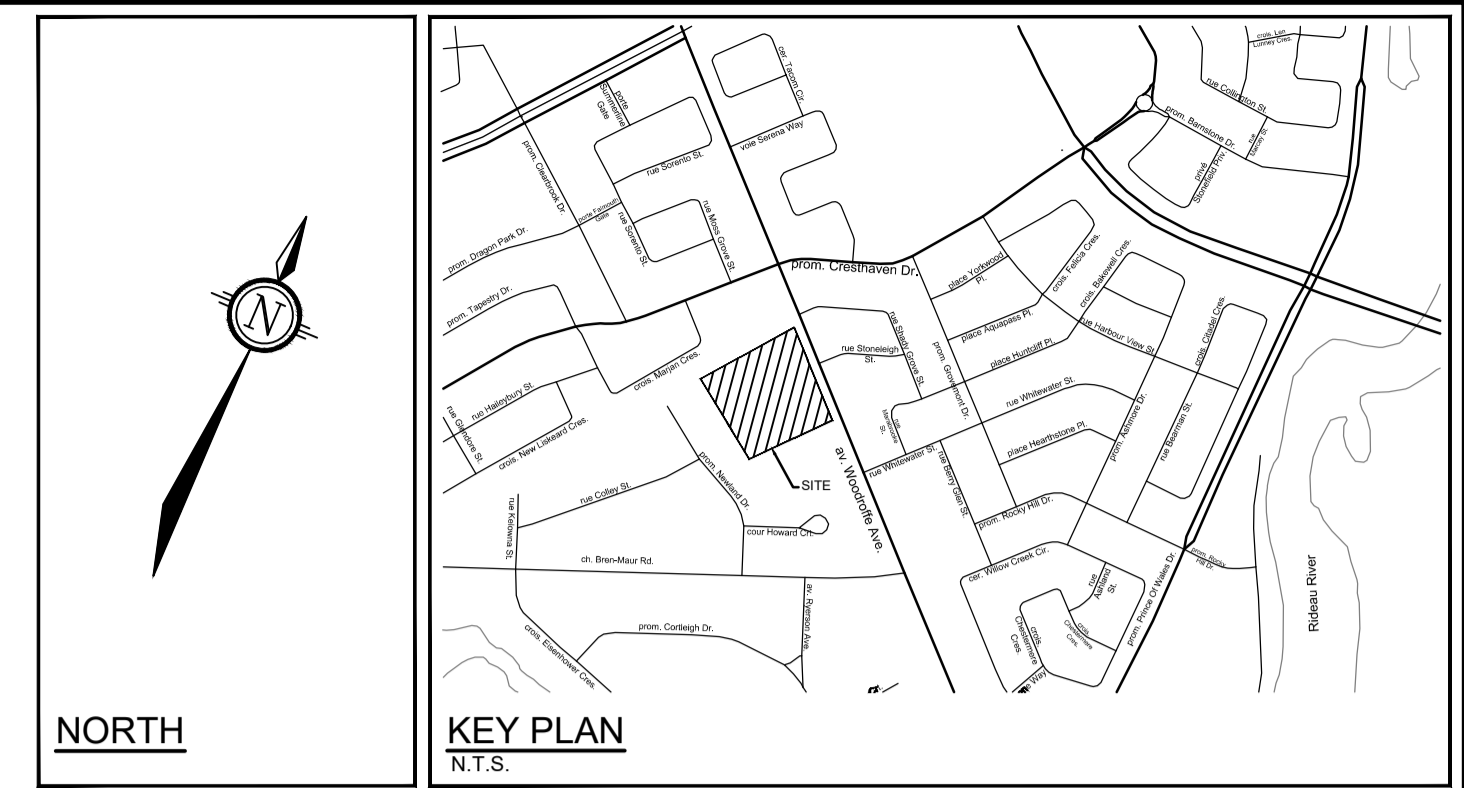

LEGEND

- 3-D1: DETAIL SHEET # 3-D1, NOVATECH OR CITY DETAIL NUMBER SEE LIST FOR CODE
- PROPERTY LIMIT
- EXISTING TREE TO REMAIN, SYMBOL SIZE REFLECTS CRZ
- EXISTING TREE TO REMOVE, SYMBOL SIZE REFLECTS CRZ
- TREE PROTECTION FENCE

TREE PROTECTION

Implement the following protection measures for retained trees, both on site and on adjacent sites, prior to any work activity, including tree removal. Maintain tree protection fence in place and in good condition for the duration of site works:

- The Landscape Architect or Certified Arborist is to determine the location of the tree protection fencing and detail it on any associated plans for the site (e.g. tree conservation report, tree disclosure report, etc.).
- Under the guidance of a Landscape Architect or Certified Arborist, erect a fence at the critical root zone (CRZ) of trees. Diameter at breast height (DBH) is the trunk diameter measured at 1.3m height on the tree trunk. The CRZ is calculated as DBH x 10. Refer to the Tree Protection Fence detail.
- Refer to the Tree Protection Plan for fence location. City Forestry Staff are to approve both the plan and the installed fence prior to work commencement.
- Do not place any material or equipment within 2m of the CRZ of any tree, including outhouses.
- Do not disturb, raise, or lower the existing grade within the CRZ, without approval.
- Only tunnel or bore when digging within the CRZ of a tree. Hand work only where required within the CRZ; absolutely no machinery permitted.
- Do not damage the root system, trunk, or branches, or any tree.
- Do not extend hard surface or significantly change landscaping.
- Ensure that exhaust fumes from all equipment are directed away from any tree canopy.
- When trees marked for removal overlap with the CRZ of trees marked for preservation: cut roots at the edge of the CRZ and grind down stumps after tree removals; do not pull out stumps. Ensure there is no root pulling or disturbance of the ground within the CRZ.
- Prior to work taking place, notify and consult the Landscape Architect and City Forestry Staff if roots must be cut. Roots 20mm or larger should be cut at right angles with clean, sharp horticultural tools without tearing, crushing, or pulling. Refer to City of Ottawa Specification S.P. F-8011 Tree Protection, Excavation of Root Zone.
- If damaged or objectionable branches are observed, consult the Landscape Architect, before any work is conducted. Do not prune leaders. Do not prune more than 1/4 of crown.
- Set up a water and fertilizing program, if trees are being affected by site works, to the satisfaction of the Landscape Architect.
- The Landscape Architect is to prescribe mitigation measures if the protected fenced area must be reduced to facilitate construction. Measures may include the placement of plywood, wood chips, or steel plating over the roots for protection. City Forestry Staff are to approve said measures prior to fence movement.
- City of Ottawa By-law: Protects municipal trees and municipal natural areas in the City of Ottawa and trees on private property in the urban area of the City of Ottawa (2020-340).



- GENERAL**
- Read and interpret this drawing/ drawing set in conjunction with all the contract details and specifications, including related civil, utility, structural, architectural, mechanical, electrical, environmental, geotechnical, and survey information.
 - The Contractor is to determine the exact location, size, material, and elevation of all existing utilities prior to commencing construction. Protect and assume responsibility for all existing utilities regardless of being shown on the drawings.
 - It is essential to use the plans and details in conjunction with the specifications and notes.
 - Do not scale drawings. Work to dimensions only.
 - Protect all existing and retained vegetation for the duration of construction according to the contract details and specifications.
 - Reinstate all areas and items damaged or disturbed, beyond the Limit of Work, because of construction activities, including but not limited to construction staging areas, haul roads, stockpile areas, etc., to the satisfaction of the Consultant. Unless otherwise noted, Contractor is to reinstate all areas to pre-construction condition or better to the satisfaction of the Contract Administrator.

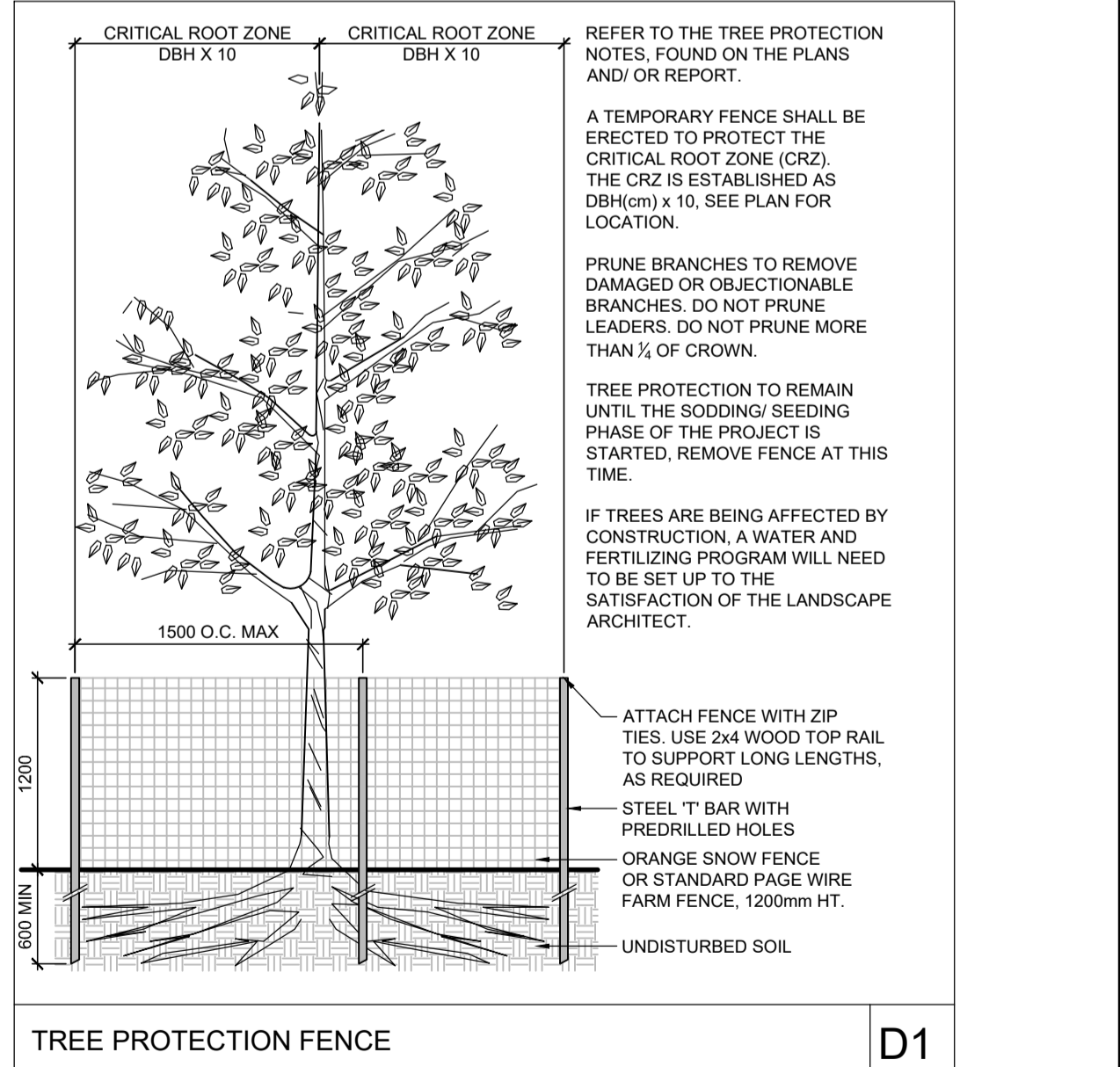

NOTE:
THE POSITION OF ALL POLE LINES, CONDUITS, WATERMANS, SEWERS AND OTHER UNDERGROUND AND OVERGROUND UTILITIES AND STRUCTURES IS NOT NECESSARILY SHOWN ON THE CONTRACT DRAWINGS, AND WHERE SHOWN, THE ACCURACY OF THE POSITION OF SUCH UTILITIES AND STRUCTURES IS NOT GUARANTEED. BEFORE STARTING WORK, DETERMINE THE EXACT LOCATION OF ALL SUCH UTILITIES AND STRUCTURES AND ASSUME ALL LIABILITY FOR DAMAGE TO THEM.

No.	REVISION	DATE	BY
3.	RE-ISSUED FOR SITE PLAN APPLICATION	APR 24/26	SC
2.	RE-ISSUED FOR SITE PLAN CONTROL APPLICATION	NOV 5/25	SC
1.	ISSUED FOR SITE PLAN CONTROL APPLICATION	OCT 7/25	SC

NOVATECH
Engineers, Planners & Landscape Architects
Suite 200, 240 Michael Cowpland Drive
Ottawa, Ontario, Canada K2M 1P6
Telephone (613) 254-9643
Facsimile (613) 254-5867
Website www.novatech-eng.com

FOR REVIEW ONLY

DESIGN: MJT
CHECKED: SC
DRAWN: MJT
CHECKED: SC
APPROVED: SC

LOCATION: CITY OF OTTAWA, 3400 WOODROFFE AVENUE
DRAWING NAME: TREE CONSERVATION PLAN
PROJECT No: 124147-00
REV: REV # 3
DRAWING No: 124147-TCR
PLANNING CODE: #19422

D02-02-25-0090 D07-12-25-0158