

PLAN VIEW
SCALE 1:750

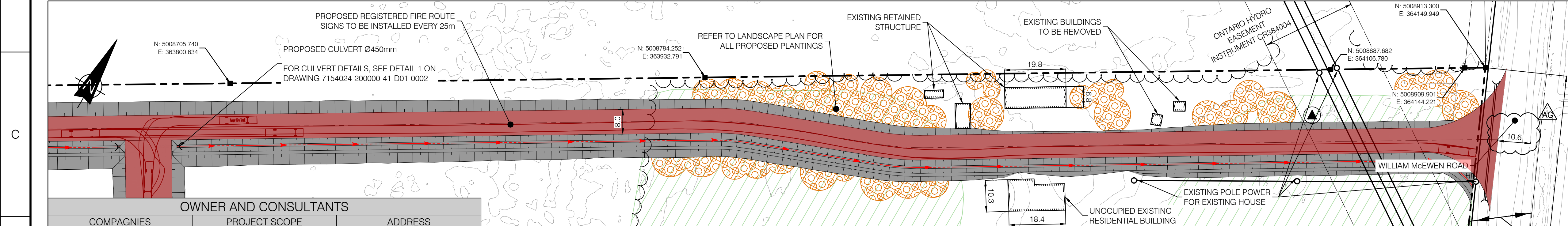

ACCESS ROAD PLAN VIEW
SCALE 1:750

OWNER AND CONSULTANTS		
COMPAGNIES	PROJECT SCOPE	ADDRESS
TRAIL ROAD BESS INC	OWNER / DEVELOPPER	4186 WILLIAM MCEWEN DRIVE, RICHMOND, ON K0A 2E0
BBA	CIVIL ENGINEERING	20 CARLSON COURT, SUITE 100, TORONTO, ON M9W 7K6
STANTEC	PLANNING, LANDSCAPE PLANS	1331 CLYDE AVE. #300, OTTAWA, ON K2C 3G4
HATCH	GEOTECHNICAL, HYDROGEOLOGY	2800 SPEAKMAN Dr. MISSISSAUGA, ON L5K 2R7
TULLOCH GEOMATICS INC.	SURVEYOR	900 MORRISON Dr. SUITE 208, OTTAWA, ON K2H 8K7

DRAWING No.	DESCRIPTION	REV	DESCRIPTION	PREPARED BY	CHECKED BY	DATE
REFERENCE DRAWINGS		REVISIONS				
25286.00	TRAIL ROAD INITIAL NOISE CONROL OPTIONS AERCOUSTICS	AD	FOR PERMITTING	B. THOMAS	V. BRUNELLE P. Eng.	2025-09-24
241437	TOPOGRAPHIC PLAN OF SURVEY	AC	FOR PERMITTING	B. THOMAS	V. BRUNELLE P. Eng.	2025-09-15
SURFACE LIDAR	LIDAR DTM OTTAWA-GATINEAU 2019-20 PACKAGE M	AB	FOR PERMITTING	B. THOMAS	V. BRUNELLE P. Eng.	2025-05-13
7154024300000-47-D20-0001-02	TRAIL BESS - 150 MW - 230 kV - 34.5 kV SUBSTATION	AA	FOR COMMENTS	B. THOMAS	V. BRUNELLE P. Eng.	2025-05-02

FOR PERMITTING
NOT TO BE USED FOR CONSTRUCTION

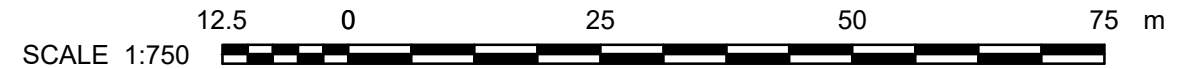

SCALE 1:750



KEY PLAN

LEGEND

WATERCOURSE DITCH

NATURAL RUNOFF CORRIDOR

DIVERSION DITCH

PROPOSED FENCE

PROPERTY LIMIT

STORMWATER SEWER

VEGETATION SWALE

PROPOSED FENCE

PROPERTY LIMIT

STORMWATER SEWER

MAIN PIPE FIRE PROTECTION 200mm HDPE DR11 PE4710

PIPE CONNECTION 150mm HDPE DR11 PE4710

HYDRANT

HYDRANTS BOLLARDS

BATTERY CORNERS BOLLARDS

POST INDICATOR VALVE

60m RADIUS PROTECTION

FLOW DIRECTION PORPOSED GRADE

PROPOSED CULVERT

TREE LINE

CULTIVATED AREA

ACCES ROAD

PROPOSED INSULATING

STONE SURFACE AREA

PROPOSED GRAVEL SURFACE AREA

PROPOSED GRADE

EXISTING GRADE ELEVATION

BATTERY/MVT GROUP

AUXILIARY TRANSFORMER

WET POND

EXISTING POLE

MONUMENT

LANDSCAPING

PROPOSED REGISTERED FIRE ROUTE

- NOTES:
- COORDINATES SYSTEM IS:
HORIZONTAL DATUM: MTM_NAD83 (CSRS)_ZONE 9
VERTICAL DATUM: CGVD28
 - THIS SITE PLAN HAS BEEN BASED ON THE SURVEYORS TOPOGRAPHY SKETCH PREPARED BY TULLOCH GEOMATICS INC. DATED MARCH 12, 2025
 - THE VEHICLE USED TO PERFORM THE SIMULATION IS PUMPER FIRE TRUCK
OVERALL LENGTH= 12.192m
OVERALL WIDTH= 2.489m
COUNTER-STEERING DELAY= 5sec
MAXIMUM WHEEL ANGLE 45.00°
 - LOT ADDRESS: 4186 WILLIAM MCEWEN DR, OTTAWA
 - REFER TO LANDSCAPE PLAN FOR ALL PROPOSED PLANTINGS
 - THE FIRE PROTECTION TANK SHALL BE FILLED VIA A TRUCK, AND SHALL HAVE A LEVEL GAUGE VISIBLE TO MAINTENANCE STAFF CONDUCTING SITE ROUNDS.
 - THE REFERENCE COORDINATES COMES FROM THE TULLOCH SURVEY 241437 DONE ON 10th JANUARY 2025

BY: REBECCA L. CHRISTOPHER
PRINTED: 2025-09-24 11:45:24