

LEGEND

- PROPERTY LINE
- RETAINED EXISTING BUILDING
- PROPOSED RETAINING WALL
- PEASTONE MAINTENANCE EDGE
- C.I.P. CONCRETE PATH
- PRECAST CONCRETE PAVERS TYP.1
- PRECAST CONCRETE PAVERS TYP.2
- STEPPING STONE PATH
- PROPOSED SOD
- PROPOSED PERENNIALS

Plant List					
Origin	ID	Qty	Botanical Name	Common Name	Sched. Size Remarks
Ntv	Gd	1	LARGE TREES		
			Gymnocladus dioicus	Kentucky Coffee Tree	70mm caliper WB, Staked
Ntv	Ov	1	MEDIUM TREES		
			Ostrya virginiana	Ironwood	50mm caliper WB, Staked
Ntv	Hvi	1	ORNAMENTAL TREES		
			Hamamelis virginiana	Virginia Witch Hazel	50mm caliper WB, Staked
Non N	MsRS	1	Magnolia stellata 'Royal Star'	Royal Star Magnolia	45mm caliper WB, Staked
Non N	MHG	1	Malus x 'Harvest Gold'	Harvest Gold Crabapple	50mm caliper WB, Staked
Ntv H	BnFV	1	SMALL ORNAMENTAL TREES*		
			Betula nigra 'Little King'	Fox Valley River Birch	150cm ht WB Staked
Ntv	Cal	2	SHRUBS		
			Clethra alnifolia	Summersweet Clethra	50cm ht
Ntv	Cs	2	Cornus sericea (stolonifera)	Red Twigged Dogwood	50cm ht
Ntv	DI	3	Diervilla lonicera	Dwarf Bush Honeysuckle	50cm ht.
Ntv H	HaA	9	Hydrangea arborescens 'Annabelle'	Annabelle Hydrangea	2 gallon pot
Ntv H	HqA	4	Hydrangea quercifolia 'Amethyst'	Amethyst Oakleaf Hydrangea	2 gallon pot 1.2m o.c.
Ntv H	JvSR	3	Juniperus virginiana 'Skyrocket'	Skyrocket Juniper	150cm ht Potted
Ntv H	PoTW	2	Physocarpus opulifolius 'Tiny Wine'	Tiny Wine Ninebark	50cm ht.
Non N	SbT	9	Spiraea betulifolia 'Tor'	Tor Birchleaf Spirea	50cm ht
Non N	SjS	3	Spiraea japonica 'Shirobana'	Shirobana Spirea	3 gallon pot
Ntv	Mp	3	PERENNIALS		
			Matteuccia pennsylvanica	Ostrich Fern	2 gallon pot
Mix	PvA	85	Perennial varieties A	Flowering perennials sun/part shade for roadside	0.5m o.c
Mix	PvB	13	Perennial varieties B	Groundcovers for light foot-traffic	0.3m o.c
Mix	PvC	20	Perennial varieties C	Flowering perennials sun/part shade	0.6m o.c
Mix	PvD	25	Perennial varieties D	Flowering perennials shade/part shade	0.5m o.c
Mix	PvE	85	Perennial varieties E	Flowering perennials shade/part shade moist areas	0.45m o.c.

Plant origin:
Ntv - Native
Ntv H - Native species, horticultural variety
Mix - Mixed: minimum 50% native
Non N - Introduced, non-invasive species

Perennial varieties:
PvA - Purple Coneflower (Ntv), Sea Thrift (Ntv), Black-eyed Susan (Ntv), Daylilies (Non N)
PvB - Irish Moss (Non N), Barren Strawberry (Ntv), Prairie Everlasting (Ntv)
PvC - Daylilies (Non N), Russian Sage (Non N), Purple Coneflower (Ntv), White Blazing Star (Ntv)
PvD - Hosta varieties (Non N), Spotted Geranium (Ntv), Wild Blue Phlox (Ntv), Rodgersia (Non N), Ferns (Ntv)
PvE - Firecracker Yellow Loosestrife (Ntv H), Cardinal Flower (Ntv), Rodgersia (Non N), Blue Flag Iris (Ntv)

Note:
MHG and BnFV between building and Murray street are on City property and will be City owned.

NOTE:

THIS PLAN IS ISSUED FOR SITE PLAN CONTROL SUBMISSION ONLY. ADDITIONAL DETAILING AND SPECIFICATIONS ARE REQUIRED PRIOR TO TENDERING OR CONSTRUCTION.

THIS PLAN TO BE READ IN CONJUNCTION WITH TCR BY DENDRON FORESTRY SERVICES. EXISTING TREES TO BE PRESERVED AND PROTECTED AS PER TCR.

SERVICING INFORMATION SHOWN AS REFERENCE ONLY. REFER TO CIVIL DRAWINGS.

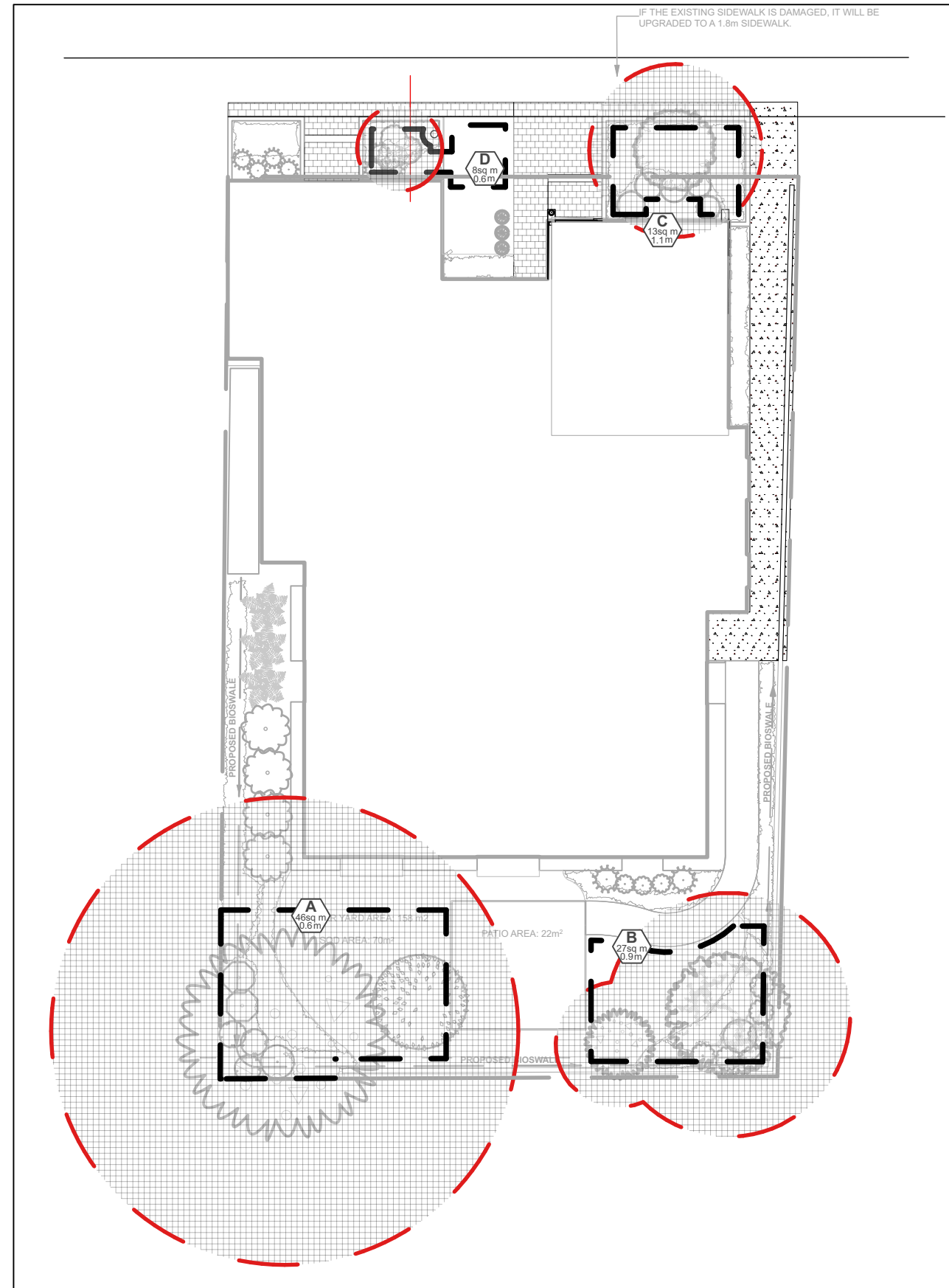

LEGEND

- SOIL VOLUME AREA AND IDENTIFIER
- MATURE TREE CANOPY AREA

TREE CANOPY COVERAGE	
TOTAL CANOPY AREA	326 m ²
TOTAL SITE AREA	654 m ²
PERCENT COVERAGE	50%

SOIL VOLUME CHART:

Soil Volume Area, Tree Quantity and Size	Tree Qty	OTTAWA Target Soil Volume (m ³)	Design Soil Volume (m ³)	Soil Adequacy %	Tree Ownership	Contractor soil volume provision
AREA A - 1 large tree, 1 ornamental tree						
plant bed (46 sq m x 0.6 ave metre deep)	2	27.0	27.6	102%	Private	See note
AREA B - 1 medium tree, 1 ornamental tree						
plant bed (26.5 sq m x 0.9 ave metre deep)	2	24.0	23.9	99%	Private	See note
AREA C - 1 ornamental tree						
plant bed (13 sq m x 1.1 ave metre deep)	1	15.0	14.3	95%	City	100%
AREA D - 1 small ornamental tree (8cm DBH)*						
plant bed (8 sq m x 0.6 ave metre deep)	1	5.0	4.8	96%	City	100%

* Smaller columnar trees, small ornamental trees with growth to 8-15cm DBH, large shrubs, and columnar conifers calculated using 'How much soil to grow a big tree' by DeepRoot as a guide

NOTES:

- PLANTING MEDIUM REQUIREMENTS FOR TREE PLANTING**
- .1 AREAS A & B**
- ADDITIONAL PLANTING MEDIUM IS NOT REQUIRED WHERE EXISTING SOIL IS PRESENT IN OR ADJACENT TO THE PROPERTY WITHIN 1.5m. THIS DOES NOT INCLUDE TOPSOIL REQUIRED FOR SODDING.
- WHERE SUBSOIL BELOW THE INDICATED DEPTH OF PLANTING MEDIUM IS NOT CONDUCTIVE TO PLANT GROWTH, REPLACE WITH APPROVED SUBSOIL TO A DEPTH OF 300mm.
- IN DISTURBED AREAS OR WHERE EXISTING SOILS ARE REMOVED OR NOT CONDUCTIVE TO PLANT GROWTH, PLACE PLANTING MEDIUM (TO DEPTH INDICATED ON SOIL VOLUME CHART).
BASE CONTRACT TO ASSUME SUBSOIL IS CONDUCTIVE TO PLANT GROWTH.
- .2 AREAS C & D:**
- REPLACE ANY EXISTING MATERIALS, PROVIDING 100% PLANTING MEDIUM TO DEPTHS INDICATED IN SOIL VOLUME CHART.
- WHERE SUBSOIL BELOW THE INDICATED DEPTH OF PLANTING MEDIUM IS NOT CONDUCTIVE TO PLANT GROWTH, REPLACE WITH APPROVED SUBSOIL TO A FURTHER DEPTH OF 300mm.
BASE CONTRACT TO ASSUME SUBSOIL IS CONDUCTIVE TO PLANT GROWTH.

Ruhland & Associates Ltd

landscape architecture • urban design • site planning

Ph 613-224-4744 Fx 613-224-1331 info@rala.ca www.rala.ca

DEVELOPER:
OTTAWA CARLETON CONSTRUCTION GROUP LTD.
37 Sunnyside Avenue, Suite 101 Ottawa, ON K1S 0R9

CONSULTING ENGINEER:
T.L. MAK ENGINEERING CONSULTANTS LTD.
1455 Youville Dr, Orleans, ON K1C 6Z7.

SURVEYOR:
ANNIS, O'SULLIVAN, VOLLEBEKK LTD. - SURVEYOR
14 Concourse Gate Suite 500, Nepean, ON K2E 7S6

GENERAL NOTES

- All general site information and conditions compiled from existing plans, surveys and consultant's field notes. Report all discrepancies prior to any work. No responsibility is born by the Consultant for unknown subsurface conditions.
- The location of the utilities is approximate only, and the exact location should be determined by consulting the municipal authorities and utility companies concerned. The Contractor shall prove the location of utilities and shall be responsible for adequate protection from damage.
- All dimensions shown are to be verified on site prior to any construction. No deviations are to be made from the layouts as shown on this plan without prior consultation with the Landscape Architect and Owner.
- Obtain approval of the Consultant(s) for granular base and layout of all pavement areas prior to construction.
- Stake planting locations and receive approval of Landscape Architect, prior to excavation of any planting pits. No substitutions of plant material shall be made without prior approval of the Landscape Architect.
- Where clay is encountered proper drainage must be ensured in tree/shrub pits, prior to planting. Have method approved by Landscape Architect.
- Maintain positive surface runoff through the entire construction period.
- Reinstate all areas and items damaged as a result of construction activities.

7	Re-issued for Site Plan Control	2025-07-24
6	Re-issued for Site Plan Control	2025-06-23
5	Re-issued for Site Plan Control	2025-04-08
4	Re-issued for Site Plan Control	2024-11-29
3	Re-issued for Site Plan Control	2023-12-13
2	Re-issued for Site Plan Control	2023-11-01
1	Issued for Site Plan Control	2023-07-18

NUMBER/ NUMBER	MILESTONE / FAT SALLANT	DATE (Y/M/D)	INT.
DESIGNED BY / CONDUIT PAR	CHECKED BY / VERIFIE PAR		
A. Ahmed / M. Ruhland	M. Ruhland		
DRAWN BY / DESINE PAR	SCALE / ECHELLE		
T. Frost / V. Odusanya	1:100		

ARCHITECT

CONSULTANT



CONSULTANT

CONSULTANT

PROJECT / LOCATION

168 - 174 MURRAY ST ADDITION

168 - 174 MURRAY STREET
OTTAWA, ONTARIO
LOT 23, REGISTERED PLAN 42482, CITY OF OTTAWA

DRAWING

LANDSCAPE / PLANTING PLAN

SHEET NO.

PROJECT NO.

22-1682

L-01

107-12-24-0175

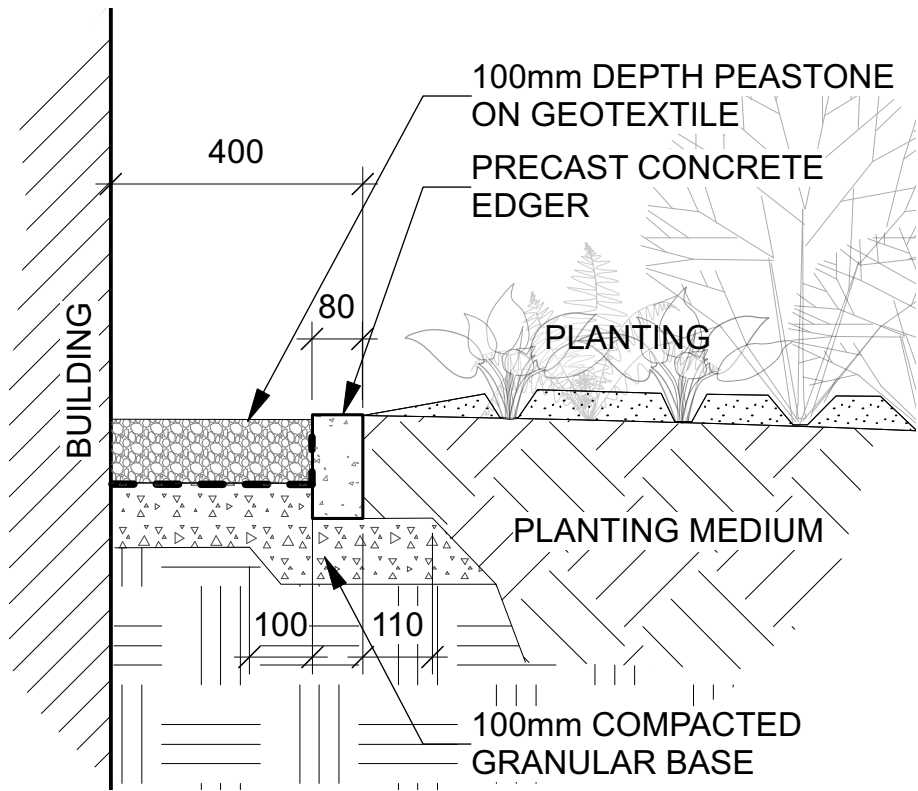

1 Peastone maintenance edge
Scale: NTS

NOTE - TREE SOIL VOLUME REQUIREMENTS: STANDARD TREE SOIL VOLUMES QUANTITIES INCLUDE THE TOP 900-1000mm OF SOIL/EXISTING SUBSOIL LAYER TO CALCULATE TOTAL SOIL VOLUMES REQUIRED BY CITY OF OTTAWA FOR SUSTAINABLE TREE GROWTH. WHERE LARGER SOFT AREAS ARE AVAILABLE, THE TOP 400-500mm LAYER IS USED TO CALCULATE SOIL VOLUMES.

WHERE EXISTING MATERIAL BELOW THE SPECIFIED TOPSOIL IS NOT CONDUCTIVE TO TREE GROWTH, AN ADDITIONAL LAYER OF PLANTING MEDIUM IS TO BE INSTALLED BELOW SPECIFIED TOPSOIL DEPTH TO OBTAIN THE SOIL VOLUME DEPTH REQUIRED.

REFER TO SOIL VOLUME CHART AND PLANS FOR AREA WHERE TREE SOIL VOLUMES ARE REQUIRED.

ADDITIONAL NOTES FOR NUMBER 5: PRECAST PAVERS IN PEDESTRIAN AREAS WHERE NORMAL SNOW REMOVALS ARE DONE IS TO RECEIVE A MINIMUM 200mm GRANULAR 'A'. FURTHER ADJUSTMENTS TO BE SPECIFIED IN RELATION TO SITE CONDITIONS AND GEOTECHNICAL RECOMMENDATIONS.

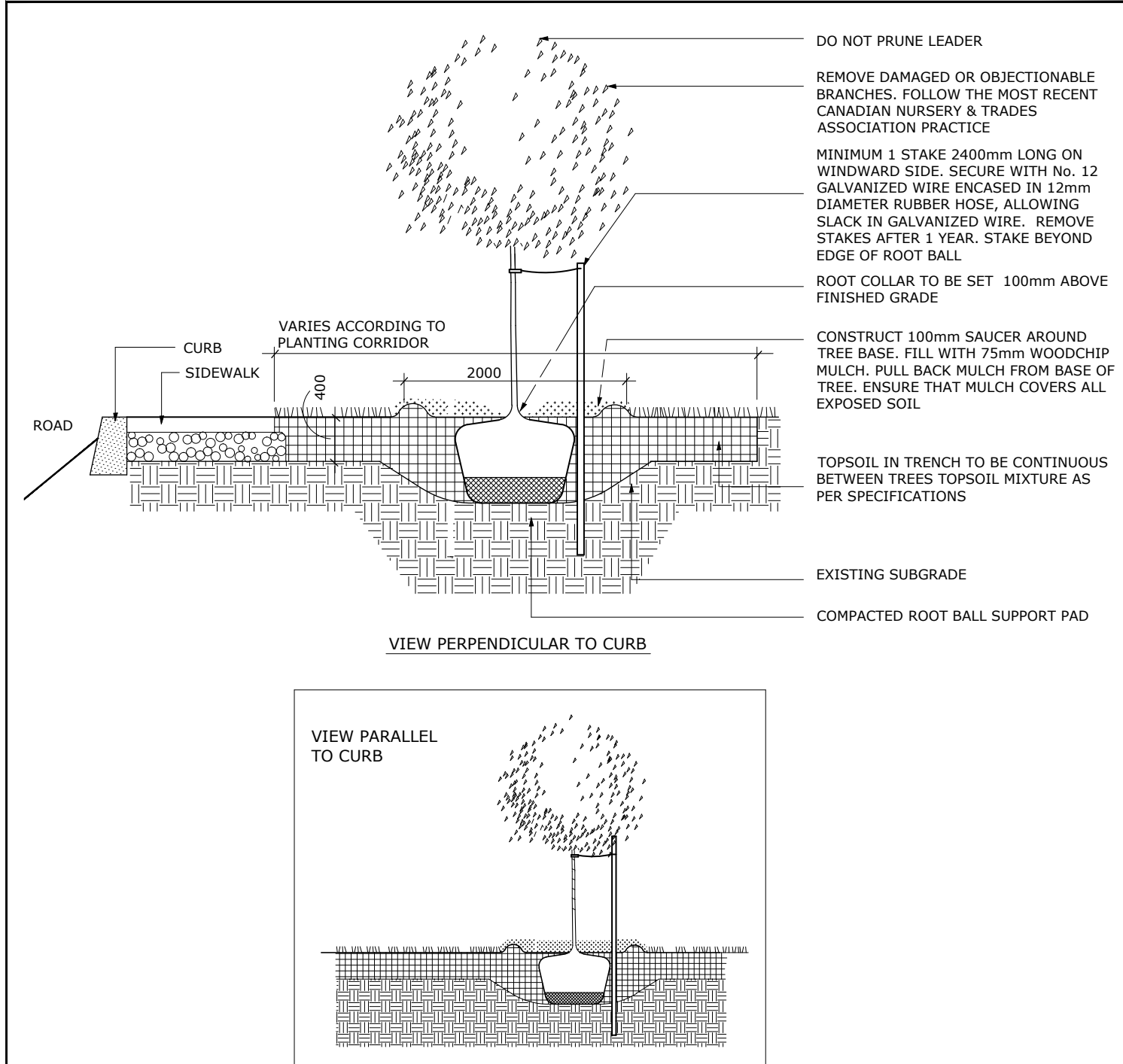

NOTES:

1. ALL MEASUREMENTS ARE IN MILLIMETRES UNLESS OTHERWISE NOTED
2. CUT AND REMOVE BURLAP AND WIRE BASKET FROM TOP 2/3 OF ROOT BALL WITHOUT DISTURBING ROOTS
3. LOCATION AS SPECIFIED ON THE CONTRACT DRAWINGS



TITLE: PLANTING TRENCH WELL DRAINED SOILS

DATE: MAY 2001
REV: JAN 2017
DWG No: L1

NOTE: TREE SOIL VOLUME REQUIREMENTS: - STANDARD TREE SOIL VOLUMES QUANTITIES INCLUDE THE TOP 900-1000mm OF SOIL/EXISTING SUBSOIL LAYER TO CALCULATE TOTAL SOIL VOLUMES REQUIRED BY CITY OF OTTAWA FOR SUSTAINABLE TREE GROWTH. WHERE LARGER SOFT AREAS ARE AVAILABLE, THE TOP 400-500mm LAYER IS USED TO CALCULATE SOIL VOLUMES. - WHERE EXISTING MATERIAL BELOW THE SPECIFIED TOPSOIL IS NOT CONDUCTIVE TO TREE GROWTH, AN ADDITIONAL LAYER OF PLANTING MEDIUM IS TO BE INSTALLED BELOW SPECIFIED TOPSOIL DEPTH TO OBTAIN THE SOIL VOLUME DEPTH REQUIRED. - REFER TO SOIL VOLUME CHART AND PLANS FOR AREA WHERE TREE SOIL VOLUMES ARE REQUIRED.

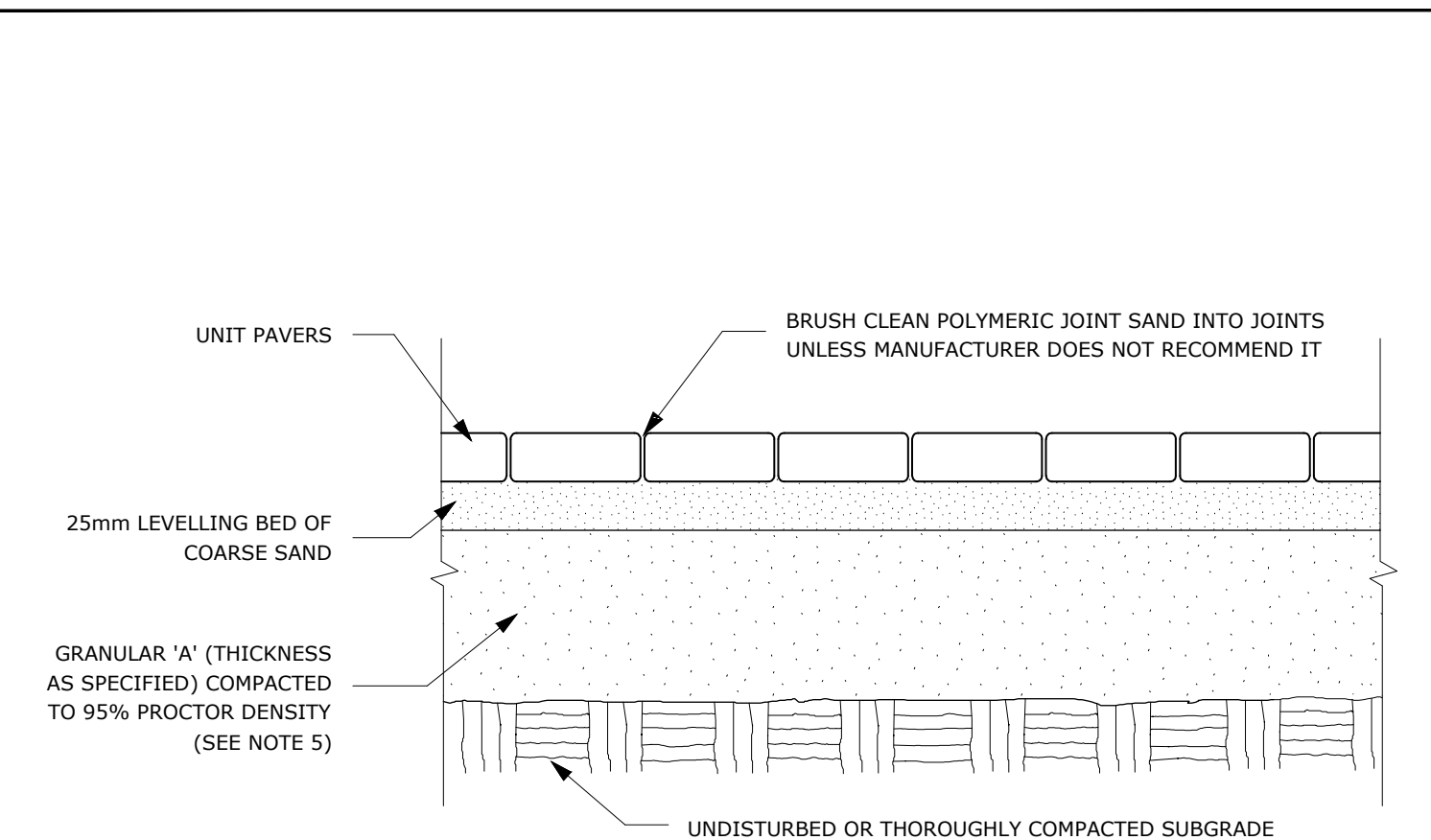

NOTES:

1. THE LEVELING COURSE (BEDDING SAND) SHALL BE PLACED LOOSE, IN A UNIFORM LAYER AT A MAXIMUM DEPTH OF 25mm TO ACHIEVE THE FINAL COMPACTED THICKNESS AND GRADE AS SPECIFIED
2. INSTALL SOLID EDGE RESTRAINT BETWEEN UNIT PAVERS AND ANY SOFT SURFACE (SOD, PLANTING BED, ETC.)
3. UNIT PAVERS ARE THEN PLACED ON TOP OF THE LEVELING COURSE AND ADDITIONAL SAND SWEEPED BETWEEN THE UNIT PAVERS
4. THE UNIT PAVERS ARE THEN VIBRATED INTO PLACE WITH A VIBRA-PLATE AND WATER IS ADDED TO ASSIST IN THE SETTLING OF THE JOINT SAND
5. GRANULAR 'A' DEPTH TO BE 100mm FOR PEDESTRIAN AREAS AND 150mm FOR VEHICULAR ACCESSES, OR AS RECOMMENDED BY GEOTECHNICAL INVESTIGATION
6. USE OF THIS DETAIL REQUIRES THE PRIOR APPROVAL OF THE GENERAL MANAGER



TITLE: UNIT PAVING - ON GRANULAR BASE

DATE: MAY 2001
REV: FEB 2016
DWG No: SC9

NOTE: ADDITIONAL NOTES FOR NUMBER 5: 100mm DEPTH GRANULAR 'A' TO BE USED (AFTER APPROVAL) ONLY IN PEDESTRIAN WHERE NO SNOW REMOVAL IS PLANNED. ALL OTHER PEDESTRIAN AREAS ARE TO RECEIVE 150mm COMPACTED GRANULAR 'A' MINIMUM, VEHICULAR 200mm MINIMUM. FURTHER ADJUSTMENTS TO BE SPECIFIED IN RELATION TO SITE CONDITIONS AND GEOTECHNICAL RECOMMENDATIONS.

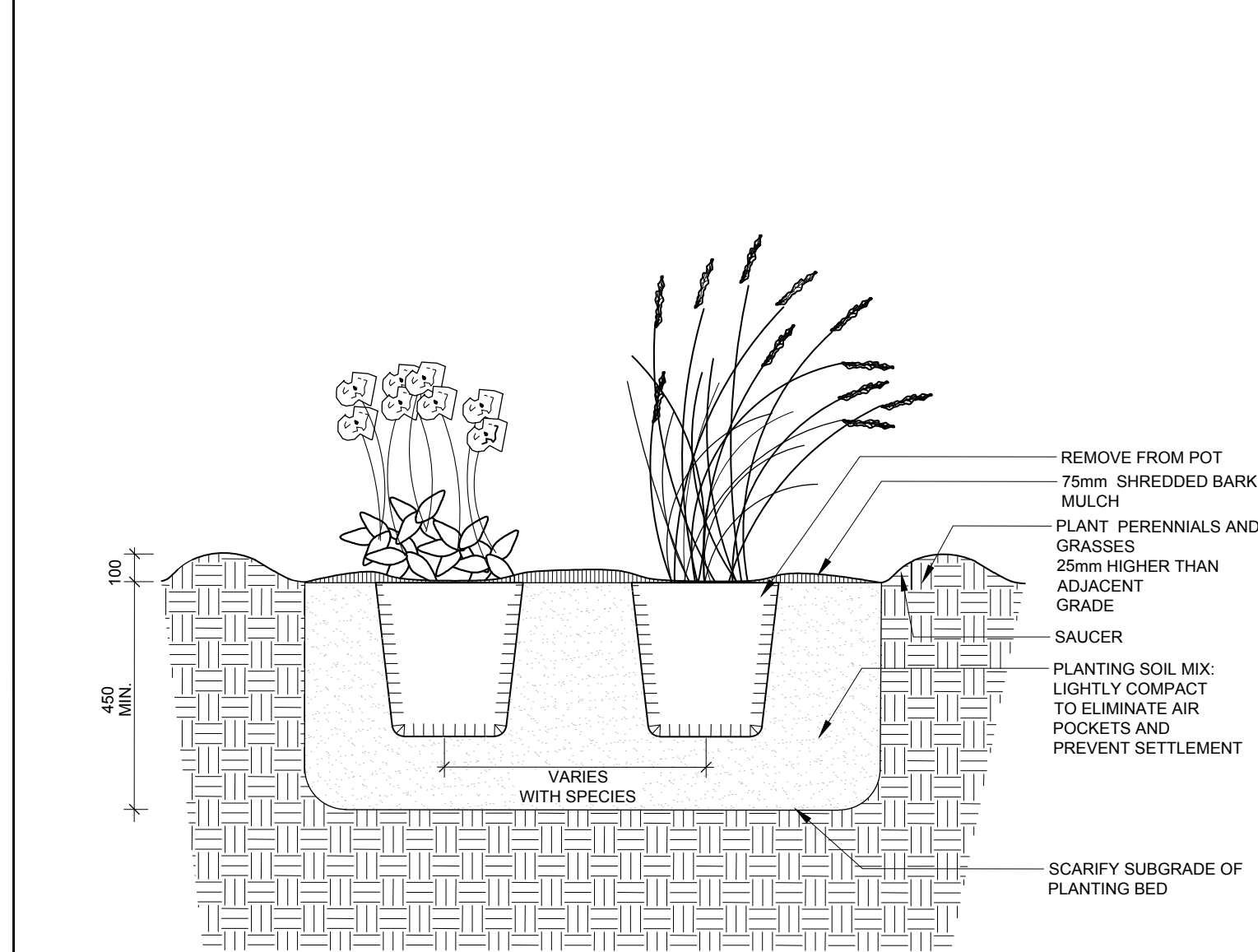

NOTES:

1. ALL DIMENSIONS ARE IN MILLIMETRES UNLESS OTHERWISE NOTED.
2. PLANTING SOIL MIXTURE AS PER SPECIFICATION.
3. PROVIDE 100MM HIGH EARTH SAUCER AROUND PERENNIAL/GRASS BED.



TITLE: PERENNIAL AND ORNAMENTAL GRASS PLANTING

DATE: JAN 2015
REV:
DWG No: L21

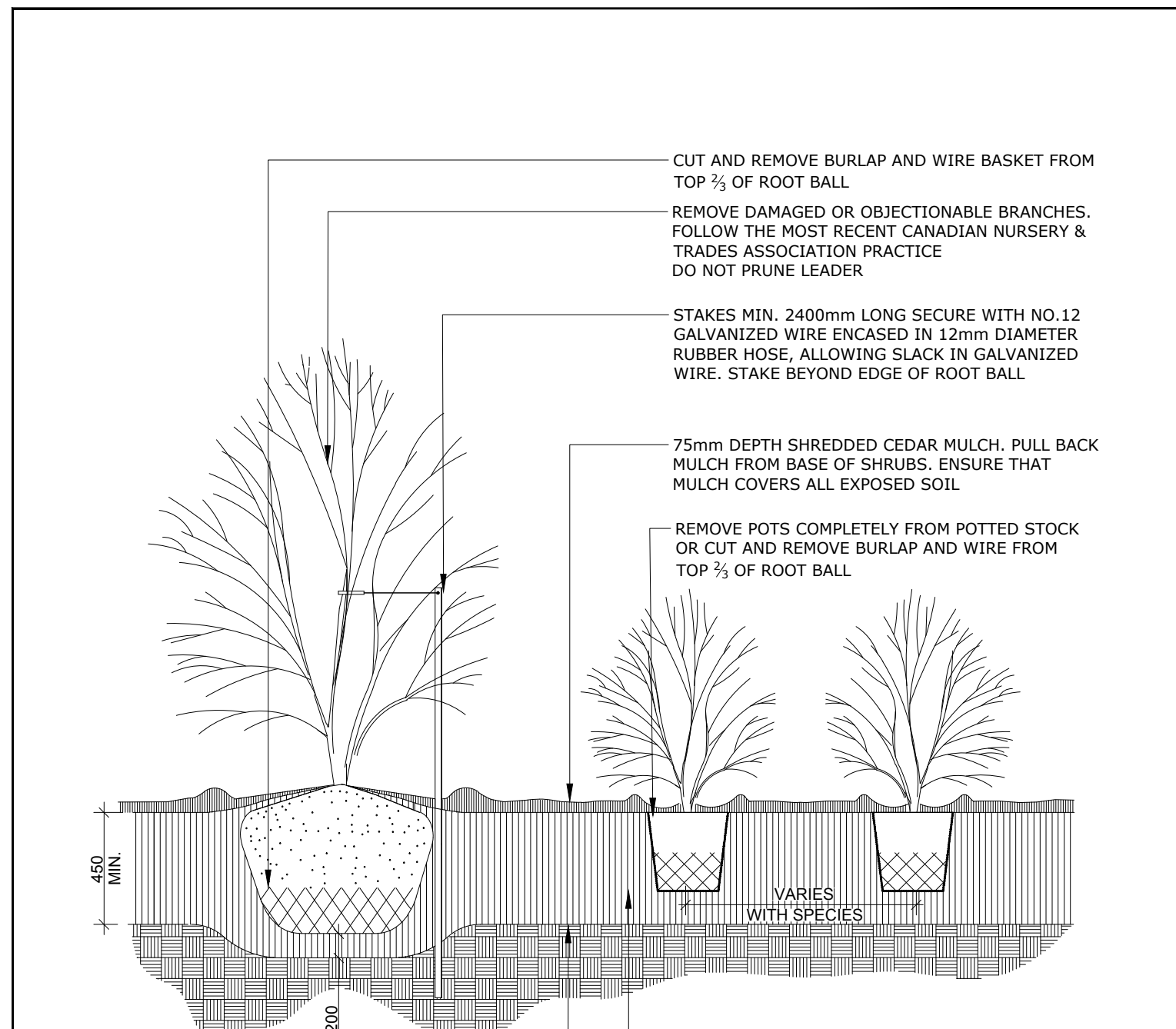

NOTES:

1. PLANTING SOIL MIXTURE AS PER SPECIFICATION.
2. SHRUBS SPECIFIED BARE ROOTS (B.R.) TO BE PLANTED SO THAT ROOTS ARE FULLY EXTENDED IN PLANTING HOLE WITH SOIL MIX BACKFILLED CAREFULLY TO PREVENT ROOT DAMAGE
3. PROVIDE 100 HIGH EARTH SAUCER AROUND SHRUB BED
4. STAKES TO BE REMOVED AT COMPLETION OF TWO YEAR WARRANTY PERIOD



TITLE: CONTINUOUS SHRUB BED PLANTING

DATE: FEB 2013
REV: FEB 2014
DWG No: L17

DEVELOPER:
OTTAWA CARLETON CONSTRUCTION GROUP LTD.
37 Sunnyside Avenue, Suite 101 Ottawa, ON K1S 0R9

CONSULTING ENGINEER:
T.L. MAK ENGINEERING CONSULTANTS LTD.
1455 Youville Dr, Orleans, ON K1C 6Z7-

SURVEYOR:
ANNIS, O'SULLIVAN, VOLLEBEKK LTD. - SURVEYOR
14 Concourse Gate Suite 500, Nepean, ON K2E 7S6

GENERAL NOTES

- .1 All general site information and conditions compiled from existing plans, surveys and consultant's field notes. Report all discrepancies prior to any work. No responsibility is born by the Consultant for unknown subsurface conditions.
- .2 The location of the utilities is approximate only, and the exact location should be determined by consulting the municipal authorities and utility companies concerned. The Contractor shall prove the location of utilities and shall be responsible for adequate protection from damage.
- .3 All dimensions shown are to be verified on site prior to any construction. No deviations are to be made from the layouts as shown on this plan without prior consultation with the Landscape Architect and Owner.
- .4 Obtain approval of the Consultant(s) for granular base and layout of all pavement areas prior to construction.
- .5 Stake planting locations and receive approval of Landscape Architect, prior to excavation of any planting pits. No substitutions of plant material shall be made without prior approval of the Landscape Architect.
- .6 Where clay is encountered proper drainage must be ensured in tree/shrub pits, prior to planting. Have method approved by Landscape Architect.
- .7 Maintain positive surface runoff through the entire construction period.
- .8 Reinstate all areas and items damaged as a result of construction activities.

7	Re-issued for Site Plan Control	2025-07-24
6	Re-issued for Site Plan Control	2025-06-23
5	Re-issued for Site Plan Control	2025-04-08
4	Re-issued for Site Plan Control	2024-11-29
3	Re-issued for Site Plan Control	2023-12-13
2	Re-issued for Site Plan Control	2023-11-01
1	Issued for Site Plan Control	2023-07-18

NUMBER/	MILESTONE / FAIT SALLANT	DATE: (Y/M/D)	INT.
DESIGNED BY / CONÇU PAR	CHECKED BY / VÉRIFIÉ PAR		
A. Ahmed / M. Ruhland	M. Ruhland		
DRAWN BY / DÉSSINÉ PAR	SCALE / ÉCHELLE		
T. Frost / V. Odusanya			

ARCHITECT	CONSULTANT

CONSULTANT	CONSULTANT

PROJECT / LOCATION
168 - 174 MURRAY ST ADDITION
168 - 174 MURRAY STREET
OTTAWA, ONTARIO
LOT 23, REGISTERED PLAN 42482, CITY OF OTTAWA

DRAWING

DETAILS

	SHEET NO.
	L-02
PROJECT NO.	
22-1682	