

PLOT INFORMATION: DWG NAME: p:\PROJECTS\MMT\Quinn's point\stage 5\7 drawing\landscape\landscape plan.dwg PLOT DATE: 06/17/2025 11:43:07 AM SHEET SIZE: ISO A1 (841 x 594 mm) PLOTTED BY: Megan Riley LAST SAVED BY: mday

1

LANDSCAPE PLAN

L1

1:750

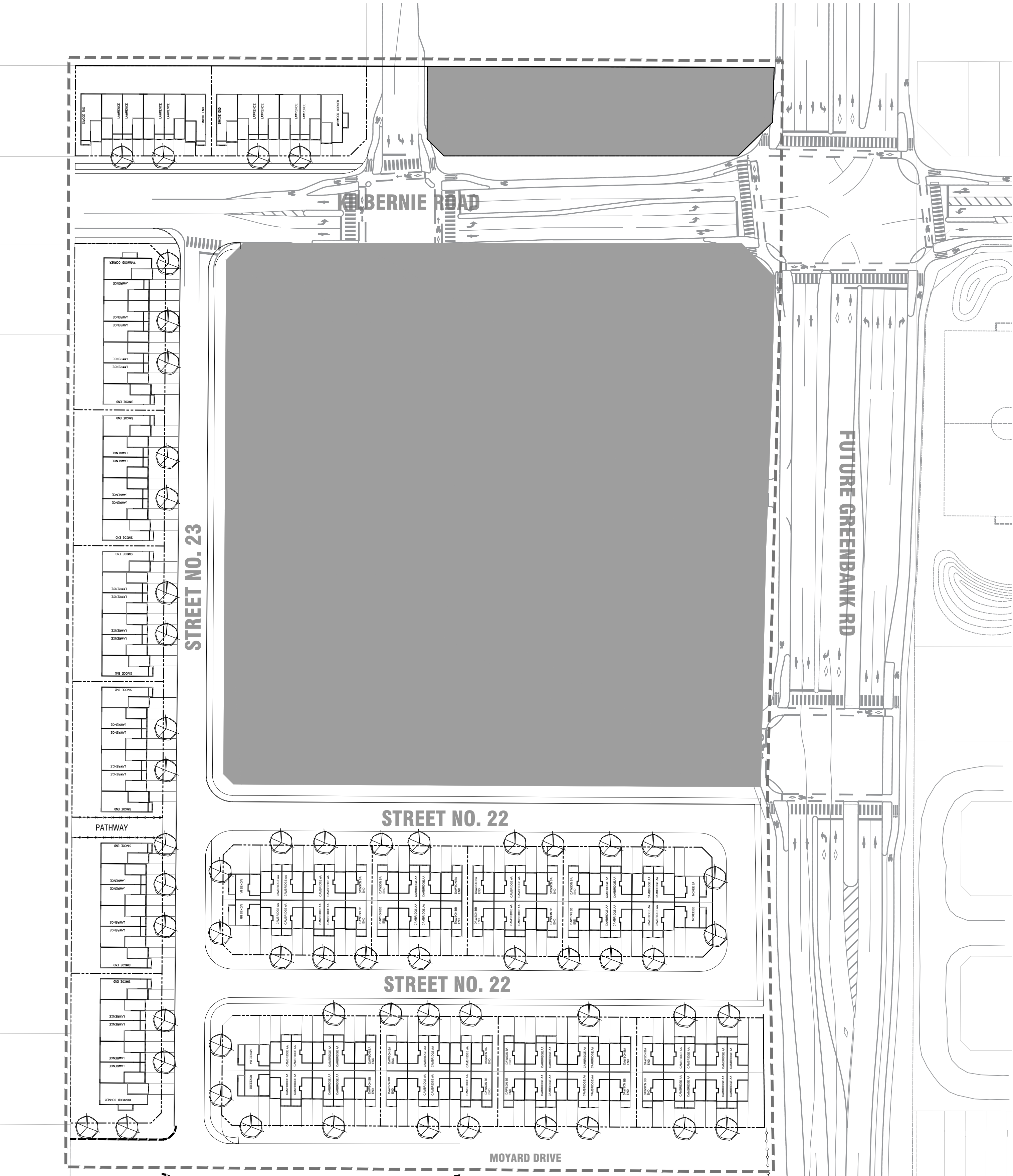

NOTES:

THESE NOTES ARE APPLICABLE TO ALL DRAWINGS IN THE SET;

DO NOT SCALE DRAWINGS;

Fotenn Consultants Inc. IS NOT RESPONSIBLE FOR ACCURACY OF BASE INFORMATION;

REFER TO CIVIL ENGINEERING DRAWINGS FOR GRADING & SITE SERVICING INFORMATION;

THE CONTRACTOR IS RESPONSIBLE FOR CONFIRMING SITE CONDITIONS AND REPORTING ANY DISCREPANCIES TO THE LANDSCAPE ARCHITECT;

THE CONTRACTOR IS RESPONSIBLE FOR CONFIRMING EXACT LOCATIONS OF ALL UNDERGROUND SERVICES AND OBTAINING CLEARANCE FROM ALL APPLICABLE UTILITIES. PROPOSED WORKS FOUND TO BE IN CONFLICT WITH UNDERGROUND SERVICES MAY BE ADJUSTED AT THE DIRECTION OF THE LANDSCAPE ARCHITECT;

LANDSCAPE ELEMENTS SHOWN ARE SUBJECT TO THE FINAL LOCATION OF UNDERGROUND SERVICES AND UTILITIES;

DO NOT INSTALL TREES ON PROPERTY / LOT LINES OR WITHIN DRAINAGE EASEMENTS;

PERFORM WORK IN ACCORDANCE WITH DETAILS AND SPECIFICATIONS;

ALL PLANT MATERIAL SHALL BE No. 1 NURSERY STOCK AND SHALL MEET OR EXCEED THE SPECIFICATION OF THE Canadian Standards for Nursery Stock, AS PUBLISHED BY THE Canadian Nursery Landscape Association;

SPECIES SUBSTITUTIONS ARE NOT PERMITTED WITHOUT PRIOR WRITTEN APPROVAL OF THE LANDSCAPE ARCHITECT;

ALL UN-PAVED SURFACES TO RECEIVE 150mm DEPTH TOPSOIL & SOD.

CITY OF OTTAWA STANDARDS FOR TREE PLANTING:

MAINTAIN A MINIMUM DISTANCE OF 3.0m FROM ALL HYDRO TRANSFORMERS;

MAINTAIN A MINIMUM DISTANCE OF 2.5m FROM FIRE HYDRANTS AND NO PLANTING IN FRONT OF HYDRANTS;

MAINTAIN A MINIMUM DISTANCE OF 1.5m FOR DECIDUOUS (4.5m FOR CONIFERS) FROM ANY SIDEWALK;

MAINTAIN A MINIMUM DISTANCE OF 1.0m FROM ALL UNDERGROUND SERVICES;

MAINTAIN A MINIMUM DISTANCE OF 1.0m FROM ALL BELL AND CABLE BOXES;

MAINTAIN A MINIMUM DISTANCE OF 1.0m FROM ALL DRIVEWAYS.

NOTE: THIS PLAN IS SCHEMATIC ONLY AND SUBJECT TO THE FINALIZING OF THE STREET DESIGN

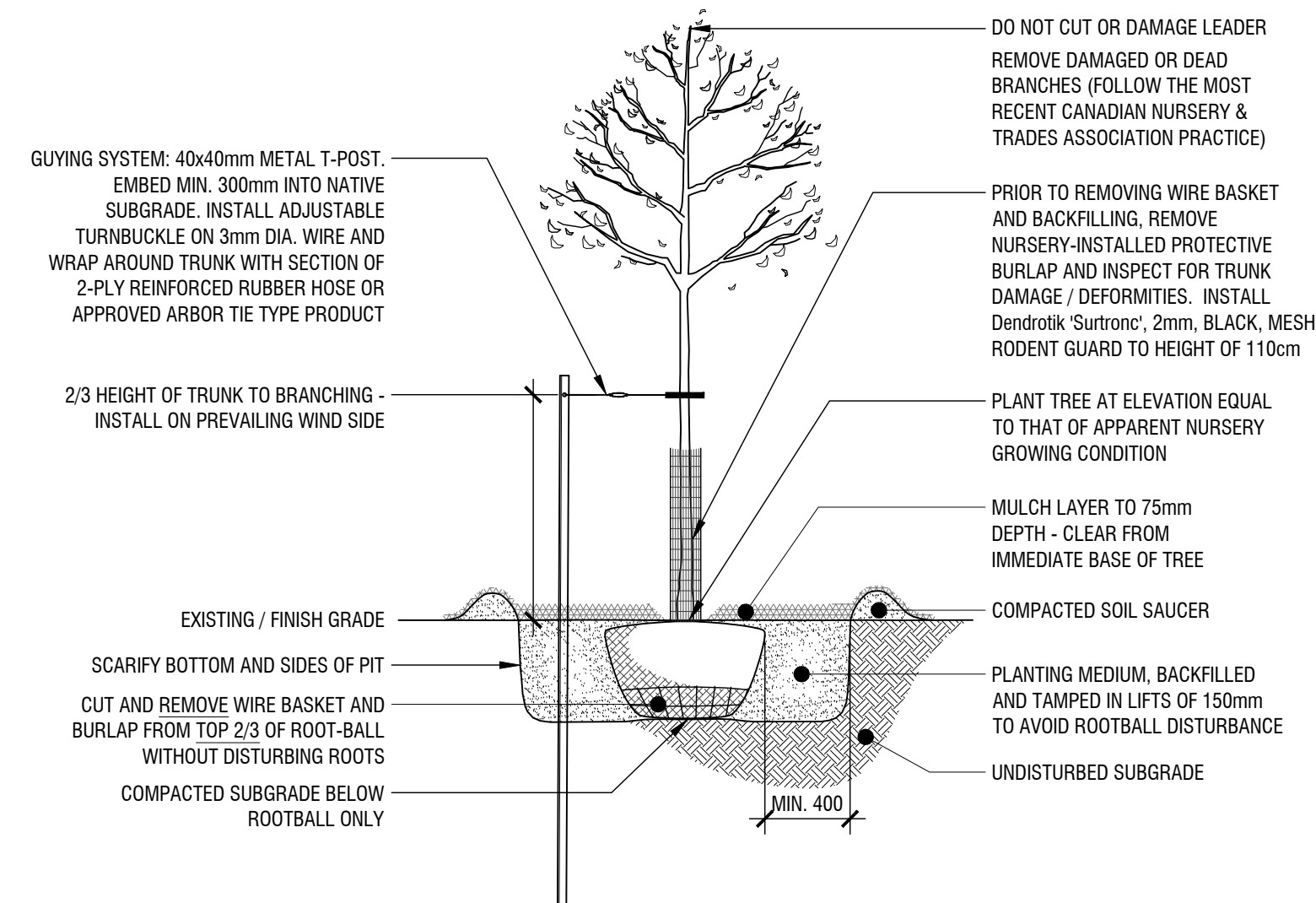

2

DECIDUOUS TREE PLANTING DETAIL

L1

n.t.s.

NOT FOR
CONSTRUCTION

Copyright Reserved
The Copyrights to all designs and drawings are the property of Fotenn Consultants Inc. Unauthorized reproduction or use is forbidden. DO NOT SCALE DRAWING

Copyright réservés
Les droits d'auteur à tous les modèles et dessins sont la propriété de Fotenn Consultants Inc. Reproduction ou utilisation non autorisée est interdite. NE PAS L'ÉCHELLE DE DESSIN

Client / Client



key plan / plan repère

legend / légende

- SCOPE OF APPLICATION
- MEDIUM DECIDUOUS TREE (REFER TO PLANTING SCHEDULE FOR SPECIES AND QUANTITIES)
- DECORATIVE FENCE
- CHAINLINK FENCE

00	Issued for Client Review	2025/06/17
rev'n	description / la description	yyyy/mm/dd

FOTENN Planning + Design
The Woolen Mill - 4 Cataract St, Suite 315
Kingston, ON, CANADA K1K 1Z7
613.542.5454
fotenn.com

north / le nord

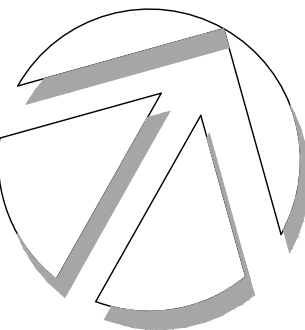

stamp / le cachet

project / projet

QUINN'S POINTE STAGE 5

drawing / dessin

LANDSCAPE CONCEPT PLANS
FOR ZONING

designed / conçu XX / YY	drawn / dessiné MB	reviewed / examiné XX / YY
date June 2025	project number / No. du projet	

drawing number / No. du dessin

L1