

Copyright Reserved

The Contractor shall verify and be responsible for all dimensions. DO NOT scale the drawing - any errors or omissions shall be reported to Stantec without delay.
The Copyrights to all designs and drawings are the property of Stantec. Reproduction or use for any purpose other than that authorized by Stantec is forbidden.

Legend

AREA ID
RUNOFF COEFFICIENT
STORM DRAINAGE AREA ha.
STORM DRAINAGE BOUNDARY

AREA ID
EXTERNAL RUNOFF COEFFICIENT
EXTERNAL STORM DRAINAGE AREA ha.
EXTERNAL STORM DRAINAGE BOUNDARY
DIRECTION OF OVERLAND FLOW
PROPOSED STORM MH AND SEWER
PROPOSED CATCHBASIN MANHOLE
PROPOSED CATCHBASIN
PROPOSED CB T AND SUBDRAIN
EXISTING STORM MH AND SEWER
EXISTING CATCHBASIN
EXISTING COMBINED MH AND SEWER
THERMAL INSULATION ON STORM SEWER WHERE COVER IS LESS THAN 2.0m AS PER S35.
MAXIMUM STATIC PONDING LIMITS
PROPOSED ROOF DRAINS
PROPOSED ROOF SCUPPERS

Notes

- TRENCH DRAIN TO U/G PARKING TO BE CONNECTED TO INTERNAL PLUMBING AND DIRECTED TO THE STORM SERVICE DOWNSTREAM OF THE BUILDING CISTERN.
- FINAL METER AND REMOTE METER LOCATIONS TO BE CONFIRMED BY MECHANICAL CONSULTANT.
- THE LOCATION AND ELEVATION OF SEWERS, WATERMAIN AND UTILITIES IS APPROXIMATE ONLY AND THE EXACT LOCATION AND ELEVATIONS SHOULD BE DETERMINED BY CONSULTING THE MUNICIPAL AUTHORITIES AND UTILITY COMPANIES CONCERNED. THE CONTRACTOR SHALL PROVE THE LOCATION AND ELEVATION OF SEWERS, WATERMANS AND UTILITIES AND SHALL BE RESPONSIBLE FOR THEIR PROTECTION AND THE IMPLEMENTATION OF ANY NECESSARY PROCEDURES CALLED FOR IN THE APPROPRIATE STANDARD AND REGULATIONS. ANY DISCREPANCY WITH THE INFORMATION SHOWN ON THESE PLANS SHALL BE REPORTED TO THE ENGINEER PRIOR TO CONTINUING WITH CONSTRUCTION.
- INTERNAL PLUMBING TO BE DESIGNED BY THE MECHANICAL CONSULTANT.
- STORMWATER MANAGEMENT TO BE PROVIDED THROUGH A 20m³ CISTERN LOCATED IN THE UNDERGROUND PARKING.
- CISTERN IS TO BE MECHANICALLY PUMPED. MAX. CISTERN RELEASE RATE TO STORM SEWER = 3.0 L/s.
- FLOOR DRAINS LOCATED INSIDE PARKING GARAGE TO BE CONNECTED TO BUILDING INTERNAL SANITARY SEWER.
- USF TO BE CONFIRMED BY THE STRUCTURAL CONSULTANT.

| | | | | |
|------------|------------------|------|-------|----------|
| 0 | ISSUED FOR SPA | MJS | DT | 25.02.27 |
| Revision | | By | Appd. | YY.MM.DD |
| File Name: | 160402005 DB.dwg | MJS | DT | MJS |
| | | Dwn. | Chkd. | Dsgn. |
| | | | | YY.MM.DD |

Permit-Seal

Client/Project

1146 SNOW STREET INC.
5669 POWER ROAD

1146 SNOW STREET
4 STOREY 43 UNIT APARTMENT BUILDING
OTTAWA, ON

Title

STORM DRAINAGE PLAN

| | | |
|-------------|-------|-----------|
| Project No. | Scale | 0 2 6 10m |
| 160402005 | 1:200 | |
| Drawing No. | Sheet | Revision |

SD-1 8 of 9 0
PLAN # XXXXX

| SCHEDULE OF ROOF RELEASE RATES | | | | | |
|--------------------------------|-------------------|-------------|----------------|--------------------------|--|
| DRAIN TYPE | TRIBUTARY AREA ID | # OF DRAINS | 100YR HEAD (m) | 100YR RELEASE RATE (L/s) | 100YR PONDING VOLUME (m ³) |
| WATTS ACCUFLOW (50% OPEN) | R102A | 3 | 0.15 | 3.7 | 24.9 |
| WATTS ACCUFLOW (CLOSED) | R102B | 8 | 0.13 | 2.5 | 6.7 |

| ICD TABLE | | | | | |
|---------------|-------------------|----------|--------------|----------------|------------------|
| CATCHBASIN ID | TRIBUTARY AREA ID | ICD TYPE | SYR HEAD (m) | 100YR HEAD (m) | 100YR FLOW (L/s) |
| CB 500 | C500A | LMF 40 | 1.38 | 1.38 | 1.59 |

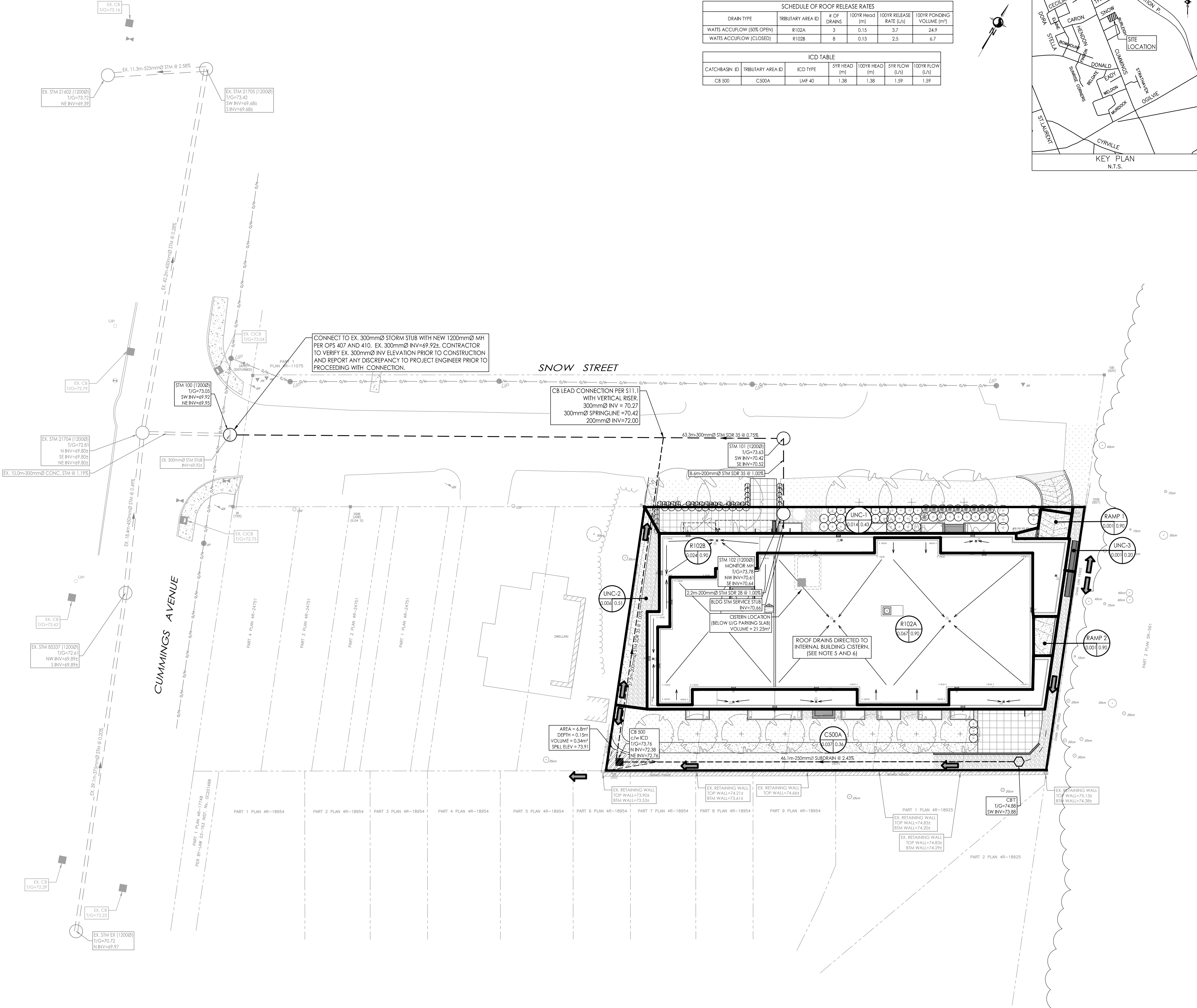
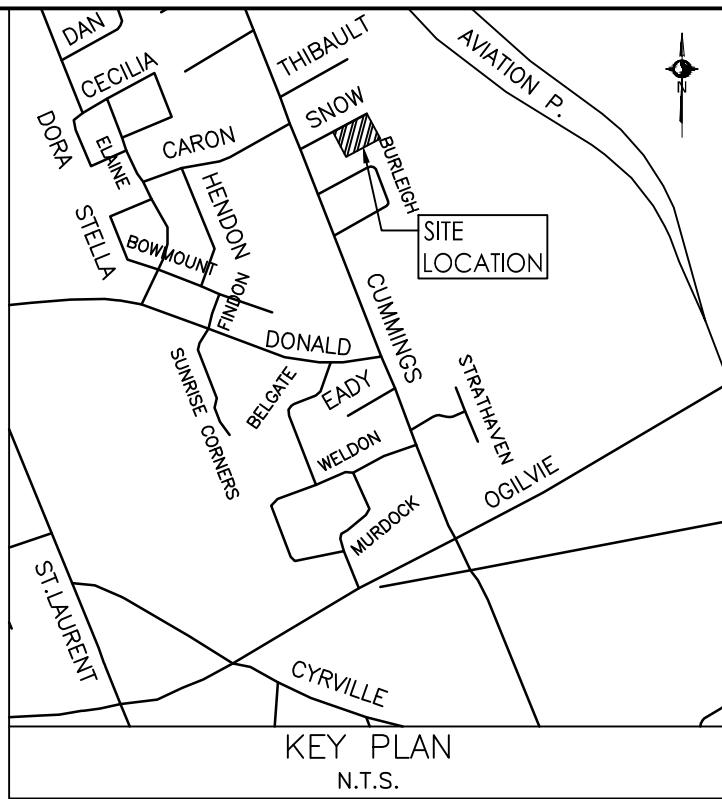

\\C:\proj\160402005\160402005.dwg
2025/02/28 13:31 PM by: 160402005.dwg
ORIGINAL SHEET - ARCH 0