

LANDSCAPE PLAN

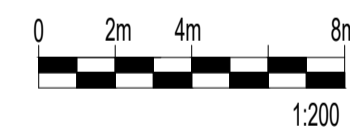

LEGEND

- 14.** EXISTING VEGETATION TO REMAIN & ID
- CRITICAL ROOT ZONE
- PROPOSED PLANTING
- PROPOSED PEASTONE MAINTENANCE EDGE
- PROPOSED STANDARD PAVERS
- SOD
- SOIL VOLUME AREAS ID
- TREE PROTECTION FENCE

SERVICING INFORMATION SHOWN AS REFERENCE ONLY. REFER TO CIVIL DRAWINGS.

THIS PLAN IS ISSUED FOR SITE PLAN CONTROL ONLY. ADDITIONAL DETAILING AND SPECIFICATIONS ARE REQUIRED PRIOR TO TENDERING AND CONSTRUCTION.

PLAN TO BE READ IN CONJUNCTION WITH 'TREE CONSERVATION REPORT FOR 1058-1066 Silver Street and 1291-1305 Summerville Avenue' January 24, 2024 BY Kevin Myers, MFC ISA Certified Arborist @, ON-2907A Dendron Forestry Services

Plant List - 1291 Summerville					
ID	Qty	Botanical Name	Common Name	Scheduled Size	Remarks
Trees					
BnC	1	Betula nigra Clump	River Birch	50mm cal.	WB. Staked
Ms	1	Magnolia stellata	Star Magnolia	250cm ht.	BB Staked
Large Shrubs					
CaW	1	Caragana arborescens 'Walker'	Walker's Weeping Caragana	125cm stem	Potted
HpG	1	Hydrangea paniculata 'Grandiflora' standard	Peegee Hydrangea standard	125cm stem	Potted
Shrubs					
SJS	25	Spirea japonica 'Shirobana'	Spirea Shirobana	100cm ht.	Potted
Perennials					
PvA	18	Low Flowering perennials		150mm Pot	50cm o.c.
PvB	35	Flowering perennials		150mm Pot	60cm o.c.
PvC	45	Ornamental Grasses		150mm Pot	60cm o.c.
Plant List - 1066 Silver Street					
ID	Qty	Botanical Name	Common Name	Scheduled Size	Remarks
Perennials					
PvA	19	Low Flowering perennials		150mm Pot	50cm o.c.
PvB	36	Flowering perennials		150mm Pot	60cm o.c.
PvC	45	Ornamental Grasses		150mm Pot	60cm o.c.

CONTRACTOR TO REPORT ANY DISCREPANCIES FOUND BETWEEN PLAN & PLANT LIST PRIOR TO PLANTING

Perennial types (invasive species such as Miscanthus are not to be planted)
PvA: Low Flowering perennials up to 30cm ht (minimum 5 species mix): Cranesbill Geranium, Sweet Woodroffe, Low Meadow Sage, Coral Bells, Dianthus, Lung Wort, low Phlox.
PvB: Tall Flowering Perennials (minimum 5 species mix): Shasta Daisy, Coneflower, Veronica, Tall Meadow and Russian Sage, Tall Phlox, Rudbeckia
PvC: Ornamental Grasses (minimum 2 species mix): feather Reed Grass, Switch grass, Tufted Hairgrass

TOTAL NUMBER OF PRIVATE TREES = 2, CITY TREES = 0

- GENERAL NOTES**
- All general site information and conditions compiled from existing plans, surveys and consultant's field notes. Report all discrepancies prior to any work. No responsibility is born by the Consultant for unknown subsurface conditions.
 - The location of the utilities is approximate only, and the exact location should be determined by consulting the municipal authorities and utility companies concerned. The Contractor shall prove the location of utilities and shall be responsible for adequate protection from damage.
 - All dimensions shown are to be verified on site prior to any construction. No deviations are to be made from the layouts as shown on this plan without prior consultation with the Landscape Architect and Owner.
 - No other trees to be removed without prior approval by Landscape Architect.

4	Reissued for SPC	Jan. 14/25
3	Issued for SPC Coordination	Nov. 08/24
2	Reissued for SPC	Jul. 10/24
1	Issued for SPC	Feb. 01/24
no.	issue / revision	date

Ruhland & Associates Ltd
 200-1750 Courtwood Crescent, Ottawa, Ontario K2C 2B5
 P (613) 224-4744 x 232 F (613) 224-1131 info@rala.ca www.rala.ca

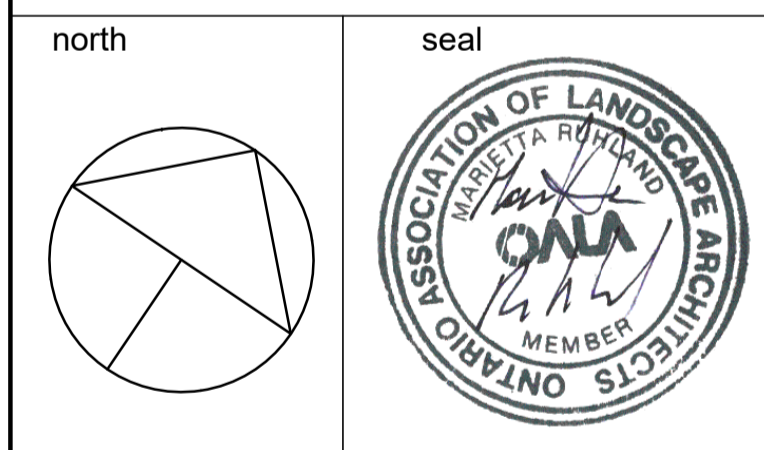

project
1058-1066 Silver & 1291-1305 Summerville
 OTTAWA, ONTARIO

LANDSCAPE PLAN

scale 1:200	drawn by D. Abdullah	designed by R. Ruhland
date	checked by R. Ruhland	plot date

project number 24-1739	drawing number L - 01
----------------------------------	---------------------------------

Contractor to check and verify all dimensions on the job

TREE CANOPY COVERAGE		
TOTAL CANOPY AREA	348	m2
TOTAL SITE AREA	5346	m2
PERCENT COVERAGE	6.51%	

TREE SOIL VOLUME CALCULATIONS - 1291 Summerville Avenue

Soil Volume Area, Tree Quantity and Size	Tree Quantity	OTTAWA TARGET SOIL VOLUME (m3)	Design Soil Volume	SOIL ADEQUACY percentage
AREA A - 1 Large Shrub in plant bed*				
Plant bed (6 sq m x 0.4 metre deep average)	1	2.0	2.4	120.00%
AREA B - 1 ornamental tree in plant bed				
plant bed (19.5 sq m x .8 metre deep ave)	1	15.0	15.6	104.00%
AREA C - 1 small tree in plant bed				
Plant bed (25 sq m x .8 metre deep ave)	1	20.0	20.0	100.00%
AREA D - 1 Large Shrub in plant bed*				
plant bed (7 sq m x .4 metre deep ave)	1	2.0	2.4	120.00%

* Large shrubs where soil volumes do not support trees

* Small ornamental trees with growth to 10-15cm DBH using 'How much soil to grow a big tree' by DeepRoot as a guide

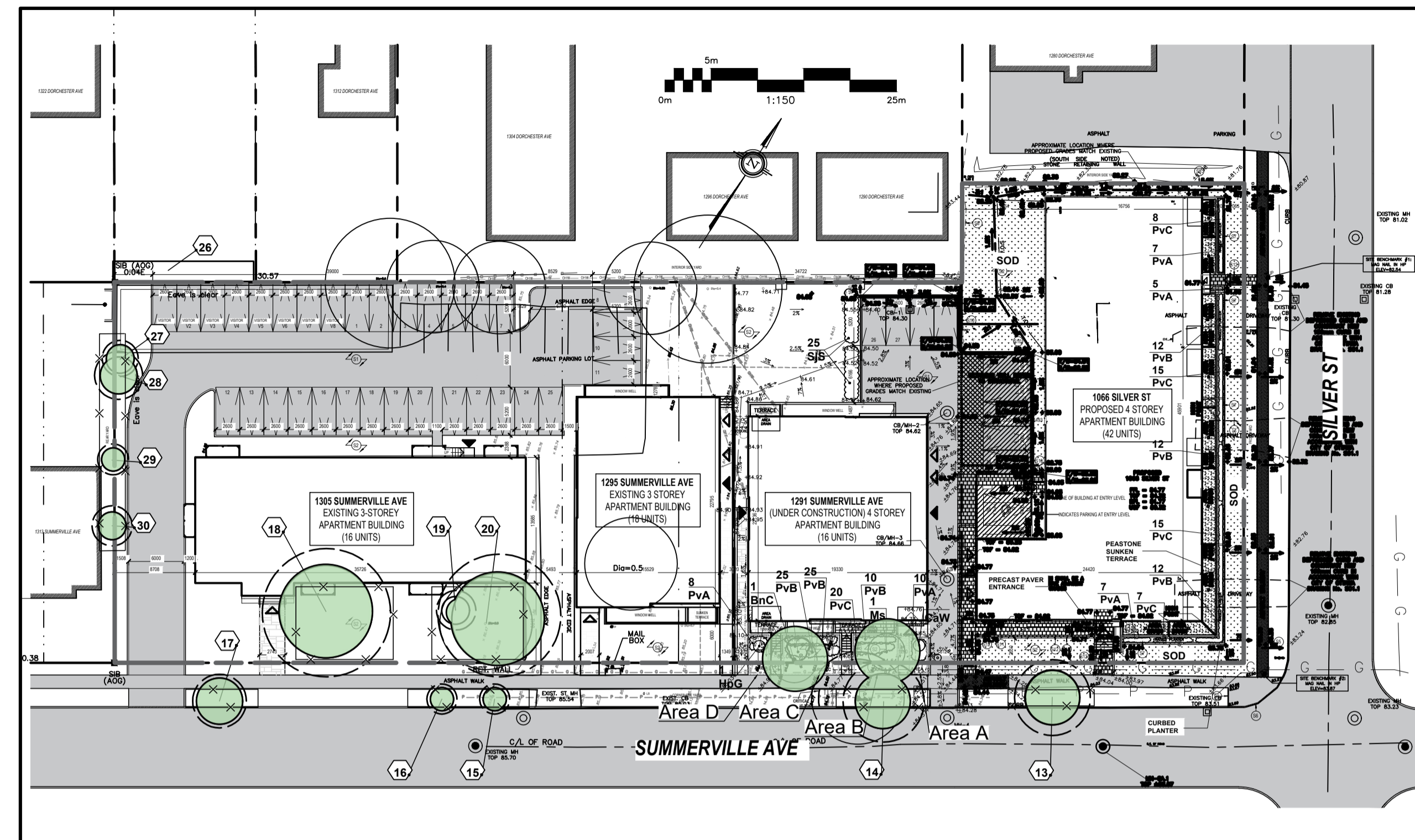

GENERAL NOTES

- All general site information and conditions compiled from existing plans, surveys and consultant's field notes. Report all discrepancies prior to any work. No responsibility is born by the Consultant for unknown subsurface conditions.
- The location of the utilities is approximate only, and the exact location should be determined by consulting the municipal authorities and utility companies concerned. The Contractor shall prove the location of utilities and shall be responsible for adequate protection from damage.
- All dimensions shown are to be verified on site prior to any construction. No deviations are to be made from the layouts as shown on this plan without prior consultation with the Landscape Architect and Owner.
- No other trees to be removed without prior approval by Landscape Architect.

4	Reissued for SPC	Jan. 14/25
3	Issued for SPC Coordination	Nov. 08/24
2	Reissued for SPC	Jul. 10/24
1	Issued for SPC	Feb. 01/24

Ruhland & Associates Ltd
 200-1750 Courtwood Crescent, Ottawa, Ontario K2C 2B5
 P (613) 224-4744 x 232 F (613) 224-1131 info@rala.ca www.rala.ca

north seal

project
1058-1066 Silver & 1291-1305 Summerville
 OTTAWA, ONTARIO

drawing title
LANDSCAPE DETAILS & PLANT LISTS

scale	drawn by D. Abdullah	designed by R. Ruhland
date	checked by R. Ruhland	plot date

project number 24-1739	drawing number L - 02
----------------------------------	---------------------------------

Contractor to check and verify all dimensions on the job

