

LEGEND

- FFL FIRST FLOOR ELEVATION
- TOF TOP OF FOUNDATION
- BFL BASEMENT FLOOR ELEVATION
- USF UNDERSIDE OF FOOTING
- PROPERTY LINE
- CB CATCH BASIN
- MH STORM MANHOLE
- CB/MH CATCH BASIN/MANHOLE
- MH SANITARY MANHOLE
- FH FIRE HYDRANT
- EXISTING GRADE ELEVATION
- +99.99 PROPOSED GRADE ELEVATION
- 2% EXISTING SLOPE OF GRADE
- 2% PROPOSED SLOPE OF GRADE
- CENTERLINE OF SWALE
- 150mm BARRIER CURB
- D.C. DEPRESSED CURB
- LIGHT-DUTY PAVEMENT
- HEAVY-DUTY PAVEMENT
- ASPHALT SIDEWALK
- INTERLOCK
- LANDSCAPE

TOP OF FOUNDATION SHALL BE A MINIMUM 0.15m ABOVE ADJACENT PROPOSED GRADES

USF SHALL BE A MINIMUM 1.5m BELOW ADJACENT PROPOSED GRADES OR PROVIDE ADEQUATE INSULATION

GRADING SHALL BE BETWEEN 2% & 7%. GRADING OVER 7% SHALL BE TERRACED AT MAXIMUM 3H:1V.

ALL EXISTING TREES SHALL BE PROTECTED DURING AND AFTER CONSTRUCTION IN ACCORDANCE WITH THE TREE PROTECTION BY-LAW

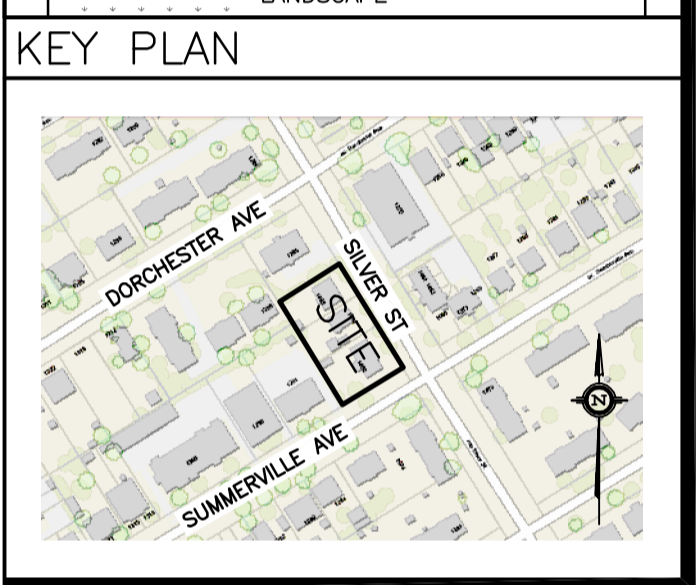

No.	DATE	REVISION
7	DEC 12-24	RE-ISSUED FOR APPROVAL
6	NOV 14-24	RE-ISSUED FOR APPROVAL
5	AUG 12-24	RE-ISSUED FOR APPROVAL
4	JUL 11-24	RE-ISSUED FOR COORDINATION
3	MAY 7-24	RE-ISSUED FOR APPROVAL
2	FEB 27-24	ISSUED FOR APPROVAL
1	FEB 22-24	ISSUED FOR COORDINATION

D. B. GRAY ENGINEERING INC.
 Stormwater Management • Grading & Drainage • Storm & Sanitary Sewers • Watermain
 700 Long Point Circle
 Ottawa, Ontario
 613-425-8044
 d.gray@dbgrayengineering.com

Project
PROPOSED 4-STORY APARTMENT BUILDING
1066 SILVER STREET
 OTTAWA, ONTARIO

GRADING PLAN

Engineer's Seal

 NOT VALID UNLESS SIGNED & DATED

Drawn: D.B.G
 H. Scale: 1:150
 V. Scale:
 Date: JAN 23-24
 Job No.: 23056

Drawing No.
C-2
 of 7

REFER TO NOTES & DETAILS ON DRAWINGS C-5 & C-6