

# CAIVAN ORLEANS VILLAGE PHASE 4

CAIVAN  
COMMUNITIES

NAK   
design strategies

LIST OF DRAWINGS:

- L01 - LANDSCAPE PLAN
- L02 - LANDSCAPE PLAN
- L03 - LANDSCAPE PLAN
- L04 - LANDSCAPE PLAN
- L05 - LANDSCAPE DETAILS
- L06 - LANDSCAPE DETAILS

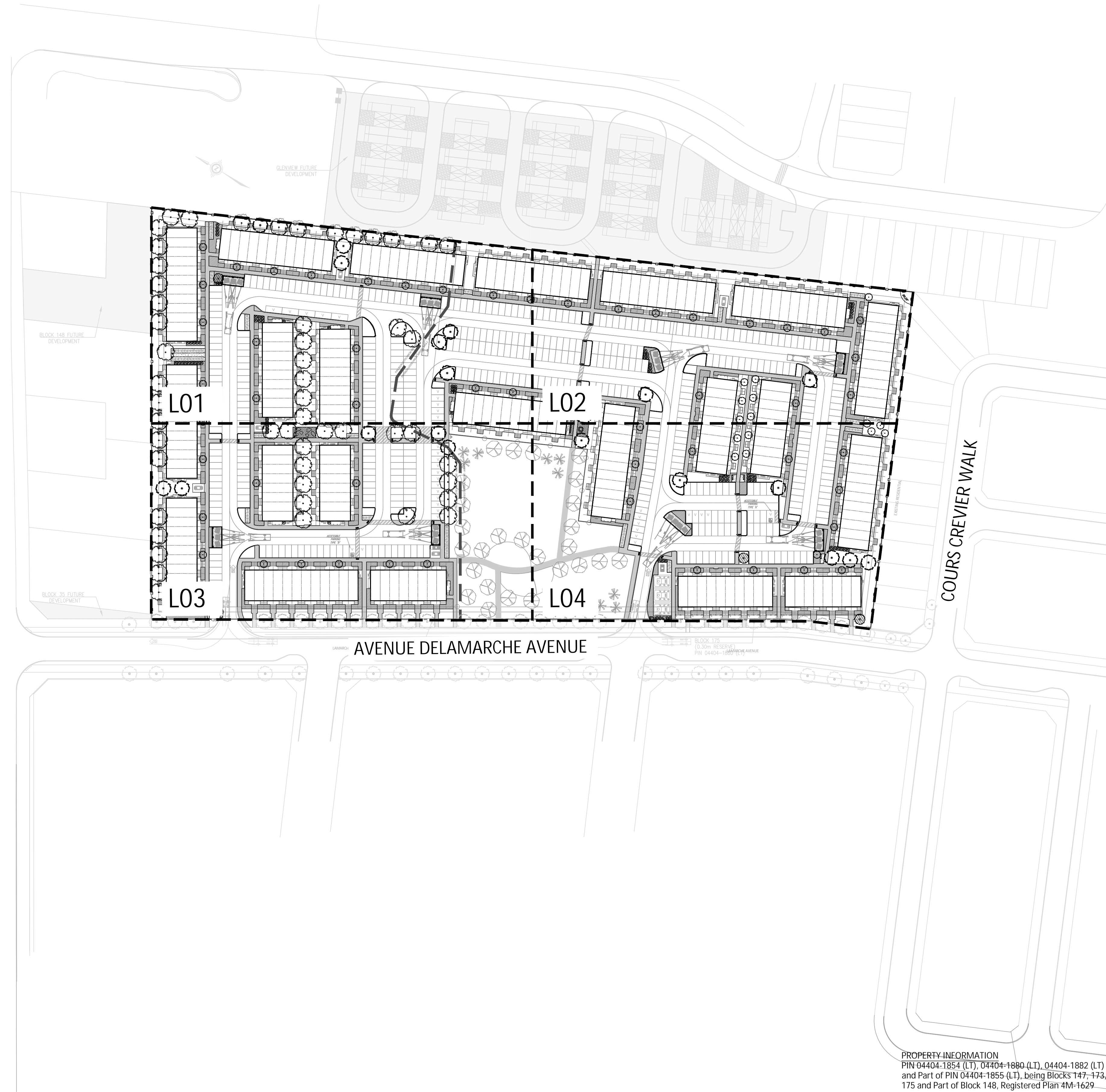

PROPERTY INFORMATION  
PIN 04404-1854 (LT), 04404-1880 (LT), 04404-1882 (LT)  
and Part of PIN 04404-1855 (LT), being Blocks 147, 173,  
175 and Part of Block 148, Registered Plan 4M-1629

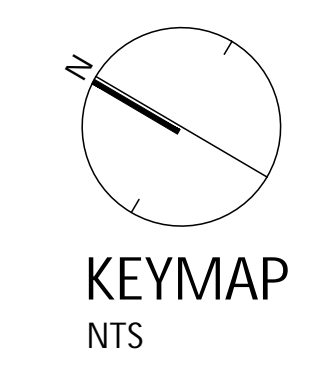



KEY	BOTANICAL NAME	COMMON NAME	QTY.	SIZE	REMARKS	NATIVE	OWNER
<b>DECIDUOUS TREES - LARGE (15-30M HEIGHT)</b>							
AR	ACER RUBRUM	RED MAPLE	8	50mm	B&B	Y	PRIVATE
CC	CARYA CORDIFORMIS	BITTERNUT HICKORY	8	50mm	B&B	Y	PRIVATE
GD	GYMNOCALADUS DIOICUS	KENTUCKY COFFEE TREE	7	50mm	B&B	Y	PRIVATE
QR	QUERCUS PALUSTRIS	PIN OAK	6	50mm	B&B	Y	PRIVATE
QP	QUERCUS RUBRA	RED OAK	9	50mm	B&B	Y	PRIVATE
PO	PLATANUS OCCIDENTALIS	AMERICAN SYCAMORE	8	50mm	B&B	Y	PRIVATE
LT	LIRIODENDRON TULIPIFERA	TULIP TREE	7	50mm	B&B	Y	PRIVATE
<b>DECIDUOUS TREES - MEDIUM (8-14M HEIGHT)</b>							
AG	AESCULUS GLABRA	OHIO BUCKEYE	4	50mm	B&B	Y	PRIVATE
ARR	ACER RUBRUM 'REDPOINTE'	REDPOINTE RED MAPLE	3	50mm	B&B	Y	PRIVATE
BL	BETULA LENTA	CHERRY BIRCH	3	50mm	B&B	Y	PRIVATE
CCA	CARPINUS CAROLINIANA	BLUE BEECH	3	50mm	B&B	Y	PRIVATE
OV	OSTRYA VIRGINIANA	IRONWOOD	4	50mm	B&B	Y	PRIVATE
QO	QUERCUS PRINUS	CHESTNUT OAK	3	50mm	B&B	Y	PRIVATE

<b>DECIDUOUS TREES - SMALL (6-8M HEIGHT)</b>							
CCI	CRATAEGUS CRUSGALI 'INERMIS'	THORNLESS HAWTHORN	3	25cm 15 GAL	PT, TREE FORM	Y	PRIVATE
<b>MULTI-STEM SHRUBS</b>							
Ac	AMELANCHIER CANADENSIS	SERVICEBERRY	11	125cm ht.	PT, CLUMP	Y	PRIVATE
Al	AMELANCHIER LAEVIS	ALLEGHENY SERVICEBERRY	14	125cm ht.	PT, CLUMP	Y	PRIVATE
Ca	CORNUS ALTERNIFOLIA	PAGODA DOGWOOD	13	125cm ht.	PT, CLUMP	Y	PRIVATE
Hv	HAMAMELIS VIRGINIANA	WITCHHAZEL	11	125cm ht.	PT, CLUMP	Y	PRIVATE
Vd	VIBURNUM DENTATUM	ARROWOOD VIBURNUM	11	125cm ht.	PT, CLUMP	Y	PRIVATE
VI	VIBURNUM LENTAGO	NANNYBERRY	11	125cm ht.	PT, CLUMP	Y	PRIVATE
<b>CONIFEROUS SHRUBS</b>							
Js	JUNIPERUS SCOPULORUM 'WICHITA BLUE'	WITCHITA BLUE JUNIPER	25	3 GAL	POT	Y	PRIVATE
Tc	TAXUS CANADENSIS	CANADIAN YEW	61	3 GAL	POT	Y	PRIVATE
<b>DECIDUOUS SHRUBS</b>							
Am	ARONIA MELANOCARPA	BLACK CHOKEBERRY	292	3 GAL	POT	Y	PRIVATE
Sa	SYMPHORICARPOS ALBUS	SNOWBERRY	165	3 GAL	POT	Y	PRIVATE
Po	PHYSCARPUS OPULIFOLIUS 'DIABOLO'	'DIABOLO' NINEBARK	143	3 GAL	POT	Y	PRIVATE

<b>ORNAMENTAL GRASSES</b>							
cl	CHASMANTHIUM LATIFOLIUM	NORTHERN SEA OATS	410	7 GAL	POT	Y	PRIVATE
dc	DESCHAMPSIA CESPITOSA	TUFTED HAIR GRASS	294	7 GAL	POT	Y	PRIVATE
bg	BOUTELOUA GRACILIS	BLUE GRAMA	191	7 GAL	POT	Y	PRIVATE
sh	SPOROBOLUS HETEROLEPSIS	PRARIE DROPSEED	377	7 GAL	POT	Y	PRIVATE
ss	SCHIZACHYRIUM SCOPARIUM	LITTLE BLUESTEM	276	7 GAL	POT	Y	PRIVATE

**GENERAL NOTES:**

- ALL PLANT MATERIAL SHALL BE NURSERY GROWN STOCK UNLESS OTHERWISE NOTED.
- TREES TO HAVE A MINIMUM 1800 CLEAR STEM ABOVE GRADE.
- CONTRACTOR TO MAKE GOOD ALL EXISTING AREAS DAMAGED BY HIS WORK TO THE SATISFACTION OF THE CONTRACTOR.
- ALL PLANT MATERIAL SHALL BE WARRANTED FOR TWO YEARS FROM THE DATE OF SUBSTANTIAL COMPLETION.
- CONTRACTOR TO VERIFY LOCATION OF ALL SERVICES PRIOR TO ANY EXCAVATION.
- ANY PROPOSED SUBSTITUTIONS OF PLANT SPECIES SHALL BE MADE WITH PLANTS OF EQUIVALENT OVERALL FORM, HEIGHT, BRANCHING HABIT, FLOWER, LEAF, COLOR, FRUIT AND CULTURE AND ONLY AFTER APPROVAL OF THE LANDSCAPE ARCHITECT.

**TREE PLANTING IN MARINE CLAY SOILS**

THE LANDSCAPE CONSIDERATIONS CONTAINED WITHIN SEC. 6.8 OF PATERSON GROUP'S GEOTECHNICAL INVESTIGATION, DATED AUGUST 26, 2024.

- THIS LANDSCAPE PLAN CONFORMS WITH THE TREE-TO-FOUNDATION SETBACK, SOIL VOLUME, AND SURFACE-GRADING REQUIREMENTS OUTLINED IN THE CITY OF OTTAWA'S GUIDELINES FOR TREE PLANTING IN SENSITIVE MARINE CLAY SOILS (2017), BASED ON THE FINDINGS OUTLINED IN THE PROJECT GEOTECHNICAL REPORT BY PATERSON GROUP (REPORT PG6152-1 REV 3 DATED AUGUST, 2024).
- ADDITIONAL REQUIREMENTS OUTLINED IN THE CITY OF OTTAWA'S GUIDELINES FOR TREE PLANTING IN SENSITIVE MARINE CLAY SOILS (2017), INCLUDING USF DEPTH, FOUNDATION WALL REINFORCEMENT, AND SUBDIVISION GRADING, SHOULD BE CONFIRMED BY THE PROJECT ENGINEER(S).

<b>TREE SOIL VOLUMES</b>			
TREE TYPE/SIZE	SINGLE TREE SOIL VOLUME	MULTIPLE TREE SOIL VOLUME (m <sup>3</sup> /TREE)	SOIL VOLUME FOR MARINE CLAY AREAS (SINGLE TREE)
ORNAMENTAL	15	9	
COLUMNAR	15	9	
SMALL	20	12	25
MEDIUM	25	15	30
LARGE	30	18	
CONIFER	25	15	

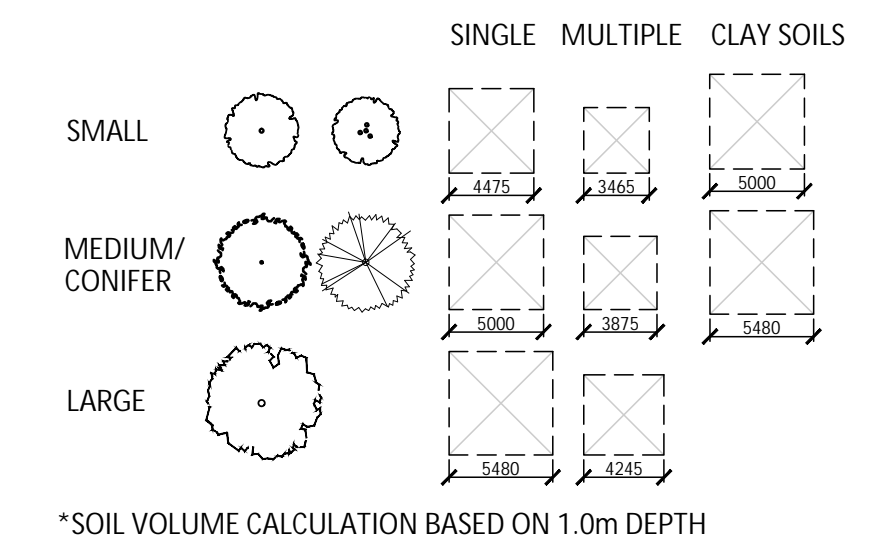

Contractor shall check all dimensions on the work and report any discrepancy to the Landscape Architect before proceeding. All drawings and specifications are the property of the Landscape Architect and must be returned at the completion of the work. This drawing is not to be used for construction until signed by the Landscape Architect.

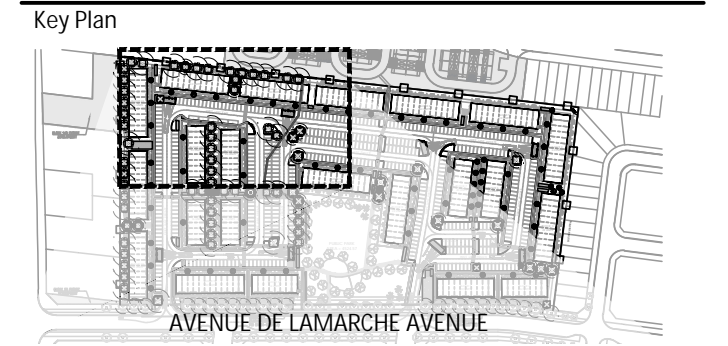

**LEGEND**

--- PROPERTY LINE

**FENCING**

--- WASTE ENCLOSURE FENCE

--- WOOD PRIVACY FENCE

**PLANTING**

○ LARGE DECIDUOUS TREE

○ MEDIUM DECIDUOUS TREE

○ SMALL DECIDUOUS TREE

○ TREE CANOPY PROJECTION

○ TREE FORM SHRUB

○ DECIDUOUS/CONIFEROUS SHRUBS

○ GRASSES/PERENNIALS

○ SODDING

**PAVING**

■ ASPHALT PAVING

■ CIP CONCRETE PAVING

■ HEAVY DUTY CONCRETE PAVING

■ RIVERSTONE PAVING

■ UNIT PAVING

**PLANTING KEY**

XX TREE SPECIES

00 QUANTITY

XX SHRUB SPECIES

00 QUANTITY

**DETAIL KEY**

1 DETAIL NO.

L1 SHEET NO.

No.	Description	Date
3	Issued for Revised First Submission	Dec. 17/24
2	Issued for Revised First Submission	Nov. 04/24
1	Issued for First Submission	Sept. 03/24

**PROPERTY INFORMATION**  
 PIN 04404-1854 (LT), 04404-1880 (LT), 04404-1882 (LT) and Part of PIN 04404-1855 (LT), being Blocks 147, 173, 175 and Part of Block 148, Registered Plan 4M-1629

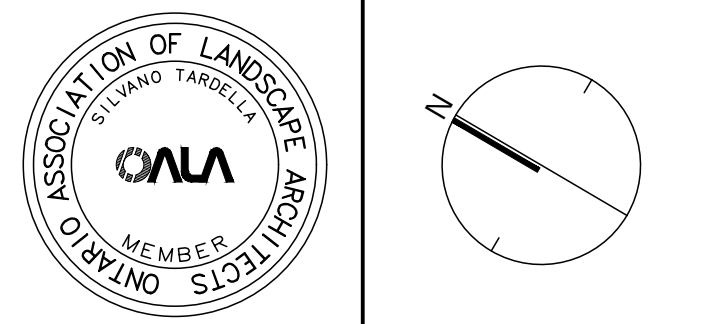

**NAK design strategies**  
 1285 WELLINGTON STREET, OTTAWA, ON K1Y 3A8 CANADA  
 T 613 237 2345 NAKDESIGNSTRATEGIES.COM

**ORLEANS VILLAGE PHASE 4**  
 OTTAWA, ON

**LANDSCAPE PLAN**

Date: 2024-08-12  
 Scale: 1:250  
 Drawn: SW  
 Checked: SC  
 Job No.: 22-145

**L01**

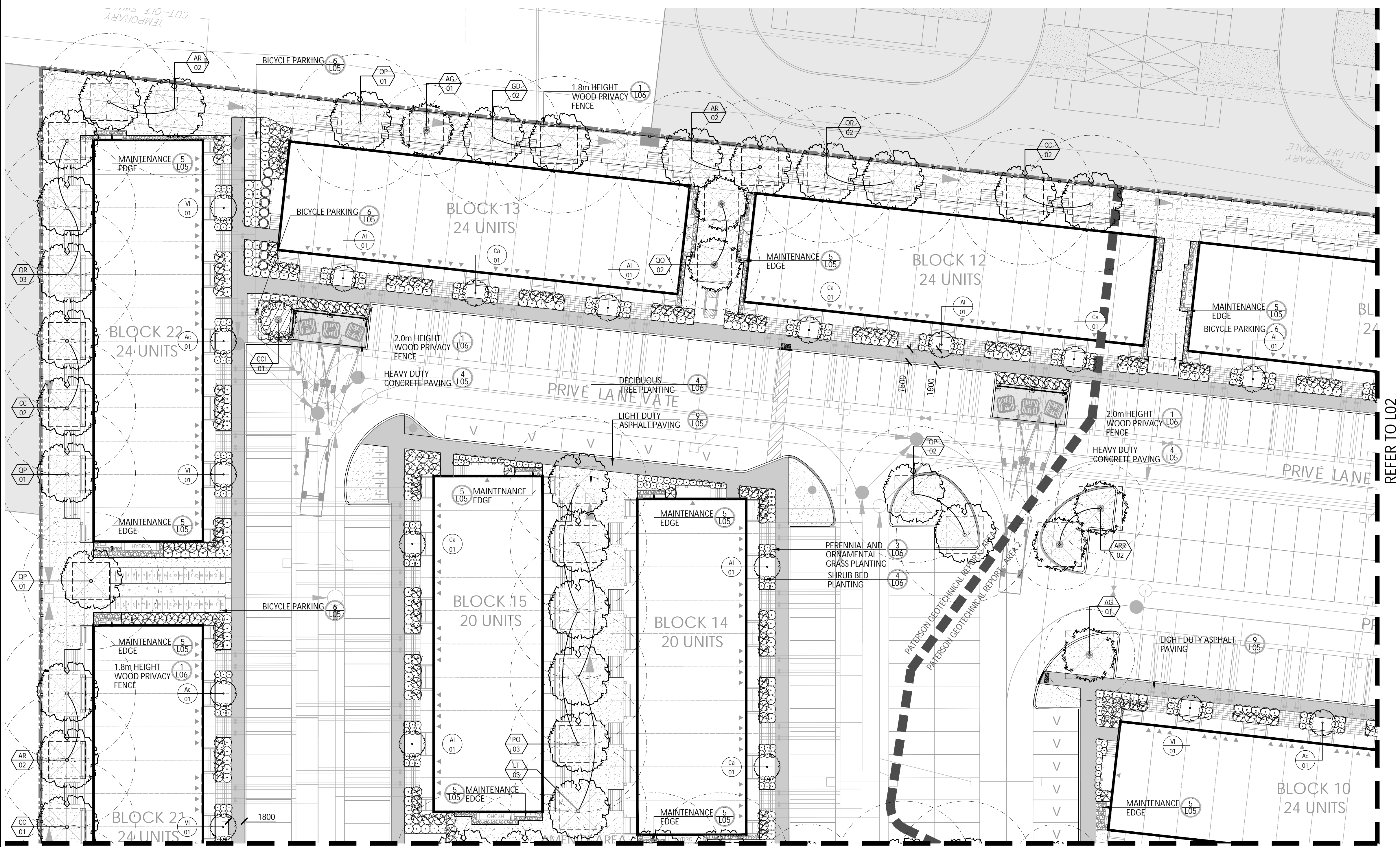

REFER TO L03

REFER TO L02

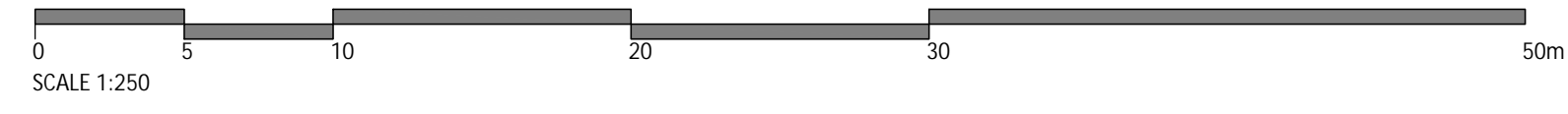

CITY FILE N° 'D07-12-24-0103

PLAN N° --



KEY	BOTANICAL NAME	COMMON NAME	QTY.	SIZE	REMARKS	NATIVE	OWNER
<b>DECIDUOUS TREES - LARGE (15-30M HEIGHT)</b>							
AR	ACER RUBRUM	RED MAPLE	8	50mm	B&B	Y	PRIVATE
CC	CARYA CORDIFORMIS	BITTERNUT HICKORY	8	50mm	B&B	Y	PRIVATE
GD	GYMNOCLADUS DIOICUS	KENTUCKY COFFEE TREE	7	50mm	B&B	Y	PRIVATE
QP	QUERCUS PALUSTRIS	PIN OAK	6	50mm	B&B	Y	PRIVATE
QR	QUERCUS RUBRA	RED OAK	9	50mm	B&B	Y	PRIVATE
PO	PLATANUS OCCIDENTALIS	AMERICAN SYCAMORE	8	50mm	B&B	Y	PRIVATE
LT	LIRIODENDRON TULIPIFERA	TULIP TREE	7	50mm	B&B	Y	PRIVATE
<b>DECIDUOUS TREES - MEDIUM (8-14M HEIGHT)</b>							
AG	AESCULUS GLABRA	OHIO BUCKEYE	4	50mm	B&B	Y	PRIVATE
ARR	ACER RUBRUM 'REDPOINTE'	REDPOINTE RED MAPLE	3	50mm	B&B	Y	PRIVATE
BL	BETULA LENTA	CHERRY BIRCH	3	50mm	B&B	Y	PRIVATE
CCA	CARPINUS CAROLINIANA	BLUE BEECH	3	50mm	B&B	Y	PRIVATE
OV	OSTRYA VIRGINIANA	IRONWOOD	4	50mm	B&B	Y	PRIVATE
QO	QUERCUS PRINUS	CHESTNUT OAK	3	50mm	B&B	Y	PRIVATE

<b>DECIDUOUS TREES - SMALL (6-8M HEIGHT)</b>							
CCI	CRATAEGUS CRUSGALI 'INERMIS'	THORNLESS HAWTHORN	3	250cm 15 GAL	PT, TREE FORM	Y	PRIVATE
<b>MULTI-STEM SHRUBS</b>							
Ac	AMELANCHIER CANADENSIS	SERVICEBERRY	11	125cm ht.	PT, CLUMP	Y	PRIVATE
Al	AMELANCHIER LAEVIS	ALLEGHENY SERVICEBERRY	14	125cm ht.	PT, CLUMP	Y	PRIVATE
Ca	CORNUS ALTERNIFOLIA	PAGODA DOGWOOD	13	125cm ht.	PT, CLUMP	Y	PRIVATE
Hv	HAMAMELIS VIRGINIANA	WITCHHAZEL	11	125cm ht.	PT, CLUMP	Y	PRIVATE
Vd	VIBURNUM DENTATUM	ARROWOOD VIBURNUM	11	125cm ht.	PT, CLUMP	Y	PRIVATE
VI	VIBURNUM LENTAGO	NANNYBERRY	11	125cm ht.	PT, CLUMP	Y	PRIVATE
<b>CONIFEROUS SHRUBS</b>							
Js	JUNIPERUS SCOPULORUM 'WICHITA BLUE'	WITCHITA BLUE JUNIPER	25	3 GAL	POT	Y	PRIVATE
Tc	TAXUS CANADENSIS	CANADIAN YEW	61	3 GAL	POT	Y	PRIVATE
<b>DECIDUOUS SHRUBS</b>							
Am	ARONIA MELANOCARPA	BLACK CHOKEBERRY	292	3 GAL	POT	Y	PRIVATE
Sa	SYMPHORICARPOS ALBUS	SNOWBERRY	165	3 GAL	POT	Y	PRIVATE
Po	PHYSCARPUS OPULIFOLIUS 'DIABOLO'	'DIABOLO' NINEBARK	143	3 GAL	POT	Y	PRIVATE

<b>ORNAMENTAL GRASSES</b>							
cl	CHASMANTHIUM LATIFOLIUM	NORTHERN SEA OATS	410	7 GAL	POT	Y	PRIVATE
dc	DESCHAMPSIA CESPITOSA	TUFTED HAIR GRASS	294	7 GAL	POT	Y	PRIVATE
bg	BOUTELOUA GRACILIS	BLUE GRAMA	191	7 GAL	POT	Y	PRIVATE
sh	SPOROBOLUS HETEROLEPSIS	PRARIE DROPSEED	377	7 GAL	POT	Y	PRIVATE
ss	SCHIZACHYRIUM SCOPARIUM	LITTLE BLUESTEM	276	7 GAL	POT	Y	PRIVATE

**GENERAL NOTES:**

- ALL PLANT MATERIAL SHALL BE NURSERY GROWN STOCK UNLESS OTHERWISE NOTED.
- TREES TO HAVE A MINIMUM 1800 CLEAR STEM ABOVE GRADE.
- CONTRACTOR TO MAKE GOOD ALL EXISTING AREAS DAMAGED BY HIS WORK TO THE SATISFACTION OF THE CONTRACTOR.
- ALL PLANT MATERIAL SHALL BE WARRANTIED FOR TWO YEARS FROM THE DATE OF SUBSTANTIAL COMPLETION.
- CONTRACTOR TO VERIFY LOCATION OF ALL SERVICES PRIOR TO ANY EXCAVATION.
- ANY PROPOSED SUBSTITUTIONS OF PLANT SPECIES SHALL BE MADE WITH PLANTS OF EQUIVALENT OVERALL FORM, HEIGHT, BRANCHING HABIT, FLOWER, LEAF, COLOR, FRUIT AND CULTURE AND ONLY AFTER APPROVAL OF THE LANDSCAPE ARCHITECT.

**TREE PLANTING IN MARINE CLAY SOILS**

THE LANDSCAPE CONSIDERATIONS CONTAINED WITHIN SEC. 6.8 OF PATERSON GROUP'S GEOTECHNICAL INVESTIGATION, DATED AUGUST 26, 2024.

- THIS LANDSCAPE PLAN CONFORMS WITH THE TREE-TO-FOUNDATION SETBACK, SOIL VOLUME, AND SURFACE-GRADING REQUIREMENTS OUTLINED IN THE CITY OF OTTAWA'S GUIDELINES FOR TREE PLANTING IN SENSITIVE MARINE CLAY SOILS (2017), BASED ON THE FINDINGS OUTLINED IN THE PROJECT GEOTECHNICAL REPORT BY PATERSON GROUP (REPORT PG6152-1 REV 3 DATED AUGUST, 2024).
- ADDITIONAL REQUIREMENTS OUTLINED IN THE CITY OF OTTAWA'S GUIDELINES FOR TREE PLANTING IN SENSITIVE MARINE CLAY SOILS (2017), INCLUDING USF DEPTH, FOUNDATION WALL REINFORCEMENT, AND SUBDIVISION GRADING, SHOULD BE CONFIRMED BY THE PROJECT ENGINEER(S).

<b>TREE SOIL VOLUMES</b>			
TREE TYPE/SIZE	SINGLE TREE SOIL VOLUME	MULTIPLE TREE SOIL VOLUME (m <sup>3</sup> /TREE)	SOIL VOLUME FOR MARINE CLAY AREAS (SINGLE TREE)
ORNAMENTAL	15	9	
COLUMNAR	15	9	
SMALL	20	12	25
MEDIUM	25	15	30
LARGE	30	18	
CONIFER	25	15	

Contractor shall check all dimensions on the work and report any discrepancy to the Landscape Architect before proceeding. All drawings and specifications are the property of the Landscape Architect and must be returned at the completion of the work. This drawing is not to be used for construction until signed by the Landscape Architect.

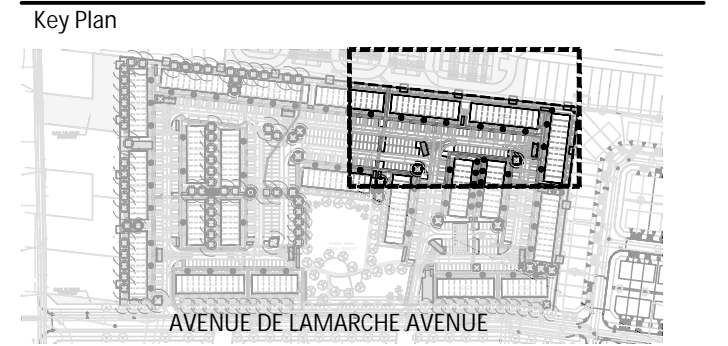

**LEGEND**

--- PROPERTY LINE

**FENCING**

--- WASTE ENCLOSURE FENCE

--- WOOD PRIVACY FENCE

**PLANTING**

○ LARGE DECIDUOUS TREE

○ MEDIUM DECIDUOUS TREE

○ SMALL DECIDUOUS TREE

○ TREE CANOPY PROJECTION

○ TREE FORM SHRUB

○ DECIDUOUS/CONIFEROUS SHRUBS

○ GRASSES/PERENNIALS

○ SODDING

**PAVING**

ASPHALT PAVING

CIP CONCRETE PAVING

HEAVY DUTY CONCRETE PAVING

RIVERSTONE PAVING

UNIT PAVING

**PLANTING KEY**

XX TREE SPECIES

00 QUANTITY

XX SHRUB SPECIES

00 QUANTITY

**DETAIL KEY**

1 DETAIL NO.

L1 SHEET NO.

No.	Description	Date
3	Issued for Revised First Submission	Dec.17/24
2	Issued for Revised First Submission	Nov.04/24
1	Issued for First Submission	Sept.03/24

**PROPERTY INFORMATION**  
 PIN 04404-1854 (LT), 04404-1880 (LT), 04404-1882 (LT) and Part of PIN 04404-1855 (LT), being Blocks 147, 173, 175 and Part of Block 148, Registered Plan 4M-1629

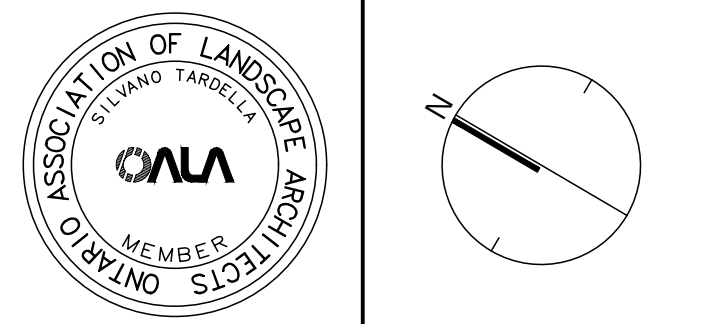

**NAK design strategies**  
 1285 WELLINGTON STREET, OTTAWA, ON K1Y 3A8 CANADA  
 1.613.237.2345  
 Project

**ORLEANS VILLAGE PHASE 4**  
 OTTAWA, ON

Title	LANDSCAPE PLAN
Date	2024-08-12
Scale	1:250
Drawn	SW
Checked	SC
Job No.	22-145

L02

PLAN N° --



TREE TYPE/SIZE	SINGLE TREE SOIL VOLUME	MULTIPLE TREE SOIL VOLUME (m <sup>3</sup> /TREE)	CLAY SOILS
SMALL	15	9	4475, 3465, 3000
MEDIUM/CONIFER	20	12	5000, 3870, 3480
LARGE	25	15	5180, 4240

\*SOIL VOLUME CALCULATION BASED ON 1.0m DEPTH

<b>PROPOSED TREE CANOPY PROJECTIONS</b>			
TREE TYPE/SIZE	CROWN AREA PER TREE STANDARD RANGE (m <sup>2</sup> )	CROWN AREA PER TREE USED FOR CALC. (m <sup>2</sup> )	SITE CANOPY COVER
LARGE (54)	135-250*	192	CANOPY (W. OVERLAP): 6,980m <sup>2</sup>
MEDIUM (19)	35-135*	85	
SMALL (3)	5-35*	20	

<b>PROPOSED STREET TREE PROJECTED CANOPY</b>		
PROPOSED STREET TREE CANOPY (BY OTHERS), m <sup>2</sup> CALCULATION BASED ON PROPOSED TREE SPECIES PROJECTIONS	CANOPY (W. OVERLAP):	
658m <sup>2</sup>	40,717m <sup>2</sup>	TOTAL PERCENT COVER: 18.76%

\*RANGE OF CROWN AREAS IS IN ACCORDANCE WITH PROPOSED TREES SPECIES

\*\*CROWN AREAS ARE ACCORDING TO THE AVERAGE MATURE CANOPY SIZE OF THE RESPECTIVE SPECIES. CANOPY SIZING HAS BEEN DETERMINED IN REFERENCE TO VARIOUS ARBORICULTURAL AND BOTANICAL SOURCES, SUCH AS: ONTARIO MINISTRY OF NATURAL RESOURCES & FORESTRY (OMNRF); US FOREST SERVICE; FARRAR, J.L. TREES IN CANADA, UNIVERSITY OF GUELPH ARBORETUM, VARIOUS PUBLICATIONS

\*\*\*NOTE: SITE AREA AND TREE COUNTS DO NOT INCLUDE PARK BLOCK.

CITY FILE N° - D07-12-24-0103



KEY	BOTANICAL NAME	COMMON NAME	QTY.	SIZE	REMARKS	NATIVE	OWNER
<b>DECIDUOUS TREES - LARGE (15-30M HEIGHT)</b>							
AR	ACER RUBRUM	RED MAPLE	8	50mm	B&B	Y	PRIVATE
CC	CARYA CORDIFORMIS	BITTERNUT HICKORY	8	50mm	B&B	Y	PRIVATE
GD	GYMNOCALDUS DIOICUS	KENTUCKY COFFEE TREE	7	50mm	B&B	Y	PRIVATE
QR	QUERCUS PALUSTRIS	PIN OAK	6	50mm	B&B	Y	PRIVATE
QP	QUERCUS RUBRA	RED OAK	9	50mm	B&B	Y	PRIVATE
PO	PLATANUS OCCIDENTALIS	AMERICAN SYCAMORE	8	50mm	B&B	Y	PRIVATE
LT	LIRIODENDRON TULIPIFERA	TULIP TREE	7	50mm	B&B	Y	PRIVATE
<b>DECIDUOUS TREES - MEDIUM (8-14M HEIGHT)</b>							
AG	AESCULUS GLABRA	OHIO BUCKEYE	4	50mm	B&B	Y	PRIVATE
ARR	ACER RUBRUM 'REDPOINTE'	REDPOINTE RED MAPLE	3	50mm	B&B	Y	PRIVATE
BL	BETULA LENTA	CHERRY BIRCH	3	50mm	B&B	Y	PRIVATE
CCA	CARPINUS CAROLINIANA	BLUE BEECH	3	50mm	B&B	Y	PRIVATE
OV	OSTRYA VIRGINIANA	IRONWOOD	4	50mm	B&B	Y	PRIVATE
OO	QUERCUA PRINUS	CHESTNUT OAK	3	50mm	B&B	Y	PRIVATE

<b>DECIDUOUS TREES - SMALL (6-8M HEIGHT)</b>							
CCI	CRATAEGUS CRUSGALI 'INERMIS'	THORNLESS HAWTHORN	3	250cm ht	15 GAL	PT, TREE FORM	Y PRIVATE
<b>MULTI-STEM SHRUBS</b>							
Ac	AMELANCHIER CANADENSIS	SERVICEBERRY	11	125cm ht.		PT, CLUMP	Y PRIVATE
Al	AMELANCHIER LAEVIS	ALLEGHENY SERVICEBERRY	14	125cm ht.		PT, CLUMP	Y PRIVATE
Ca	CORNUS ALTERNIFOLIA	PAGODA DOGWOOD	13	125cm ht.		PT, CLUMP	Y PRIVATE
Hv	HAMAMELIS VIRGINIANA	WITCHHAZEL	11	125cm ht.		PT, CLUMP	Y PRIVATE
Vd	VIBURNUM DENTATUM	ARROWOOD VIBURNUM	11	125cm ht.		PT, CLUMP	Y PRIVATE
VI	VIBURNUM LENTAGO	NANNYBERRY	11	125cm ht.		PT, CLUMP	Y PRIVATE
<b>CONIFEROUS SHRUBS</b>							
Js	JUNIPERUS SCOPULORUM 'WICHITA BLUE'	WITCHITA BLUE JUNIPER	25	3 GAL		POT	Y PRIVATE
Tc	TAXUS CANADENSIS	CANADIAN YEW	61	3 GAL		POT	Y PRIVATE
<b>DECIDUOUS SHRUBS</b>							
Am	ARONIA MELANOCARPA	BLACK CHOKEBERRY	292	3 GAL		POT	Y PRIVATE
Sa	SYMPHORICARPOS ALBUS	SNOWBERRY	165	3 GAL		POT	Y PRIVATE
Po	PHYSCARPUS OPULIFOLIUS 'DIABOLO'	'DIABOLO' NINEBARK	143	3 GAL		POT	Y PRIVATE

<b>ORNAMENTAL GRASSES</b>							
cl	CHASMANTHIUM LATIFOLIUM	NORTHERN SEA OATS	410	7 GAL		POT	Y PRIVATE
dc	DESCHAMPSIA CESPITOSA	TUFTED HAIR GRASS	294	7 GAL		POT	Y PRIVATE
bg	BOUTELOUA GRACILIS	BLUE GRAMA	191	7 GAL		POT	Y PRIVATE
sh	SPOROBOLUS HETEROLEPSIS	PRARIE DROPSEED	377	7 GAL		POT	Y PRIVATE
ss	SCHIZACHYRIUM SCOPARIUM	LITTLE BLUESTEM	276	7 GAL		POT	Y PRIVATE

**GENERAL NOTES:**

- ALL PLANT MATERIAL SHALL BE NURSERY GROWN STOCK UNLESS OTHERWISE NOTED.
- TREES TO HAVE A MINIMUM 1800 CLEAR STEM ABOVE GRADE.
- CONTRACTOR TO MAKE GOOD ALL EXISTING AREAS DAMAGED BY HIS WORK TO THE SATISFACTION OF THE CONTRACTOR.
- ALL PLANT MATERIAL SHALL BE WARRANTIED FOR TWO YEARS FROM THE DATE OF SUBSTANTIAL COMPLETION.
- CONTRACTOR TO VERIFY LOCATION OF ALL SERVICES PRIOR TO ANY EXCAVATION.
- ANY PROPOSED SUBSTITUTIONS OF PLANT SPECIES SHALL BE MADE WITH PLANTS OF EQUIVALENT OVERALL FORM, HEIGHT, BRANCHING HABIT, FLOWER, LEAF, COLOR, FRUIT AND CULTURE AND ONLY AFTER APPROVAL OF THE LANDSCAPE ARCHITECT.

**TREE PLANTING IN MARINE CLAY SOILS**

THE LANDSCAPE CONSIDERATIONS CONTAINED WITHIN SEC. 6.8 OF PATERSON GROUP'S GEOTECHNICAL INVESTIGATION, DATED AUGUST 26, 2024.

- THIS LANDSCAPE PLAN CONFORMS WITH THE TREE-TO-FOUNDATION SETBACK, SOIL VOLUME, AND SURFACE-GRADING REQUIREMENTS OUTLINED IN THE CITY OF OTTAWA'S GUIDELINES FOR TREE PLANTING IN SENSITIVE MARINE CLAY SOILS (2017), BASED ON THE FINDINGS OUTLINED IN THE PROJECT GEOTECHNICAL REPORT BY PATERSON GROUP (REPORT PG6152-1 REV 3 DATED AUGUST, 2024).
- ADDITIONAL REQUIREMENTS OUTLINED IN THE CITY OF OTTAWA'S GUIDELINES FOR TREE PLANTING IN SENSITIVE MARINE CLAY SOILS (2017), INCLUDING USF DEPTH, FOUNDATION WALL REINFORCEMENT, AND SUBDIVISION GRADING, SHOULD BE CONFIRMED BY THE PROJECT ENGINEER(S).

<b>TREE SOIL VOLUMES</b>			
TREE TYPE/SIZE	SINGLE TREE SOIL VOLUME	MULTIPLE TREE SOIL VOLUME (m3/TREE)	SOIL VOLUME FOR MARINE CLAY AREAS (SINGLE TREE)
ORNAMENTAL	15	9	
COLUMNAR	15	9	
SMALL	20	12	25
MEDIUM	25	15	30
LARGE	30	18	
CONIFER	25	15	

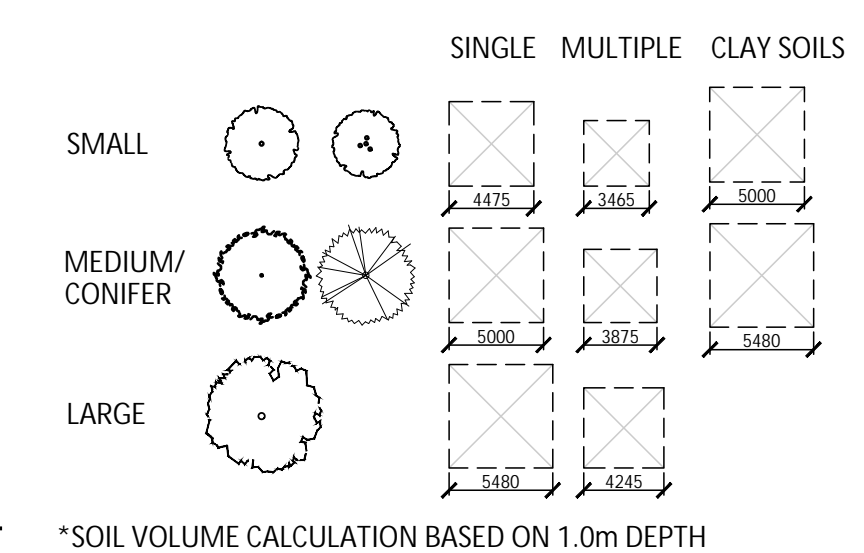

\*SOIL VOLUME CALCULATION BASED ON 1.0m DEPTH

<b>PROPOSED TREE CANOPY PROJECTIONS</b>			
TREE TYPE/SIZE	CROWN AREA PER TREE STANDARD RANGE (m²)	CROWN AREA PER TREE USED FOR CALC. (m²)	SITE CANOPY COVER
LARGE (54)	135-250*	192	CANOPY (W. OVERLAP): 6,980m²
MEDIUM (19)	35-135*	85	
SMALL (3)	5-35*	20	

<b>PROPOSED STREET TREE PROJECTED CANOPY</b>	
PROPOSED STREET TREE CANOPY (BY OTHERS), m² CALCULATION BASED ON PROPOSED TREE SPECIES PROJECTIONS	CANOPY (W. OVERLAP): 658m²
**RANGE OF CROWN AREAS IS IN ACCORDANCE WITH PROPOSED TREE SPECIES	SITE: 40,717m²
**CROWN AREAS ARE ACCORDING TO THE AVERAGE MATURE CANOPY SIZE OF THE RESPECTIVE SPECIES. CANOPY SIZING HAS BEEN DETERMINED IN REFERENCE TO VARIOUS ARBORICULTURAL AND BOTANICAL SOURCES, SUCH AS: ONTARIO MINISTRY OF NATURAL RESOURCES & FORESTRY (OMNRF); US FOREST SERVICE; FARRAR, J.L. TREES IN CANADA; UNIVERSITY OF GUELPH ARBORETUM, VARIOUS PUBLICATIONS	TOTAL PERCENT COVER: 18.76%
***NOTE: SITE AREA AND TREE COUNTS DO NOT INCLUDE PARK BLOCK.	

Contractor shall check all dimensions on the work and report any discrepancy to the Landscape Architect before proceeding. All drawings and specifications are the property of the Landscape Architect and must be returned at the completion of the work. This drawing is not to be used for construction until signed by the Landscape Architect.

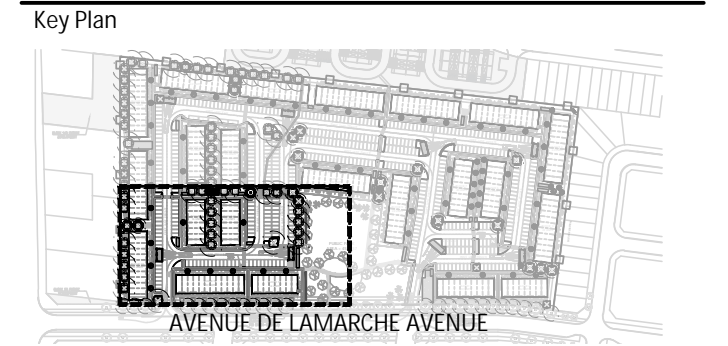

**LEGEND**

--- PROPERTY LINE

**FENCING**

--- WASTE ENCLOSURE FENCE

--- WOOD PRIVACY FENCE

**PLANTING**

○ LARGE DECIDUOUS TREE

○ MEDIUM DECIDUOUS TREE

○ SMALL DECIDUOUS TREE

○ TREE CANOPY PROJECTION

○ TREE FORM SHRUB

○ DECIDUOUS/CONIFEROUS SHRUBS

○ GRASSES/PERENNIALS

○ SODDING

**PAVING**

■ ASPHALT PAVING

■ CIP CONCRETE PAVING

■ HEAVY DUTY CONCRETE PAVING

■ RIVERSTONE PAVING

■ UNIT PAVING

**PLANTING KEY**

XX TREE SPECIES

00 QUANTITY

XX SHRUB SPECIES

00 QUANTITY

**DETAIL KEY**

1 DETAIL NO.

L1 SHEET NO.

No.	Description	Date
3	Issued for Revised First Submission	Dec. 17/24
2	Issued for Revised First Submission	Nov. 04/24
1	Issued for First Submission	Sept. 03/24

PROPERTY INFORMATION  
 PIN 04404-1854 (LT), 04404-1880 (LT), 04404-1882 (LT) and Part of PIN 04404-1855 (LT), being Blocks 147, 173, 175 and Part of Block 148, Registered Plan 4M-1629

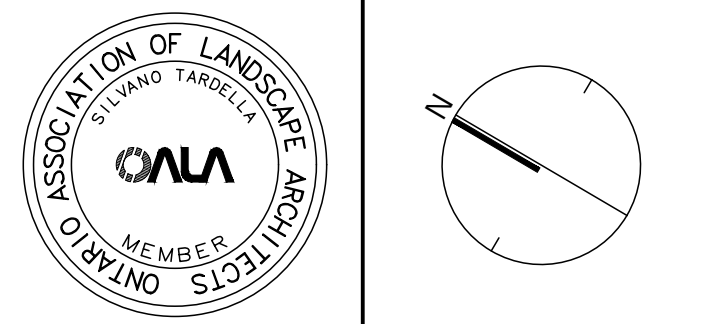

**NAK design strategies**

1285 WELLINGTON STREET, OTTAWA, ON K1Y 3A8 CANADA  
 1.613.237.2345 NAKDESIGNSTRATEGIES.COM

**ORLEANS VILLAGE PHASE 4**  
OTTAWA, ON

Title	LANDSCAPE PLAN
Date	2024-08-12
Scale	1:250
Drawn	SW
Checked	SC
Job No.	22-145

L03

PLAN N° --

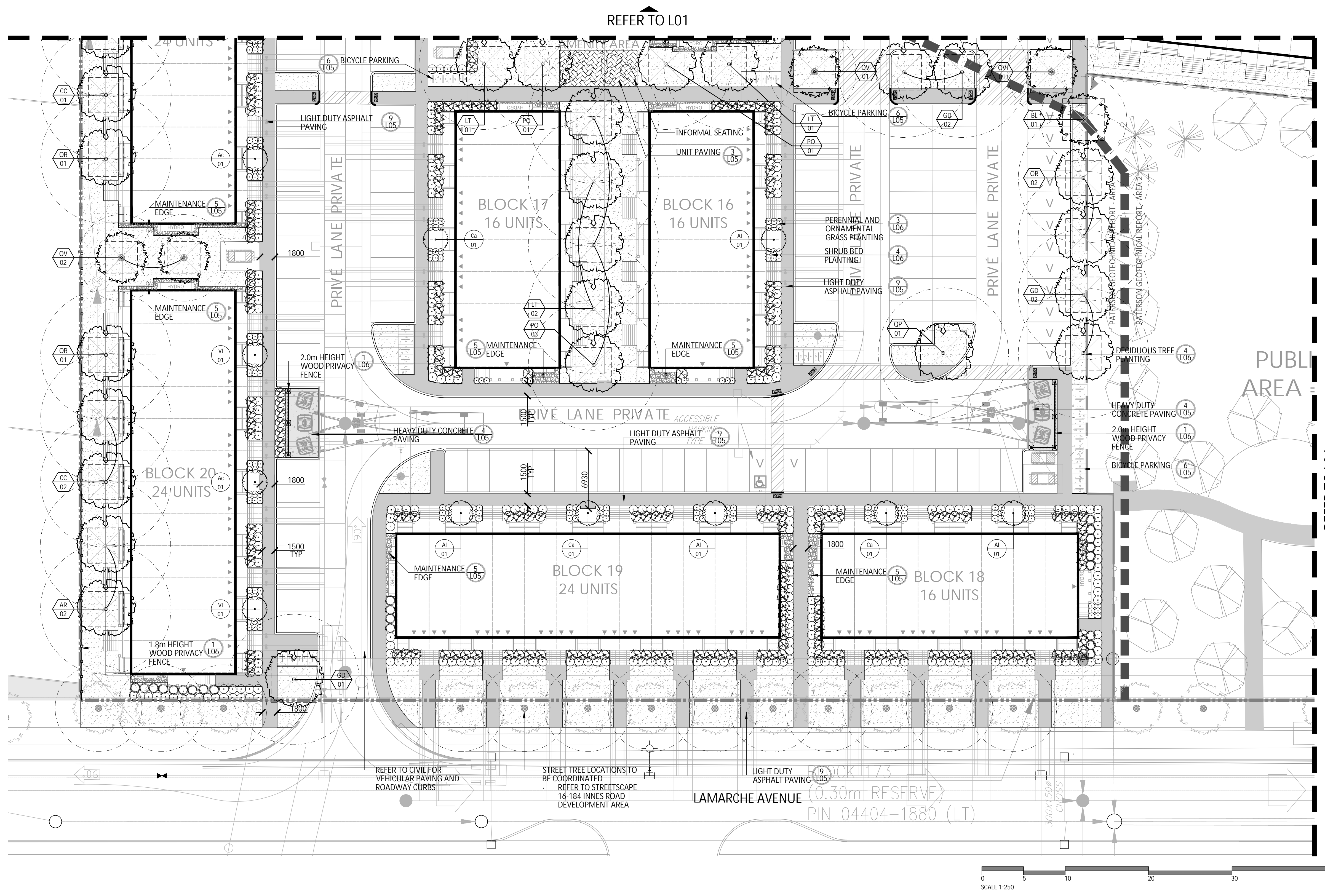

CITY FILE N° D07-12-24-0103



KEY	BOTANICAL NAME	COMMON NAME	QTY.	SIZE	REMARKS	NATIVE	OWNER
<b>DECIDUOUS TREES - LARGE (15-30M HEIGHT)</b>							
AR	ACER RUBRUM	RED MAPLE	8	50mm	B&B	Y	PRIVATE
CC	CARYA CORDIFORMIS	BITTERNUT HICKORY	8	50mm	B&B	Y	PRIVATE
GD	GYMNOCLADUS DIOICUS	KENTUCKY COFFEE TREE	7	50mm	B&B	Y	PRIVATE
QR	QUERCUS PALUSTRIS	PIN OAK	6	50mm	B&B	Y	PRIVATE
QP	QUERCUS RUBRA	RED OAK	9	50mm	B&B	Y	PRIVATE
PO	PLATANUS OCCIDENTALIS	AMERICAN SYCAMORE	8	50mm	B&B	Y	PRIVATE
LT	LIRIODENDRON TULIPIFERA	TULIP TREE	7	50mm	B&B	Y	PRIVATE
<b>DECIDUOUS TREES - MEDIUM (8-14M HEIGHT)</b>							
AG	AESCULUS GLABRA	OHIO BUCKEYE	4	50mm	B&B	Y	PRIVATE
ARR	ACER RUBRUM 'REDPOINTE'	REDPOINTE RED MAPLE	3	50mm	B&B	Y	PRIVATE
BL	BETULA LENTA	CHERRY BIRCH	3	50mm	B&B	Y	PRIVATE
CCA	CARPINUS CAROLINIANA	BLUE BEECH	3	50mm	B&B	Y	PRIVATE
OV	OSTRYA VIRGINIANA	IRONWOOD	4	50mm	B&B	Y	PRIVATE
QO	QUERCUS PRINUS	CHESTNUT OAK	3	50mm	B&B	Y	PRIVATE

<b>DECIDUOUS TREES - SMALL (6-8M HEIGHT)</b>							
CCI	CRATAEGUS CRUSGALI 'INERMIS'	THORNLESS HAWTHORN	3	250cm 15 GAL	PT, TREE FORM	Y	PRIVATE
<b>MULTI-STEM SHRUBS</b>							
Ac	AMELANCHIER CANADENSIS	SERVICEBERRY	11	125cm ht.	PT, CLUMP	Y	PRIVATE
AI	AMELANCHIER LAEVIS	ALLEGHENY SERVICEBERRY	14	125cm ht.	PT, CLUMP	Y	PRIVATE
Ca	CORNUS ALTERNIFOLIA	PAGODA DOGWOOD	13	125cm ht.	PT, CLUMP	Y	PRIVATE
Hv	HAMAMELIS VIRGINIANA	WITCHHAZEL	11	125cm ht.	PT, CLUMP	Y	PRIVATE
Vd	VIBURNUM DENTATUM	ARROWOOD VIBURNUM	11	125cm ht.	PT, CLUMP	Y	PRIVATE
VI	VIBURNUM LENTAGO	NANNYBERRY	11	125cm ht.	PT, CLUMP	Y	PRIVATE
<b>CONIFEROUS SHRUBS</b>							
Js	JUNIPERUS SCOPULORUM 'WICHITA BLUE'	WITCHITA BLUE JUNIPER	25	3 GAL	POT	Y	PRIVATE
Tc	TAXUS CANADENSIS	CANADIAN YEW	61	3 GAL	POT	Y	PRIVATE
<b>DECIDUOUS SHRUBS</b>							
Am	ARONIA MELANOCARPA	BLACK CHOKEBERRY	292	3 GAL	POT	Y	PRIVATE
Sa	SYMPHORICARPOS ALBUS	SNOWBERRY	165	3 GAL	POT	Y	PRIVATE
Po	PHYSCARPUS OPULIFOLIUS 'DIABOLO'	'DIABOLO' NINEBARK	143	3 GAL	POT	Y	PRIVATE

<b>ORNAMENTAL GRASSES</b>							
cl	CHASMANTHIUM LATIFOLIUM	NORTHERN SEA OATS	410	7 GAL	POT	Y	PRIVATE
dc	DESCHAMPSIA CESPITOSA	TUFTED HAIR GRASS	294	7 GAL	POT	Y	PRIVATE
bg	BOUTELOUA GRACILIS	BLUE GRAMA	191	7 GAL	POT	Y	PRIVATE
sh	SPOROBOLUS HETEROLEPSIS	PRARIE DROPSEED	377	7 GAL	POT	Y	PRIVATE
ss	SCHIZACHYRIUM SCOPARIUM	LITTLE BLUESTEM	276	7 GAL	POT	Y	PRIVATE

**GENERAL NOTES:**

- ALL PLANT MATERIAL SHALL BE NURSERY GROWN STOCK UNLESS OTHERWISE NOTED.
- TREES TO HAVE A MINIMUM 1800 CLEAR STEM ABOVE GRADE.
- CONTRACTOR TO MAKE GOOD ALL EXISTING AREAS DAMAGED BY HIS WORK TO THE SATISFACTION OF THE CONTRACTOR.
- ALL PLANT MATERIAL SHALL BE WARRANTED FOR TWO YEARS FROM THE DATE OF SUBSTANTIAL COMPLETION.
- CONTRACTOR TO VERIFY LOCATION OF ALL SERVICES PRIOR TO ANY EXCAVATION.
- ANY PROPOSED SUBSTITUTIONS OF PLANT SPECIES SHALL BE MADE WITH PLANTS OF EQUIVALENT OVERALL FORM, HEIGHT, BRANCHING HABIT, FLOWER, LEAF, COLOR, FRUIT AND CULTURE AND ONLY AFTER APPROVAL OF THE LANDSCAPE ARCHITECT.

**TREE PLANTING IN MARINE CLAY SOILS**

THE LANDSCAPE CONSIDERATIONS CONTAINED WITHIN SEC. 6.8 OF PATERSON GROUP'S GEOTECHNICAL INVESTIGATION, DATED AUGUST 26, 2024.

- THIS LANDSCAPE PLAN CONFORMS WITH THE TREE-TO-FOUNDATION SETBACK, SOIL VOLUME, AND SURFACE-GRADING REQUIREMENTS OUTLINED IN THE CITY OF OTTAWA'S GUIDELINES FOR TREE PLANTING IN SENSITIVE MARINE CLAY SOILS (2017), BASED ON THE FINDINGS OUTLINED IN THE PROJECT GEOTECHNICAL REPORT BY PATERSON GROUP (REPORT PG6152-1 REV 3 DATED AUGUST, 2024).
- ADDITIONAL REQUIREMENTS OUTLINED IN THE CITY OF OTTAWA'S GUIDELINES FOR TREE PLANTING IN SENSITIVE MARINE CLAY SOILS (2017), INCLUDING USF DEPTH, FOUNDATION WALL REINFORCEMENT, AND SUBDIVISION GRADING, SHOULD BE CONFIRMED BY THE PROJECT ENGINEER(S).

<b>TREE SOIL VOLUMES</b>			
TREE TYPE/SIZE	SINGLE TREE SOIL VOLUME	MULTIPLE TREE SOIL VOLUME (m3/TREE)	SOIL VOLUME FOR MARINE CLAY AREAS (SINGLE TREE)
ORNAMENTAL	15	9	
COLUMNAR	15	9	
SMALL	20	12	25
MEDIUM	25	15	30
LARGE	30	18	
CONIFER	25	15	

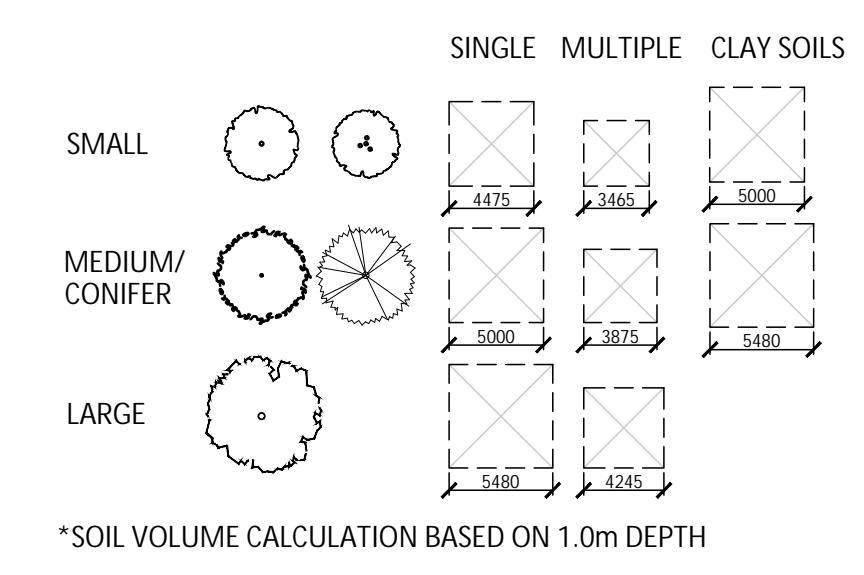

\*SOIL VOLUME CALCULATION BASED ON 1.0m DEPTH

<b>PROPOSED TREE CANOPY PROJECTIONS</b>			
TREE TYPE/SIZE	CROWN AREA PER TREE STANDARD RANGE (m²)	CROWN AREA PER TREE USED FOR CALC. (m²)	SITE CANOPY COVER
LARGE (54)	135-250*	192	CANOPY (W. OVERLAP): 6,980m²
MEDIUM (19)	35-135*	85	
SMALL (3)	5-35*	20	

<b>PROPOSED STREET TREE PROJECTED CANOPY</b>	
PROPOSED STREET TREE CANOPY (BY OTHERS), m² CALCULATION BASED ON PROPOSED TREE SPECIES PROJECTIONS	CANOPY (W. OVERLAP): 658m²
*RANGE OF CROWN AREAS IS IN ACCORDANCE WITH PROPOSED TREES SPECIES	SITE: 40,717m²
**CROWN AREAS ARE ACCORDING TO THE AVERAGE MATURE CANOPY SIZE OF THE RESPECTIVE SPECIES. CANOPY SIZING HAS BEEN DETERMINED IN REFERENCE TO VARIOUS ARBORICULTURAL AND BOTANICAL SOURCES, SUCH AS: ONTARIO MINISTRY OF NATURAL RESOURCES & FORESTRY (OMNRF); US FOREST SERVICE; FARRAR, J.L. TREES IN CANADA; UNIVERSITY OF GUELPH ARBORETUM, VARIOUS PUBLICATIONS	TOTAL PERCENT COVER: 18.76%
***NOTE: SITE AREA AND TREE COUNTS DO NOT INCLUDE PARK BLOCK.	

Contractor shall check all dimensions on the work and report any discrepancy to the Landscape Architect before proceeding. All drawings and specifications are the property of the Landscape Architect and must be returned at the completion of the work. This drawing is not to be used for construction until signed by the Landscape Architect.

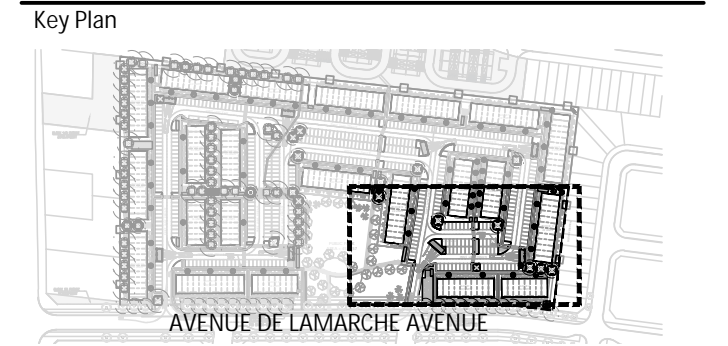

**LEGEND**

--- PROPERTY LINE

**FENCING**

--- WASTE ENCLOSURE FENCE

--- WOOD PRIVACY FENCE

**PLANTING**

○ LARGE DECIDUOUS TREE

○ MEDIUM DECIDUOUS TREE

○ SMALL DECIDUOUS TREE

○ TREE CANOPY PROJECTION

○ TREE FORM SHRUB

○ DECIDUOUS/CONIFEROUS SHRUBS

○ GRASSES/PERENNIALS

○ SODDING

**PAVING**

■ ASPHALT PAVING

■ CIP CONCRETE PAVING

■ HEAVY DUTY CONCRETE PAVING

■ RIVERSTONE PAVING

■ UNIT PAVING

**PLANTING KEY**

XX TREE SPECIES

XX QUANTITY

XX SHRUB SPECIES

XX QUANTITY

**DETAIL KEY**

1 DETAIL NO.

L1 SHEET NO.

No.	Description	Date
3	Issued for Revised First Submission	Dec.17/24
2	Issued for Revised First Submission	Nov.04/24
1	Issued for First Submission	Sept.03/24

Revision	Date
3	Dec.17/24
2	Nov.04/24
1	Sept.03/24

City Approval Stamp

**PROPERTY INFORMATION**

PIN 04404-1854 (LT), 04404-1880 (LT), 04404-1882 (LT) and Part of PIN 04404-1855 (LT), being Blocks 147, 173, 175 and Part of Block 148, Registered Plan 4M-1629

**NAK design strategies**

1285 WELLINGTON STREET, OTTAWA, ON K1Y 3A8 CANADA  
1.613.237.2345 NAKDESIGNSTRATEGIES.COM

**ORLEANS VILLAGE PHASE 4**  
OTTAWA, ON

Title: LANDSCAPE PLAN

Date: 2024-08-12  
Scale: 1:250  
Drawn: SW  
Checked: SC  
Job No.: 22-145

L04

PLAN N° --

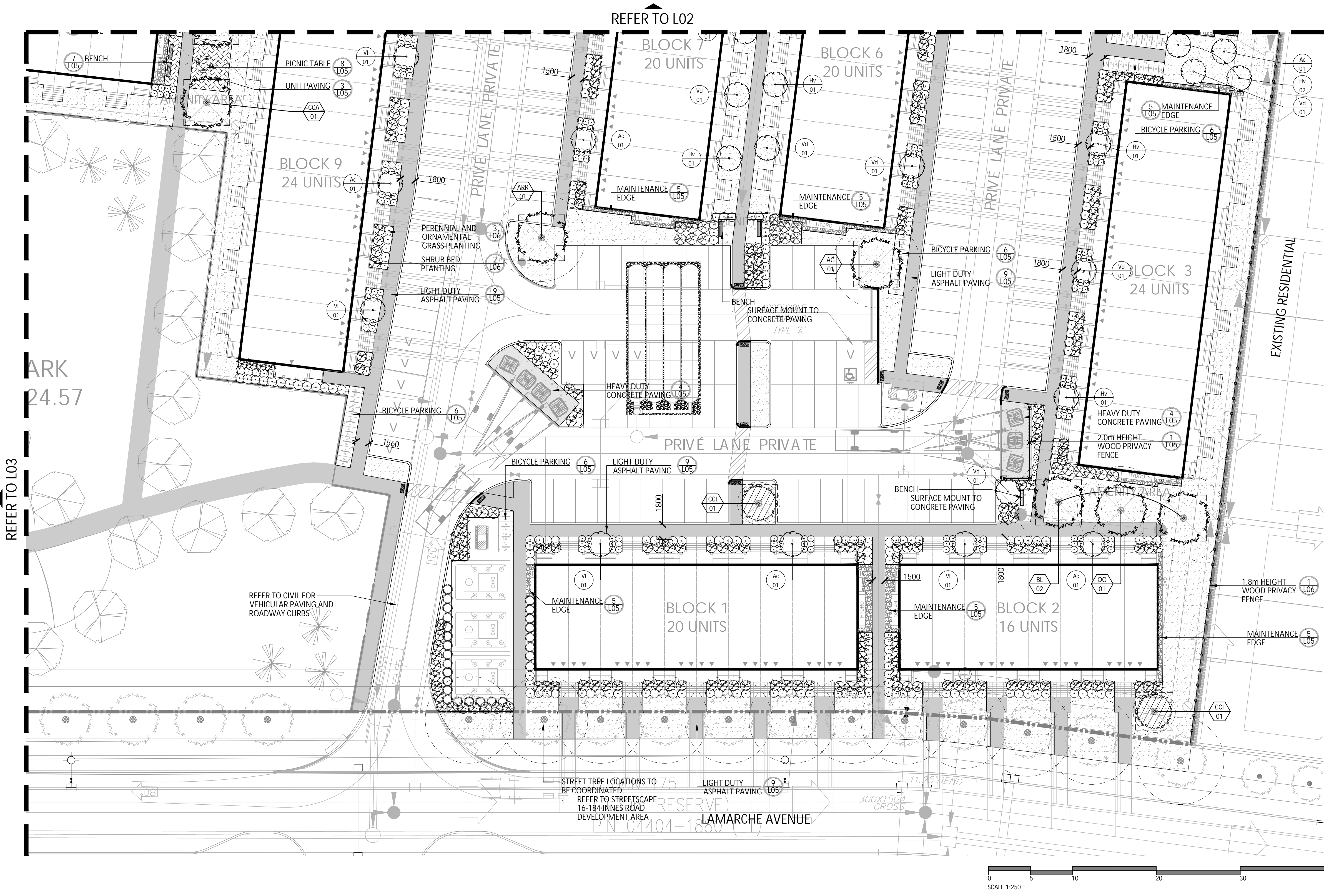

REFER TO L03

REFER TO L02

REFER TO CIVIL FOR VEHICULAR PAVING AND ROADWAY CURBS

STREET TREE LOCATIONS TO BE COORDINATED WITH THE CITY OF OTTAWA. REFER TO LANDSCAPE DEVELOPMENT AREA 16-184 INNES ROAD DEVELOPMENT AREA. LAMARCHE AVENUE PIN 04404-1880 (LT)

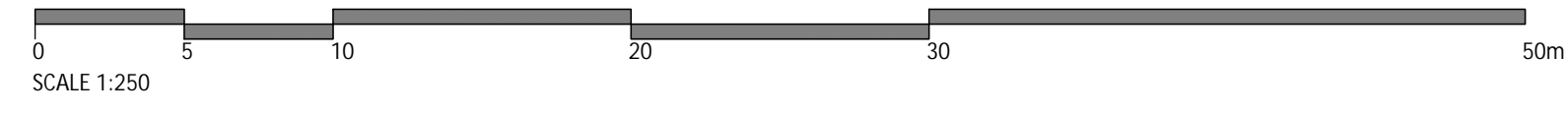

CITY FILE N°: D07-12-24-0103



Contractor shall check all dimensions on the work and report any discrepancy to the Landscape Architect before proceeding. All drawings and specifications are the property of the Landscape Architect and must be returned at the completion of the work. This drawing is not to be used for construction until signed by the Landscape Architect.

Key Plan

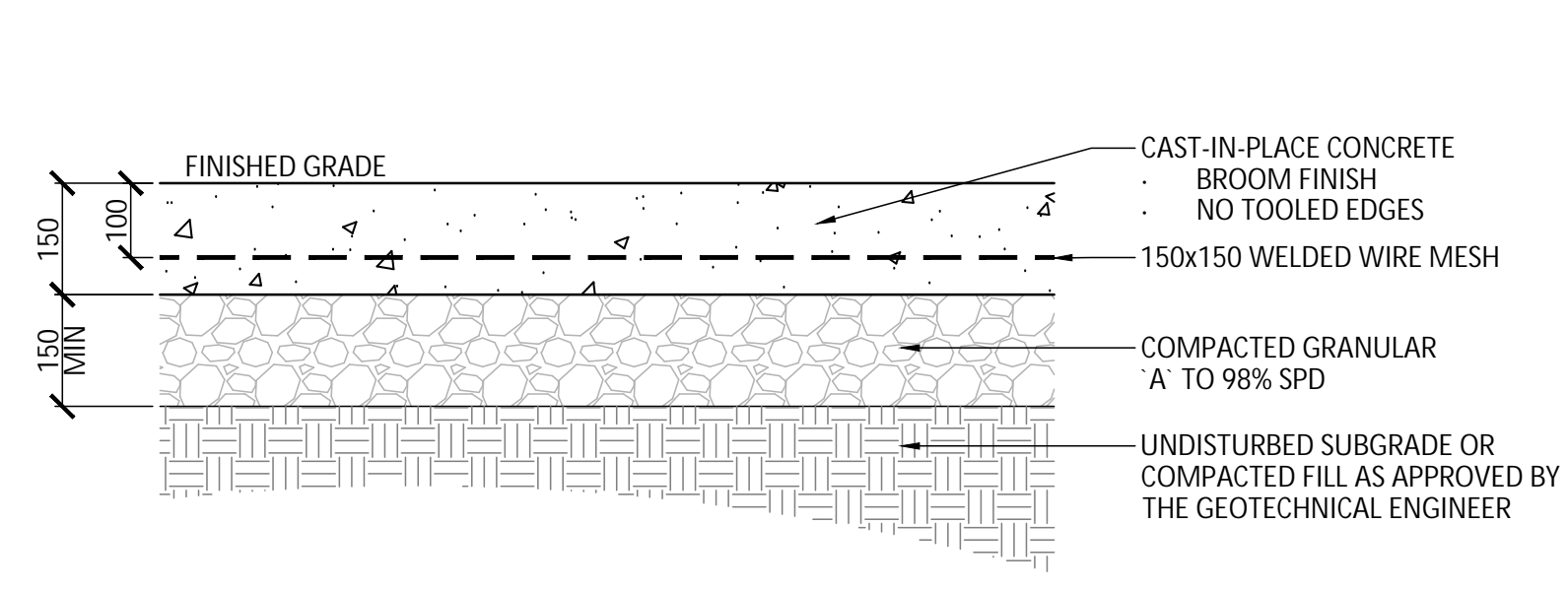

1 PEDESTRIAN CONCRETE PAVING  
1:10

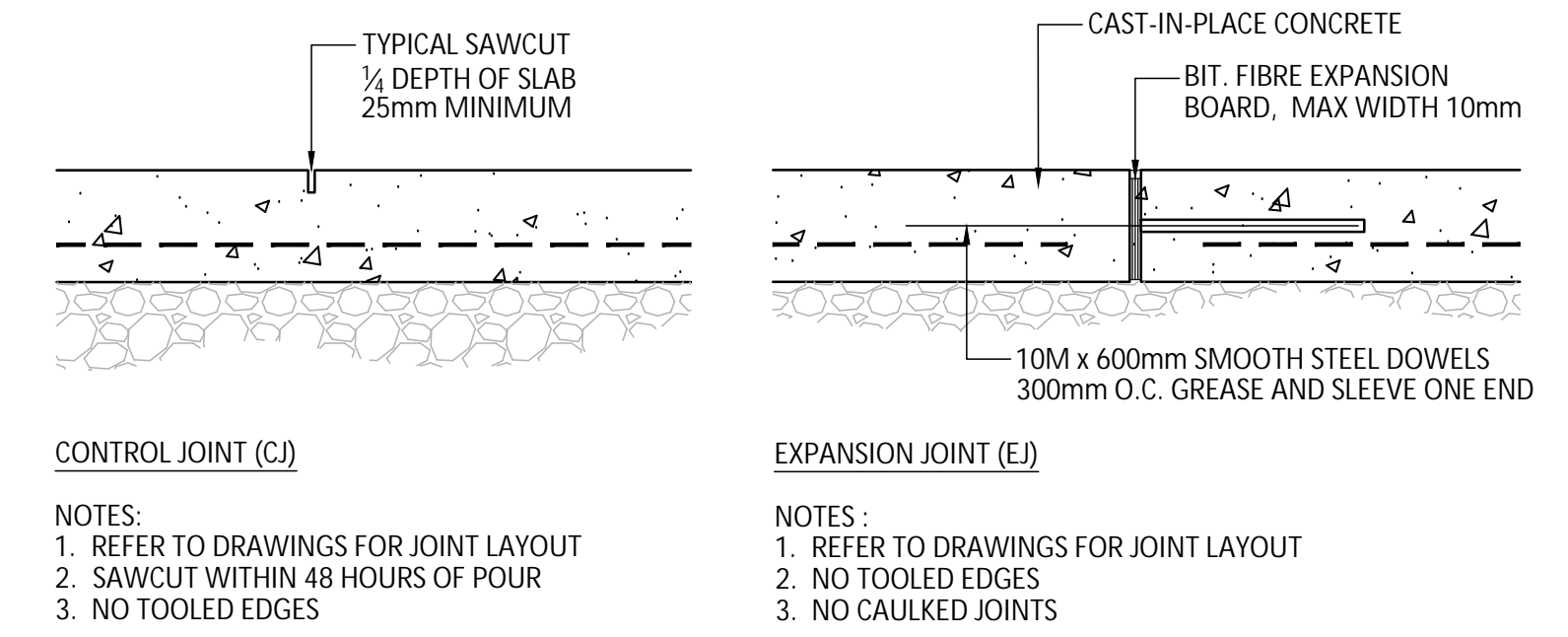

2 PEDESTRIAN CONCRETE JOINTING  
1:10

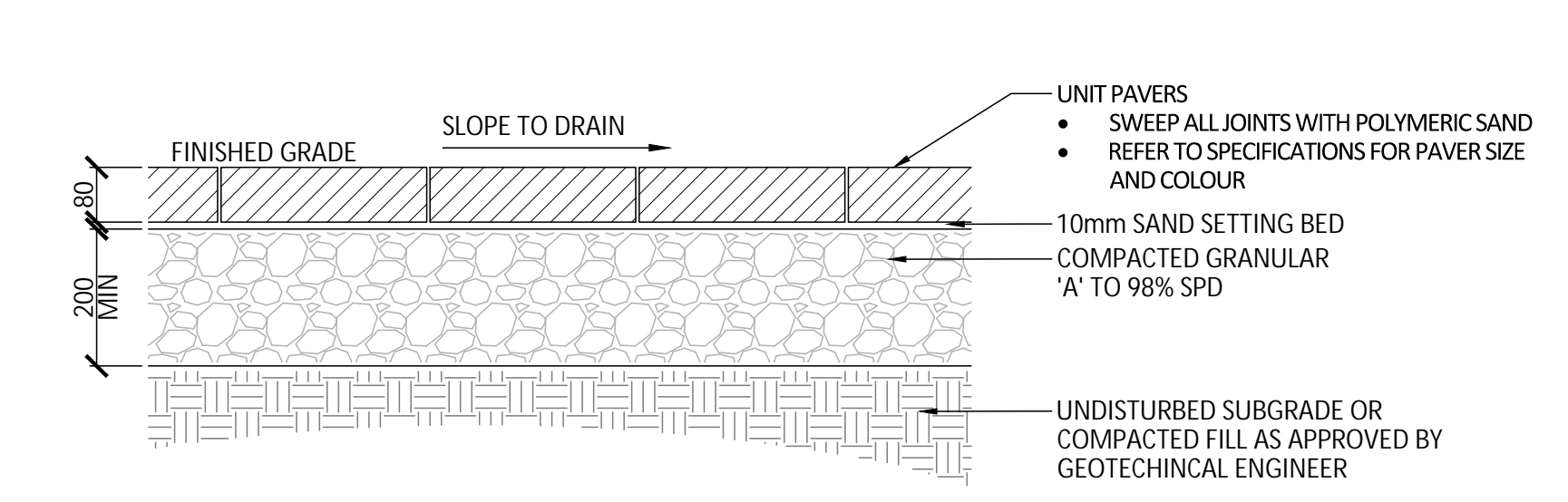

3 UNIT PAVING  
1:10

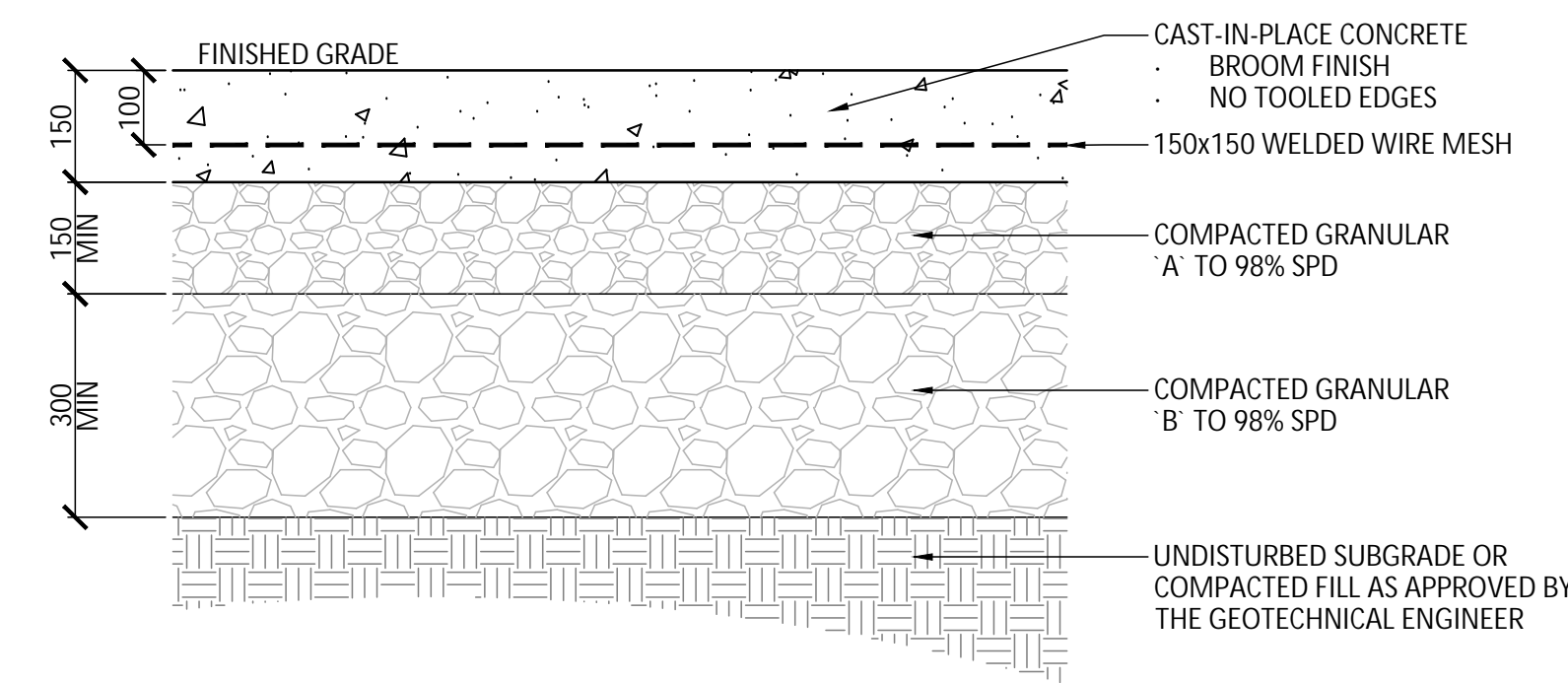

4 HEAVY DUTY CONCRETE PAVING  
1:10

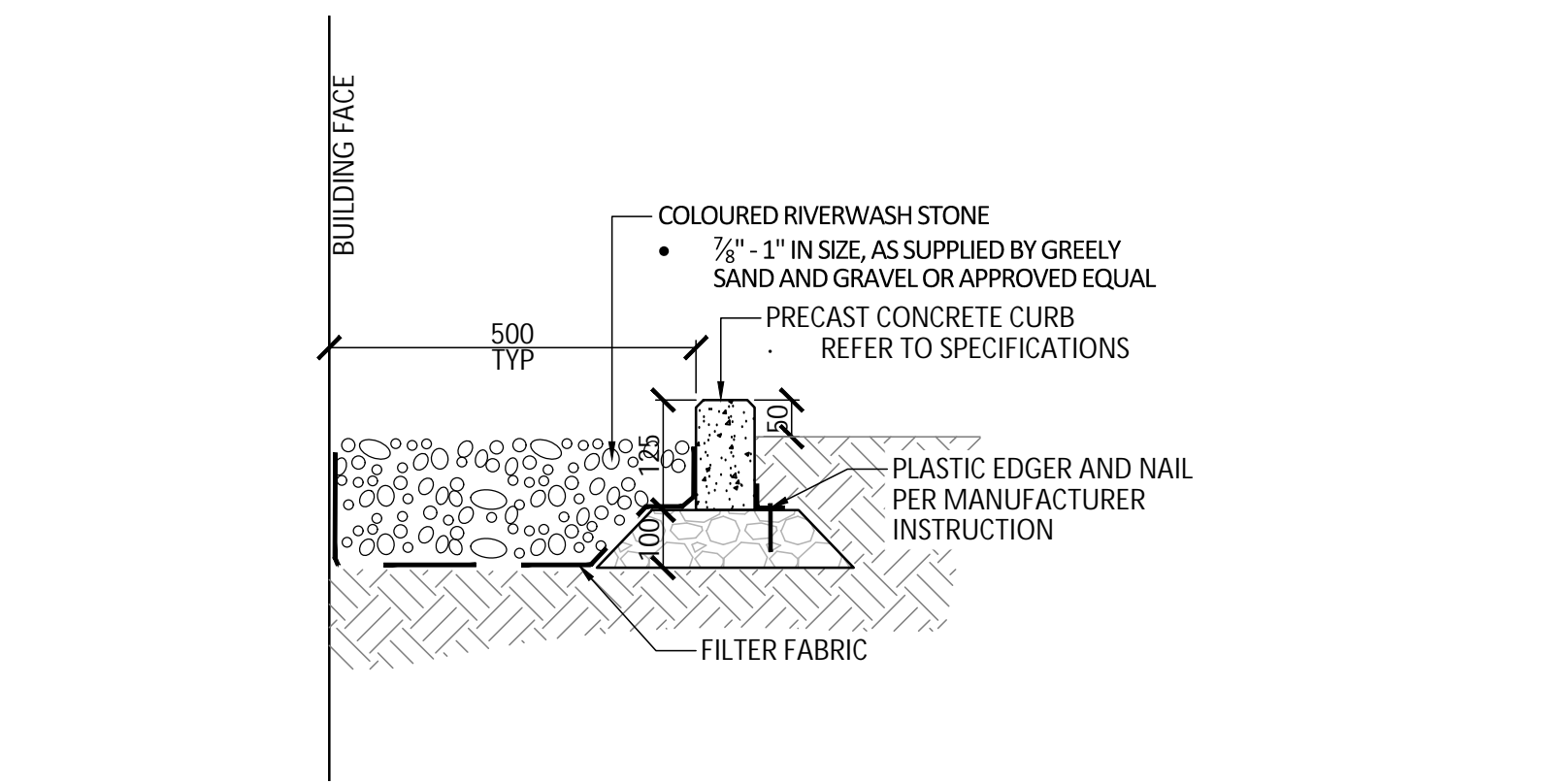

5 MAINTENANCE EDGE  
1:10

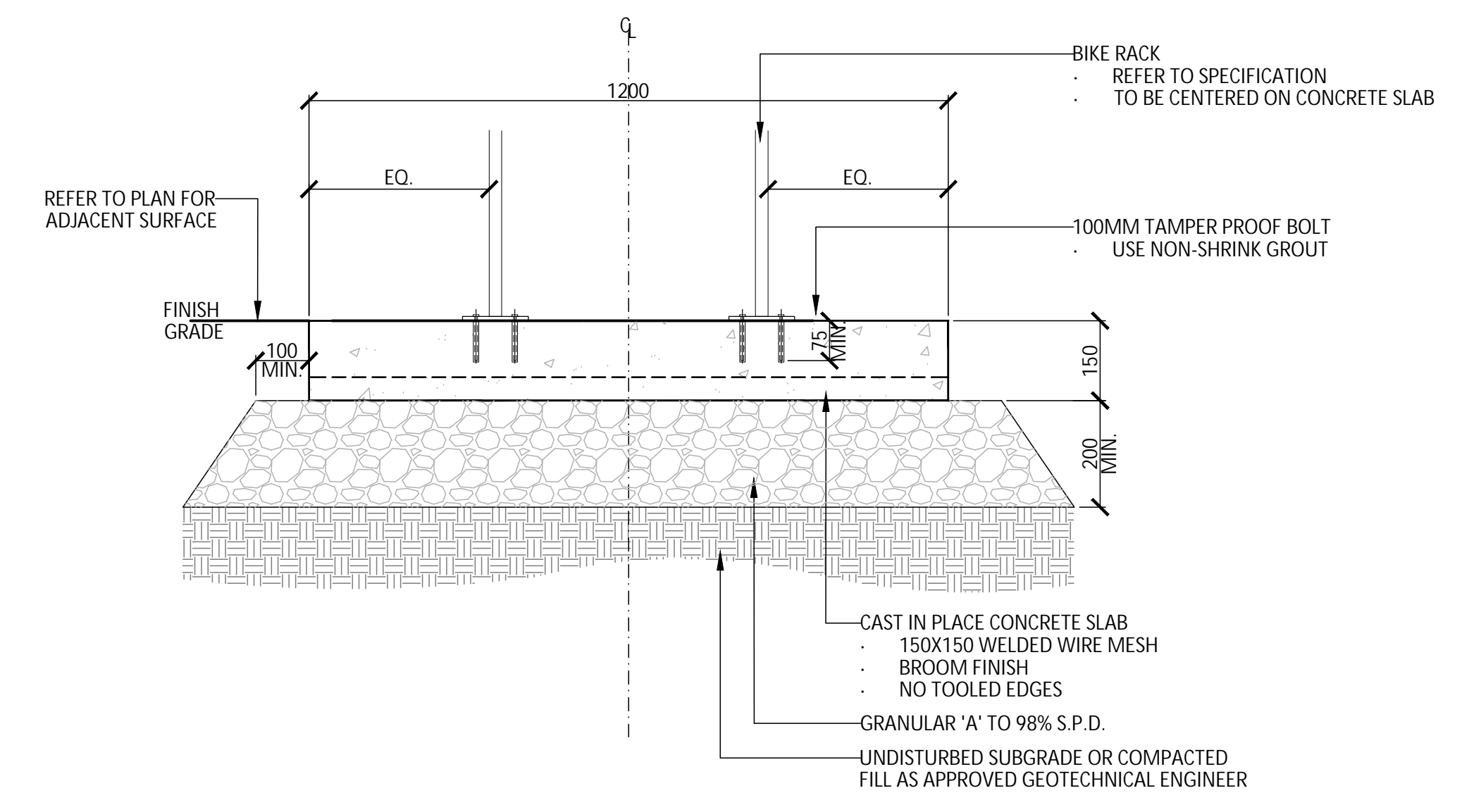

6 BICYCLE PARKING  
1:10

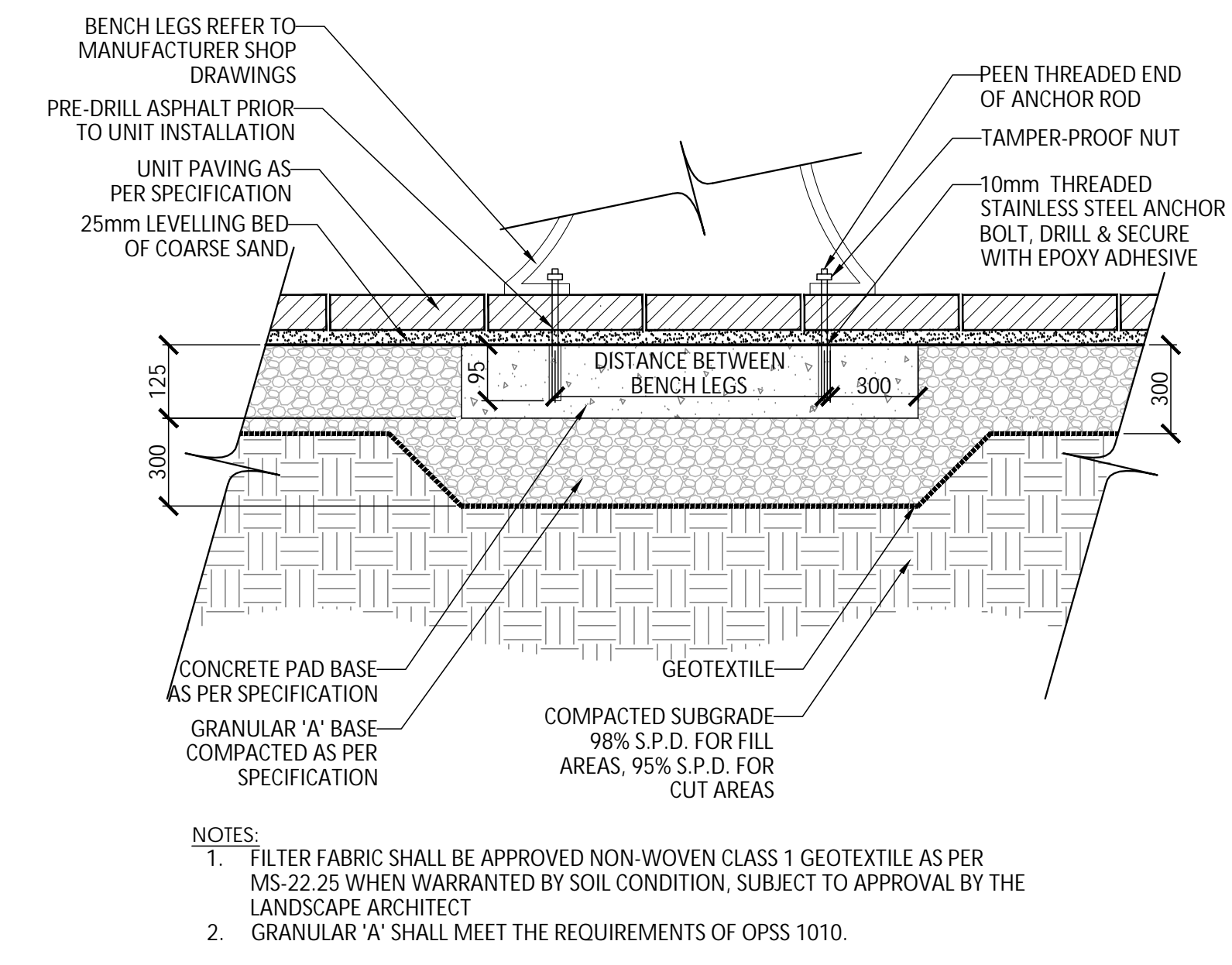

7 BENCH ON UNIT PAVING WITH CONCRETE PAD  
1:20

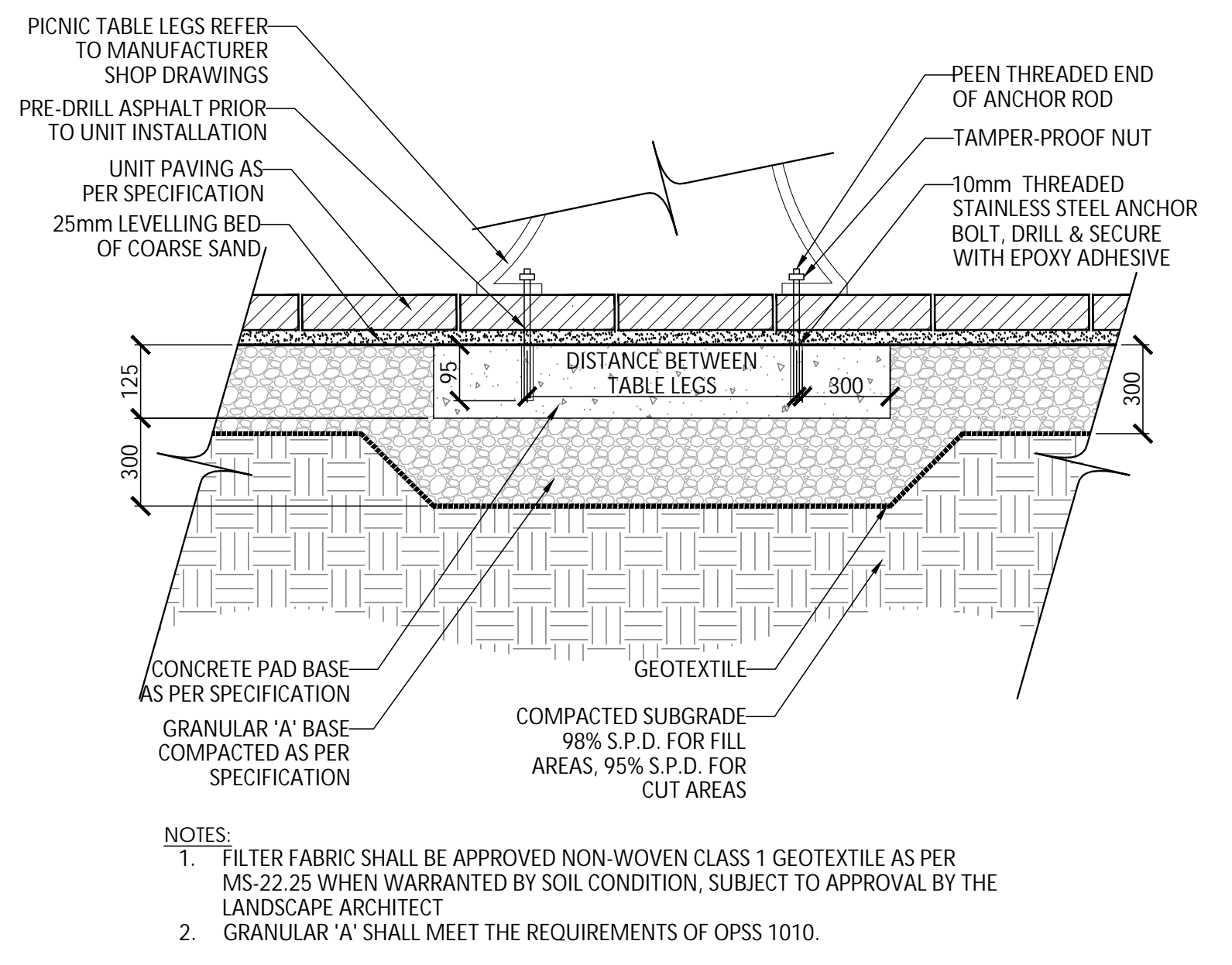

8 PICNIC TABLE ON UNIT PAVING WITH CONCRETE PAD  
1:20

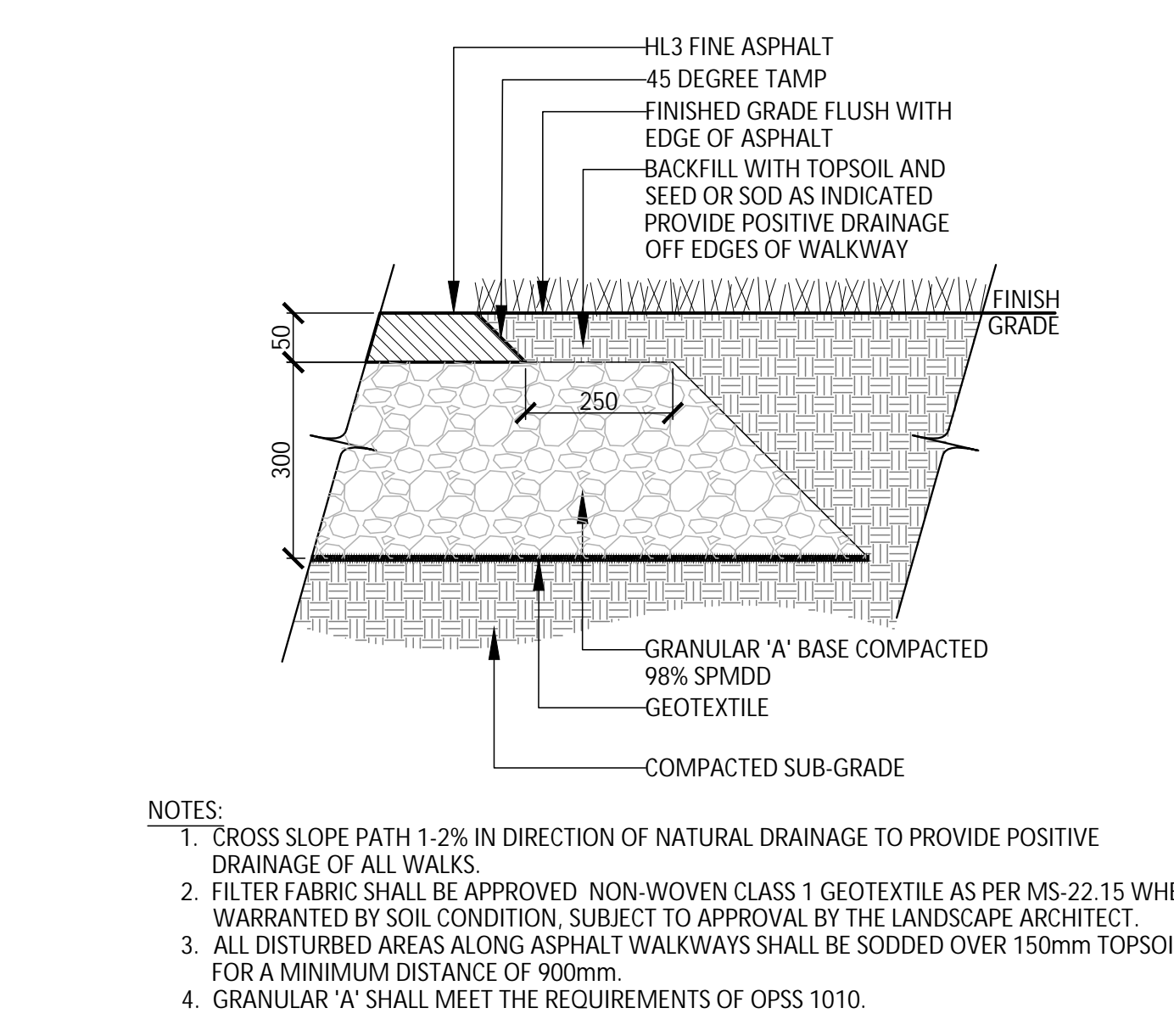

9 LIGHT DUTY ASPHALT PAVING  
1:10

3	Issued for Revised First Submission	Dec. 17/24
2	Issued for Revised First Submission	Nov. 04/24
1	Issued for First Submission	Sept. 03/24
No.	Description	Date

City Approval Stamp

PROPERTY INFORMATION  
PIN 04404-1854 (LT), 04404-1880 (LT), 04404-1882 (LT) and Part of PIN 04404-1855 (LT), being Blocks 147, 173, 175 and Part of Block 148, Registered Plan 4M-1629



**NAK**  
design strategies

1285 WELLINGTON STREET, OTTAWA, ON K1Y 3A8 CANADA  
1.613.297.2345 NAKDESIGNSTRATEGIES.COM

ORLEANS VILLAGE PHASE 4

Title  
LANDSCAPE DETAILS

Date 2024-08-12  
Scale AS NOTED  
Drawn SW  
Checked SC  
Job No. 22-145

L05

PLAN N° -

CITY FILE N° D07-12-24-0103



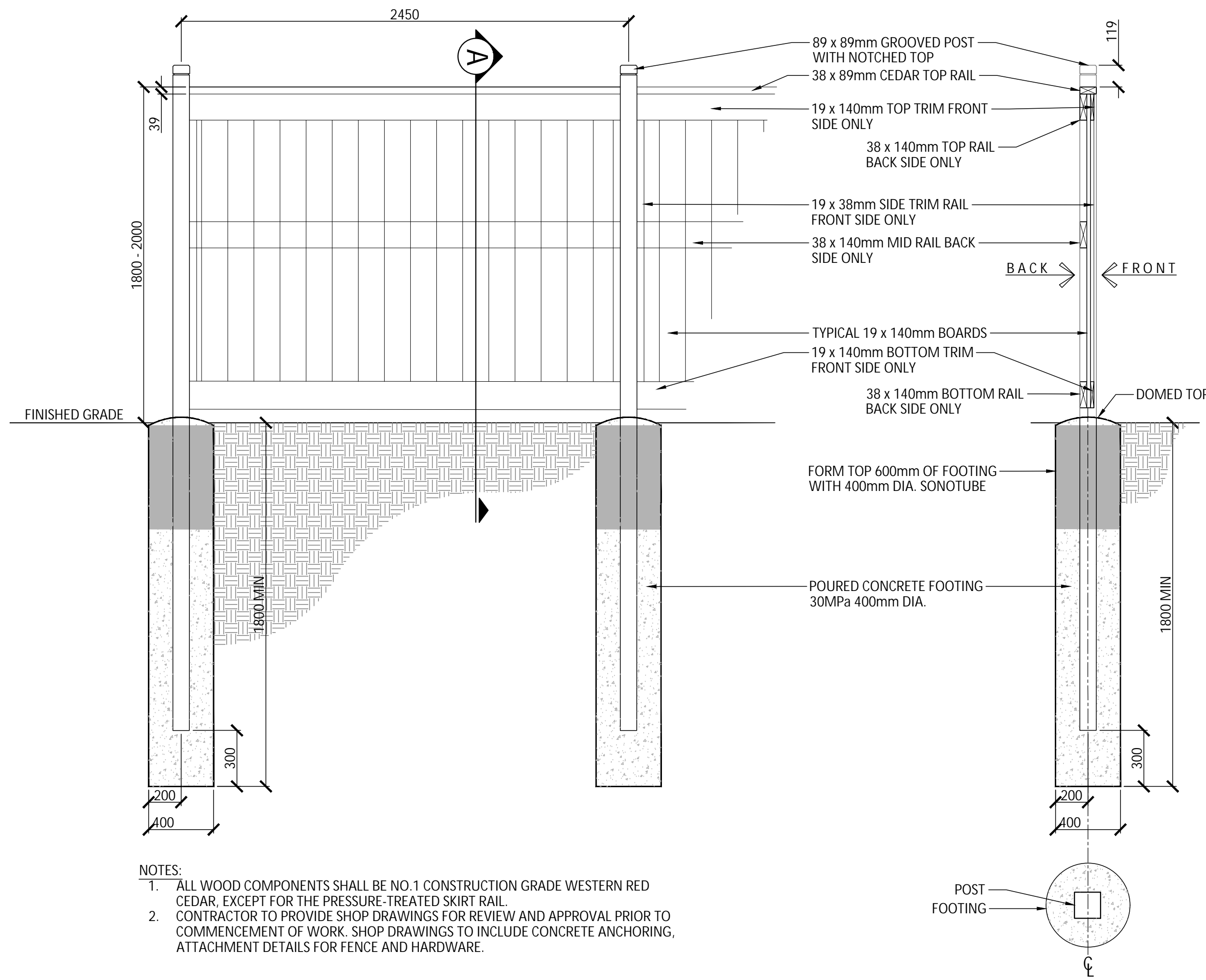

- NOTES:
- ALL WOOD COMPONENTS SHALL BE NO. 1 CONSTRUCTION GRADE WESTERN RED CEDAR, EXCEPT FOR THE PRESSURE-TREATED SKIRT RAIL.
  - CONTRACTOR TO PROVIDE SHOP DRAWINGS FOR REVIEW AND APPROVAL PRIOR TO COMMENCEMENT OF WORK. SHOP DRAWINGS TO INCLUDE CONCRETE ANCHORING, ATTACHMENT DETAILS FOR FENCE AND HARDWARE.

**1** 1.8m - 2.0m HEIGHT WOOD PRIVACY FENCE  
1:20

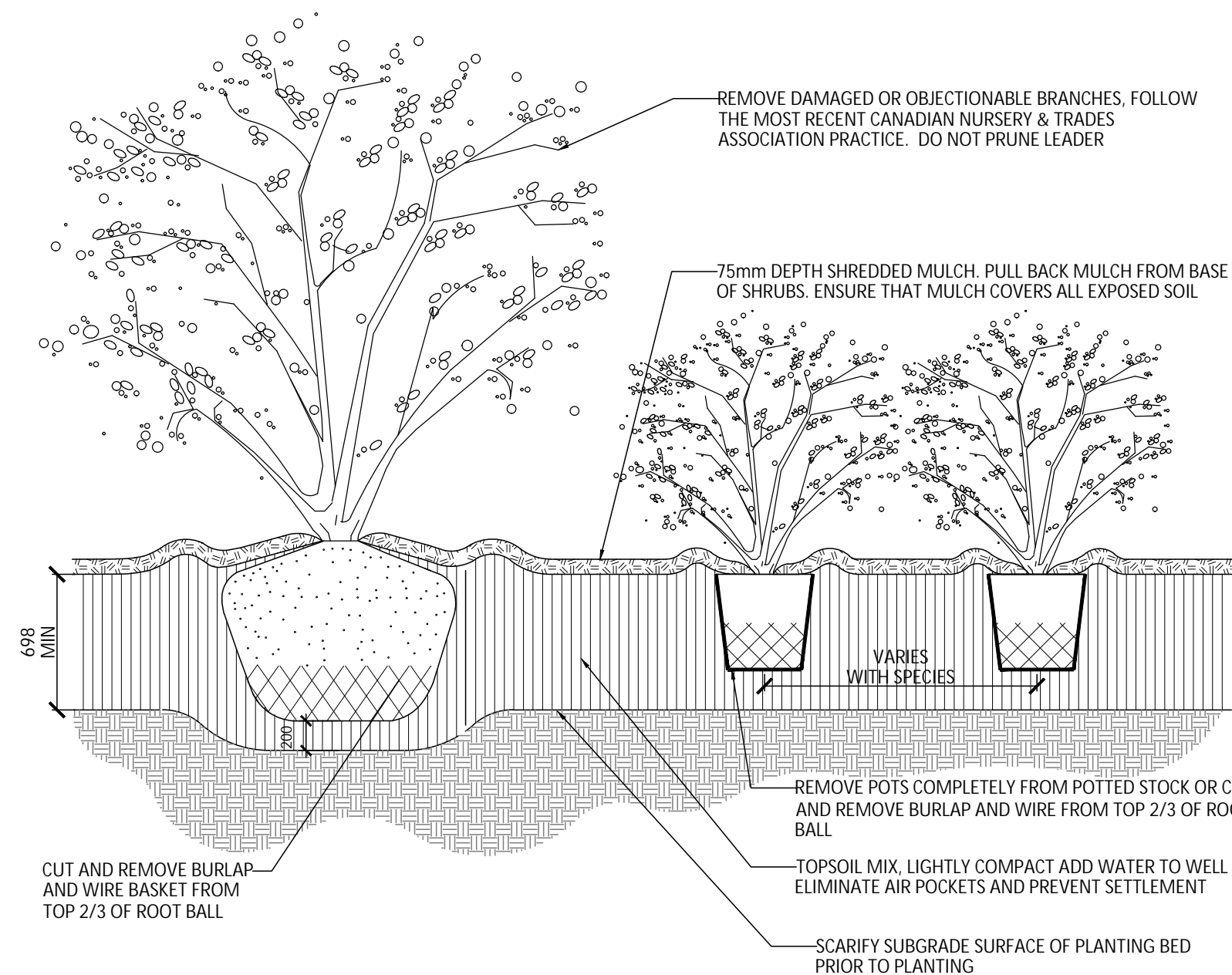

- NOTES:
- TOPSOIL MIXTURE AND SHREDDED MULCH AS PER SPECIFICATION.
  - SHRUBS SPECIFIED BARE ROOT (B.R.) TO BE PLANTED SO THAT ROOTS ARE FULLY EXTENDED IN PLANTING HOLE WITH SOIL MIX BACKFILLED CAREFULLY TO PREVENT ROOT DAMAGE.
  - PROVIDE 100mm HIGH EARTH SAUCER AROUND SHRUB BED.
  - STAKES TO BE REMOVED AFTER ONE YEAR OR UNTIL TAKEOVER UNLESS OTHERWISE DIRECTED BY LANDSCAPE ARCHITECT.

**2** CONTINUOUS SHRUB BED PLANTING (OTT STD-L17, REV 2014)  
1:30

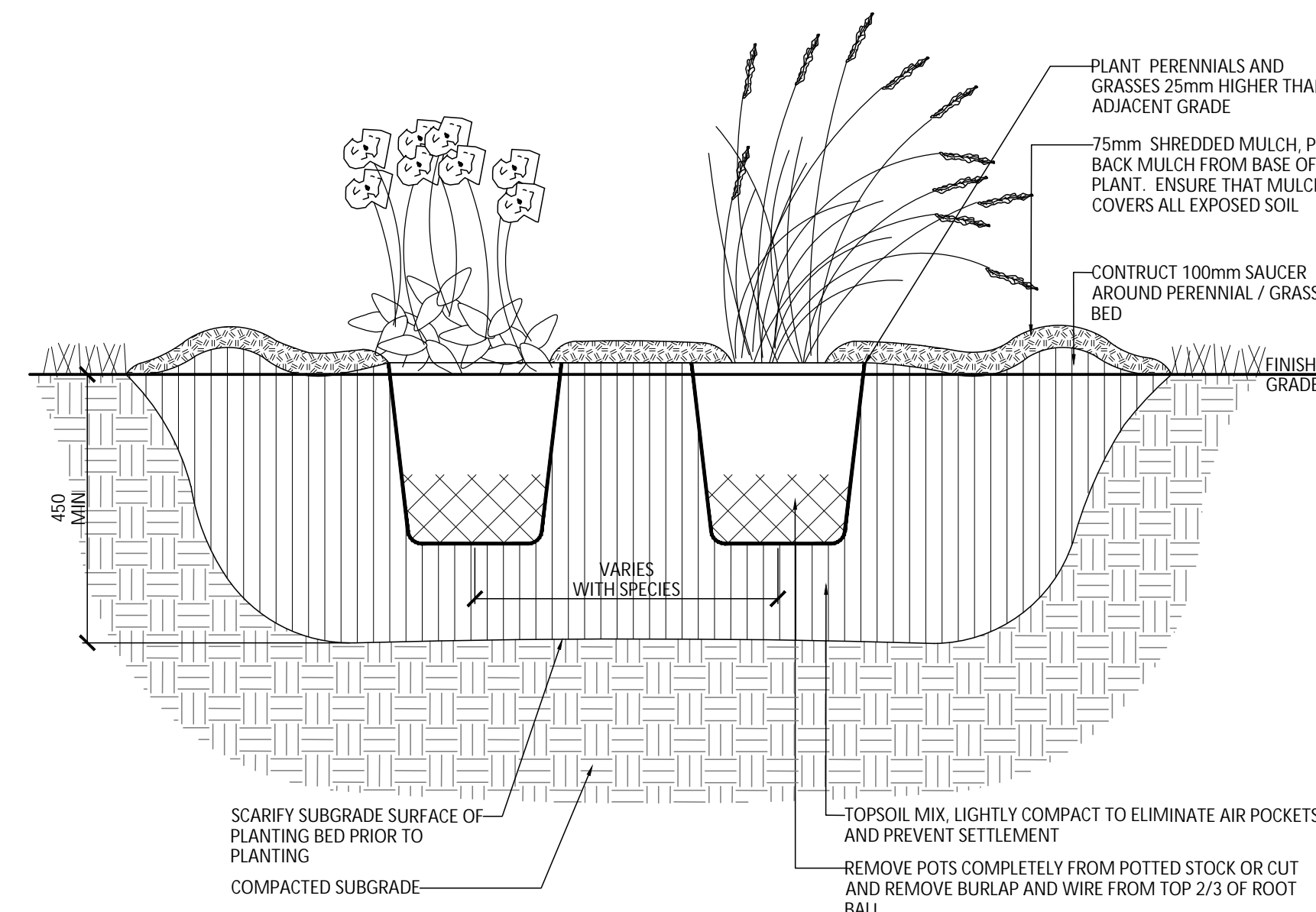

- NOTES:
- TOPSOIL MIXTURE AND SHREDDED MULCH AS PER SPECIFICATION.
  - PROVIDE 100mm HIGH EARTH SAUCER AROUND PERENNIAL/GRASS BED.

**3** PERENNIAL AND ORNAMENTAL GRASS PLANTING  
1:30

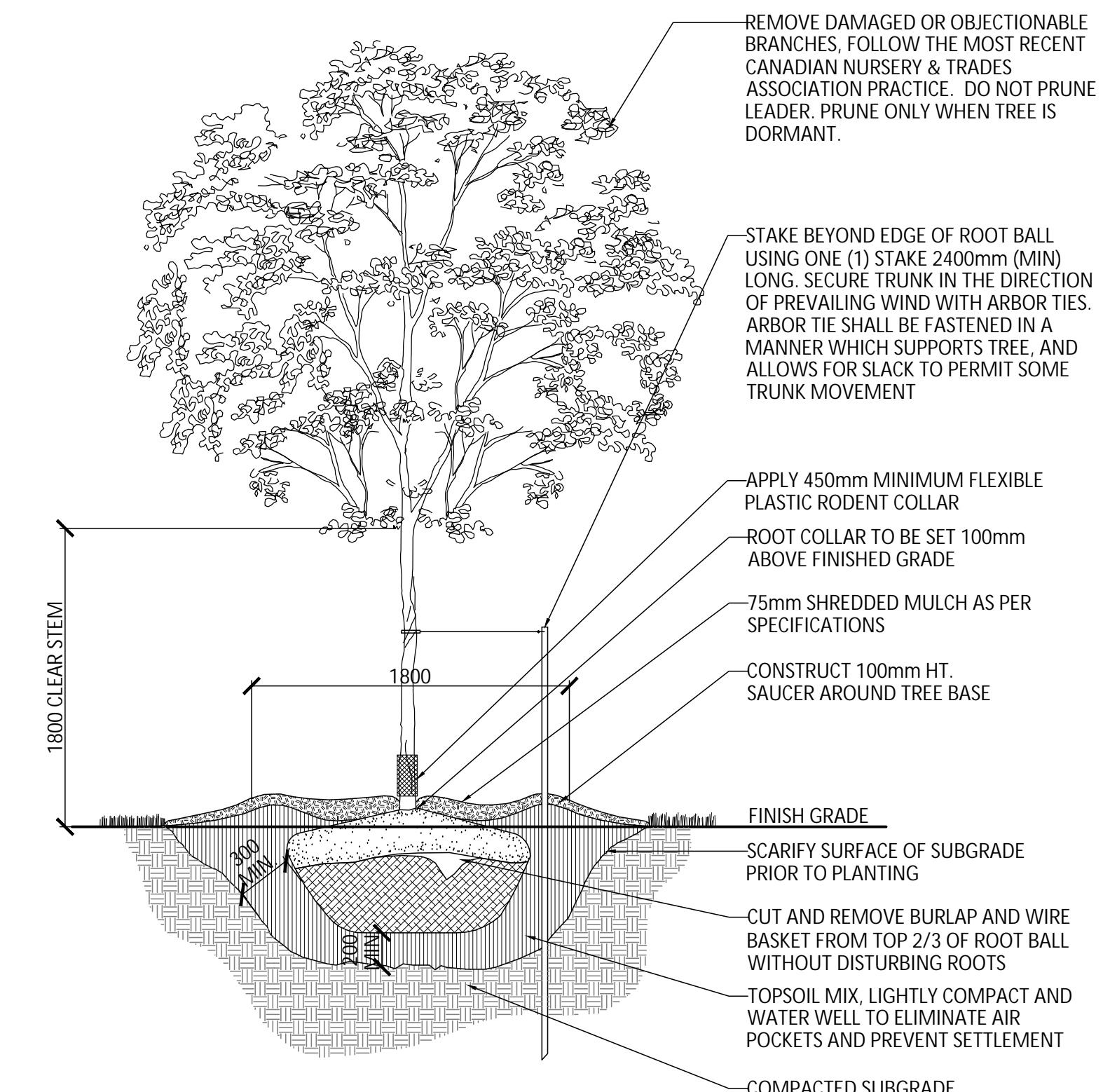

- NOTES:
- REMOVE STAKE AFTER ONE YEAR OR UNTIL TAKEOVER, UNLESS OTHERWISE DIRECTED BY THE LANDSCAPE ARCHITECT.
  - TOPSOIL MIXTURE AND SHREDDED MULCH AS PER SPECIFICATION
  - REMOVE TREE WRAP AFTER PLANTING
  - CALIPER TO BE MEASURED AT THE BASE OF TREE AT ROOT BALL.

**4** DECIDUOUS TREE PLANTING (ONE STAKE W/ARBOR TIES)  
1:30

**PLANTING NOTES:**

- CONTRACTOR TO VERIFY LOCATION OF ALL SERVICES PRIOR TO ANY EXCAVATION.
- LOCATIONS OF ALL PLANT MATERIALS TO BE STAKED BY THE CONTRACTOR AND VERIFIED IN THE FIELD BY LANDSCAPE ARCHITECT PRIOR TO THE EXCAVATION OF PITS.
- ALL PLANT MATERIAL SHALL BE NURSERY GROWN STOCK UNLESS OTHERWISE NOTED.
- DECIDUOUS TREES TO HAVE A MINIMUM 1800 CLEAR STEM ABOVE GRADE.
- ALL PLANT MATERIAL SHALL BE WARRANTIED FOR TWO YEARS FROM THE DATE OF PERFORMANCE ACCEPTANCE AS DETERMINED BY THE LANDSCAPE ARCHITECT.
- ALL STEEL T-BARS TO BE REMOVED AT THE ONE YEAR INTERIM INSPECTION UNLESS OTHERWISE DIRECTED BY THE LANDSCAPE ARCHITECT.
- CONTRACTOR TO MAKE GOOD ALL EXISTING AREAS DAMAGED BY HIS WORK TO THE SATISFACTION OF THE LANDSCAPE ARCHITECT.
- PERIODIC REVIEWS OF PLANTING SHALL BE CARRIED OUT BY THE LANDSCAPE ARCHITECT.
- ANY PROPOSED SUBSTITUTIONS OF PLANT SPECIES SHALL BE MADE WITH PLANTS OF EQUIVALENT OVERALL FORM, HEIGHT, BRANCHING HABIT, FLOWER, LEAF, COLOR, FRUIT AND CULTURE AND ONLY AFTER APPROVAL OF THE LANDSCAPE ARCHITECT.

**SHRUB NOTES:**

- PLACE THE SHRUB AS UPRIGHT AS POSSIBLE, INCLUDING ON SLOPES.
- PLANT SHRUBS AT THE PROPER DEPTH AS INDICATED ON THE DRAWINGS.
- PACK THE SOIL WELL AROUND THE PLANT BASE TO REMOVE AIR POCKETS, BUT DO NOT COMPACT SOIL. PRESS SOIL GENTLY BUT FIRMLY TO PREVENT SHOCKING THE ROOTS.
- PLACE SPECIES ACCORDING TO THE QUANTITIES AND SPACING AS INDICATED ON THE DRAWINGS.
- PLANT SHRUBS AT THE PROPER DEPTH THE ROOT COLLARS SHOULD BE AT GROUND LEVEL.
- MULCH THE SOIL SURFACE AS INDICATED ON DRAWINGS.
- WATER PLANTS THOROUGHLY FOLLOWING PLANTING.
- REFER TO SPECIFICATIONS FOR MAINTENANCE REQUIREMENTS.

**SOD NOTES:**

- SODDED AREAS SHALL HAVE A MINIMUM 150mm TOPSOIL.
- FIRM THE SOIL BY GENTLY TAMPING OR ROLLING THE TOPSOIL. DO NOT COMPACT THE SOIL. EXCESSIVE FORCE WILL DESTROY THE SOIL STRUCTURE AND INHIBIT GERMINATION.
- CUT THE GRASS TO 50mm WHENEVER IT REACHES THE HEIGHT OF 70mm. REMOVE CLIPPINGS THAT WILL SMOTHER GRASS.
- SODDED AREAS WILL BE ACCEPTED BY THE PROJECT MANAGER FOLLOWING PERFORMANCE ACCEPTANCE, PROVIDED:
  - SEEDED AREAS ARE PROPERLY ESTABLISHED.
  - TURF IS FREE OF DEAD SPOTS AND WEEDS.
  - NO SURFACE SOIL IS VISIBLE WHEN GRASS HAS BEEN CUT TO A HEIGHT OF 50mm
  - TURF AREAS HAVE BEEN CUT NO LESS THAN TWICE, THE LAST CUT BEING CARRIED OUT WITHIN 24 HOURS PRIOR TO THE ACCEPTANCE INSPECTION.

Contractor shall check all dimensions on the work and report any discrepancy to the Landscape Architect before proceeding. All drawings and specifications are the property of the Landscape Architect and must be returned at the completion of the work. This drawing is not to be used for construction until signed by the Landscape Architect.

Key Plan

No.	Description	Date
3	Issued for Revised First Submission	Dec. 17/24
2	Issued for Revised First Submission	Nov. 04/24
1	Issued for First Submission	Sept. 03/24

Revision

City Approval Stamp

PROPERTY INFORMATION  
PIN 04404-1854 (LT), 04404-1880 (LT), 04404-1882 (LT) and Part of PIN 04404-1855 (LT), being Blocks 147, 173, 175 and Part of Block 148, Registered Plan 4M-1629

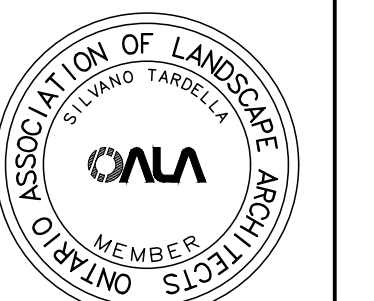

**NAK**  
design strategies

1285 WELLINGTON STREET, OTTAWA, ON K1Y 3A8 CANADA  
1.613.237.2345 NAKDESIGNSTRATEGIES.COM

ORLEANS VILLAGE PHASE 4

Title  
LANDSCAPE DETAILS

Date 2024-08-12  
Scale AS NOTED  
Drawn SW  
Checked SC  
Job No. 22-145

L06

PLAN N°

CITY FILE N° DO7-12-24-0103