

PRE-DEVELOPMENT  
(2002)

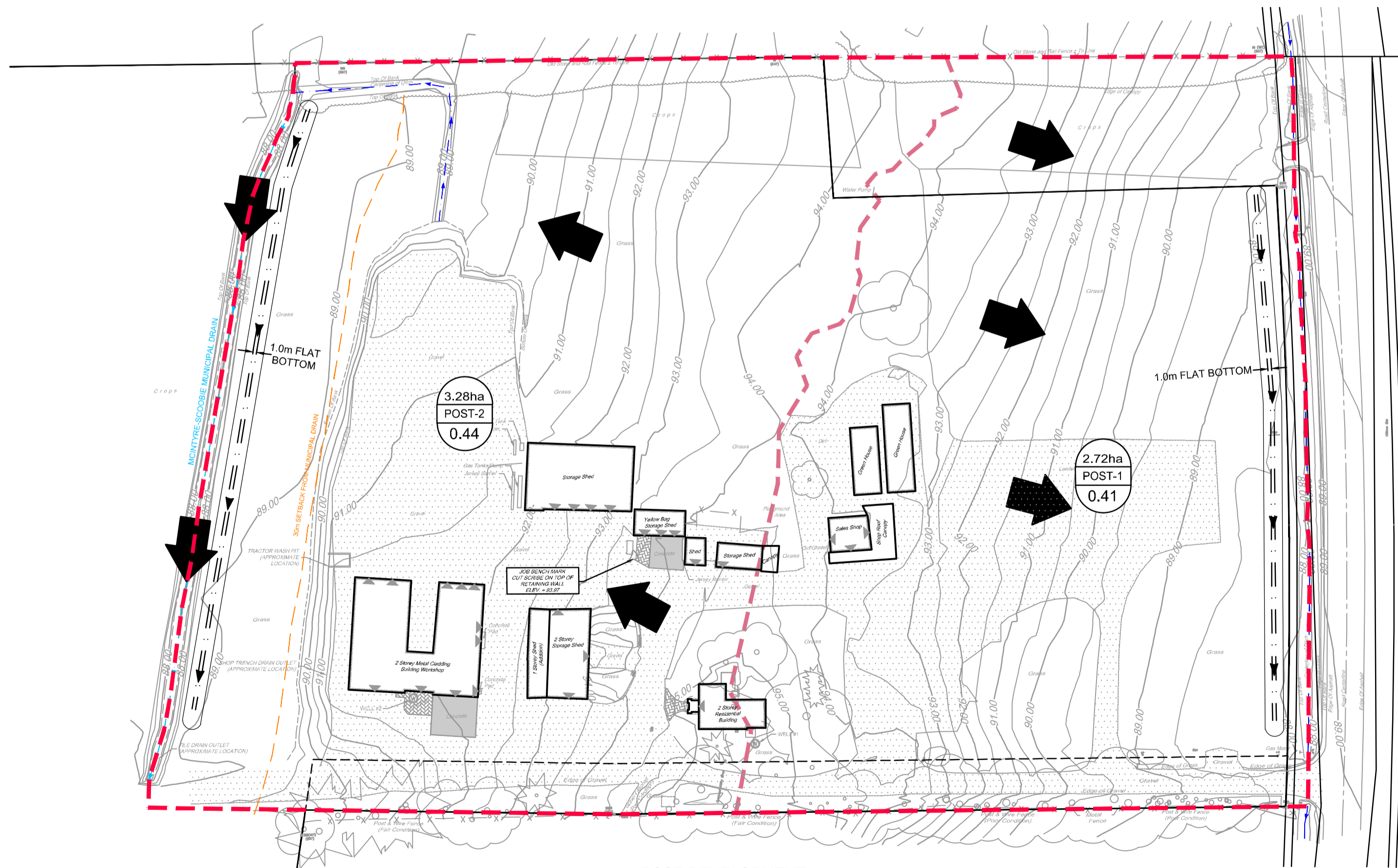

POST-DEVELOPMENT  
(2023)

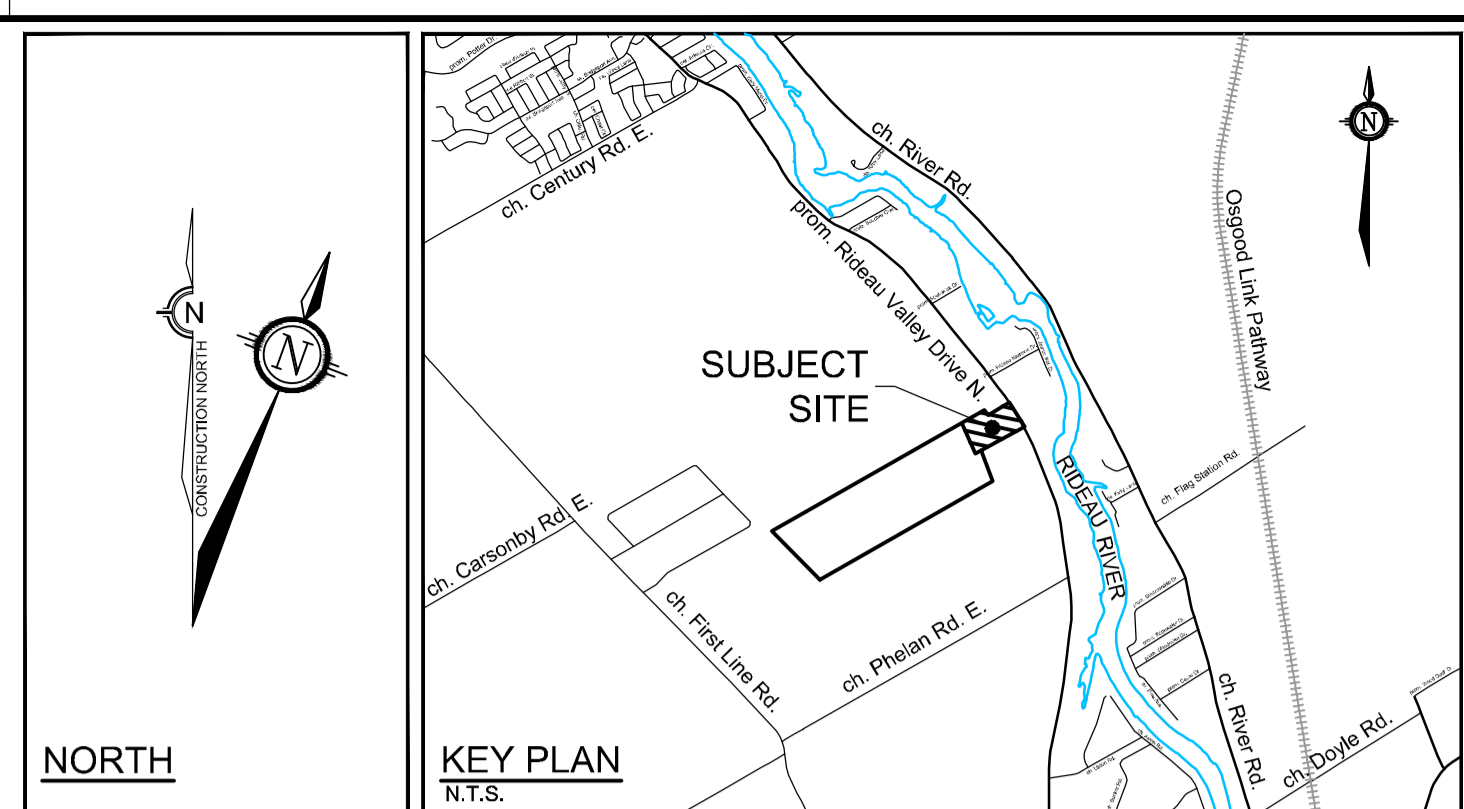

- LEGEND**
- 2.72ha  
PRE-1  
0.24 DRAINAGE AREA (ha)
  - AREA ID
  - RUNOFF COEFFICIENT
  - DRAINAGE AREA
  - PRE-DEVELOPMENT DRAINAGE AREA
  - POST-DEVELOPMENT DRAINAGE AREA
  - DIRECTION OF OVERLAND FLOW
  - DIRECTION OF PROPOSED OVERLAND FLOW
  - EXISTING DITCHES / SWALES AND DIRECTION OF FLOW
  - EXISTING MCINTYRE-SCOOBIE MUNICIPAL DRAIN AND DIRECTION OF FLOW
  - 30m SETBACK FROM MCINTYRE-SCOOBIE MUNICIPAL DRAIN

TOTAL DRAINAGE AREA = 6.00ha  
TOTAL SITE AREA = 5.45ha

**SOURCE REFERENCE:**  
LEGAL INFORMATION:  
*Topographic Survey of Part of Lot 13 Concession Broken Front AKA Concession 'A' Broken Front - Geographic Township of North Gower - City of Ottawa / Fairhall, Moffatt & Woodland Ltd / January 11, 2023 / MTM Zone 9, NAD83 Original*

**TOPOGRAPHIC INFORMATION:**

- *Topographic Survey of Part of Lot 13 Concession Broken Front AKA Concession 'A' Broken Front - Geographic Township of North Gower - City of Ottawa / Fairhall, Moffatt & Woodland Ltd / January 11, 2023 / MTM Zone 9, NAD83 Original*
- *GeoOttawa / 2023*

**EXISTING DRAINAGE:**  
*GeoOttawa / 2023*

**NOTE:**  
THE POSITION OF ALL POLE LINES, CONDUITS, WATERMANS, SEWERS AND OTHER UNDERGROUND AND OVERGROUND UTILITIES AND STRUCTURES IS NOT NECESSARILY SHOWN ON THE CONTRACT DRAWINGS, AND WHERE SHOWN, THE ACCURACY OF THE POSITION OF SUCH UTILITIES AND STRUCTURES IS NOT GUARANTEED. BEFORE STARTING WORK, DETERMINE THE EXACT LOCATION OF ALL SUCH UTILITIES AND STRUCTURES AND ASSUME ALL LIABILITY FOR DAMAGE TO THEM.

No.	REVISION	DATE	BY
1.	ISSUED WITH CONCEPTUAL SERVICING AND STORMWATER MANAGEMENT REPORT	JULY 12/24	RJK

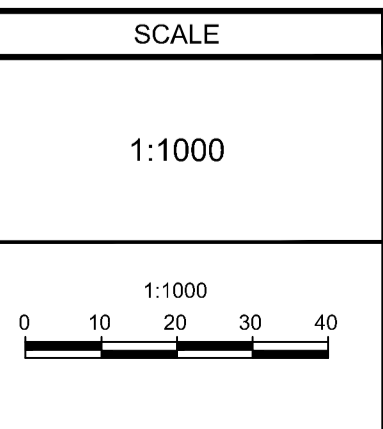

DESIGN	FOR REVIEW ONLY
RJK	
CHECKED	
LAB	
DRAWN	
RJK	
CHECKED	
LAB	
APPROVED	
SMG	

**NOVATECH**  
Engineers, Planners & Landscape Architects  
Suite 200, 240 Michael Cowpland Drive  
Ottawa, Ontario, Canada K2M 1P6

Telephone (613) 254-9643  
Facsimile (613) 254-5867  
Website www.novatech-eng.com

LOCATION CITY OF OTTAWA 6158 RIDEAU VALLEY DRIVE	PROJECT No. 121265
DRAWING NAME PRE & POST DEVELOPMENT STORM DRAINAGE AREA PLAN	REV REV # 1
	DRAWING No. 121265-SDA

M:\2021\121265\CAD\Design\121265-SDA.dwg, SDA, Jul 12, 2024, 12:10pm, rkaragus