

TYPICAL SWALE CROSS SECTION A-A
SCALE 1:100

TYPICAL SWALE CROSS SECTION B-B
SCALE 1:100

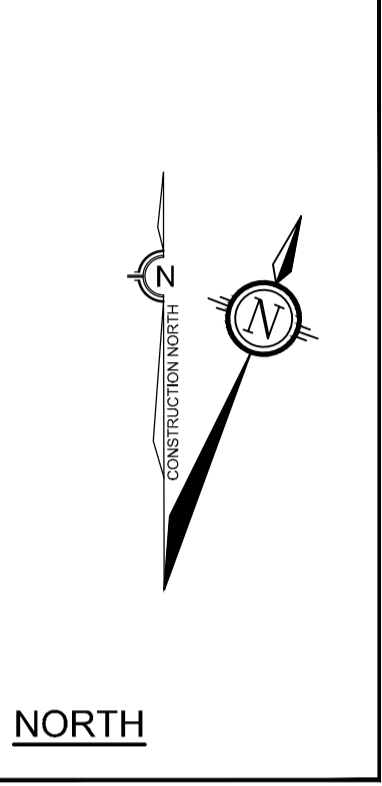

- LEGEND**
- PROPOSED ELEVATION
 - EXISTING ELEVATION
 - PROPOSED SWALE ELEVATION
 - EXISTING ELEVATION
 - PROPOSED SWALES AND DIRECTION OF FLOW
 - EXISTING DITCHES / SWALES AND DIRECTION OF FLOW
 - EXISTING MCINTYRE-SCOOBIE MUNICIPAL DRAIN AND DIRECTION OF FLOW
 - 30m SETBACK FROM MCINTYRE-SCOOBIE MUNICIPAL DRAIN
 - PROPOSED OUTLET CONTROL STRUCTURE (TBC)
 - DIRECTION OF OVERLAND FLOW
 - PROPOSED RIP-RAP (OPSD 810.10)
 - PROPOSED STRAWBALE CHECK DAMS (OPSD 219.180)
 - EXISTING WELL

NOTE:
THE POSITION OF ALL POLE LINES, CONDUITS, WATERMANS, SEWERS AND OTHER UNDERGROUND AND OVERGROUND UTILITIES AND STRUCTURES IS NOT NECESSARILY SHOWN ON THE CONTRACT DRAWINGS, AND WHERE SHOWN, THE ACCURACY OF THE POSITION OF SUCH UTILITIES AND STRUCTURES IS NOT GUARANTEED. BEFORE STARTING WORK, DETERMINE THE EXACT LOCATION OF ALL SUCH UTILITIES AND STRUCTURES AND ASSUME ALL LIABILITY FOR DAMAGE TO THEM.

SOURCE REFERENCE:
LEGAL INFORMATION:
TOPOGRAPHIC SURVEY OF PART OF LOT 13 CONCESSION BROKEN FRONT AKA CONCESSION 'A' BROKEN FRONT - GEOGRAPHIC TOWNSHIP OF NORTH GOWER - CITY OF OTTAWA / FAIRHALL, MOFFATT & WOODLAND LTD / JANUARY 11, 2023 / MTM ZONE 9, NAD83 ORIGINAL

TOPOGRAPHIC INFORMATION:
TOPOGRAPHIC SURVEY OF PART OF LOT 13 CONCESSION BROKEN FRONT AKA CONCESSION 'A' BROKEN FRONT - GEOGRAPHIC TOWNSHIP OF NORTH GOWER - CITY OF OTTAWA / FAIRHALL, MOFFATT & WOODLAND LTD / JANUARY 11, 2023 / MTM ZONE 9, NAD83 ORIGINAL

EXISTING DRAINAGE:
GEOOTTAWA / 2023

No.	REVISION	DATE	BY
1.	ISSUED WITH CONCEPTUAL SERVING AND STORMWATER MANAGEMENT REPORT	JULY 12/24	RJK

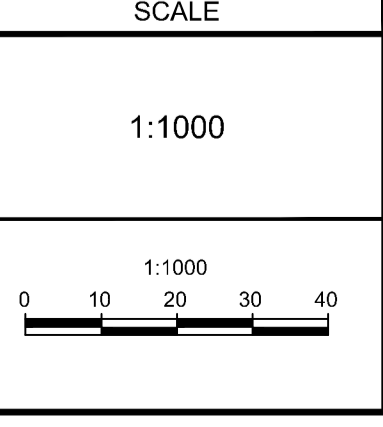

DESIGN	RJK
CHECKED	LAB
DRAWN	RJK
CHECKED	LAB
APPROVED	SMG

FOR REVIEW ONLY

NOVATECH
Engineers, Planners & Landscape Architects
Suite 200, 240 Michael Cowpland Drive
Ottawa, Ontario, Canada K2M 1P6

Telephone: (613) 254-9643
Facsimile: (613) 254-5867
Website: www.novatech-eng.com

LOCATION CITY OF OTTAWA 6158 RIDEAU VALLEY DRIVE	
DRAWING NAME GRADING AND EROSION AND SEDIMENT CONTROL PLAN	
PROJECT No.	121265
REV	REV # 1
DRAWING No.	121265-GR

M:\2021\121265\CAD\design\121265-GR.dwg, GR, Jul 12, 2024, 2:11pm, kdragun