

SAN STRUCTURE TABLE				
NAME	RIM ELEV.	INVERT IN	INVERT OUT	DESCRIPTION
MH1A	96.40	S90.317	NW90.280	STRUC: OPSD 701.010 FRAME: CITY S25 COVER: CITY S24

STM STRUCTURE TABLE				
NAME	RIM ELEV.	INVERT IN	INVERT OUT	DESCRIPTION
CB1	92.80	SW90.580	N90.549	STRUC: OPSD 705.010 FRAME: CITY S19 COVER: CITY S19 C/W CB SHIELD
CB6	95.85		S94.854	STRUC: OPSD 705.010 FRAME: CITY S19 COVER: CITY S19
CB7	91.84		NW90.093	STRUC: OPSD 705.010 FRAME: CITY S19 COVER: CITY S19
CB8	93.98		NW90.636	STRUC: OPSD 705.010 FRAME: CITY S19 COVER: CITY S19
CB12	91.89		E90.574	STRUC: OPSD 705.010 FRAME: CITY S19 COVER: CITY S19
CBMH2	91.83	S90.330	N90.300	STRUC: OPSD 701.010 FRAME: CITY S25 COVER: CITY S24.1
CBMH4	96.29	S94.090	NE90.810	STRUC: OPSD 701.010 FRAME: CITY S25 COVER: CITY S24.1 C/W EXTERNAL DROP STRUCTURE PER OPSD 1003.010
LSCB9	95.11		E94.228	PER CITY STANDARD S31
LSCB10	95.06		E94.545	PER CITY STANDARD S31
LSCB11	95.68		E94.907	PER CITY STANDARD S31
MH3	92.43	SE90.512 SW90.491	NE90.380	STRUC: OPSD 701.010 FRAME: CITY S25 COVER: CITY S24.1
MH5	91.45	SW90.109	NE90.082	STRUC: OPSD 701.010 FRAME: CITY S25 COVER: CITY S24.1

CROSSING CONFLICT TABLE		
LOCATION	DESCRIPTION	SEPARATION
1	150mm WTR SERVICE TOP 92.24 250mm STM SEWER INV 95.68	2.37
2	150mm WTR SERVICE TOP 93.31 250mm STM SEWER INV 95.56	2.25
3	200mm STM SERVICE INV 90.68 150mm SAN SERVICE TOP 90.36	0.32

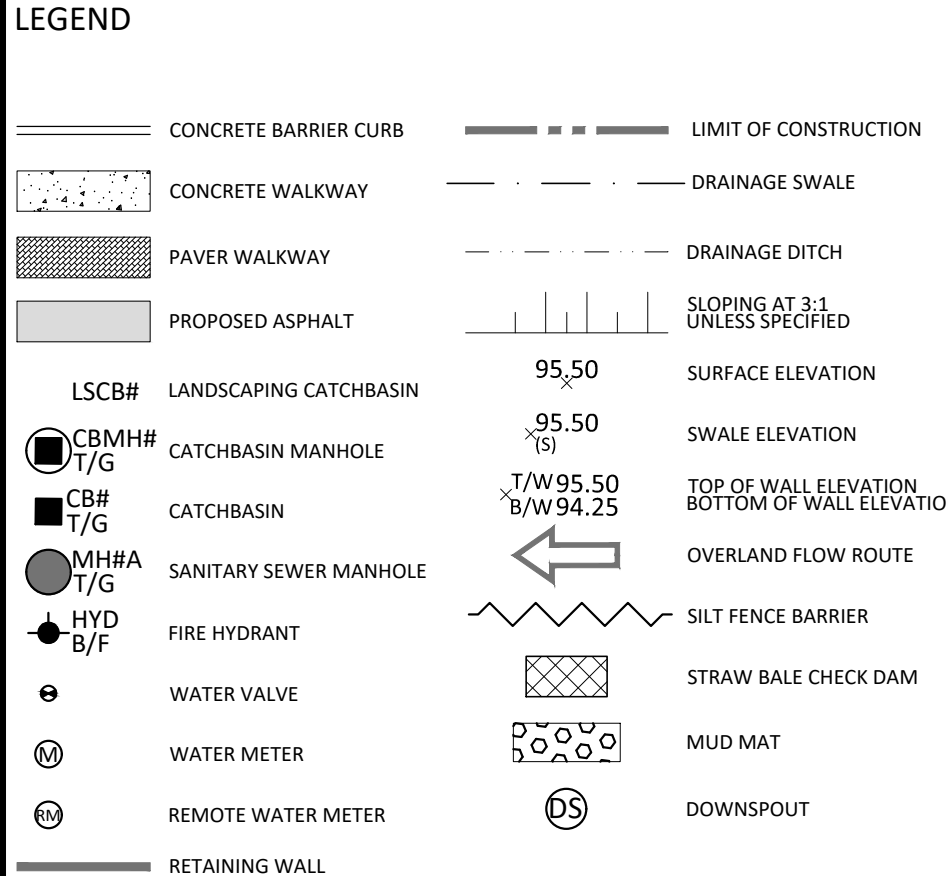
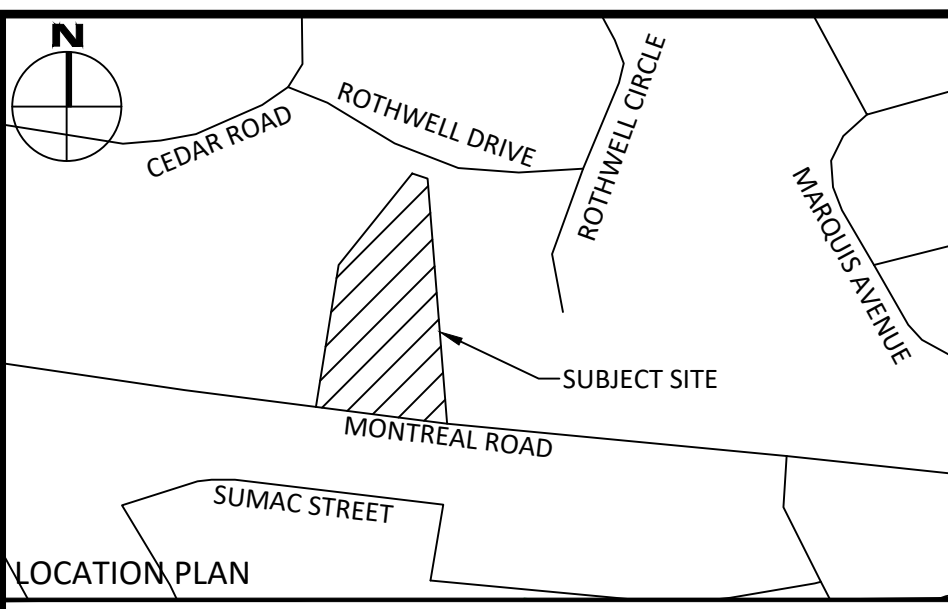

No.	Revisions	Date
3	ISSUED FOR SITE PLAN CONTROL	JAN. 05, 2024
2	ISSUED FOR SITE PLAN CONTROL	OCT. 05, 2023
1	ISSUED FOR SITE PLAN CONTROL	MAY 30, 2023

Check and verify all dimensions before proceeding with the work. Do not scale drawings.

SCALE 1:200

McINTOSH PERRY  
115 Walgreen Road, RR3, Carp, ON K0A 1L0  
Tel: 613-836-2184 Fax: 613-836-3742  
www.mcintoshperry.com

Client: **CSV ARCHITECTS**  
190 O'CONNOR STREET, SUITE 100  
OTTAWA, ON K2P 2R3

Project: **9-STOREY APARTMENT BUILDING**  
1815 MONTREAL ROAD

Drawing Title: **SITE SERVICING PLAN**

Scale: 1:200 Project Number: CCO-23-3469

Drawn By: FV Checked By: JH Designed By: FV Drawing Number: C102

**GENERAL NOTES**

- THE ORIGINAL TOPOGRAPHY, GROUND ELEVATION AND SURVEY DATA SHOWN ARE SUPPLIED FOR INFORMATION PURPOSES ONLY, AND IMPLY NO GUARANTEE OF ACCURACY. IT SHALL BE THE RESPONSIBILITY OF THE CONTRACTOR TO VERIFY ALL INFORMATION SHOWN.
- THIS PLAN IS NOT A CADASTRAL SURVEY SHOWING LEGAL PROPERTY BOUNDARIES AND EASEMENTS. THE PROPERTY BOUNDARIES SHOWN HEREON HAVE BEEN DERIVED FROM INFORMATION SUPPLIED BY (OR SHOWN ON) J.D. BARNES DRAWING 22-10-111-00 AND CANNOT BE RELIED UPON TO BE ACCURATE OR COMPLETE. THE PRECISE LOCATION OF THE CURRENT PROPERTY BOUNDARIES AND EASEMENTS CAN ONLY BE DETERMINED BY AN UP-TO-DATE LAND TITLES SEARCH AND A SUBSEQUENT CADASTRAL SURVEY PERFORMED AND CERTIFIED BY AN ONTARIO LAND SURVEYOR.
- THE CONTRACTOR IS TO OBTAIN AND PAY FOR ALL NECESSARY PERMITS AND APPROVALS FROM THE CITY BEFORE COMMENCING CONSTRUCTION.
- THE CONTRACTOR IS RESPONSIBLE FOR ALL LAYOUT.
- THE CONTRACTOR IS TO DETERMINE THE EXACT LOCATION, SIZE, MATERIAL AND ELEVATION OF ALL EXISTING UTILITIES PRIOR TO COMMENCING CONSTRUCTION. PROTECT AND ASSUME ALL RESPONSIBILITY FOR EXISTING UTILITIES WHETHER OR NOT SHOWN ON THESE DRAWINGS. IF THERE IS ANY DISCREPANCY THE CONTRACTOR IS TO NOTIFY THE ENGINEER PROMPTLY.
- RESTORE ALL TRENCHES AND SURFACES OF PUBLIC ROAD ALLOWANCES TO CONDITION EQUAL OR BETTER THAN ORIGINAL CONDITION AND TO THE SATISFACTION OF THE CITY AUTHORITIES.
- EXCAVATE AND DISPOSE OF ALL EXCESS EXCAVATED MATERIAL, SUCH AS ASPHALT, CURBING AND DEBRIS, OFF SITE AS DIRECTED BY THE ENGINEER AND THE CITY.
- TOPSOIL TO BE STRIPPED AND STOCKPILED FOR REHABILITATION. CLEAN FILL TO BE PLACED IN FILL AREAS AND COMPACTED TO 95% STANDARD PROCTOR DENSITY.
- ALL DISTURBED AREAS TO BE RESTORED TO ORIGINAL CONDITION OR BETTER UNLESS OTHERWISE SPECIFIED.
- THE CONTRACTOR SHALL BE RESPONSIBLE FOR ALL TRAFFIC CONTROL AND SAFETY MEASURES DURING THE CONSTRUCTION PERIOD, INCLUDING THE SUPPLY,

**WATERMAIN NOTES**

- CONSTRUCT ALL WATERMANS AND APPURTENANCES IN ACCORDANCE WITH OPSD STANDARDS AND SPECIFICATIONS, AS WELL AS CITY STANDARDS.
- WATERMANS AND/OR WATER SERVICES ARE TO HAVE A MINIMUM COVER OF 2.4m. OTHERWISE THERMAL INSULATION IS REQUIRED AS PER CITY STANDARDS (IF AVAILABLE) OR OPSD 1109.030.
- IF THE WATERMAIN MUST BE DEFLECTED TO MEET ALIGNMENT, ENSURE THAT THE AMOUNT OF DEFLECTION USED IS EQUAL TO OR LESS THAN THAT WHICH IS RECOMMENDED BY THE MANUFACTURER.
- THERMAL INSULATION OF WATERMANS AT OPEN STRUCTURES AS PER CITY STANDARDS (IF AVAILABLE) OR OPSD 1109.030.
- VALVES TO BE OPERATED BY CITY STAFF ONLY.
- NO CONNECTION TO EXISTING WATER NETWORK SHALL BE COMPLETED UNTIL A WATER PERMIT IS OBTAINED FROM THE CITY. TO BE PRESENT FOR WATERMAIN CONNECTION, CONNECTION, EXCAVATION, BACKFILLING AND REINSTATEMENT TO BE COMPLETED BY CONTRACTOR.
- IT WILL BE THE RESPONSIBILITY OF THE CONTRACTOR TO PERFORM ANY WATERMAIN CONNECTIONS REQUIRED. THIS SHALL BE COMPLETED IN THE PRESENCE OF A DESIGNATED MUNICIPAL WATER OPERATOR AND THE SELECTED CONTRACTOR SHALL PROVE TO THE SATISFACTION OF THE CITY THAT THEY ARE COMPETENT TO PERFORM THE WORKS PRIOR TO INITIATING CONSTRUCTION.
- CONCRETE THRESH BLOCKS TO CONFORM TO OPSD 1103.010 AND OPSD 1103.020.
- ALL WATERMAIN TO BE CLASS 150 DR-18 OR APPROVED EQUIVALENT.
- ALL WATERMAIN TO BE EQUIPPED WITH TRACER WIRE.
- ALL SERVICES BENEATH PRIVATE ENTRANCES, WALKWAYS, AND STRUCTURES ARE TO BE SLEEVED.

**SEWER NOTES:**

- CONSTRUCT ALL SEWERS, CATCH BASINS, MANHOLES AND APPURTENANCES IN ACCORDANCE WITH OPSD STANDARDS AND SPECIFICATIONS, AS WELL AS CITY STANDARDS.
- SEWER TRENCHING AND BEDDING SHALL CONFORM TO OPSD 802.010 AND 802.013 UNLESS NOTED OTHERWISE.
- BEDDING SHALL BE A MINIMUM 150mm OF GRANULAR "A", COMPACTED TO MINIMUM 95% STANDARD PROCTOR DRY DENSITY. CLEAR STONE BEDDING SHALL NOT BE PERMITTED.
- SUB-BEDDING, IF REQUIRED SHALL CONSIST OF 450mm OF COMPACTED GRANULAR "B" TYPE 1.
- BACKFILL TO AT LEAST 300mm ABOVE TOP OF PIPE WITH GRANULAR "A" OR GRANULAR "B" TYPE 1.
- TO MINIMIZE DIFFERENTIAL FROST HEAVING, TRENCH BACKFILL FROM PAVEMENT SUBGRADE TO 2.0 METRES BELOW FINISHED GRADE) SHALL MATCH EXISTING SOIL CONDITIONS.
- SANITARY SEWERS AND CONNECTIONS 150mm AND SMALLER TO BE PVC SDR-28.
- SEWERS AND CONNECTIONS 200mm AND LARGER TO BE PVC SDR-35. BEDDING TO BE TYPE "B" EXCEPT AT RISERS, UNLESS NOTED OTHERWISE.
- INSULATE ALL STORM AND SANITARY SEWERS SERVICES THAT HAVE LESS THAN 2.0m OF COVER WITH THERMAL INSULATION AS PER OPSD 1109.030.
- SEWER CONNECTIONS ARE TO BE MADE ABOVE THE SPRINGLINE OF THE SEWER MAINS AS PER CITY OF OTTAWA STANDARD DRAWING S11, S11.1 & S11.2.
- SUPPLY AND INSTALL ALL PIPING AND APPURTENANCES AS SHOWN AND DETAILED TO WITHIN 1.0m OF BUILDING. ALL ENDS OF SERVICES TO BE PROPERLY CAPPED AND LOCATED WITH 2"x2" LONG MARKER.
- CONTRACTOR TO TELEVIEW (CTV) ALL PROPOSED SEWERS ON SITE, OUTLET CONNECTION TO THE MAIN AND PIPES 150mm OR GREATER PRIOR TO BASE COURSE ASPHALT. UPON COMPLETION OF CONTRACT, THE CONTRACTOR IS RESPONSIBLE TO FLUSH AND CLEAN ALL SEWERS & APPURTENANCES.
- DYE TESTING IS TO BE COMPLETED ON SANITARY SEWERS TO CONFIRM PROPER CONNECTION TO SANITARY SEWER MAIN.
- ALL SERVICES BENEATH PRIVATE ENTRANCES, WALKWAYS, AND STRUCTURES ARE TO BE SLEEVED.

D02-02-23-0043 & D07-12-23-0071