

1 EAST BUILDING ELEVATION
1:100

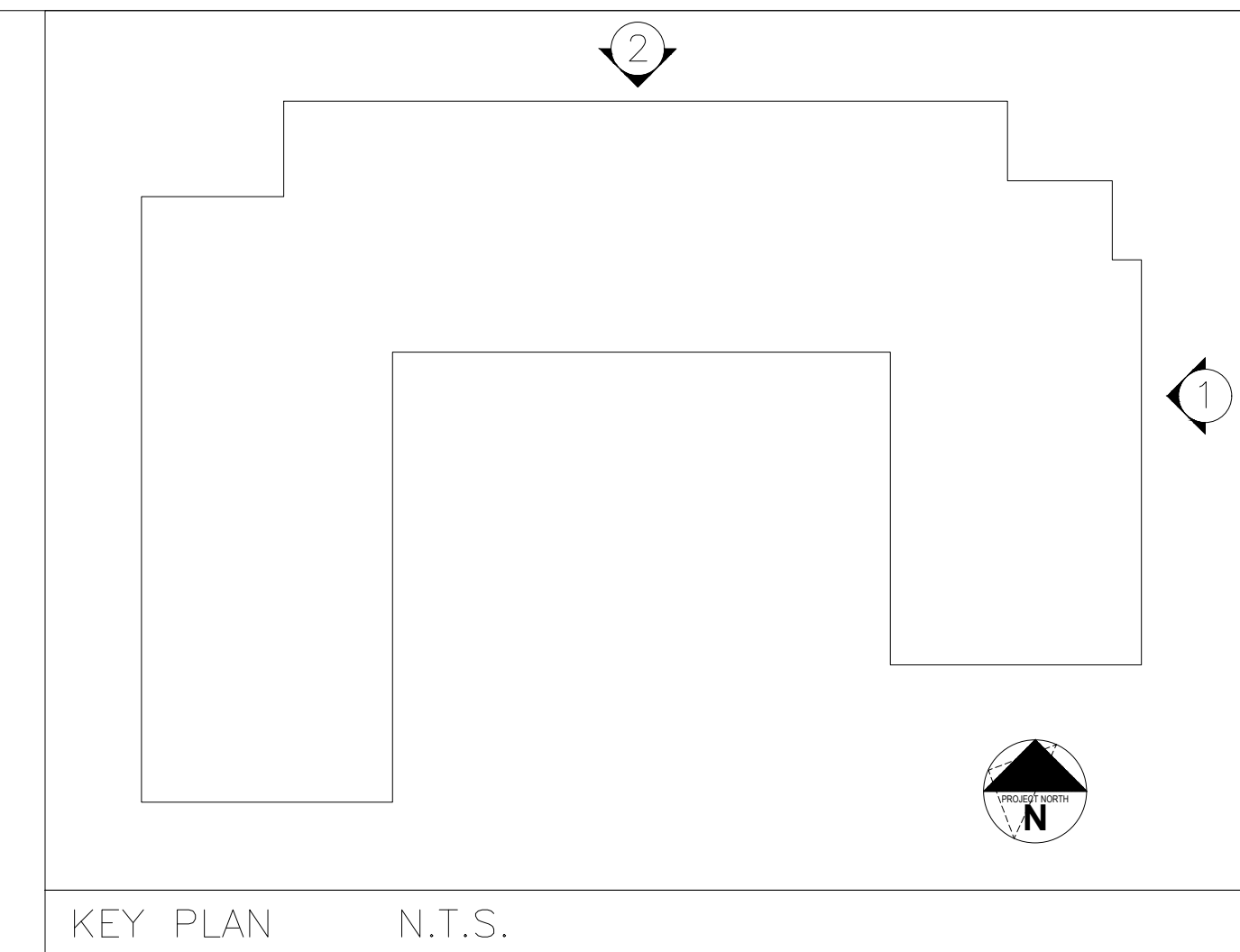

2 NORTH BUILDING ELEVATION
1:100



KEY PLAN N.T.S.

MATERIAL LEGEND

- MS - PRE-FINISHED METAL SIDING, PROFILE, COLOUR & GAUGE TBD.
- BV - BRICK VENEER, MANUFACTURER, SIZE & COLOUR TBD.
- CB - CEMENT BOARD, (MANUFACTURER, SIZE, HUE TBD) COLOUR: ORANGE.
- *ARROW ORIENTATION REFERS TO DIRECTION OF SIDING.

GENERAL NOTES

IT IS THE RESPONSIBILITY OF THE CONTRACTOR TO VERIFY ALL DIMENSIONS ON SITE AND REPORT ANY ERRORS AND OMISSIONS TO THE ARCHITECT. ALL CONTRACTORS MUST COMPLY WITH ALL PERTINENT CODES AND BY-LAWS. DO NOT SCALE DRAWINGS. THESE DRAWINGS MAY NOT BE USED FOR CONSTRUCTION UNTIL SIGNED. THIS DRAWING IS THE EXCLUSIVE PROPERTY OF COLIZZA BRUNI ARCHITECTURE INCORPORATED. COPYRIGHT RESERVED.

| NO | REV DATE | REV DESCRIPTION |
|----|--------------|------------------------------|
| 1 | OCT 20, 2021 | ISSUED FOR SITE PLAN CONTROL |
| 2 | NOV 7, 2023 | ISSUED FOR SPC RESUBMISSION |

PROJECT NAME
**1104 HALTON -
103 UNIT APARTMENT
BUILDING**
OTTAWA, ON

DRAWING TITLE
**EAST &
NORTH
ELEVATIONS**

SCALE
AS NOTED
DRAWN BY
DM
DATE
11/8/23
PROJECT NO.
03020

DRAWING NO.
A200

COLIZZA BRUNI
architecture

76 CHAMBERLAIN AVE • OTTAWA • ONTARIO • K1S 1V9
T 613.236.2944 • F 613.236.6777 • www.colizzabruni.com



1 WEST BUILDING ELEVATION
1:100

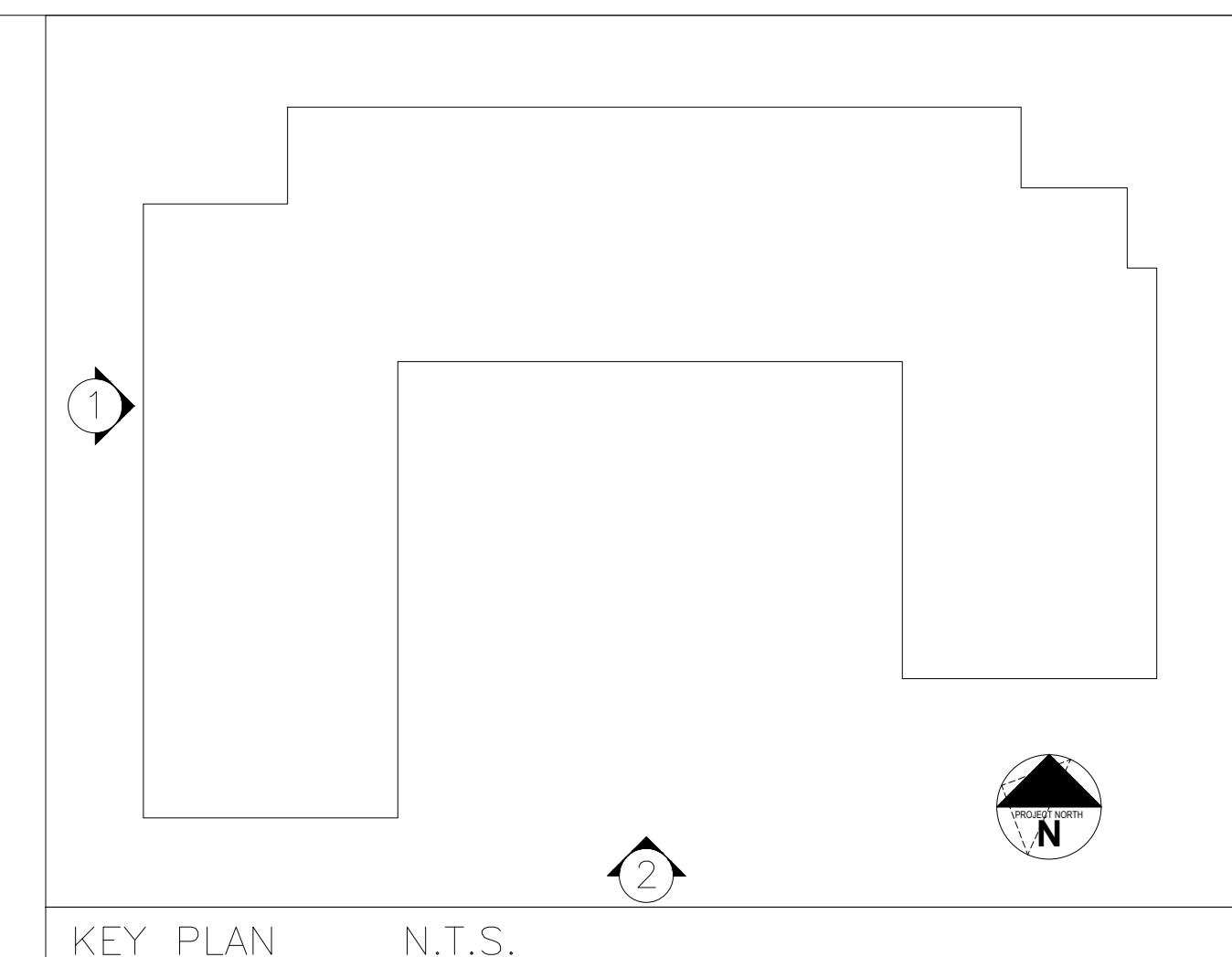

MATERIAL LEGEND

- MS - PRE-FINISHED METAL SIDING PROFILE, COLOUR & GAUGE TBD.
- BV - BRICK VENEER, MANUFACTURER, SIZE & COLOUR TBD.
- CB - CEMENT BOARD, (MANUFACTURER, SIZE, HUE TBD) COLOUR: ORANGE.
- *ARROW ORIENTATION REFERS TO DIRECTION OF SIDING.



2 SOUTH BUILDING ELEVATION
1:100

GENERAL NOTES

IT IS THE RESPONSIBILITY OF THE CONTRACTOR TO VERIFY ALL DIMENSIONS ON SITE AND REPORT ANY ERRORS AND OMISSIONS TO THE ARCHITECT. ALL CONTRACTORS MUST COMPLY WITH ALL PERTINENT CODES AND BY-LAWS. DO NOT SCALE DRAWINGS. THESE DRAWINGS MAY NOT BE USED FOR CONSTRUCTION UNTIL SIGNED. THIS DRAWING IS THE EXCLUSIVE PROPERTY OF COLIZZA BRUNI ARCHITECTURE INCORPORATED. COPYRIGHT RESERVED.

| NO | REV DATE | REV DESCRIPTION |
|----|--------------|------------------------------|
| 1 | OCT 20, 2021 | ISSUED FOR SITE PLAN CONTROL |
| 2 | NOV 7, 2023 | ISSUED FOR SPC RESUBMISSION |

PROJECT NAME
**1104 HALTON -
103 UNIT APARTMENT
BUILDING**
OTTAWA, ON

DRAWING TITLE
**WEST &
SOUTH
ELEVATIONS**

SCALE
AS NOTED
DRAWN BY
DM
DATE
11/8/23
PROJECT NO.
03020

DRAWING NO.
A201

COLIZZA BRUNI
architecture

76 CHAMBERLAIN AVE • OTTAWA • ONTARIO • K1S 1V9
T 613.236.2944 • F 613.236.6777 • www.colizzabruni.com



1 WEST COURTYARD ELEVATION
1:100



2 EAST COURTYARD ELEVATION
1:100

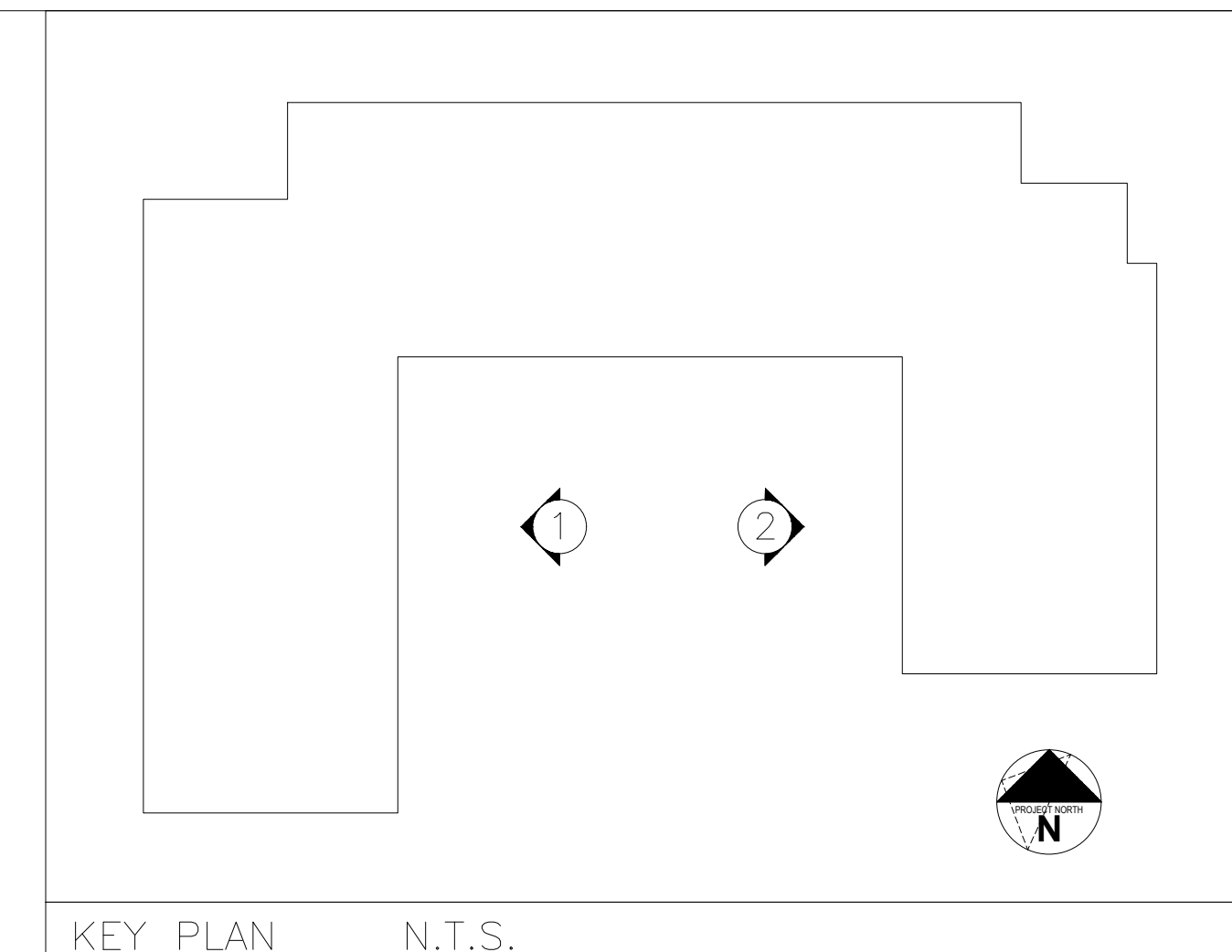

KEY PLAN N.T.S.

MATERIAL LEGEND

| | |
|--|---|
| | MS - PRE-FINISHED METAL SIDING PROFILE, COLOUR & GAUGE TBD. |
| | BV - BRICK VENEER, MANUFACTURER, SIZE & COLOUR TBD. |
| | CB - CEMENT BOARD, (MANUFACTURER, SIZE, HUE TBD) COLOUR: ORANGE |
| | *ARROW ORIENTATION REFERS TO DIRECTION OF SIDING |

GENERAL NOTES

IT IS THE RESPONSIBILITY OF THE CONTRACTOR TO VERIFY ALL DIMENSIONS ON SITE AND REPORT ANY ERRORS AND OMISSIONS TO THE ARCHITECT. ALL CONTRACTORS MUST COMPLY WITH ALL PERTINENT CODES AND BY-LAWS. DO NOT SCALE DRAWINGS. THESE DRAWINGS MAY NOT BE USED FOR CONSTRUCTION UNTIL SIGNED. THIS DRAWING IS THE EXCLUSIVE PROPERTY OF COLIZZA BRUNI ARCHITECTURE INCORPORATED. COPYRIGHT RESERVED.

| NO | REV DATE | REV DESCRIPTION |
|----|--------------|------------------------------|
| 1 | OCT 20, 2021 | ISSUED FOR SITE PLAN CONTROL |
| 2 | NOV 7, 2023 | ISSUED FOR SPC RESUBMISSION |

PROJECT NAME
**1104 HALTON -
103 UNIT APARTMENT
BUILDING**
OTTAWA, ON

DRAWING TITLE
**WEST &
SOUTH
ELEVATIONS**

SCALE
AS NOTED
DRAWN BY
DM
DATE
11/8/23
PROJECT NO.
03020

DRAWING NO.
A202