

SILVER STREET

SHILLINGTON AVENUE

ALEXANDER PARK

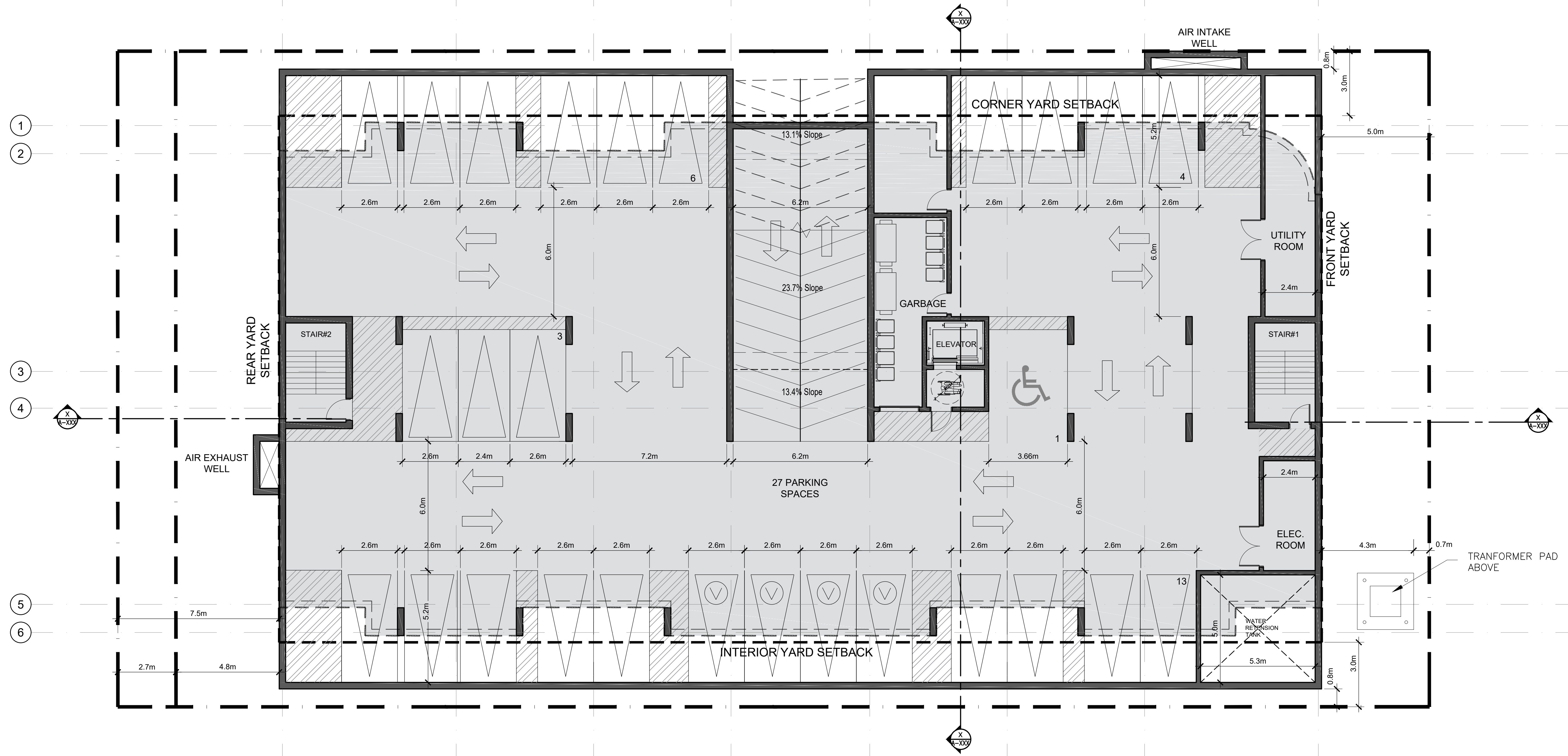

LEGEND:

- PROPOSED NEW BUILDING
- NEW UNIT PAVERS
- PROPERTY LINE
- ADJACENT LOT PROPERTY LINES
- EXISTING OVERHEAD HYDRO LINE
- NEW WOOD FENCE
- EXISTING HYDRO POLE TO REMAIN
- ENTRANCE ARROWS
- NEW BIKE RACKS
- NEW PARKING
- EXISTING CONCRETE CURB
- LIGHT STANDARD
- WALL MOUNTED LIGHTING FIXTURE
- EXTERIOR SOFFIT LIGHTING FIXTURE
- EXTERIOR WALL MOUNTED LIGHT FIXTURE

11			
10			
09			
08			
07			
06	FOR COORDINATION	JP	OCT 03 2023
05	FOR REVIEW	JP	MAY 03 2023
04	FOR REVIEW	PE	JAN. 26 2022
03	FOR REVIEW	PE	JAN. 18 2022
02	FOR REVIEW	PE	NOV. 25 2021
01	FOR REVIEW	PE	OCT. 18 2021
No.	REVISIONS	BY	DATE

**1** PARKING LEVEL  
 A100 SCALE = 1:100  
 GFA 1381 sqm

DESIGNED BY:	DRAWN BY:	APPROVED BY:
P.E.	P.E.	
PROJECT		
970, 974, Silver Street & 1271, 1275 Shillington Avenue		
DRAWING TITLE		
UNDERGROUND PARKING FLOOR PLAN		
PROJECT NO.		
0453		
DATE		
OCT. 18, 2021		

**A-100**

D02-02-22-0026