

**PART OF LOT 5  
CONCESSION 4 (OTTAWA FRONT)  
(Geographic Township of Gloucester)  
CITY OF OTTAWA**

Surveyed by Annis, O'Sullivan, Vollebek Ltd.

Scale 1 : 250



**Metric**

DISTANCES SHOWN ON THIS PLAN ARE IN METRES AND CAN BE CONVERTED TO FEET BY DIVIDING BY 0.3048

**Surveyor's Certificate**

I CERTIFY THAT:

1. This survey and plan are correct and in accordance with the Surveys Act, the Surveyors Act and the regulations made under them.
2. The survey was completed on March 2, 2022.

*Mac 11/22*  
Date

*Terrell J. Allison*  
Terrell J. Allison  
Ontario Land Surveyor

**BENCHMARK**  
Top of Spindle of Fire Hydrant Elev.=87.89

ROAD ALLOWANCE BETWEEN CONCESSIONS 3 AND 4 (OTTAWA FRONT)

KNOWN AS CHEMIN RENAUD ROAD

PIN 04404 - 0253

PART 2 PLAN 4R-28739  
PIN 04352 - 2295  
BY-LAW NO. 2015-260

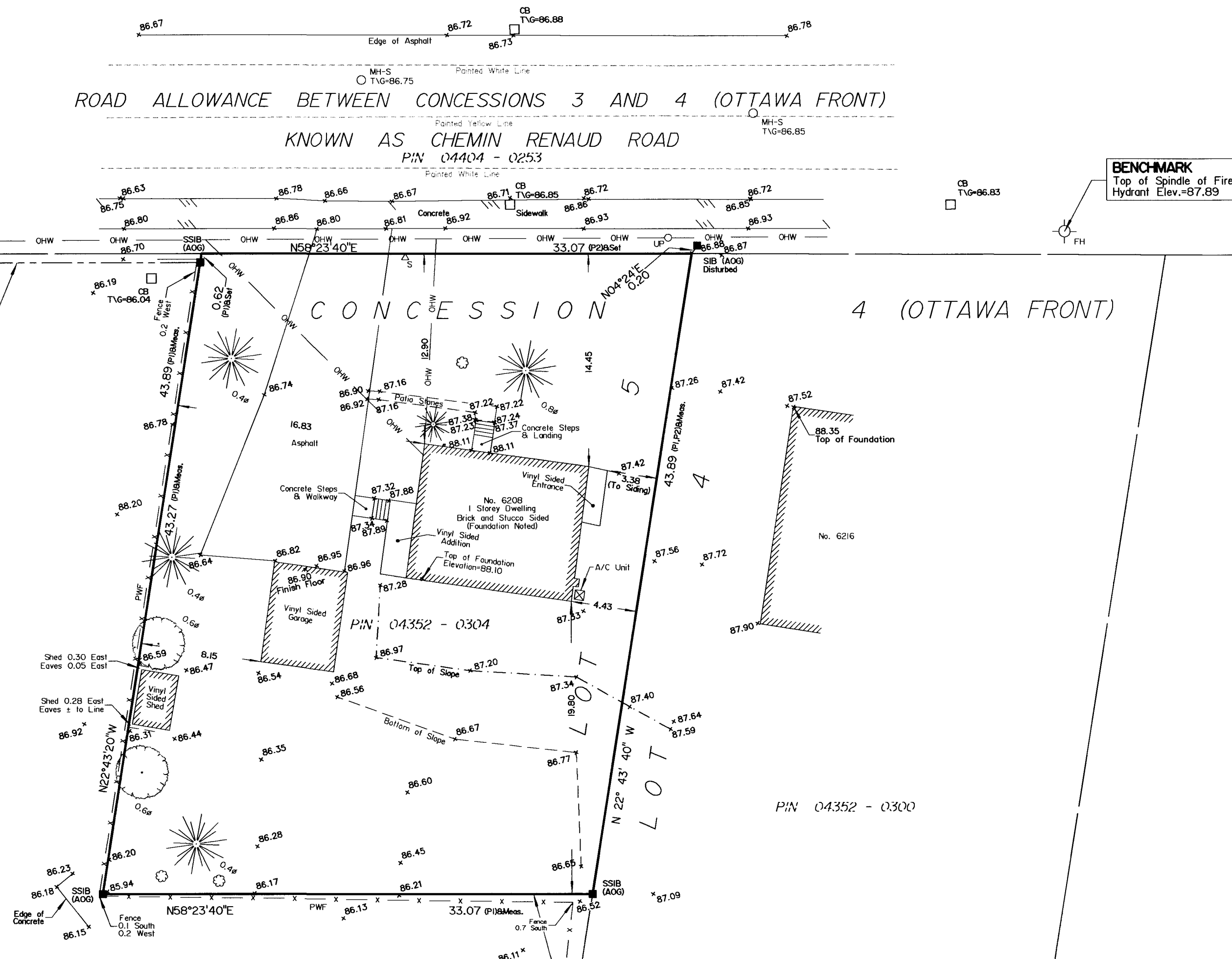

**Notes & Legend**

Denotes	
	Survey Monument Planted
	Survey Monument Found
SIB	Standard Iron Bar
SSIB	Short Standard Iron Bar
IB	Iron Bar
Meas.	Measured
(AOG)	Annis, O'Sullivan, Vollebek Ltd.
(PI)	Ottawa Carleton Standard Condominium Plan No. 1008
(P2)	Plan 4R-28739
	Maintenance Hole (Sanitary)
OHW	Overhead Wires
UP	Utility Pole
CB	Catch Basin
FH	Fire Hydrant
	Deciduous Tree
	Coniferous Tree
	Sign
P&W	Post and Wire
	Diameter
+ 86.00	Location of Elevations
C/L	Centreline
—	Property Line

ASSOCIATION OF ONTARIO  
LAND SURVEYORS  
PLAN SUBMISSION FORM  
V-24434

THIS PLAN IS NOT VALID UNLESS IT IS AN EMBOSSED ORIGINAL COPY ISSUED BY THE SURVEYOR IN ACCORDANCE WITH Regulation 1026, Section 29 (3)

**ELEVATION NOTES**

1. Elevations shown are geodetic and are referred to the CGVD28 geodetic datum.
2. It is the responsibility of the user of this information to verify that the job benchmark has not been altered or disturbed and that its relative elevation and description agrees with the information shown on this drawing.

**UTILITY NOTES**

1. This drawing cannot be accepted as acknowledging all of the utilities and it will be the responsibility of the user to contact the respective utility authorities for confirmation.
2. Only visible surface utilities were located.
3. A field location of underground plant by the pertinent utility authority is mandatory before any work involving breaking ground, probing, excavating etc.

OTTAWA-CARLETON STANDARD  
CONDOMINIUM PLAN 1008  
CONDO BLOCK 16008

© Annis, O'Sullivan, Vollebek Ltd, 2022. \*THIS PLAN IS PROTECTED BY COPYRIGHT\*

**ANNIS, O'SULLIVAN, VOLLEBEK LTD.**  
165 Bay Street  
Embrun, Ont. K0A 1W1  
Phone: (613) 443-3364  
Email: Embrun@aovltd.com

Ontario  
Land Surveyors

Job No. E-2002-22