

Notes:

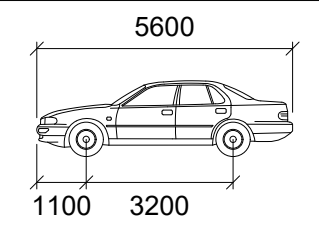

P

Width	: 2000	mm
Track	: 2000	
Lock to Lock Time	: 6.0	
Steering Angle	: 35.9	

04	Issued for Review	BB	2023-01-11
03	Issued for Review	BB	2022-12-16
02	Issued for Review	AN	2022-12-08
01	Issued for Review	AN	2022-08-26
REV:	DESCRIPTION:	BY:	DATE:
STATUS:			

CGH Transportation
 6 Plaza Court
 Ottawa, ON
 K2H 7W1
 (343) 999-9117

CLIENT: Carleton Construction

ARCHITECT:

SITE: 224 Preston

TITLE: Turning Movement Analysis
 In-bound Turning Movement

SCALE AT A3: NTS	DATE: 2022-01-11	DRAWN: BB	CHECKED: AH
PROJECT NO: 2022-114	DRAWING NO: 001	REVISION: 04	

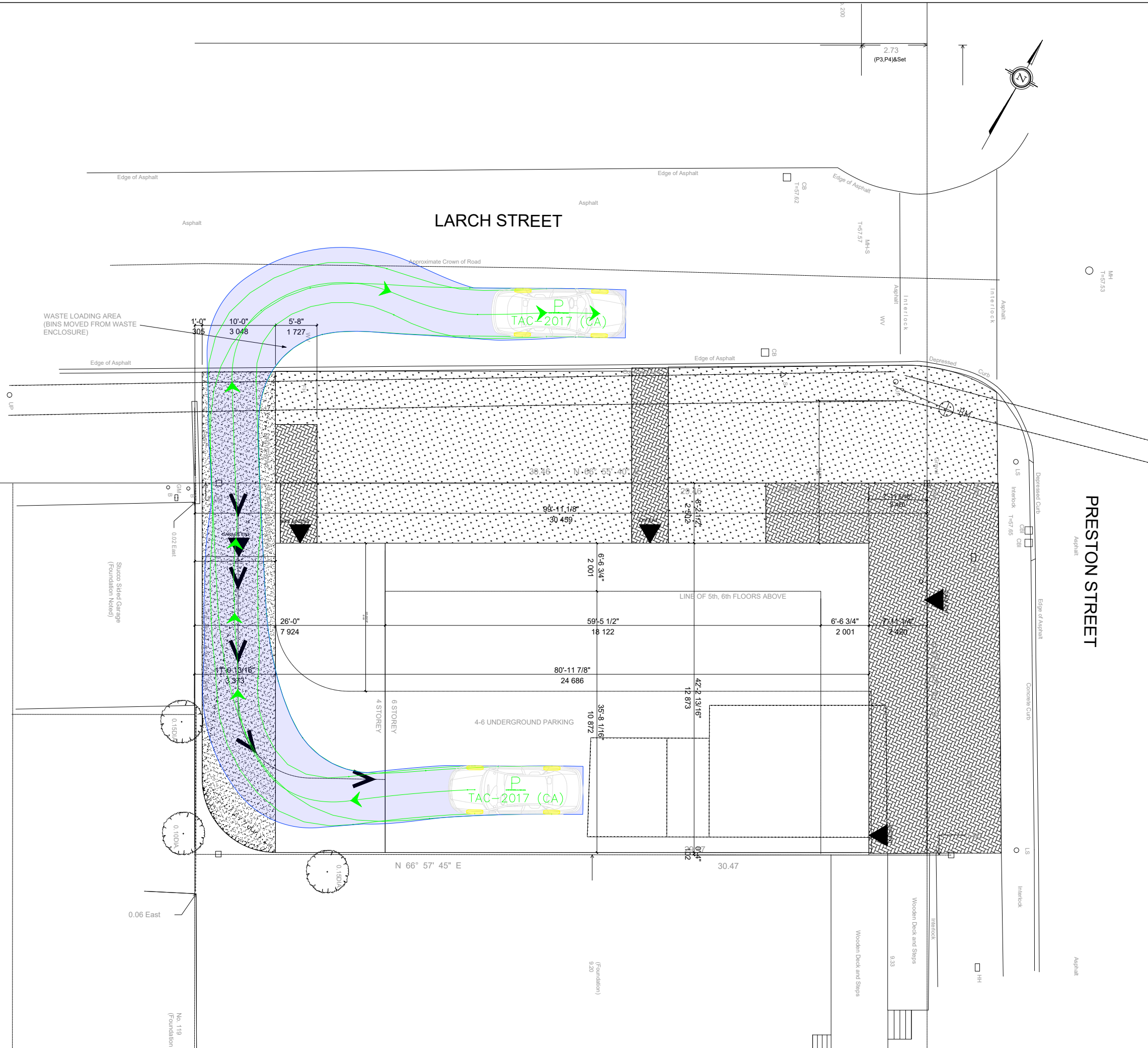

Notes:

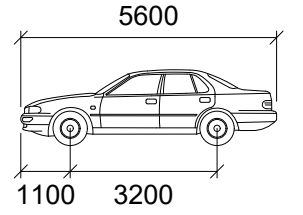

P

Width	: 2000	mm
Track	: 2000	
Lock to Lock Time	: 6.0	
Steering Angle	: 35.9	

04	Issued for Review	BB	2023-01-11
03	Issued for Review	BB	2022-12-16
02	Issued for Review	AN	2022-12-08
01	Issued for Review	AN	2022-08-26
REV:	DESCRIPTION:	BY:	DATE:
STATUS:			



CGH Transportation
 6 Plaza Court
 Ottawa, ON
 K2H 7W1
 (343) 999-9117

CLIENT: Carleton Construction

ARCHITECT:

SITE: 224 Preston

TITLE: Turning Movement Analysis
 Out-bound Turning Movement

SCALE AT A3:	DATE:	DRAWN:	CHECKED:
NTS	2023-01-11	BB	AH
PROJECT NO:	DRAWING NO:	REVISION:	
2022-114	002	04	

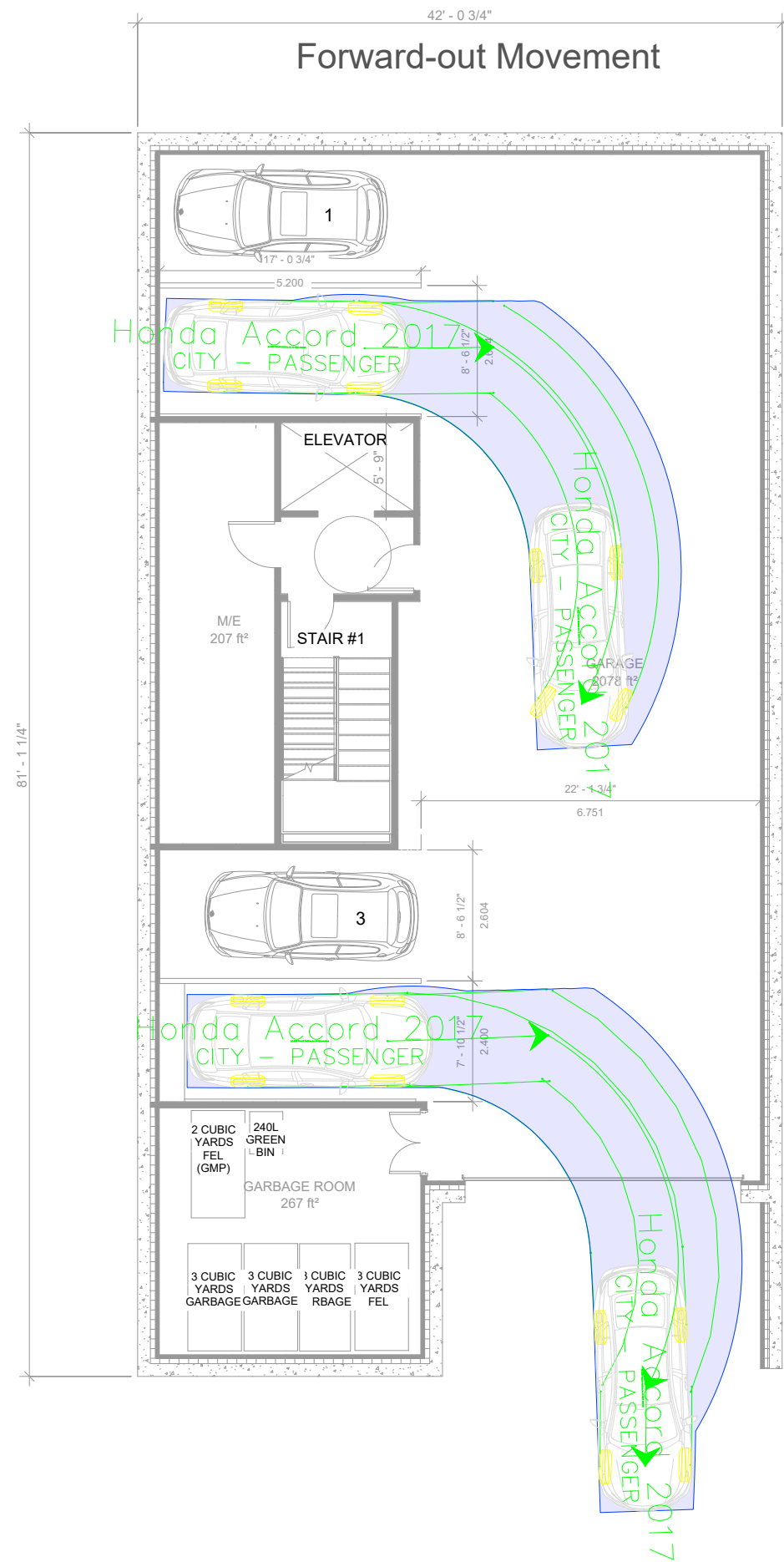
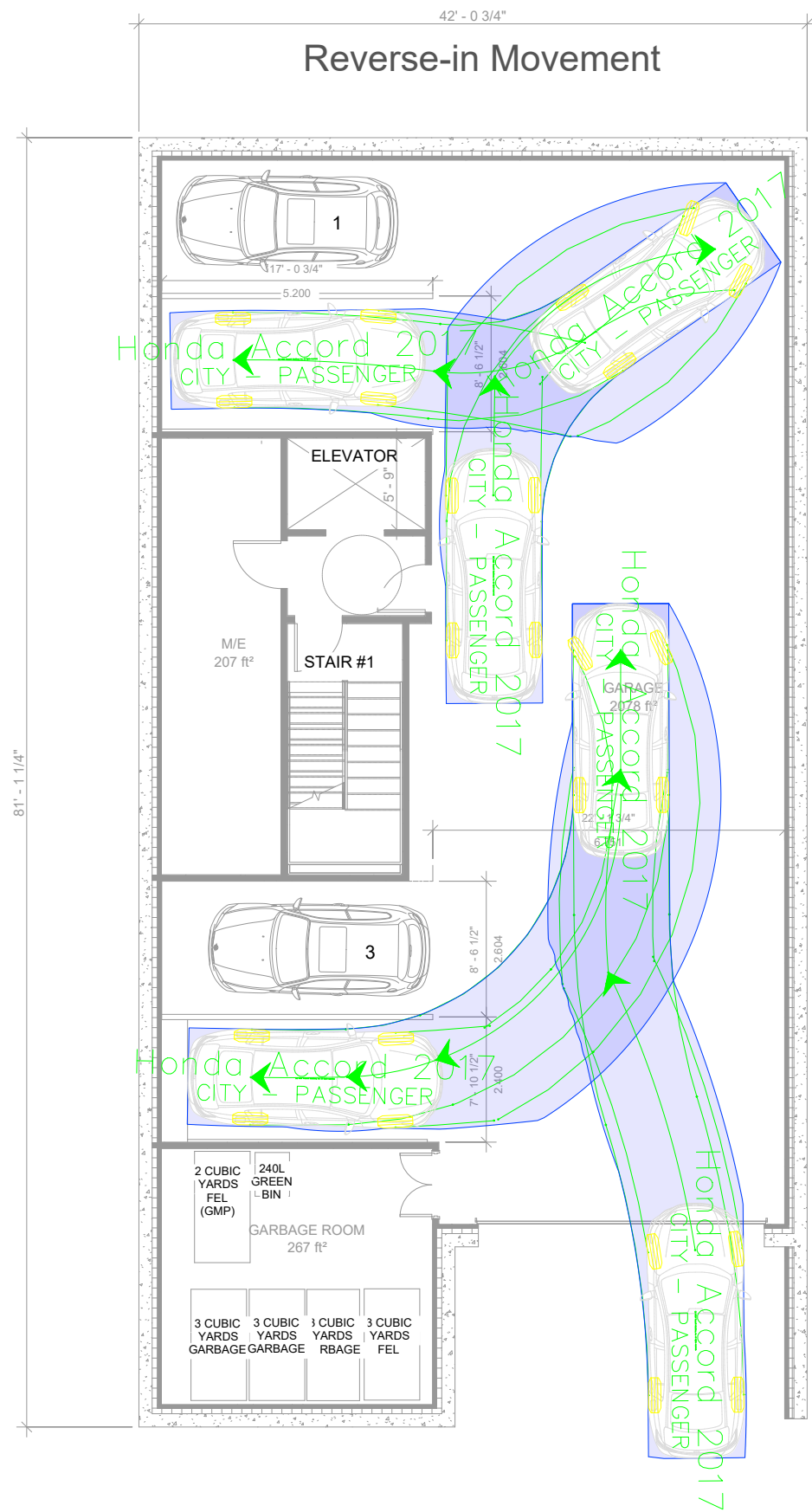

Notes:

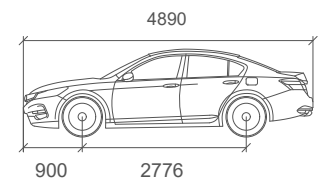

Honda Accord 2017
 Width : 1849 mm
 Track : 1827 mm
 Lock to Lock Time : 6.0
 Steering Angle : 31.9

04	Issued for Review	BB	2023-01-11
03	Issued for Review	BB	2022-12-16
02	Issued for Review	AN	2022-12-08
01	Issued for Review	AN	2022-08-26
REV:	DESCRIPTION:	BY:	DATE:
STATUS:			

CGH Transportation
 6 Plaza Court
 Ottawa, ON
 K2H 7W1
 (343) 999-9117

CLIENT: Carleton Construction
 ARCHITECT:

SITE: 224 Preston
 TITLE: Turning Movement Analysis
 Parking Movement (1)

SCALE AT A3: NTS	DATE: 2023-01-11	DRAWN: BB	CHECKED: AH
PROJECT NO: 2022-114	DRAWING NO: 003	REVISION: 04	

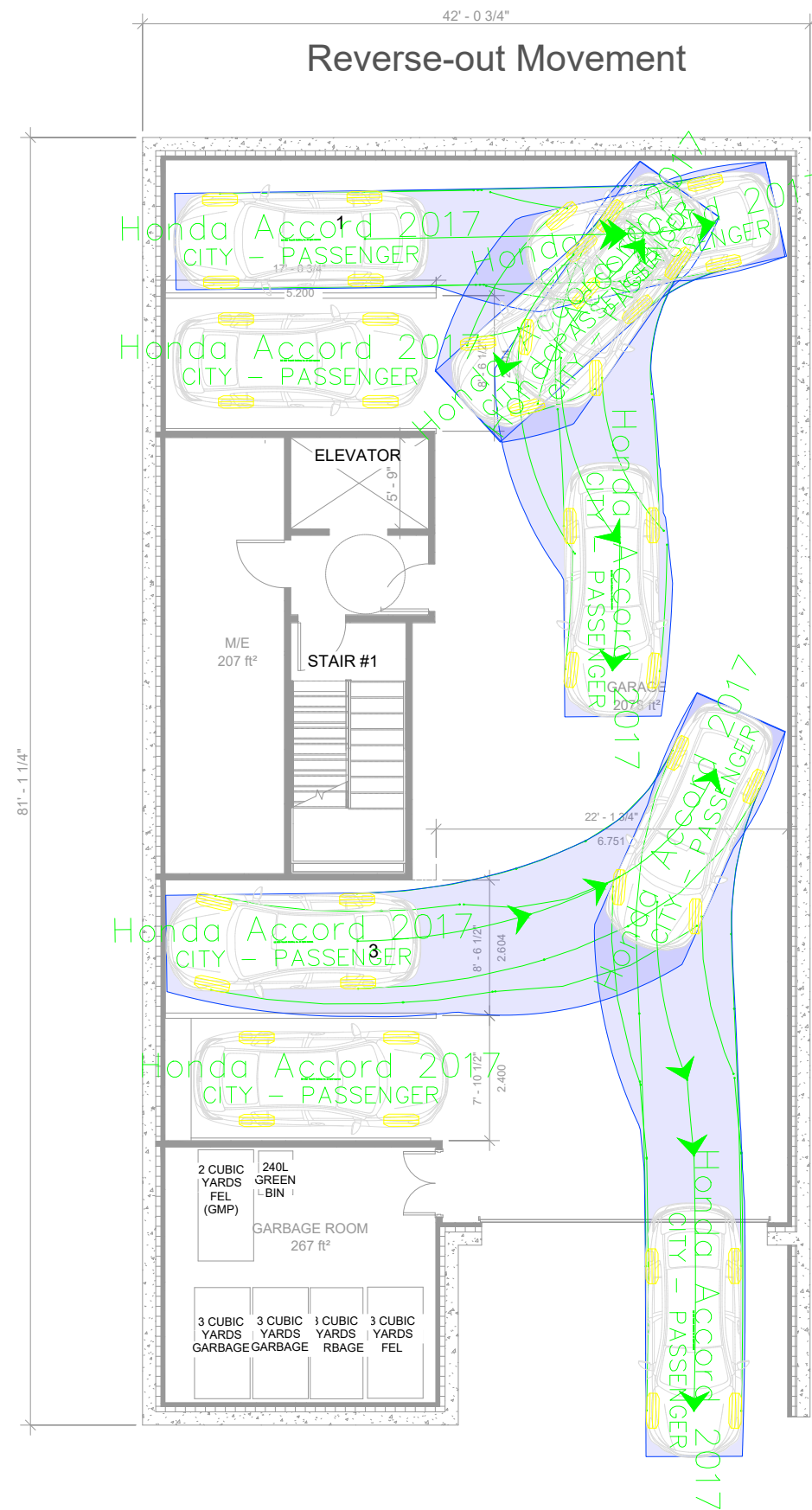
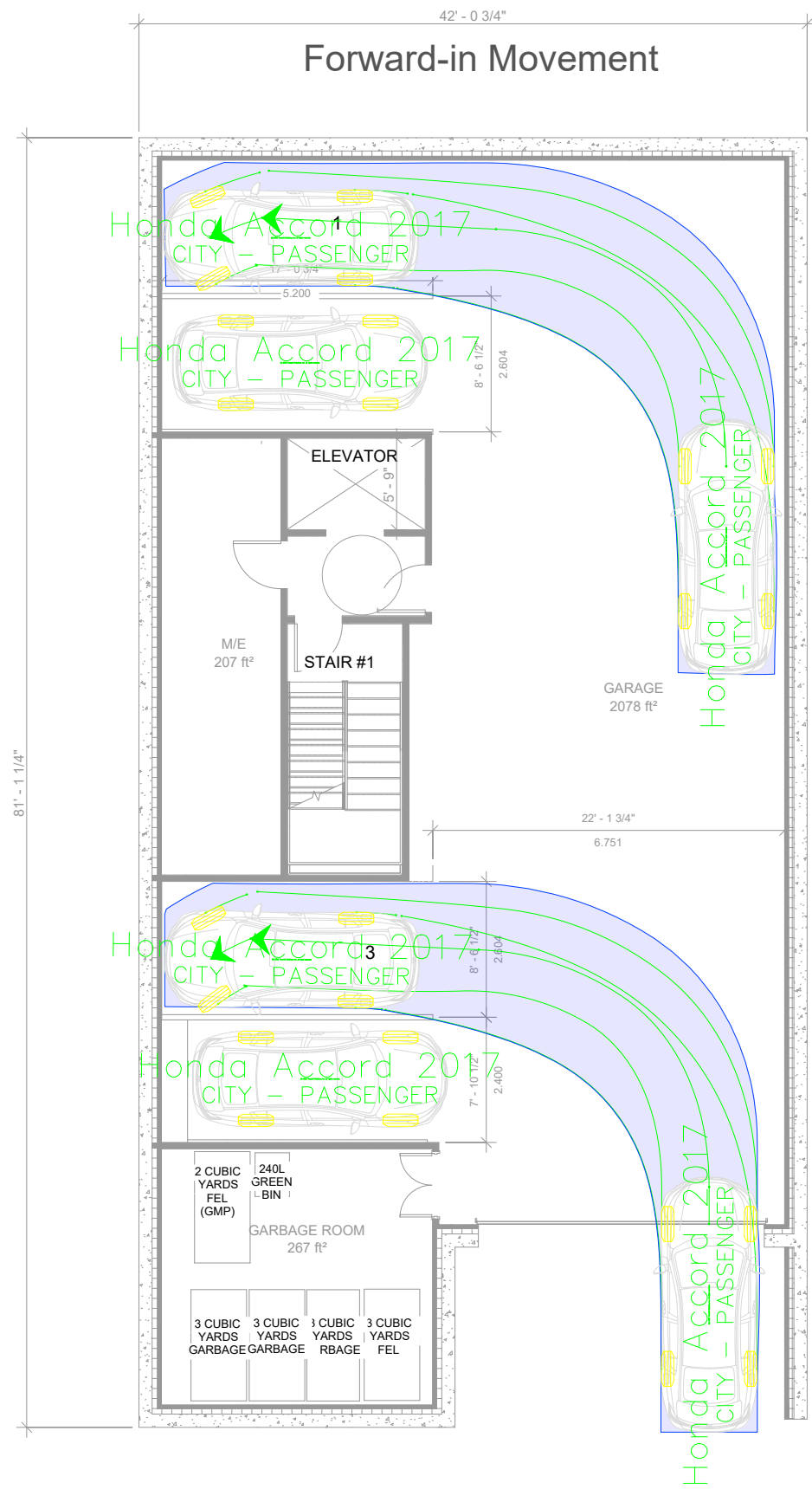

Notes:

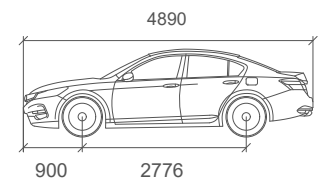

Honda Accord 2017

	mm
Width	: 1849
Track	: 1827
Lock to Lock Time	: 6.0
Steering Angle	: 31.9

04	Issued for Review	BB	2023-01-11
03	Issued for Review	BB	2022-12-16
02	Issued for Review	AN	2022-12-08
01	Issued for Review	AN	2022-08-26
REV:	DESCRIPTION:	BY:	DATE:
STATUS:			



CGH Transportation
 6 Plaza Court
 Ottawa, ON
 K2H 7W1
 (343) 999-9117

CLIENT: Carleton Construction

ARCHITECT:

SITE: 224 Preston

TITLE: Turning Movement Analysis
 Parking Movement (2)

SCALE AT A3:	DATE:	DRAWN:	CHECKED:
NTS	2023-01-11	BB	AH
PROJECT NO:	DRAWING NO:	REVISION:	
2022-114	004	04	

50mm Ground Clearance
0 CONFLICT POINTS

ENTERING Underground
Parking Garage

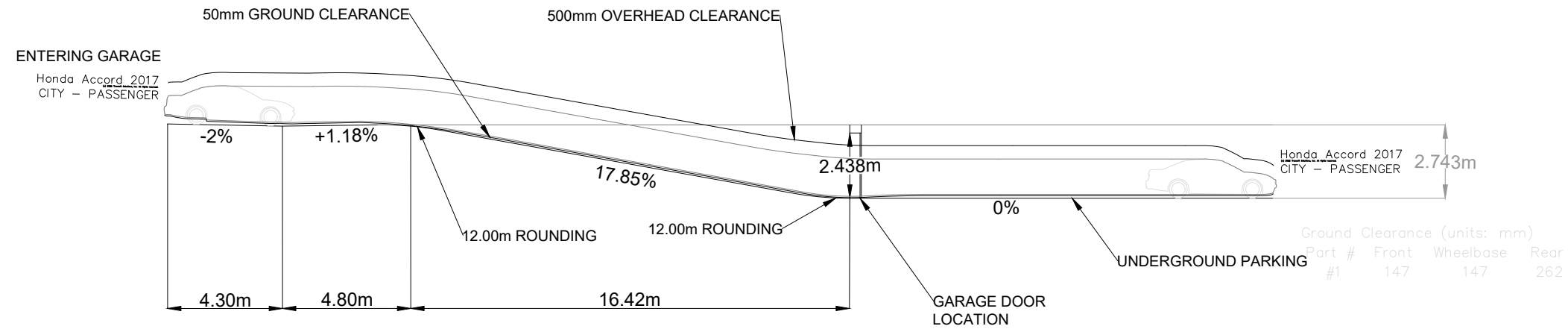

Notes:

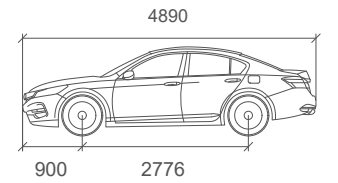

Honda Accord 2017

	mm
Width	: 1849
Track	: 1827
Lock to Lock Time	: 6.0
Steering Angle	: 31.9

50mm Ground Clearance
0 CONFLICT POINTS

EXITING Underground
Parking Garage

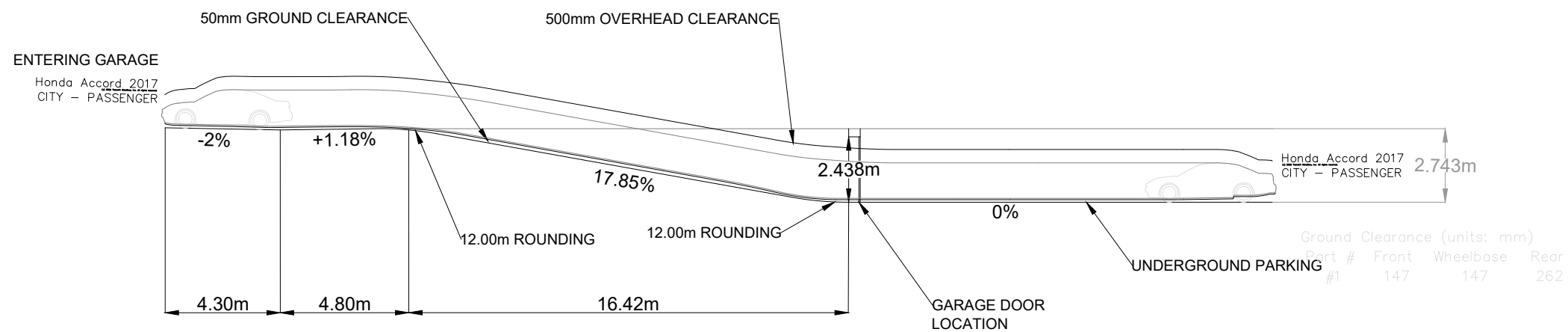

04	Issued for Review	BB	2023-01-11
03	Issued for Review	BB	2022-12-16
02	Issued for Review	AN	2022-12-08
01	Issued for Review	AN	2022-08-26
REV:	DESCRIPTION:	BY:	DATE:
STATUS:			

CGH Transportation
6 Plaza Court
Ottawa, ON
K2H 7W1
(343) 999-9117

CLIENT: Carleton Construction

ARCHITECT:

SITE:
224 Preston

TITLE:
**Vertical Slope Analysis
Proposed Ramp Slope**

SCALE AT A3: NTS	DATE: 2023-01-11	DRAWN: BB	CHECKED: AH
PROJECT NO: 2022-114	DRAWING NO: 005	REVISION: 04	