



Stantec Consulting Ltd.
400 - 1331 Clyde Avenue
Ottawa ON
Tel. 613.722.4420
www.stantec.com

Copyright Reserved
The Contractor shall verify and be responsible for all dimensions. DO NOT scale the drawing - any errors or omissions shall be reported to Stantec without delay.
The Copyrights to all designs and drawings are the property of Stantec. Reproduction or use for any purpose other than that authorized by Stantec is forbidden.



Legend

- AREA ID
- RUNOFF COEFFICIENT
- STORM DRAINAGE AREA hg.
- STORM DRAINAGE BOUNDARY
- INSULATION AS PER CITY STD W22
- DIRECTION OF EMERGENCY OVERLAND FLOW ROUTE
- PROPOSED STORM SEWER
- PROPOSED CATCHBASIN
- EXISTING CATCHBASIN
- PROPOSED ROOF DRAIN (REFER TO ARCHITECTURAL DWGS FOR DETAILS)
- EXISTING STORM SEWER

Notes

SCHEDULE OF ROOF RELEASE RATES				
BUILDING	DRAIN TYPE	# DRAINS	100YR HEAD (mm)	100YR RELEASE RATE (L/s)
BLDG	WATER/POSSIBLE ACCUMUL.	2	114	0.63

Revision	By	Appd.	YY.MM.DD
3	WAJ	AG	23.04.04
2	WAJ	AG	23.01.30
1	WAJ	AG	22.06.15

File Name:	160401745	WAJ	AG	WAJ	22.05.04
		Dwn.	Chkd.	Dgn.	YY.MM.DD

Permit-Seal

Client/Project
LION TRADE LTD.

211 ARMSTRONG STREET

OTTAWA, ON

Title
STORM DRAINAGE PLAN

Project No. 160401745
Drawing No. SD-1

Scale 1:100
Sheet 6 of 6

Revision 3
PLAN # 18847

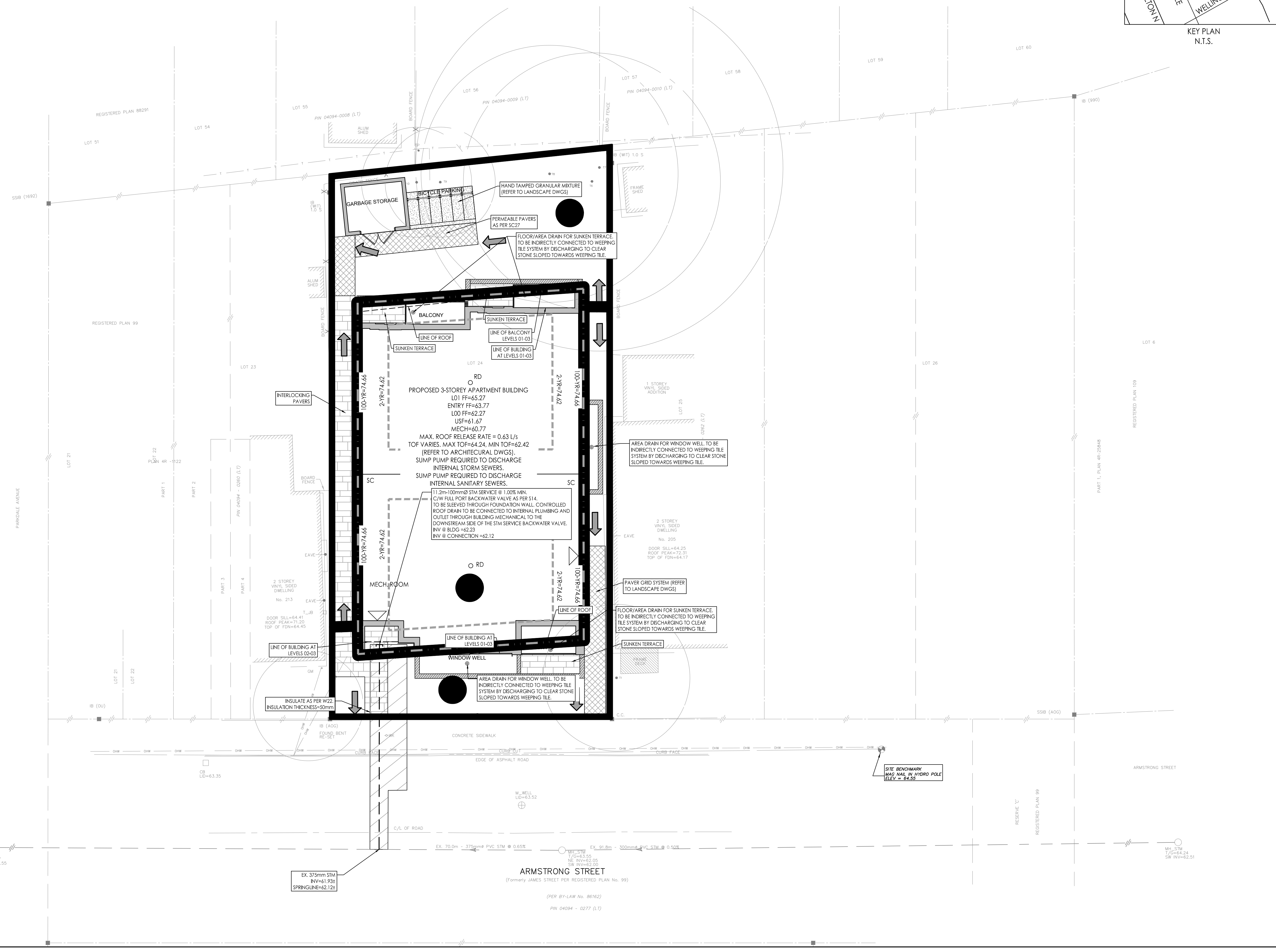

V:\CS\160401745\160401745\Design\Drawings\160401745-SD.dwg
 2023/04/24 09:54:14 AM by: JGIBSON