

**1 TREE CONSERVATION REPORT & LANDSCAPE PLAN**  
L.1 SCALE 1:300

- GENERAL NOTES:**
- IT IS THE RESPONSIBILITY OF THE APPROPRIATE CONTRACTOR OR OFFICIAL TO REPORT ANY ERRORS, OMISSIONS OR DISCREPANCIES ON THIS PLAN WITH ACTUAL SITE CONDITIONS TO THE LANDSCAPE ARCHITECT BEFORE PROCEEDING WITH CONSTRUCTION.
  - THE CONTRACTOR IS TO NOTIFY ALL UTILITY COMPANIES AND AUTHORITIES PRIOR TO ANY EXCAVATION AND ASCERTAIN LOCATIONS OF UNDERGROUND SERVICES.
  - THE CONTRACTOR IS TO REINSTATE ALL AREAS AND ITEMS DAMAGED AS A RESULT OF CONSTRUCTION ACTIVITY.
  - THE CONTRACTOR IS TO COMPLY WITH ALL PERTINENT CODES AND BY-LAWS.
  - THE CONTRACTOR IS TO MAINTAIN A POSITIVE SURFACE RUN-OFF THROUGHOUT THE ENTIRE CONSTRUCTION PERIOD.
  - THE LANDSCAPE ARCHITECT IS NOT RESPONSIBLE FOR SUBSURFACE CONDITIONS.
  - THE CONTRACTOR IS TO IDENTIFY ALL EXISTING TREES TO REMAIN ON SITE WITH THE LANDSCAPE ARCHITECT PRIOR TO CONSTRUCTION.
  - THE CONTRACTOR IS TO STAKE THE PROPOSED LOCATION OF ALL PLANT MATERIAL IN CONJUNCTION WITH THE LANDSCAPE ARCHITECT PRIOR TO EXCAVATION.
  - MINIMUM DISTANCES FOR SELECTED DECIDUOUS TREES ARE AS FOLLOWS:
    - BUILDING FOUNDATIONS - 7.5M
    - SIDEWALKS - 1.5M
    - PUBLIC STREETS - 2.5M
    - UNDERGROUND INFRASTRUCTURE - 2.0M
  - ALL TREES WITHIN 1M OF UNDERGROUND UTILITY TRENCHES ARE TO BE EXCAVATED BY HAND.
  - REMOVE ALL PROTECTIVE WRAPPING FROM TREE TRUNKS AFTER INSTALLATION.
  - STAKING OF TREES SHALL ONLY BE PERFORMED IF NECESSARY.
  - ENSURE THAT MULCH IS PULLED BACK A MINIMUM DISTANCE OF 75MM FROM BASE OF TREE TRUNK.

**EXISTING TREE LIST**

KEY	QTY	BOTANICAL NAME	COMMON NAME	SIZE	CONDITION	REMARKS	OWNERSHIP
AG	3	Acer ginnala	Amur Maple	100-200mm DBH	GOOD	To be removed	265 CENTRUM
AN	1	Acer negundo	Manitoba Maple	4x250-300mm DBH	FAIR	To be removed	265 CENTRUM
AP	5	Acer platanoides	Columnar Norway Maple	200-230mm DBH	GOOD	To be removed	265 CENTRUM
FR	1	Fraxinus spp. 'Multi-Stem'	Multi-Stem Ash	100-200mm DBH	DEAD	To be removed	265 CENTRUM
GT	3	Gleditsia triacanthos	Honey Locust	250-280mm DBH	GOOD	To be removed	265 CENTRUM
HL	4	Gleditsia triacanthos	Honey Locust	250-400mm DBH	GOOD	See plan	CITY OF OTTAWA
HO	9	Gleditsia triacanthos	Honey Locust	240-300mm DBH	GOOD	See plan	CITY & 265 CENTRUM
PD	1	Populus deltoides	Eastern Cottonwood	300mm DBH	GOOD	To remain	CITY OF OTTAWA
PI	3	Picea pungens	Colorado Spruce	200-300mm DBH	GOOD	To be removed	265 CENTRUM
PP	9	Picea pungens	Colorado Spruce	200-300mm DBH	GOOD	To remain	CITY OF OTTAWA
QM	1	Quercus macrocarpa	Honey Locust	250mm DBH	GOOD	To be removed	265 CENTRUM
SR	2	Syringa reticulata	Japanese Tree Lilac	100mm DBH	GOOD	To be removed	265 CENTRUM
TF	3	Thuja occidentalis 'Fastigiata'	Columnar White Cedar	100mm DBH	FAIR	To remain	CITY OF OTTAWA

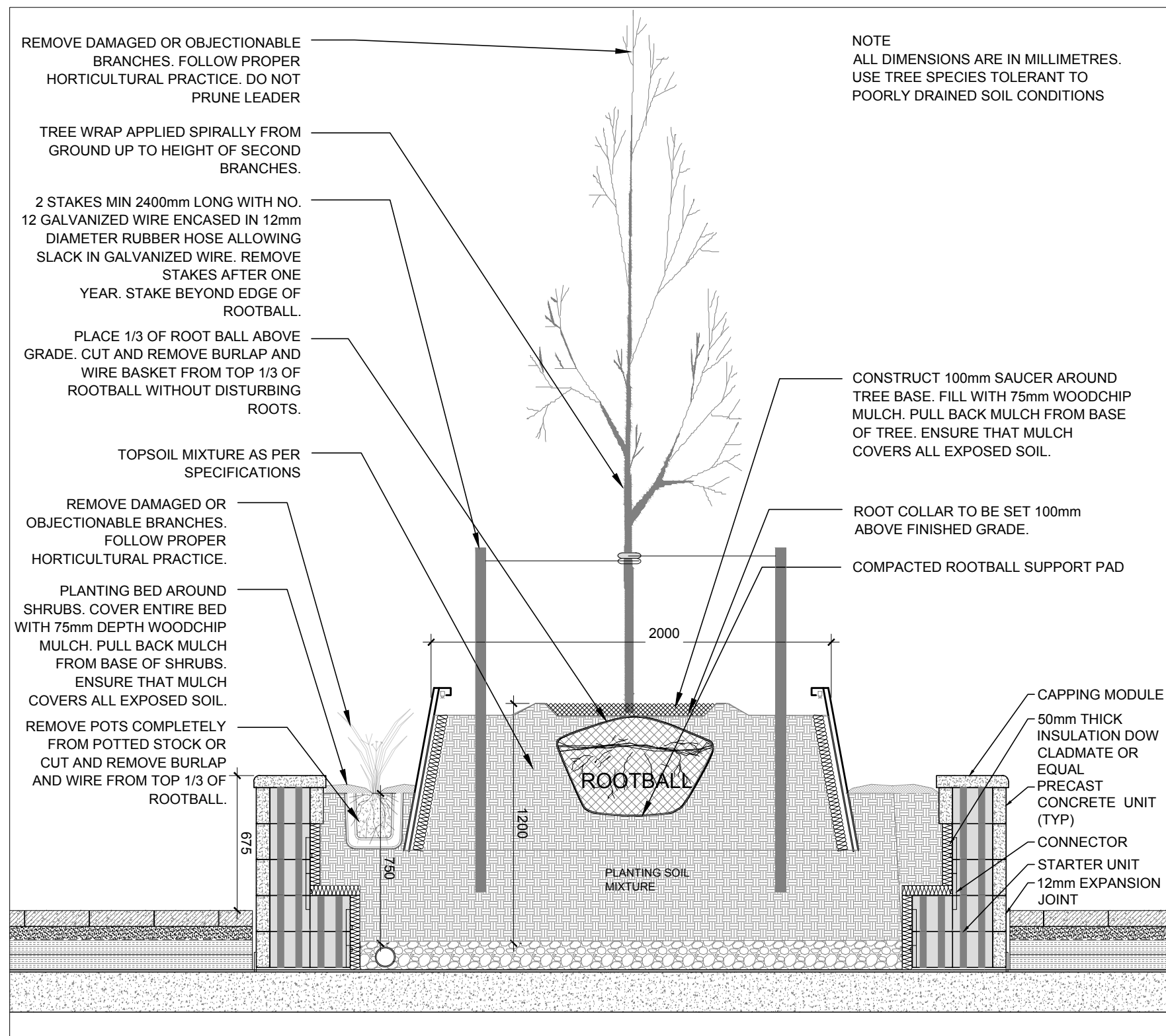

**2 RAISED PLANTER & ILLUMINATED TREE PIT DETAIL**  
L.1 SCALE 1:25

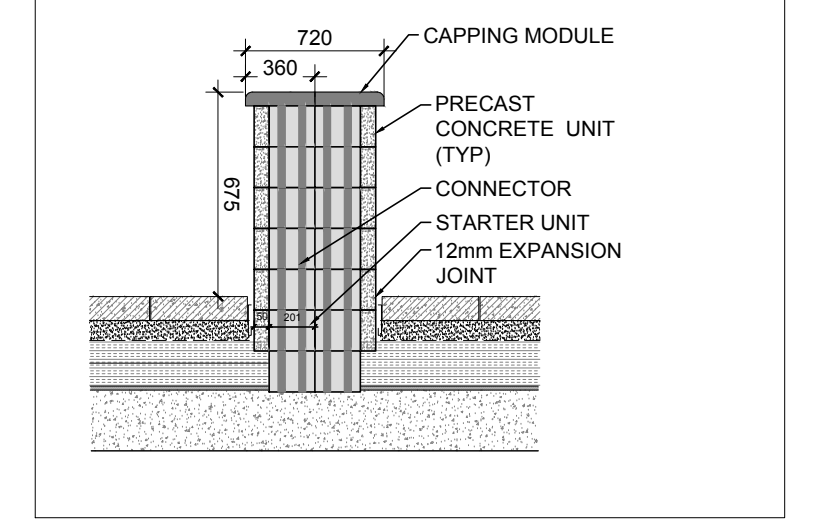
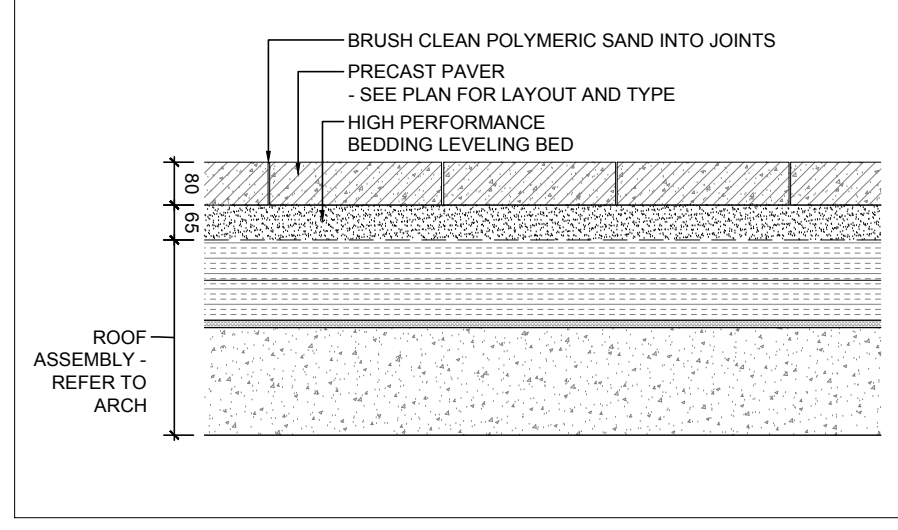

**3 PRECAST CONCRETE UNIT PAVERS**  
L.1 SCALE NTS

**4 DOUBLESIDED PRECAST SEATED WALL**  
L.1 SCALE NTS

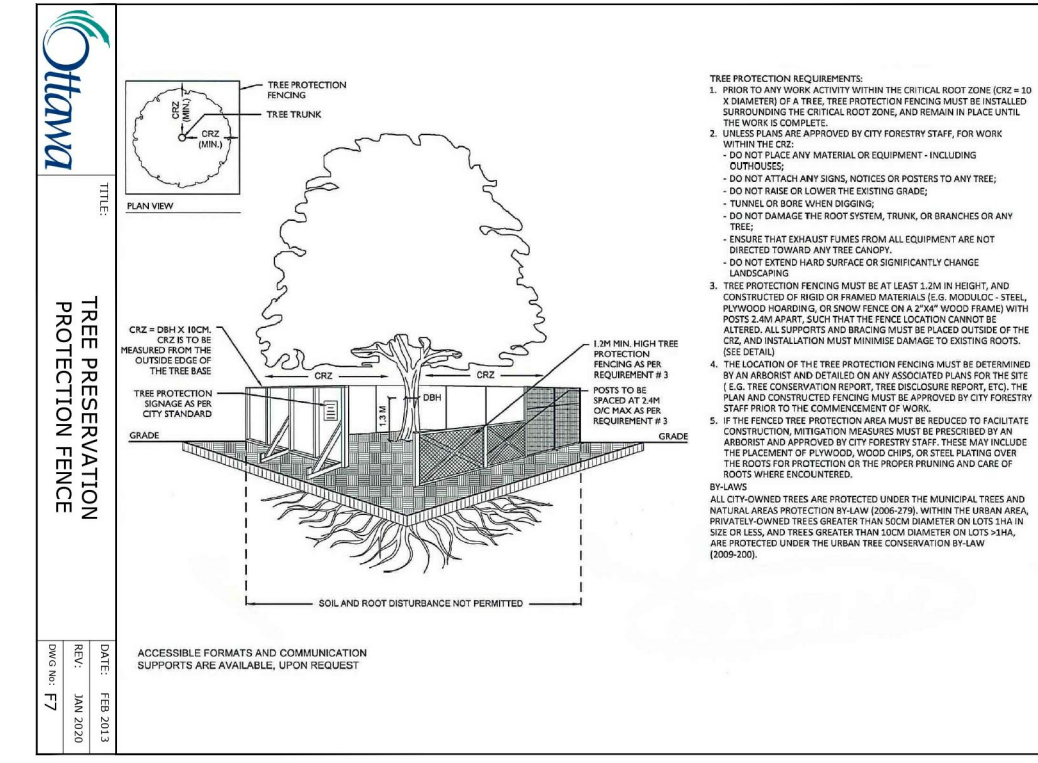

**5 TREE PROTECTION FENCE**  
L.1 SCALE NTS

**BAYVIEW ORLEANS INC.**

**CONSULTANTS**  
ARCHITECTS: **B+H**  
320 Bay St. #200  
Toronto, ON M5H 4A6  
Tel: (416) 596-2299

**SURVEYORS:**  
ANNIS, O'SULLIVAN, VOLLEBECK LTD.  
14 Concourse Gate, Suite 500  
Newport, Ont. K2E 7R6  
Phone: (613) 727-0850 / Fax: (613) 727-1079

**CIVIL ENGINEERS:**  
**McINTOSH PERRY**  
115 Walgreen Rd.  
Carp, ON K0A 1L0  
Tel: (613) 836-2184

- LEGEND**
- EXISTING TREE TO REMAIN
  - EXISTING TREE TO BE REMOVED
  - TREE PROTECTION FENCING
  - PROPOSED DECIDUOUS TREE
  - PROPOSED DECIDUOUS TREE IN RAISED ILLUMINATED PLANTER (REFER TO 2L.1)
  - PROPOSED DECIDUOUS & CONIFEROUS SHRUBS
  - PROPOSED 3 RING BIKE RACK
  - PROPOSED PERGOLA W/ STRING LIGHTS & LOUNGE SEATING
  - PROPOSED AMENITY TABLE
  - OUTDOOR BBQ KITCHEN
  - PROPOSED BENCH
  - PROPOSED GRASS
  - PROPOSED GREENROOF
  - PROPOSED ARTIFICIAL TURF
  - PROPOSED PRECAST UNIT PAVING TO MATCH CENTRUM STREETSCAPE
  - PROPOSED ROOF TOP PAVERS
  - PROPOSED PRIVATE PATIO PAVERS
  - PROPOSED CONCRETE SIDEWALK
  - PROPOSED PLANTER/ SEATWALL
  - PROPOSED GUARDRAIL
  - PROPOSED GRADE (REFER TO GRADING PLAN)
  - PROPOSED TACTILE WALKING SURFACE INDICATOR (TWSI)
  - FIRE HYDRANT REFER TO ARCH & CIVIL

No.	Issue	Date	DR	CK
4	ISSUED FOR SPA	03/24/2023	SL	JL
3	ISSUED FOR REVIEW & COMMENT	03/21/2023	SL	JL
2	ISSUED FOR REVIEW & COMMENT	03/15/2023	SL	JL
1	ISSUED FOR PROGRESS REVIEW	03/10/2023	SL	JL

**JAMES B. LENNOX & ASSOCIATES INC.**  
**LANDSCAPE ARCHITECTS**  
3332 CARLING AVE. OTTAWA, ONTARIO K2H 5A8  
Tel: (613) 722-5168 Fax: (866) 343-3942

**PROJECT**  
265 CENTRUM, OTTAWA ON

**DRAWING**  
TREE CONSERVATION REPORT & LANDSCAPE PLAN CONCEPT

**STAMP**

AS SHOWN  
START DATE  
FEBRUARY 2023  
PROJECT NO.  
23MIS2323

**PROJECT NORTH**

**DRAWING NO.**  
**L.1**  
PLOT SIZE ARCH-D