

DEPTH OF THE EXISTING 200mm WATERMAIN HAS BEEN ESTIMATED TO BE ±2.10m. PRIOR TO COMMENCING CONSTRUCTION DAYLIGHT EXISTING WATERMAIN AND DETERMINE ITS EXACT LOCATION, DEPTH AND SIZE BY CAREFUL TEST EXCAVATION. REPORT ANY DIFFERENCES TO THE ENGINEER.

SIZE AND DEPTH OF THE EXISTING STORM SEWER HAS BEEN ESTIMATED. PRIOR TO COMMENCING CONSTRUCTION DAYLIGHT EXISTING STORM SEWER AND DETERMINE THEIR EXACT LOCATIONS, DEPTHS AND SIZES BY CAREFUL TEST EXCAVATIONS. REPORT ANY DIFFERENCES TO THE ENGINEER.

EXIST. SAN MH
TOP 71.58
INV ±68.74(SE)

EXIST. MH
TOP 71.19
INV ±68.92(NE)
INV ±68.98(S)
INV ±68.96(SW)

EXIST. CB
TOP 71.10

EXIST. CB
TOP 71.16

MH-9
TOP 71.30
INV 68.96(N)
INV 68.99(SE)

MH-8 (OGS)
TOP 71.40
INV 69.00(NW)
INV 69.01(SE)

150 SAN INV 68.48
250 SAN SPL ±68.48

EXIST. CB/MH
TOP 70.86
INV ±69.05(N)
INV ±69.06(S)
INV ±69.06(W)

EXIST. MH
TOP 71.72
INV ±69.31(W)
INV ±68.24(NW)
INV ±68.19(SE)

MH-7
TOP 71.10
INV 69.11(NW)
INV 69.11(NE)
INV 69.11(SE)

CB-5
TOP 70.97
INV 69.17

250 ST
SPL 69.27
300 ST
SPL 69.27

3.9m - 250 PVC
ST @ 0.432%

50mm THICK INSULATION, 1.8m WIDE

ICD IN OUTLET PIPE PLUG
STYLE 21.90L/s @ 1.95m
(86mm DIA.)
ORIFICE LOCATED AT
BOTTOM OF PLUG

CLAY SEEPAGE BARRIER IN TRENCH
(REFER TO GEOTECHNICAL)

PROPOSED 6-STOREY MIXED-USE BUILDING
FFL = 71.71
USF = 70.06

Garbage Enclosure

PATIO

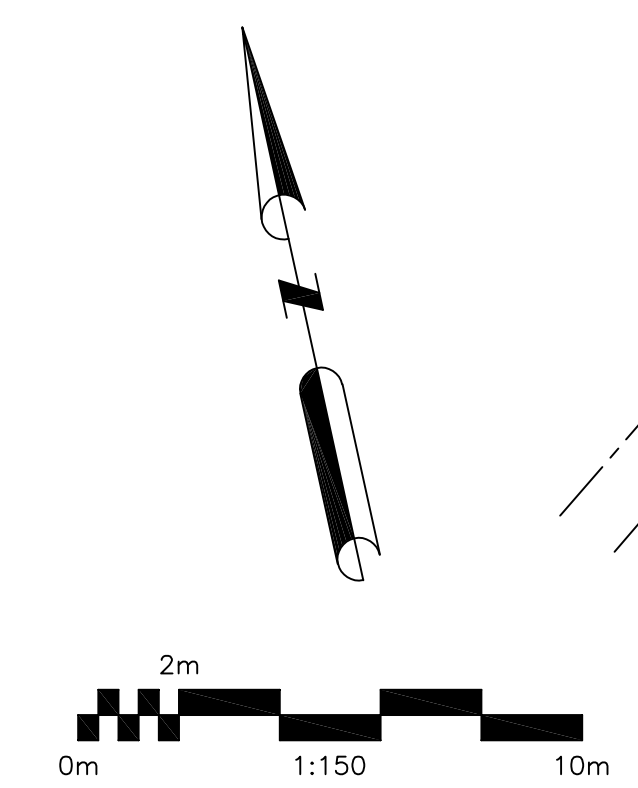

REFER TO NOTES & DETAILS ON DRAWINGS C-10 & C11

No. 2044
14-Storey Apartment Building

LEGEND

- FFL FINISHED FLOOR ELEVATION
- TOP TOP OF FOUNDATION
- BFL BASEMENT FLOOR ELEVATION
- USF UNDERSIDE OF FOOTING
- PROPERTY LINE
- - - - - CRITICAL ROOT ZONE
- CB CATCH-BASIN
- MH STORM MANHOLE
- CB/MH CATCH-BASIN/MANHOLE
- MH SANITARY MANHOLE
- FH FIRE HYDRANT
- FDC FIRE DEPARTMENT CONNECTION
- VB VALVE & VALVE BOX
- M WATER METER
- R REMOTE WATER METER
- SAN SANITARY SEWER
- ST STORM SEWER
- WS/WM WATER SERVICE/WATERMAIN
- OBV OBVERT OF PIPE
- SPL SPRINGLINE OF PIPE
- INV INVERT OF PIPE
- I.O.S TOP OF SLOPE
- B.O.S BOTTOM OF SLOPE
- CENTERLINE OF SWALE
- 150mm BARRIER CURB
- DEPRESSED CURB
- ROAD CUT REINSTATEMENT

KEY PLAN

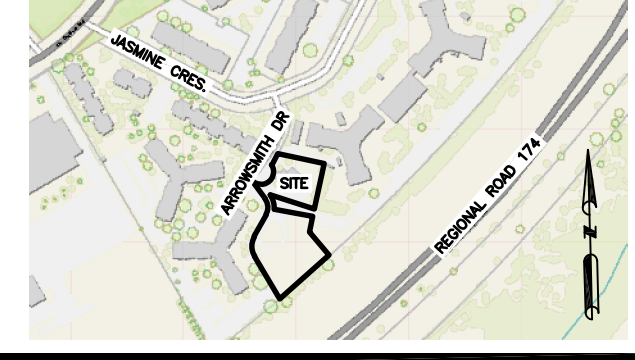

No.	DATE	REVISION
2	DEC 21-22	ISSUED FOR APPROVAL
1	DEC 19-22	ISSUED FOR COORDINATION

D. B. GRAY ENGINEERING INC.
Stormwater Management - Grading & Drainage - Storm & Sanitary Sewers - Watermain
 700 Long Point Circle 613-425-8044
 Ottawa, Ontario d.gray@dbgrayengineering.com

Project
PROPOSED 6-STOREY MIXED-USE BUILDING
2040 ARROWSMITH DRIVE
 OTTAWA, ONTARIO

Drawing Title
SITE SERVICING PLAN
 (NORTH)

Engineer's Seal

 NOT VALID UNLESS SIGNED & DATED

Drawn D.B.G.
 H. Scale 1:150
 V. Scale
 Date DEC 19-22
 Job No. 22062
 Drawing No.
C-3
 of 14