

KANATA LAKES PLAZA				
KANATA LAKES SITE				
Building Use	m2	s.f.	Parking Required	Rate
Retail & Dental Clinic	2,848	30,655	97	3.4 per 100m2
Restaurant	687	7,398	69	10 per 100m2
Restaurant (with Drive-thru)	192	2,064	16	8 per 100m2
Total	3,727	40,117	182	
Parking spaces required (MAX)			182	
Parking spaces provided			183	
Barrier Free parking required (as per City of Ottawa Accessibility Design Standards)			7	
Barrier Free parking provided			10	

2 bays on Building E	200.54
3 Bays on Building C	300.90
5 bays of Restaurant + half of building A	501.44 + 185.86
	687.30

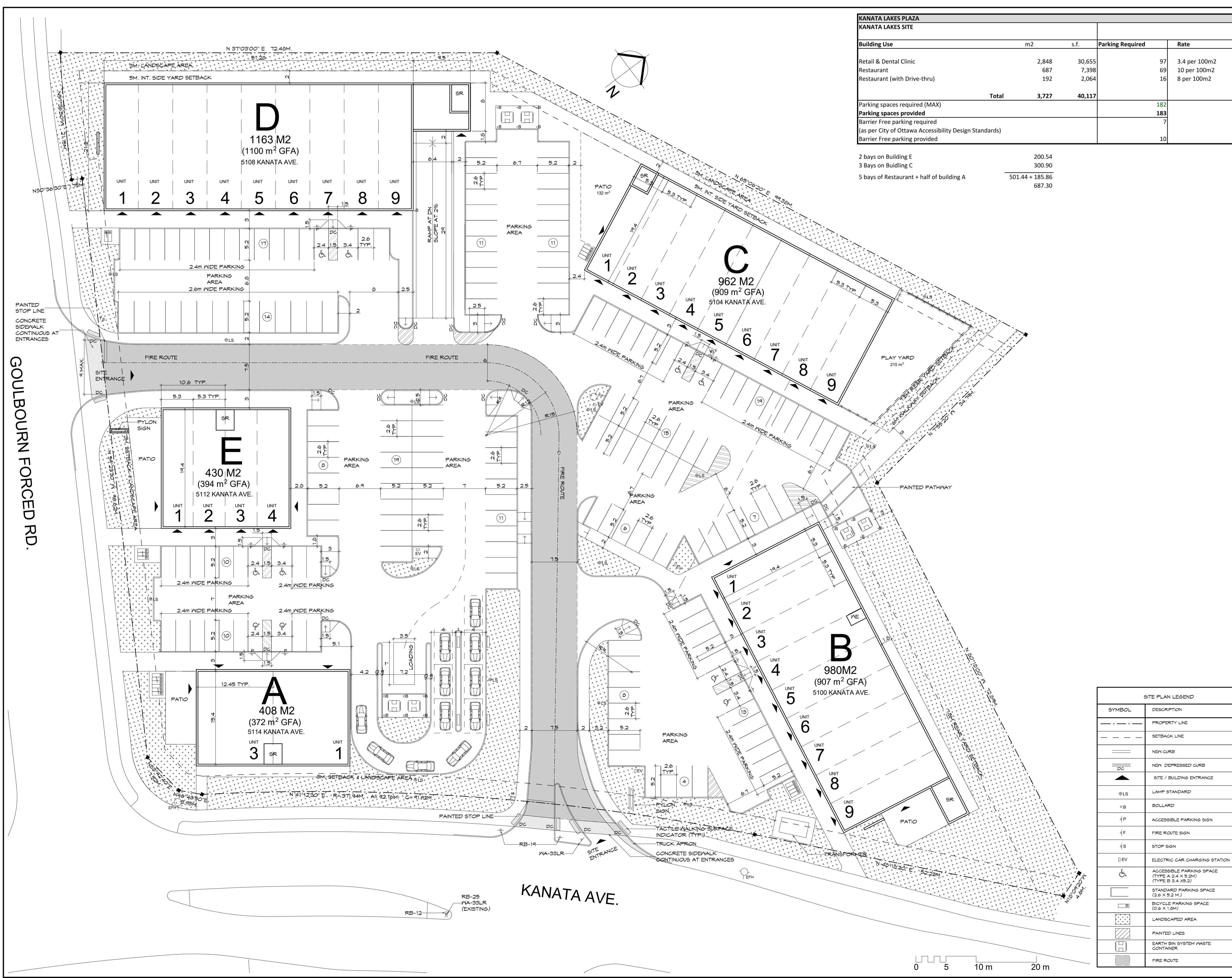
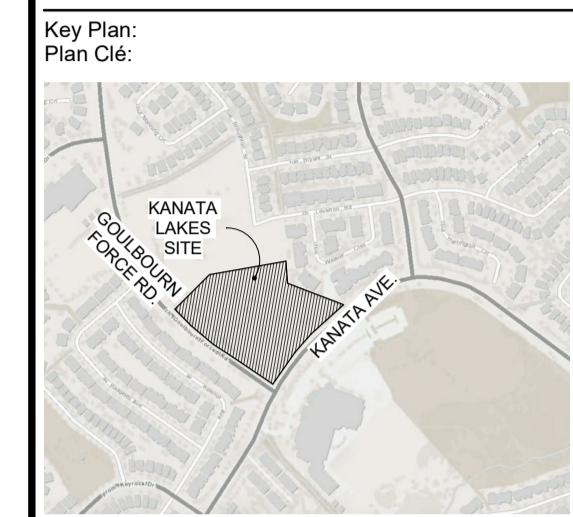

SITE PLAN LEGEND	
SYMBOL	DESCRIPTION
---	PROPERTY LINE
---	SETBACK LINE
---	NEW CURB
---	NEW DEPRESSED CURB
▲	SITE / BUILDING ENTRANCE
⊙LS	LAMP STANDARD
⊙B	BOLLARD
⊙P	ACCESSIBLE PARKING SIGN
⊙F	FIRE ROUTE SIGN
⊙S	STOP SIGN
⊙EV	ELECTRIC CAR CHARGING STATION
⊙	ACCESSIBLE PARKING SPACE (TYPE A 2.4 X 5.2M) (TYPE B 3.4 X 5.2)
□	STANDARD PARKING SPACE (2.6 X 5.2 M)
□	BICYCLE PARKING SPACE (0.6 X 1.8M)
▨	LANDSCAPED AREA
▨	PAINTED LINES
⊙	EARTH BIN SYSTEM WASTE CONTAINER
---	FIRE ROUTE

1 SITE PLAN
A1 SCALE: 1 : 300

ISSUED FOR REVIEW 03 / 29 / 2021

Issue: Date:

Prime Consultant: Expert-Consult:

DREDGE LEAHY ARCHITECTS INC.
100 - 25 Holland Ave. Ottawa, ON K1Y 4R9 613.724.9865 dl-arch.ca

Sub Consultant: Expert-Consult:

Project: Project: KANATA LAKES PLAZA

KANATA AVE., OTTAWA, ON K2K 3K5

Drawing: Dessin: SITE PLAN

Drawn by: Dessiné par: R.D. Scale: Echelle: As indicated

Designed by: Conçu par: M.D. Date: MAR. 2021

Approved by: Approuvé par: M.D. Client Project No. No. du Projet du Client:

Seal: Scellé: Project No. No. du Projet: 1374 Sheet No. No. de la feuille: A1

D07-12-18-0063