

**Craig Zoning Sketch**  
 3722 John Shaw Road  
 Part Lot 10, Concession 8  
 Geographic Township of Fitzroy  
 City of Ottawa

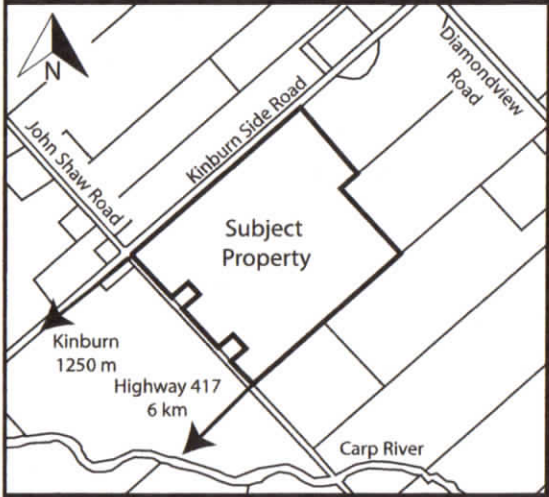

- Legend**
- |                       |                         |
|-----------------------|-------------------------|
| Unstable Slopes       | Wooded Area             |
| Existing Driveway     | Existing Dwelling       |
| Watercourse           | Existing Well           |
| MVCA Regulation Limit | Septic Field            |
| 1:100 year Floodplain | Existing Field Entrance |
| Utility Poles         |                         |
| Hydro Wires           |                         |

**Notes**

1. Boundary and dimensions of subject property are approximate and not based on plan of survey.
2. Locations of watercourses, regulation limits, and floodplain are approximate and derived from MVCA Online GIS mapping.
3. Location of unstable slopes are approximate and derived from Schedule K - Environmental Constraints from The City of Ottawa Official Plan.

Version Date: January 12, 2021

File No. 21-287 | Drawn By: ML

**ZANDERPLAN**  
 Your rural land planning experts  
 40 Sunset Boulevard, Unit 40, Perth, ON 613-264-9600

