

1 TREE CONSERVATION REPORT & LANDSCAPE PLAN  
SCALE 1:100

- GENERAL NOTES:**
- IT IS THE RESPONSIBILITY OF THE APPROPRIATE CONTRACTOR OR OFFICIAL TO REPORT ANY ERRORS, OMISSIONS OR DISCREPANCIES ON THIS PLAN WITH ACTUAL SITE CONDITIONS TO THE LANDSCAPE ARCHITECT BEFORE PROCEEDING WITH CONSTRUCTION.
  - THE CONTRACTOR IS TO NOTIFY ALL UTILITY COMPANIES AND AUTHORITIES PRIOR TO ANY EXCAVATION AND ASCERTAIN LOCATIONS OF UNDERGROUND SERVICES.
  - THE CONTRACTOR IS TO REINSTATE ALL AREAS AND ITEMS DAMAGED AS A RESULT OF CONSTRUCTION ACTIVITY.
  - THE CONTRACTOR IS TO COMPLY WITH ALL PERTINENT CODES AND BY-LAWS.
  - THE CONTRACTOR IS TO MAINTAIN A POSITIVE SURFACE RUN-OFF THROUGHOUT THE ENTIRE CONSTRUCTION PERIOD.
  - THE LANDSCAPE ARCHITECT IS NOT RESPONSIBLE FOR SUBSURFACE CONDITIONS.
  - THE CONTRACTOR IS TO IDENTIFY ALL EXISTING TREES TO REMAIN ON SITE WITH THE LANDSCAPE ARCHITECT PRIOR TO CONSTRUCTION.
  - THE CONTRACTOR IS TO STAKE THE PROPOSED LOCATION OF ALL PLANT MATERIAL IN CONJUNCTION WITH THE LANDSCAPE ARCHITECT PRIOR TO EXCAVATION.
  - MINIMUM DISTANCES FOR SELECTED DECIDUOUS TREES ARE AS FOLLOWS:
    - BUILDING FOUNDATIONS - 7.5M
    - SIDEWALKS - 1.5M
    - PUBLIC STREETS - 2.5M
    - UNDERGROUND INFRASTRUCTURE - 2.0M
  - ALL TREES WITHIN 1M OF UNDERGROUND UTILITY TRENCHES ARE TO BE EXCAVATED BY HAND.
  - REMOVE ALL PROTECTIVE WRAPPING FROM TREE TRUNKS AFTER INSTALLATION.
  - STAKING OF TREES SHALL ONLY BE PERFORMED IF NECESSARY.
  - ENSURE THAT MULCH IS PULLED BACK A MINIMUM DISTANCE OF 75MM FROM BASE OF TREE TRUNK.

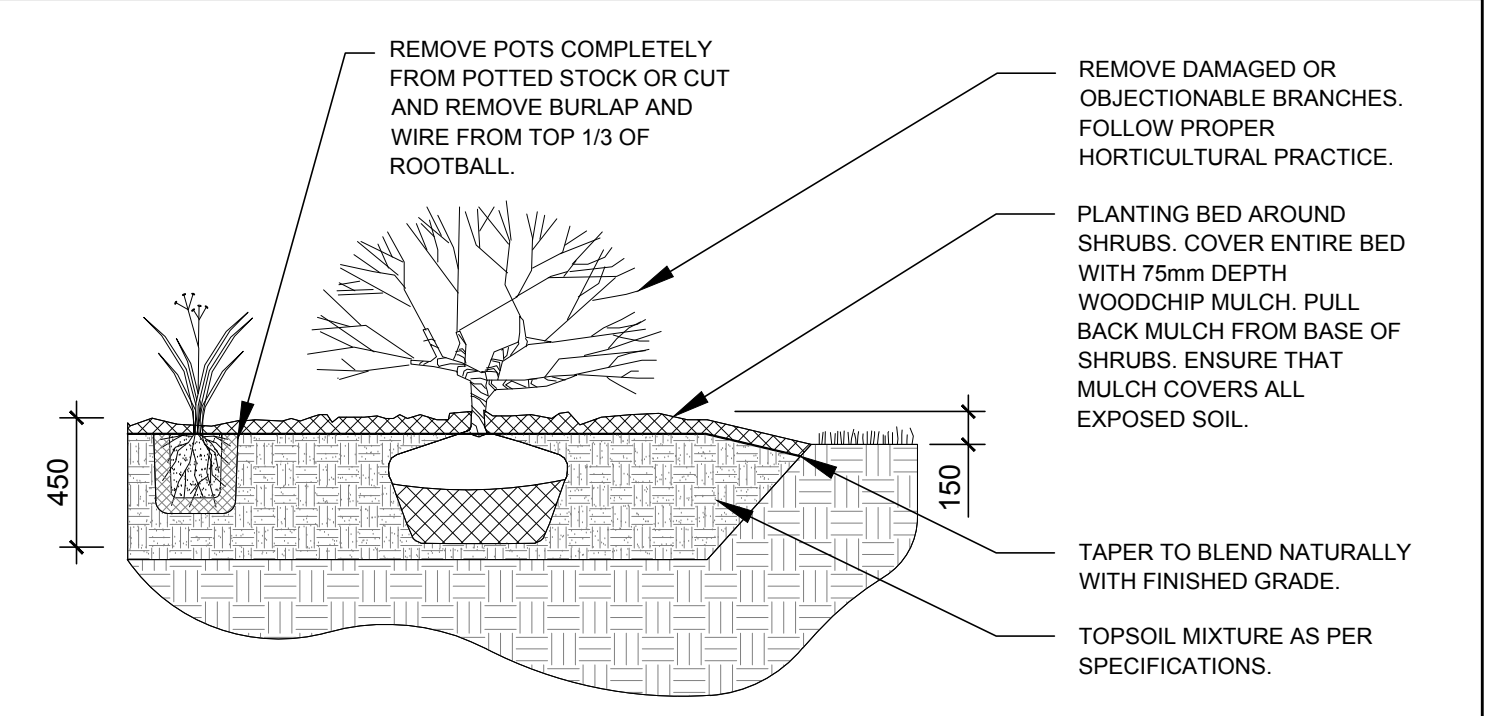

2 SHRUB PLANTING  
SCALE: NTS

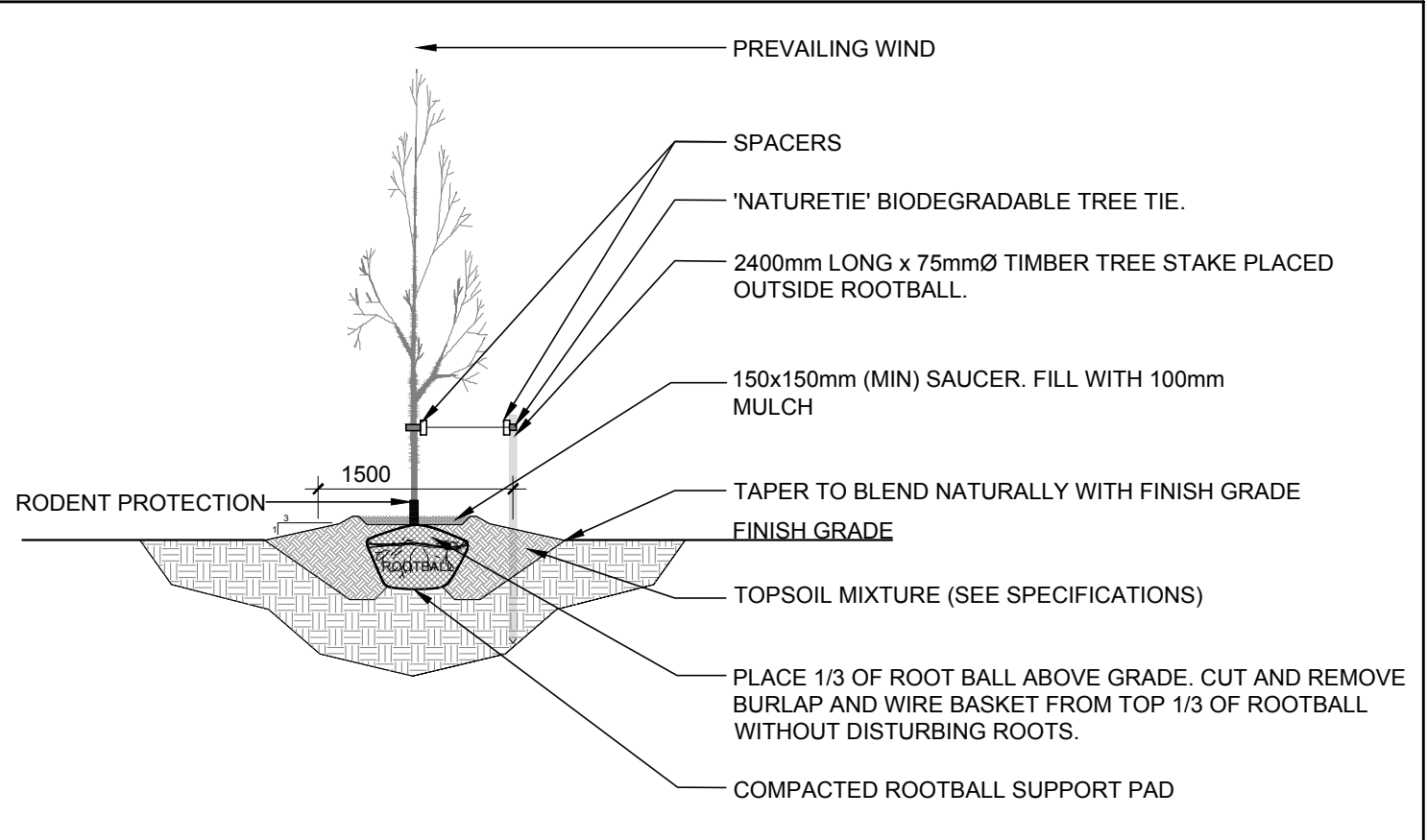

3 DECIDUOUS TREE PLANTING  
SCALE: NTS

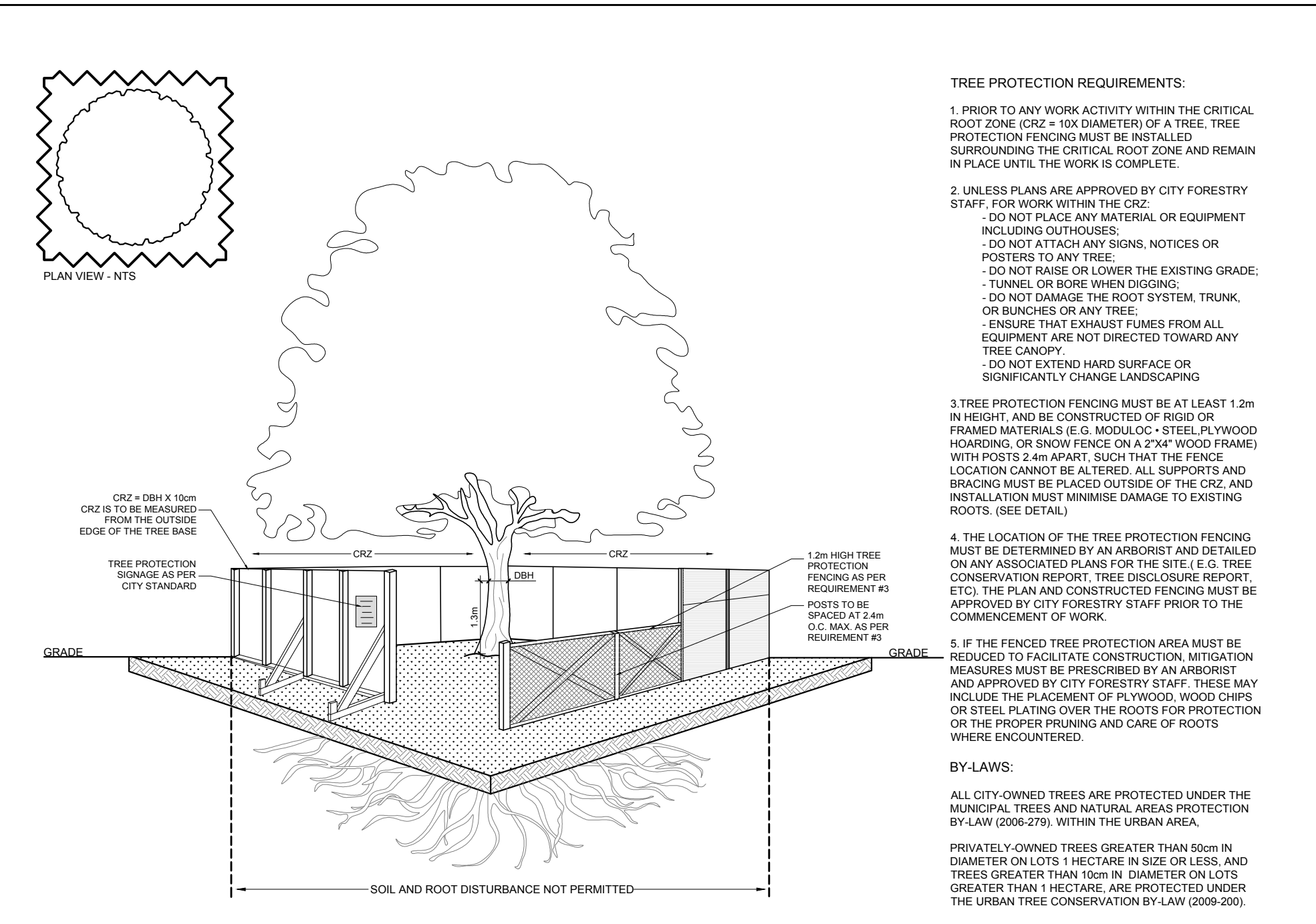

4 TREE PROTECTION FENCE  
SCALE: NTS

**EXISTING TREE LIST**

KEY	QTY.	BOTANICAL NAME	COMMON NAME	SIZE	CONDITION	OWNERSHIP
AN	1	Acer negundo	Manitoba Maple	160mm DBH	GOOD	522 Lower Byron
AP	4	Acer platanoides	Norway Maple	100-400mm DBH	GOOD	522 Lower Byron
JN	1	Juglans nigra	Black Walnut	460mm DBH	GOOD	522 Lower Byron
MM	1	Acer negundo	Manitoba Maple	300mm DBH	GOOD	526 Lower Byron
NM	3	Acer platanoides	Norway Maple	400-550mm DBH	POOR-GOOD	518 Lower Byron
PG	1	Picea glauca	White Spruce	200mm DBH	GOOD	518 Lower Byron

**PROPOSED PLANT LIST**

KEY	QTY.	BOTANICAL NAME	COMMON NAME	SIZE	CONDITION	REMARKS
HB	1	Celtis occidentalis	Hackberry	60mm ø	B&B	
HL	1	Gleditsia triacanthos	Honey Locust	60mm ø	B&B	
JL	1	Syringa reticulata	Japanese Tree Lilac	60mm ø	B&B	Single leader
SB	1	Amelanchier laevis JFS-ARB	Spring Flurry Serviceberry	60mm ø	B&B	
SM	1	Acer saccharum	Sugar Maple	60mm ø	B&B	Single leader

  

SHRUBS						
RR	9	Rosa rugosa	Rugosa Rose	600mm ht.	Potted	1000 mm o.c.
SE	9	Sorbaria sorbifolia 'Sem'	Sem False Spirea	600 mm ht.	Potted	1000mm o.c.

**OWNER INFORMATION**  
 SERCO REALTY INC.  
 9 CAPELLA, CRT.  
 OTTAWA, ONTARIO, K2E 8A7  
 NAME: LOREDANA POCARI  
 PHONE: (613) 226-2221  
 EMAIL: l.pocari@sercorealty.com

**CONSULTANTS**  
 ARCHITECTS:  
**S. J. LAWRENCE ARCHITECT INC.**  
 18 DEAKIN STREET, SUITE 205, NEPEAN, ON K2E 8B7  
 Tel: (613) 739 7770

**CIVIL ENGINEERS:**  
**NOVATECH**  
 Engineers, Planners & Landscape Architects  
 Suite 200, 240 Michael Cowpland Drive  
 Ottawa, Ontario, Canada K2M 1P6  
 Telephone: (613) 254-9643  
 Facsimile: (613) 254-5867  
 Website: www.novatech-eng.com

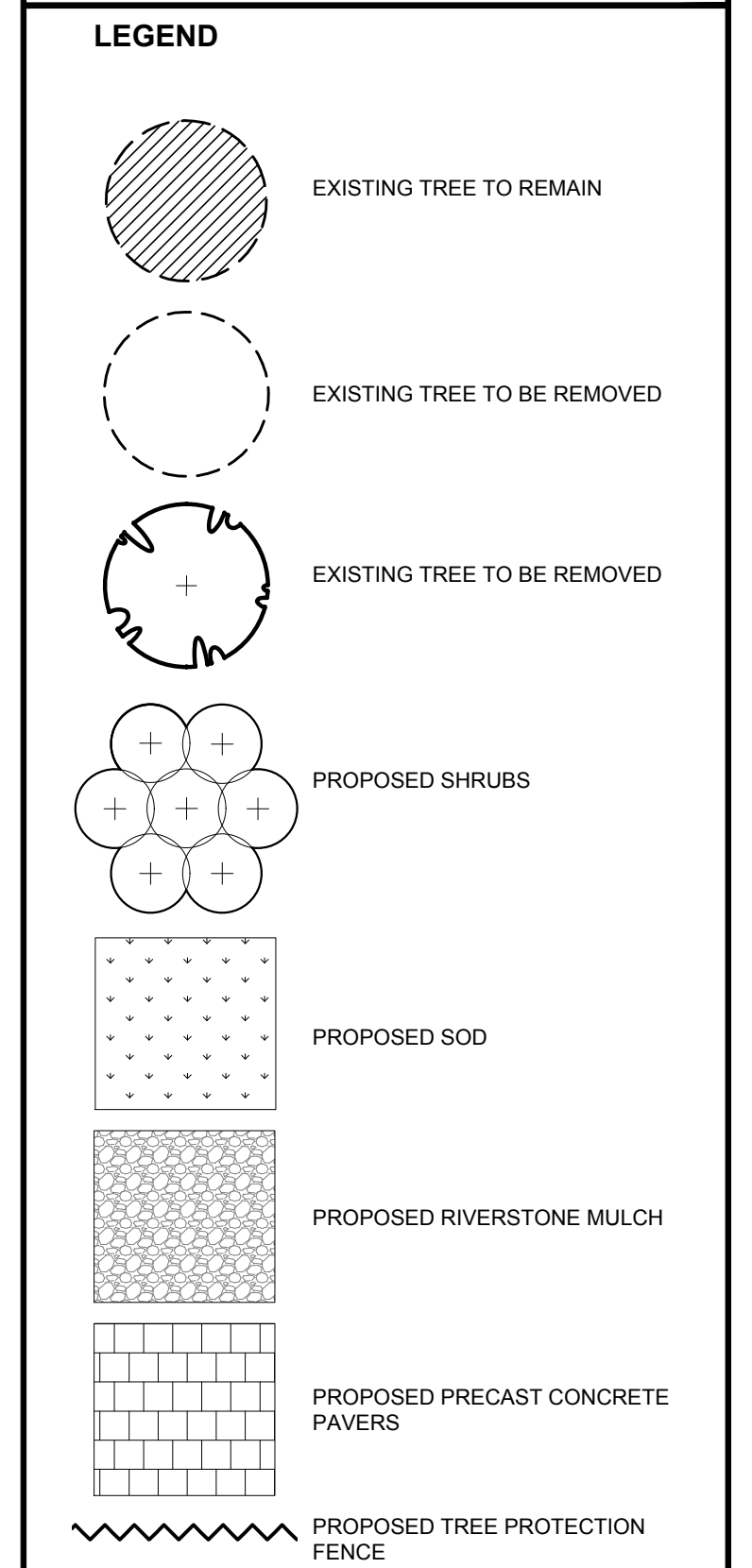

No.	Issue	Date Issued	ML	JL
1	ISSUED FOR DISCUSSION AND REVIEW	06/30/2022		

**JAMES B. LENNOX & ASSOCIATES INC.**  
 LANDSCAPE ARCHITECTS  
 3332 CARLING AVE. OTTAWA, ONTARIO K2H 5A8  
 Tel. (613) 722-5168 Fax. (613) 343-3942

**PROJECT**  
 PROPOSED THREE STOREY APARTMENT BUILDING  
 522 LOWER BYRON AVENUE, OTTAWA ON

**DRAWING**  
 TREE CONSERVATION REPORT & LANDSCAPE PLAN

STAMP	SCALE
	AS SHOWN
	START DATE
	JUNE 2022
	PROJECT NO.

**PROJECT NORTH**

**DRAWING NO.**  
**L.1**  
 PLOT SIZE ARCH-D