

DRAWING LEGEND

- CB CATCH-BASIN
- MH STORM MANHOLE
- MH SANITARY MANHOLE
- OBV OBVERT OF PIPE
- SPL SPRINGLINE OF PIPE
- INV INVERT OF PIPE
- SAN SANITARY SEWER
- ST STORM SEWER
- WS/WM WATER SERVICE/WATERMAIN
- CS CURB STOP & STANDPOST
- ROOF DRAIN
- WATER METER
- REMOTE WATER METER READOUT
- EXISTING GRADE ELEVATION
- PROPOSED GRADE ELEVATION
- EXISTING SLOPE OF GRADE
- PROPOSED SLOPE OF GRADE
- PROPERTY LINE
- CENTERLINE OF SWALE
- INTERLOCK
- LANDSCAPE
- FFL FIRST FLOOR ELEVATION
- TOF TOP OF FOUNDATION
- BFL BASEMENT FLOOR ELEVATION
- USF UNDERSIDE OF FOOTING

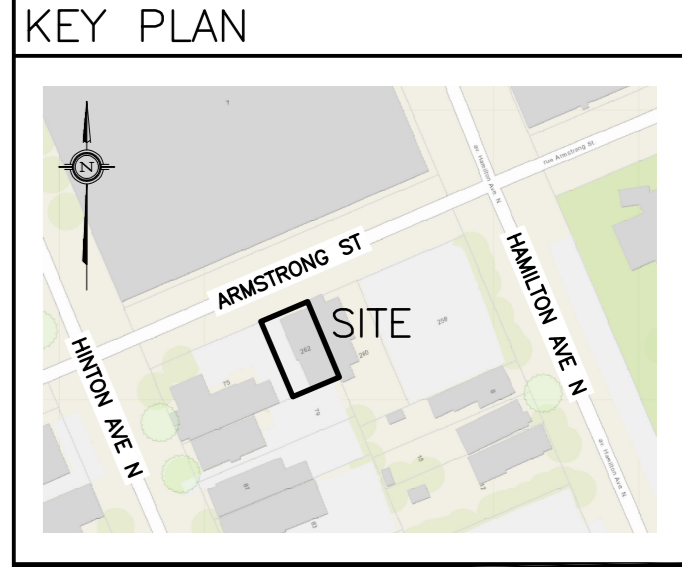
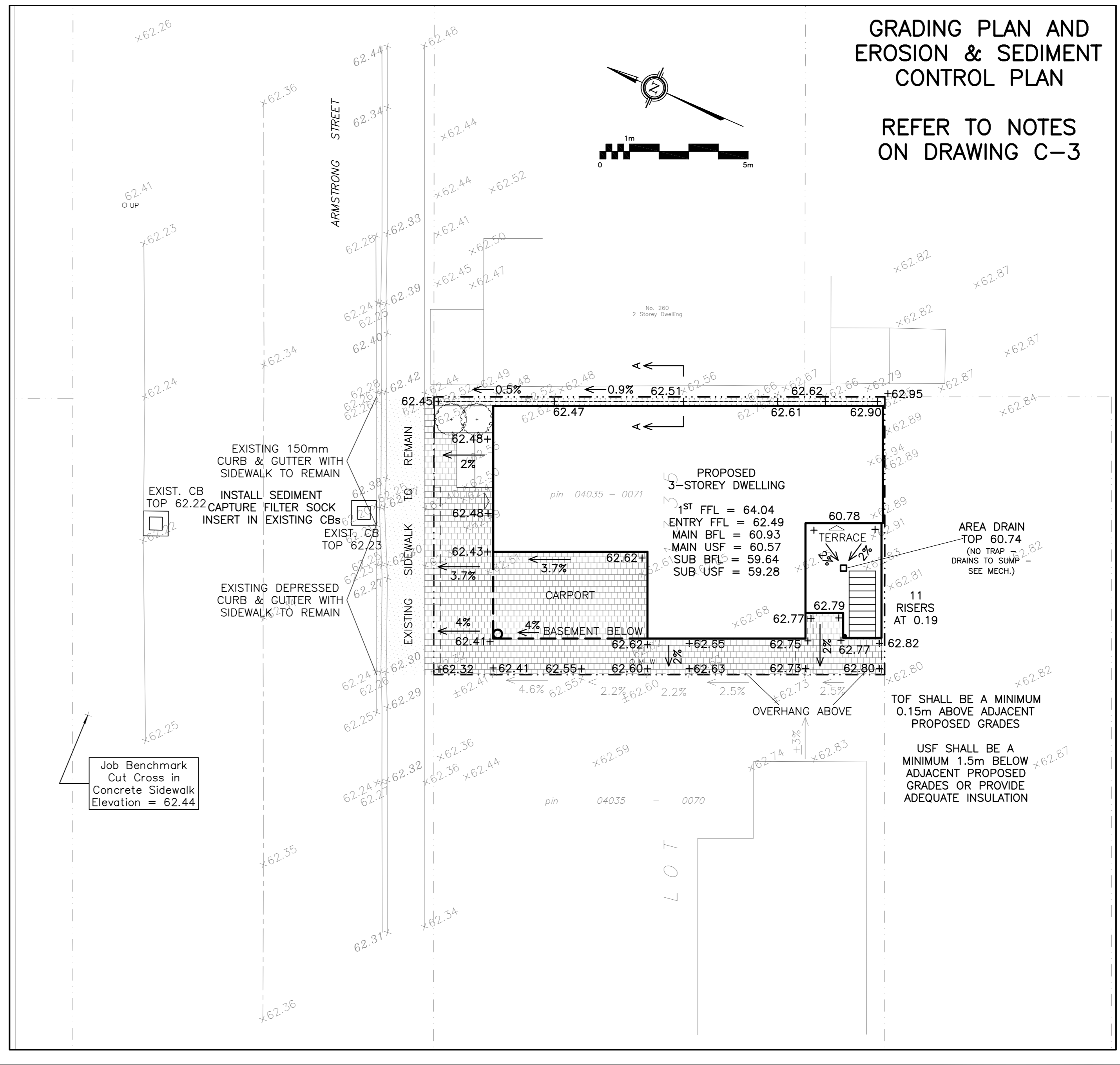
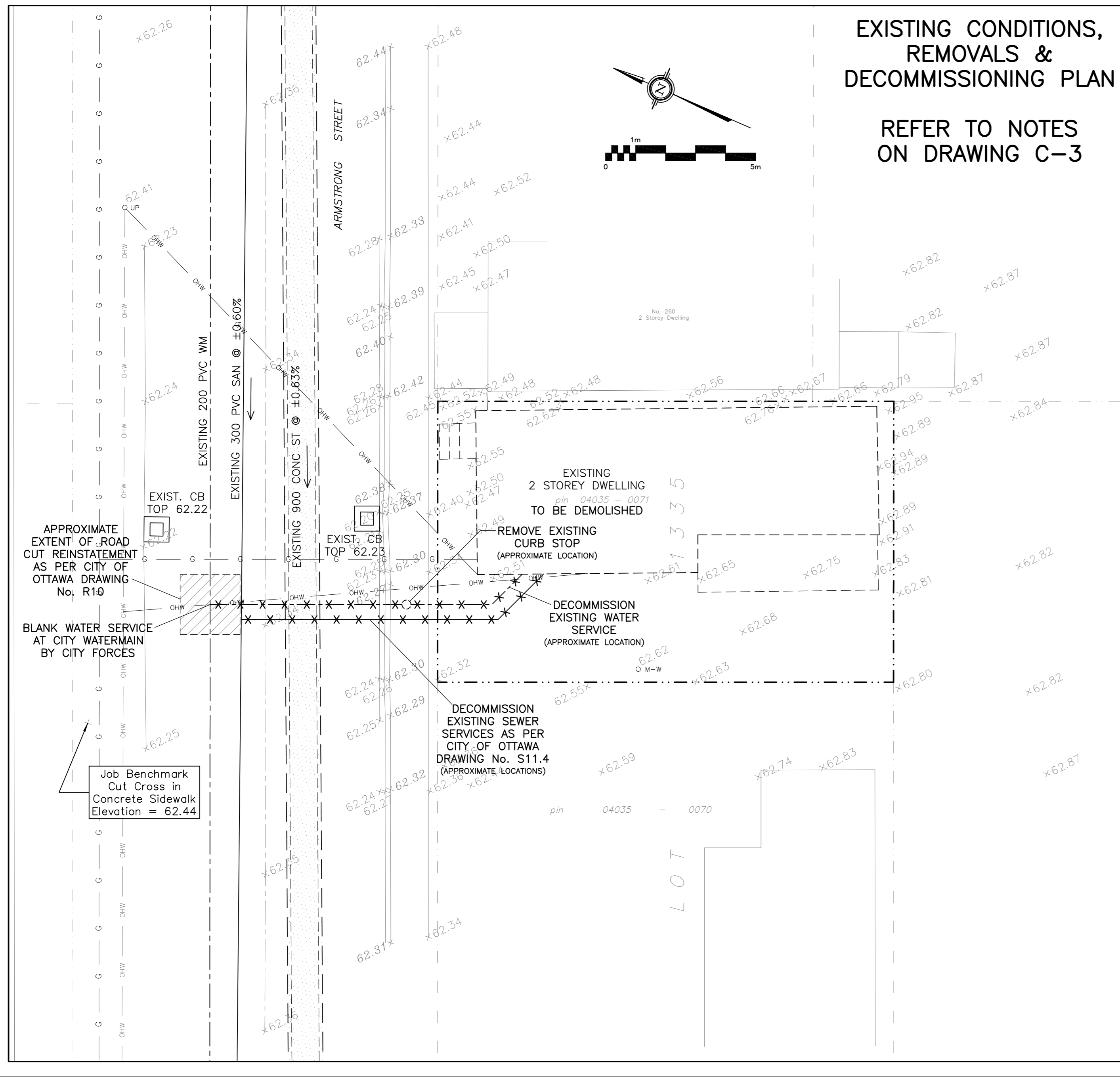

No.	DATE	REVISION
3	FEB 24-22	ISSUED FOR APPROVAL
2	FEB 10-22	ISSUED FOR COORDINATION
1	JUN 8-21	PRELIMINARY

D. B. GRAY ENGINEERING INC.
 Stormwater Management - Grading & Drainage - Storm & Sanitary Sewers - Watermain
 700 Long Point Circle 613-425-8044
 Ottawa, Ontario d.gray@dbgrayengineering.com

Project
PROPOSED 3-STOREY 4-UNIT APARTMENT BUILDING
 262 ARMSTRONG STREET
 OTTAWA, ONTARIO

Drawing Title
EXISTING CONDITIONS, ROOF DRAINAGE PLAN AND GRADING PLAN

Engineer's Seal

 NOT VALID UNLESS SIGNED & DATED

Drawn D.B.G.
 H. Scale 1:100
 V. Scale
 Date JUN 8-21
 Job No. 21037

Drawing No.
C-2 of 3