

**JOINT RESTRAINER DEVICES**

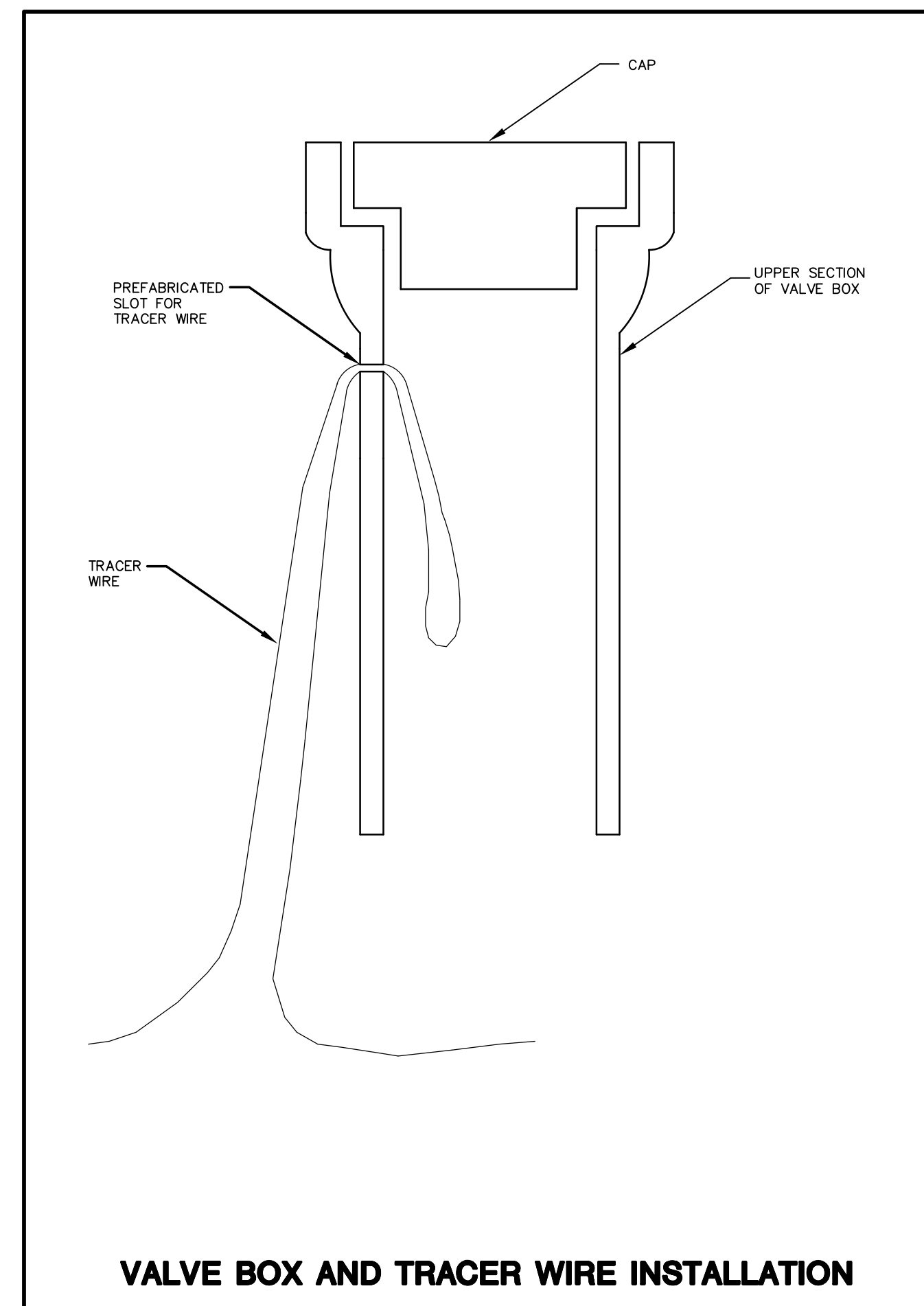

**VALVE BOX AND TRACER WIRE INSTALLATION**

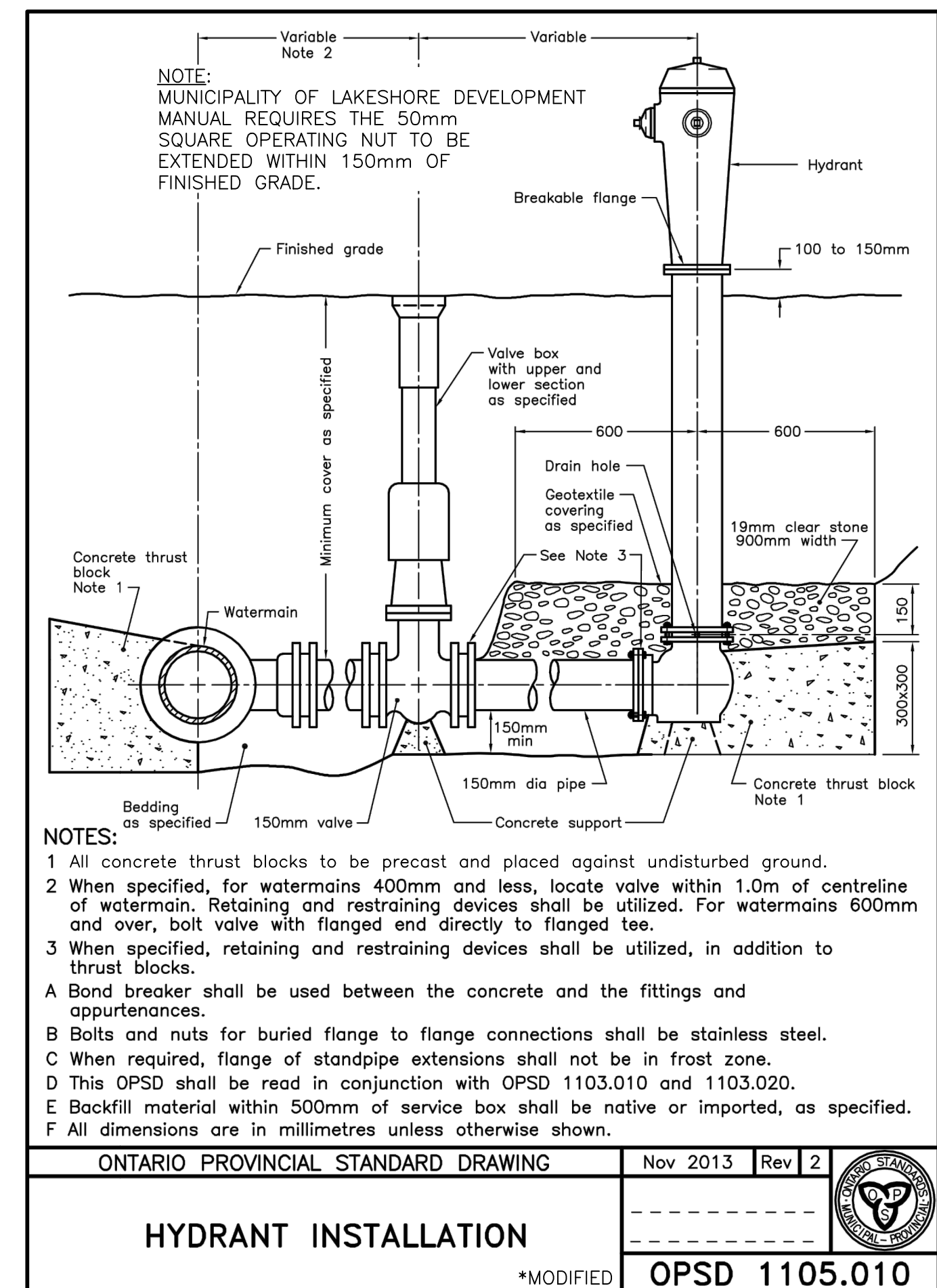

**HYDRANT INSTALLATION**  
 ONTARIO PROVINCIAL STANDARD DRAWING  
 Nov 2013 Rev | 2  
 \*MODIFIED OPSD 1105.010

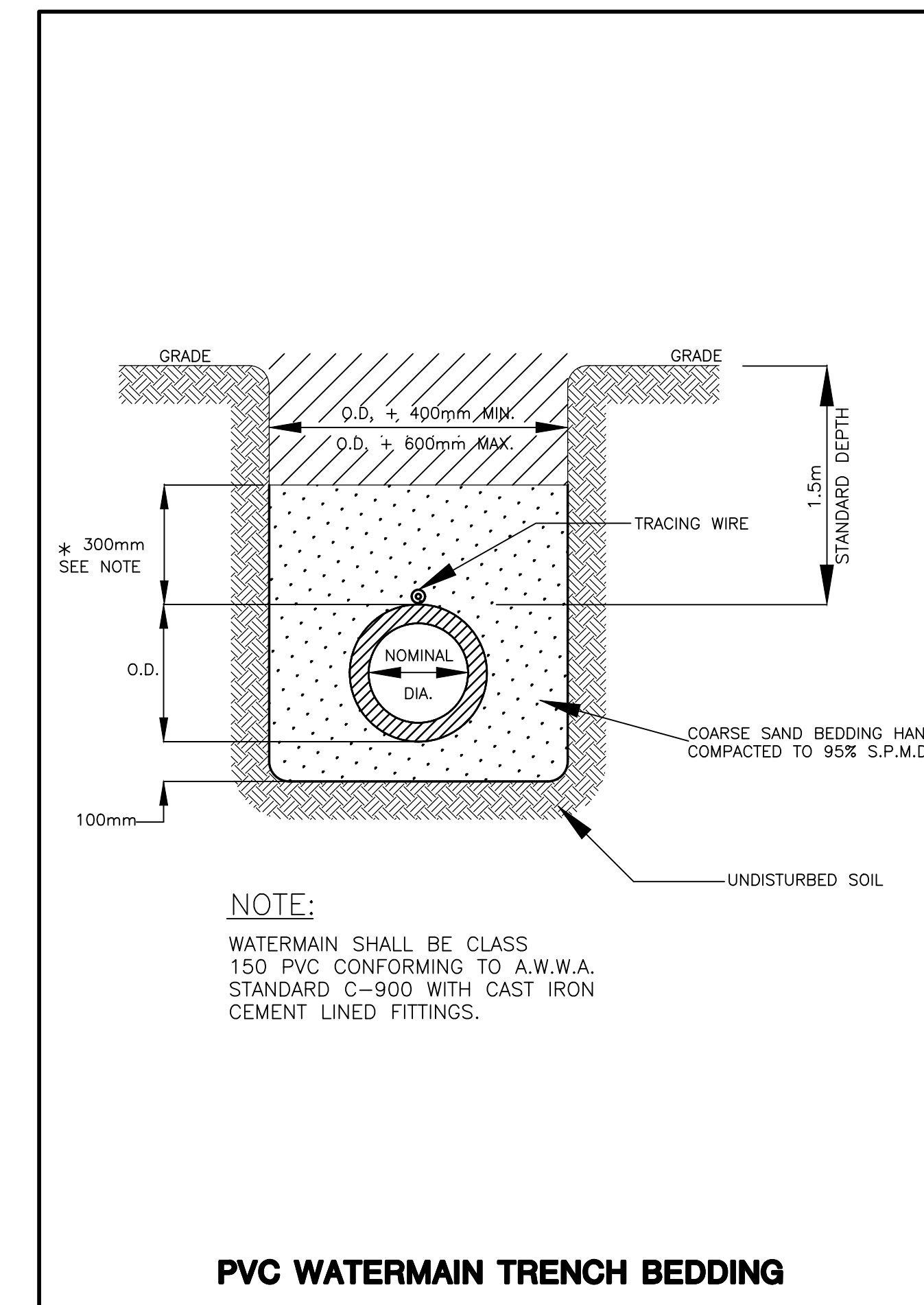

**PVC WATERMAIN TRENCH BEDDING**

**GENERAL NOTES:**

1. THE OWNER AND DILLON CONSULTING LIMITED DO NOT GUARANTEE THE ACCURACY OF THE UTILITIES SHOWN ON THE DRAWINGS. OTHER UTILITIES MAY BE PRESENT OR THE UTILITIES SHOWN MAY DIFFER IN SIZE OR LOCATION FROM THOSE SHOWN. THE CONTRACTOR SHALL NOTE THAT SERVICES FROM THE MAIN LINES ARE NOT SHOWN. THE CONTRACTOR ASSUMES FULL RESPONSIBILITY TO CONTACT THE VARIOUS UTILITY COMPANIES AND TO REPAIR ANY DAMAGE IT MAY CAUSE TO THESE UTILITIES OR TO OTHER THIRD PARTIES. THE CONTRACTOR AGREES TO INDEMNIFY THE OWNER AND DILLON CONSULTING LIMITED AGAINST ANY CLAIMS WHICH MAY ARISE FROM THE CONTRACTOR'S ACTIONS.
2. ALL WORKS SHALL COMPLY WITH THE CITY OF OTTAWA OR OPS STANDARDS.

ALL EXISTING INVERTS TO BE FIELD CHECKED PRIOR TO CONSTRUCTION

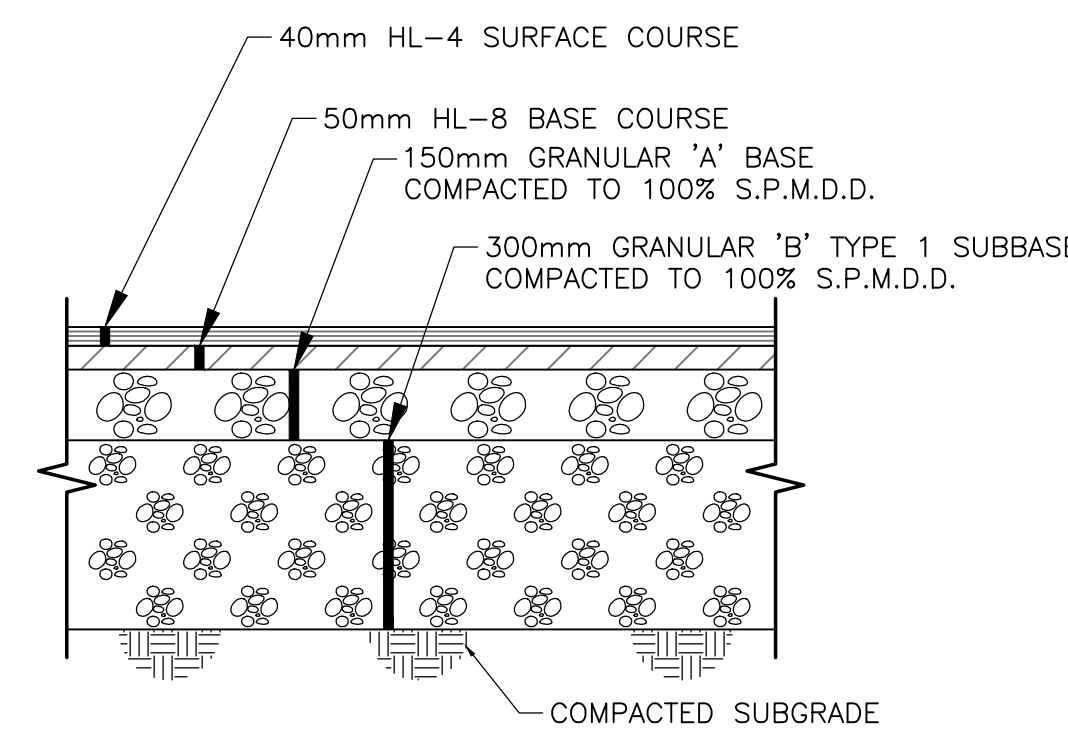

NOTE:  
ASPHALT MIXES TO BE PG 58-34

**LIGHT DUTY ASPHALT PAVEMENT**  
 NOT TO SCALE

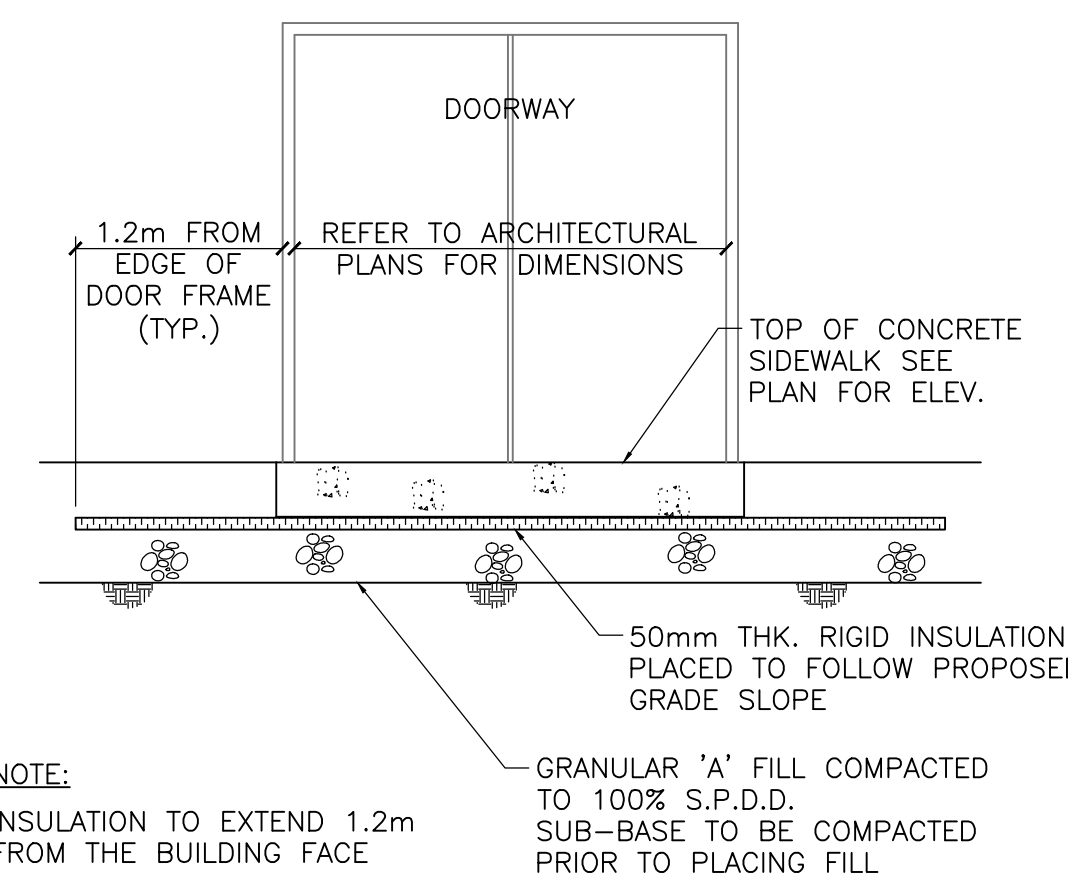

NOTE:  
INSULATION TO EXTEND 1.2m FROM THE BUILDING FACE

**SIDEWALK AT DOORWAY DETAIL**  
 NOT TO SCALE

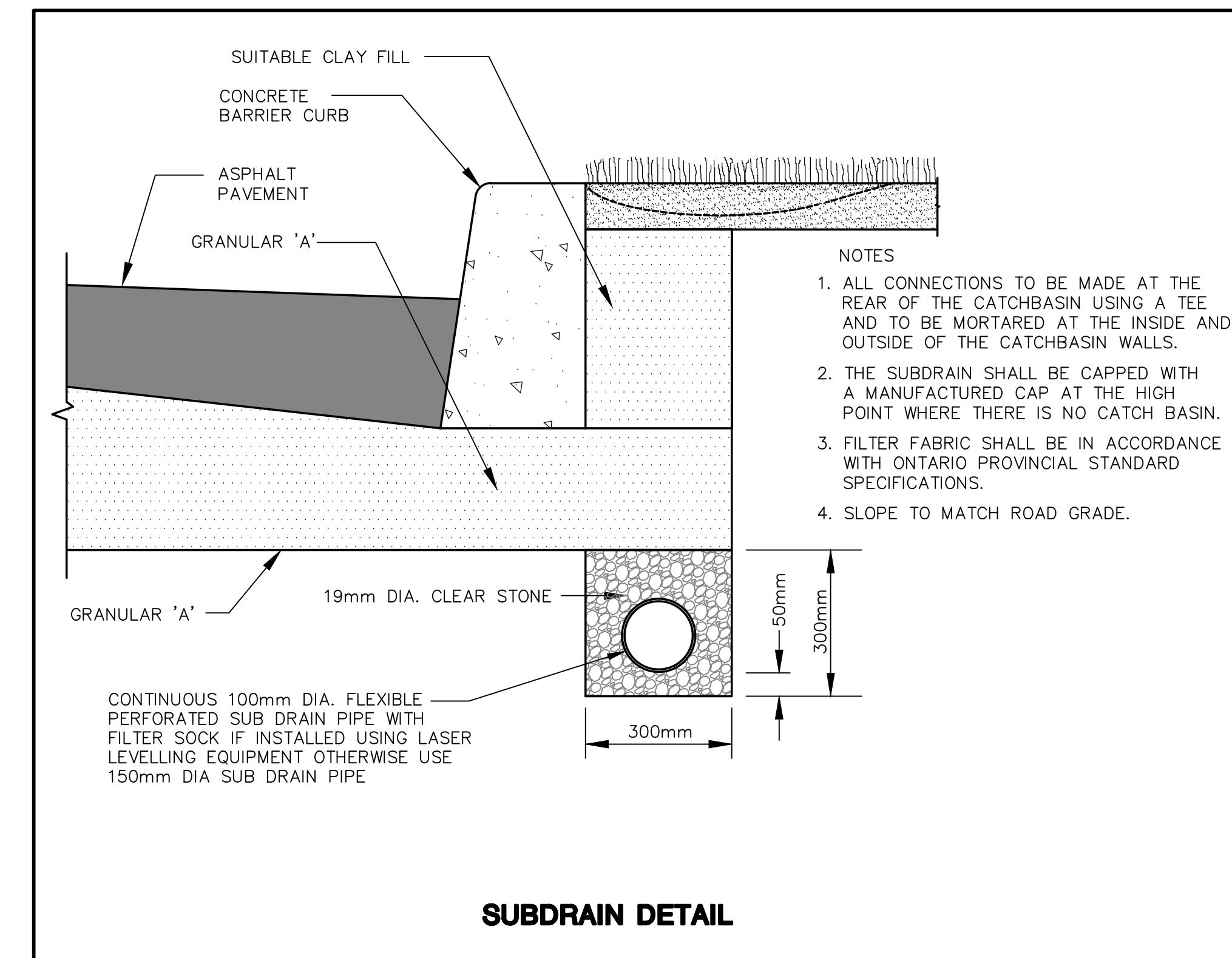

**SUBDRAIN DETAIL**

THE FOLLOWING ONTARIO PROVINCIAL STANDARD DETAILS SHALL APPLY TO THIS CONTRACT

600.040	CONCRETE BARRIER CURB WITH STANDARD GUTTER
600.110	CONCRETE BARRIER CURB
701.010	PRECAST CONCRETE MAINTENANCE HOLE - 1200mm DIAMETER
705.010	PRECAST CONCRETE CATCH BASIN - 600x600mm
708.020	SUPPORT FOR PIPE AT CATCH BASIN OR MAINTENANCE HOLE
708.030	CATCH BASIN CONNECTION FOR FLEXIBLE MAIN PIPE SEWER
802.010	FLEXIBLE PIPE EMBEDMENT AND BACKFILL EARTH EXCAVATION
802.030	RIGID PIPE BEDDING, COVER, AND BACKFILL TYPE 1 OR 2 - EARTH EXCAVATION



**Conditions of Use**  
 Verify elevations and/or dimensions on drawing prior to use. Report any discrepancies to Dillon Consulting Limited.  
 Do not modify drawing, re-use it, or use it for purposes other than those intended at the time of its preparation without prior written permission from Dillon Consulting Limited.

1 12/02/2021 SPA LZBA SUBMISSION CDP  
 # Date: revision: by:

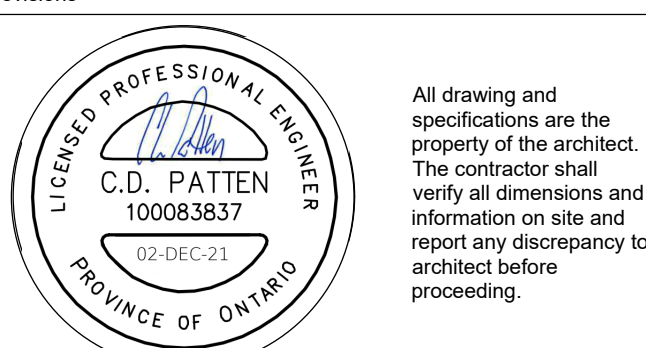

Arch Corp - LTC ORLEANS

FAMILLE LAPORTE AVE  
 OTTAWA, ON

**MISCELLANEOUS DETAILS**

scale: N.T.S.  
 drawn by: DS  
 reviewed by: CDP  
 job number: 21-2647  
 plot date: December 02, 2021  
 drawing number:

**STD**