

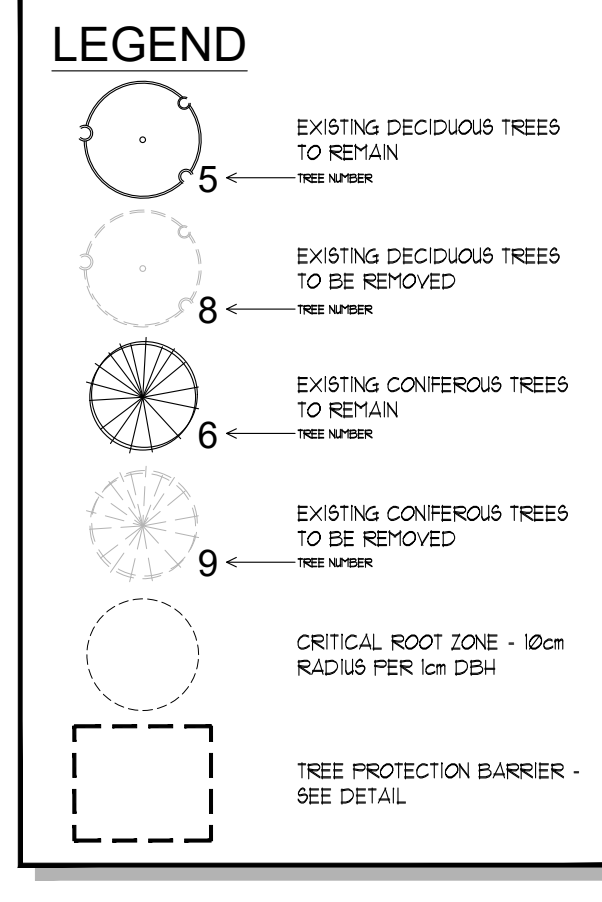

**EXISTING VEGETATION PLAN**  
SCALE = 1:250



REFER TO TREE CONSERVATION REPORT FOR ADDITIONAL INFORMATION AND DETAIL ABOUT THE INVENTORY AND ASSESSMENT PROCESS

**TREES TO BE PRESERVED (35 TOTAL)**

ID#	GENERAL INFORMATION	SIZE	HEALTH & CONDITION	RECOMMENDATIONS	NOTES
1-6	Trees within subject site (6)				
7	Trees within private property adjacent to subject site (7)				
8	Municipal trees (22)				

**TREES TO BE REMOVED (94 TOTAL)**

ID#	GENERAL INFORMATION	SIZE	HEALTH & CONDITION	RECOMMENDATIONS	NOTES
1-10	Trees within subject site (8)				
11-45	Municipal trees (34)				
46-139	Boundary trees (5)				

**TREES WITHIN PRIVATE PROPERTY ADJACENT TO SUBJECT SITE (1)**

ID#	GENERAL INFORMATION	SIZE	HEALTH & CONDITION	RECOMMENDATIONS	NOTES
1	Trees within private property adjacent to subject site (1)				

**MUNICIPAL TREES (22)**

ID#	GENERAL INFORMATION	SIZE	HEALTH & CONDITION	RECOMMENDATIONS	NOTES
1-22	Municipal trees (22)				

**BOUNDARY TREES (5)**

ID#	GENERAL INFORMATION	SIZE	HEALTH & CONDITION	RECOMMENDATIONS	NOTES
1-5	Boundary trees (5)				

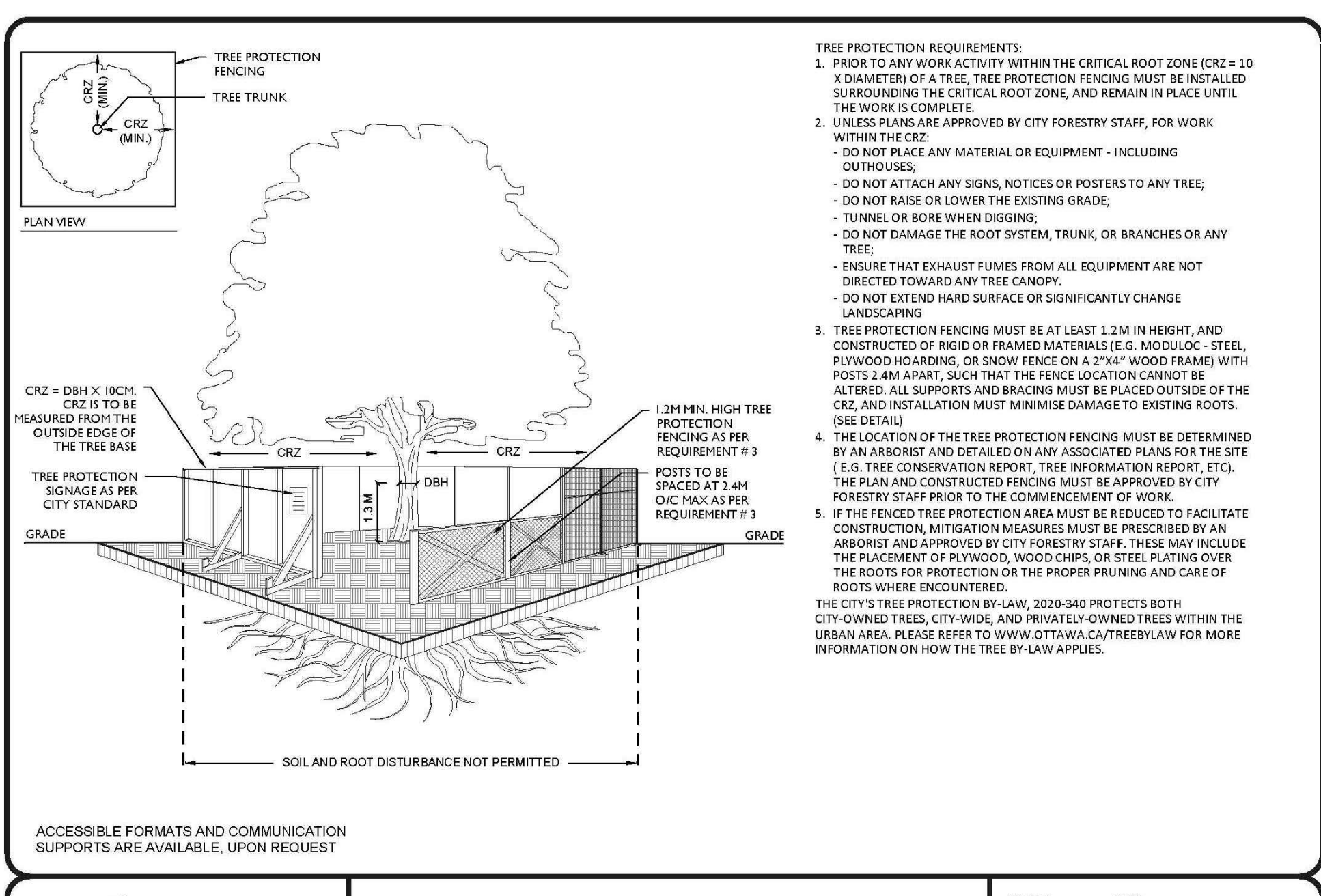

**TREE PROTECTION SPECIFICATION**

ID#	GENERAL INFORMATION	SIZE	HEALTH & CONDITION	RECOMMENDATIONS	NOTES
1-22	Trees to be preserved (22)				

**TREES WITHIN PRIVATE PROPERTY ADJACENT TO SUBJECT SITE (1)**

ID#	GENERAL INFORMATION	SIZE	HEALTH & CONDITION	RECOMMENDATIONS	NOTES
1	Trees within private property adjacent to subject site (1)				

**MUNICIPAL TREES (22)**

ID#	GENERAL INFORMATION	SIZE	HEALTH & CONDITION	RECOMMENDATIONS	NOTES
1-22	Municipal trees (22)				

**BOUNDARY TREES (5)**

ID#	GENERAL INFORMATION	SIZE	HEALTH & CONDITION	RECOMMENDATIONS	NOTES
1-5	Boundary trees (5)				



**PROPOSED DEVELOPMENT & CONSERVED VEGETATION**

SCALE = 1:250

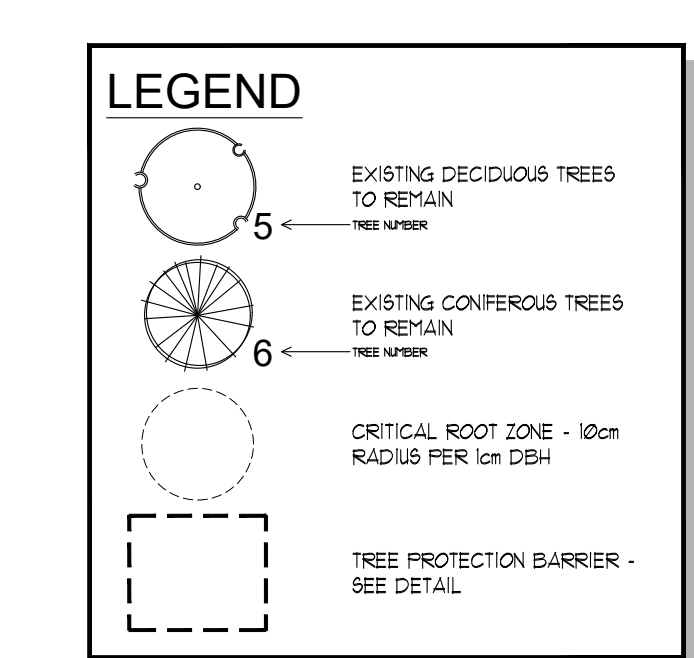

REFER TO TREE CONSERVATION REPORT FOR ADDITIONAL INFORMATION AND DETAIL ABOUT THE INVENTORY AND ASSESSMENT PROCESS

**TREES TO BE PRESERVED (35 TOTAL)**

ID#	GENERAL INFORMATION	SIZE	HEALTH & CONDITION	DIRECTED CONSTRUCTION IMPACT	RECOMMENDATIONS	NOTES
-----	---------------------	------	--------------------	------------------------------	-----------------	-------

**TREES WITHIN SUBJECT SITE (6)**

234	Quercus macrocarpa (Oak)	Subst Site	22	53	5	SW	Tree	Light crown, growing branches, no decay	none	preserve	none
235	Quercus macrocarpa (Oak)	Subst Site	24	4	5	SW	Tree	Light crown, growing branches, no decay	none	preserve	none
236	Quercus macrocarpa (Oak)	Subst Site	22	4	5	SW	Tree	Light crown, no form decay	none	preserve	none
237	Quercus macrocarpa (Oak)	Subst Site	20	53	5	SW	Tree	Light crown, growing branches, no decay	none	preserve	none
238	Quercus macrocarpa (Oak)	Subst Site	22	4	5	SW	Tree	Disrupted crown	none	preserve	none
239	Quercus macrocarpa (Oak)	Subst Site	22	12	1	SW	Tree	Minor dead wood	none	preserve	none

**TREES WITHIN PRIVATE PROPERTY ADJACENT TO SUBJECT SITE (7)**

240	Quercus macrocarpa (Oak)	ST/233 Montreal St	21	1	5	SW	Tree	Mature, some crown loss	None, 20% of critical root zone to be removed	preserve	tree preservation barrier
241	Quercus macrocarpa (Oak)	ST/233 Montreal St	21	1	4	SW	Tree	Small tree	None, 20% of critical root zone to be removed	preserve	tree preservation barrier
242	Quercus macrocarpa (Oak)	ST/233 Montreal St	42	5	5	SW	Tree	Light crown	None, 20% of critical root zone to be removed	preserve	tree preservation barrier
243	Quercus macrocarpa (Oak)	ST/233 Montreal St	42	7	5	SW	Tree	Light crown	None, 20% of critical root zone to be removed	preserve	tree preservation barrier
244	Quercus macrocarpa (Oak)	ST/233 Montreal St	8	1	5	SW	Tree	Disrupted crown	None, 20% of critical root zone to be removed	preserve	tree preservation barrier
245	Quercus macrocarpa (Oak)	ST/233 Montreal St	28	8	5	SW	Tree	Disrupted crown	None, 20% of critical root zone to be removed	preserve	tree preservation barrier
246	Quercus macrocarpa (Oak)	ST/233 Montreal St	22	4	5	SW	Tree	Disrupted crown	None, 20% of critical root zone to be removed	preserve	tree preservation barrier

**MUNICIPAL TREES (22)**

207	Quercus macrocarpa (Oak)	ST/233 Montreal St	5	12	1	SW	Tree	Very tall tree	none	preserve	tree preservation barrier
208	Acer rubrum (Red Maple)	ST/233 Montreal St	7	1	1	SW	Tree	Red maple, dense crown	none	preserve	none
209	Quercus macrocarpa (Oak)	ST/233 Montreal St	6	1	4	SW	Tree	Red maple, dense crown	none	preserve	none
210	Quercus macrocarpa (Oak)	ST/233 Montreal St	8	1	5	SW	Tree	Red maple, dense crown	none	preserve	none
211	Acer rubrum (Red Maple)	ST/233 Montreal St	1	12	5	SW	Tree	Red maple, dense crown	none	preserve	none
212	Quercus macrocarpa (Oak)	ST/233 Montreal St	1	12	5	SW	Tree	Red maple, dense crown	none	preserve	none
213	Acer rubrum (Red Maple)	ST/233 Montreal St	9	12	5	SW	Tree	Red maple, dense crown	none	preserve	none
214	Acer rubrum (Red Maple)	ST/233 Montreal St	4	12	5	SW	Tree	Red maple, dense crown	none	preserve	none
215	Acer rubrum (Red Maple)	ST/233 Montreal St	4	12	5	SW	Tree	Red maple, dense crown	none	preserve	none
216	Acer rubrum (Red Maple)	ST/233 Montreal St	9	12	5	SW	Tree	Red maple, dense crown	none	preserve	none
217	Acer rubrum (Red Maple)	ST/233 Montreal St	4	12	5	SW	Tree	Red maple, dense crown	none	preserve	none
218	Acer rubrum (Red Maple)	ST/233 Montreal St	9	12	5	SW	Tree	Red maple, dense crown	none	preserve	none
219	Acer rubrum (Red Maple)	ST/233 Montreal St	1	12	5	SW	Tree	Red maple, dense crown	none	preserve	none
220	Quercus macrocarpa (Oak)	ST/233 Montreal St	5	12	5	SW	Tree	Red maple, dense crown	none	preserve	none
221	Quercus macrocarpa (Oak)	ST/233 Montreal St	8	12	5	SW	Tree	Red maple, dense crown	none	preserve	none
222	Quercus macrocarpa (Oak)	ST/233 Montreal St	6	12	5	SW	Tree	Red maple, dense crown	none	preserve	none
223	Quercus macrocarpa (Oak)	ST/233 Montreal St	6	12	5	SW	Tree	Red maple, dense crown	none	preserve	none
224	Quercus macrocarpa (Oak)	ST/233 Montreal St	7	1	1	SW	Tree	Red maple, dense crown	none	preserve	none
225	Quercus macrocarpa (Oak)	ST/233 Montreal St	1	12	5	SW	Tree	Red maple, dense crown	none	preserve	none
226	Quercus macrocarpa (Oak)	ST/233 Montreal St	9	12	5	SW	Tree	Red maple, dense crown	none	preserve	none
227	Acer rubrum (Red Maple)	ST/233 Montreal St	9	12	5	SW	Tree	Red maple, dense crown	none	preserve	none
228	Quercus macrocarpa (Oak)	ST/233 Montreal St	7	12	5	SW	Tree	Red maple, dense crown	none	preserve	none
229	Quercus macrocarpa (Oak)	ST/233 Montreal St	8	12	5	SW	Tree	Red maple, dense crown	none	preserve	none
230	Acer rubrum (Red Maple)	ST/233 Montreal St	8	2	5	SW	Tree	Red maple, dense crown	none	preserve	none
231	Quercus macrocarpa (Oak)	ST/233 Montreal St	7	2	5	SW	Tree	Red maple, dense crown	none	preserve	none
232	Acer rubrum (Red Maple)	ST/233 Montreal St	7	1	1	SW	Tree	Red maple, dense crown	none	preserve	none

**TREES TO BE PRESERVED (35 TOTAL)**

**PRE-CONSTRUCTION RECOMMENDATIONS**

- a) PRIOR TO ANY CONSTRUCTION ACTIVITY, TREE PRESERVATION FENCING IS TO BE INSTALLED AS PER THE ATTACHED TREE PRESERVATION DRAWINGS AND DETAIL.
  - b) WHERE HIGH QUALITY SPECIMENS TO BE PRESERVED ARE ADJACENT TO AREAS SUBJECT TO INTENSIVE CONSTRUCTION ACTIVITIES, THESE TREES ARE TO HAVE ADDITIONAL PROTECTION MEASURES IMPLEMENTED TO PROTECT THEIR TRUNKS FROM MECHANICAL DAMAGE. THESE MEASURES MAY INCLUDE SURROUNDING THE TRUNK WITH WOOD PLANKS. TREES THAT REQUIRE ADDITIONAL PROTECTION WILL BE CLEARLY IDENTIFIED ON THE TREE PRESERVATION PLAN WITH DETAILED INFORMATION ON SPECIFIC PROTECTION MEASURES.
  - c) TREES APPROVED FOR REMOVAL ARE TO BE CLEARLY INDICATED IN THE FIELD (MARKED WITH SPRAY PAINT OR OTHER AGREED UPON METHOD) BY THE PROJECT ARBORIST OR LANDSCAPE ARCHITECT PRIOR TO ANY TREE REMOVAL OPERATIONS. ALL REMOVALS TO BE UNDERTAKEN BY AN ISA CERTIFIED ARBORIST.
  - d) IN ACCORDANCE WITH THE MIGRATORY BIRDS CONVENTION ACT 1994, ALL REMOVALS MUST TAKE PLACE BETWEEN SEPTEMBER 1ST AND MARCH 31ST TO AVOID DISTURBING NESTING MIGRATORY BIRDS. IF TREE REMOVAL OCCURS BETWEEN APRIL 1ST AND AUGUST 31ST, A BIOLOGIST IS REQUIRED TO COMPLETE A SEARCH FOR NESTS. ONCE CLEARED, THE CONTRACTOR HAS 48 HOURS TO REMOVE. IF REMOVAL DOES NOT OCCUR WITHIN 48 HOURS, ANOTHER SEARCH WILL BE REQUIRED.
  - e) CARE SHOULD BE TAKEN DURING THE FELLING OPERATION TO AVOID DAMAGING THE BRANCHES, STEMS, TRUNKS, AND ROOTS OF NEARBY TREES TO BE PRESERVED. WHERE POSSIBLE, ALL TREES ARE TO BE FELLED TOWARDS THE CONSTRUCTION ZONE TO MINIMIZE IMPACTS ON ADJACENT VEGETATION. ALL REMOVALS TO BE UNDERTAKEN BY AN ISA CERTIFIED ARBORIST.
  - f) IT IS RECOMMENDED THAT THE EXISTING GROUND-LAYER VEGETATION AT THE BASE OF TREES TO BE PRESERVED REMAIN INTACT WITHIN THE CRITICAL ROOT ZONE SO AS NOT TO DISTURB THE SOIL AROUND THE BASE OF THE EXISTING TREES.
- g) FINAL SITE GRADING PLANS SHOULD ENSURE THAT THE EXISTING SOIL MOISTURE CONDITIONS ARE MAINTAINED.

**RECOMMENDATIONS RELATED TO THE CONSTRUCTION PROCESS**

- a) TREE PRESERVATION FENCING IS TO BE MAINTAINED IN GOOD CONDITION AND EFFECTIVE FOR THE DURATION OF CONSTRUCTION UNTIL ALL CONSTRUCTION ACTIVITY IS COMPLETE OR AS PER THE PROJECT ARBORIST OR LANDSCAPE ARCHITECT.
- b) NO CONSTRUCTION EXCAVATION, ADDING OF FILL, STOCKPILING OF CONSTRUCTION MATERIAL, OR HEAVY EQUIPMENT IS PERMITTED WITHIN THE CRITICAL ROOT ZONE WITHIN THE TREE PRESERVATION FENCING.
- c) WHEN EXCAVATION NEAR A TREE IS REQUIRED, AND IT IS ANTICIPATED THAT ROOTS WILL BE SEVERED AND EXPOSED, DURATION OF EXPOSURE IS TO BE MINIMIZED TO PREVENT ROOT DESICCATION.
- d) DURING THE EXCAVATION PROCESS, ROOTS 15MM OR LARGER THAT ARE SEVERED AND EXPOSED SHOULD BE HAND PRUNED TO LEAVE A CLEAN-CUT SURFACE TO BE UNDERTAKEN BY AN ISA CERTIFIED ARBORIST. EXPOSED SEVERED ROOTS THAT CANNOT BE COVERED IN SOIL ON THE SAME DAY AS THE CUTS ARE MADE ARE TO BE KEPT MOIST. EXPOSED ROOTS ARE TO BE KEPT MOIST BY COVERING THEM WITH WATER SOAKED BURLAP OR ANY OTHER MEANS AVAILABLE TO PREVENT THEM FROM DRYING OUT.
- e) AVOID IDLING HEAVY EQUIPMENT UNDER/WITHIN CLOSE PROXIMITY TO TREES TO BE PRESERVED TO PREVENT CANOPY DAMAGE FROM EXPOSURE TO EXHAUST HEAT.

**POST-CONSTRUCTION RECOMMENDATIONS**

- a) AVOID DISCHARGING RAIN WATER LEADERS ADJACENT TO RETAINED TREES, AS THIS MAY RESULT IN AN OVERLY MOIST ENVIRONMENT WHICH CAN CAUSE ROOT ROT.
- b) AFTER ALL WORK IS COMPLETED, TREE PRESERVATION FENCES AND ANY OTHER IMPACT MITIGATION PARAPHERNALIA MUST BE REMOVED.
- c) A FINAL REVIEW MUST BE UNDERTAKEN BY THE PROJECT ARBORIST TO ENSURE THAT ALL MITIGATION MEASURES AS DESCRIBED ABOVE HAVE BEEN MET.

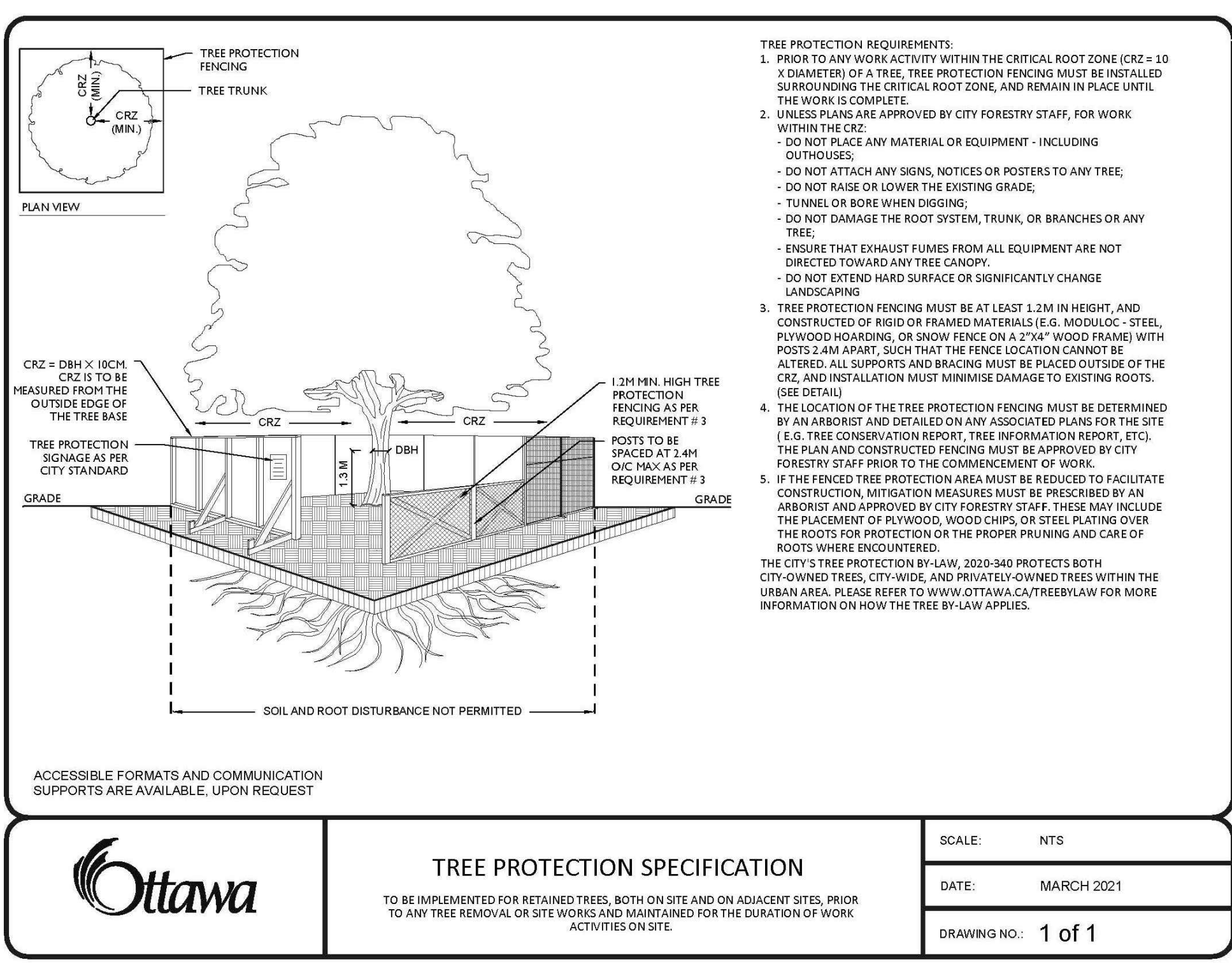

SCALE: NTS

DATE: MARCH 2021

DRAWING NO: 1 OF 1

1	DEC 13/2021	ISSUED FOR S&A & CORNING BY LAW AMENDMENT	MCB
2	NOV 19/2021	ISSUED FOR 100% GP	MCB
3	NOV 19/2021	ISSUED FOR 50% GP	MCB
4	OCT 22/2021	ISSUED FOR 50% GP	MCB
5	AUG 26/2021	ISSUED FOR 100% GP	MCB
6			NTS

ARCH CORP LTC ORLEANS

**TREE PRESERVATION PLAN**

scale: AS NOTED

drawn by: MCB

checked by: MCB

job number: 21-1004

plot date: 2021-11-30

drawing number: T-2

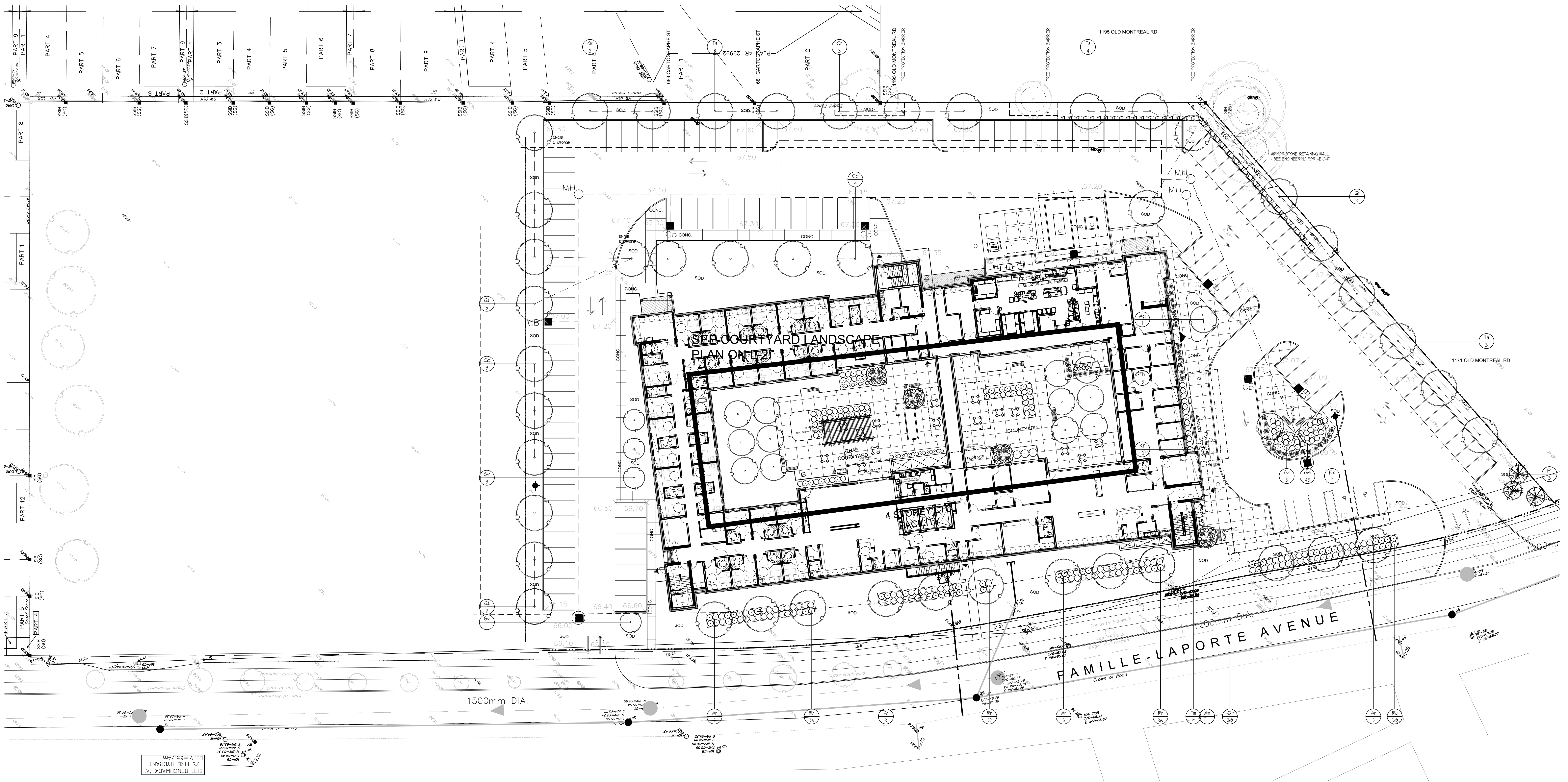

OVERALL LANDSCAPE PLAN  
SCALE = 1:250

KEY	COMMON NAME	BOTANICAL NAME	QTY	SIZE	COND
AG	ATLANTIC MAPLE	<i>Acer glabrum</i> (Mill.) Steud.	1	40cm	UB
AM	HILL CLUSTER BERRY	<i>Alexandria spinosa</i> Nutt. & Steud.	1	50cm	POF
AR	RED MAPLE	<i>Acer rubrum</i> L.	0	40cm	UB
BA	GREEN YELT BIRCH	<i>Betula x colorata</i>	0	10cm	POF
CO	HICKBERRY TREE	<i>Carya occidentalis</i>	1	40cm	UB
DI	FRAXINUS TRE	<i>Fraxinus nigra</i> Mill.	20	10cm	POF
GA	ROZANE GERANIUM	<i>Geranium Rozanne</i>	43	10cm	POF
GI	HAZELBERRY LOGAN	<i>Geobotrya racemosa</i> 'Brookmeyer'	1	40cm	UB
KF	KARL ROESTER REED GRASS	<i>Calamagrostis australis</i> Karl Foerster	3	10cm	POF
PI	SAINT SPURGE	<i>Picea canadensis</i>	3	10cm	UB
QF	RED OAK	<i>Quercus rubra</i>	8	40cm	UB
RI	ALPINE CORAL	<i>Rosa alba</i>	3	10cm	UB
RI	BURNO ROSE	<i>Rosa rugosa</i>	104	40cm	POF
SI	HORN BEECH LILAC	<i>Syringa reticulata</i>	1	10cm	POF
TA	BLANCO	<i>Tilia amplexicaulis</i>	1	40cm	UB
TH	HICKS YEW	<i>Taxus x media</i> 'Hicksii'	3	40cm	POF
TR	CHINESE YEW	<i>Taxus x media</i> 'Chinensis'	4	40cm	POF

**LEGEND**

- PROPOSED DECIDUOUS TREES
- PROPOSED CONIFEROUS TREES
- PROPOSED PLANTINGS
- PLANT KEYS - SEE PLANT MATERIALS LIST
- PROPOSED CONCRETE PAVING
- PROPOSED CONCRETE PAVING SURF. PATTERN
- SEEDING - SEE NOTES
- PROPOSED RAISED PLANTER SEE DETAIL
- PROPOSED BENCH SEE DETAIL
- PROPOSED TRASH RECEPTACLE SEE DETAIL
- PROPOSED BIKE RACK SEE DETAIL
- PROPOSED FIRE HYDRANT LOCATION
- PROPOSED LIGHTING SEE ELECTRICAL PLAN
- EXISTING DECIDUOUS TREES TO RETAIN
- CRITICAL ROOT ZONE - 10cm RADIUS PER 1cm DBH

1.	DEC.18.2021	ISSUED FOR SPA & CONING BY LAW AMENDMENT	MCB
2.	NOV.19.2021	ISSUED FOR 100% CD	MCB
3.	NOV.19.2021	ISSUED FOR 20% PA	MCB
4.	OCT.22.2021	ISSUED FOR 50% CD	MCB
5.	AUG.26.2021	ISSUED FOR 100% SP	MCB

ARCH CORP LTC ORLEANS

AVENUE DES FAMILLES  
ORLEANS, ON

LANDSCAPE PLAN

scale:	AS NOTED
drawn by:	MCB
checked by:	MCB
job number:	21-1004
plot date:	2021.11.30
drawing number:	L-1

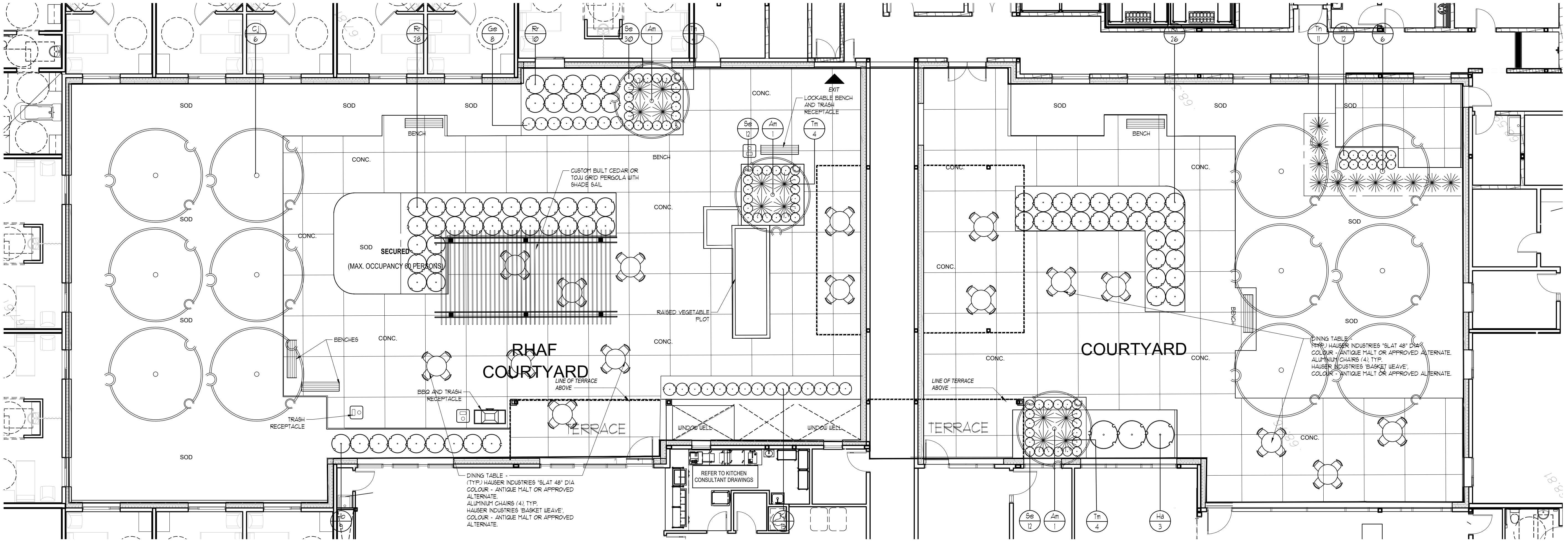

**GENERAL PLANTING SPECIFICATIONS:**

- BASE INFORMATION SUPPLIED BY HANSEN GROUP ARCHITECTS INC.
- CONTRACTOR TO VERIFY ALL INFORMATION AND SPECIFICATIONS.
- CONTRACTOR TO MAINTAIN ALL PLANTING AREAS UNTIL ACCEPTANCE OF PROJECT COMPLETION TO NOTIFY LANDSCAPE ARCHITECT IN WRITING.
- CONTRACTOR TO REPORT ALL DISCREPANCIES TO THE LANDSCAPE ARCHITECT DURING TENDERING PROCESS ERRORS AND/OR OMISSIONS WILL BE THE RESPONSIBILITY OF THE CONTRACTOR.
- CONTRACTOR TO MAINTAIN ALL PLANTING AREAS UNTIL ACCEPTANCE OF PROJECT COMPLETION TO NOTIFY LANDSCAPE ARCHITECT IN WRITING.
- CONTRACTOR TO REPORT ALL DISCREPANCIES TO THE LANDSCAPE ARCHITECT DURING TENDERING PROCESS ERRORS AND/OR OMISSIONS WILL BE THE RESPONSIBILITY OF THE CONTRACTOR.
- CONTRACTOR TO MAINTAIN ALL PLANTING AREAS UNTIL ACCEPTANCE OF PROJECT COMPLETION TO NOTIFY LANDSCAPE ARCHITECT IN WRITING.
- CONTRACTOR TO REPORT ALL DISCREPANCIES TO THE LANDSCAPE ARCHITECT DURING TENDERING PROCESS ERRORS AND/OR OMISSIONS WILL BE THE RESPONSIBILITY OF THE CONTRACTOR.
- CONTRACTOR TO MAINTAIN ALL PLANTING AREAS UNTIL ACCEPTANCE OF PROJECT COMPLETION TO NOTIFY LANDSCAPE ARCHITECT IN WRITING.
- CONTRACTOR TO REPORT ALL DISCREPANCIES TO THE LANDSCAPE ARCHITECT DURING TENDERING PROCESS ERRORS AND/OR OMISSIONS WILL BE THE RESPONSIBILITY OF THE CONTRACTOR.

**LEGEND**

	PROPOSED DECIDUOUS TREES
	PROPOSED CONIFEROUS TREES
	PROPOSED PLANTINGS
	PLANT KEY'S - SEE PLANT MATERIALS LIST
	PROPOSED CONCRETE PAVING
	PROPOSED CONCRETE PAVING SUN PATTERN
	BEDDINGS - SEE NOTES
	PROPOSED RAISED PLANTER SEE DETAIL
	PROPOSED BENCH SEE DETAIL
	PROPOSED TRASH RECEPTACLE SEE DETAIL
	PROPOSED BIKE RACK SEE DETAIL
	PROPOSED FIRE HYDRANT LOCATION
	PROPOSED LIGHTING SEE ELECTRICAL PLAN

**RON KOUDYS LANDSCAPE ARCHITECTS**

ALL DRAWINGS REMAIN THE PROPERTY OF THE LANDSCAPE ARCHITECT AND SHALL NOT BE REPRODUCED OR REUSED WITHOUT THE LANDSCAPE ARCHITECT'S WRITTEN PERMISSION.

THIS DRAWING SHALL NOT BE USED FOR CONSTRUCTION OR TENDER PURPOSES UNLESS SIGNED AND DATED BY RONALD H. KOUDYS, O.A.L.C.S.L.A. LANDSCAPE ARCHITECT.

Ronald H. Kouody, O.A.L.C.S.L.A. DATE



**COURTYARD LANDSCAPE PLAN**  
SCALE = 1:100

**PLANT MATERIAL**

KEY	COMMON NAME	BOTANICAL NAME	QTY	SIZE	COND.
JA	MILK-THIMBLE BERRY/CENTURY	Aster sp.	3	100cm	POT
G1	KATSURBA TREE	Castanopsis japonica	0	46cm tall	ARB
F1	PERSEA NUT	Hemlock	2	70cm tall	POT
GR	KOZANE GERANIUM	Geranium Rosmarinum	8	70cm tall	POT
JL	JANISSELE HEDERA	Hedera Helix	10	70cm tall	POT
HB	PRALAGE PURPLE CORAL BELL	Hesperis matronalis Purple	3	70cm tall	POT
K7	KARE ROSEBUD REED GRASS	Carex sp.	6	70cm tall	POT
R9	RAISED ROSE	Rosa sp.	4	80cm	POT
BE	AUTUMN ZOT SEDUM	Sedum spectabile	14	70cm tall	POT
T9	HORN TREE	Taxus canadensis	1	80cm	POT
TE	DEMBE TREE	Taxus media	0	40cm	POT

**DECIDUOUS TREE PLANTING DETAIL - N.T.S.**

NEVER CUT A LEADER AND TREE WITH DEAD OR DAMAGED BRANCHES WILL NOT BE ACCEPTED.

CALIPER TREES AS PER PLANT MATERIAL LIST.

TRAVERSE AND/OR APPROVED ALTERNATE SHALL BE SECURED TIGHTLY TO STAKE BUT LOCATED AT LEAST 100mm FROM TRUNK.

TRAVERSE AND/OR APPROVED ALTERNATE SHALL BE SECURED TIGHTLY TO STAKE BUT LOCATED AT LEAST 100mm FROM TRUNK.

TRAVERSE AND/OR APPROVED ALTERNATE SHALL BE SECURED TIGHTLY TO STAKE BUT LOCATED AT LEAST 100mm FROM TRUNK.

**CONIFEROUS TREE PLANTING DETAIL - N.T.S.**

NEVER CUT A LEADER AND TREE WITH DEAD OR DAMAGED BRANCHES WILL NOT BE ACCEPTED.

TRAVERSE AND/OR APPROVED ALTERNATE SHALL BE SECURED TIGHTLY TO STAKE BUT LOCATED AT LEAST 100mm FROM TRUNK.

TRAVERSE AND/OR APPROVED ALTERNATE SHALL BE SECURED TIGHTLY TO STAKE BUT LOCATED AT LEAST 100mm FROM TRUNK.

TRAVERSE AND/OR APPROVED ALTERNATE SHALL BE SECURED TIGHTLY TO STAKE BUT LOCATED AT LEAST 100mm FROM TRUNK.

**SHRUB PLANTING DETAIL - N.T.S.**

NEVER CUT A LEADER AND TREE WITH DEAD OR DAMAGED BRANCHES WILL NOT BE ACCEPTED.

TRAVERSE AND/OR APPROVED ALTERNATE SHALL BE SECURED TIGHTLY TO STAKE BUT LOCATED AT LEAST 100mm FROM TRUNK.

TRAVERSE AND/OR APPROVED ALTERNATE SHALL BE SECURED TIGHTLY TO STAKE BUT LOCATED AT LEAST 100mm FROM TRUNK.

TRAVERSE AND/OR APPROVED ALTERNATE SHALL BE SECURED TIGHTLY TO STAKE BUT LOCATED AT LEAST 100mm FROM TRUNK.

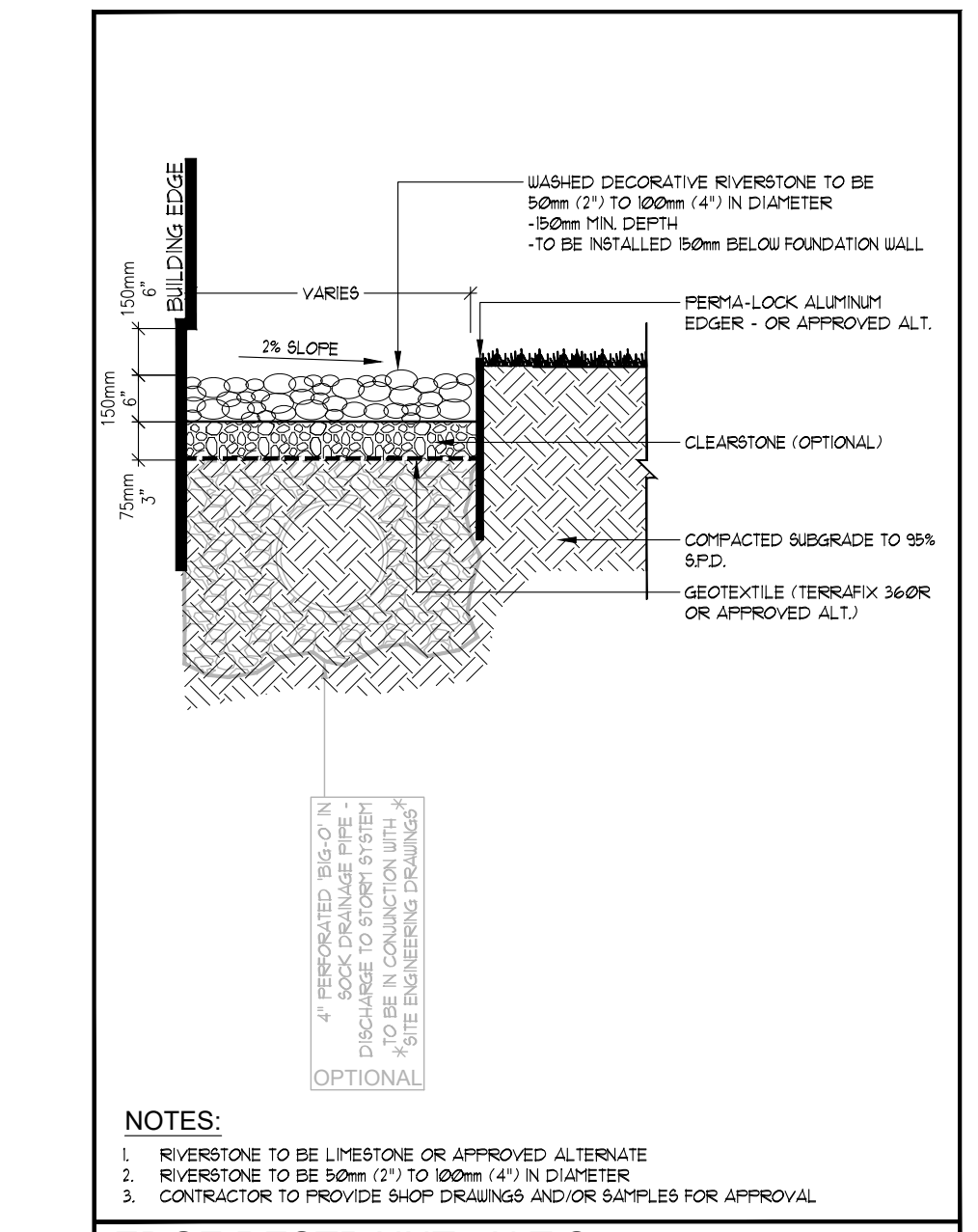

**EDGE RESTRAINT - N.T.S.**

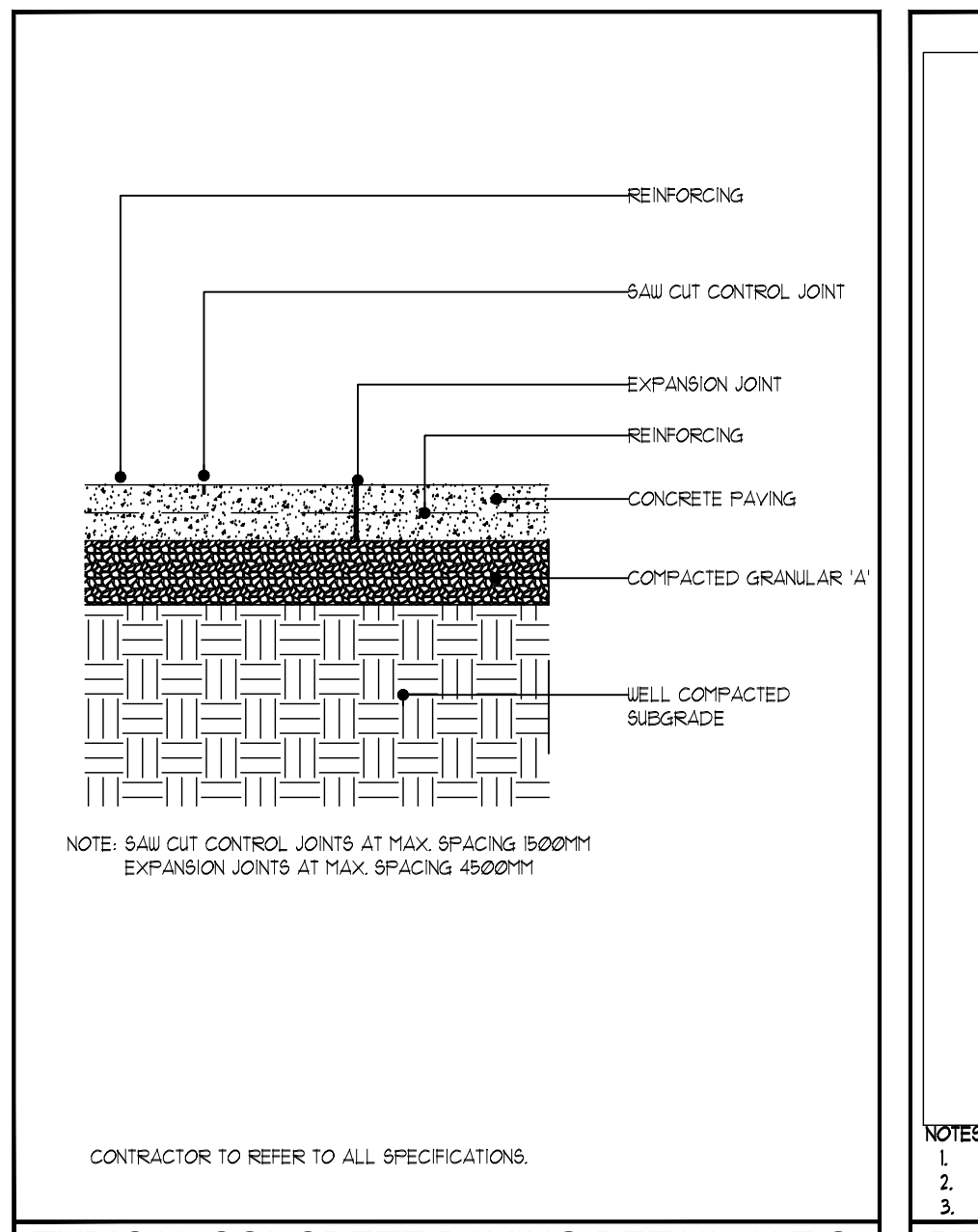

**TYPICAL CONCRETE PAVING DETAIL - N.T.S.**



**BENCH N.T.S.**

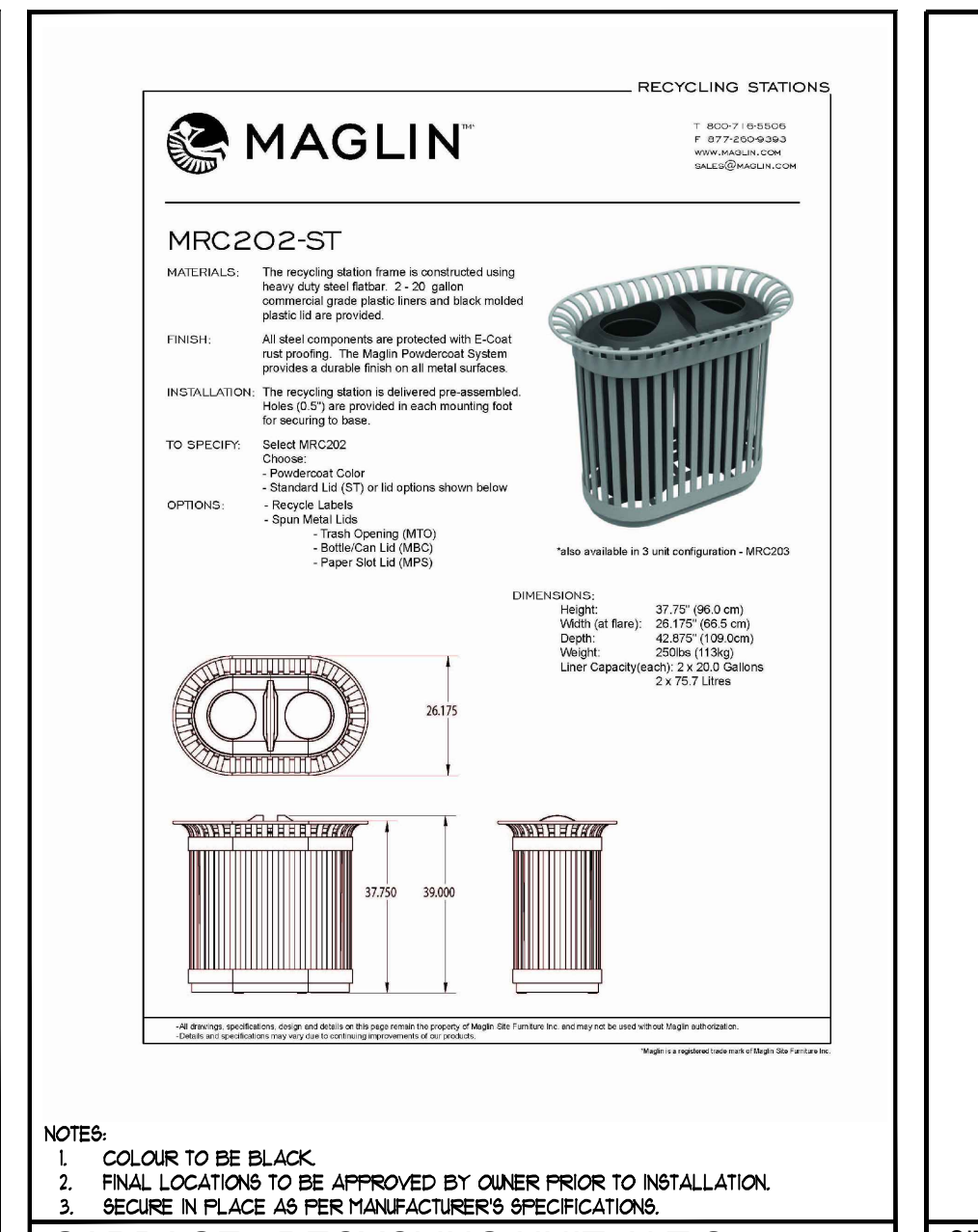

**GARbage - RECYCLING UNIT N.T.S.**

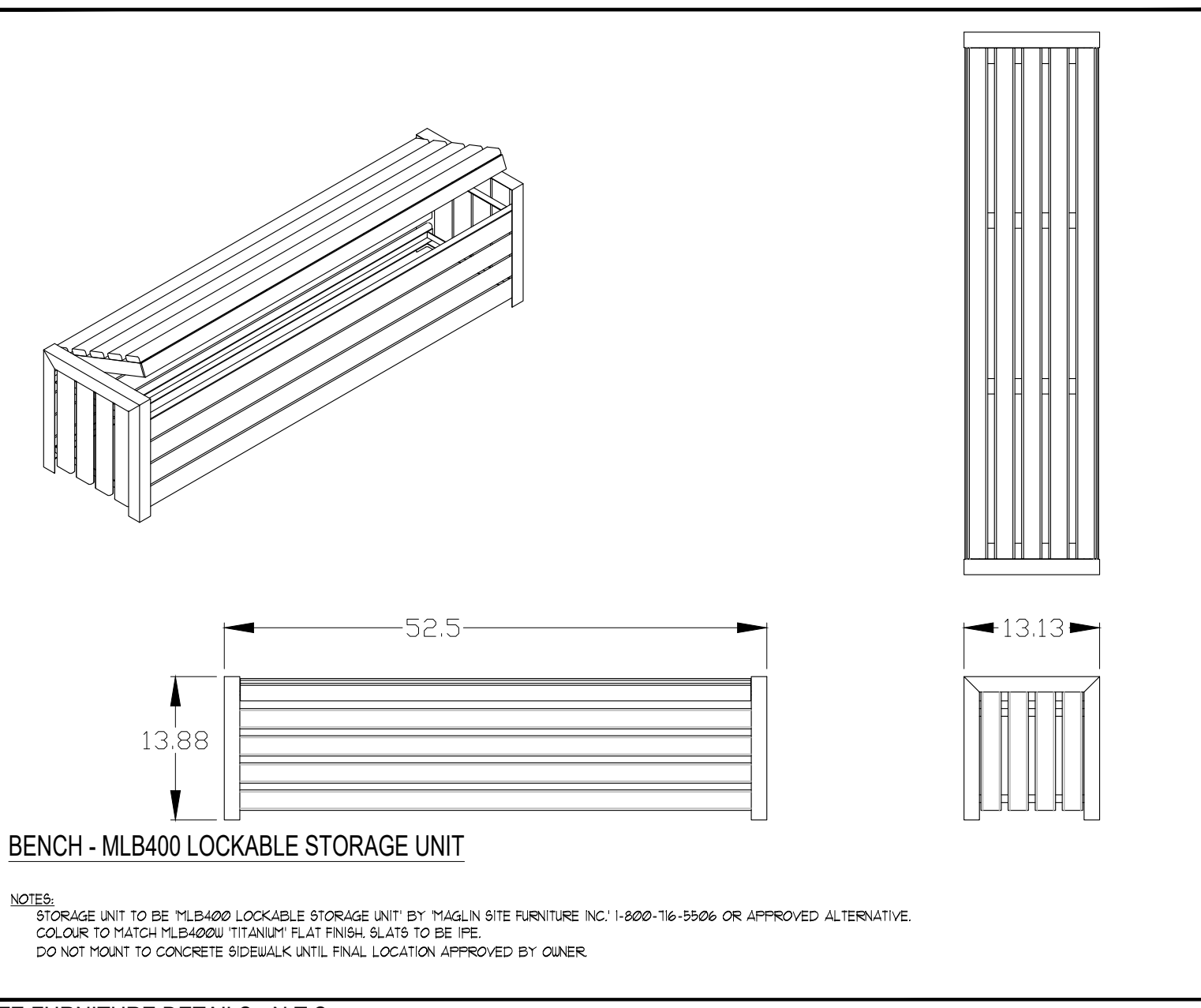

**SITE FURNITURE DETAILS - N.T.S.**

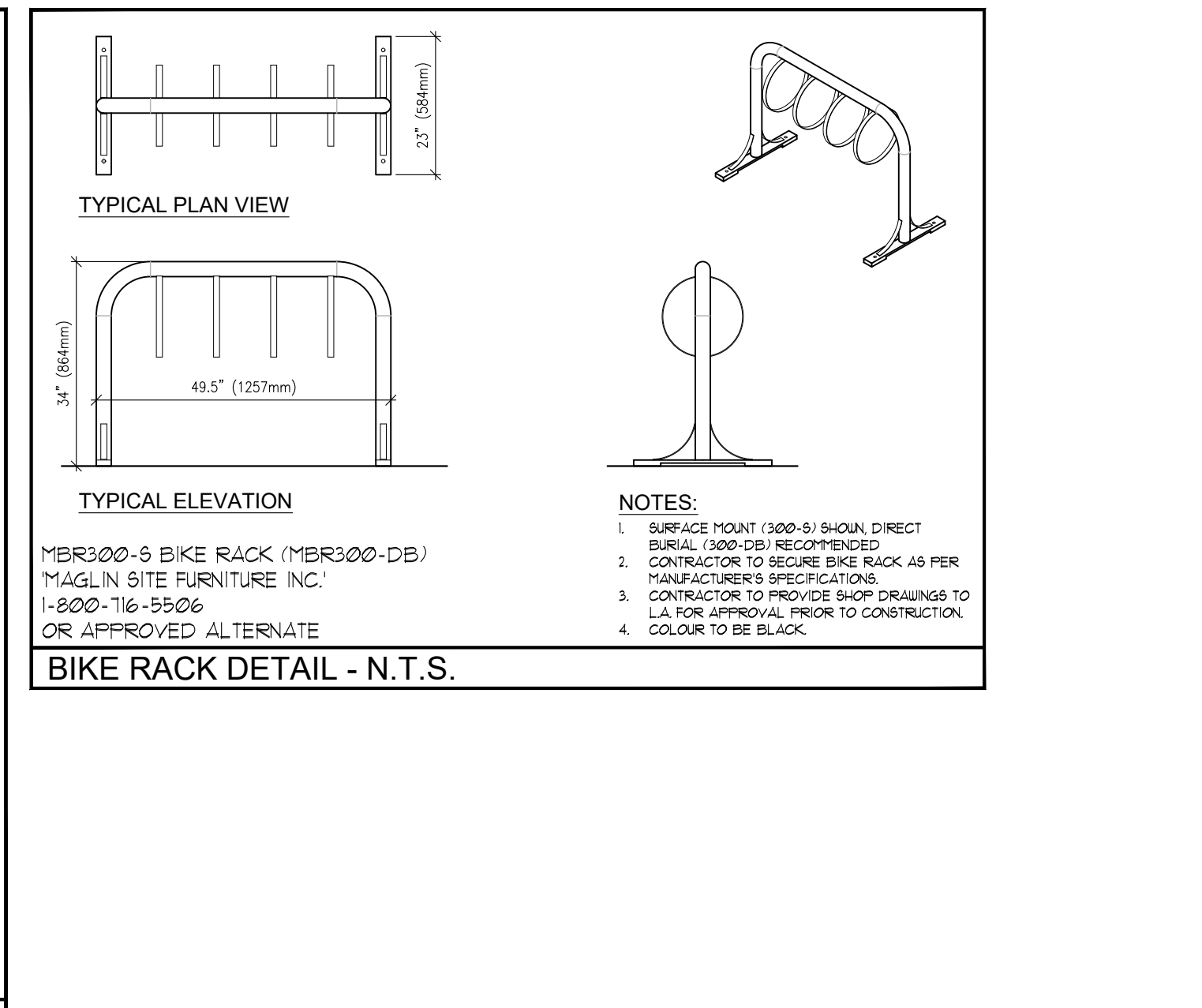

**BIKE RACK DETAIL - N.T.S.**

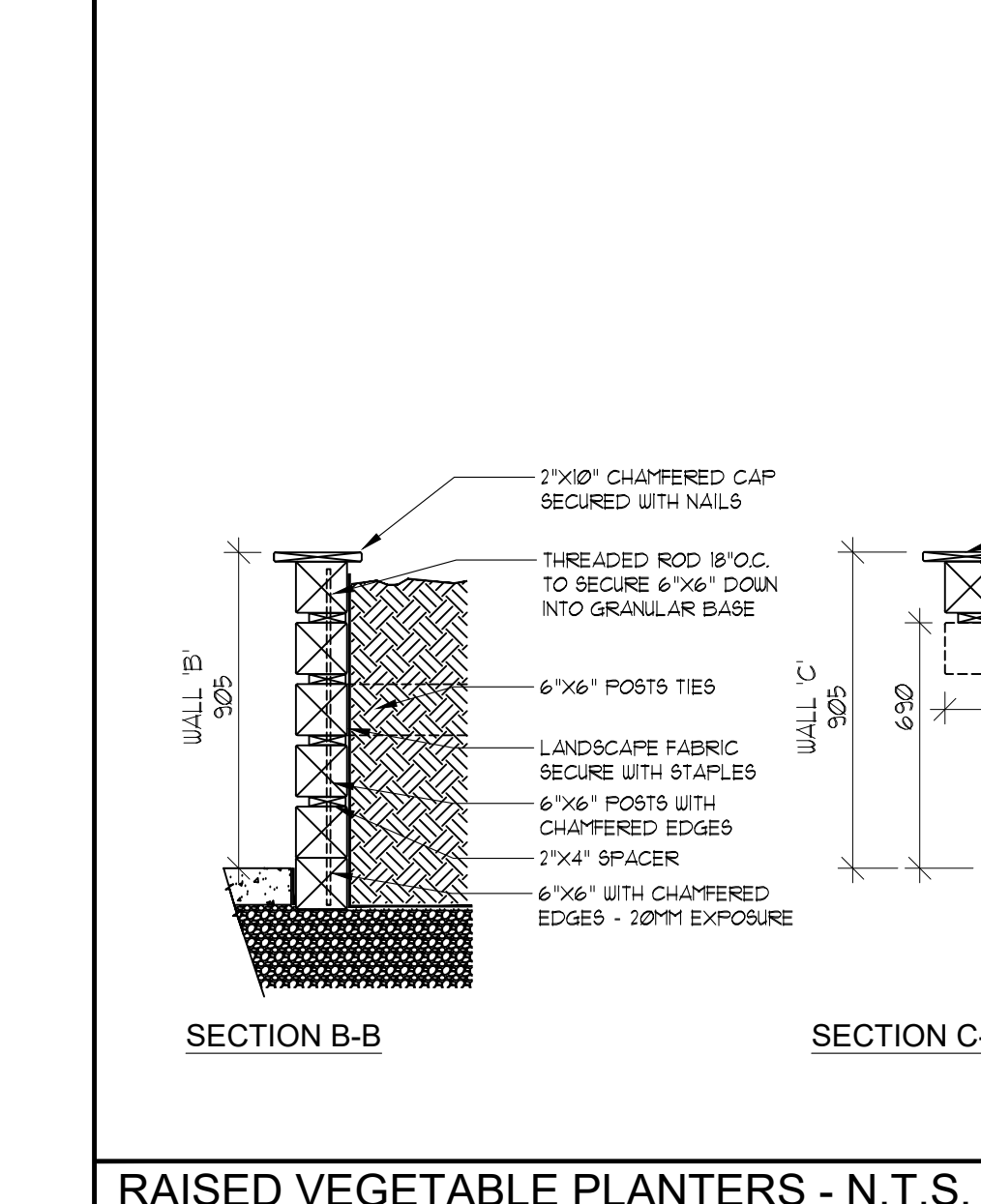

**RAISED VEGETABLE PLANTERS - N.T.S.**

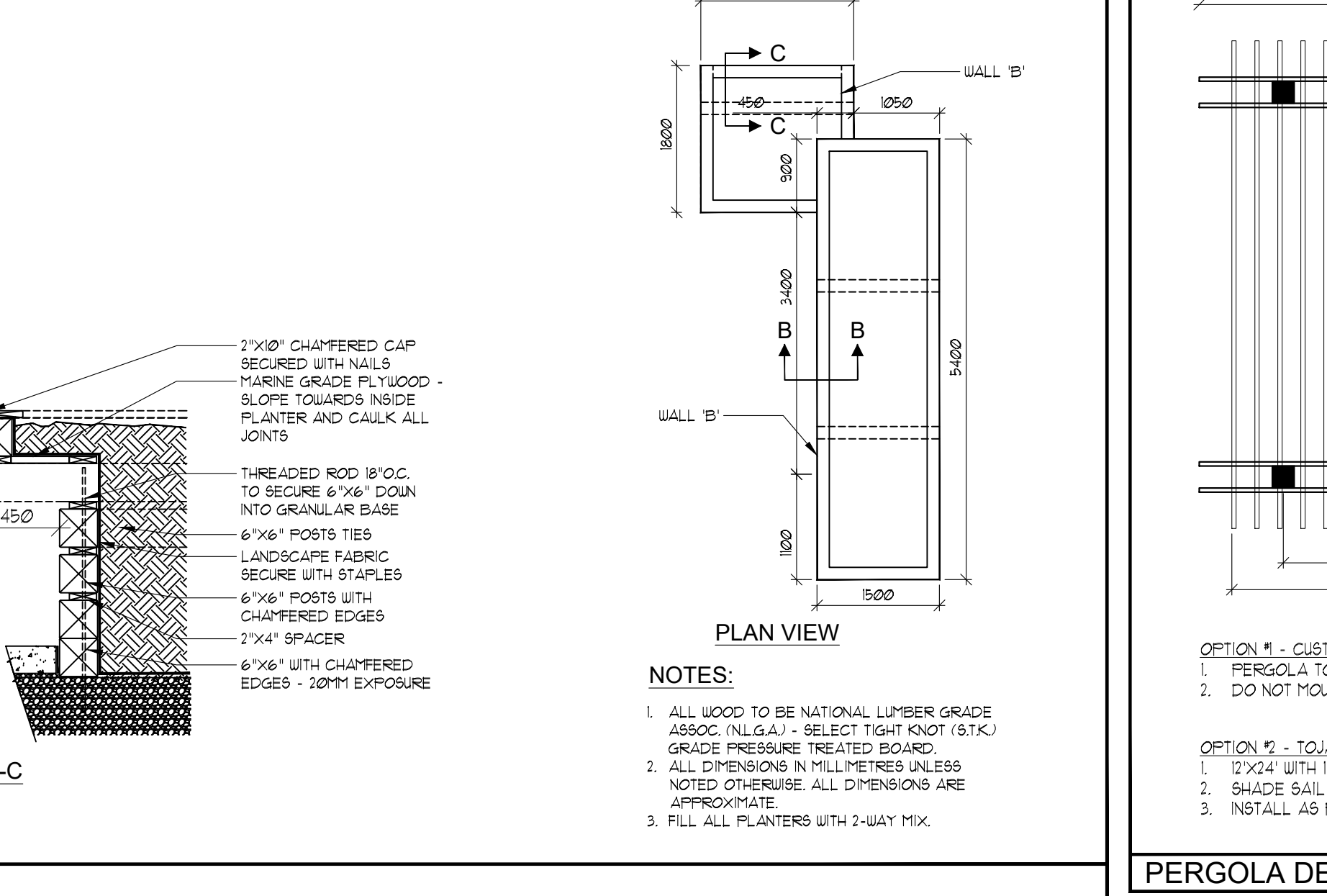

**PERGOLA DETAIL N.T.S.**

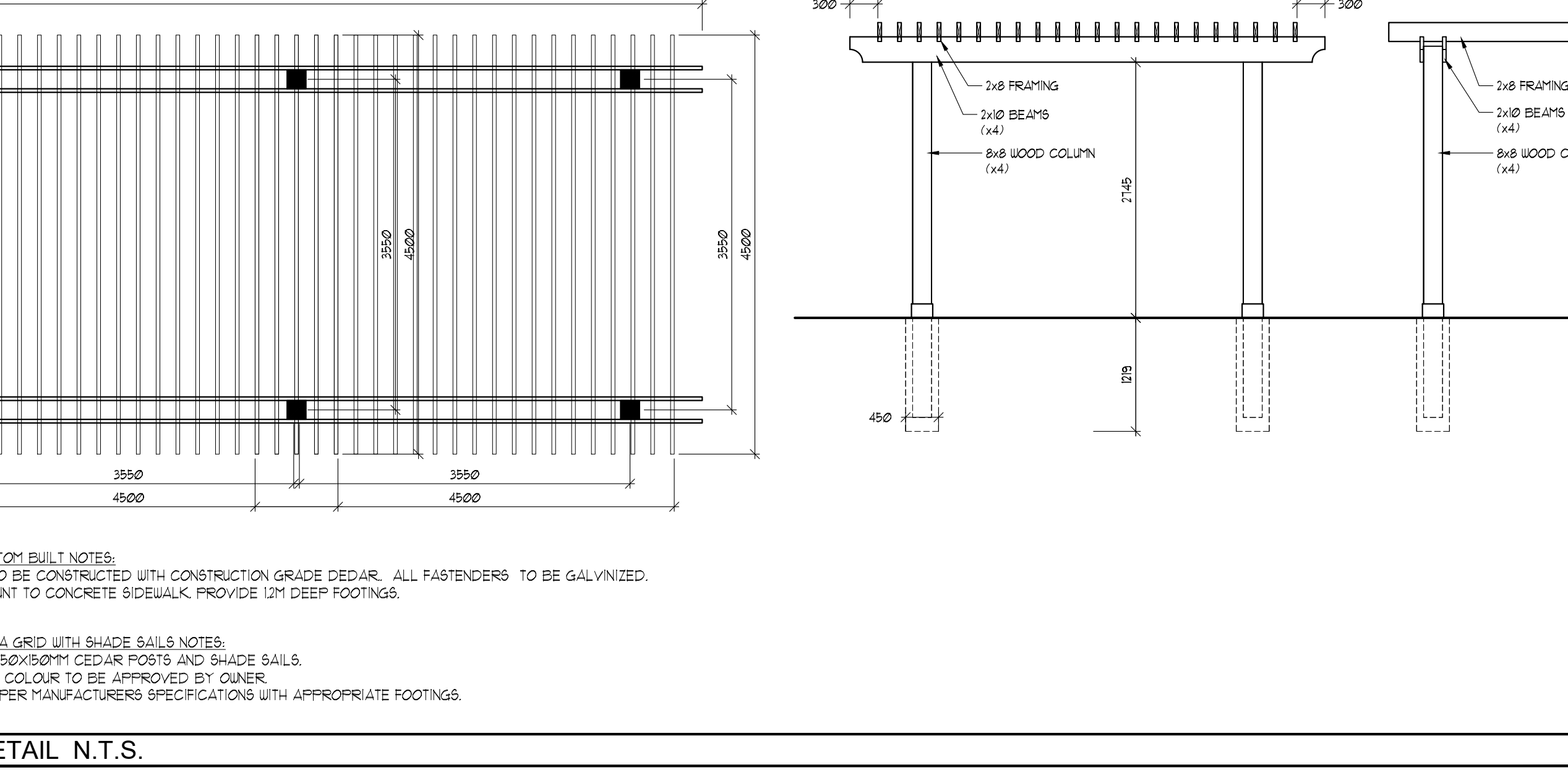

**5'-0" (+/-1524mm) HIGH SOLID BOARD WOOD FENCE - N.T.S.**

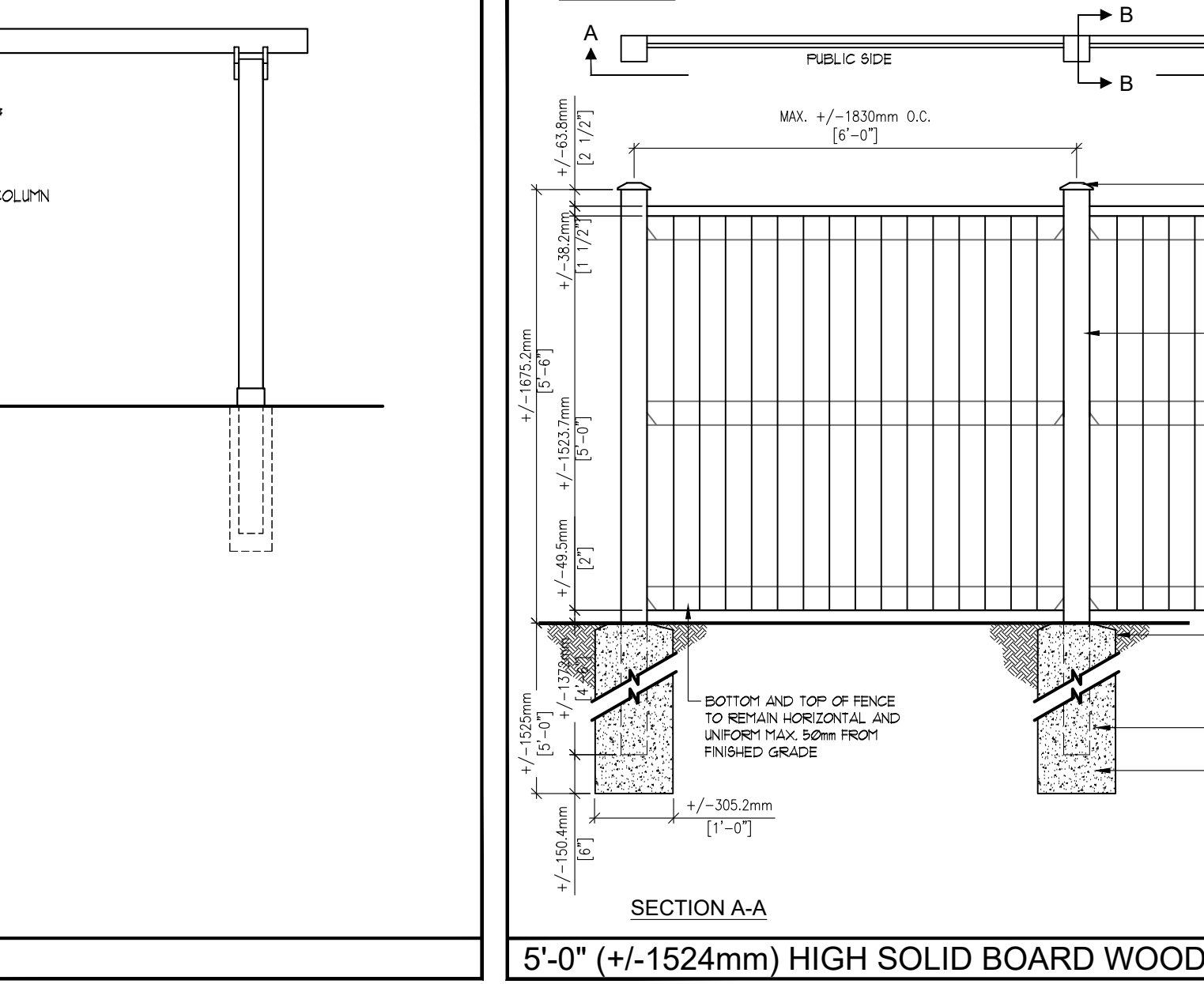

**ARCH CORP LTC LEAMINGTON**

1. DEC 02/2021	ISSUED FOR 5% AS BIDDING BY AMENDMENT	MCB
2. NOV 19/2021	ISSUED FOR 100% DC	MCB
3. NOV 19/2021	ISSUED FOR 0% DC	MCB
4. OCT 22/2021	ISSUED FOR 0% DC	MCB
5. AUG 02/2021	ISSUED FOR 100% DC	MCB
6.		MCB