

DRAWING LEGEND

CB	CATCH BASIN
MH	MANHOLE
SPL	SPRINGLINE OF PIPE
INV	INVERT OF PIPE
SAN	SANITARY SEWER
ST	STORM SEWER
WS/WM	WATER SERVICE/WATERMAIN
CS	CURB STOP & STAMPOST
VB	VALVE & VALVE BOX
FHT	FIRE HYDRANT
FDC	FIRE DEPARTMENT CONNECTION
ROOF DRAIN	ROOF DRAIN
WATER METER	WATER METER
RMOTE WATER METER READOUT	REMOTE WATER METER READOUT
+67.89	EXISTING GRADE ELEVATION
+67.89	PROPOSED GRADE ELEVATION
2%	EXISTING SLOPE OF GRADE
2%	PROPOSED SLOPE OF GRADE
---	PROPERTY LINE
D.C.	150mm CURB/DEPRESSED CURB
CONCRETE	CONCRETE
HEATED CONCRETE	HEATED CONCRETE
INTERLOCK	INTERLOCK
LANDSCAPE	LANDSCAPE
AREA WELL	AREA WELL
FFL	FIRST FLOOR ELEVATION
TOP	TOP OF FOUNDATION
USF	UNDERSIDE OF FOOTING

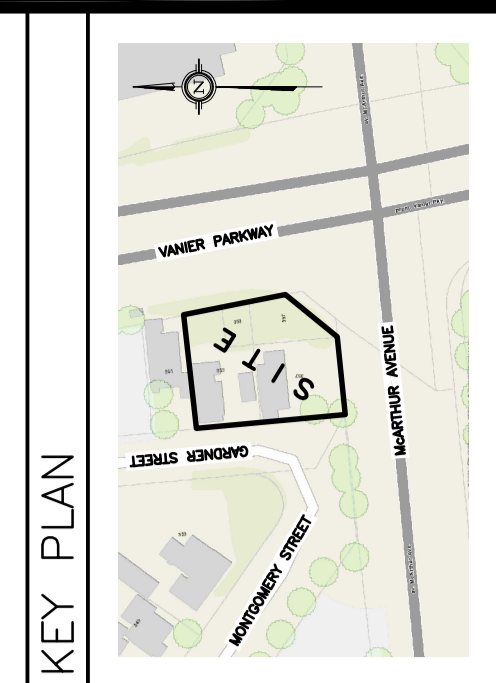

No.	DATE	REVISION
1	JUN 24-20	ISSUED FOR COORDINATION
2	JUN 26-20	ISSUED FOR APPROVAL

D. B. GRAY ENGINEERING INC.
 700 Long Point Circle
 Ottawa, Ontario
 613-425-8044
 dgray@dbgrayengineering.com

**PROPOSED 9-STORY
 61-UNIT APARTMENT
 BUILDING
 353-357 GARDNER STREET
 OTTAWA, ONTARIO**

SITE SERVICING PLAN

Engineer's Seal

 Drawn: D.B.G.
 Horz. Scale: 1:100
 Vert. Scale: 20:1
 Date: MAY 20-20
 Job No.: 20037
 Drawing No.: **C-1**
 of **6**
 NOT VALID UNLESS SIGNED & DATED

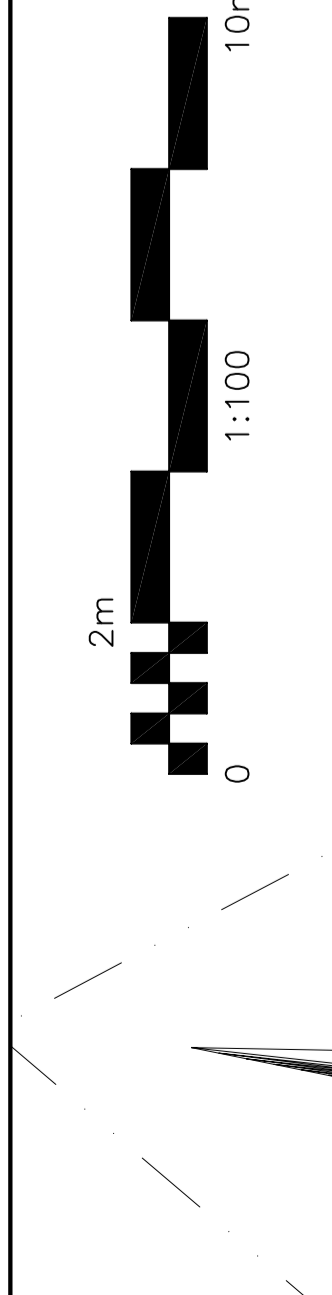

SITE BENCHMARK
 Top of Spindle
 of Fire Hydrant
 Elevation = 57.91

THE DEPTH OF THE EXISTING
 150mm WATERMAIN IS ESTIMATED
 TO BE 1.8m. PRIOR TO
 COMMENCEMENT OF CONSTRUCTION
 OF SAN SERVICE CONNECTIONS
 EXPOSE THE EXISTING WATERMAIN
 AND DETERMINE ITS EXACT LOCATION
 AND GEODETIC ELEVATION AND
 REPORT FINDINGS TO THE ENGINEER.

FFL = 58.13
 TOP = 58.13
 (EXCEPT WHERE NOTED)
 USF = ±53.10
 (EXCEPT WHERE NOTED)

**REFER TO NOTES, DETAILS &
 SCHEDULES ON DRAWING C-4 & C-5**