

EROSION & SEDIMENT CONTROL

1. SILT FENCE SHALL BE INSTALLED WHERE INDICATED AND MAINTAINED DURING CONSTRUCTION.
2. SILT SACKS SHALL BE INSTALLED UNDER THE FRAME AND COVER OF ALL PROPOSED AND EXISTING CATCH BASINS.
3. THE CONTRACTOR SHALL IMPLEMENT BEST MANAGEMENT PRACTICES, TO PROVIDE FOR PROTECTION OF THE AREA DRAINAGE SYSTEM DURING CONSTRUCTION ACTIVITIES. THE CONTRACTOR ACKNOWLEDGES THAT FAILURE TO IMPLEMENT APPROPRIATE EROSION AND SEDIMENT CONTROL MEASURES MAY BE SUBJECT TO PENALTIES IMPOSED BY ANY APPLICABLE REGULATORY AGENCY.

NOTES

THE POSITION OF ALL POLE LINES, CONDUITS, WATERMANS, SEWERS AND OTHER UNDERGROUND AND OVERGROUND UTILITIES AND STRUCTURES IS NOT NECESSARILY SHOWN ON THE CONTRACT DRAWINGS, AND WHERE SHOWN, THE ACCURACY OF THE POSITION OF SUCH UTILITIES AND STRUCTURES IS NOT GUARANTEED. BEFORE STARTING WORK, DETERMINE THE EXACT LOCATION OF ALL SUCH UTILITIES AND STRUCTURES AND ASSUME ALL LIABILITY FOR DAMAGE TO THEM.

NO.	REVISION DESCRIPTION	DATE	BY
2	REVISED PER CITY COMMENTS	21/01/20	SMC
1	ISSUED FOR SUBDIVISION APPLICATION	05/12/19	SMC

NO.	REVISION DESCRIPTION	DATE	BY

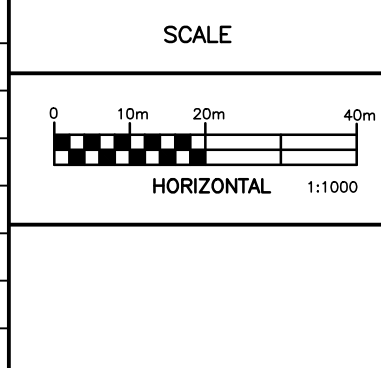



Robinson
Land Development

CONSULTING ENGINEERS
350 PALLADIUM DRIVE
KANATA, ONTARIO K2V 1A8
TELEPHONE (613) 592-6060

DESIGN	BLM
CHECKED	SMC
DRAWN	BLM
CHECKED	SMC
APPROVED	SMC

INVERNESS HOMES
38 AURIGA DRIVE, SUITE 200
OTTAWA, ON K2E 8A6

147 LANGSTAFF DRIVE
CARP, ON

EROSION AND SEDIMENT CONTROL PLAN

PROJECT No.	19008
SURVEY	RLD
DATED	JANUARY 2020
DWG. No.	19008-ESC1

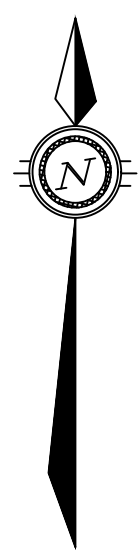
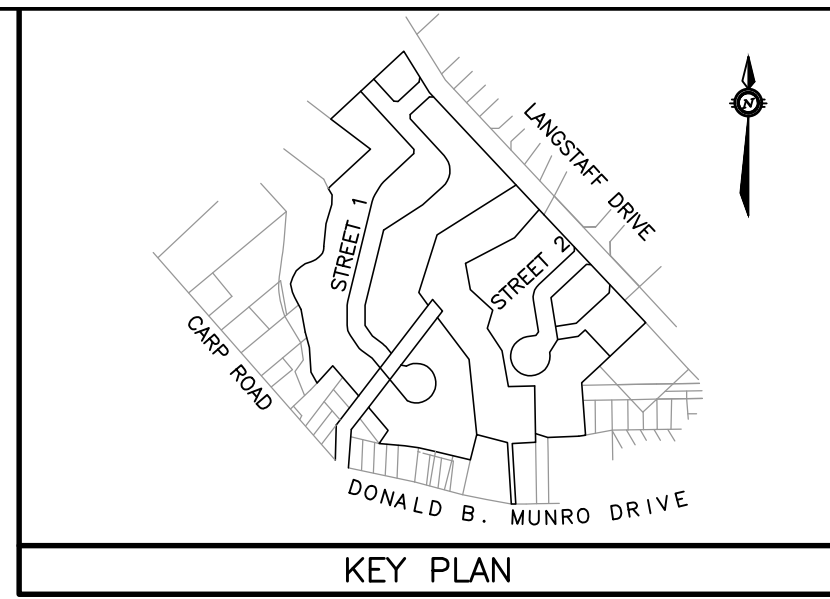

LEGEND

	PROPERTY BOUNDARY
	STORM SEWER AND MANHOLE
	ROADSIDE CATCH BASIN
	EXISTING STORM SEWER AND MANHOLE
	EXISTING CATCH BASIN
	SILT FENCE
	STRAW BALE CHECK DAM