

SURVEYOR'S REAL PROPERTY REPORT
PART 1 Plan of
LOT 20 (SOUTH YORK STREET)
REGISTERED PLAN 42482
CITY OF OTTAWA
 Surveyed by Annis, O'Sullivan, Vollebek Ltd.

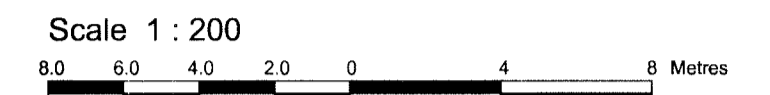

Metric
 DISTANCES SHOWN ON THIS PLAN ARE IN METRES AND CAN BE CONVERTED TO FEET BY DIVIDING BY 0.3048

Surveyor's Certificate

- I CERTIFY THAT :
1. This survey and plan are correct and in accordance with the Surveys Act, the Surveyors Act and the Land Titles Act and the regulations made under them.
 2. The survey was completed on the 15th day of November, 2017.

Date Nov 20 2017
 E. H. Herweyer
 Ontario Land Surveyor

PART 2
 THIS PLAN MUST BE READ IN CONJUNCTION WITH SURVEY REPORT DATED: November 20, 2017

ANNIS, O'SULLIVAN, VOLLEBEKK LTD. grants to BAYVIEW HOSPITALITY INC. ("The Client"), their solicitors, mortgagees, and other related parties, permission to use original, signed, sealed copies of the Surveyor's Real Property Report in transactions involving The Client.

ASSOCIATION OF ONTARIO
 LAND SURVEYORS
 PLAN SUBMISSION FORM
 2029690

THIS PLAN IS NOT VALID UNLESS IT IS AN EMBOSSED ORIGINAL COPY ISSUED BY THE SURVEYOR In accordance with Regulation 1026, Section 29 (3).

Notes & Legend

- IB Denotes Survey Monument Planted
- Survey Monument Found
- SIB Standard Iron Bar
- SSIB Short Standard Iron Bar
- CC Iron Bar
- CP Cut Cross
- Meas. Concrete Pin
- ACC Measured
- (WIT) Accepted
- (AOG) Witness
- UP Utility Pole
- BF Board Fence
- CLF Chain Link Fence
- C/L Centreline
- △ Sign
- Overhead Wires
- (P1) Registered Plan 42482
- (P2) Plan 5R-13174
- (P3) Plan 4R-27331
- (P4) Plan 4R-19481
- (P5) (1692) Plan August 29, 2005
- (P6) (857) Plan May 6, 1992

Bearings are grid, derived from the Southerly limit of York Street, shown to be N 58°17'25"E on Plan by (SG) dated September 16, 2013, and are referred to the Central Meridian of MTM Zone 9 (76°30' West Longitude) NAD-83 (original).

© Annis, O'Sullivan, Vollebek Ltd. 2017. "THIS PLAN IS PROTECTED BY COPYRIGHT"
ANNIS, O'SULLIVAN, VOLLEBEKK LTD.
 14 Concourse Gate, Suite 500
 Nepean, Ont. K2E 7S6
 Phone: (613) 727-0850 / Fax: (613) 727-1079
 Email: Nepean@aovtld.com
 Ontario Land Surveyors Job No. 18416-17 BayviewHosp L120 PL42482 O D2 FS

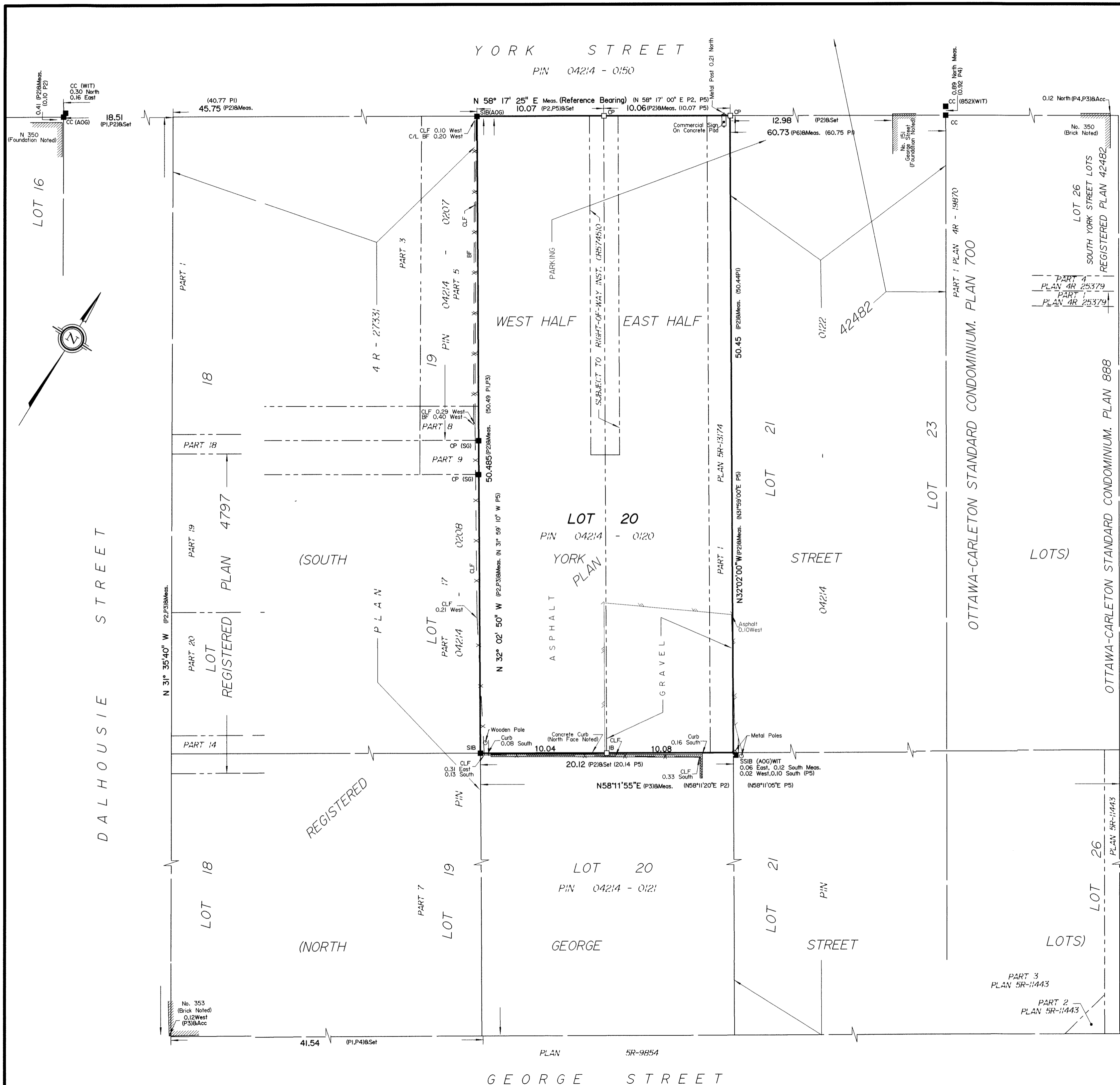

PLAN 5R-9854
 GEORGE STREET