

PROPOSED PLANT LIST						
KEY	QTY	BOTANICAL NAME	COMMON NAME	SIZE	CONDITION	REMARKS
TREES						
HL	3	Gleditsia triacanthos 'Skyline'	Skyline Honey Locust	60mm ø	B&B	
JL	2	Syringa reticulata	Japanese Tree Lilac	70mm ø	B&B	Single Leader

GENERAL NOTES:

- It is the responsibility of the appropriate contractor or official to report any errors, omissions or discrepancies on this plan with actual site conditions to the Landscape Architect before proceeding with construction.
- The contractor is to notify all utility companies and authorities prior to any excavation and ascertain locations of underground services.
- The contractor is to restate all areas and items damaged as a result of construction activity.
- The contractor is to comply with all pertinent codes and by-laws.
- The contractor is to maintain a positive surface run-off throughout the entire construction period.
- The Landscape Architect is not responsible for subsurface conditions.
- The contractor is to identify all existing trees to remain on site with the Landscape Architect prior to construction.
- The contractor is to stake the proposed location of all plant material in conjunction with the Landscape Architect prior to excavation.
- Minimum distances for selected deciduous trees are as follows:
 - Building Foundations 7.5m
 - Sidewalks 1.5m
 - Underground infrastructure 2.0m
- All trees within 1m of underground utility trenches are to be excavated by hand.
- Remove all protective wrapping from tree trunks after installation.
- Staking of trees shall only be performed if necessary.
- Ensure that mulch is pulled back a min. distance of 75mm from base of tree trunk.
- Deciduous trees to be planted on private property 450mm inside of property line.

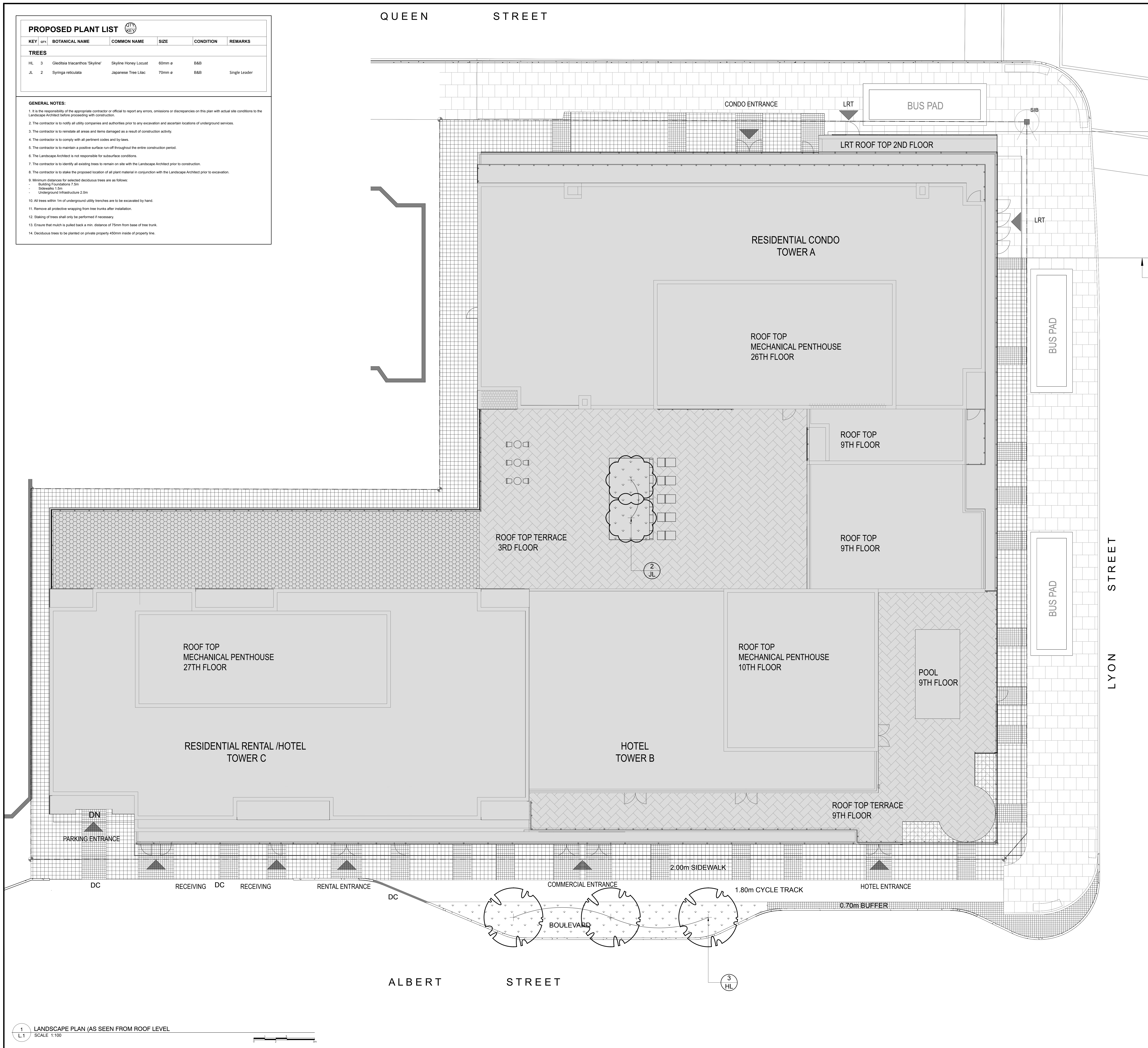

CLIENT: Claridge Homes
210 Gladstone Ave., Suite 2001
Ottawa, ON
Tel: (813) 225-8020

LOCATION PLAN:

CONSULTANTS:

ARCHITECTS: NEUF architect(s)
630 boul. René-Lévesque O. 32e étage
Montréal, QC
Tel: (514) 947-1117

SURVEYORS: Annis, O'Sullivan, Vollbeek Ltd.
14 Concourse Gate, Suite 500
Napan, ON
Tel: (813) 727-0850

STRUCTURAL ENGINEERS: Goodeve Manhire Partners Inc.
77 Auriga Drive, Suite 18
Ottawa, ON
Tel: (813) 225-4558

MECHANICAL AND ELECTRICAL ENGINEERS: Quadrant Engineering Ltd.
107 Preston Ave.
Ottawa, ON
Tel: (813) 567-1487

CIVIL ENGINEERS: Novatech Engineering Consultants Ltd.
243 Michael Cowland Dr., Suite 200
Ottawa, ON
Tel: (813) 254-9543

LEGEND:

- PROPOSED DECIDUOUS TREE
- PROPOSED PAVER TYPE 1 INSTALLED AT GRADE
- PROPOSED PAVER TYPE 2 INSTALLED AT GRADE
- PROPOSED PAVER TYPE 3 INSTALLED AT GRADE
- PROPOSED PAVER TYPE 4
- PROPOSED GREEN ROOF VEGETATION
- PROPOSED SOD
- PROPOSED FURNISHINGS
- PROPOSED LANDSCAPE PLANTER
- PROPOSED LANDSCAPE FEATURE WALL

No.	Issue	Date	DR	CK
3	ISSUED FOR ZONING BY-LAW AMENDMENT / SITE PLAN CONTROL	20/08/2018	LC	JL
2	ISSUED FOR SITE PLAN APPROVAL	15/10/2013	VP	JL
1	ISSUED FOR COORDINATION	10/10/2013	VP	JL

JAMES B. LENNOX & ASSOCIATES INC. LANDSCAPE ARCHITECTS
SUITE 200A HAMILTON BRICK PLAZA, 1419 CARLING AVE. OTTAWA, ONTARIO K1Z 7L7
Tel: (613) 722-5168 Fax: (866) 343-3942

PROJECT: 383 Albert Street

DRAWING: LANDSCAPE PLAN

STAMP:

SCALE: See Plan

START DATE: September 2013

PROJECT NO.: 13-CLG-1370

DRAWING NO.: L.1

PROJECT NORTH:

PLOT SIZE: ARCH-E