

LEGEND

- SANITARY DRAINAGE SUB AREA
- POPULATION EQUIVALENT
- NUMBER OF UNITS IN SUB AREA
- DRAINAGE AREA BOUNDARY
- PROPOSED SANITARY SEWER
- EXISTING SANITARY SEWER
- OUTSIDE PROPOSED DEVELOPMENT
- N=85.75
S=85.75
W=85.75
- PROPOSED OVERT ELEVATION
- 160
- PROPOSED MANHOLE NUMBER

THE POSITION OF ALL POLE LINES, CONDUITS, WATERMANS, SEWERS AND OTHER UNDERGROUND AND OVERGROUND UTILITIES AND STRUCTURES IS NOT NECESSARILY SHOWN ON THE CONTRACT DRAWINGS, AND WHERE SHOWN, THE ACCURACY OF THE POSITION OF SUCH UTILITIES AND STRUCTURES IS NOT GUARANTEED. BEFORE STARTING WORK, DETERMINE THE EXACT LOCATION OF ALL SUCH UTILITIES AND STRUCTURES AND ASSUME ALL LIABILITY FOR DAMAGE TO THEM.

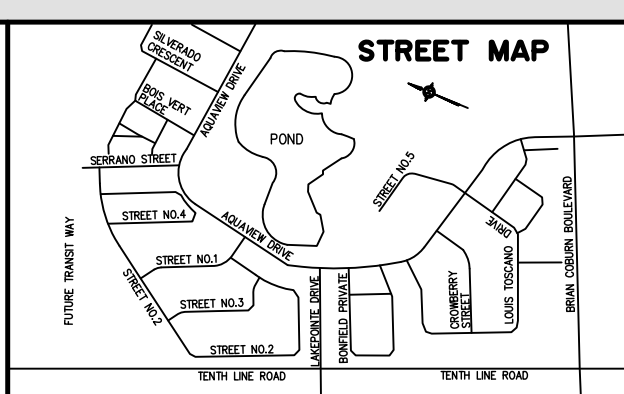

No.	REVISION	APPLIES WHEN DRAWING MODIFIED	DATE	BY

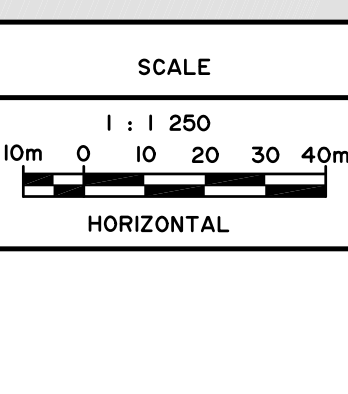

DESIGN	VLL
CHECKED	AGS
DRAWN	VLL
CHECKED	AGS
APPROVED	AGS

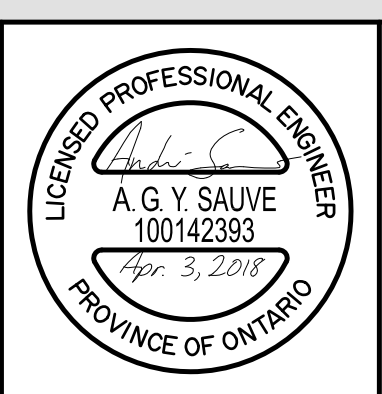

CITY OF OTTAWA AQUAVIEW PLAN	MINTO COMMUNITIES INC. MACRO SANITARY DRAINAGE AREA PLAN	CLIENT No.	148
		PROJECT No.	171203
		DRAWING No.	171203-SANM