

PLANTING MIX TO BE APPROVED BY LANDSCAPE ARCHITECT.
ALL PLANT MATERIAL TO MEET CNLA STANDARDS, AND BE APPROVED BY LANDSCAPE ARCHITECT PRIOR TO PLANTING.
REFER TO CIVIL ENGINEER'S DRAWING FOR ELEVATIONS / GRADING.
ALL WORK TO INCLUDE 1 YEAR WARRANTY FROM DATE OF FINAL ACCEPTANCE.
MAINTAIN ALL AREAS UNTIL FINAL ACCEPTANCE, INCLUDING MOWING OF TURF, WEEDING OF BEDS, WATERING.
PROVIDE WATERING OF ALL PLANT MATERIAL AS REQUIRED FOR PROPER ESTABLISHMENT, UNTIL END OF WARRANTY PERIOD.
The Landscape Plan is to be read in conjunction with the grading and survey plan, underground services engineering drawings, construction details and contract documents and cannot be used for construction until signed by the landscape architect. Bare root material to be planted in season only. All plant material locations to be staked on site by the landscape contractor and checked by the landscape architect prior to planting. All trees to be preserved on or directly adjacent to the site will be protected. Plant material are to be installed a minimum of: 3.0m away from any part of any hydro transformer, 3.0m corridor between a fire hydrant and the curb, a 2.5m radius beside or behind a fire hydrant, 2.0m from any servicing/utility line or structure.

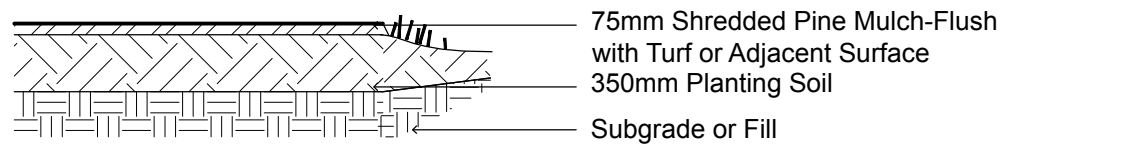

TYPICAL PLANTING BED NTS

During Excavation/Bed Preparation if Extreme Conditions are Encountered (Water, Rock, Gravel...) that Could Effect the Planting, Notify GJALA Immediately.

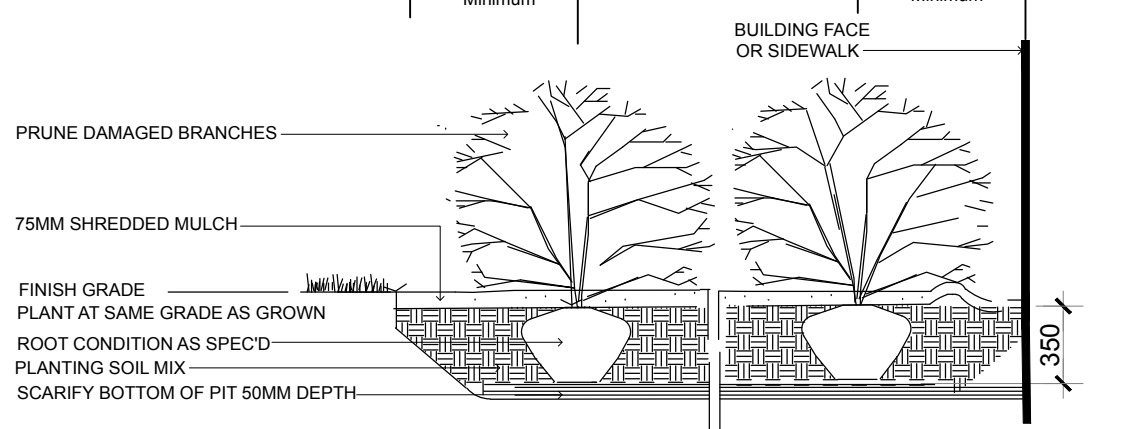

SHRUB PLANTING NTS

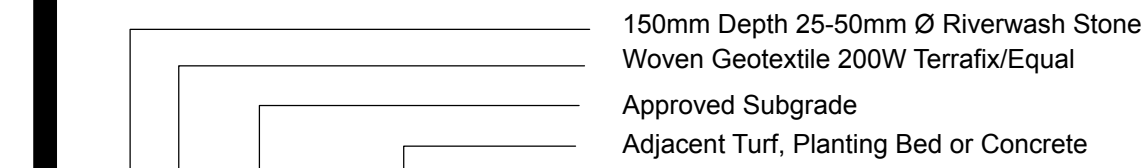

TYPICAL RIVERWASH STONE NTS

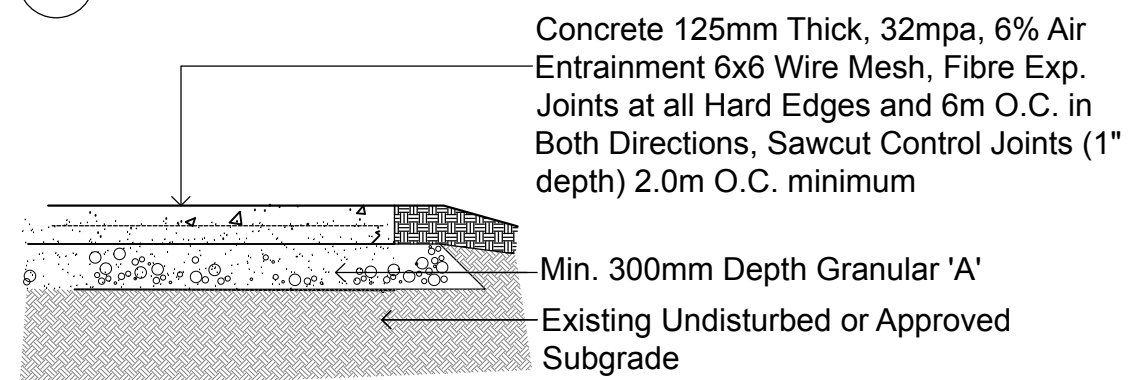

CONCRETE WALKWAY

32 MPA C2 c/w LIGHT BROOM FINISH - TOOL EDGE FIRST, THEN WIPE OFF TOOL MARKS WHILE APPLYING BROOM FINISH

GENERAL CONCRETE NOTES:
ALL CONCRETE FINISHES TO BE APPROVED BY GJA LANDSCAPE ARCHITECT.

SAWCUT LAYOUT FOR ALL AREAS TO BE MARKED ON SITE IN RED CHALK, REVIEWED, ADJUSTED AND APPROVED BY GJA LANDSCAPE ARCHITECT-PRIOR TO ANY CUTTING.

EXPANSION JOINT LAYOUT FOR ALL AREAS TO BE LAID OUT ON SITE, REVIEWED, ADJUSTED AND APPROVED BY GJA LANDSCAPE ARCHITECT-PRIOR TO ANY CONCRETE POURING.

FINISH: LIGHT BROOM - TOOL EDGE FIRST, THEN WIPE OFF TOOL MARKS WHILE APPLYING BROOM FINISH

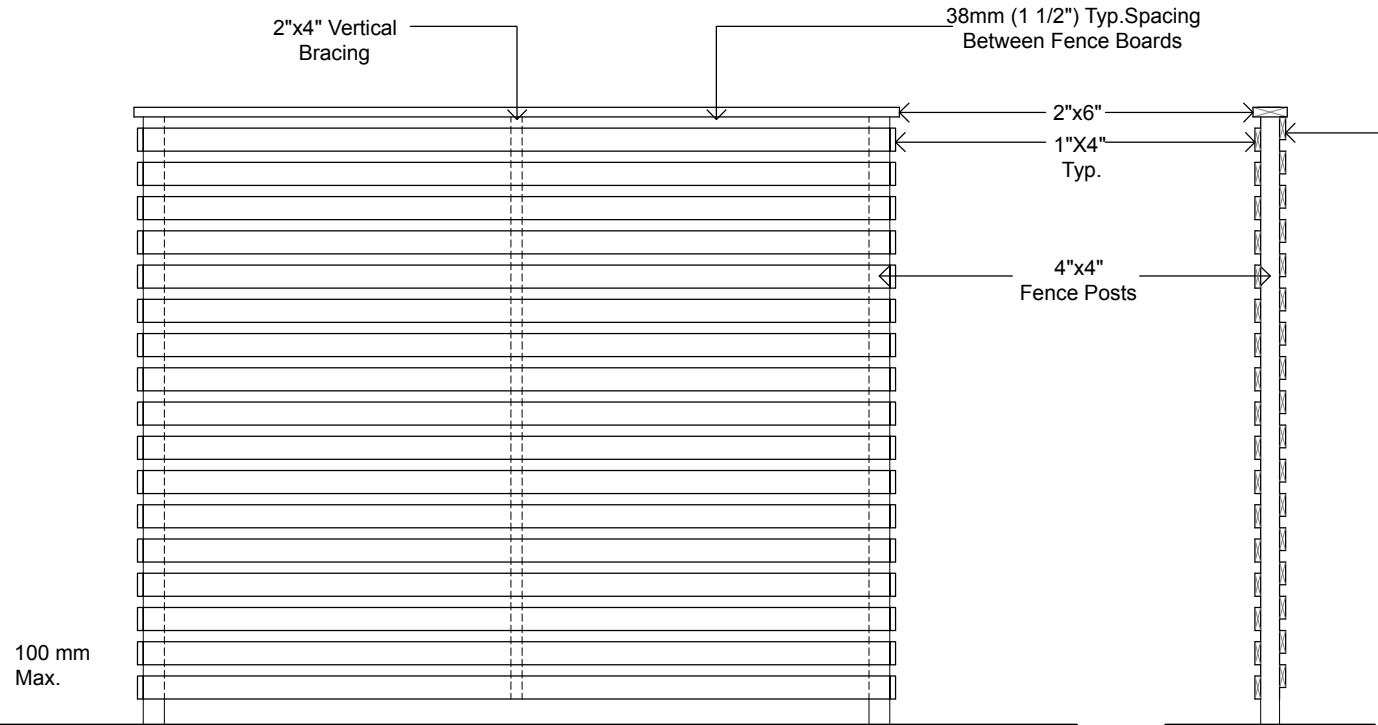

SOLID WOOD FENCE 7' / 2.13m Ht. NTS
All Wood To Be Local White Cedar

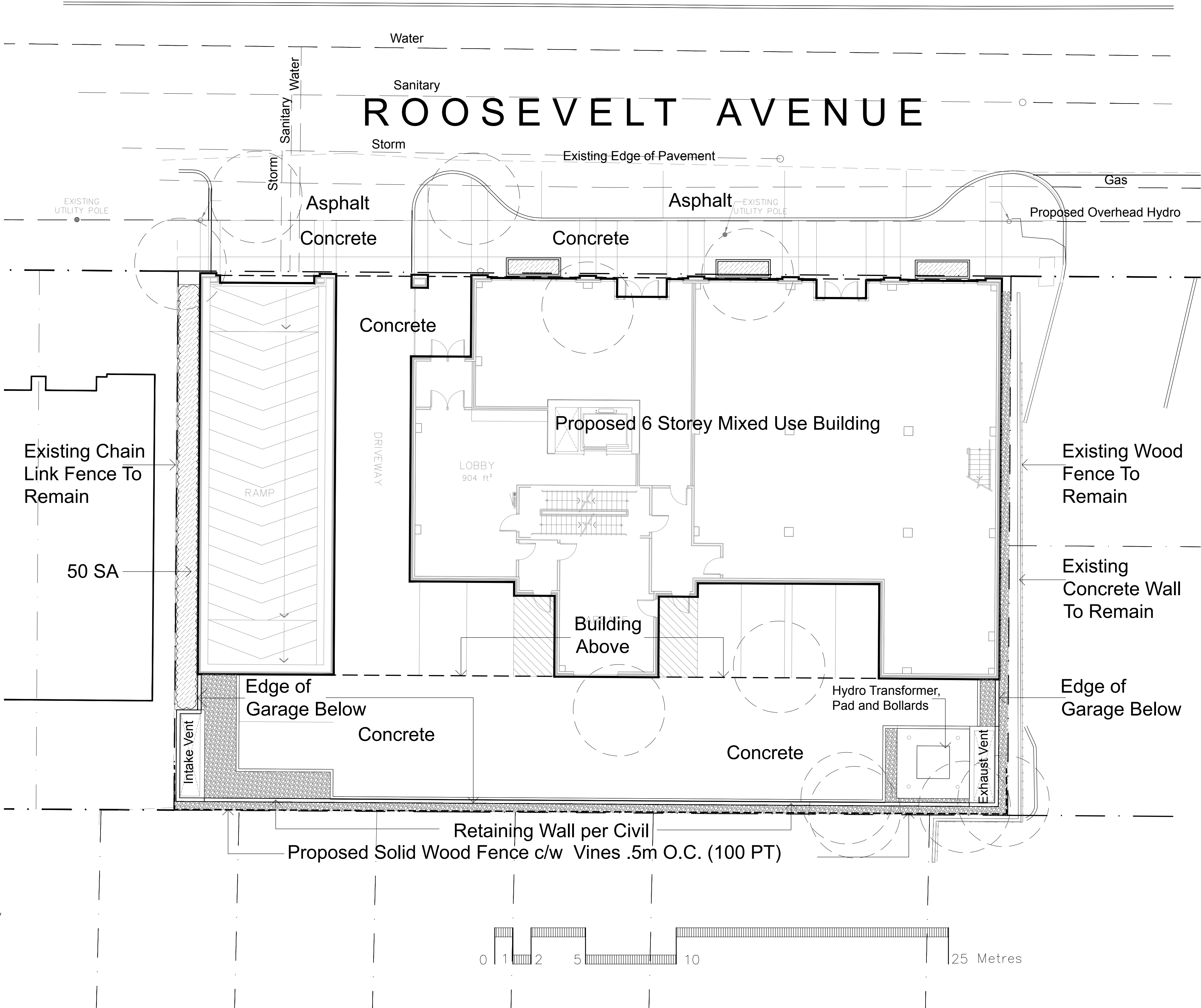

Plant List - Shrubs and Vines - 398-406 Roosevelt				
Code	Qty.	Botanical Name	Common Name	Size Condition
SA	50	Symphoricarpos albus	Snowberry	60cm Ht. Pot
PT	100	Parthenocissus tricuspidata	Boston Ivy	9cm Pot

Drawing Remains the Property of Gino J. Aiello Landscape Architect. Copyright Reserved by Gino J. Aiello Landscape Architect. Do Not Use or Reproduce Without Approval of Gino J. Aiello. Do Not Use For Construction Unless Signed By Landscape Architect. Contractor is Responsible for Verification of Site Locations of all Utilities. Report any Discrepancies Between Site and Drawing Immediately to Gino J. Aiello.

19 Existing Tree to be Removed

Proposed Planting Bed

Proposed Riverwash Stone On Filter Cloth

Proposed Planter 0.9m x 3.0m - Maglin MLP 400 Series Customized c/w Seasonal Planting

REVISIONS	
2	For Site Plan Control December 18 2017
1	For Review / Coordination December 13 2017
No. Revision	Date

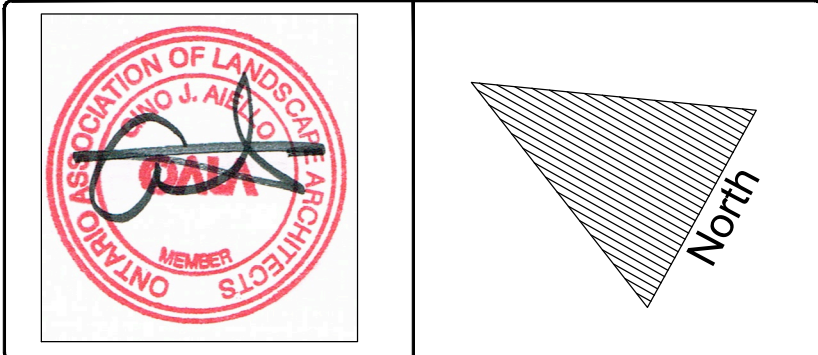

Property Owner
Domicile Developments Inc.
371A Richmond Road Ottawa K2A 0E7

Consultant
Gino J. Aiello landscape architect www.gjala.com
gino@gjala.com (613) 852 1343
50 Camelot Drive, Nepean, Ontario K2G 5X8

Project
Mixed Use Building
Commercial/Residential
398, 402, 406 Roosevelt Avenue

Drawing
Landscape Plan

Drawn By: GJA
Design By: GJA
Date: December 2017
Scale: 1:125
Sheet Number
L1

Dwg -#####

D07-##-##-###