

REFER TO ELECTRICAL/MECHANICAL ROOM DETAIL

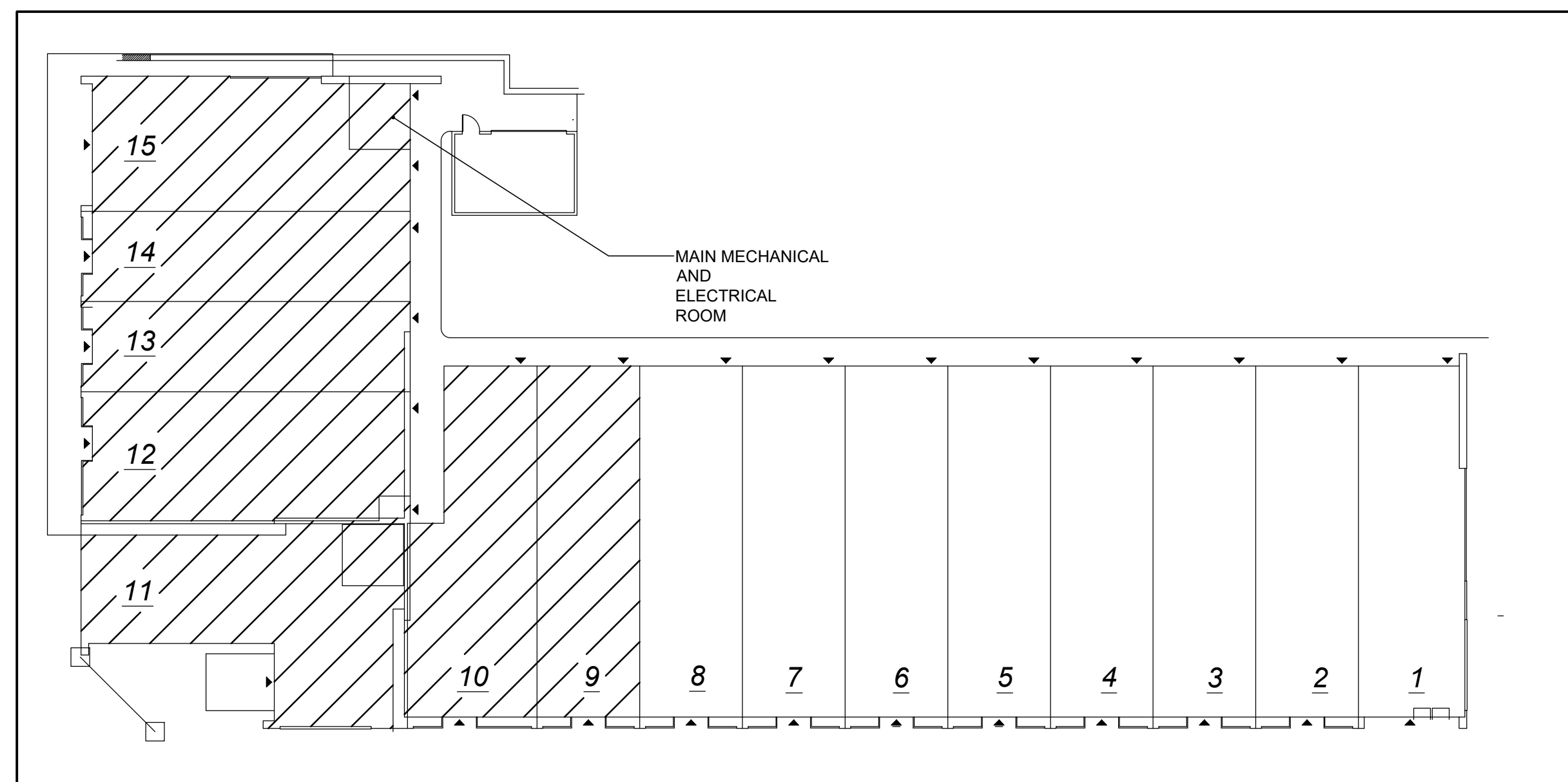

KEY PLAN - UNIT 9 TO UNIT 15
N.T.S.

DRAWING NOTES

- 1 UNDERGROUND INCOMING HYDRO SERVICES, 347/600 VOLT, 3-PHASE, 4 WIRE, 600 AMP, 2 (4 MCM 350 - 4" PVC) REFER TO ELECTRICAL SITE PLAN FOR CONTINUATION.
- 2 UNDERGROUND DATA/TELECOMMUNICATION 4" PVC CONDUIT C/W PULL STRING REFER TO ELECTRICAL SITE PLAN FOR CONTINUATION.
- 3 PROVIDE FORCE FLOW ELECTRIC HEATER 3000 WATTS, 208 VOLT, 1-PHASE C/W BUILT-IN ROOM THERMOSTAT, CCT H 3/5.
- 4 600 AMP MAIN DISCONNECT SWITCH AND HYDRO METER/CT 347/600 VOLT, 3-PHASE, 4 WIRE.
- 5 METER CENTER C/W CIRCUIT BREAKERS, TOTAL OF 16 METERS AND CIRCUIT BREAKERS REFER TO DISTRIBUTION DIAGRAM.
- 6 PROVIDE POWER FOR EXHAUST FAN, 120 VOLT, FRACTIONAL H.P. THE FAN TO BE CONTROLLED BY LINE THERMOSTAT, SUPPLIED BY THE MECHANICAL CONTRACTOR, INSTALLED/WIRED BY THE ELECTRICAL CONTRACTOR, CCT H 13.
- 7 LINE VOLTAGE ROOM THERMOSTAT FOR EXHAUST FAN CONTROL, SUPPLIED BY THE MECHANICAL CONTRACTOR, INSTALLED/WIRED BY THE ELECTRICAL CONTRACTOR.
- 8 TELEPHONE/DATA BACKBOARD, 4" HIGH, 3" WIDE, 3/4" THICK FIRE RETARDANT PLYWOOD BOARD.
- 9 DRY CORE TRANSFORMER FROM 600 VOLT TO 120/208 VOLT, 3-PHASE, 4 WIRE, 30KVA, INSTALL THE TRANSFORMER ABOVE FLOOR AS HIGH AS POSSIBLE C/W SEISMIC STEEL SUPPORT CONTRACTOR IS TO RETAIN A QAILED STRUCTURAL ENGINEER TO DESIGN AND REVIEW THE SUPPORT C/W SEALED & SIGNED DOCUMENT.
- 10 PROVIDE ELECTRICAL PANEL "H" 120/208 VOLT, 3-PHASE, 4 WIRE, 125 AMP MAINS, 30 CIRCUITS.

NOTES

1. ALL ITEMS INDICATED ON THIS DRAWING ARE NEW UNLESS OTHERWISE NOTED.
2. CONTRACTOR IS TO SUPPLY & INSTALL & WIRE ALL DEVICES NOTED ON THIS DRAWING UNLESS OTHERWISE NOTED.

LEGEND

	COMBINATION EMERGENCY BATTERY PACK G.V.D.C., EMERGENCY LIGHT HEADS AND ILLUMINATED EXIT SIGN ("GREEN RUNNING MAN") POWER WIRING TO BE PROVIDED BY FUTURE TENANT
	SINGLE PHASE MOTOR C/W UNFUSED DISCONNECT SWITCH. POWER WIRING TO BE PROVIDED BY FUTURE TENANT
	DISCONNECT SWITCH (UNFUSED)
	DISCONNECT SWITCH
	CEILING JUNCTION BOX
	WEATHER PROOF
	DUPLEX RECEPTACLE
	LED EXTERIOR WALL MOUNTED LIGHT FIXTURE CONNECTED TO HOUSE PANEL LIGHT FIXTURE TO SPECIFIED BY THE OWNER LIGHT FIXTURE TO BE CONTROLLED BY A CENTRAL PHOTOCELL SYSTEM C/W RELAY/CONTACTOR AS REQUIRED

proj. north

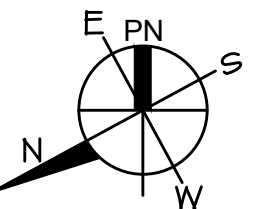

B.A. Design Ltd.
Complete Engineering Services

1470 Triole Street,
Unit 2, Ottawa, Ontario
K1B 3S6
Tel: (613) 742-1853
Fax: (613) 742-0386
E-mail: altman@trytel.com

SEAL



1	ISSUED FOR PERMIT	08/Dec/2017
No	Revision	Date

A	A detail no.	A
B	B location drawing no.	B
C	C drawing no.	C

project

**LONGFIELDS STATION
COMMERCIAL PLAZA**

605 LONGFIELDS DRIVE
OTTAWA, ONTARIO

drawing

**UNIT 9 TO UNIT 15
ELECTRICAL LYOUT**

designed	H.D.
drawn	G.C.
revised	B.A.
date	08/Dec/2017
scale	1/8" = 1' - 0"
project no.	LCP12-2017
file no.	
drawing no.	