

LEGEND	
	COMBINATION EMERGENCY BATTERY PACK GVDC, EMERGENCY LIGHT HEADS AND ILLUMINATED EXIT SIGN ('GREEN RAUNNING MAN') POWER WIRING TO BE PROVIDED BY FUTURE TENANT
	SINGLE PHASE MOTOR C/W UNFUSED DISCONNECT SWITCH. POWER WIRING TO BE PROVIDED BY FUTURE TENANT
	DISCONNECT SWITCH (UNFUSED)
	DISCONNECT SWITCH
	CEILING JUNCTION BOX
	WEATHER PROOF
	LED EXTERIOR WALL MOUNTED LIGHT FIXTURE CONNECTED TO HOUSE PANEL LIGHT FIXTURE TO BE SPECIFIED BY THE OWNER LIGHT FIXTURE TO BE CONTROLLED BY A CENTRAL PHOTOCELL SYSTEM C/W RELAY/CONTACTOR AS REQUIRED

DRAWING NOTES	
1	ALL ITEMS INDICATED ON THIS DRAWING ARE NEW UNLESS OTHERWISE NOTED
2	CONTRACTOR IS TO SUPPLY & INSTALL & WIRE ALL DEVICES NOTED ON THIS DRAWING UNLESS OTHERWISE NOTED

proj. north

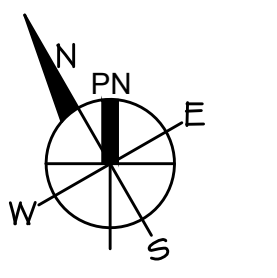

**B.A. Design Ltd.**  
Complete Engineering Services

1470 Triole Street,  
Unit 2, Ottawa, Ontario  
K1B 3S6  
Tel: (613) 742-1853  
Fax: (613) 742-0386  
E-mail: altman@trytel.com

SEAL



No	Revision	Date
1	ISSUED FOR PERMIT	08/Dec/2017

A	A detail no.	A
B	B location drawing no.	B
C	C drawing no.	C

project  
**LONGFIELDS STATION  
COMMERCIAL PLAZA**  
605 LONGFIELDS DRIVE  
OTTAWA, ONTARIO

drawing  
**UNIT 1 TO UNIT 8  
ELECTRICAL LAYOUT**

designed	H.D.
drawn	G.C.
revised	B.A.
date	08/Dec/2017
scale	1/8" = 1' - 0"
project no.	LCP12-2017
file no.	
drawing no.	<b>E-2</b>

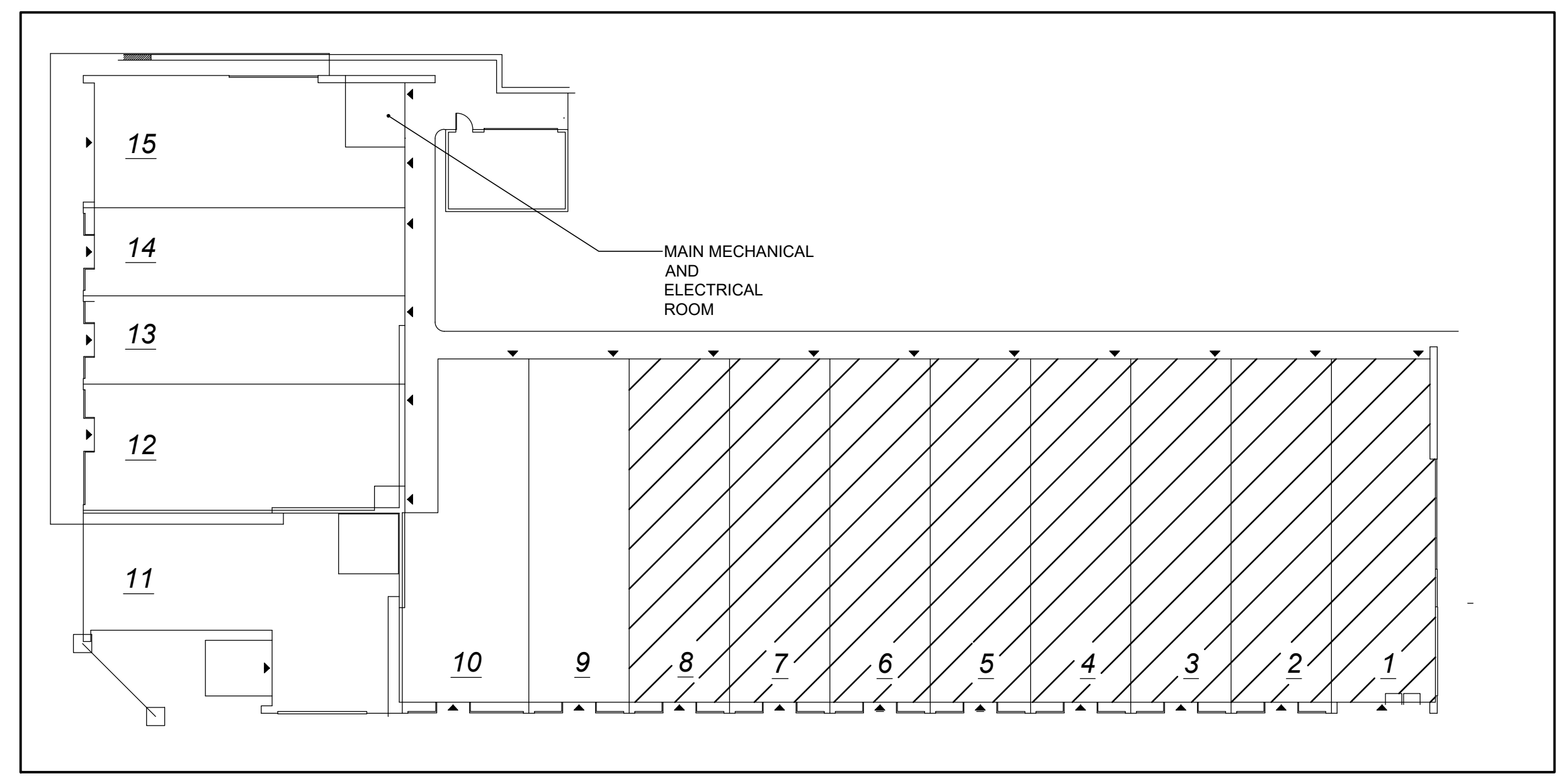

**KEY PLAN - UNIT 1 TO UNIT 8**  
N.T.S.